

# Stoney Ridge

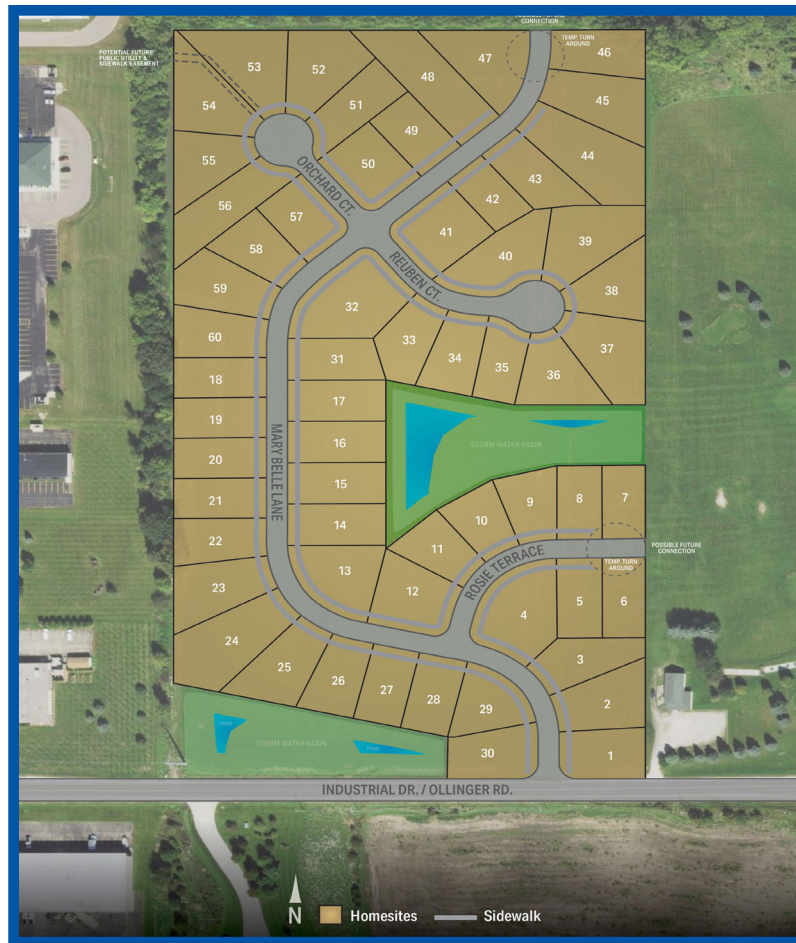

Harbor Homes is excited to build at Stoney Ridge in Beaver Dam. This highly affordable community will include 60 single-family homes from Harbor Homes. With 8 floor plans ranging from 1610 to 2288 square feet and multiple elevations, there are options for every lifestyle. **Harbor's All-in-One Home & Lot packages make living in Stoney Ridge even more affordable.**

Beaver Dam is a vibrant and welcoming community offering a 6,000-acre lake, great parks, a high-quality school district, and plentiful healthcare options. Situated in between Milwaukee, Madison, and Fond du Lac, Stoney Ridge is perfect for anyone looking for easy access to the cities.

- Min. Size One-Story: 1,200 Sq. Ft.
- Min. Size Two-Story: 1,600 Sq. Ft.
- Approximately 1/4 Acre Homesites
- Municipal Sewer and Water
- Beaver Dam Unified School District
- Protective Covenants

**Directions (from Milwaukee):** Take I-94 West to Exit 267 for WI-26 toward Watertown/Johnson Creek. Right onto WI-26 N/WI-26 Trunk N. Turn left onto County Road A. Then turn left onto Ollinger Road.



**HARBOR**  
HOMES



262-232-8520 | HarborHomesWI.com



# Stoney Ridge

## PHASE 1

Lot	Sq. Ft.	Exposure	Price	Availability
1	10,345	None	SOLD	SOLD
2	12,346	None	SOLD	SOLD
3	10,468	None	SOLD	SOLD
4	13,759	None	Ready Home	Ready Home
5	8,732	None	SOLD	SOLD
6	8,769	None	SOLD	SOLD
7	8,076	4' lookout	SOLD	SOLD
8	8,050	None	SOLD	SOLD
9	8,995	None	SOLD	SOLD
10	8,653	None	SOLD	SOLD
11	9,271	None	SOLD	SOLD
12	11,366	None	\$49,900	Available
13	11,612	None	SOLD	SOLD
14	9,741	None	SOLD	SOLD
15	9,741	None	SOLD	SOLD
16	9,741	None	SOLD	SOLD
17	9,741	None	SOLD	SOLD
18	9,333	None	SOLD	SOLD
19	9,332	None	SOLD	SOLD
20	9,332	None	SOLD	SOLD
21	9,331	None	SOLD	SOLD
22	10,065	None	SOLD	SOLD
23	13,039	None	SOLD	SOLD
24	18,304	None	SOLD	SOLD
25	12,857	None	SOLD	SOLD
26	9,699	None	SOLD	SOLD
27	9,164	None	SOLD	SOLD
28	9,164	None	SOLD	SOLD
29	9,464	None	Ready Home	Ready Home
30	10,726	None	\$44,900	Available



**HARBOR**  
HOMES

Information is deemed to be accurate as of 3/18/2024 and is subject to change without notice or obligation.



262-232-8520 | HarborHomesWI.com



# Stoney Ridge

## PHASE 2

Lot	Sq. Ft.	Exposure	Price	Availability
31	9,083	None	SOLD	SOLD
32	15,618	None	Ready Home	Ready Home
33	10,116	None	\$54,900	Available
34	9,822	None	\$61,900	Available
35	8,493	4' Rear Look-Out	\$61,900	Available
36	11,685	4' Rear Look-Out	\$61,900	Available
37	15,316	4' Rear Look-Out	\$61,900	Available
38	11,666	4' Rear Look-Out	\$59,900	Available
39	15,576	None	\$61,900	Available
40	13,153	None	\$50,900	Available
41	11,438	None	\$50,900	Available
42	7,312	None	\$54,900	Available
43	10,507	None	\$54,900	Available
44	19,066	None	\$61,900	Available
45	13,264	None	\$57,900	Available
46	10,460	2' Side	\$54,900	Available
47	13,444	4' Side Look-Out	\$50,900	Available
48	17,748	None	\$61,900	Available
49	9,200	None	\$54,900	Available
50	10,296	None	\$50,900	Available
51	10,685	None	\$54,900	Available
52	14,037	None	SOLD	SOLD
53	15,267	None	SOLD	SOLD
54	13,890	None	\$59,900	Available
55	11,264	None	\$59,900	Available
56	13,449	None	\$54,900	Available
57	9,205	None	\$50,900	Available
58	10,073	None	Ready Home	Ready Home
59	12,722	None	Ready Home	Ready Home
60	10,777	None	SOLD	SOLD



**HARBOR**  
HOMES

Information is deemed to be accurate as of 3/18/2024 and is subject to change without notice or obligation.



262-232-8520 | HarborHomesWI.com

