

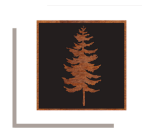

STONE BRIDGE HOMES NW



Autumn Sunrise

**SINGLE-LEVEL
LIVING!**



**DUAL
SUITES**

**9243 SW SALINAN ST
HOMESITE 391
PLAN 400**

ABOUT THE PROPERTY

This single-level plan features stained mission cabinetry, slab quartz countertops with undermount sinks in kitchen and bathrooms, gas fireplace in great room with box beam wood mantel, and Whirlpool stainless steel appliances, including 5 burner gas cooktop, wall oven and wall microwave, stainless steel tub dishwasher and chimney hood vent. Enjoy a roomy primary suite with a spacious walk-in closet and adjoining bath with all tile shower, soaking tub, and dual sink vanity. Front and rear landscaping, fenced with gate, sprinkler system on timer. Gasline for future BBQ! Earth Advantage Certified!

FEATURES

- ✓ 3 BED / 3 BATH
- ✓ 2,070 SF HOME
- ✓ 2 SUITES W/ PRIVATE BATH
- ✓ DEN/3RD BEDROOM
- ✓ CENTRAL AIR CONDITIONING
- ✓ 2 CAR GARAGE
- ✓ FULLY FENCED & LANDSCAPED

\$779,975

RMLS# 352407264



503.746-6215
GaryC@stonebridge-realty.com



MODEL HOME:
9345 SW SALINAN STREET
TUALATIN, OR 97062

Prices, features, and incentives are subject to change. Photos and drawings are for illustrative purposes only and actual details may vary. Please see a sales representative and the sale agreement for additional information. CCB#173318



HOMESITE 391

9243 SW SALINAN ST.
TUALATIN OR, 97062

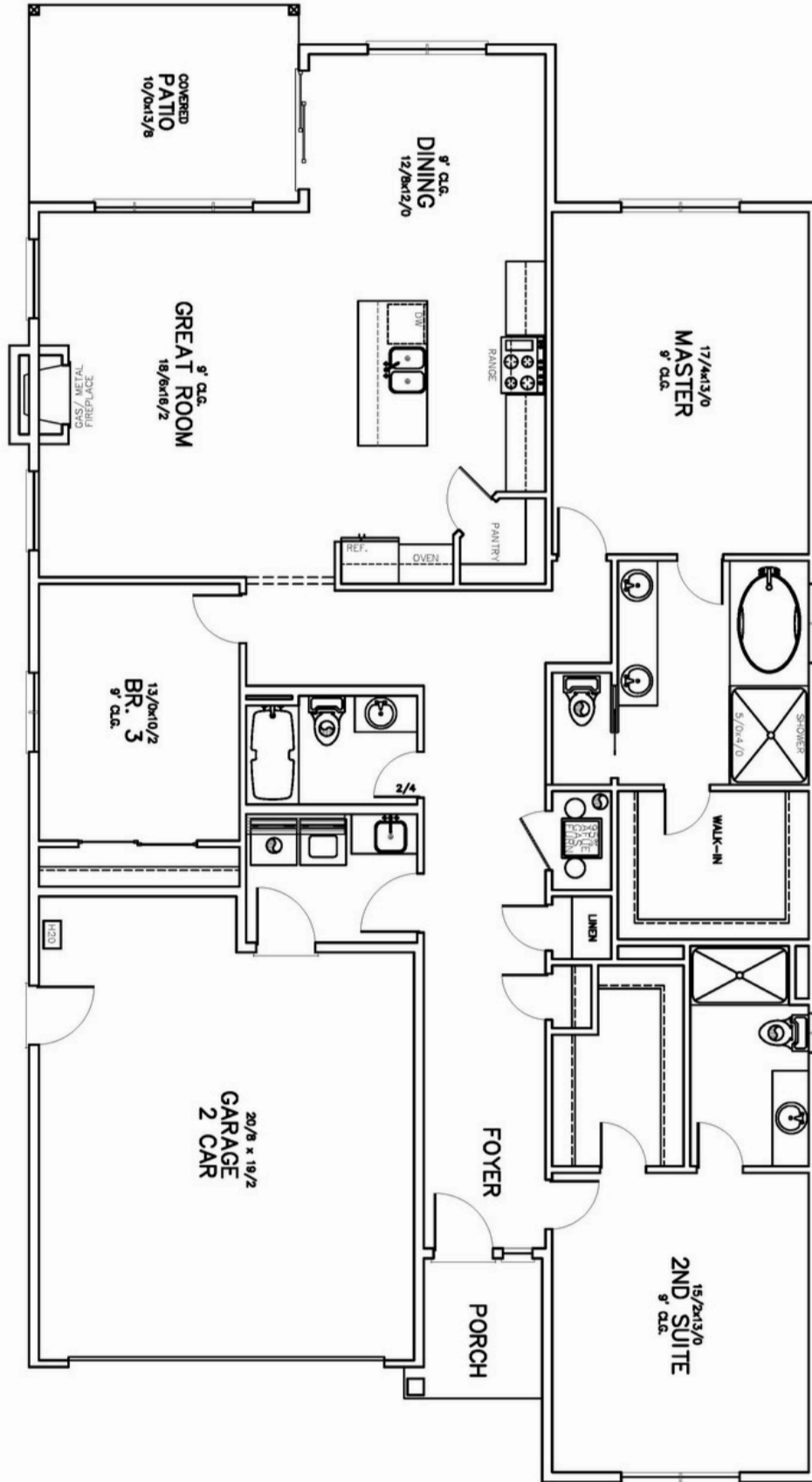

Autumn Sunrise