

Hayden 3-Car

- 4 BEDROOMS ■ 2 BATHS
- 2,008 SF (A/C LIVING) ■ 3-CAR

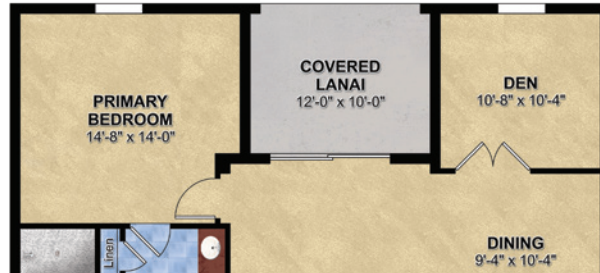

Floor Plan



Optional Den
(#00027)

SQUARE FOOTAGE – BASE PLAN

A/C Living.....	2,008 sf
3-Car Garage.....	655 sf
Covered Lanai.....	120 sf
Entry Porch.....	95 sf
Total Under Roof	2,878 sf



Optional 3 Bedroom with Den
(Includes Extended Lanai)
(#00077)



BASE FLOOR PLAN



Optional Extended Covered Lanai
(#00076)



Optional Garage
Service Door
(#00001)

ELEVATION
01

SHOWN WITH STUCCO FINISH



ELEVATION
01

SHOWN WITH OPTIONAL STONE



ELEVATION
02

SHOWN WITH STUCCO FINISH



ELEVATION
02

SHOWN WITH OPTIONAL STONE



ELEVATION
03

SHOWN WITH STUCCO FINISH



ELEVATION
03

SHOWN WITH OPTIONAL STONE



ELEVATION
04

SHOWN WITH STUCCO FINISH



ELEVATION
04

SHOWN WITH OPTIONAL STONE



*See full disclaimer at bottom of preceding page.