



SANDLIN
HOMES



Sheppard's Place

Waxhachie, TX

417 Daybreak Drive

2,311

SQUARE FEET

4

BEDROOMS

3

BATHROOMS

2

GARAGE

\$424,900

Was \$474,900

Redwood JS

- Open Floor Plan
- Large Kitchen Island
- Oven Tower
- Freestanding Bathtub
- Large Walk-In Closet
- J-Swing Garage
- Covered Patio

Jorge Esquivel

817-562-9218

JorgeE@SandlinHomes.com

2225 Sheppards Lane
Waxahachie, TX 75167

www.SandlinHomes.com



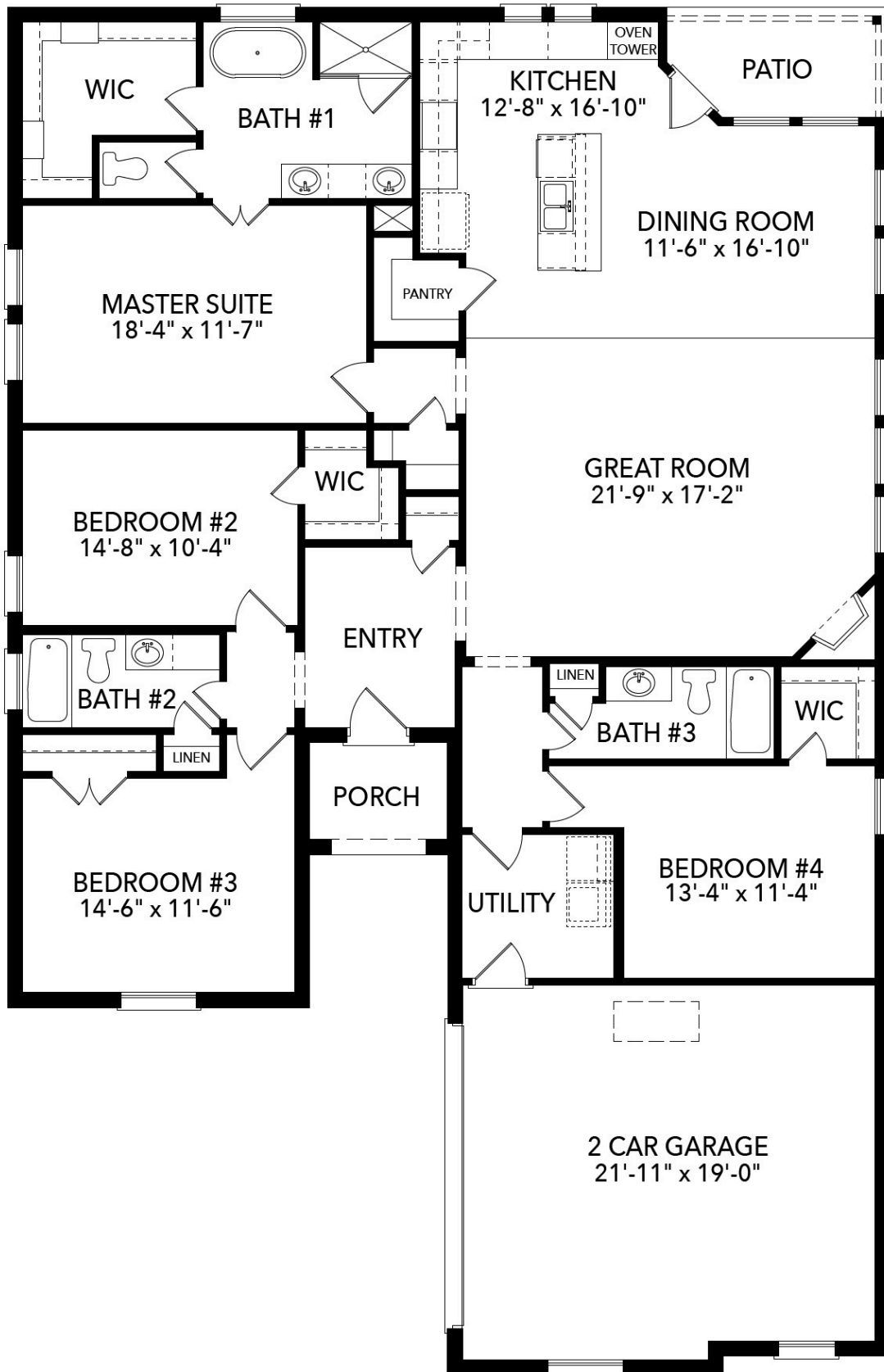

First Floor