



2026

Garman

BUILDERS



INCLUDED FEATURES

Autumn Chase Townhomes

INTRODUCTION

The following pages will be your introduction to the Included Features in your Garman Builders home. We encourage you to visit our online design studio to learn more about the options available in your home.

Scan the QR code below to learn more!



- Neighborhood Features** 3
- Local Community** 4
- Building Science & Efficiency** 5
- Building Structure** 6-7
- Exterior Features** 8
- Interior Features** 9-11
- Electrical** 12
- HVAC & Plumbing** 13-14
- Online Design Studio** 15
- Online Visualizer** 16

Disclaimer: On-screen and printed colors may vary from actual materials. Photos shown include some optional features or upgrades. All products are subject to manufacturer availability. Some selections, products, materials, color and finishes may not be available for every community and floorplan. All specifications are subject to change without notice. Some restrictions may apply. Please see your Community Sales Agent or Design Team Member for more details.

NEIGHBORHOOD FEATURES

Small-town Charm, Easy Access, & Convenience

Welcome to Garman's newest multi-family community near Harrisburg, offering first floor living options with a two-car garage.

With a balance of small-town charm and easy access to exciting cities like Harrisburg, Mechanicsburg, and Lancaster, Autumn Chase Townhomes offers the best of both worlds.

At Autumn Chase, get a low-maintenance lifestyle with a homeowners' association to take care of exterior maintenance, lawn care, and snow removal.

HOA Regulations: Outdoor storage buildings (i.e. sheds etc.) and fencing must be approved by the HOA. No chain-link, wire, net, or stockade fencing permitted. Hot tubs and swimming pools are not permitted.

ABOUT THE AREA



Autumn Chase is close to everything you need! For a full listing, scan here.

Entertainment | Healthcare | Shopping



Slanted Curbing



Community Shade Trees



Public Water



Natural Gas Available

4

Distinct Floor Plans

\$

\$81 / month HOA Fee

Rolling hills and farmland views set the stage for a carefree lifestyle!

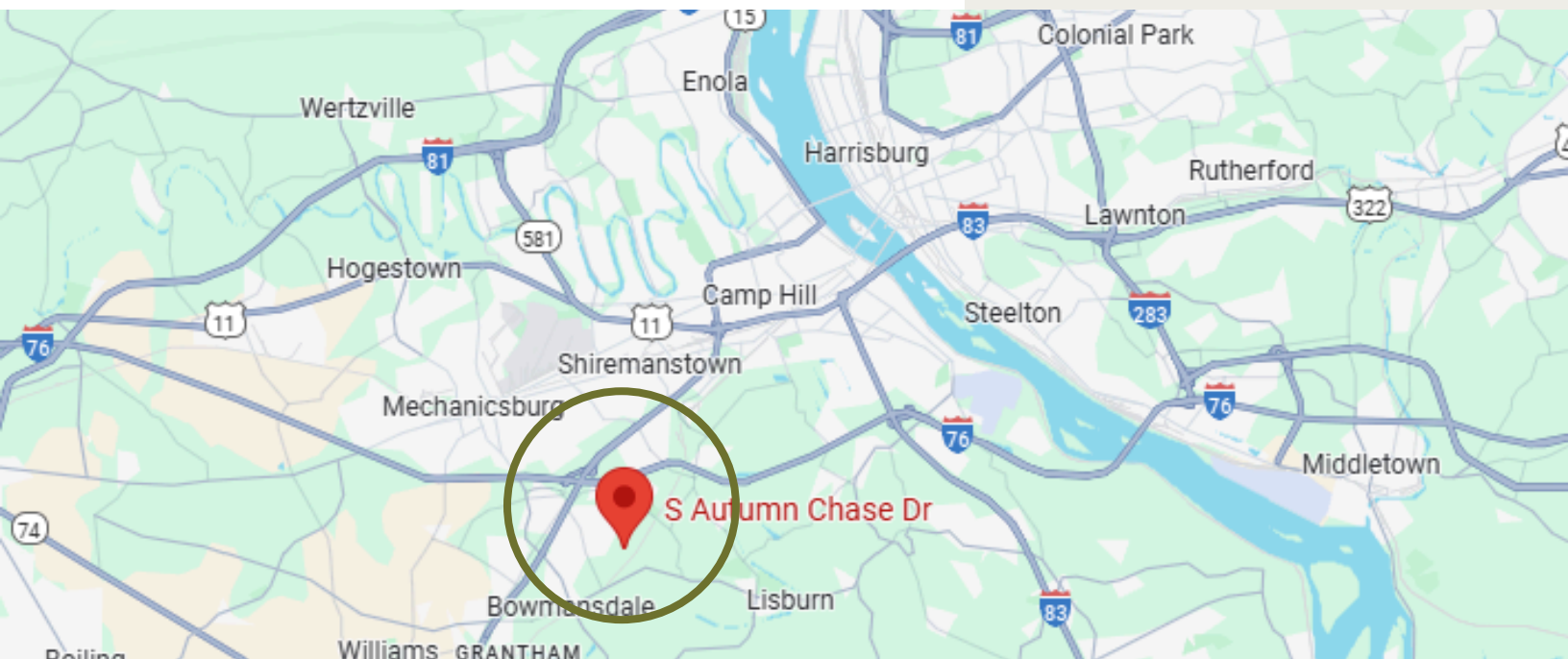

LOCAL COMMUNITY



OUTDOOR ACTIVITIES

- McCormick Park
- Liberty Forge Golf Course
- Lower Allen Community Park

CULTURAL & EDUCATIONAL

- Whitaker Center for Science & the Arts
- Harrisburg Midtown Arts Center
- Climenhaga Fine Arts Center

TRAVEL

- Harrisburg International Airport
- Lancaster Airport
- Capital City Airport

ENTERTAINMENT & SHOPPING

- Dave & Busters
- Hershey Outlets
- Hersheypark



BUILDING SCIENCE & EFFICIENCY

Our Homes are Built on Innovation and Energy Efficiency.

Garman Builders builds a better home with innovative thinking, techniques, and products. Our plans are meticulously designed with a 'built the way you live' mentality.

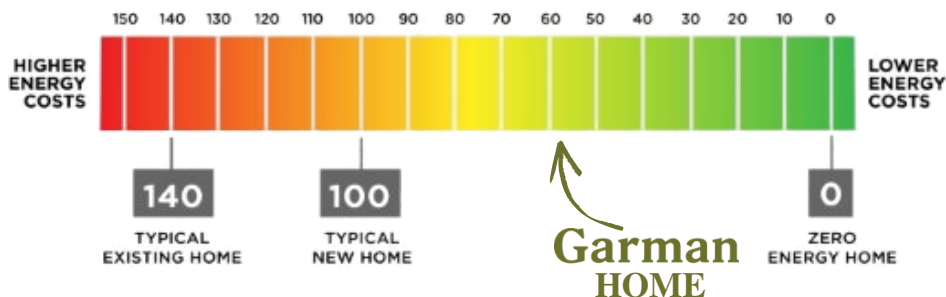

Garman homes averages 64 on the HERS scale, making them **37% more efficient than the average home built today.**



Garman's total air leakage score is **33% better than the industry code.**



Our homes feature the Super Seal Air Infiltration Package, delivering **10% higher overall performance compared to standard wall construction.**



BETTER INSULATION

Our continuous insulation outperforms conventional insulation methods, increasing efficiency and longevity.

Garman

BUILDERS



Built for the way you live.



STRONGER FOUNDATION

Our homes are built with revolutionary, precision pre-cast foundations using The Superior Wall System to provide insulation and easy expansion capabilities.

BUILDING STRUCTURE

Continuous Foam
Insulation Installed over
7/16-inch OSB
Sheathing

2x4 Wall
Framing

Roof System with
Engineered Trusses

2x10 Floor
Joists



Superior Walls®
Concrete Wall Panels

Primary Floor Full-
integrated Wax Coated
Subflooring

Primary Floor "Bridging"
between Floor Joists

BUILDING STRUCTURE

Conditioned air stays inside structure

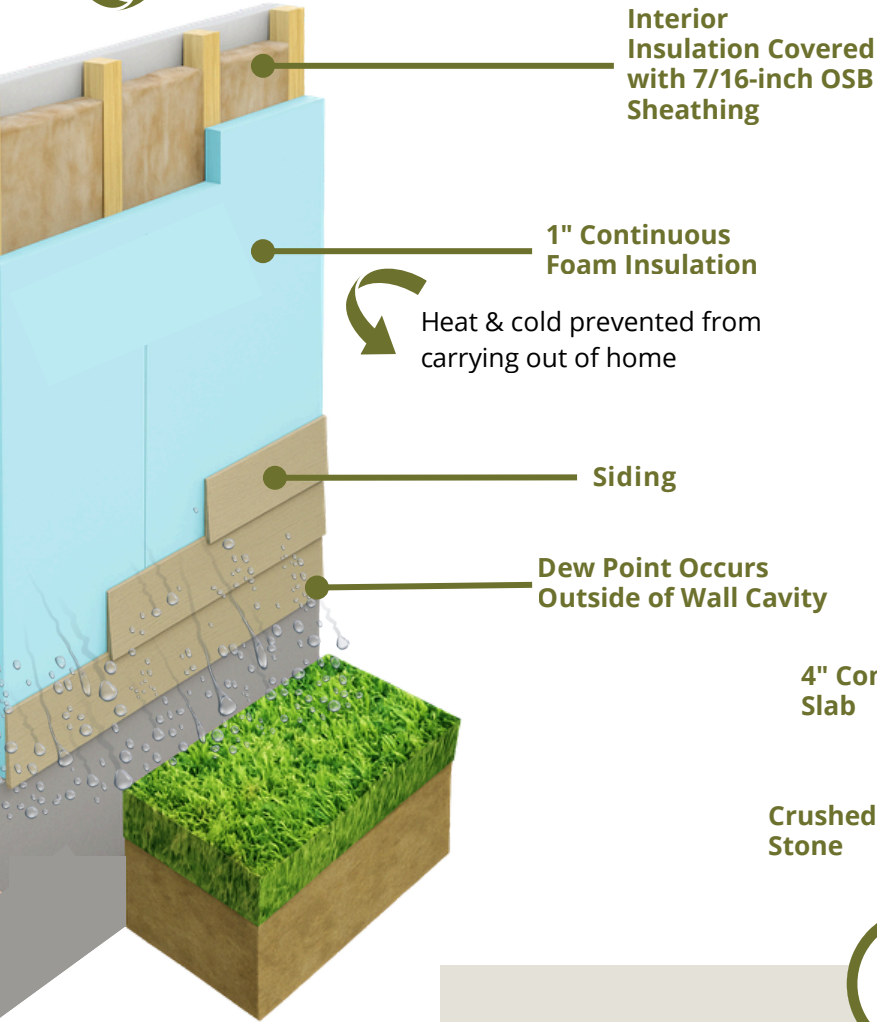

EXTERIOR WALL INSULATION

Every Garman home is externally wrapped in a continuous insulated sheathing panel.

This not only provides energy efficiency but also allows for insulation across wall 2x4s.

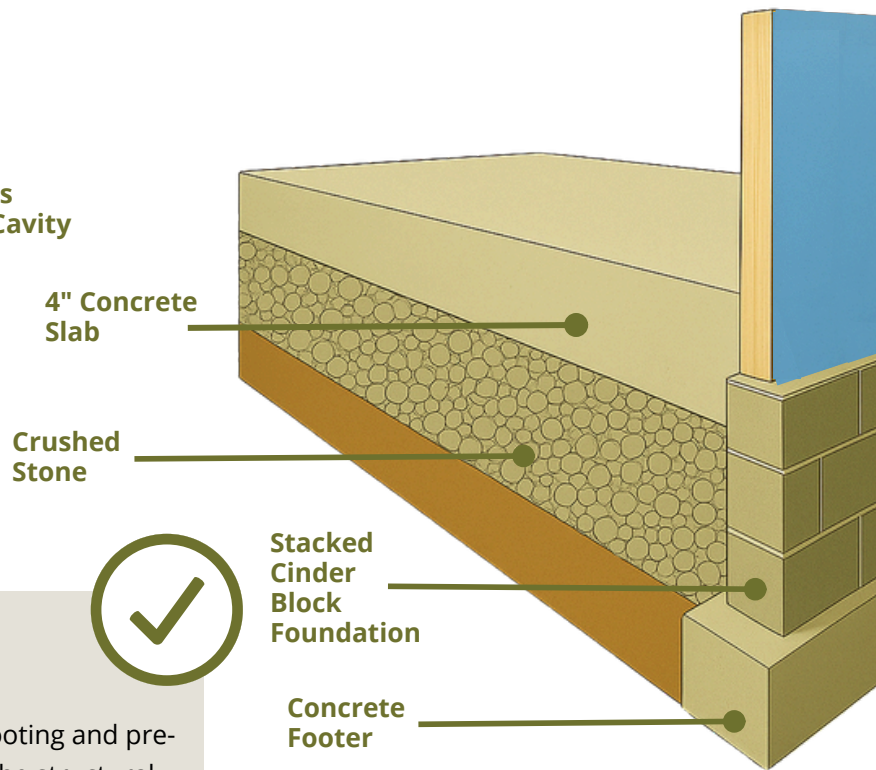

SLAB FOUNDATION

Reinforced concrete footing and pre-cast block walls carry the structural load. Followed by a crushed-stone layer, rigid foam insulation, and 4-inch concrete slab to manage moisture and thermal flow.

INCLUDED EXTERIOR FEATURES



Aluminum
facia

Tamko® Dimensional
Shingles with Limited
Lifetime Warranty.

Aluminum
freeze
board

Optional,
metal
roofing.

Royal® Building Products vinyl
siding is included on your home
along with vinyl board and
batten or portsmouth shake,
dependent on plan.

United Window &
Door single hung,
vinyl windows with
Limited Lifetime
Warranty.

Aluminum
window
wrap, per
elevation.

CHI® insulated garage door with
LiftMaster® electric garage door
opener including push button and
remote control.

Fiberglass front door
(optional door pictured).

INCLUDED ENTRY FEATURES



**Foyer Light
Fixture**



**Drywall Returns
at Windows**



**9 Foot
Ceilings**



**Garman Flat,
Soft-white Paint
Package**



**3 1/4 Inch
Baseboard
Trim**



**Half-wall
Railing**



**Carpet Package
in Dry Areas**

*Please note image includes optional features.

INCLUDED KITCHEN FEATURES



*Cabinetry from Woodmont Cabinetry along with granite countertops, hardware included.

*Please note image includes optional features.

INCLUDED BATH FEATURES



Interior Six
Panel Doors

Plate Glass
Mirror

Fiberglass Tub /
Shower Combo

Delta®
Plumbing
Fixtures

Cultured
Marble
Countertops

INCLUDED ELECTRICAL



Half Bath

SMOKE DETECTORS
Combination carbon monoxide/smoke detectors are hardwired throughout the home, per code.



Interior Recessed



Primary Bath



Dining Room



Exterior



- Exhaust fans in every bathroom
- 4 recessed can lights in kitchen
- 3 recessed lights over kitchen island (per plan)
- 1 flush-mount light at front door
- Exterior lights at garage (per plan)
- Progress® light fixtures
- 3 phone or cable jacks
- GFI-protected over the counter outlets

INCLUDED HVAC & PLUMBING

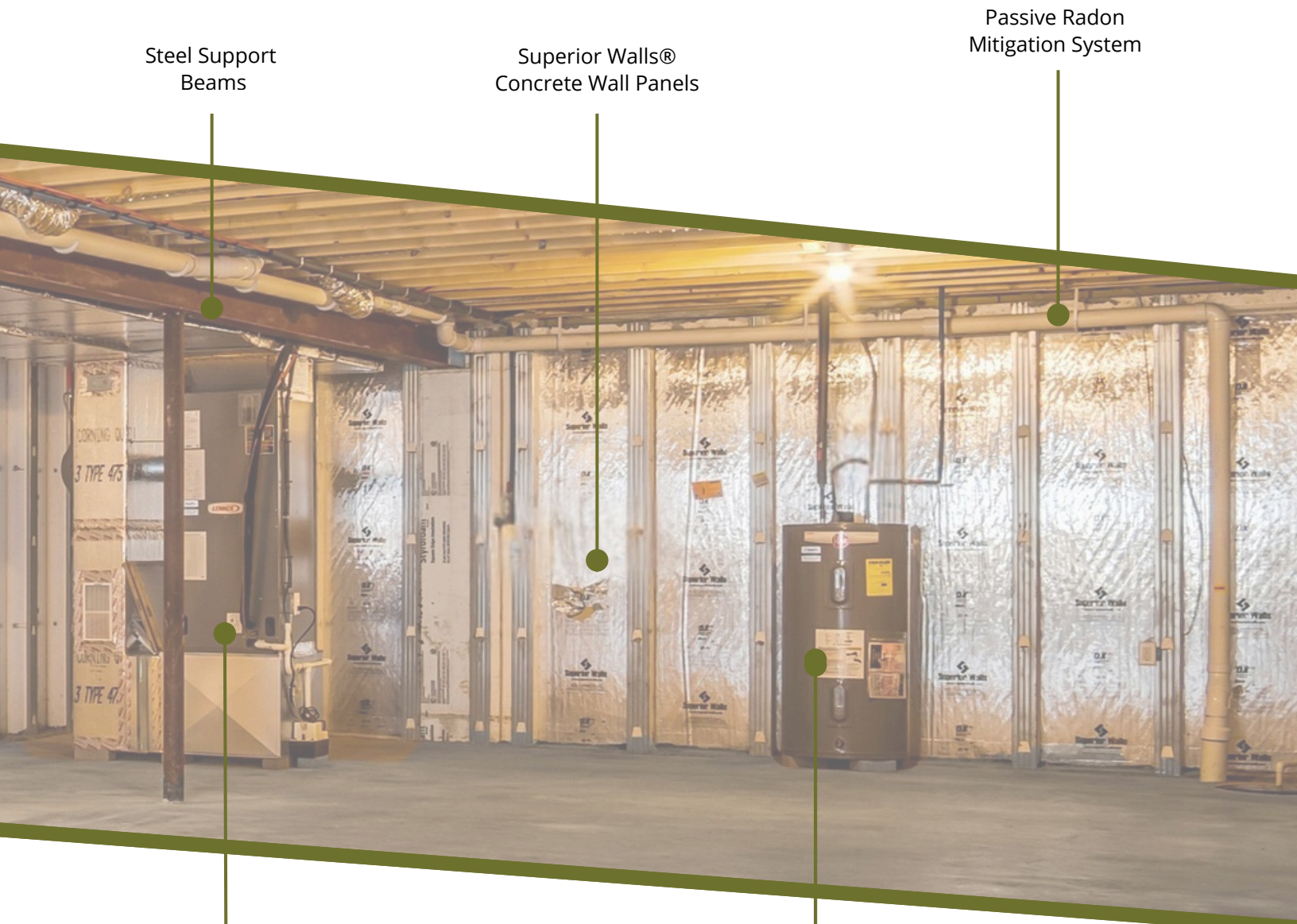

Steel Support Beams

Superior Walls® Concrete Wall Panels

Passive Radon Mitigation System

Lennox® 14 SEER Heat Pump & Air Handler, included.

50-gallon Water Heater

INCLUDED HVAC & PLUMBING



**Bath
Faucet**



Thermostat



**Powder
Bath Sink**



**Kitchen
Faucet**



Toilets



- Frost-free exterior house bibb
- Round front toilets
- 50 gallon electric water heater
- Programmable thermostat
- Efficient MERV 8 air filters
- Passive radon mitigation system

ONLINE DESIGN STUDIO

My Dream Home: My Dream Home: My Dream Home



WELCOME TO THE GARMAN BUILDERS ONLINE DESIGN STUDIO!

Making all of the choices of your new home is exciting but can also be an overwhelming task.

To help prepare you for your Design Selections Appointment, scan the below QR code.

You can browse inspirational photos, view our online catalog, add your favorite items(s) to your Wish List and collect product ideas!



- Browse design features for all areas of the home
- Explore your home's Included Features in the design library
- Selections will be automatically shared with your design expert

GET STARTED!



VISUALIZER TOOL

FLOOR PLANS MY PROJECTS SAVE SHARE FEEDBACK HELP

The screenshot displays the Garman Visualizer Tool interface. At the top, a navigation bar includes 'FLOOR PLANS', 'MY PROJECTS', 'SAVE', 'SHARE', 'FEEDBACK', and 'HELP'. The main content area is divided into three sections:

- Left Panel:** A sidebar for editing the 'Front Door'. It shows '57% COMPLETE' and 'APPLIED PRODUCT: Pewter Green'. Below this is a 'VIEW ALL APPLIED' button and a grid of color swatches with names: Black Magic, Dark Night, Stolen Kiss, Roycroft Bottle Green, Waterloo, Porpoise, Quietude, Mount Etna, and Elephant Ear.
- Center:** A large 3D rendering of a house with a stone and white siding exterior, a dark roof, and a green lawn.
- Right Panel:** Project details for 'Bryson K-15', including '3 Beds', '1880 Sq Ft', '2 Full Baths', '0 Half Baths', '3 Car Garage', and '1 Stories'. Below this is a 'MORE INFO' section with three smaller house images and 'SWITCH TO A-10', 'SWITCH TO G-10', and 'SWITCH TO H-10' buttons.

Design Your Home with Garman's New Visualizer!

GET STARTED!



With our new visualizer platform, view exterior options for our most popular models, try out elevation, save your project, and even send to family and friends!



- Try out various floor plans & elevations
- Explore different color and material palettes
- Save and share your projects
- Create a account for easy access to your designs



GET AN **EDGE** WITH GARMAN

At Garman Builders, we set the standard in home construction — combining over 50 years of expertise with innovative building science to deliver better-built, more efficient homes.



EFFICIENCY

Garman homes are HERS tested and proven to be 37% more energy-efficient than today's average home.



DESIGN

By using cutting-edge building science and design, we deliver high-performance homes built for lasting value.



GUARANTEE

We guarantee your settlement date—on time, every time. If we're late, we'll pay you \$150 for every day of delay.



EXCELLENCE

From the ground up, we deliver quality craftsmanship resulting in a home you'll be proud to call your own.





**BUILDING HOMES, COMMUNITIES,
AND CONNECTIONS THAT
POSITIVELY IMPACT THE
LIVES OF OTHERS**



garmanbuilders.com
717-733-4383