

The Augusta

BY TODD HOMES LLC

TODD
Homes llc.com
Affordable Luxury



THE AUGUSTA FEATURES:

- Easy One-Level Living In This Custom Ranch by Todd Homes
- Step Into The Open Foyer & Experience The Magnificent Open Living Triangle of The Dining Room, Great Room & Kitchen
- Beautiful & Durable LVT Flooring In All Shared Living Spaces
- Spacious, Upscale Kitchen With Granite Countertops, Dining/Food Prep/Serving Island with Overhead Pendant Lights, Soft Close Shaker Cabinetry, Stainless Steel Appliances & Walk-In Pantry
- Expansive Great Room Flows Into The Kitchen
- Optional 14ft x 10ft Light Filled Sunroom Adds 140sf
- Private Primary Suite Has a Walk-In Closet & Adjoining Spa-Like Bath with a Walk-In Shower, Quartz Topped Vanity & Dual Sinks
- Add The Optional Lower Level With Full Bath Rough-In & Egress

 **3**
Bedrooms

 **2**
Bathrooms

 **2**
Garage

 **1600 - 1740**
Square Feet

The Augusta

BY TODD HOMES LLC

TODD
Homes
llc.com
Affordable Luxury

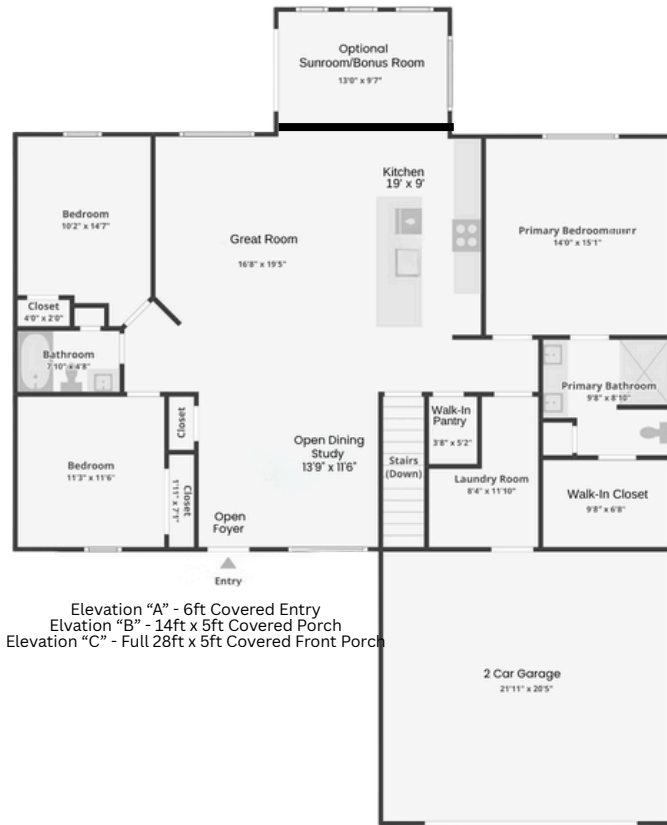

Elevation "A" - 6ft Covered Entry
Elevation "B" - 14ft x 5ft Covered Porch
Elevation "C" - Full 28ft x 5ft Covered Front Porch

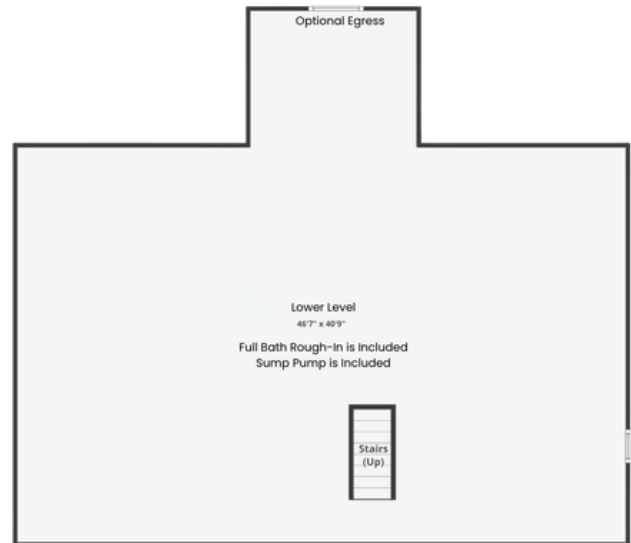

TOUR THE AUGUSTA

CONTACT US  513.823.3774  VISIT US: www.toddhomesllc.com