

· P E N N ·
M E A D O W S

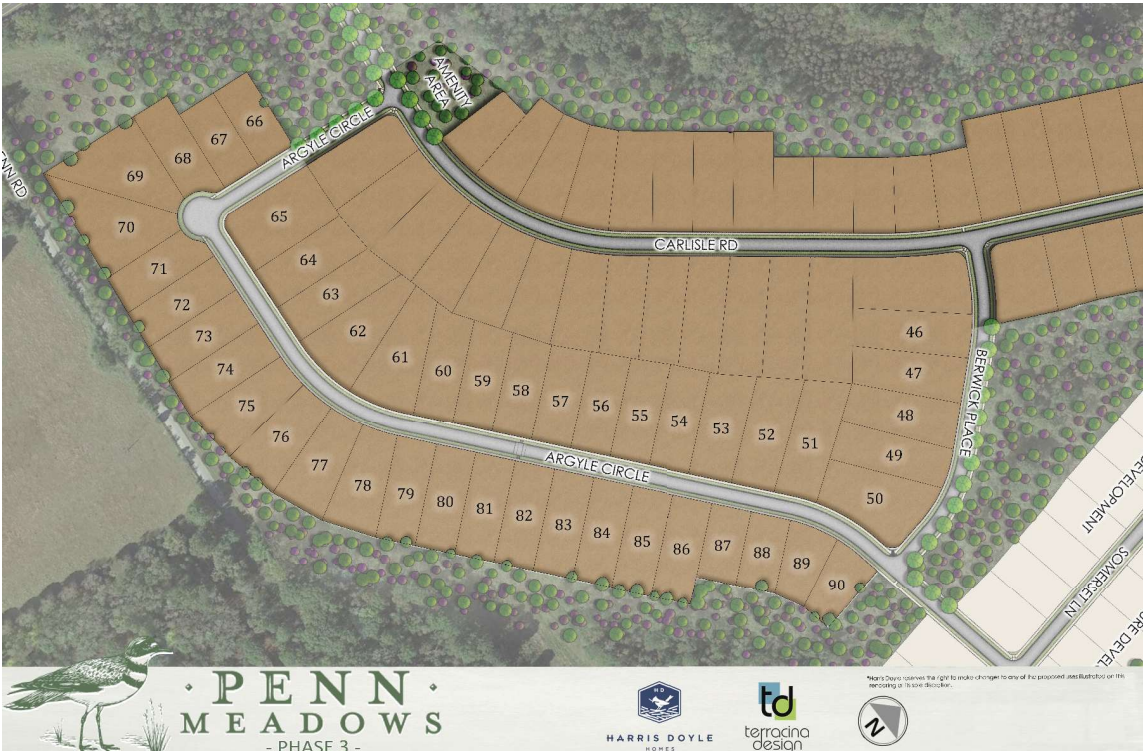

*Harris Doyle reserves the right to make changes to any of the proposed uses illustrated on this rendering at its sole discretion.



· P E N N ·
M E A D O W S



STEPHANIE GWIN GANT
Mortgage Loan Originator
205-516-7282
stephanie.gant@silvertonmortgage.com
silvertonmortgage.com/harrisdoyle
NMLS 184503
3115 Timberlake Road, Suite 200 | Birmingham, AL 35243



HARRIS DOYLE
HOMES

LIFE WELL CRAFTED

HARRISDOYLE.COM

ALL LOANS ARE SUBJECT TO CREDIT APPROVAL.
Silverton Mortgage closing cost credit is paid by Harris Doyle Homes and is only available for borrowers financing the purchase of a new home from Harris Doyle Homes with Silverton Mortgage. Closing cost credit will be limited to the amount of the actual closing costs, up to \$2,500. Closing costs that exceed \$2,500 are the responsibility of and must be paid by the buyer financing with Silverton Mortgage. Closing cost credit may not be available with all loan programs.
Vanderbilt Mortgage and Finance, Inc. dba Silverton Mortgage, 1201 Peachtree St NE, Ste 2050, Atlanta, GA 30361, 404-615-0291, NMLS #1561, (https://www.nmlsconsumeraccess.org/), AZ Lic. #BK-0902616, Licensed by the Department of Financial Protection and Innovation under the California Residential Mortgage Lending Act license, Licensed by the N.J. Department of Banking and Insurance, Licensed by PA Dept. of Banking, Rhode Island Licensed Lender, Licensing information: https://silvertonmortgage.com/licensing/. All information is believed accurate and is subject to change without notice. 01/2022

the plans

Homes

plan name	approx. sf	beds/baths	garage spaces
BRISTOL	1,760 <small>(1760/0)</small>	3/2	2
TUCKER	2,009 <small>(2009/0)</small>	3/2	2
BEDFORD	2,015 <small>(2015/0)</small>	3/2	2
GRIFFIN	2,085 <small>(1590/495)</small>	4/3	2
PORTSMOUTH	2,128 <small>(2128/0)</small>	3/2	2
SHEFFIELD	2,254 <small>(2254/0)</small>	3/2	2
MANSFIELD	2,358 <small>(2358/0)</small>	4/3	2
WALKER	2,685 <small>(2685/0)</small>	4/3.5	2
FRANKLIN	2,752 <small>(1644/1108)</small>	4/2.5	2
AZALEA	2,841 <small>(1817/1024)</small>	4/3	2
CLERMONT	2,824 <small>(1569/1255)</small>	4/2.5	2
NICKLAUS	2,849 <small>(1661/1188)</small>	4/3.5	3
JEFFERSON	2,850 <small>(1945/905)</small>	4/3	2
GARRETT	3,038 <small>(2002/1036)</small>	4/3	2

Featured Community Amenities & Area Schools

Community Amenities

- ◊ Swimming Pool
- ◊ Open Air Pavilion
- ◊ Sidewalks
- ◊ Green Spaces

Pike Road School District

- ◊ Pike Road Elementary School
- ◊ Pike Road Intermediate School
- ◊ Pike Road Junior High School
- ◊ Pike Road High School



SHERRY JONES, *New Home Specialist*
PENNMeadows@HARRISDOYLE.COM | 334.651.1979

included home amenities

Interior

- ◊ Garage with Sheetrock & White Paint
- ◊ Level 1-2 Luxury Vinyl Plank Flooring in Main Level Living Areas & Hallways
- ◊ Shaw Tile Flooring in Laundry & Bathrooms
- ◊ Shaw Carpet Flooring in Bedrooms, Loft & Stairs
- ◊ 9' Ceiling Heights on Main Level, 8' on 2nd Level
- ◊ Decorative 2-Panel Interior Doors
- ◊ Oil Rubbed Bronze Door Hardware
- ◊ Crown Moulding in Main Level Living Areas & Primary Suite
- ◊ 36" Direct Ventless Fireplace with Gas Logs
- ◊ Designer Fireplace Mantel with Tile Surround
- ◊ **Kitchen:**
 - 36" Purestyle or Stained Finish Cabinets with Slow-Close Doors
 - Granite Countertops
 - Designer Tile Backsplash
 - 60/40 Stainless Undermount Sink
 - Delta Faucet with Pull-Down Sprayer
 - Frigidaire Stainless 30" Freestanding Gas Range
- Frigidaire Stainless Over-the-Range Exterior Vented Microwave
- Energy Star, Frigidaire Stainless Dishwasher
- ◊ **Primary Bath:**
 - Purestyle or Stained Finish Cabinets with Slow-Close Doors
 - Granite Countertops
 - Oval Undermount Sinks with WaterSense Delta Faucets
 - Drop-in Tub with Tile Surround (per plan)
 - Tile Shower
- ◊ **Secondary Baths:**
 - Purestyle or Stained Finish Cabinets with Slow-Close Doors
 - Granite Countertops
 - Oval Undermount Sinks with WaterSense Delta Faucets
 - Fiberglass Tub/Shower Unit
 - Pedestal Sink in Powder Room (per plan)

Electrical

- ◊ 1 Floor Outlet in Great Room
- ◊ 2 Exterior Electrical Outlets
- ◊ Wired Smoke Detectors per Code
- ◊ RING Video Doorbell & Chime
- ◊ Bedrooms & Great Room Pre-Wired for Ceiling Fans
- ◊ LED Flush Mount Lighting

Exterior

- ◊ 30-Year, Dimensional Roof Shingles
- ◊ Professionally Designed Landscape Plan
- ◊ Insulated Garage Door(s) with Remote Openers
- ◊ 2 Hose Bibbs
- ◊ Mailbox per Community Covenants
- ◊ Gutters

*Variations and/or substitutions of equal value are subject to builder discretion.

