



# DIY BUILT IN BUNK BEDS



**HISTORYMAKER**

H O M E S

est 1949

# DIY BUILT IN BUNK BEDS AT SIERRA VISTA

Designed By: Sarah Ciesla for HistoryMaker Homes

## Supplies:

- 3/4 MDF Sheets
- Latex Primer
- Latex Bunk Bed Paint - We used Sherwin Williams SW 0048 Bunglehouse Blue Semi-gloss
- Latex Wall Paint - We used Sherwin Williams SW 7066 Gray Matters
- Stud Finder
- Cutting and Joining Solutions for MDF to MDF joints (recommended) <https://www.kregtool.com/>
- Wood Glue
- 1/4"x 3-1/2" Lag Screws
- Coat Hooks
- Plastic or Fabric Drop Cloth

## Tools:

- Tape Measure
- Pencil
- 4-ft and 2-ft levels
- Miter Saw
- Table Saw
- Screw Driver
- Paint brush / roller
- Socket Wrench, Extension, and Ratchet (for lag screws)

## Step by Step:

### 1. Prepare Area for Work

- Remove base trim
- Lay plastic or fabric drop cloth on floor. Tape or tack as required to keep covering in place to protect adjacent surfaces.

### 2. Paint Wall Accent Color

- Follow latex accent color paint manufacturer's instructions and paint wall accent color. Let dry 24-hours.

### 3. Install Bunk Bed Built In

- Use drawings (Figure A, Figure B, and Figure C) as reference. Use table saw and miter saw and cut MDF to size making sure that all MDF joints are perfectly square. **Work slowly - measure 3 times and cut once.**
- Assemble / Install MDF bunk bed built in - we recommended using appropriate KREG cutting and joining solutions and wood glue for all MDF to MDF joints (<https://www.kregtool.com/>)
- Use level to insure MDF elements are perfectly level and plumb.
- Use stud finder to locate wall studs and install lag screws into wall studs as indicated on Figure B and Figure C.
- Follow latex primer manufacturer's instructions and coat all visible surfaces of MDF bunk bed built in. Let dry 24-hours.
- Follow latex bunk bed paint manufacturer's instructions and coat all visible surfaces of MDF bunk bed built in. Let dry 48-hours before placing mattresses.
- Touch up areas of latex accent color and adjacent existing wall paint as required.
- Install coat hooks.

# Figure A

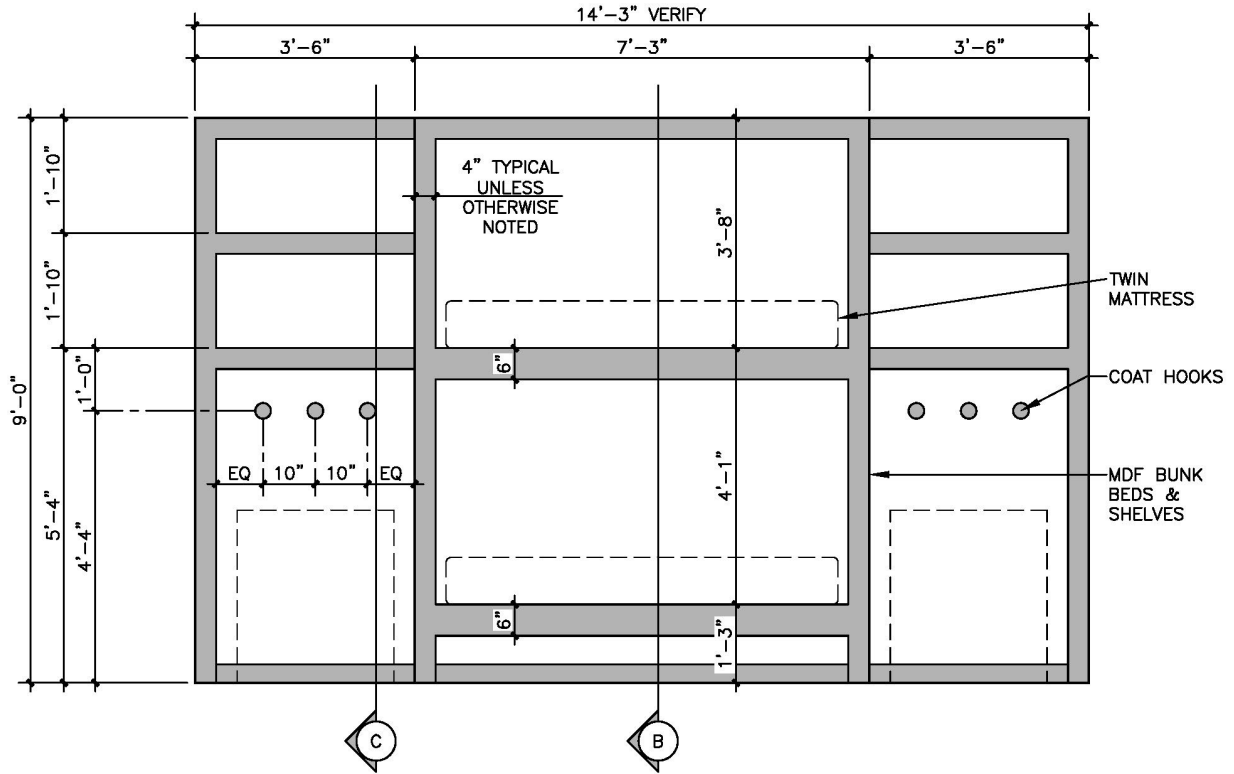

# Figure B

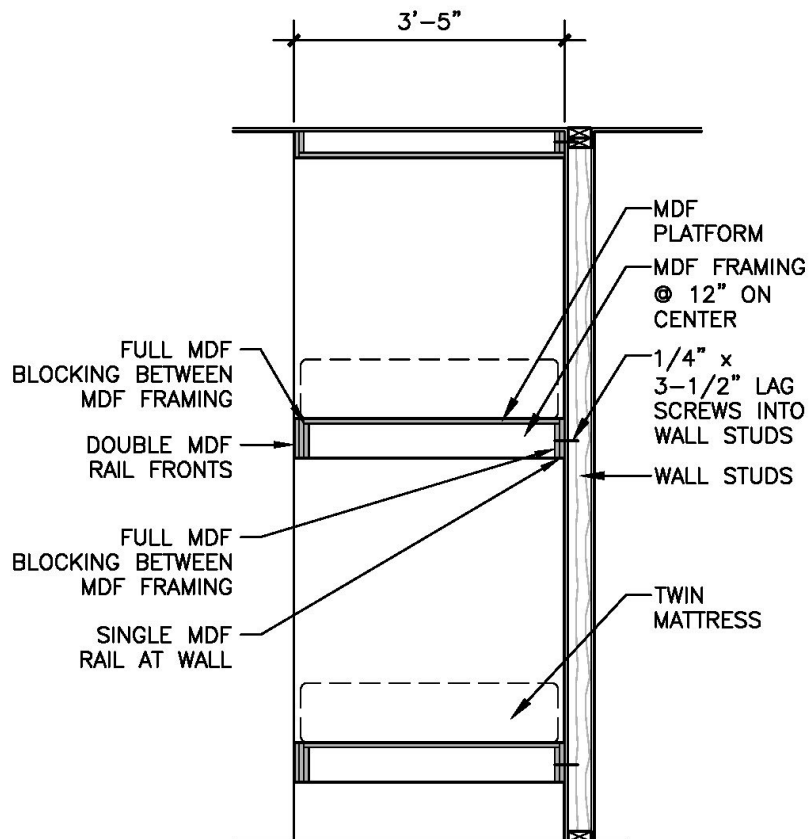
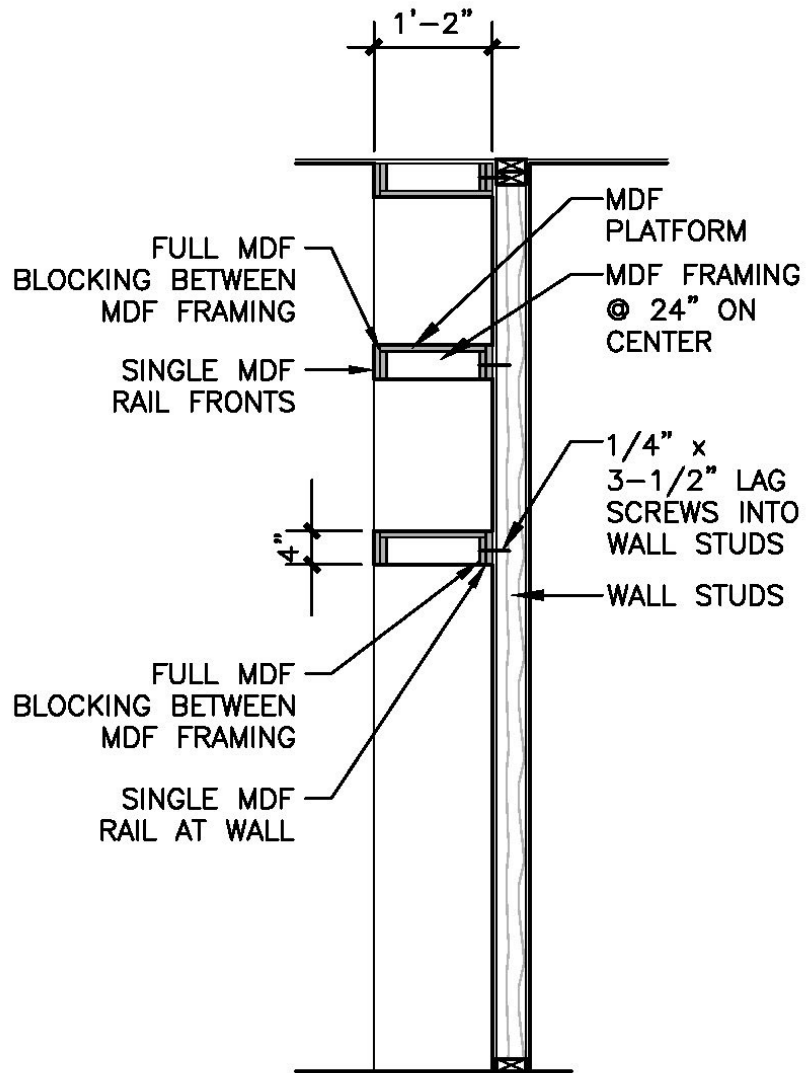

Figure C



**Stand Back and Enjoy Your Work - You're Finished!**

*You Did It!*

