

# Stoney Ridge

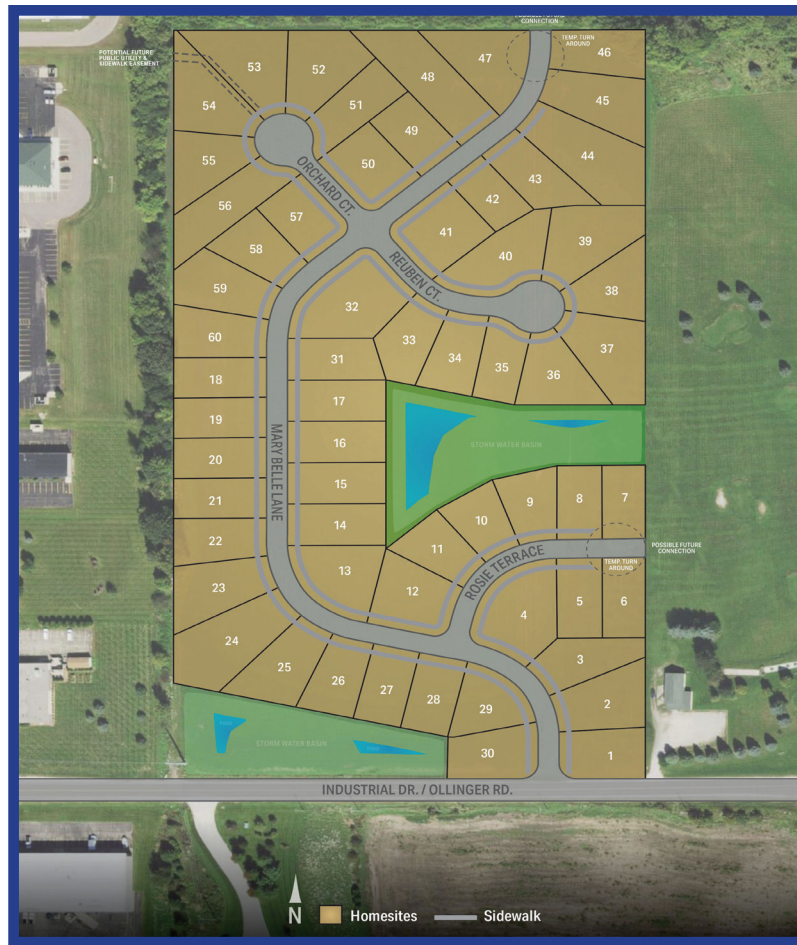

Harbor Homes is excited to build at Stoney Ridge in Beaver Dam. This highly affordable community will include 60 single-family homes from Harbor Homes. With 8 floor plans ranging from 1610 to 2288 square feet and multiple elevations, there are options for every lifestyle. **Harbor's All-in-One Home & Lot packages make living in Stoney Ridge even more affordable.**

Beaver Dam is a vibrant and welcoming community offering a 6,000-acre lake, great parks, a high-quality school district, and plentiful healthcare options. Situated in between Milwaukee, Madison, and Fond du Lac, Stoney Ridge is perfect for anyone looking for easy access to the cities.

- Min. Size One-Story: 1,200 Sq. Ft.
- Min. Size Two-Story: 1,600 Sq. Ft.
- Approximately 1/4 Acre Homesites
- Municipal Sewer and Water
- Beaver Dam Unified School District
- Protective Covenants

**Directions (from Milwaukee):** Take I-94 West to Exit 267 for WI-26 toward Watertown/Johnson Creek. Right onto WI-26 N/WI-26 Trunk N. Turn left onto County Road A. Then turn left onto Ollinger Road.



**HARBOR**  
HOMES



262-232-8520 | [HarborHomesWI.com](http://HarborHomesWI.com)



# Stoney Ridge

## PHASE 1 & 2

Lot	Sq. Ft.	Exposure	Price	Availability
38	11,666	4' Rear Look-Out	Ready Home	Ready Home
40	13,153	None	Ready Home	Ready Home



**HARBOR**  
HOMES

*Development features and amenities subject to change without notice or obligation. Information is deemed to be accurate as of 11/17/2025 and is subject to change without notice or obligation.*



262-232-8520 | [HarborHomesWI.com](http://HarborHomesWI.com)

