

THE ROW HOME SERIES

GEORGETOWN

Two Story | 2 or 3 Bedrooms | 1 or 2 Full Baths | Optional Half Bath

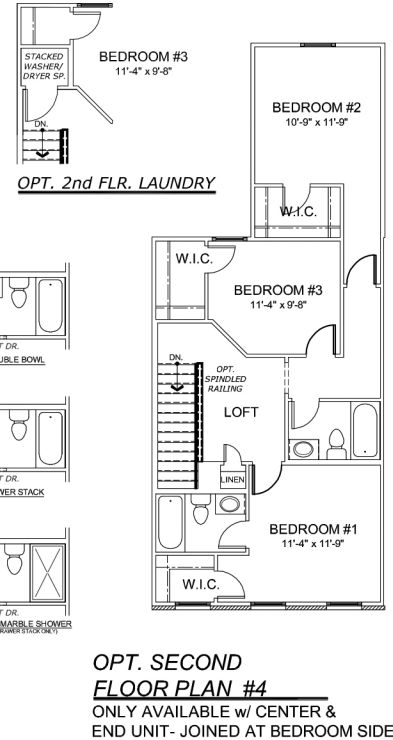

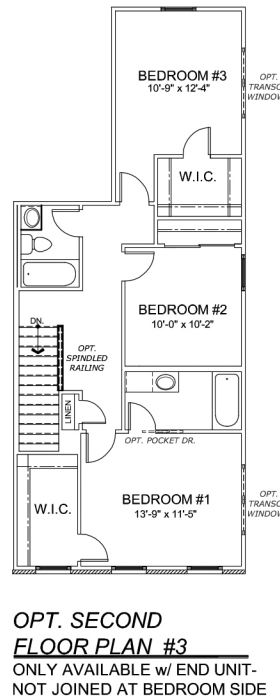
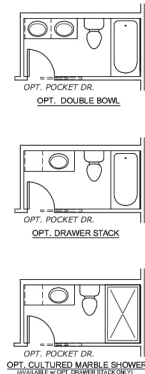
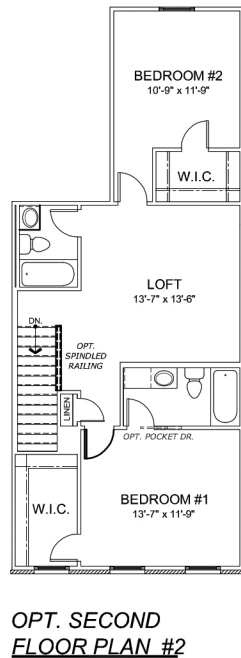
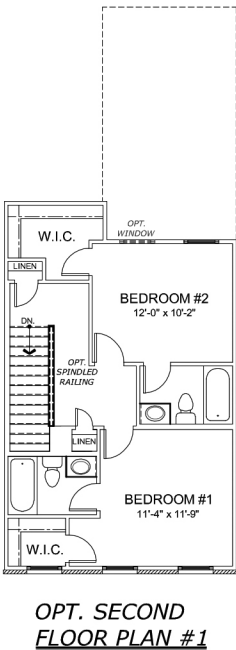
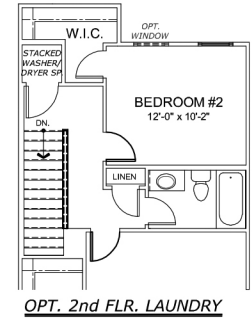
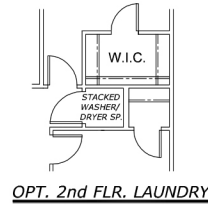
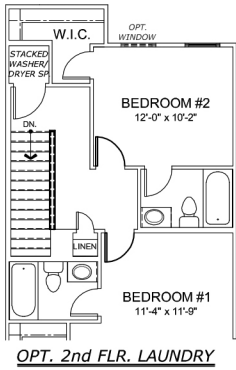
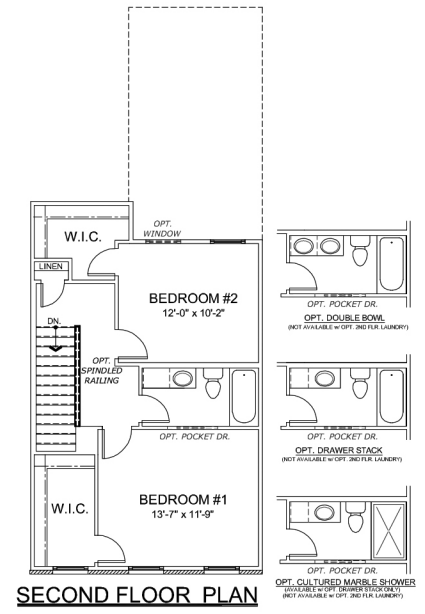
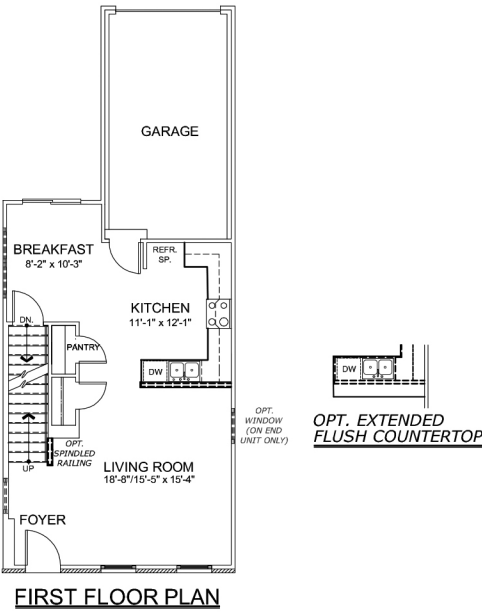
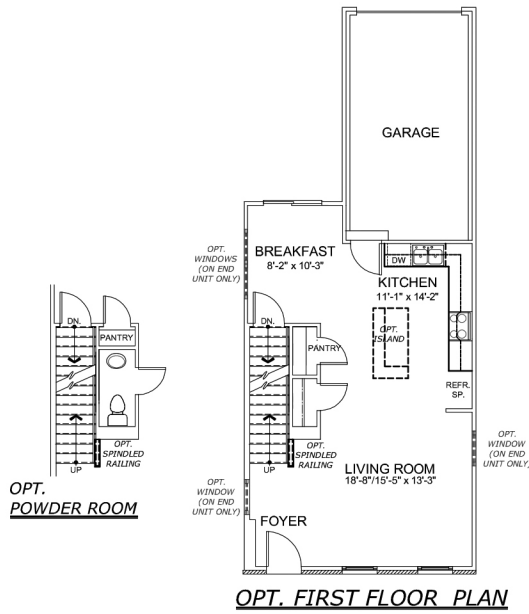

BUILT BY MCBRIDE HOMES, INC.

* Due to the evolutionary changes in our design improvements process, there may be variations between these plans and the "as built" floor plans, including layout and room sizes, square footage of the residence itself, and the location and size of doors, windows, openings, door swings, and other building components, including the location of posts and beams.

McBride Homes, in its sole and absolute discretion, reserves the right to substitute materials of comparable quality.

These plans are the sole and absolute property of McBride & Son Homes, Inc. The use or copying of these plans, without the express written consent of McBride Homes, is prohibited by law. McBride Homes may take immediate legal action against any unauthorized user of these plans.

