



—THE—  
**SHENANDOAH A**  
[www.capitalhomes.com](http://www.capitalhomes.com)



*Drawings are artistic renderings only. Actual home and floor plan may vary from rendering and community. HERS rating shown is the best certified rating obtained for this plan.*

AT CAPITAL HOMES, WE ARE COMMITTED TO BUILDING HIGH QUALITY,  
ENERGY-EFFICIENT HOMES THE RIGHT WAY, AT THE RIGHT PRICE.  
EACH OF OUR HOMES IS BUILT TO THE HIGHEST STANDARD AND IS  
THIRD-PARTY VERIFIED TO PRESERVE THE ENVIRONMENT, AND DELIVER  
ENERGY SAVINGS MONTH AFTER MONTH, YEAR AFTER YEAR.



# THE SHENANDOAH A

## FLOOR PLAN



SQUARE FOOTAGE	1461
BEDROOMS	3
BATHROOMS	2
HERS RATING	58

### MASTER BATH OPTION

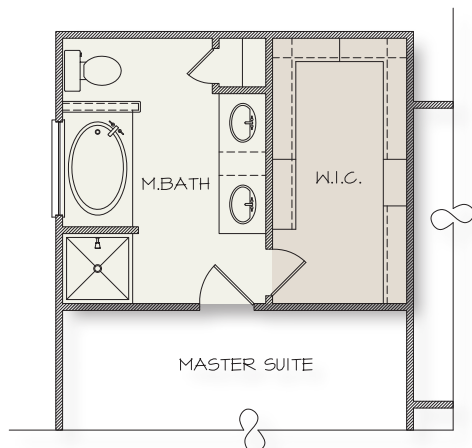

### POPULAR UPGRADES

- Additional patio space
- Four and six foot garage extensions
- Three car garage
- Hardwood flooring
- Premium appliances and fixtures
- Exterior design options
- Ask a Capital Homes representative about more options