



# CROSSINGS AT DEER CREEK

## ANKENY

### PLAT 11

www.jerryshomes.com

#### School District

Ankeny

#### Nearest Schools

K-5th - Southeast Elementary School  
6-7th - Parkview Middle School  
8-9th - Southview Middle School  
Ankeny High School

#### Nearest Grocery

Hy-Vee, Target,  
Walmart, Fareway

#### Nearest Gym

Planet Fitness  
Orangetheory Fitness  
Anytime Fitness

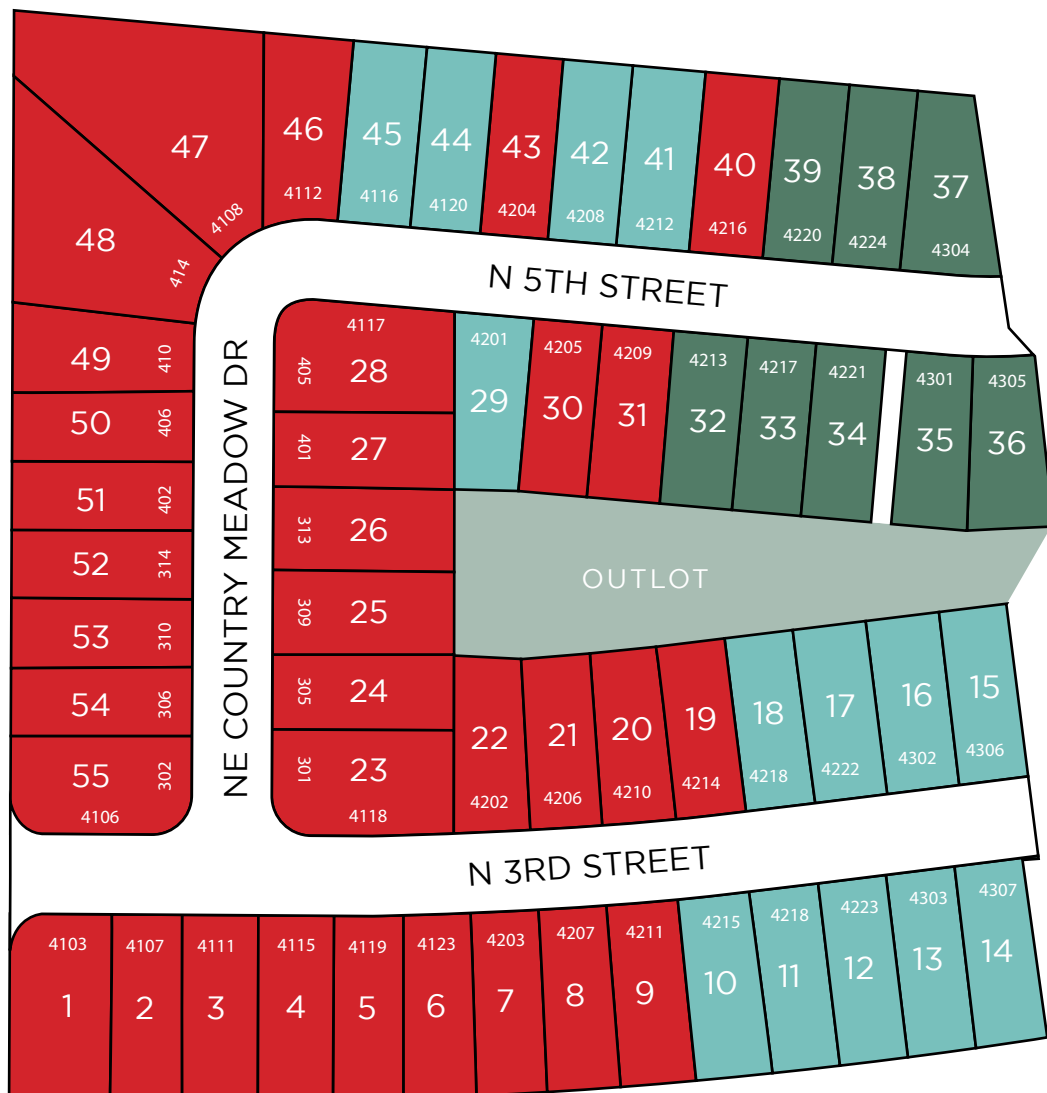

The Crossings at Deer Creek is a quiet neighborhood tucked away in a beautiful area on the east side of Ankeny. Close to grocery stores, shopping and I-35 for a quick commute to both downtown Des Moines or Ames. Within the development are plans for both an elementary school and a large city park. The Crossings at Deer Creek is an incredible option for families looking for their next home in a convenient location.

#### PLAT 11

Sold

Spec Home

Available For BTO

John Gentile | 515.771.6407 | John@johngentilerealtor.com

Listing information subject to change without notice.

#SINCE1957



## Our history builds your future.

Daylight lots are an additional \$4,000 above listing price. Walkout lots are an additional \$7,000 above listing price.



# CROSSINGS AT DEER CREEK

PLAT 11

ANKENY

www.jerryshomes.com

LOT #	ADDRESS	TYPE	LOT SQFT	PRICE	STYLE
10	4215 NE 3rd St	Daylight	6,907	\$344,990	DUKE EXP
11	4218 NE 3rd St	Daylight	6,500	\$TBD	ESTES
12	4223 NE 3rd St	Daylight	6,501	\$TBD	DUKE EXP
13	4303 NE 3rd St	Daylight	6,502	\$TBD	REED
14	4307 NE 3rd St	Daylight	6,503	\$TBD	WOODCREST
15	4306 NE 3rd St	Daylight	6,250	\$TBD	DUKE EXP
16	4302 NE 3rd St	Daylight	6,625	\$TBD	LOLO
17	4222 NE 3rd St	Daylight	6,625	\$TBD	CASCADE
18	4218 NE 3rd St	Daylight	6,250	\$TBD	CEDAR
29	4201 NE 5th St	Daylight	6,539	\$349,990	CASCADE
41	4212 NE 5th St	Daylight	6,890	\$332,990	DUKE
42	4208 NE 5th St	Daylight	6,500	\$349,990	REED
44	4120 NE 5th St	Daylight	6,500	\$344,990	DUKE EXP
45	4116 NE 5th St	Daylight	6,890	\$354,990	CASCADE

## School District

Ankeny

## Nearest Schools

K-5th - East Elementary School  
 6-7th - Parkview Middle School  
 8-9th - Southview Middle School  
 Ankeny High School

## Nearest Grocery

Hy-Vee, Target,  
 Walmart, Fareway

## Nearest Gym

Planet Fitness  
 Orangetheory Fitness  
 Anytime Fitness

LOT #	ADDRESS	TYPE	LOT SQFT	PRICE
32	4213 NE 5th St	Daylight	6,625	\$60,000
33	4217 NE 5th St	Daylight	6,250	\$60,000
34	4221 NE 5th St	Standard	6,250	\$60,000
35	4301 NE 5th St	Standard	6,497	\$60,000
36	4305 NE 5th St	Standard	6,793	\$60,000
37	4304 NE 5th St	Daylight	7,501	\$59,000
38	4224 NE 5th St	Daylight	6,500	\$59,000
39	4220 NE 5th St	Daylight	6,630	\$59,000

The Crossings at Deer Creek is a quiet neighborhood tucked away in a beautiful area on the east side of Ankeny. Close to grocery stores, shopping and I-35 for a quick commute to both downtown Des Moines or Ames. Within the development are plans for both an elementary school and a large city park. The Crossings at Deer Creek is an incredible option for families looking for their next home in a convenient location.

John Gentile | 515.771.6407 | John@johngentilerealtor.com

Listing information subject to change without notice.

#SINCE1957



REALTYONEGROUP  
IMPACT



## Our history builds your future.

Daylight lots are an additional \$4,000 above listing price. Walkout lots are an additional \$7,000 above listing price.