



Blooming Heights

Plat 3

Updated 12-16

Norwalk

www.buildwithsage.com

Available Lot - Developer Owned Lot ●

Available Pre-Designed Home ●

Available Lot- Sage Owned Lots ●

Sold ●

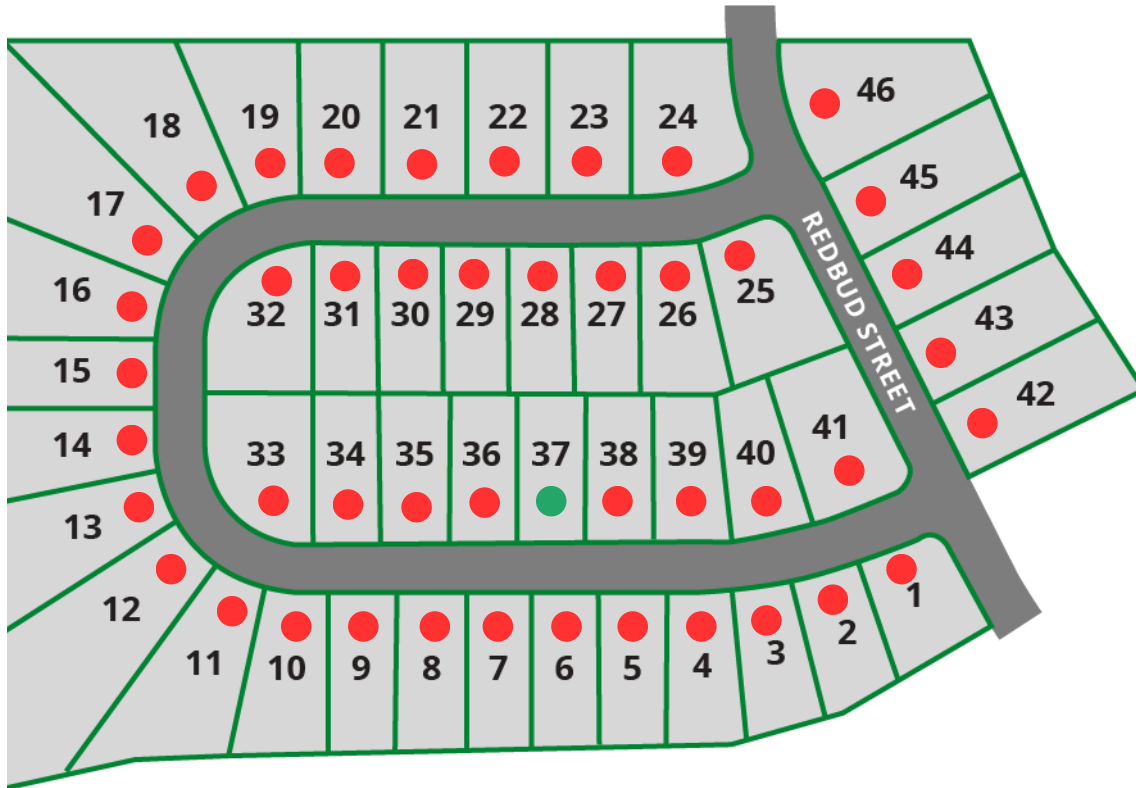

Directions:

From HWY 28/Sunset Dr., Head West on North Ave./G14, Follow G14 around curve, Take a right onto 50th Ave. and head North for 0.5 miles and turn left/west onto Redbud St. Follow Redbud St. west through the development until road curves back to the north where Plat 3 lots are located.

BLOOMING HEIGHTS PLAT 3- NORWALK

Lot	Address	Info	Elevation	Price
37	2234 Green Leaf Circle	.34 ac	Walkout	Open 12-28

Norwalk
School
District

5 year
partial tax
abatement

Close to all
the Des
Moines Metro

Local. Customizable. *Quality you can Trust.*

Kristy Leek | 515-639-0075 | kristy@homesdsm.com
301 NE Trilien Dr, Ankeny IA 50021 | 515-410-9410

