

Stoney Ridge

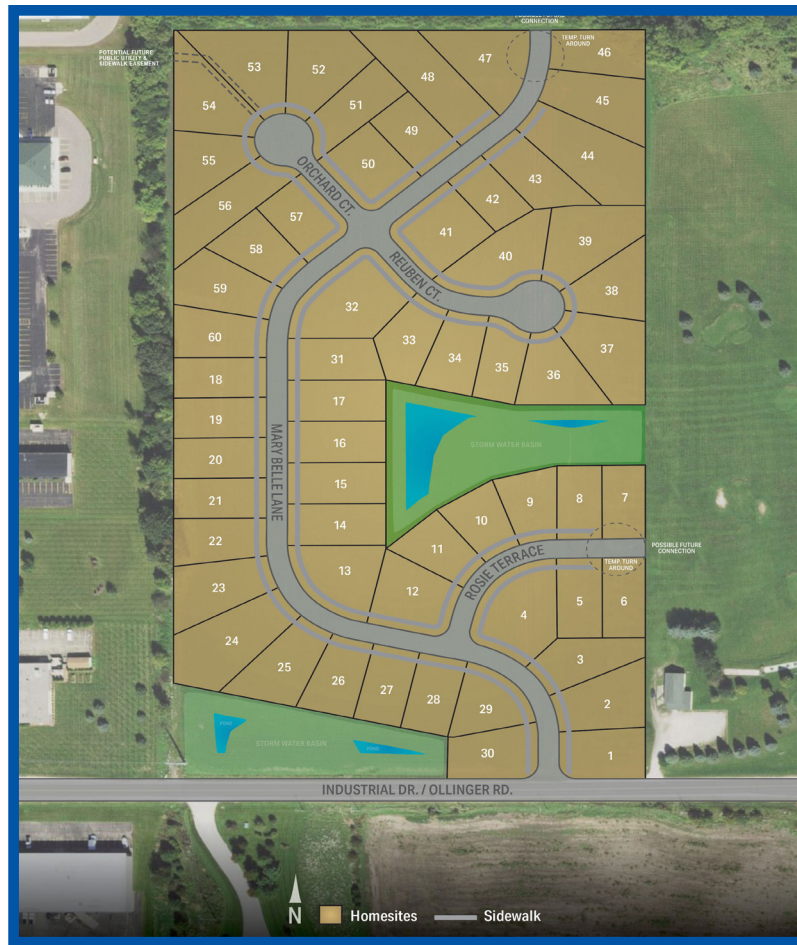

Harbor Homes is excited to build at Stoney Ridge in Beaver Dam. This highly affordable community will include 60 single-family homes from Harbor Homes. With 8 floor plans ranging from 1610 to 2288 square feet and multiple elevations, there are options for every lifestyle. **Harbor's All-in-One Home & Lot packages make living in Stoney Ridge even more affordable.**

Beaver Dam is a vibrant and welcoming community offering a 6,000-acre lake, great parks, a high-quality school district, and plentiful healthcare options. Situated in between Milwaukee, Madison, and Fond du Lac, Stoney Ridge is perfect for anyone looking for easy access to the cities.

- Min. Size One-Story: 1,200 Sq. Ft.
- Min. Size Two-Story: 1,600 Sq. Ft.
- Approximately 1/4 Acre Homesites
- Municipal Sewer and Water
- Beaver Dam Unified School District
- Protective Covenants

Directions (from Milwaukee): Take I-94 West to Exit 267 for WI-26 toward Watertown/Johnson Creek. Right onto WI-26 N/WI-26 Trunk N. Turn left onto County Road A. Then turn left onto Ollinger Road.



HARBOR
HOMES



262-232-8520 | HarborHomesWI.com



Stoney Ridge

PHASE 1 & 2

Lot	Sq. Ft.	Exposure	Price	Availability
35	8,493	4' Rear Look-Out	Ready Home	Ready Home
38	11,666	4' Rear Look-Out	Ready Home	Ready Home
40	13,153	None	Ready Home	Ready Home



HARBOR
HOMES

Development features and amenities subject to change without notice or obligation. Information is deemed to be accurate as of 07/22/2025 and is subject to change without notice or obligation.



262-232-8520 | [HarborHomesWI.com](https://www.HarborHomesWI.com)

