

# *the* SAWGRASS

## *Plan Options*

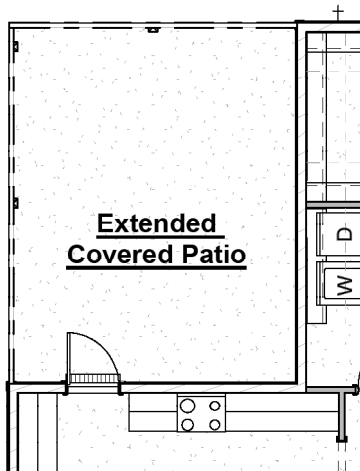

*Covered Patio Extension*

-Adds 83 sf of additional covered patio

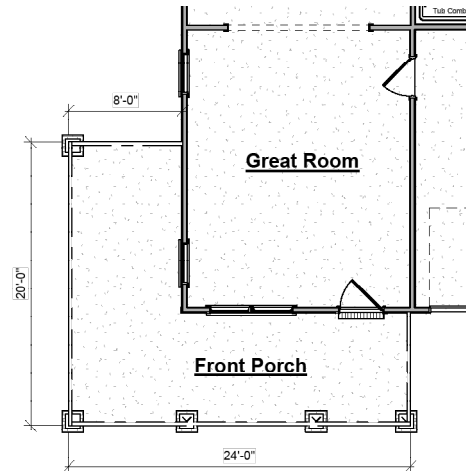

*Wrap Around Front Porch*

-Adds approximately 160 sf covered porch

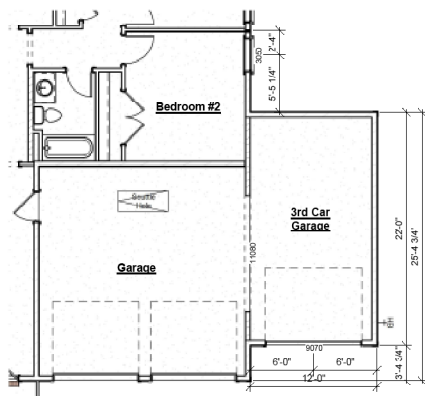

*3rd Car Garage*

-Adds approx. 253sf to garage  
-Adds additional garage door

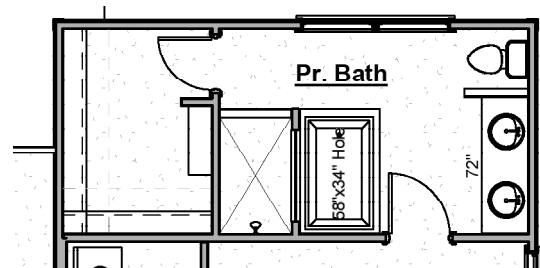

*Primary Bathroom Tub*

-Adds tub with selection at design  
-Reduces shower size to accommodate tub



Floor Plan Exclusively Designed for the SweetBay Community

# the SAWGRASS

## Plan Options

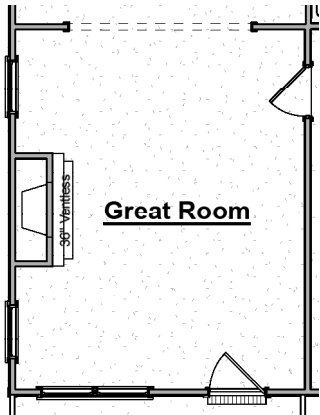

*Great Room Fireplace Bump-In*

- Adds fireplace to Great Room
- Includes trim-built mantel, firebox, 18" gas logs, tile surround & electrical outlet above fireplace

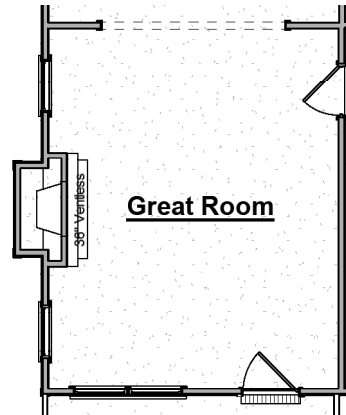

*Great Room Fireplace Bump-Out*

- Adds fireplace to Great Room
- Includes trim-built mantel, firebox, 18" gas logs, tile surround & electrical outlet above fireplace

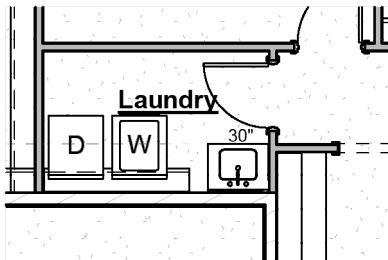

*Laundry Room Sink Option*

- Includes stainless sink with 30" base cabinet, cabinet hardware and countertop
- Cabinet base and countertop can be replaced with a freestanding utility sink

### *Other Options*

- Garage Utility Sink
- Guest Bath Syn-Iron Tub Shower with Tile Surround
- Pedestal Tubs

\*Certain structural options may not be available due to lot restrictions and/or selection of other options. Prices subject to change without notice.



HARRISDOYLE.COM



facebook.com/harrisdoylehomes



@harrisdoylehomes  
#harrisdoyle



HARRIS DOYLE  
HOMES

