



CROSSINGS AT DEER CREEK

PLAT 11

ANKENY

www.jerryshomes.com

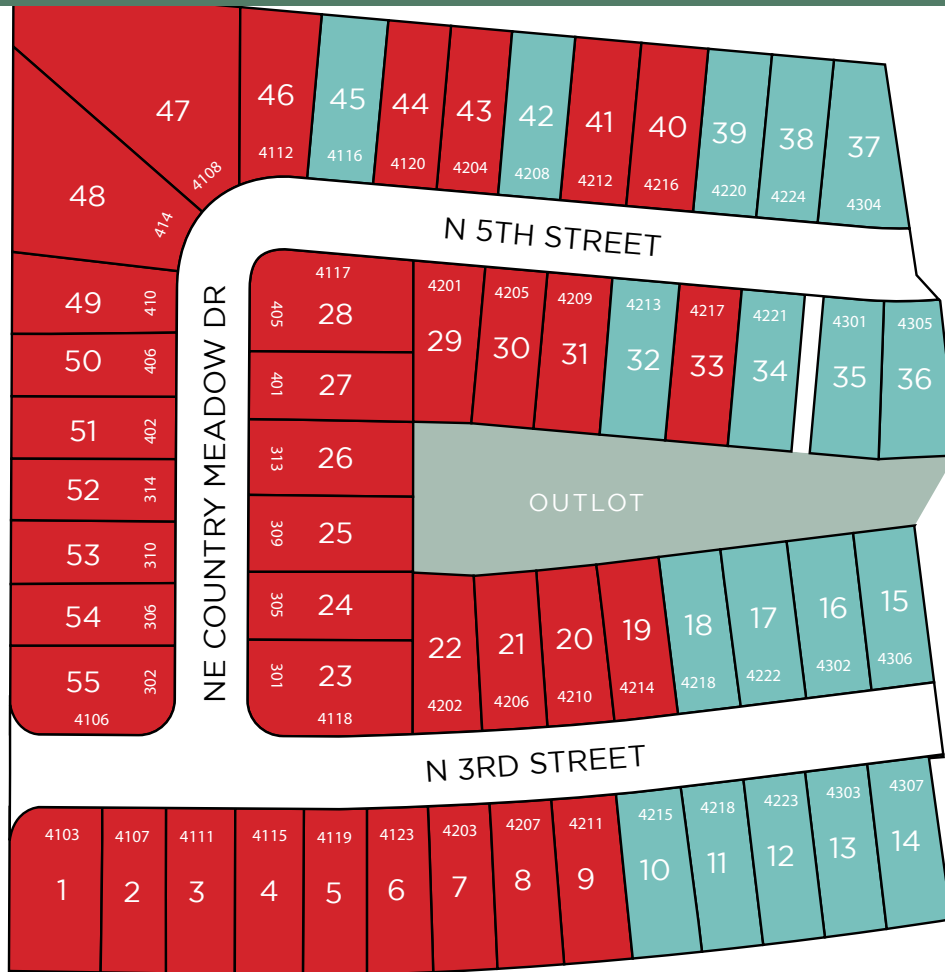

School District
Ankeny

Nearest Schools

K-5th - Southeast Elementary School
6-7th - Parkview Middle School
8-9th - Southview Middle School
Ankeny High School

Nearest Grocery

Hy-Vee, Target,
Walmart, Fareway

Nearest Gym

Planet Fitness
Orangetheory Fitness
Anytime Fitness

The Crossings at Deer Creek is a quiet neighborhood tucked away in a beautiful area on the east side of Ankeny. Close to grocery stores, shopping and I-35 for a quick commute to both downtown Des Moines or Ames. Within the development are plans for both an elementary school and a large city park. The Crossings at Deer Creek is an incredible option for families looking for their next home in a convenient location.

PLAT 11

Sold

Spec Home

Available For BTO

LOT #	ADDRESS	TYPE	LOT SQFT	PRICE	STYLE
10	4215 NE 3rd St	Daylight	6,907	\$339,990	DUKE EXP
11	4218 NE 3rd St	Daylight	6,500	\$TBD	ESTES
12	4223 NE 3rd St	Daylight	6,501	\$TBD	DUKE EXP
13	4303 NE 3rd St	Daylight	6,502	\$349,990	REED
14	4307 NE 3rd St	Daylight	6,503	\$384,990	WOODCREST
15	4306 NE 3rd St	Daylight	6,250	\$344,990	DUKE EXP
16	4302 NE 3rd St	Daylight	6,625	\$357,990	LOLO
17	4222 NE 3rd St	Daylight	6,625	\$TBD	CASCADE
18	4218 NE 3rd St	Daylight	6,250	\$TBD	CEDAR
32	4213 NE 5th St	Daylight	6,625	\$TBD	WOODCREST
34	4221 NE 5th St	Standard	6,250	\$TBD	CEDAR
35	4301 NE 5th St	Standard	6,497	\$TBD	REED
36	4305 NE 5th St	Standard	6,793	\$TBD	CASCADE
37	4304 NE 5th St	Daylight	7,501	\$TBD	COPELAND
38	4224 NE 5th St	Daylight	6,500	\$TBD	ESTES
39	4220 NE 5th St	Daylight	6,630	\$TBD	CALDWELL
42	4208 NE 5th St	Daylight	6,500	\$344,990	REED
45	4116 NE 5th St	Daylight	6,890	\$349,990	CASCADE

John Gentile | 515.771.6407 | John@johngentilerealtor.com

Listing information subject to change without notice.

#SINCE1957



Our history builds your future.

Daylight lots are an additional \$4,000 above listing price. Walkout lots are an additional \$7,000 above listing price.