

724 Countryside Avenue Arlington Parke | Trenton, Ohio



The Augusta - Elevation B



- Easy One-Level Living In This Ranch by Todd Homes
- Step Into The Open Foyer & Experience The Magnificent Open Living Triangle of The Dining Room, Great Room & Kitchen
- Beautiful & Durable LVT Flooring In All Shared Living Spaces
- Spacious, Upscale Kitchen With Granite Countertops, Dining/Food Prep/Serving Island with Overhead Pendant Lights, Soft Close Shaker Cabinetry, Stainless Steel Appliances & Walk-In Pantry
- Expansive Great Room Flows Into The Kitchen
- Private Primary Suite Has a Walk-In Closet & Adjoining Spa-Like Bath with a Walk-In Shower, Quartz Topped Vanity & Dual Sinks
- Madison Schools
- NO HOA
- Wooded Views

3
Bedrooms

2
Bathrooms

2
Garage

1600
Square Feet

724 Countryside Avenue Arlington Parke | Trenton, Ohio

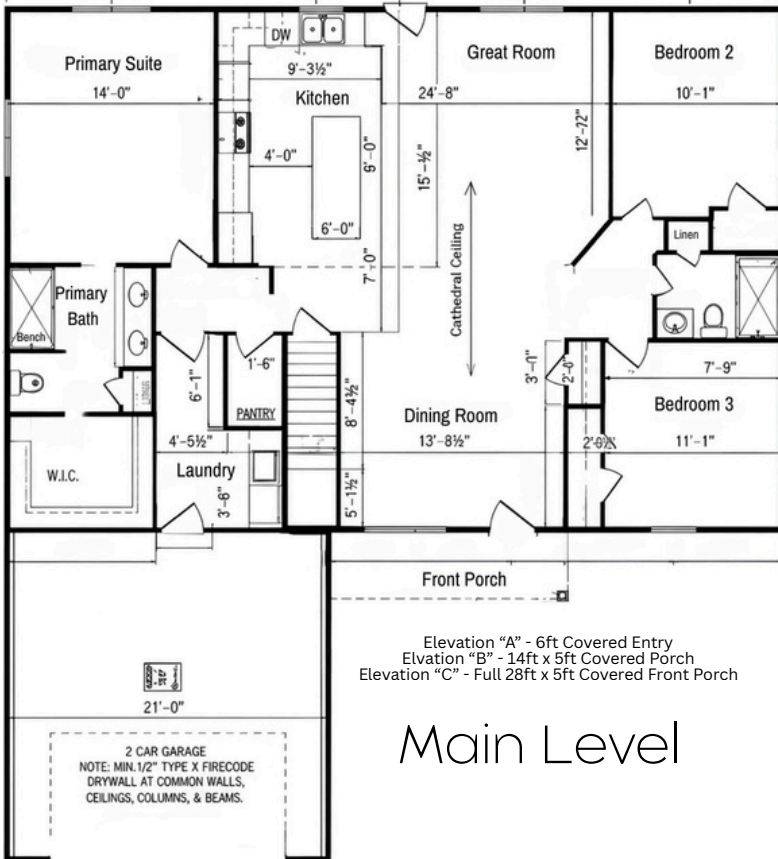

Main Level

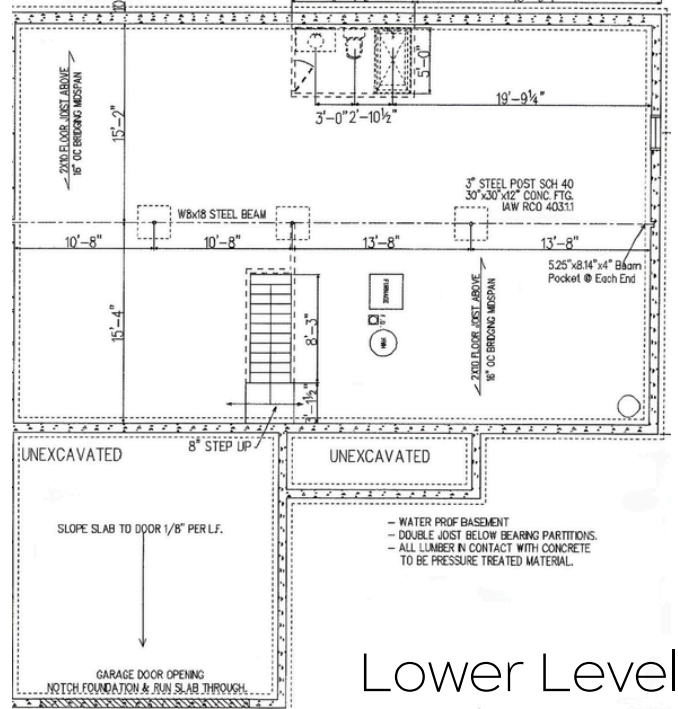

Lower Level



LEARN MORE

CONTACT US 513.823.3774 VISIT US: www.toddhomesllc.com

Copyright 2026 Todd Homes LLC. All rights reserved. Please note that floor plans, tours & photos are intended for illustrative purposes only and cannot be used for building or design purposes. Sizes and dimensions provided are approximate and not guaranteed. Floor plan and pictures shown may include upgrades & optional items; please ask your Sales Professional for details.