



# CROSSINGS AT DEER CREEK

## PLAT 12

### ANKENY

www.jerryshomes.com

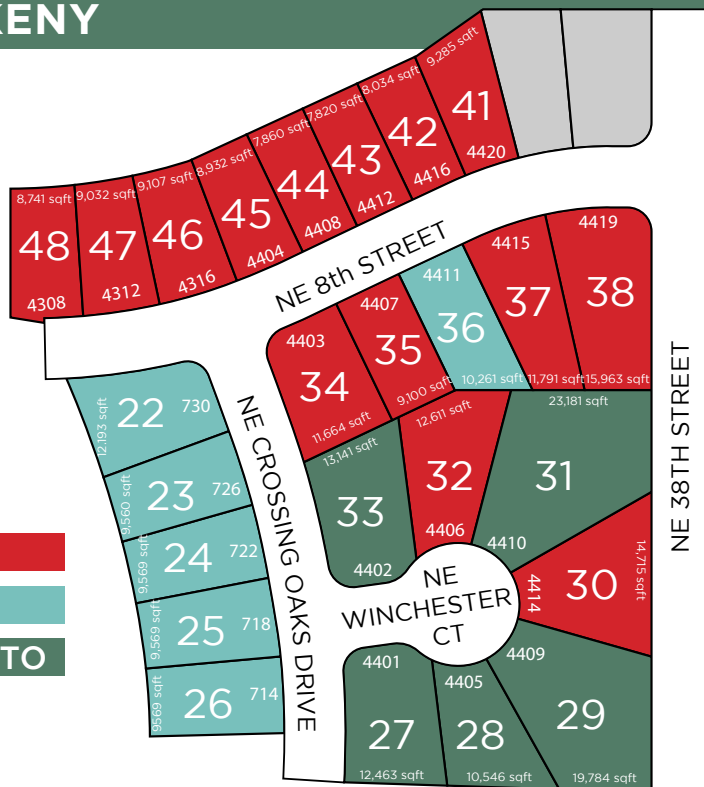

### PLAT 12

**Sold**

**Spec Home**

**Available For BTO**

**School District**  
Ankeny

**Nearest Schools**  
K-5th - Southeast Elementary School  
6-7th - Parkview Middle School  
8-9th - Southview Middle School  
Ankeny High School

**Nearest Grocery**  
Hy-Vee, Target,  
Walmart, Fareway

**Nearest Gym**  
Planet Fitness  
Orangetheory Fitness  
Anytime Fitness

LOT #	ADDRESS	TYPE	LOT SQFT	PRICE	
22	730 NE Crossing Oaks Dr	StandardL	12,193	\$TBD	Kingston
23	726 NE Crossing Oaks Dr	StandardL	9,560	\$TBD	Yuma Exp
24	722 NE Crossing Oaks Dr	StandardL	9,569	\$TBD	Richland
25	718 NE Crossing Oaks Dr	StandardL	9,569	\$TBD	Copeland II
26	714 NE Crossing Oaks Dr	DaylightL	9,569	\$TBD	Allendale
36	4411 NE 8th St	StandardL	10,261	\$374,990	Reed

LOT #	ADDRESS	TYPE	LOT SQFT	PRICE	
27	4401 NE Winchester Ct	StandardL	12,463	\$81,900	
28	4405 NE Winchester Ct	StandardL	10,546	\$81,900	
29	4409 NE Winchester Ct	StandardR	19,784	\$83,900	
31	4410 NE Winchester Ct	StandardR	23,181	\$89,900	
33	4402 NE Winchester Ct	StandardR	13,141	\$87,900	

John Gentile | 515.771.6407 | John@johngentilerealtor.com



Listing information subject to change without notice.

#SINCE1957



## Our history builds your future.

Daylight lots are an additional \$4,000 above listing price. Walkout lots are an additional \$7,000 above listing price.