

THE WILLOWBROOK G IV PLAN

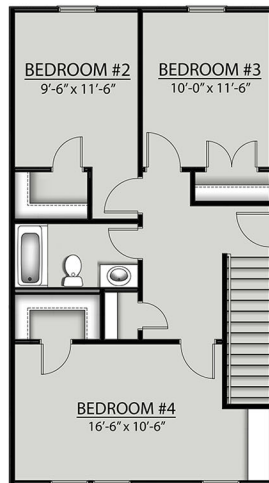

1ST FLOOR



2ND FLOOR

Living Area

1902 Square Feet

Total Area

2487 Square Feet

Features

- Open Floor Plan
- Two Story
- Four Bedrooms, 2.5 Bathrooms
- Covered Patio
- Two Car Garage
- Brick and Siding Exterior
- Separate Master Vanities
- Master GardenTub
- Separate Master Shower
- Walk-In Master Closet
- Computer Nook



Floor plans and elevations are subject to change without notice. Elevations and renderings are artistic conceptions and may not accurately depict home styles. Characteristics, including but not limited to windows, doors, plan configurations and orientations are subject to change per home site. Information contained in this flyer is subject to errors, omissions, changes, withdrawals and prior sales without notice.