

# Floor Plans

Studio  
375 sq. ft.

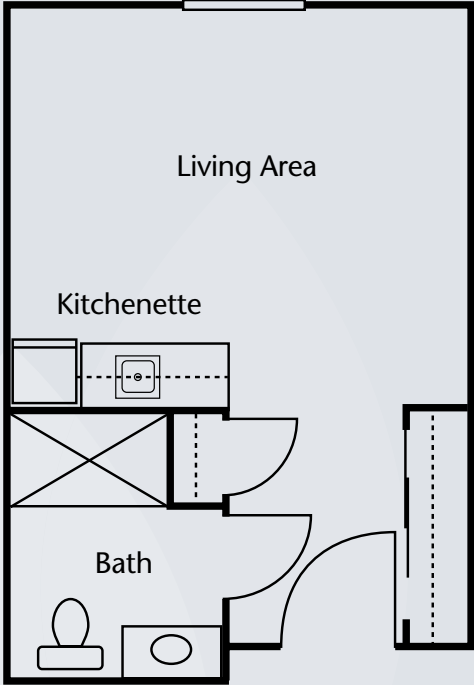

Expanded Studio  
425 sq. ft.

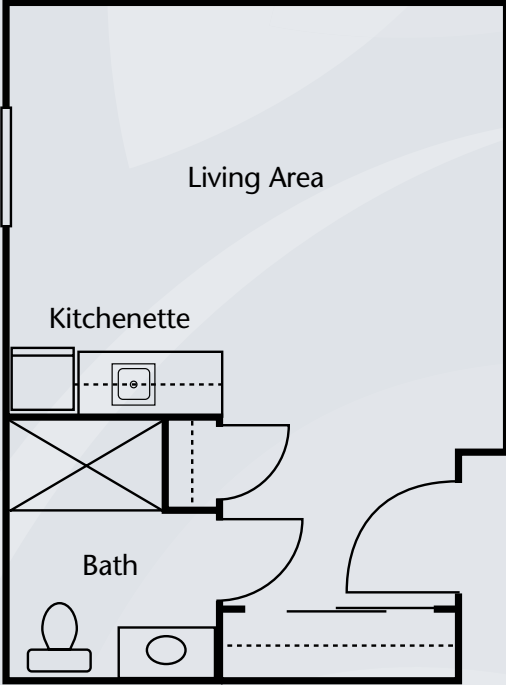

*Dimensions are approximate. Floor plans may vary.*



**Brookdale McMinnville City Center**  
721 NE 27th Street, McMinnville, Oregon 97128 | (503) 435-0100

[brookdale.com](http://brookdale.com)



# Floor Plans

One Bedroom  
475 sq. ft.

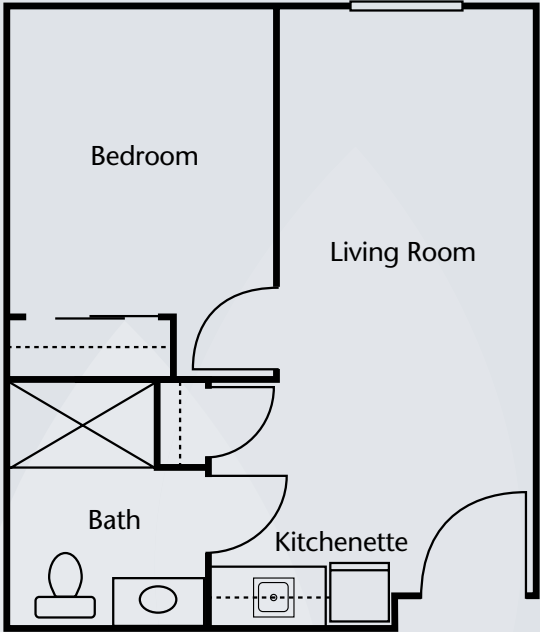

Two Bedroom  
783 sq. ft.

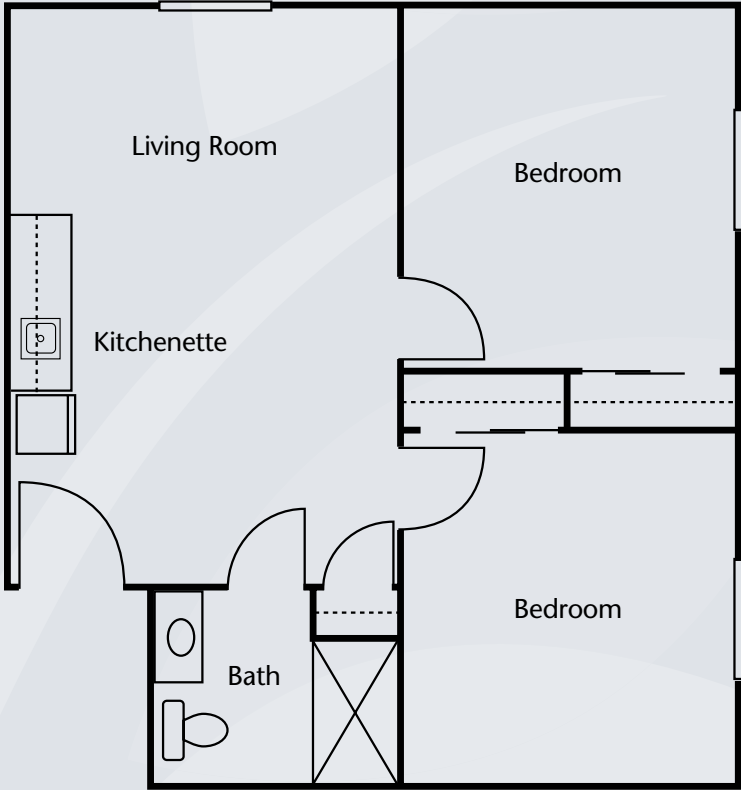

*Dimensions are approximate. Floor plans may vary.*



**Brookdale McMinnville City Center**  
721 NE 27th Street, McMinnville, Oregon 97128 | (503) 435-0100

[brookdale.com](http://brookdale.com)

