

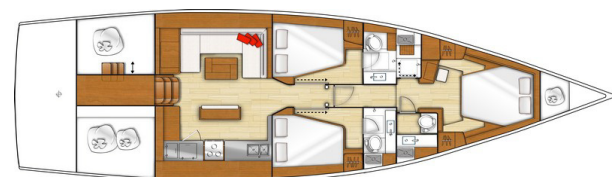

Hard top

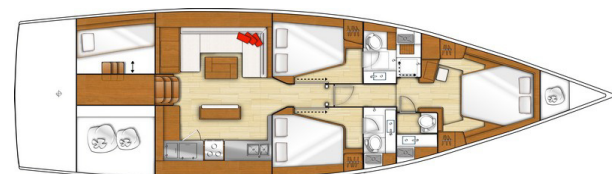

3 cabins - 3 heads



3 cabins - 3 heads - 1 Additional cabin (optional)

GENERAL SPECIFICATIONS

• Overall Length (L.O.A):		
- with bowsprit	17,78 m	58'4"
- without bowsprit	17,31 m	56'9"
• Hull length	16,80 m	55'1"
• L.W.L.	15,93 m	52'3"
• Hull Beam	4,97 m	16'4"
• Deep draft	2,40 m	7'10"
• Deep ballast weight	4 900 kg	10,803 lbs
• Shallow draft	1,85 m	6'1"
• Shallow ballast weight	5 500 kg	12,125 lbs
• Air draft	23,91 m	78'5"
• Light displacement (EC)	17 910 kg	39,474 lbs
• Fuel tank capacity (standard)	415 L	110 US Gal
• Fuel tank capacity (Option)	415 L	110 US Gal
• Fresh water capacity (standard)	640 L	169 US Gal
• Fresh water capacity (Option)	330 L	87 US Gal
• Engine power	80 HP	80 HP
	110 HP	110 HP

ARCHITECTS / DESIGNERS

- Naval Architect : Berret Racoupeau Yacht Design
- Interior design : Nauta Design

CE CERTIFICATION

- Category A - 10 people
- Category B - 11 people
- Category C - 16 people

STANDARD SAILS DIMENSIONS

• Mainsail	72 m ²	775 sq/ft
• Furling mainsail	69 m ²	743 sq/ft
• Genoa (105 %)	73 m ²	785 sq/ft
• Asymmetrical spinnaker	200 m ²	2,152 sq/ft
• Code 0	115 m ²	1,238 sq/ft
• Self-tacking jib	59 m ²	635 sq/ft
• Staysail	34 m ²	366 sq/ft
• I	20,97 m	68'10"
• J	7,31 m	24'
• P	20,2 m	66'3"
• E	6,35 m	20'10"



STANDARD EQUIPMENT

CONSTRUCTION

- Design made following European Directive requirements and according to CE certification
- Monolithic hull in polyester
- Monolithic structural hull liner laminated and bonded to the hull
- Deck in balsa and fiberglass sandwich covered in "diamond point" type non-slip surface
- Hull/deck joint screwed, bonded and covered with a single solid wood rubbing strake screwed in place
- Cast iron keel bonded and bolted using stainless steel bolts and counter plate
- Twin underhung rudders with stainless steel stock
- White hull - Grey metallic livery

DECK EQUIPMENT

RIGGING

- Standard mast SELDEN 9/10 anodized aluminium deck stepped, 2 aft-swept spreaders - MDS roller slides
- Anodized aluminum boom
- Discontinuous stainless steel standing rigging
- Backstay: Bridle
- Rigid boom vang
- Genoa furling system with drum on the deck
- 2 "STANDUP" blocks on mainsheet arch
- 2 Genoa tracks with piston adjusted traveller cars - 2 genoa sheet turning blocks
- Rigging run back to cockpit (except boom topping lift)
- Complete running rigging: Main halyard, Genoa halyard with clutch on mast and cleat, Boom topping lift with cleat on mast, Mainsheet, 2 Genoa sheets 2 Reefing lines, 1 Manual reef
- 12 Clutches, and other control lines
- 2 Line storage boxes

WINCHES

- 2 Self-tailing genoa sheet winches (H60.2 STC)
- 2 Self tailing coachroof winches (H46.2 STC to starboard, H50.2 STC to port)
- 2 Winch handles SpeedGrip
- 2 Winch handle holders

SAILS

- Dacron furling genoa, double thickness with UV protection strip
- Full batten dacron mainsail with Beneteau logo
- Lazy Jack System and Lazy bag in Natural color

MOORING - ANCHORING GEAR

- Self-draining chain locker
- Stainless steel bow fitting 2 rollers - Stainless steel bobstay
- 12 V - 1500 W vertical electric windlass - Remote control
- 8 Aluminum mooring cleats - Stainless steel chafing plate

SAIL LOCKER

- Access through deck hatch
- Stainless steel ladder
- Hatch giving access to chain locker

SAFETY ON DECK

- 1 Open stainless steel pulpit
- 2 Fixed stainless steel pushpits
- 1 Ring lifebuoy bracket
- 1 Outboard engine bracket
- 1 Ensign staff
- Double guard lines and stainless steel stanchions - Side boarding gate on either side
- 2 Stainless steel handrails on deck
- 2 Stainless steel handrails on fixed arch

COCKPIT

- Self-bailing cockpit, natural solid wood decked
- 1 Port cockpit locker (access to technical space or Additional cabin (optional))
- 1 Starboard cockpit locker (access to technical space)
- Gas locker beneath starboard cockpit seat
- Natural solid wood slatted cockpit benches
- 1 Liferaft locker in cockpit sole
- 2 Steering wheel consoles: Stainless steel steering wheels - 900 mm / 2'11" diameter - Leather covered - Stainless steel handrail - Navigation instrument pod (optional instruments) - Glass holder - 2 Steering compass on consoles
- 2 Deck access points to tiller system
- 1 Emergency tiller
- Engine throttle and control panel on starboard
- Wooden cockpit table with leaf to starboard which can be transformed into sun-bathing area
- 1 Fixed composite arch
- 2 Waterproof speakers on fixed arch
- Cockpit lighting integrated in fixed arch
- 1 PMMA companionway door
- 2 Fixed windows to the aft of the coachroof
- 1 Hot and cold cockpit shower
- 1 Shore power socket

AFT TRANSOM

- Fully opening transom, convertible into swim platform (3,20 m x 0,80 m / 12'6" x 2'7")
- Electrically operated
- Natural solid wood decking on swim platform
- 1 Folding bathing ladder (stainless steel), Solid wood steps, hand rail



INTERIOR

- Alpi walnut woodwork
- Rovere Aleve Parquet type laminated floorboards
- Padding upholstery in salon and cabins (Beige)
- Fabric upholstery in the salon
- Marine mattresses in the cabins

COMPANIONWAY

Headroom: 1,99 m / 6'6"

- Wooden companionway with cold-molded 3 steps
- 2 Leather covered stainless steel handrails

PORT SALON

Headroom: 1,98 m / 6'6"

- U-shaped salon bench
- Salon table in 1 piece, Varnished wood top with inlay, Aluminum legs.
- 1 Central unit with folding bench seat - Storage - Bar
- Cubby hole lockers and storage along the hull, Storage under bench seats
- 1 Hull porthole with curtain
- 1 Fixed coachroof side window with pleated blind
- 1 Fixed wrap-around window to cockpit + Blind
- 1 Deck hatch with mosquito blind

CHART TABLE

- Control console with flap - Glove boxes - Storage - Molded wood beading
- Navigator's seat with (15°) tilting cushion to compensate for heel
- Electrical panel
- Navigation instrument panel (without instruments)
- Radio with stereo CD / MP3 player - 2 Speakers
- Battery switch panel + Breaker panel

GALLEY - STARBOARD

Headroom: 1,97 m / 6'6"

- Lengthways galley counter
- Synthetic resin countertop in grey
- 1 Sink with 2 rectangular bowls, in Grey synthetic resin
- 1 Valve - mixing tap hot/cold water
- 1 Gas stove 2 burners, Stainless steel oven on gimbal
- 1 Fridge 200 L, ice-cube tray, front and top-opening
- 1 Cooler 100 L, top opening
- Cupboard units - Drawers - equipped lockers
- 1 Hull porthole with curtain
- 1 Fixed coachroof side window with pleated blind
- 1 Fixed wrap-around window to cockpit + Blinds
- 1 Deck hatch with mosquito blind

FORWARD CABIN

Headroom: 1,94 m / 6'4"

- Central double bed (2,03 m x 1,21 m - 1,70 m / 6'8" x 4' - 5'7") - Slatted bed base
- Wardrobe, Cupboard, Shoe cabinet
- Dressing table with grey top and removable seat
- Mirrors
- 2 Hull portholes with curtain
- 2 Opening deck hatches with mosquito blinds

FORWARD HEAD

Separate shower, to port

Headroom: 1,93 m / 6'4"

- Private access via glazed door
- Mirror - Cupboard
- Shower - mixing tap hot/cold water
- 1 Deck hatch with mosquito blind

Separate WC, to starboard

Headroom: 1,94 m / 6'4"

- Manual marine toilet + Holding tank (80 L / 21 US Gal)
- Sink - Synthetic resin countertop - mixing tap hot/cold water
- Mirror
- Toilet accessories
- Cupboard - Cubby hole locker
- 1 Deck hatch with mosquito blind

CABINS - PORT AND STARBOARD

Headroom: 1,97 m / 6'6"

2 Cabins each with:

- Sliding entrance door
- Double bed (2,00 m x 1,00 m - 1,56 m / 6'7" x 3'3" - 5'1") - Slatted bed base
- Hanging locker - Shelving unit - Drawers
- Mirror
- 1 Hull porthole with curtain
- 1 Opening deck hatch with mosquito blind

HEADS - PORT AND STARBOARD

Headroom: 1,94 m / 6'4"

2 Each head containing:

- Private entrance through cabin
- Separate molded shower, mixing tap hot/cold water
- Manual marine toilet + Holding tank (80 L / 21 US Gal)
- Sink - Synthetic resin countertop - mixing tap hot/cold water
- Mirror
- Toilet accessories
- Cupboard and cubby hole
- 1 Opening deck hatch with mosquito blind

ADDITIONAL CABIN (OPTIONAL) - In place of the sail locker (portside)

Headroom: 1,18 m / 3'10"

Access through the cockpit locker

- Solid wood sliding ladder
- Marine mattress
- 1 Opening porthole
- 1 Opening hatch

ENGINE

- Engine Yanmar Diesel:
 - 80 HP / 80 HP Common Rail, Sail Drive (standard)
 - 80 HP / 80 HP Common Rail, Dock & Go (Option)
 - 110 HP/110 HP Propeller shaft, Common Rail (Option)
- Engine control - Starting - Control panel in cockpit
- Engine compartment: Foam soundproofing - Ventilation: 1 air intake and 1 air outlet
- 1 Alternator 12 V / 125 Amp
- 1 Rotomolded diesel tank (415 L / 110 US Gal in the salon) - Electronic gauge - Low level alarm - 1 Deck filler
- Filters: Sea water - Diesel - Water separator
- Fixed three blade propeller
- Engine access via companionway and machinery space (opening with gas piston)

ELECTRICITY

- 12 V Circuit - 115 V Circuit
- 2 Service batteries (2x140 Amp) - 1 Engine battery (110 Amp)
- 1 40 Ah Battery charger - 1 115V Shore power supply - 1 Load balancer
- Electrical panel (12 V / 115 V) (Circuit breakers - Voltmeter - Water gauge - Fuel gauge - Battery warning - Fuel warning)
- 115V Sockets
- Interior lighting: Halogen ceiling lights, Reading lights
- Outside lighting: 1 Forward and aft navigation lights - 1 Steaming light - 1 Mooring light on masthead - 1 Deck light
- Wire runs for option cables

PLUMBING

- 3 Rotomolded freshwater tanks (3 x 200 L / 3 x 53 US Gal) - Salon / Side cabins - Separate fillers - Tank selection with "¼ turn" by-pass valves
- Waterpressure system - Expansion tank - Inline filter
- 40 L / 11 US Gal Electric calorifier (Operation off engine or on 115 V electrical system)
- 1 Rigid 80 L / 21 US Gal black water holding tank for each WC
- Electrical shower drain pumps
- 2 Electric bilge pumps - 1 Manual bilge pump
- 1 Electric pump for the ice box drain

GAS

- Gas bottle box in the cockpit (1 or 2 bottles, according to model)
- Regulator and solenoid

TRIM LEVEL

	ESSENTIAL	EXCLUSIVE
<ul style="list-style-type: none"> • Bowsprit with integrated anchor roller and bobstay • Cockpit galley under helmsman seats (Sink - Gas griddle) • 1 Port electric primary winch (H50.2 STECH) • Releasable forestay chainplate • Stainless steel beading for fenders in cockpit locker • 4 Opening portholes in galley and salon windows • Hifi: Fusion + Interior speakers & Waterproof exterior speakers • 12/115 V, 2 kVA inverter • Galley: Refrigeration system, 12 V, in 100 L top-opening icebox (for storage below 0°C) • 2 USB sockets at the chart table to recharge mobile devices • 2 Service batteries (2 x 140A, 12V) + Additional 40 ampères battery charger • AGM Batteries • Storage space(s) under the floor • LED interior lights • LED navigation lights 	<ul style="list-style-type: none"> ■ ■ ■ ■ ■ ■ ■ ■ ■ ■ ■ ■ ■ 	<ul style="list-style-type: none"> ■ ■ ■ ■ ■ ■ ■ ■ ■ ■ ■ ■ ■
<ul style="list-style-type: none"> • Pump for deck washing • Textile storage on 2 steering consoles • Upgrade - Bose speakers in salon • Galley: "Luxe" 3 burners hob, stainless steel oven and broiler • 3 Electric toilets • LED interior lights (Indirect) 		<ul style="list-style-type: none"> ■ ■ ■ ■ ■ ■

PACKS

ELECTRONIC B&G PACK

Pack A

- Helm consoles to port and starboard:
 - 1 Triton 2 B&G display (Log, Speedometer, Depth sounder, Windvane anemometer)
 - 1 Multifunction touchscreen B&G Zeus 9" (GPS, Chart plotter, Chart reader - Cartography Navionics Silver included)
- PC interface

Pack B

- Multifunction touchscreen B&G Zeus 12', Chart table

Autopilot Pack

- NAC3 Autopilot (with gyro compass), Control at steering station
- WR10 Wireless autopilot remote control

VERSION

	DOCK & GO
<ul style="list-style-type: none"> • Engine: YANMAR - Common Rail - Diesel • Swiveling Sail Drive base • Joystick • Vessel Management Unit (VMU) • Bow thruster • Auto pilot 	<ul style="list-style-type: none"> ■ ■ ■ ■ ■ ■

OTHERS

NAVIGATION ELECTRONICS: B&G

- 4G Radar
- AIS 500 (Transmitter / Receiver)
- Port cockpit: B&G H50 VHF, integrated AIS receiver function + H50 cockpit handset
- Chart table: Fixed B&G RS90 VHF, integrated AIS receiver function
- Forward Scan Sensor (Forward underwater vision)

RIGGING - SAIL

- Anodized furling mast with mylar Taffetas main and genoa
- In-boom furling
- Grey lacquered Park Avenue boom
- Asymmetrical spinnaker rigging + Code 0 rigging
- Self-tacking jib hardware
- Hydranet sail for classic mast (instead of standard)
- Hydranet self-tacking jib (replacing genoa)
- Hydranet self-tacking staysail with manual furling + Fixed forestay
- Laminated Mylar Taffetas (Code 0) with furling drum
- Asymmetrical spinnaker
- Releasable forestay chainplate
- Hydraulic backstay*
- Genoa sheet track leads adjustable from the cockpit
- Flag halyards

* Except on mast with in-mast furling

WINCHES

- Electric genoa sheet winches H60.2STCEH
- Starboard electric coachroof winch H46.2STCEH
- Rewind rope handling winch

HULL - DECK - COCKPIT

- Blue-grey hull - Pearl white livery
- Pearl Grey hull - Matte black hull decoration
- Metallic hull paint
- Solid wood slatted side decks
- Wood cockpit table with electrical up/down system (Starboard)
- Wood cockpit table (Port), plate and removable seat + Protective cover, Cadet Grey
- White or black steering wheels and console covers
- Rigid bimini with foldable Cadet Grey canvas
- Bimini Luxe, Cadet Grey
- Full cockpit enclosure Luxe, Cadet Grey
- Bimini Luxe + Sprayhood, Cadet Grey
- Covers pack Luxe (Table, steering wheel and console), Cadet Grey
- Natte Stone exterior upholstery (+ helmsman seatbacks and seats)
- High comfort outside upholstery, Gallet
- Bow thruster
- 3 folding blades propeller
- 2nd arch with davits and instrument base
- 2nd arch with davits, solar panels + wind turbines
- White or black composite steering wheels
- Moorings lines, anchoring gear, fenders
- Windlass control with chain counter in cockpit
- Shore freshwater supply
- Pump for deck washing
- Underwater lights
- Windex Windvane
- Powered companionway door + 2 Remote controls

INTERIOR EQUIPMENT

- Interior woodwork: Alpi mat light oak
- Upholstery: Leather, Ultra Leather, Fabric
- Ivory or Oasis moleskin fitted carpet
- Salon / cabin cushioning: Meteor or Taupe
- Ivory lacquered doors (Salon - Galley)
- Luxe folding salon table on electric leg with up/down control
- TV Pre-wiring + DVD and MP3 player in master cabin
- TV Pre-wiring + Fusion player (Bluetooth, USB, DVD, MP3) in the salon
- Double berth in salon
- All-electric galley
- 110 V Microwave oven
- 110 V Dishwasher - 6 people
- Exhaust fan
- Sea water/fresh water foot pump
- Freshwater filter
- 110V Ice maker
- Washer / dryer 110 V
- Safe
- Electrically-operated salon window blinds
- Removable blind entrance door
- Removable extra table
- Extra water tank (330 L / 87 US Gal)
- Extra fuel tank (415 L / 110 US Gal in the salon)
- 9 kVA 110 V/ 60 Hz Generator
- Water maker 60 L/h / 16 US Gal/hr 12/110V
- Chilled water air conditioning

OTHER LAYOUT VERSIONS AVAILABLE

ADDITIONAL CABIN

Port aft

- Access through the cockpit locker - Gas locker strut opening
- 1 Single berth
- 1 Opening porthole
- 1 Hinged plexiglass panel in the cockpit side