

the scottsdale iv

3-BEDROOMS
 3- BATHS
 FORMAL DININGROOM
 OPTIONAL REAR COVERED PORCH
 OPTIONAL STONE ON FRONT ELEVATION

25818 TRICKLING ROCK
 2445 sq. ft. living area



WHITESTONE
 HOMES®



front

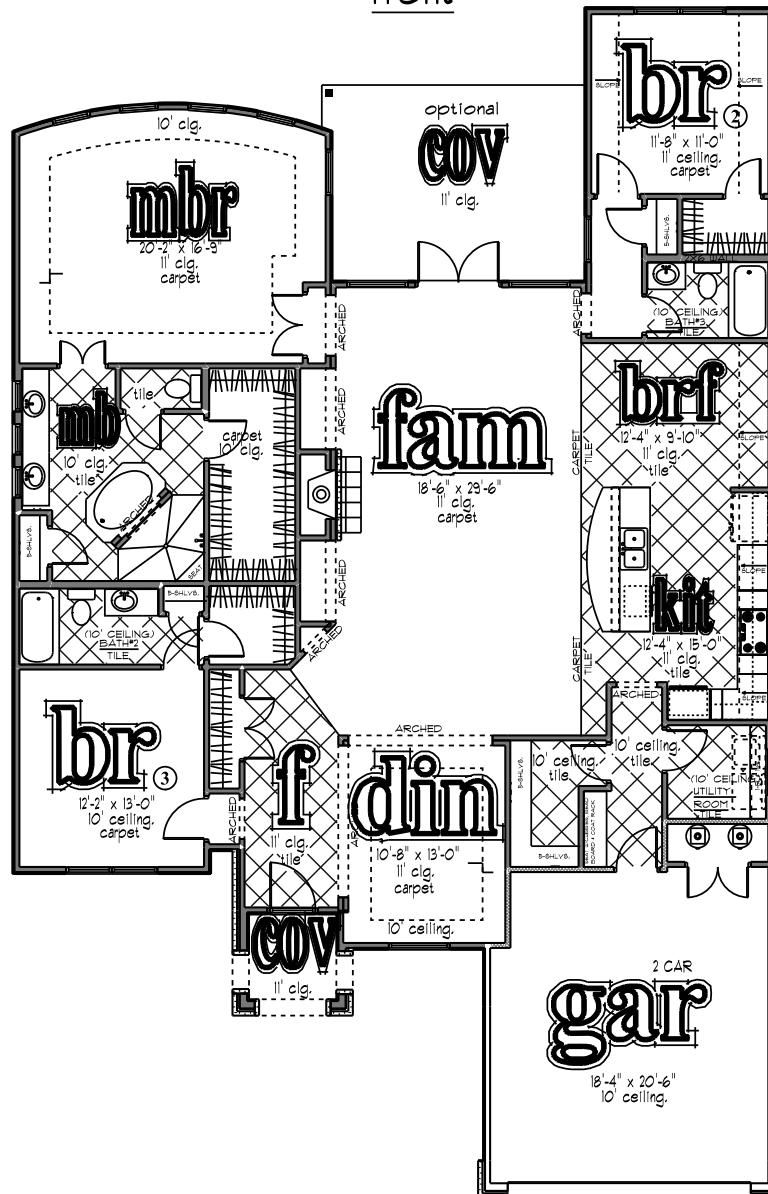

floorplan

Square footage and dimensions are approximate. Floorplans are the artist's concept and may vary. All features are subject to change without notice.