

## IC INTRACOM

Founded in 1987, IC Intracom is a leader in manufacturing and distributing high-quality, innovative networking and consumer-electronics components.

Through OEM relationships and strategic partnerships in the IT channels, products we produce are available from more than 70,000 companies in over 100 countries around the world. Through enhanced features, simplicity, quality and performance at reasonable prices, our products provide the right tools so your customers can focus on what's important to them — and so can you.

Our dedicated quality assurance team is responsible for thorough inspections to ensure products meet customer expectations, specifications and quality standards. Our aim is to be your primary source for product-sourcing needs.

[icintracom.com.tw](http://icintracom.com.tw)

[support.manhattanproducts.com/barcode/180443](http://support.manhattanproducts.com/barcode/180443)

<b>Asia &amp; Africa</b> IC Intracom Asia 4-F, No. 77, Sec. 1, Xintai 5th Rd. Xizhi Dist., New Taipei City 221, Taiwan	<b>North &amp; South America</b> IC Intracom Americas 550 Commerce Blvd. Oldsmar, FL 34677, USA	<b>Europe</b> IC Intracom Europe Löhbachstr. 7 D-58553 Halver, Germany
---------------------------------------------------------------------------------------------------------------------------------	----------------------------------------------------------------------------------------------------------	---------------------------------------------------------------------------------

All trademarks and trade names are the property of their respective owners. © IC Intracom. All rights reserved. Manhattan is a trademark of IC Intracom, registered in the U.S. and other countries.

# Slim Wireless Keyboard and Optical Mouse Set Instructions

Model 180443

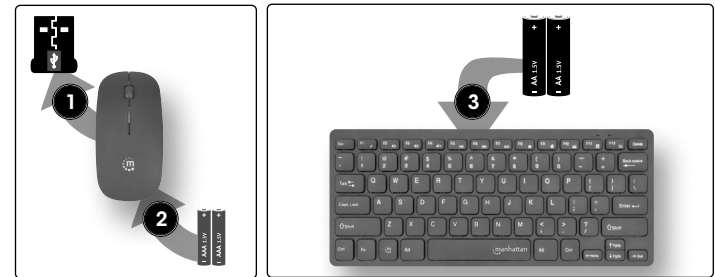

- 1 Take the nano wireless receiver from the mouse's underside and plug it into an available USB port on your computer.
- 2 Insert two AAA batteries into the mouse's battery compartment.
- 3 Insert two AA batteries into the keyboard's battery compartment.
- 4 The keyboard and mouse automatically connect to the

nano wireless receiver.

**NOTE:** If the computer doesn't detect these devices, check the USB connection and the USB compatibility of your operating system (Windows 98/ME/2000/XP/Vista/7/8.1/10 and Linux).

For specifications, go to [icintracom.com.tw](http://icintracom.com.tw).



[icintracom.com.tw](http://icintracom.com.tw)

**Important: Read before use. • Importante: Leer antes de usar.**

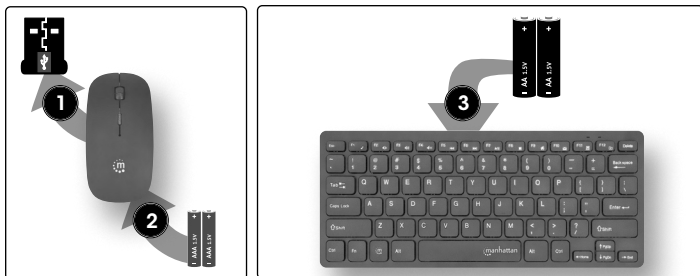

## DEUTSCH

- 1 Nehmen Sie den Nano-Funkempfänger von der Unterseite der Maus und stecken Sie ihn in einen freien USB-Anschluss Ihres Computers.
- 2 Legen Sie zwei AAA-Batterien in das Batteriefach der Maus ein
- 3 Legen Sie zwei AA-Batterien in das Batteriefach der Tastatur ein
- 4 Die Tastatur und Maus verbinden sich automatisch mit dem Nano-Funkempfänger.

**HINWEIS:** Falls Ihr Computer diese Geräte nicht erkennt, prüfen Sie die USB-Verbindung und die USB-Kompatibilität Ihres Betriebssystems (Windows 98/ME/2000/XP/Vista/7/8.1/10 und Linux).

Die Spezifikationen finden Sie auf [icintracom.com.tw](http://icintracom.com.tw).

## ESPAÑOL

- 1 Coge el receptor inalámbrico nano de la parte de abajo del ratón y conéctalo en un puerto USB libre del ordenador.
- 2 Inserta dos pilas AAA en el compartimento de las pilas del ratón.
- 3 Inserta dos pilas AA en el compartimento de las pilas del teclado.
- 4 El teclado y el ratón se conectarán automáticamente al receptor inalámbrico nano.

**NOTA:** Si la computadora no detecta estos dispositivos, compruebe la conexión USB y la compatibilidad USB de su sistema operativo (Windows 98/ME/2000/XP/Vista/7/8.1/10 y Linux).

Para especificaciones, visite [icintracom.com.tw](http://icintracom.com.tw).

## FRANÇAIS

- 1 Retirez le nano-récepteur sans fil situé sous la souris et branchez-le sur un port USB disponible sur votre ordinateur.
- 2 Insérez deux piles AAA dans le compartiment à piles de la souris.
- 3 Insérez deux piles AA dans le compartiment à pile du clavier.
- 4 Le clavier et la souris se connectent automatiquement au nano-récepteur sans fil.

**REMARQUE :** Si l'ordinateur n'identifie pas ces appareils, vérifiez la connexion USB et la compatibilité USB de votre système d'exploitation (Windows 98/ME/2000/XP/Vista/7/8.1/10 et Linux).

Vous trouvez les spécifications sur [icintracom.com.tw](http://icintracom.com.tw).

## POLSKI

- 1 Odłącz odbiornik bezprzewodowy nano od spodu myszy i podłącz go do portu USB w komputerze.
- 2 Włóż dwie baterie AAA do komory baterii myszy.
- 3 Włóż dwie baterie AA do komory baterii klawiatury.
- 4 Klawiatura i mysz automatycznie nawiążą połączenie z bezprzewodowym mini odbiornikiem.

**UWAGA:** Jeśli komputer nie wykrywa tych urządzeń, sprawdź połączenie USB i zgodność USB swojego systemu operacyjnego (Windows 98 / ME / 2000 / XP / Vista / 7 / 8.1 / 10 i Linux).

Pełną specyfikację produktu znajdziecie Państwo na stronie [icintracom.com.tw](http://icintracom.com.tw).

## ITALIANO

- 1 Prendi il nano ricevitore wireless dal lato inferiore del mouse e inseriscilo in una porta USB disponibile del tuo computer.
- 2 Inserisce due batterie AAA nell'alloggiamento batterie del mouse.
- 3 Inserisci due batterie AA nell'alloggiamento batterie della tastiera.
- 4 La tastiera e il mouse si conletteranno automaticamente al nano ricevitore wireless.

**NOTA:** Se il computer non rileva questi dispositivi, verificare la connessione USB e la compatibilità USB del sistema operativo utilizzato (Windows 98 / ME / 2000 / XP / Vista / 7 / 8.1 / 10 e Linux).

Per ulteriori specifiche, visita il sito [icintracom.com.tw](http://icintracom.com.tw).