

Visualizing Quality Control with Manhattan Mounts

Universal Flat-Panel TV Articulating Wall Mount

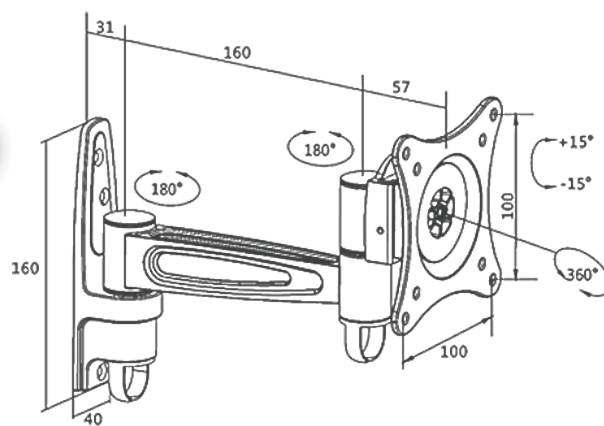

Model 460958



- Optimize views with $\pm 70^\circ$ tilt and $\pm 90^\circ$ swivel adjustments
- Easy installation ideal for home, office and commercial applications
- Built-in cable management system and integrated bubble level
- Meets VESA standards—supports TVs from 13" to 27" up to 15 kg (33 lbs.)



For more information, visit
manhattanproducts.com