







HYPERDRIVE HD1

Microphone Amplifier



User manual

<div style="text-align: center;">  <div style="background-color: black; color: white; padding: 2px 10px; font-weight: bold; margin: 0 auto; width: 100px;">CAUTION</div>  </div> <p style="text-align: center; font-size: small;"> RISK OF ELECTRIC SHOCK DO NOT OPEN RISQUE DE CHOC ELECTRIQUE NE PAS OUVRIR </p> <p style="text-align: center; font-size: x-small;"> CAUTION: TO REDUCE THE RISK OF ELECTRIC SHOCK DO NOT REMOVE COVER (OR BACK) NO USER-SERVICEABLE PARTS INSIDE REFER SERVICING TO QUALIFIED PERSONNEL </p> <p style="text-align: center; font-size: x-small;"> ATTENTION: POUR EVITER LES RISQUES DE CHOC ELECTRIQUE: NE PAS ENLEVER LE COUVERCLE. AUCUN ENTRETIEN DE PIECES INTERIEURES PAR L'USAGER. CONFIER L'ENTRETIEN AU PERSONNEL QUALIFIE. AVIS: POUR EVITER LES RISQUES D'INCENDIE OU D'ELECTROCUTION, N'EXPOSEZ PAS CET ARTICLE A LA PLUIE OU A L'HUMIDITE </p>	<div style="display: flex; flex-direction: column; align-items: center;">   </div> <p style="font-size: x-small;"> The lightning flash with arrowhead symbol within an equilateral triangle is intended to alert the user to the presence of uninsulated dangerous voltage within the product's enclosure, that may be of sufficient magnitude to electric shock to persons. Le symbol clair avec point de flèche à l'intérieur d'un triangle équilatéral est utilisé pour avertir l'utilisateur de la présence à l'intérieur du coffret de voltage dangereux non isolé d'ampleur suffisante. </p> <p style="font-size: x-small;"> exclamation point within an equilateral triangle is intended to alert the user of the presence of important operating and maintenance (servicing) instructions in the literature accompanying the appliance. Le point d'exclamation à l'intérieur d'un triangle équilatéral est employé pour avertir les utilisateurs de la présence d'instructions importantes pour le fonctionnement et l'entretien (service) dans le livret d'instruction accompagnant l'appareil. </p>
---	--

Important Safety Instructions

1. Read this manual thoroughly before using this unit.
2. Keep this manual for future reference.
3. Take notice of and comply with all warnings included in the user's manual or indicated on the appliance.
4. Follow all instructions included in this manual.
5. Do not expose this unit to rain or moisture. Avoid having water or other liquids spilled on this unit.
6. When cleaning the cabinet or other parts of this appliance, use only a dry or slightly damp soft cloth.
7. Do not block any ventilation openings or interfere with the proper ventilation of this unit. Install in accordance with the manufacturer's instructions.
8. Do not use or store near any heat sources such as radiators, heat registers, stoves, or other heat-producing appliances.
9. Do not interfere with the safety purpose of the polarized or grounding-type plug. A polarized plug has two blades with one wider than the other. A grounding-type plug has two blades and a third grounding prong. These are designated for your safety. If the provided plug does not fit into your outlet, consult an electrician.
10. Protect the power cord from being walked on or otherwise damaged by items placed on or against them. Particular attention should be given to the plugs, receptacles, and the point where the cord exits the appliance.
11. To avoid the risk of electrical shock, do not touch any exposed wiring while the unit is in operation.
12. Only use attachments/accessories specified by the manufacturer.
13. Unplug this unit and all connected electrical equipment during lightning storms or when left unused a long period of time.
14. Refer all servicing to qualified service personnel. Servicing is required when the appliance has been damaged in any way or fails to operate normally.

WARNING: To reduce the risk of fire or electric shock, do not expose this unit to rain or moisture

Contents

Introduction.....4

What's in the package?4

Register your ICON ProAudio product to your personal account5

Features6

Set Up.....7

Safety & Maintenance8

Power8

Specifications9

Services.....10

Introduction

Congratulations on your purchase of the ICON Pro Audio Hyper Drive; the perfect way to increase the gain of your dynamic or ribbon microphones without the colouration of a pre-amp. The gain is switchable between 23dB or 46dB.

Take a standard dynamic mic like the DynaMic (DM-1), add the hyper drive and benefit from Class A discrete gain, resulting in a sound on a par to a world class condenser microphone perfect for vocals and instruments. Recording acoustic or classical guitar, for example, becomes a breeze – no more cranking up the volume on your pre-amp and without the need for capacitors or resistors in the gain staging pathway. You will hear the sound of the microphone, not your pre-amp! The Hyper Drive HD1 will improve the quality and noise floor of your recordings and reduce the likelihood of buzz, interference and feedback in live performances.

What's in the package?

- Hyperdrive HD1 Microphone Amplifier x 1
- Quick Start Guide x 1
- Aluminum Case x 1

Register your ICON ProAudio product to your personal account

1. Check serial number of your device

Please go to [http:// iconproaudio.com/registration](http://iconproaudio.com/registration) or scan the QR code below.



Input your device's serial number and the other information on the screen. Click "Submit".

A message will pop up showing your device information such as model name and its serial number - Click "Register this device to my account" or if you see any other message, please contact our after-sales service team

2. Log in to your personal account page for existing user or sign up for new user

Existing user: Please log into your personal user page by inputting your user name and password.

New user: Please click "Sign Up" and fill in all the information.

3. Download all useful materials

All your registered devices under your account will show on the page. Each product will be listed along with all its available files such as drivers, firmware, user manual in different languages and bundled software etc. for download. Please make sure you have download the necessary files such as driver before you begin device installation.

Features



- Sleek black metal design
- Robust construction – perfect for live use
- Switchable power amplification - Gain: 1X 23dB or 2X 46dB
- Extremely low noise floor
- Two ways to connect: attachable via microphone or pre-amp
- Perfect for live, studio or broadcast uses
- Long cable runs more possible in live situations - less likelihood of interference, buzz and hum
- Less likelihood of feedback in live settings
- Prevents signal degradation

Note: the HD1 requires phantom power for operation and does not work with microphones that require phantom power, i.e. condenser microphones or some active ribbon microphones.

Set Up

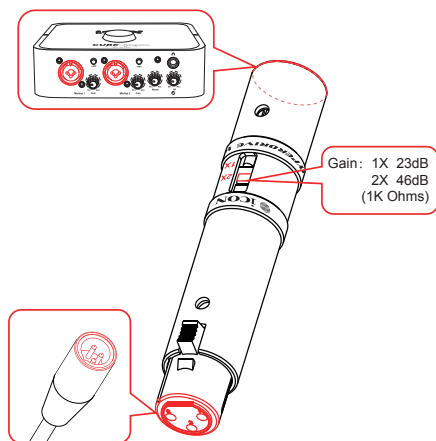

Fig. 1

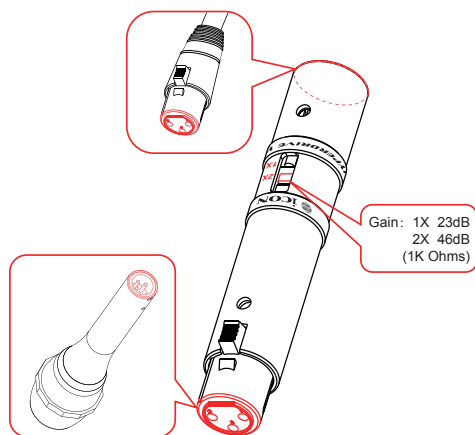

Fig. 2

The Hyperdrive HD1 is an active microphone amplifier intended to be inserted between a passive ribbon or dynamic microphone and a microphone preamplifier.

There are two ways to connect as depicted in the diagram above.

The first (Fig. 1) – Connect the Hyperdrive HD1 directly into your pre-amp interface, then connect your dynamic or ribbon mic to an XLR lead as normal. **On your sound device: ensure power is off and volume is zero. Then switch on and gradually increase volume to taste.**

The second (Fig. 2) - connect your Hyperdrive HD1 unit to your microphone. Then, plug your 3 pin XLR cable into the end of the Hyperdrive HD1, connecting the cable to your pre-amp interface. **On your sound device: ensure power is off and volume is zero. Then switch on and gradually increase volume to taste.**

As a precaution, please turn the volume relatively low (preferably zero) when switching between 1x 23dB and 2x 46dB in order to prevent pops or immediate increases in volume, especially in a live setting.

Safety & Maintenance

To enable safe operation, the HD1 requires a phantom power source providing 48Volts.

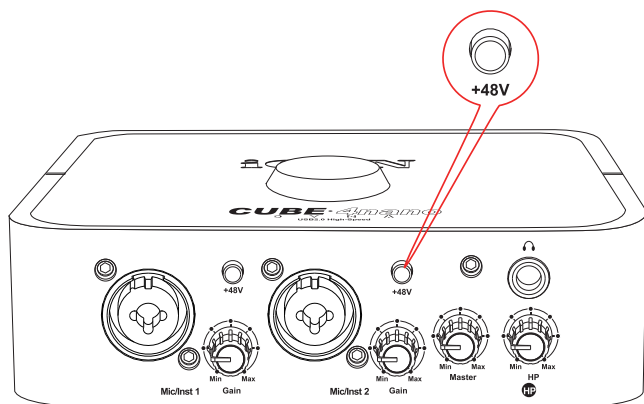

Power

In order to ensure consistent and safe operation, it is imperative that the HD1 is not connected to any power supply other than a phantom power source (input with phantom power or external IEC standard phantom power supply) with a floating connector. Please ensure a balanced cable with professional grade connectors is used.

Specifications

Frequency Range:	10Hz - 120K Hz
Output noiselevel:	1X 0.9uV 2X 1.8mV
Gain:	1X 23dB 2X 46dB (1K Ohms)
Powering:	48V phantom power
Recommended load impedance	>1K Ohms
Current consumption	3.0mA
Connectivity	3-pin male/female XLR connector

Services

If your Hyperdrive HD1 needs servicing, follow these instructions.

Check our online Help Center at <http://support.iconproaudio.com/hc/en-us>, for information, knowledge, and downloads such as:

1. FAQ
2. Download
3. Learn More
4. Forum

Very often you will find solutions on these pages. If you don't find a solution, create a support ticket at our online Help Center at the link below, and our technical support team will assist you as soon as we can.

Navigate to <http://support.iconproaudio.com/hc/en-us> and then sign in to submit a ticket.

As soon as you have submitted an inquiry ticket, our support team will assist you to resolve the problem with your ICON ProAudio device as soon as possible.

To send defective products for service:

1. Ensure the problem is not related to operation error or external system devices.
2. Keep this owner's manual. We don't need it to repair the unit.
3. Pack the unit in its original packaging including end card and box. This is very important. If you have lost the packaging, please make sure you have packed the unit properly. ICON is not responsible for any damage that occurs due to non-factory packing.
4. Ship to the ICON tech support center or the local return authorization. See our service centers and distributor service points at the link below:

If you are located in US

Send the product to:

North America

Mixware, LLC – U.S. Distributor
11070 Fleetwood Street – Unit F.

Sun Valley, CA 91352; USA

Tel.: (818) 578 4030

Contact: www.mixware.net/help

If you are located in Europe

Send the product to:

Sound Service

GmbH European

Headquarter Moriz-Seeler-Straße

3D-12489 Berlin

Telephone: +49 (0)30 707 130-0

Fax: +49 (0)30 707 130-189

E-Mail: info@sound-service.eu

If you are located in Hong Kong

Send the product to:

ASIA OFFICE:

Unit F, 15/F., Fu Cheung Centre,
No. 5-7 Wong Chuk Yueng
Street, Fotan,

Sha Tin, N.T., Hong Kong.

Tel: (852) 2398 2286

Fax: (852) 2789 3947

Email: info.asia@icon-global.com

5. For additional update information please visit our website at:

www.iconproaudio.com



天猫官方旗舰店



天猫店艾肯旗舰店

抖音号



抖音iCON艾肯

哔哩哔哩



B站iCONProAudio

中国地区用户

微信公众号



微信号iCON-PRO

官方售后QQ



4006311312.114.qq.com

Twitter



www.twitter.com/iconproaudio

Instagram



www.instagram.com/iconproaudio

Facebook



www.facebook.com/iconproaudio

Youtube



www.youtube.com/iconproaudio

Website



www.iconproaudio.com

Support



support.iconproaudio.com

Dashboard



iconproaudio.com/dashboard/

www.iconproaudio.com