



SX-3A





Bookshelf Speaker

Ingenuity Creation & Brilliant Sound Quality



Please Read all instructions carefully before use to ensure optimal performance of this product. Retain these instructions for future reference.



	<div style="background-color: black; color: white; padding: 5px; font-weight: bold; font-size: 1.2em;">CAUTION</div> <p style="font-size: 0.8em; margin: 0;">RISK OF ELECTRIC SHOCK DO NOT OPEN RISQUE DE CHOC ELECTRIQUE NE PAS OUVRIR</p> <p style="font-size: 0.8em; margin: 0;">CAUTION: TO REDUCE THE RISK OF ELECTRIC SHOCK DO NOT REMOVE COVER (OR BACK) NO USER-SERVICEABLE PARTS INSIDE REFER SERVICING TO QUALIFIED PERSONNEL</p> <p style="font-size: 0.8em; margin: 0;">ATTENTION: POUR EVITER LES RISQUES DE CHOC ELECTRIQUE: NE PAS ENLEVER LE COUVERCLE. AUCUN ENTRETIEN DE PIECES INTERIEURES PAR L'USAGER. CONFIER L'ENTRETIEN AU PERSONNEL QUALIFIE.</p> <p style="font-size: 0.8em; margin: 0;">AVIS: POUR EVITER LES RISQUES D'INCENDIE OU D'ELECTROCUTION, N'EXPOSEZ PAS CET ARTICLE A LA PLUIE OU A L'HUMIDITE</p>		 <p style="font-size: 0.8em; margin: 0;">The lightning flash with arrowhead symbol within an equilateral triangle is intended to alert the user to the presence of uninsulated dangerous voltage within the product's enclosure, that may be of sufficient magnitude to electric shock to persons. Le symbol clair avec point de flèche à l'intérieur d'un triangle équilatéral est utilisé pour avertir l'utilisateur de la présence à l'intérieur du coffret de voltage dangereux non isolé d'ampleur suffisante.</p>  <p style="font-size: 0.8em; margin: 0;">An exclamation point within an equilateral triangle is intended to alert the user of the presence of important operating and maintenance (servicing) instructions in the literature accompanying the appliance. Le point d'exclamation à l'intérieur d'un triangle équilatéral est employé pour avertir les utilisateurs de la présence d'instructions importantes pour le fonctionnement et l'entretien (service) dans le livret d'instruction accompagnant l'appareil.</p>
---	--	---	--

Important Safety Instructions

1. Read this manual thoroughly before using this unit.
2. Keep this manual for future reference.
3. Take notice of and comply with all warnings included in the user's manual or indicated on the appliance.
4. Follow all instructions included in this manual.
5. Do not expose this unit to rain or moisture. Avoid having water or other liquids spilled on this unit.
6. When cleaning the cabinet or other parts of this appliance, use only a dry or slightly damp soft cloth.
7. Do not block any ventilation openings or interfere with the proper ventilation of this unit. Install in accordance with the manufacturer's instructions.
8. Do not use or store near any heat sources such as radiators, heat registers, stoves, or other heat-producing appliances.
9. Do not interfere with the safety purpose of the polarized or grounding-type plug. A polarized plug has two blades with one wider than the other. A grounding-type plug has two blades and a third grounding prong. These are designated for your safety. If the provided plug does not fit into your outlet, consult an electrician.
10. Protect the power cord from being walked on or otherwise damaged by items placed on or against them. Particular attention should be given to the plugs, receptacles, and the point where the cord exits the appliance.
11. To avoid the risk of electrical shock, do not touch any exposed wiring while the unit is in operation.
12. Only use attachments/accessories specified by the manufacturer.
13. Unplug this unit and all connected electrical equipment during lightning storms or when left unused for a long period of time.
14. Refer all servicing to qualified service personnel. Servicing is required when the appliance has been damaged in any way or fails to operate normally.

WARNING: To reduce the risk of fire or electric shock, do not expose this unit to rain or moisture

Contents

Introduction.....	4
What's in the package?	4
Register your iCON Pro Audio product to your User Center	5
Features	6
Top Panel.....	8
Rear Panel Layout.....	9
Setting up your SX-3A Active Studio Monitor System	10
Connection Diagram.....	12
TRS in Input.....	13
Connecting with a TV	14
Setting "PCM" on your TV	14
Connecting a Bluetooth Device	15
Specifications	16
Services.....	17

Introduction

Firstly, congratulations on your purchase of the iCON Pro Audio SX-3A Active Studio Monitor System! In these pages, you'll find a detailed description of the features of the SX-3A Active Studio Monitor System, as well as instructions for its setup and use in addition to a full list of specifications.

Please register the product on our website at the link below

www.iconproaudio.com/registration

As with most electronic devices, we strongly recommend you retain the original packaging. In the unlikely event that the product is returned for servicing, the original packaging (or reasonable equivalent) is required. With proper care and adequate air circulation, your SX-3A Active Studio Monitor System will operate flawlessly for many years to come.

We trust that this product will provide years of excellent service and in the unlikely event that your product does not perform to the highest standard, every effort will be made to address the issue. Please make a note of your serial number.

What's in the package?

- Bookshelf Speaker
- Quick Start Guide
- Aviation cables
- Stereo RCA to 3.5mm Audio Cable
- Power cord



Register your iCON Pro Audio product to your User Center

1. Check the serial number of your device

Please go to [http:// iconproaudio.com/registration](http://iconproaudio.com/registration) or scan the QR code below.



Input your device's serial number and the other information on the screen. Click "Submit".

A message will pop up showing your device information such as model name and its serial number. Click "Register this device to my account". If you see any other message, please contact our after-sales service team.

2. Log in to your personal account page for existing users or sign up for new users

Existing user: Please log into your personal user page by inputting your user name and password.

New user: Please click "Sign Up" and fill in all the information.

3. Download all useful materials

All your registered devices under your account will show on the page. Each product will be listed along with all its available files such as drivers, firmware, user manuals in different languages and bundled software etc. for download.

Features



The iCON SX Active Studio Monitor System provides a smooth and accurate response which makes the system pleasant to listen to. Here are some of its main features:

- Compact high performance active studio monitor
- Active speaker system, featuring professional frequency division design
- The ideal solution for near-field monitoring in any recording or broadcasting facility
- Designed for use in stereo as well as multichannel setups
- Tuned by top acoustic engineers to fulfill any requirements in real recording studio environments
- Build-in Bi-Amp power module for low and high frequency drivers
Power output: L/R: 30W*2 + 10*2W

Mid/Woofer

- iCON Custom designed 4" woofer
- Nomex[®] reinforced paper cone for crisp, clean and very open reproduction
- Low loss SBR surround with low creep and long time reliability
- Progressive spider to achieve soft clipping and low distortion even under extreme load
- Heavy dual magnet ferrite magnet system with extended height for superb bass reproduction
- Aluminum short circuiting ring and copper cap in magnet system that practically eliminates motor distortion
- Very rigid die-cast aluminum chassis with very open geometry for optimized air-flow to eliminate compression

Tweeter

- High-end 1" dome tweeter

- Soft fabric dome and surround with wide-dispersion optimized geometry
- Big surround to reduce distortion
- Low loss ferrofluid-free magnet system for open and detailed sound
- Heavy ferrite under-hung dual magnet system for high sensitivity and low distortion
- Extended and air-flow optimized back cavity to ensure low compression and low resonance frequency
- The sturdy die-cast panel is equipped with a geometric structure with a wide distribution optimization design

Cabinet

- Robust and very rigid design
- Diffraction optimized smooth front baffle design
- Extended front baffle dimensions to eliminate any vibration or sound radiation from the enclosure
- Premium absorbing material for long-life high-performance bass reproduction
- High, Mid and Low range contour control

Top Panel

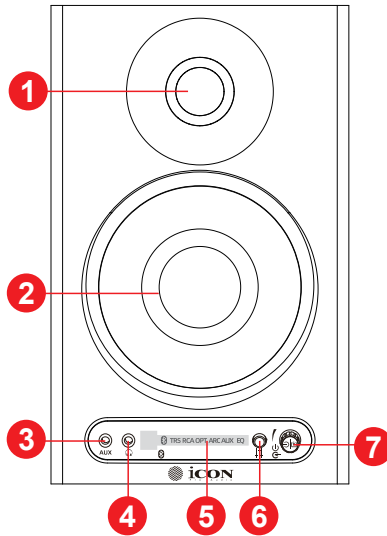

1. 1 inch soft fabric dome tweeter

Delivers smooth high-frequency response through a soft fabric dome and a ferrofluid- free magnet system, producing an open and detailed sound.

2. Low frequency driver - woofer

Custom designed 4" Nomex[®] reinforced paper cone woofer for crisp, clean and very open reproduction.

3. AUX Input Port

4. Headphone Jack

5. LED Indicators and Button Functions

BT - Bluetooth

TRS -

RCA -

OPT -

ARC -

AUX -

6. Sound Effects (EQ)

Press the "  " button to select sound modes: Music / Specialty

7. Power Supply And Select The Sourceinput mode

Press the button "  " to select input sources: Bluetooth / TRS / RCA / OPT / ARC / AUX

Rear Panel Layout

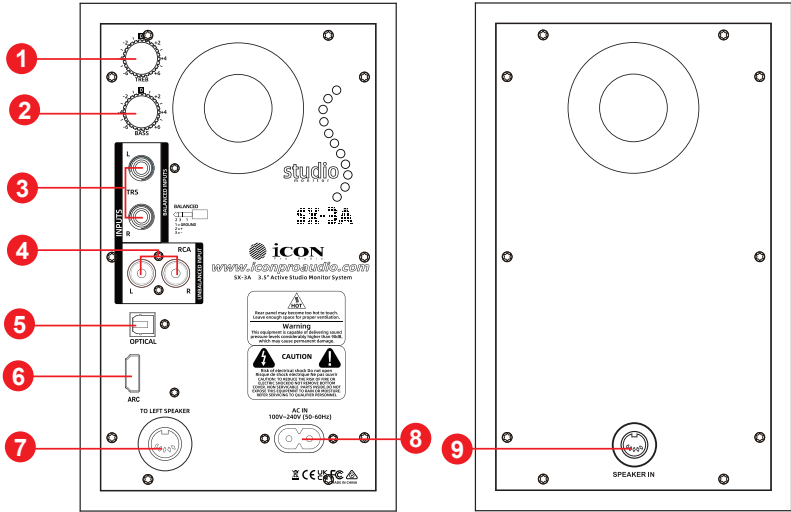

1. HIGH control
2. LOW control
3. Balanced input ports
4. RCA input port
5. Optical input port
6. ARC input port
7. Left speaker audio put
8. AC Power outlets
9. Left Speaker Audio In

Setting up your SX-3A Active Studio Monitor System

Background on the SX-3A Active Studio Monitor system

The SX-3A is a near-field recording studio monitoring device. It is designed with custom components, featuring a 4-inch high-temperature-resistant nylon paper cone woofer and a 1-inch soft fabric dome tweeter. It also employs a non-magnetic fluid lossless magnetic system. The frequency divider of this monitoring device was meticulously designed by professional engineers and uses high-quality components to ensure linear frequency and phase response. The device's casing is made of medium-density fiberboard. Its design includes tuned ventilation ports to provide extended low-frequency response and adopts a low turbulence design. The low-frequency driver can move freely with minimal impact on the overall impedance. The switching power supply supplies power to the woofer and tweeter. You will also notice that the rear panel has a variety of signal input interfaces, including digital (fiber optic, ARC), analog (TRS, RCA), as well as the AUX interface on the front panel and Bluetooth. The combined buttons on the rear panel with the power switch can convert different functions for input to meet different application scenarios and signal transmission with different impedances, and is equipped with EQ adjustment to customize the overall sound frequency response. These control functions enable mixing engineers to adjust the high, mid, and low frequency responses of the monitoring device. The traditional high-fidelity audio sound is smoothed and then processed through two levels of strong high, mid, and low frequency responses. The SX-3A design aims to provide smooth and accurate monitoring effects while also offering adjustable response curves to enable easy simulation of the sound effects of other popular near-field monitoring devices.

Positioning the SX-3A monitor

monitorNear field monitoring has become the choice of many engineers in large and small studios because it minimizes the effect of room acoustics. By positioning the reference monitors in the near field (close to the listener), you can greatly reduce the effects of room acoustics.

The most important considerations when evaluating the effects of room acoustics are the reflective surfaces around the monitoring area. These can include flat tabletops, glass mirrors, framed pictures, large open walls and even the surface of your mixing console. All reflecting sound will eventually reach the listening position, but since it is slightly delayed from the direct source, the result is random cancellation of some frequencies, or comb filtering. If possible, remove any or all reflective surfaces. You may also want to attach some acoustic foam to walls that are close to the monitors.

When positioning the monitors, aim to create what is commonly known as the 'mixing triangle'. In this ideal configuration, the space between the left and right monitor is equal to the distance from the listener to each monitor, forming an equilateral triangle (as shown in Figure 1).

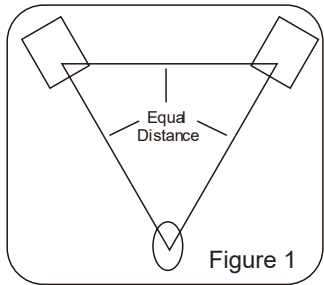

Figure 1

Speaker Orientation

The SX-3A Active Studio Monitor system can be used in either the vertical or horizontal position. When using the monitors in the horizontal position, be certain to place the left and right side tweeters on the outermost sides. (As shown in Figure 2). This will improve the stereo imaging and bass response by increasing the coupling of the low-end drivers.

Reflection

When selecting the height for your monitor system, take care to minimize reflections from the surface of the mixing console (as shown in Figure 3). These reflections arrive at the listening position with a slight delay from the original sound, resulting in strange cancellations and an overall unpredictable response. Visualize straight lines representing the beams of sound radiating from the monitors and choose a height that reduces the occurrence of reflections that will end up in the prime listening spot (As shown in Figure 4). In most cases, the ideal position is slightly behind and above the mixing console's meter bridge.

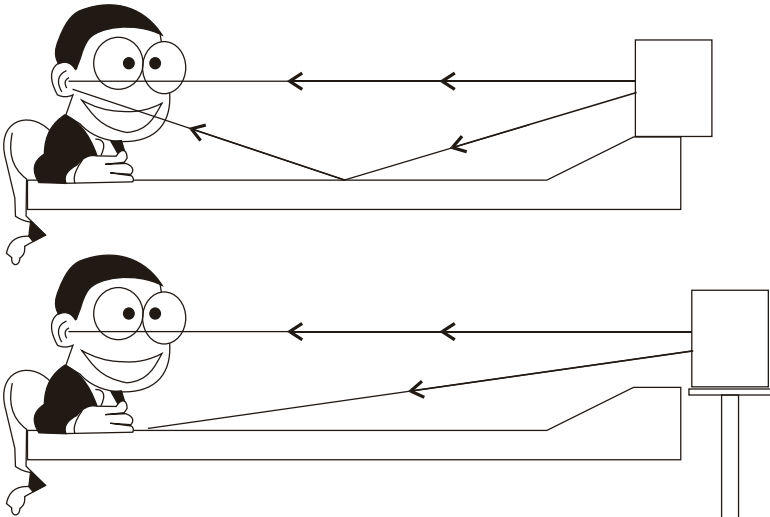

Connection Diagram

SX-3A Quick Connections

Note: Before plugging in and turning on, remember the "last on, first off" rule of power amplifiers (and powered monitors). When powering up your system, be sure that all the wires are connected. Turn your mixer and any other outboard gear on, and then finally turn on your SX-3A monitors. When powering down, turn your SX-3A monitor system off first and then your mixer and outboard gear.

Connect the SX-3A speaker system through the input interface on the panel. Just follow the steps shown in the following chart to quickly connect using the control room output of the standard recording console or the line output of the audio interface

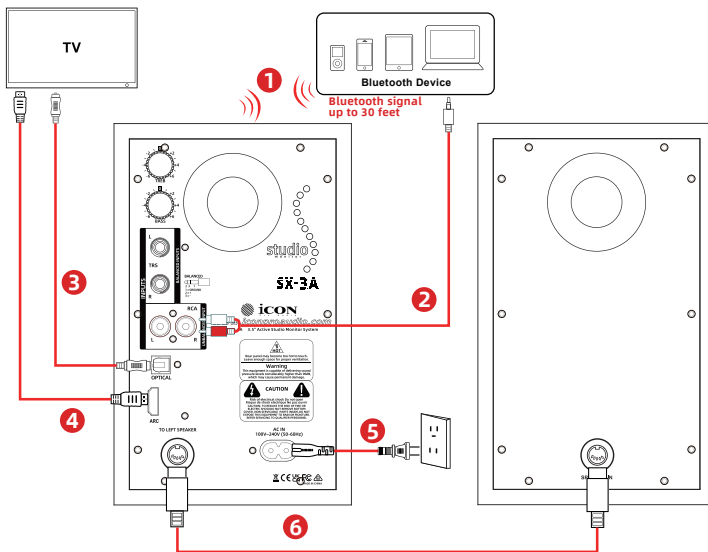

1. Bluetooth
2. RCA to 3.5mm audio cable
3. Digital Optical cable
4. High speed ARC cable
5. Power Adapter
6. Speaker connecting cable

TRS in Input

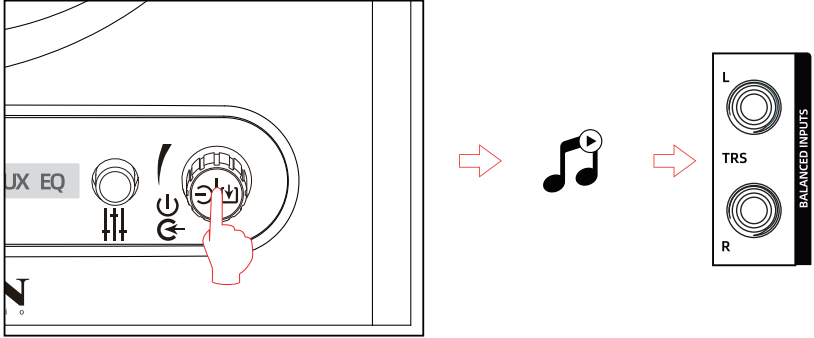

1. Turn on the speaker and briefly press the volume knob key Switch to TRS mode and the TRS mode indicator lights up
2. Use a balanced audio cable to connect to the source.
3. Play from your device and adjust the volume accordingly.

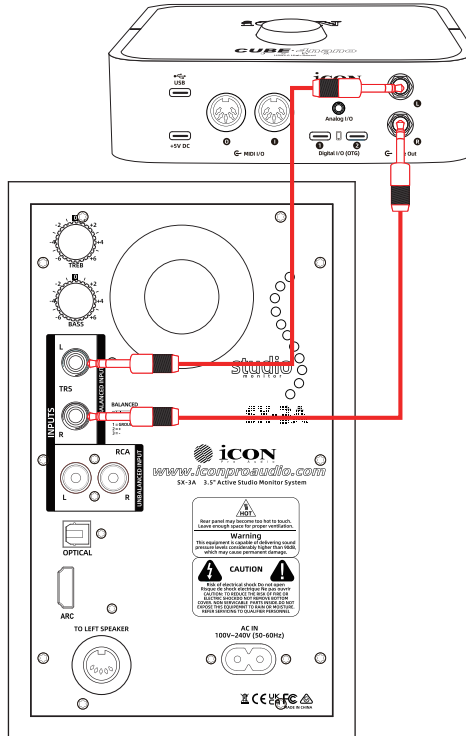

Connecting with a TV

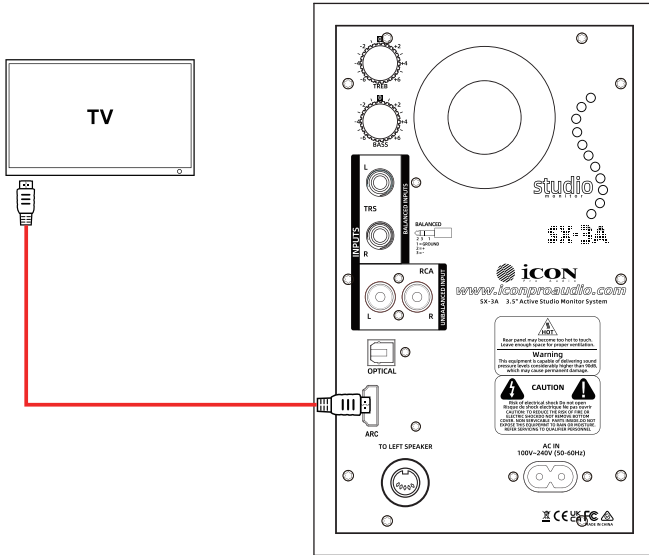

Setting "PCM" on your TV

When all cables are connected properly, and LED indicator lights properly, if there is no sound from tv or Sound Bar, please setting your tv as below:

1. Press "Menu" on the TV's remote control.
2. Press the arrow keys on the remote to scroll to "Audio Settings."
3. Press "OK" on the remote control.
4. Scroll to "Advanced Audio" and press "OK". Some televisions may not have an "Advanced Audio" menu and may list various audio settings instead.
5. Scroll to "Audio Output Mode" or "Digital Audio Output Mode" and press "OK".
6. Scroll until "PCM" is displayed as the current audio output.
7. Press "OK" to save the settings.

Connecting a Bluetooth Device

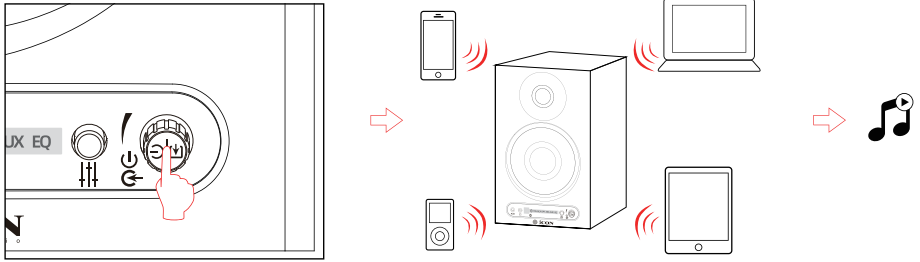

1. Turn on the speaker and briefly press the volume knob key to switch to Bluetooth mode, and the BT mode indicator lights up
2. Go to setup section on your source devices (mobile phones, tablets, etc)and search for nearby Bluetooth devices, you will find "SX-3A" in the list.
3. Play audio tracks on your device and adjust the volume to a desired level.
4. Quick double-tap to disconnect Bluetooth.

Note:

Bluetooth connectivity and compatibility may be different among different source devices, depending on the software versions of source devices.

To enjoy the full Bluetooth functions of this product, please ensure your mobile device supports A2DP and AVRCP profile.

Specifications

Frequency Range.....	50Hz–20kHz
Power Output.....	L/R: 30W (Mid-Bass) × 2 + 10W (Tweeter) × 2
Signal to Noise Ratio (A-weighted).....	L/R ≥85dB
Input Sensitivity	RCA (Unbalanced): 600mV ±50mV TRS (Balanced): 2000mV ±500mV (verify accuracy)
Bass Unit	4" (102mm)
Tweeter Unit	Φ20mm silk dome tweeter
Distortion	< 1%
Inputs.....	HDMI-ARC, Bluetooth 5.3, RCA, Optical, Optical,AUX,TRS Input
Output.....	Headphones, Speaker
Power Supply	AC IN (100~240V)50~60HZ
Weight	L:1.717kg R:2.06kg
Dimensions (WxHxD)	140x 186x 230 mm

Services

If your SX-3A needs servicing, please follow these instructions.

Check our online Help Center at <http://support.iconproaudio.com>, for information, knowledge, and downloads such as:

1. FAQ
2. Download
3. Product Registration
4. Video Tutorials

Very often you will find solutions on these pages. If you don't find a solution, create a support ticket at our online Help Center at the link below, and our technical support team will assist you as soon as we can.

Navigate to <https://support.iconproaudio.com> and then sign in to submit a ticket.

Once you have submitted an inquiry ticket, our support team will assist you to resolve the problem with your iCON Pro Audio device as soon as possible.

To send defective products for service:

1. Ensure the problem is not related to operation error or external system devices.
2. Pack the unit in its original packaging including end card and box. This is very important. If you have lost the packaging, please make sure you have packed the unit properly. iCON is not responsible for any damage that occurs due to non-factory packing.
3. Ship to the iCON tech support center or the local return authorization. See our service centers and distributor service points at the link below:

If you are located in the **United States** please visit our help centre - <https://support.iconproaudio.com> and submit a ticket to the technical support team.

If you are located in **Europe**, please email the support team and wait for a response before sending the product to:

Sound Service GmbH
European Headquarters
Moriz-Seeler-Straße3 D-12489 Berlin
Telephone: +49 (0)30 707 130-0
Fax: +49 (0)30 707 130-189
E-Mail: service@sound-service.eu

If you are located in **Hong Kong** please email the support team and wait for a response before sending the product to:

ASIA OFFICE:

**Unit F, 15/F., Fu Cheung Centre,
No. 5-7 Wong Chuk Yueng Street,
Fotan,
Sha Tin, N.T., Hong Kong.**
Tel: (852) 2398 2286
Fax: (852) 2789 3947
Email: info.asia@icon-global.com

For additional update information please visit our website at: www.iconproaudio.com



天猫官方旗舰店



天猫店iconproaudio旗舰店

抖音号



抖音iCON艾肯

哔哩哔哩



B站iCONProAudio

中国地区用户

微信公众号



微信号iCON-PRO

官方售后QQ



4006311312.114.qq.com

Twitter



www.twitter.com/iconproaudio

Instagram



www.instagram.com/iconproaudio

Facebook



www.facebook.com/iconproaudio

Youtube



www.youtube.com/iconproaudio

Website



www.iconproaudio.com

Support



support.iconproaudio.com

Dashboard



iconproaudio.com/dashboard/

www.iconproaudio.com