



BECAUSE THE SHOWER IS EVERYTHING

Quick'N Stall Installation Supplement

This supplement is intended for use with the proper Door & Panel instruction sheet for your unit.



Instructions:

1. Install the shower curb or curb assembly and the wall jamb according to the instruction sheet provided with the unit.
2. Take the pre-assembled QUICK'N STALL panel and snap it into the curb next to the wall jamb. (Fig. A)
3. Slide the QUICK'N STALL panel over until the side rail is flush with the wall jamb. (Fig. B)
4. Slide the center post (180°, 90°, or 135°) over the QUICK'N STALL panel rail and push it firmly downward into the curb. (Fig. C)
5. Install any other QUICK'N STALL panels.
6. Set the header or header assembly into place and snap it over the top vinyl rail on the QUICK'N STALL panel(s). (Fig. C)
7. Continue with the rest of the assembly according to the provided installation instruction sheet.

Pro Tip - slide a bar of soap (or use some soapy water) across the black plastic top & bottom. This will make it easier for the panel to snap into the curb (Step 2) and header (Step 6).

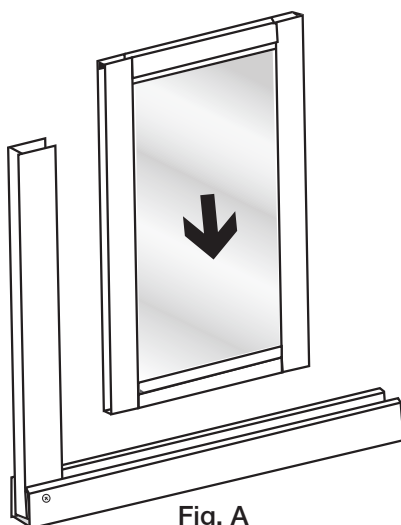
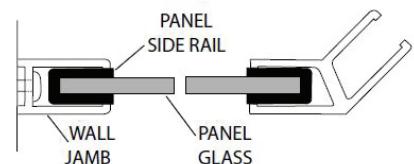
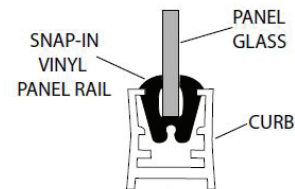

Fig. A

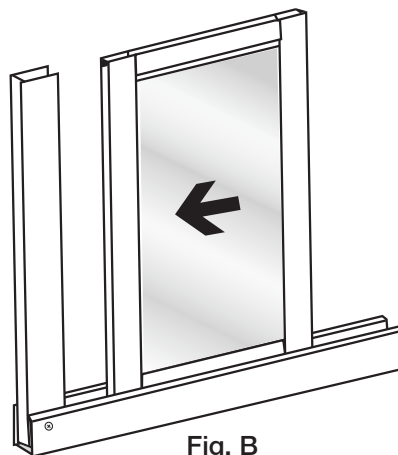

Fig. B

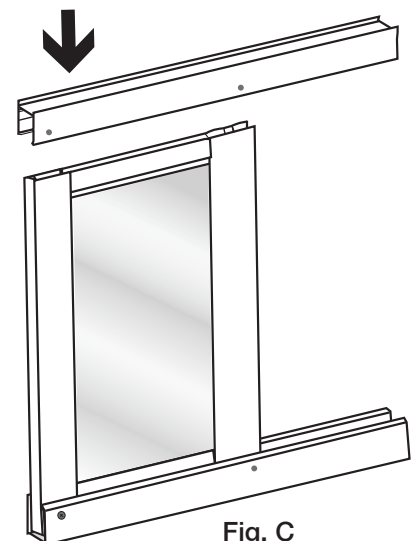

Fig. C



How to Glaze Quick N Stall Panels

Items needed:

- (1) Glass Panel
- (2) SC620 Vertical Rails
(Note: each SC620 rail should be $\frac{3}{4}$ " taller than the glass panel.)
- (1) Silicone
- (2) SCV315 Vinyl Pieces
- (4) SCR25 Screws

Directions:

- 1) Apply a small bead of Silicone inside the vertical rails down the center of the entire length.
- 2) Press each rail onto the vertical edge of the glass, while keeping the glass centered in the rail. The rail should extend $\frac{3}{8}$ " away from the glass on both sides.
- 3) Attach the SCV315 vinyl to the top and bottom of the glass panel with the SCR25 screws provided.

Centerline

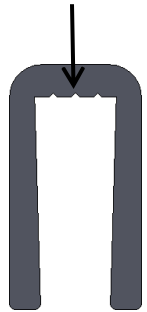

SC620

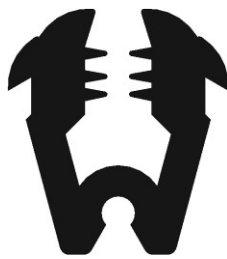

SCV315

