

# Frameless Inline Door With Return

## QCI5261

PIVOT HINGES

FRAMELESS DOOR / RETURN PANEL



# Parts List

## with pivot hinges

ITEM NO.	DESCRIPTION	QTY.
1	GLASS DOOR	1
2	FIXED GLASS PANEL	1
3	RETURN GLASS PANEL	1
4	HEADER	1
5	HEADER	1
6	ETCHED PIVOT HINGE	1
7	BOTTOM PIVOT HINGE	1
8	U-CHANNEL	1
9	U-CHANNEL	1
10	U-CHANNEL	1
11	PULL	1
12	WALL BRACKET	2
13	90 CORNER BRACKET	1
14	VINYL BOTTOM SWEEP	1
15	#8 x 1 1/2 TRUSS HEAD SCREW	11
16	PLASTIC WALL ANCHOR	11
17	1/8 SETTING BLOCK	6
18	HEADER VINYL	1
19	HEADER VINYL	1
20	HEADER FILLER	1

\*Quantities may vary

# Exploded View

with pivot hinges

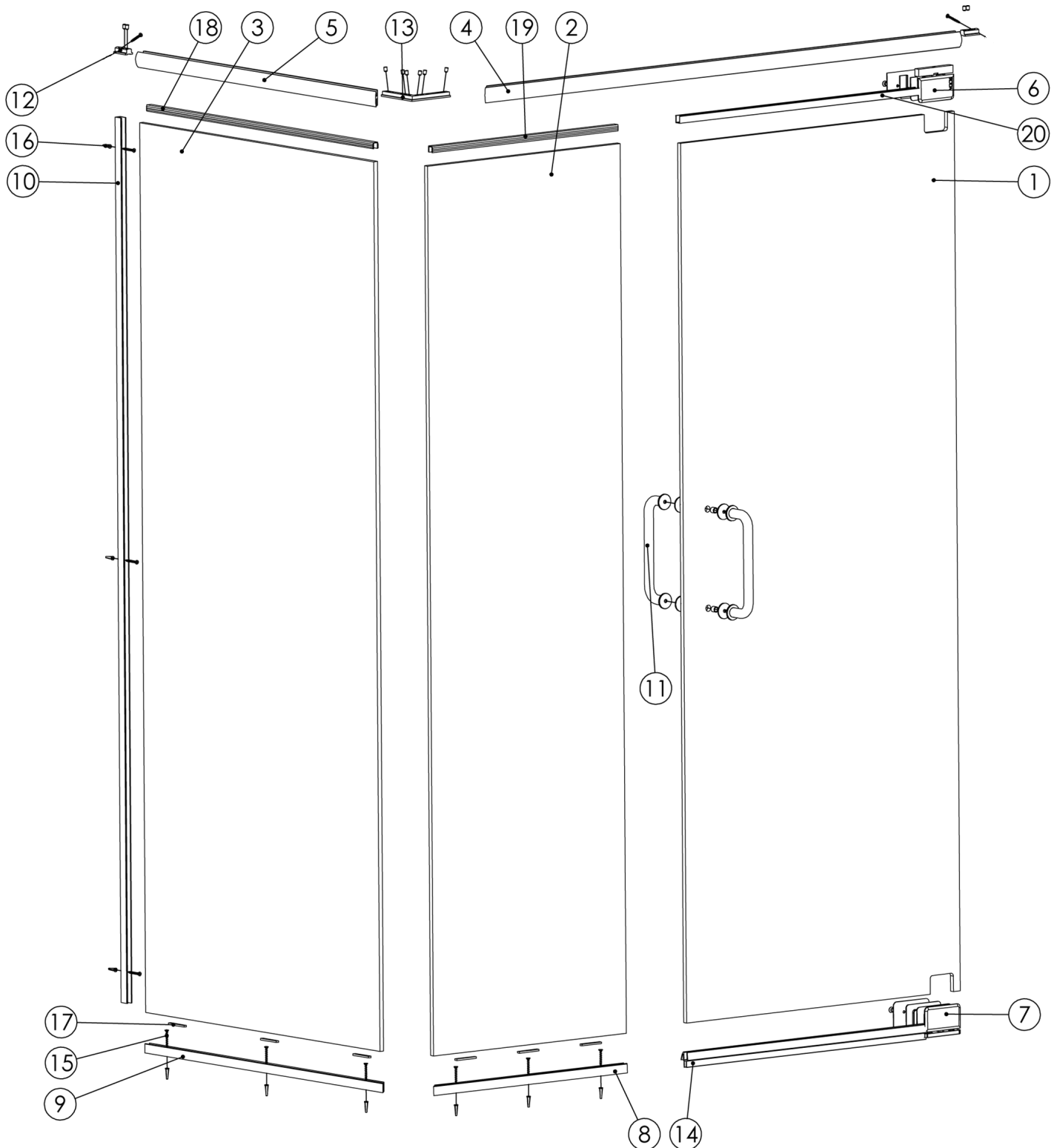

## Tools:

To install your New Shower Enclosure, you may need the following:

- Pencil
- Low Tack Tape
- Tape Measure
- 4' & 6' Levels
- #2 Phillips Screwdriver
- Drill
- 1/8" & 3/16" Drill Bit
- Center Punch
- Files
- Hack Saw
- Caulk Gun
- Clear Silicone Caulk
- Suction Cups

## Safety Notes:

- This unit is best installed by two people.
- Handle the glass panels carefully and protect the edges. Safety tempered glass is very resistant to breakage, but the sharp corners of the panels can damage tile and flooring surfaces.
- The glass can break if unequal pressure is applied during installation.
- Please wear safety glasses whenever drilling or cutting. When drilling holes in ceramic tile or marble, use a center punch and hammer to carefully break the glazed surface to prevent skidding when drilling.

**NOTE:** Tempered glass cannot be cut.

## Installation Notes:

- Proper blocking is required for every Heavy Glass unit prior to installation. At minimum 2x4 blocking is required at the location of any structural member of the unit including, but not limited to: hinges, clamps, and header brackets. All fasteners at these locations are required to be installed into the blocking.
- A minimum of 1 1/4" thread engagement is required of all fasteners into the blocking at these locations. Depending on the application the customer maybe required to supply the proper fasteners to ensure adequate engagement.
- U-Channel maybe installed using wall plugs where no backing is found.
- Use caution to not pierce plumbing or electric lines while installing door hardware.
- Cover the drain with tape prior to installation to prevent loss of small parts.
- Unpack your unit carefully and inspect for freight damage. Lay out and identify all parts using the instruction sheet as a reference. Before discarding the carton, check to see that no small hardware parts have fallen to the bottom of the box. If any parts are damaged or missing, refer to the description noted in the instructions when contacting your dealer for replacements.

## Maintenance:

Two primary materials are used to manufacture your new shower enclosure: tempered glass and anodized aluminum. To assure a long lasting finish on the enclosure, wipe it down with a towel after each use.

For occasional, more concentrated cleaning efforts, we find that **Lysol® Non-Abrasive Bathroom Cleaner** works extremely well. Be sure that any over spray falling on the aluminum frame is rinsed thoroughly and dried. Many over-the-counter cleaners, if applied to the aluminum and left on, will harm the metal finish and cause permanent damage even though their directions indicate safe use on shower doors. Never use a scouring agent to clean the aluminum.

For units with **AquaglideXP** please use Maintain spray from the maintenance on the glass. Please contact customer service for details and to purchase the maintenance kit.

If a continuous unit centerline does not exist from the original measuring process, it will be necessary to create one. Referencing the Measuring Guide included with this unit, lightly mark a continuous unit centerline on the threshold.

Next, mark a continuous unit centerline up each wall, starting where the threshold centerline meets the wall. Use a level to ensure the wall centerline is plumb and straight. The wall centerlines should be a minimum of unit height from the threshold.

**Note:** Centerline (CL) is a term used to describe the center or mid-point of the unit. The position of the unit centerline can be located anywhere in the width of the threshold, as long as adequate structure exists beneath the centerline for fastening and the outer edges of the unit will not overhang the threshold. The most common unit centerline position is the middle of the threshold.

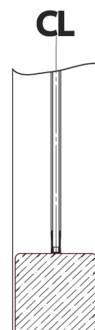
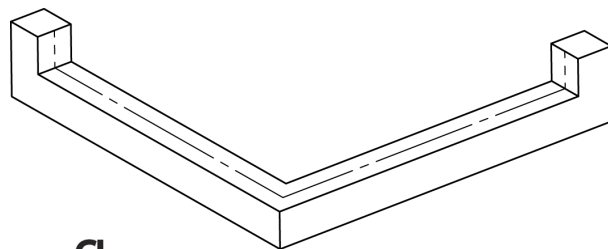

Unit Cross  
Section

**Note:** It is extremely important the unit centerline be continuous and straight to ensure proper installation.

Use a level to check the threshold for out of level conditions if the original measured conditions are not available. If no conditions exist, measure up each wall centerline a distance of Unit Height from the threshold, and clearly mark each location.

**Note:** The Unit Height is the height of the shower door unit to the top of the header.

If out of level conditions exist; measure up the “high” side wall centerline a distance of Unit Height from the threshold and clearly mark this location. For the wall centerline distance on the “low” side of the threshold, use a level to determine the threshold out of level distance and add this value to the Unit Height. Measure this summed distance up the “low” side wall centerline from the threshold and clearly mark this location.

(See illustration for example.)

**\*\*IMPORTANT\*\***

**Keep both marks in-line to ensure the header mounts level.**

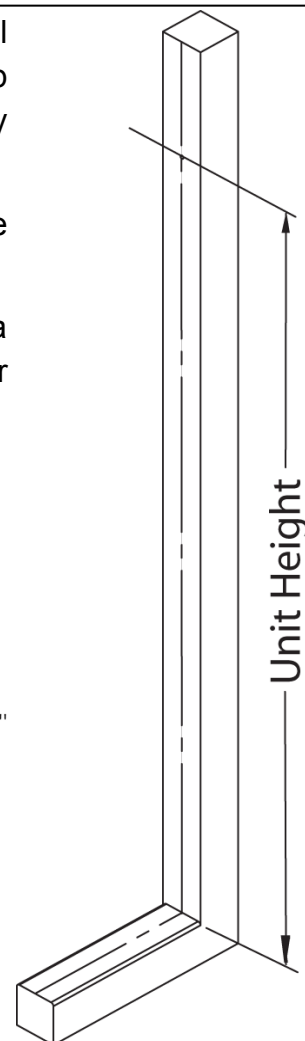
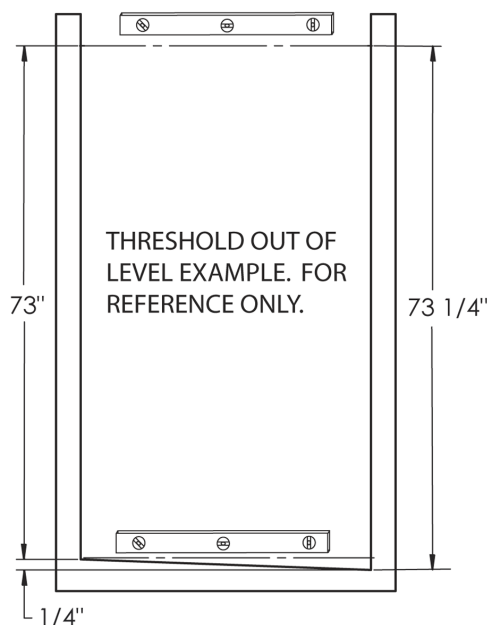

Remove u-channels from the hardware box and counter-sink holes in the u-channels. Each piece of u-channel requires a minimum of two (2) screws, 3" from each end for lengths less than 18". Lengths 18" or greater require screws approximately every 18"-24", and 4"-6" from each end.

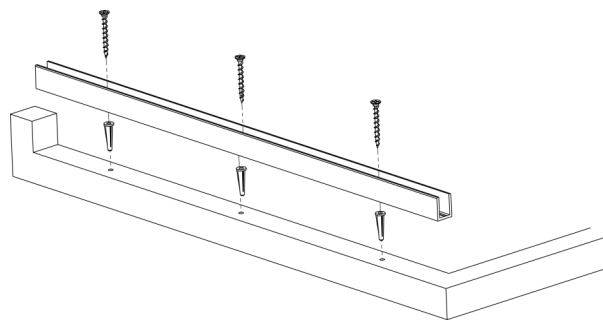

Each piece of u-channel is cut to length and mitered as necessary. Position each piece of u-channel along the threshold centerline and use low-tack tape to hold in place. Check that each piece of u-channel fits in location along the marked centerlines and mitered joints fit tightly.

In the even the u-channel doesn't fit properly, contact Technical Support.

*If your unit was ordered with a notch panel, please see appendix "A" for supplemental installation instructions.*

*If your unit includes multiple stationary Glass Panels, repeat the steps associated w/ installing the stationary Glass Panels for each stationary panel.*

*Reference the unit drawing shipped with the unit to determine where each stationary glass panel is to be located.*

With a pencil, carefully mark each hole position on the threshold centerline. Remove the U-Channel and drill a 3/16" diameter hole, approximately 1-1/2" deep, at the marked locations.

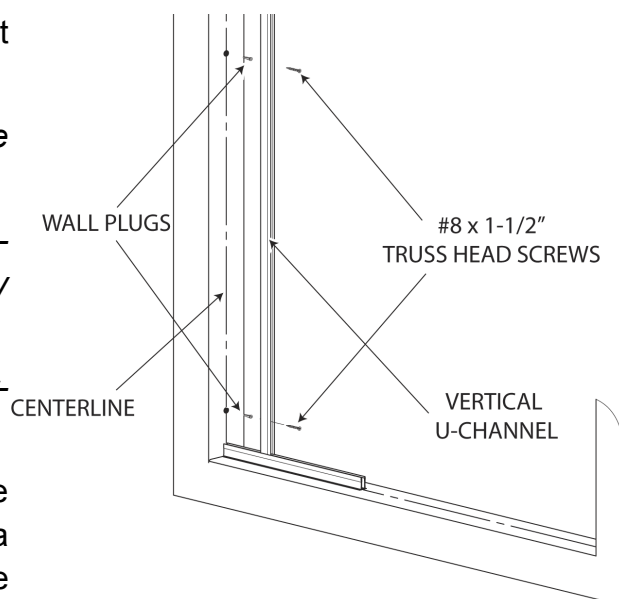

Insert a small amount of silicon into each drilled hole, followed by a wall anchor.

(Note: This must be done just before u-channel installation).

Carefully cut the heads off the wall anchors with a razor blade. Place the u-channel in correct position and secure it with #8 x 1-1/2" truss head screws.

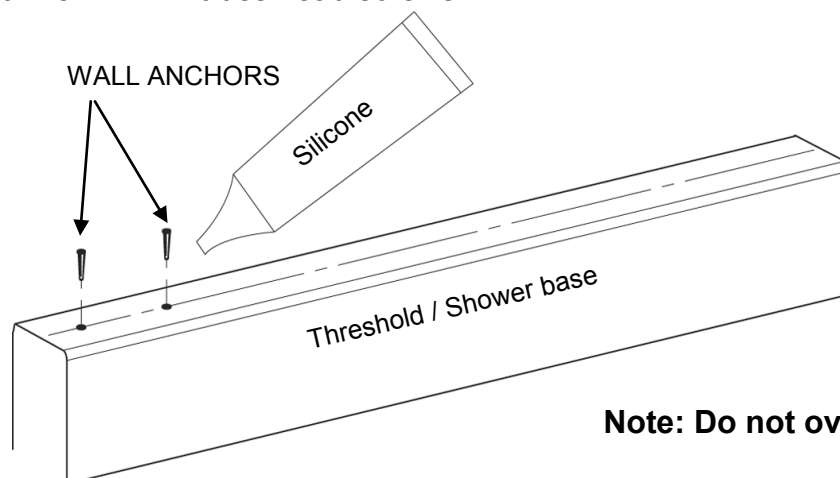

**Note: Do not over tighten screws.**

Place 1/8" setting blocks as shown or approximately every 18". Do not place setting blocks over screw heads.

Using suction cups, slide the Fixed Panel Glass into the appropriate location. Use setting blocks to make exposed edges of the glass level and plumb. Exposed edges **MUST** be level and plumb before moving to next step.

\*\*Different size setting blocks may be required depending on level conditions. Various size setting blocks provided and can be used in different combinations (stacked) to obtain the desired results.

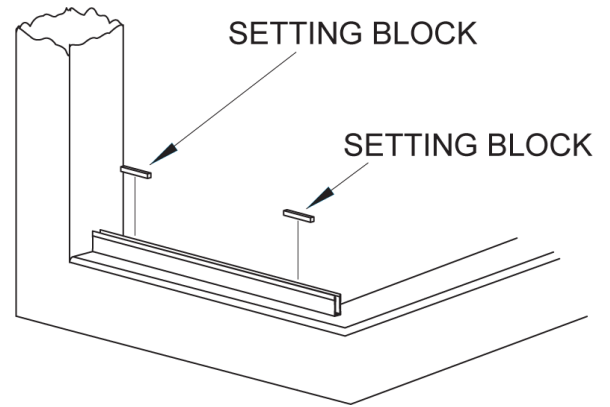

**Note: The glass should be approx. 3/8" above the top of the wall u-channels.**

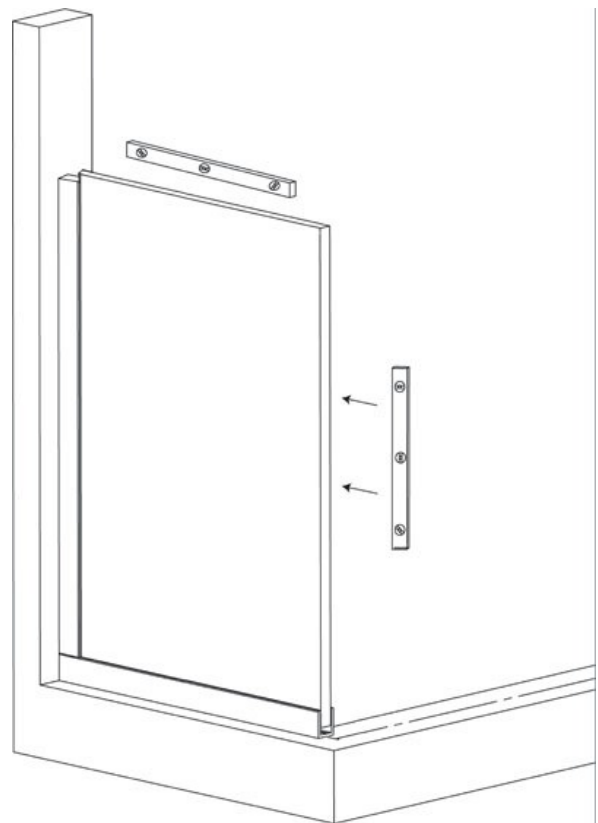

With the two Header pieces laying on a flat surface with the top of the Header facing upward, slide the 90° Header Bracket into one half of the Header and tighten the set screws.

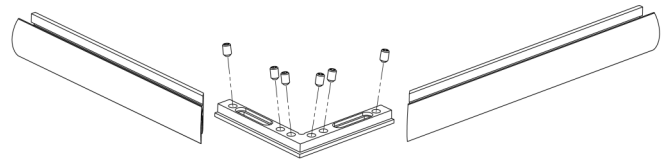

---

Slide the other half of the Header onto the exposed portion of the 90° Header Bracket. Make sure the ensuing corner is straight, tight and square. Tighten the other three set screws to complete the bracket installation.

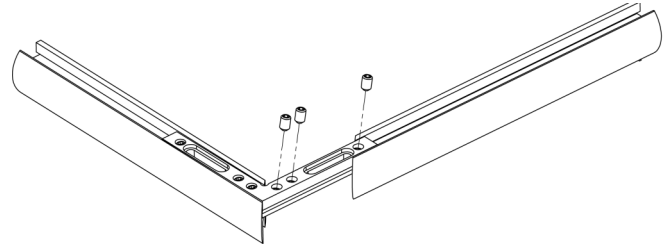

---

Check the Header for proper length in the opening. The Header should be the opening size minus 1/16". In the event there is a measurement discrepancy, contact Technical Support.

Install the Wall Mount brackets into the Header. Be sure the hole of the bracket is facing outward and it is flush with the end of the Header. Tighten the Allen head set screws to lock them in place.

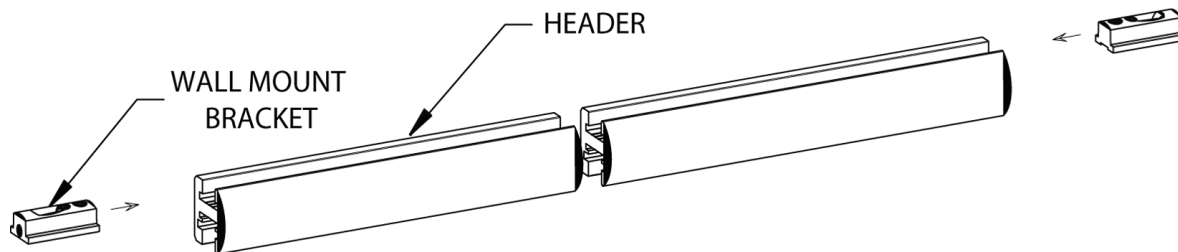

NOTE: Your header may differ in external shape than what's shown. However, internal geometry and installation procedures are the same.



Cut Header Vinyl into 1" strips. Place the 1" pieces of Header Vinyl over each glass panel 2" from each end. Place the Header over the Vinyl. Check to make sure the header is level across the opening.

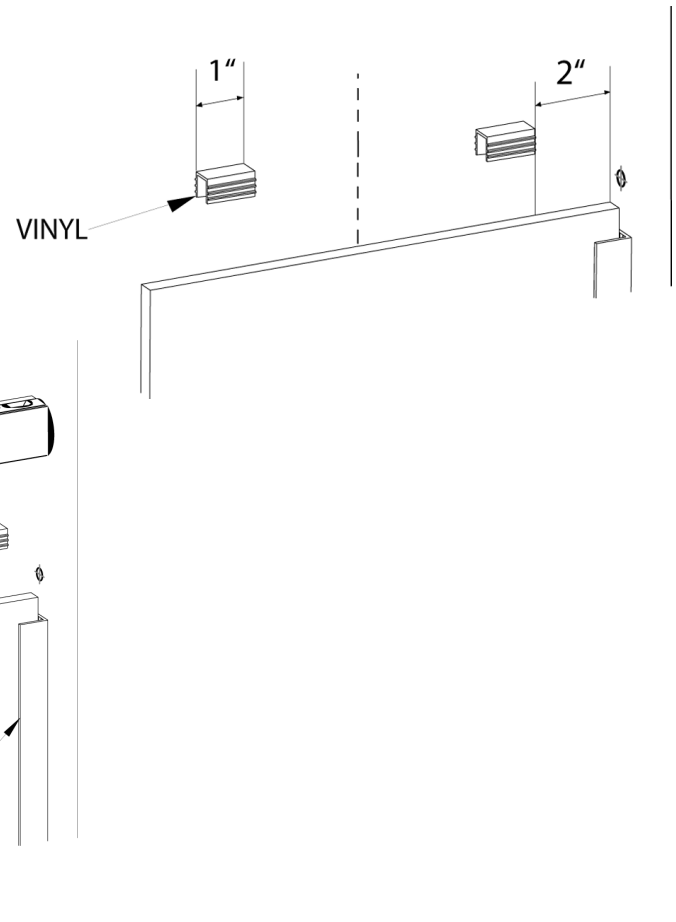

On each wall, make a mark on the wall centerline 5/16" down from the Unit Height marks.

Holding the drill at a downward angle drill a 3/16" hole at the previously marked locations. Drill through tile and backer board. Do not drill through blocking.

Be sure that the angle is close to the downward angle of the hole in the Mounting Bracket.

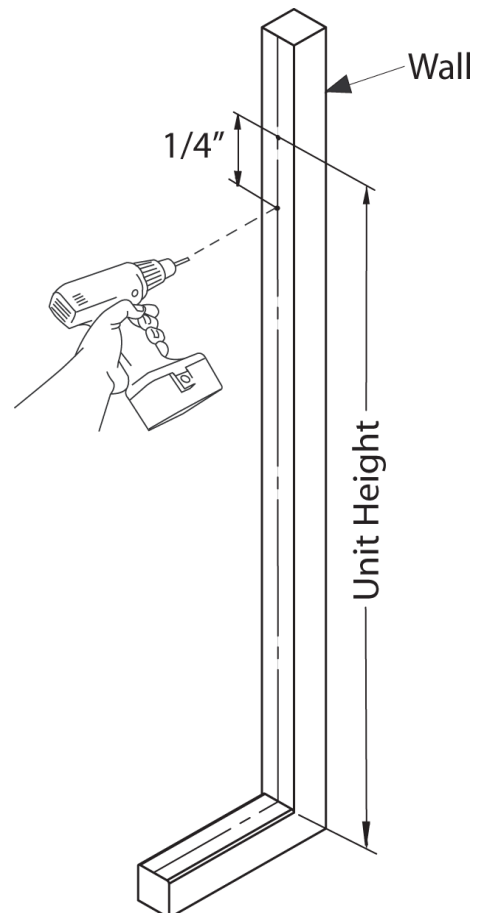

Install the Header using a Truss Head Screw on each end.

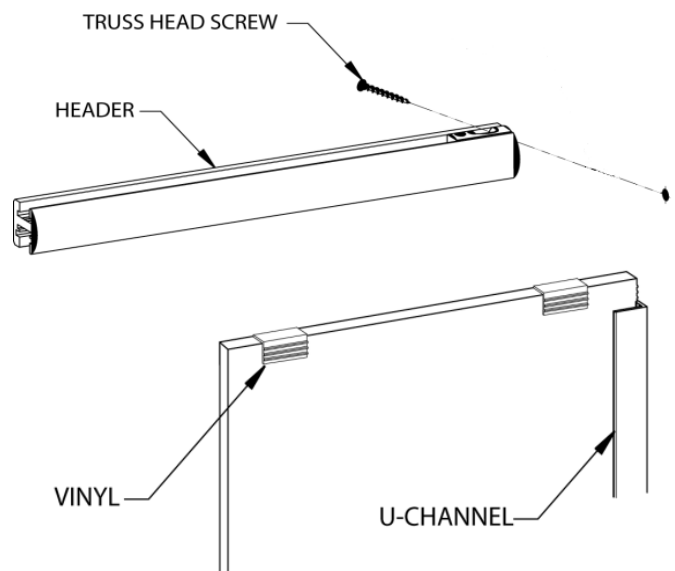

Tighten the Wall Mount set screws to secure the Header in place.

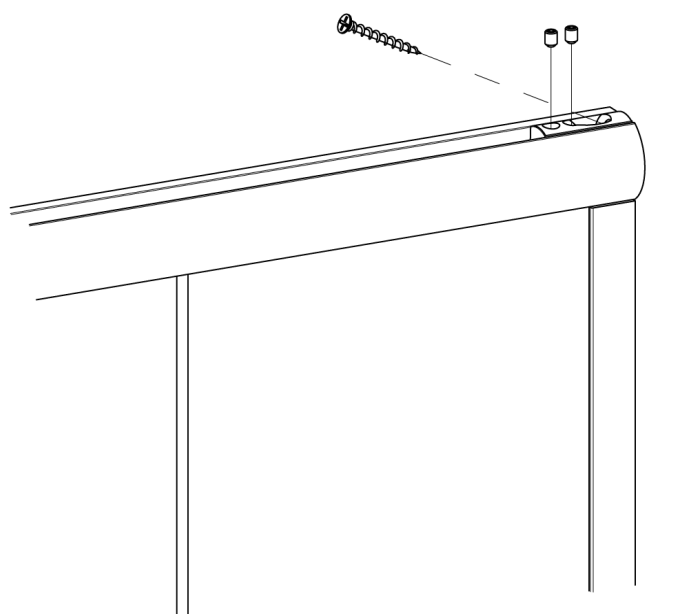

Place a mark on the Glass at the center of each hinge cut out.

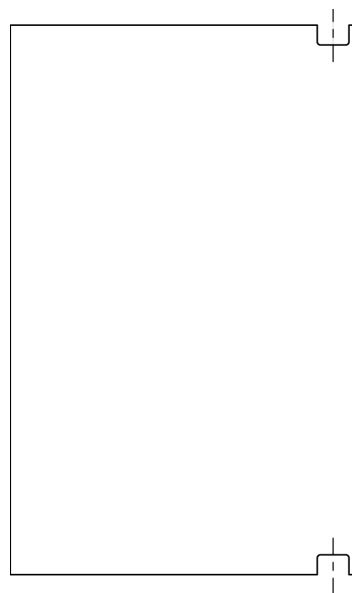

Place two 7/16" shims on the curb or threshold. These shims must remain in place throughout the installation process.

Next, position one person on each side of the door panel and carefully pivot the door into the opening, using suction cups align the glass with the opening centerline.

Place a 3/16" surround clearance on each side of the door to maintain a 3/16" gap all the way around.

Use a 6' level to plumb the door. The door must be plumb to allow the hinge pivot pins to align to each other.

Finally, with the door panel aligned and plumb, mark the center of the hinge cut out onto the header and threshold.

Remove the door glass panel from the opening.

**NOTE: 1/2" door panels require a 9/16" gap at the threshold**

**Note:** Use level to mark center lines on header and threshold.

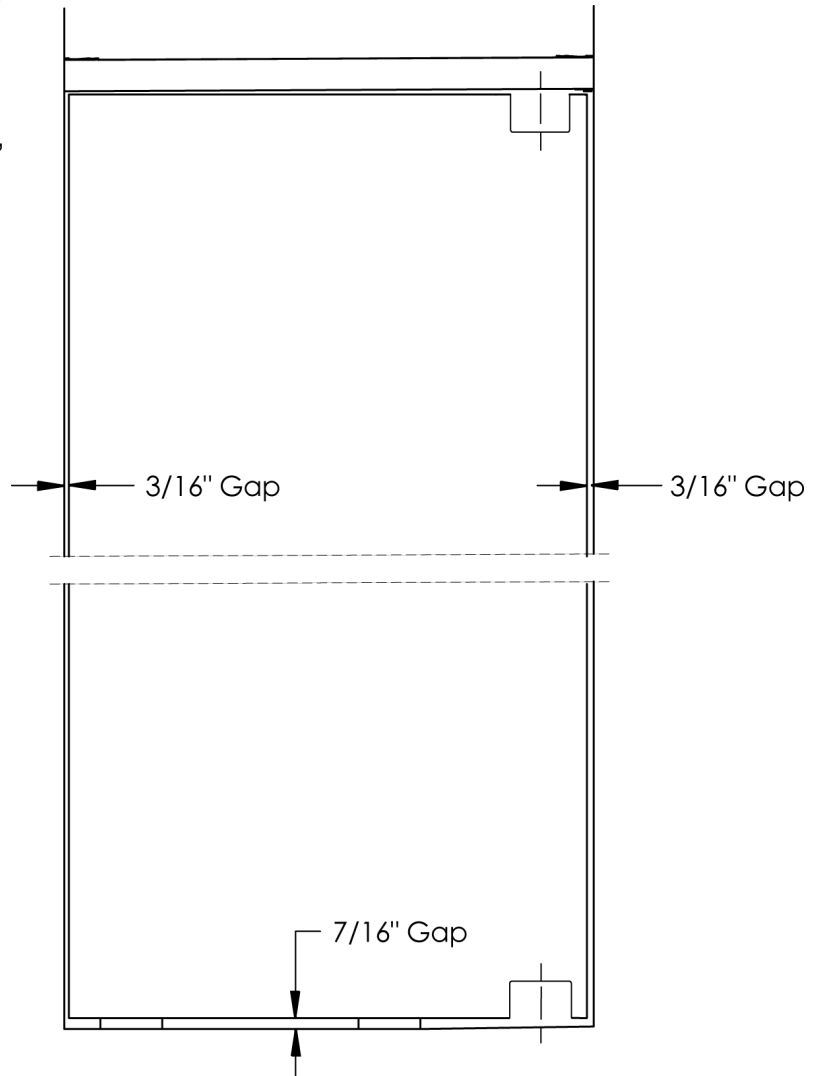

Insert the Adapter Block into the header aligning the hole with the mark from the previous step. Use low-tack tape to hold the Adapter Block in place while drilling a 3/16" hole through the header as shown.

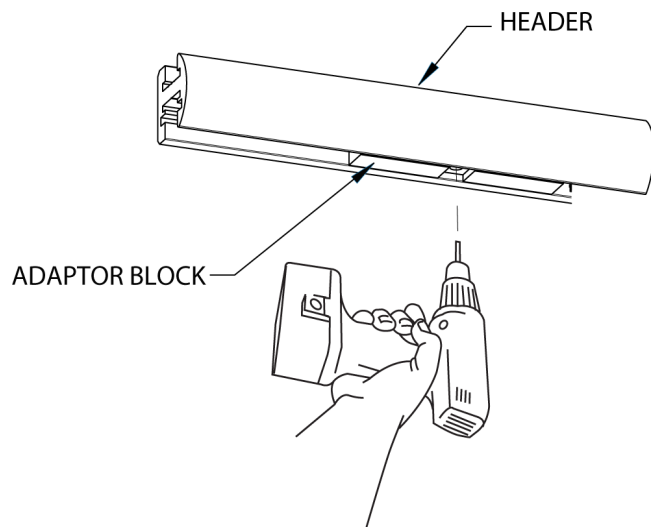

Use the screw provided to mount the Top Pivot Hinge to the Header from the top down.

Rotate the Top Hinge 90 degrees (open).

**Note:** Base plate must be removed from top

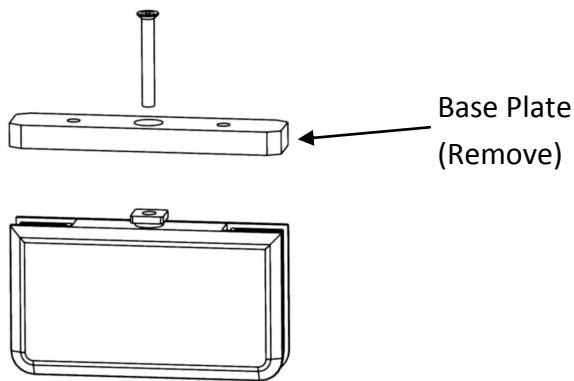
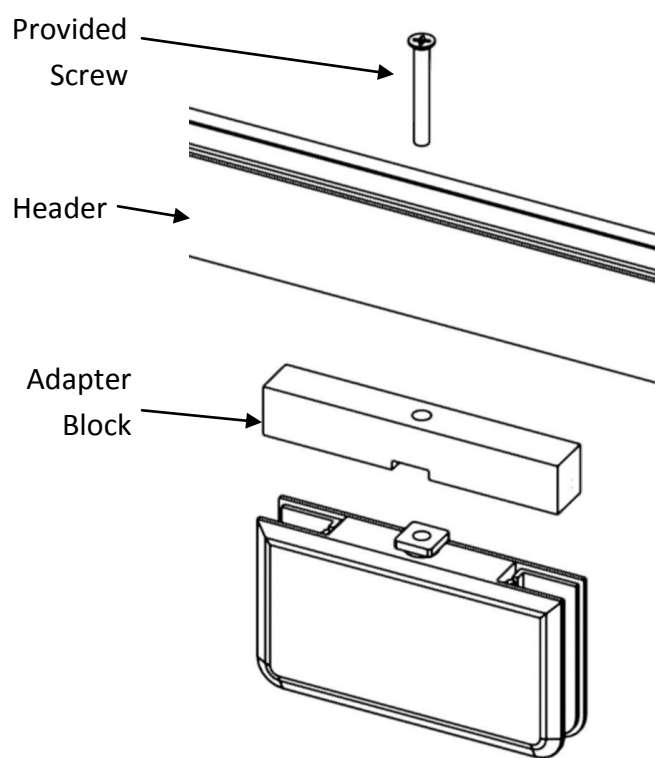

Rotate the Bottom Hinge 90 degrees (open). Center the hinge using both the unit Centerline mark and the hinge cut out mark, when perfectly centered mark the two mounting hole locations onto the threshold.

Remove the hinge and drill two 3/16" holes in the threshold approximately 2" deep. Put a small amount of silicone in the hole.

Set the Bottom Hinge in place and carefully secure with two #10 x 2" Flathead screws. Leave the hinge in the open position.

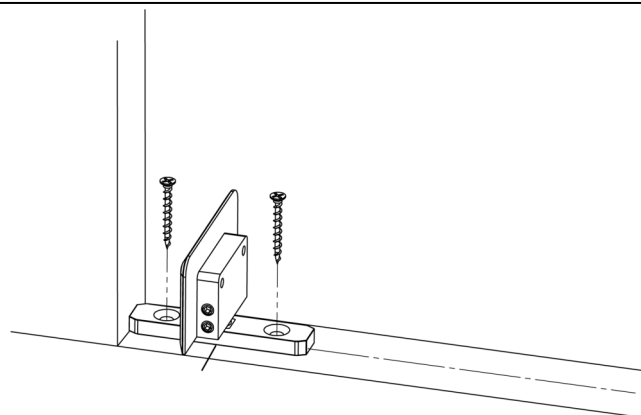

With both hinges open and aligned to each other, use a suction cup to carefully move the Door Glass into the opening over the hinges.

Insert the vinyl Hinge Gaskets on each side of the glass. Use a #3 screwdriver to mount the back plates to the glass

**TIP: Use the setting blocks from the hardware strip to fill in the void in between the top of the bottom hinge and the glass. (see illustration)**

Align the hinge on the hinge notch cutout being sure that it is centered and the edge of the plate is even with the edge of the Glass. This will ensure correct pivot pin alignment.

Tighten the screws, alternating so the pressure is evenly applied to the inside cover plate as you tighten the screws. Continue tightening until the screws begin to squeak.

Slowly shut the door and align it on the opening centerline. The gap on each side of the glass should be approximately 3/16".

To adjust the door, loosen the back plates and shift the door left or right to allow a consistent gap.

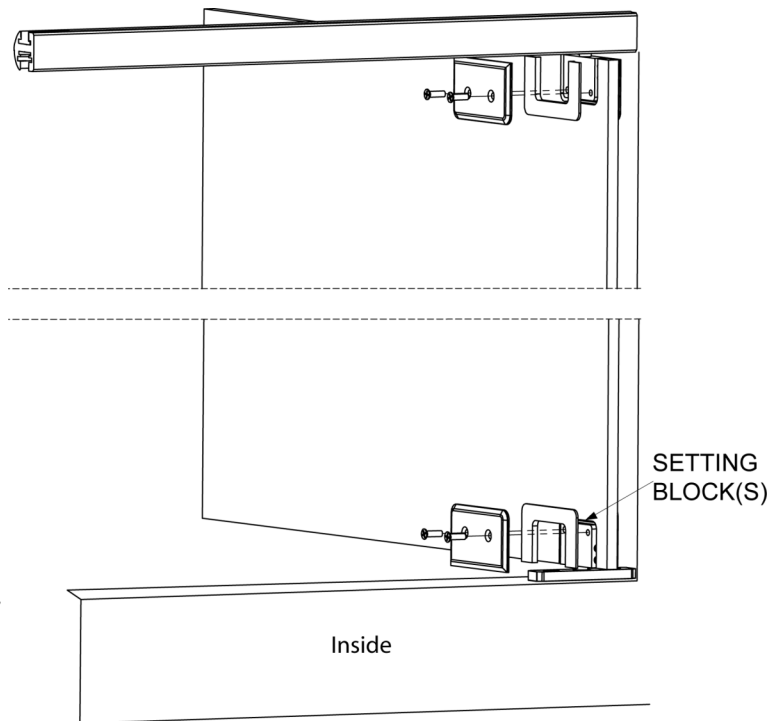

Measure the distance between the end of the Adapter Block and the wall from the under side of the Header. Cut the Filler to this dimension. Install the Filler in the Header above the Door as shown so the finished edge is facing down.

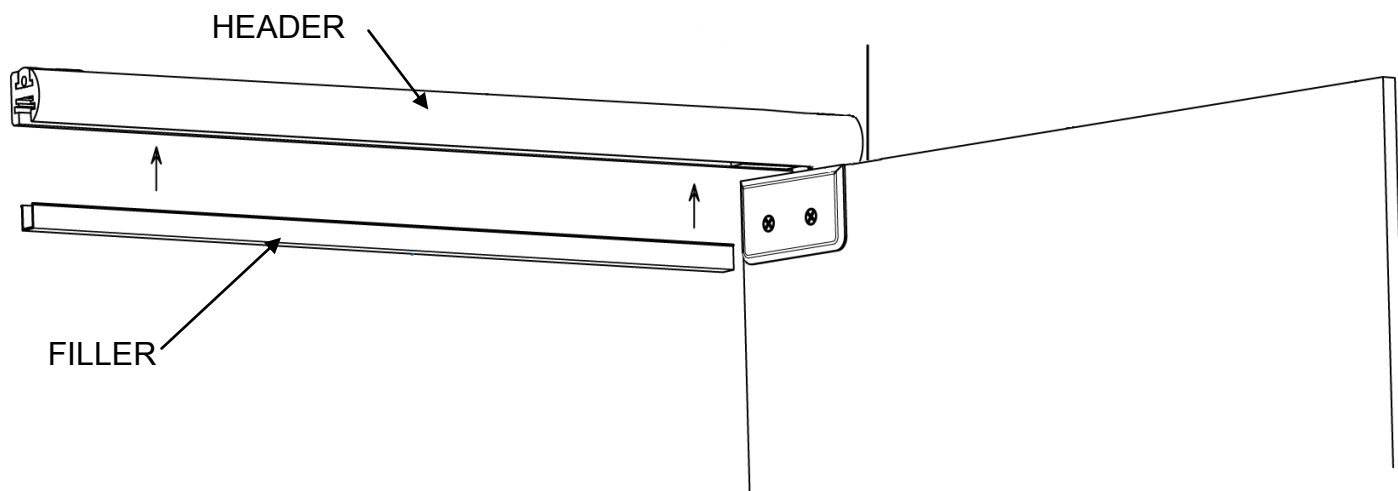

Place the Drip Vinyl onto the bottom of the door panel. Line it up on the hinge side of the door and cut it off flush with the strike edge of the door.

**NOTE:** The sweep may be pulled up or down on the glass to adjust how much of the sweep contacts the threshold

**TIP:** Round the end of the deflector of the drip vinyl on the handle side of the door as with a file to prevent potential future injuries.

**TIP:** Run a small bead of silicone between the drip vinyl and the glass to secure the vinyl sweep and prevent water from collecting inside the sweep if adjusted.

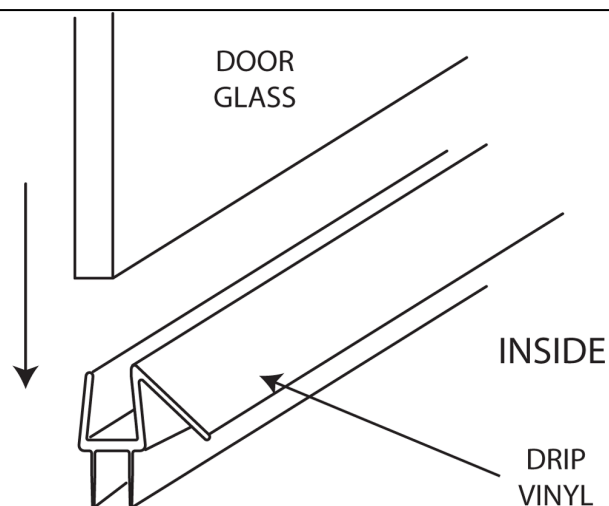

On the interior face of the glass, place a strip of low tack tape on the glass about 1/8" to 3/16" away from edge of the u-channel both vertically and horizontally. Run a small bead of silicone along this edge. Next, on the interior, run a bead of silicone between the u-channel and the threshold and also between the u-channel and the wall. After completing, remove the tape before silicone sets.

**NOTE: DO NOT USE the shower until the silicone is completely cured. Check the tube of silicone for the manufacturer recommended cure time (typically 24 - 48 hours).**

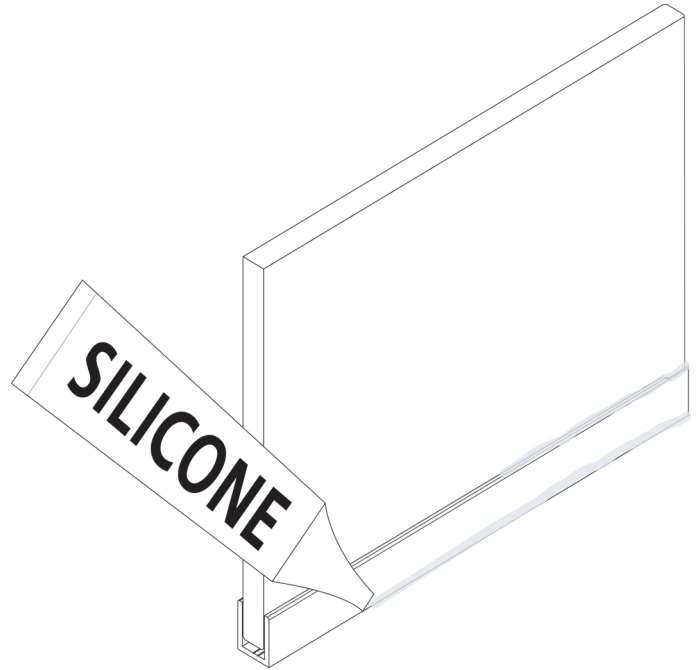

## Appendix — A Notch Panel

If your unit has been purchased with a notch panel option, two additional pre-cut pieces of u-channel will be provided. These two pieces of u-channel will be mitered and cut to size based on the opening dimensions provided with your order. Please follow the same instructions provided in step (3 thru 6), for mounting threshold and wall u-channels, to mount the notch panel u-channels. Below are illustrations to clarify the mounting orientations.

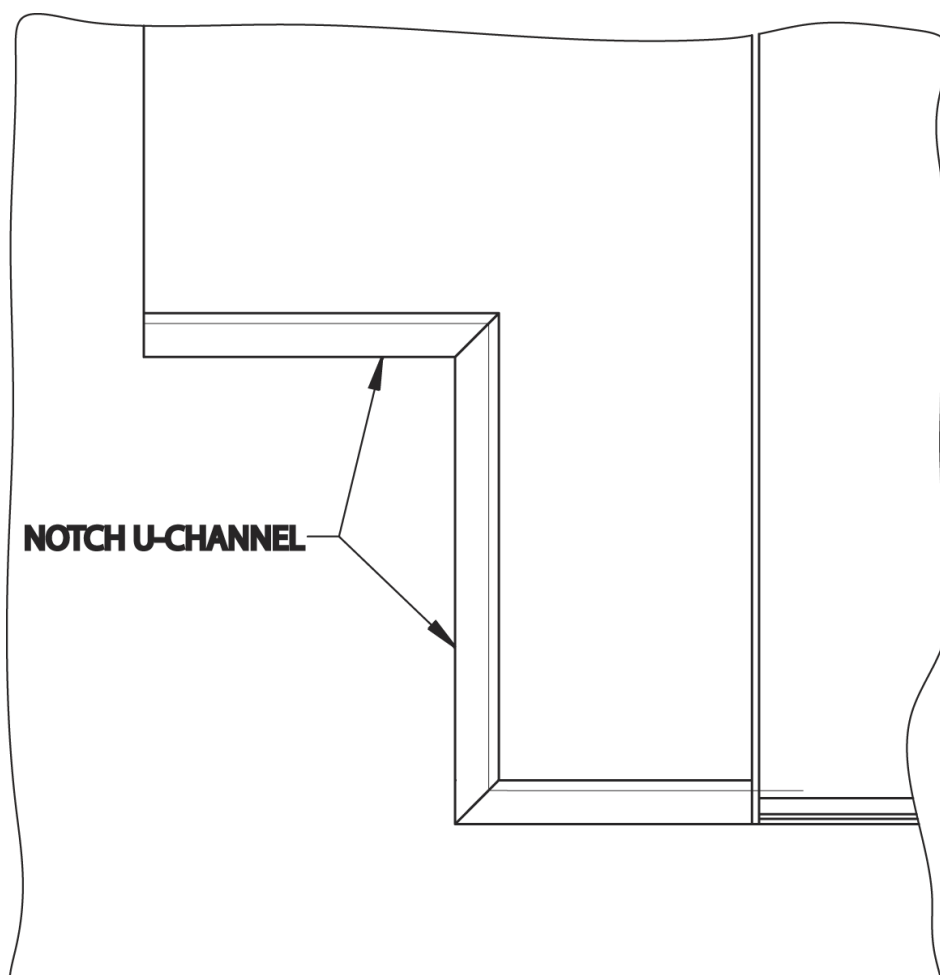



# Appendix — B Glass to Glass Pivot Hinges

If your unit has been purchased glass to glass (panel mounted) pivot hinges the following is how to install the hinges.

**1)** Mount the hinge on the 1/2" glass panel with the hinge hole. Use a 16mm (5/8") long screw from the hinge pack for this step. A thin gasket needs to be placed between the glass and the clamping surface of the hinge.

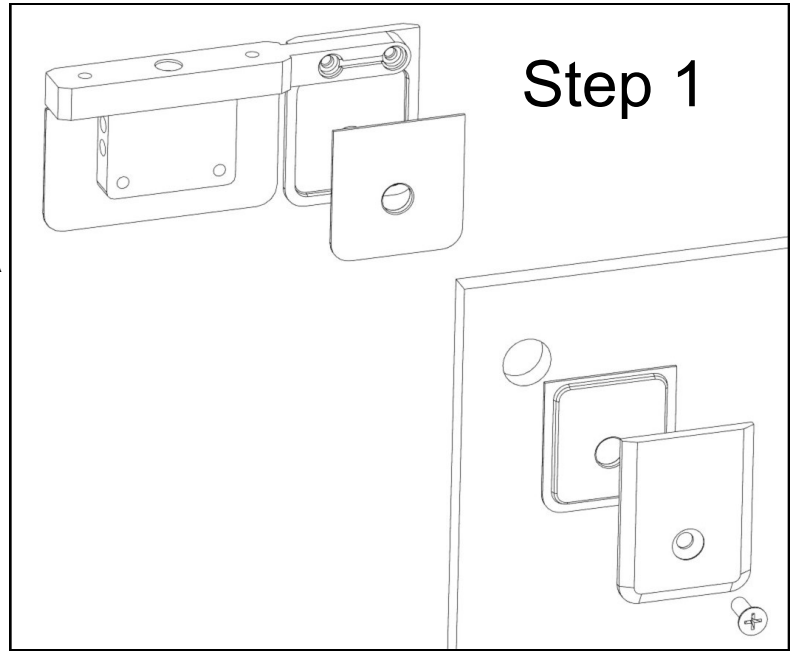

**2)** Using the process found on pages 11 & 12, mount the bottom hinge to the threshold.

- 3/8" door require a 7/16" threshold gap
- 1/2" door require a 9/16" threshold gap.

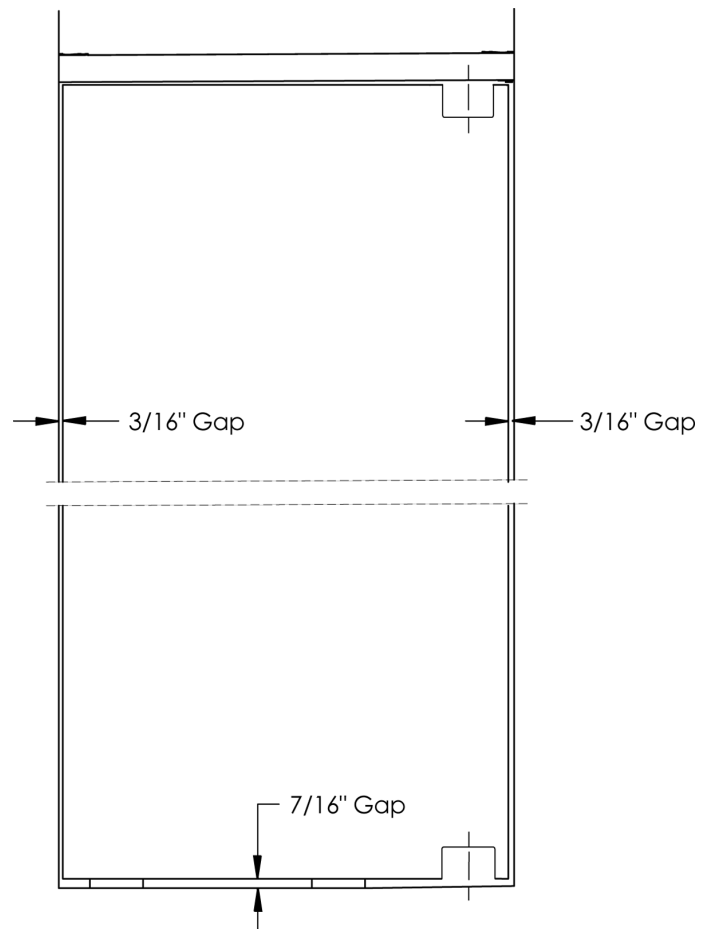
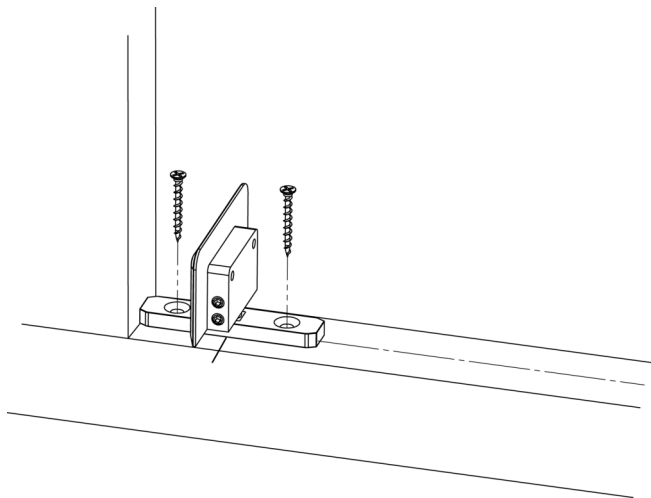

## Appendix—B Glass to Glass Pivot Hinges (cont'd)

3) Install the door panel into the top and bottom hinges using 1 gasket on each side of the glass. Check for correct gaps, using additionally setting blocks in the hinges as necessary to set the gaps. When gaps are correct, securely tighten 2 screws in each hinge to permanently install the door panel.

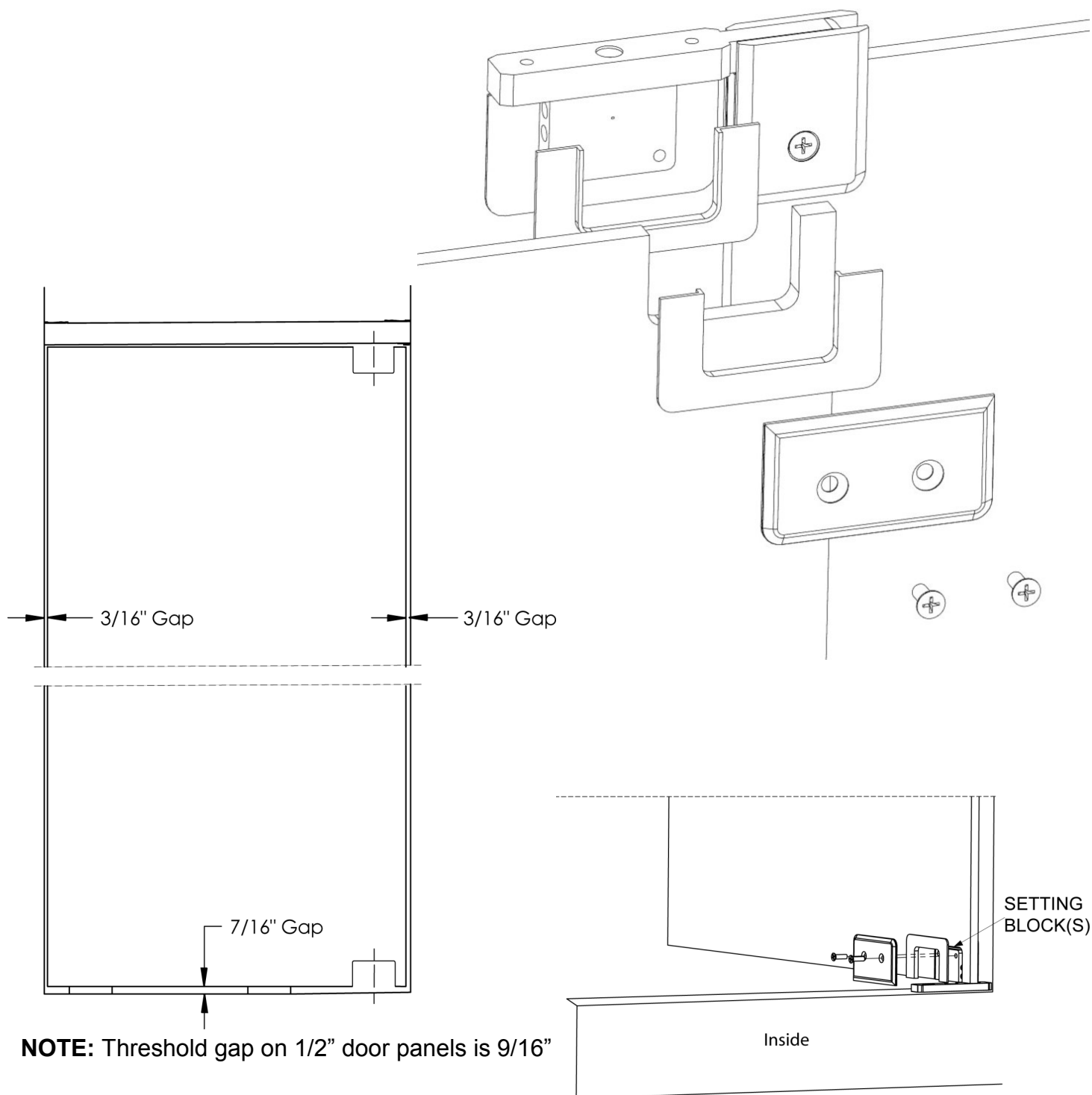

**NOTE:** Threshold gap on  $1/2''$  door panels is  $9/16''$

**Installing Handles:**

Assemble parts as shown. Screw washers, end plates, and gaskets into one side of the handle through the glass. Then align the other side of the handle onto the bushing and tighten the set screws.

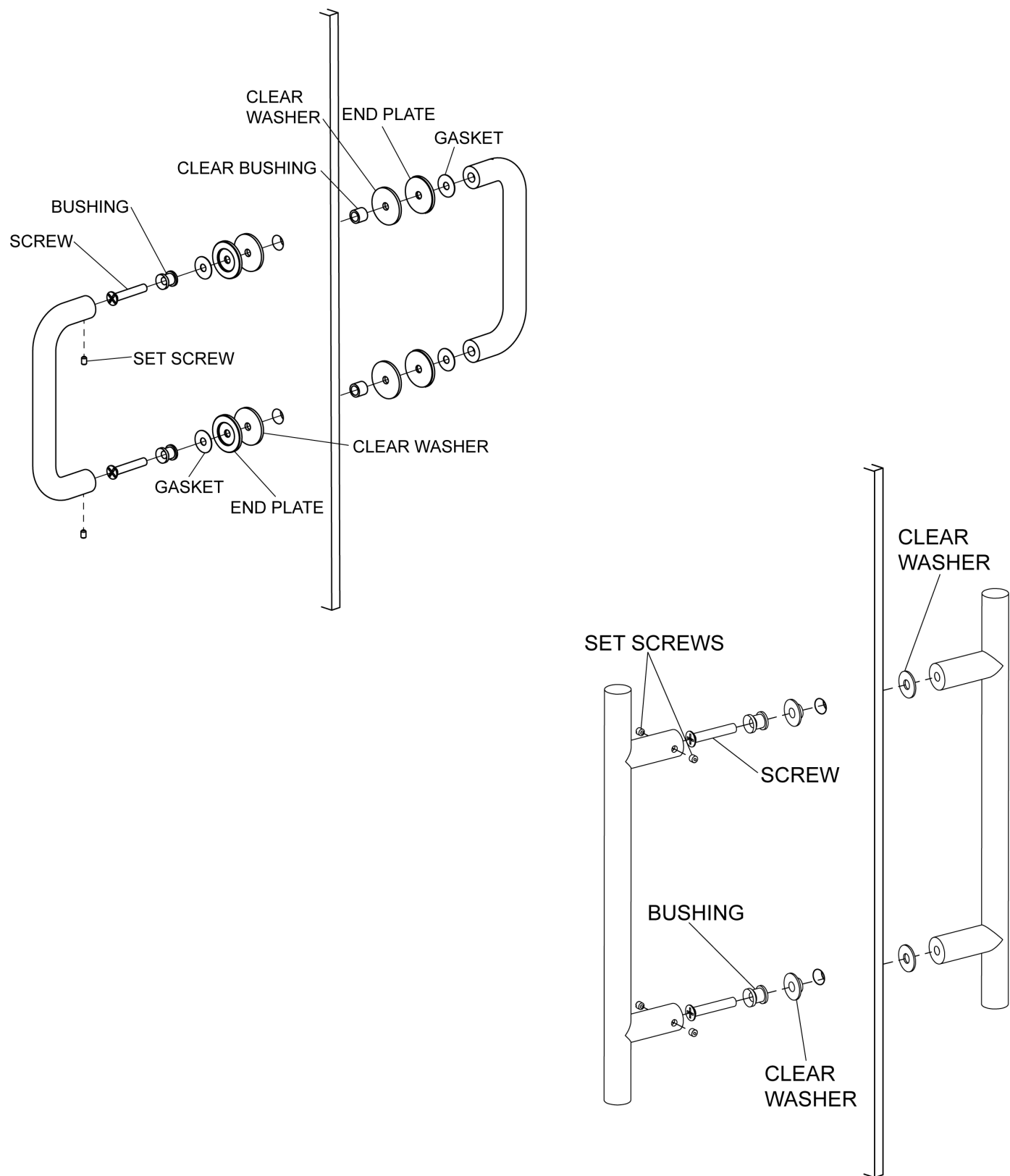

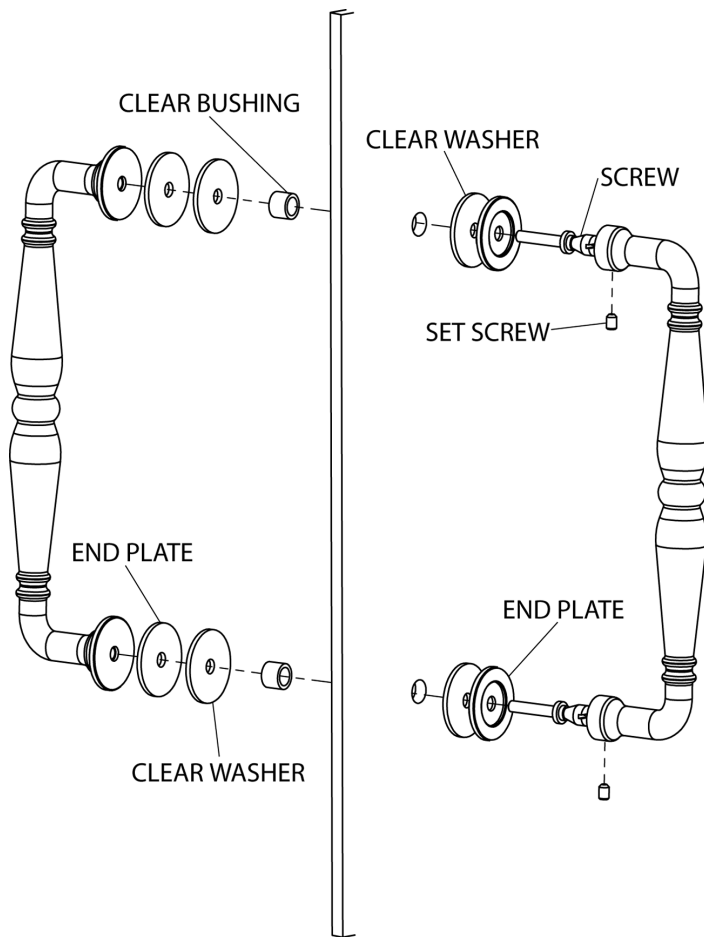

# Installing Towel Bars:

Assemble parts as shown. Screw the threaded back plate or screw into the towel bar holding the washers, end plates, and gaskets in place. Align other side of towel bar on opposite side of glass and tighten set screws

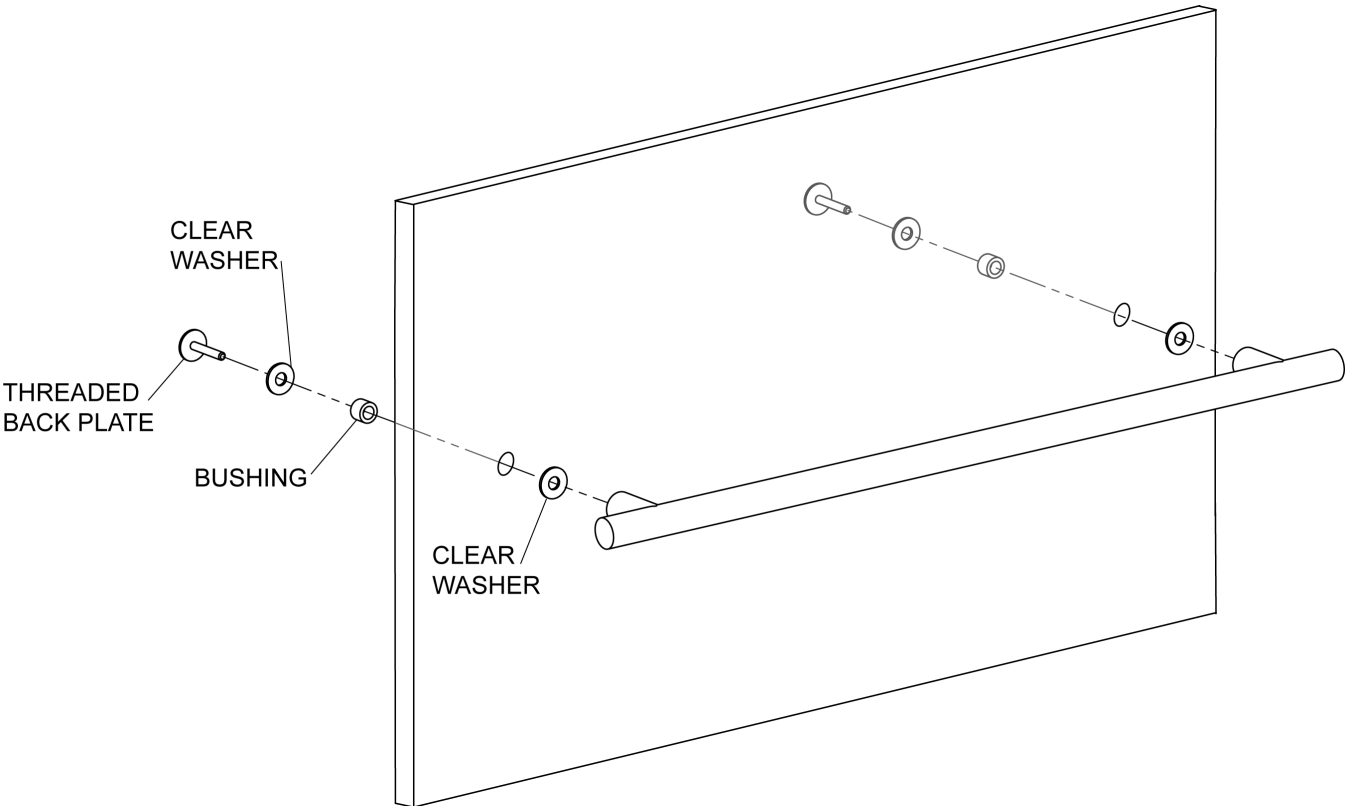
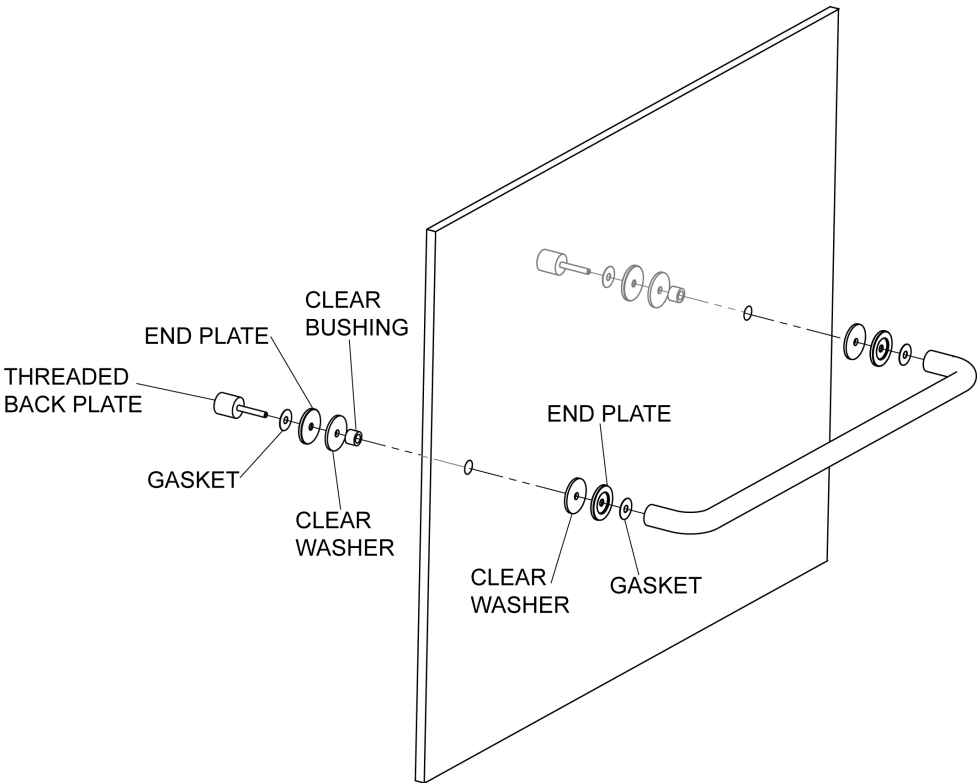

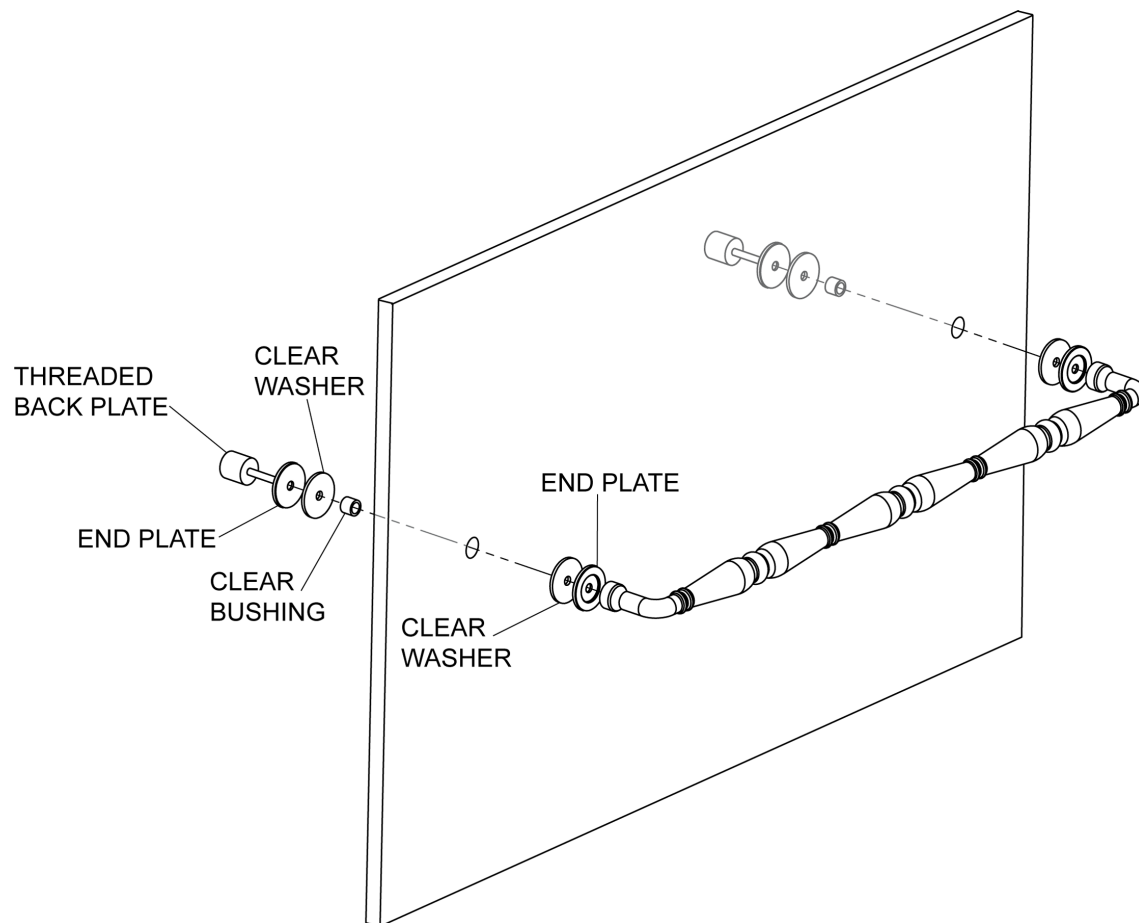

## Installing Combination Towel Bars with Handle:

Assemble parts as shown. Screw washers, end plates, and gaskets into the towel bar through the glass using either a screw or the threaded back plate. Then align the handle on the other side of the glass. Tighten the set screws to hold the handle in place.

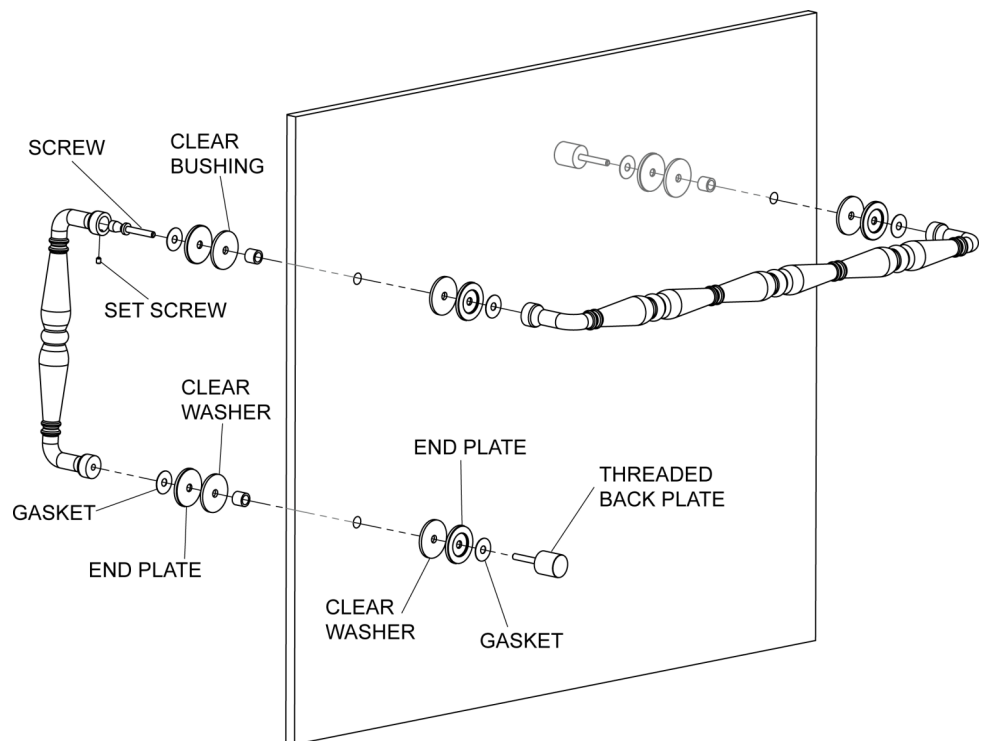
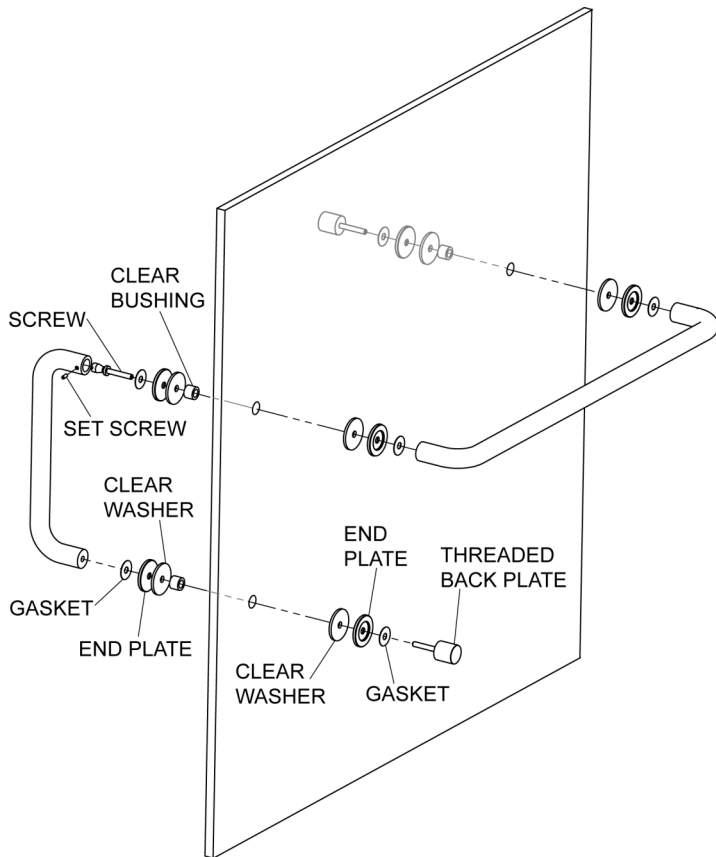

## Installing Knobs:

Assemble parts as shown. Tighten each side of the knob onto the stud or tighten one side with screw and place other side on opposite side of glass and tighten with set screws.

