

FRAMELESS FIXED PANEL SLIDER WITH INLINE PANEL

QCI-5152



FIXED PANEL SLIDER WITH INLINE PANEL

Parts List

ITEM NO.	PART NUMBER	DESCRIPTION	QTY.
1	SC893	1" HEADER, TUBE	1
2	SC938	U-CHANNEL (HORIZONTAL)	1
3	SC938	U-CHANNEL (VERTICAL)	1
4	SC938	U-CHANNEL (VERTICAL)	1
5	SC892	FILLER	1
6	SCV917	3/8" VINYL, SEAL	2
7	SCV912	3/8" VINYL, DRIP	1
8	BK6J-000BS	WALL MOUNT HEADER BRACKET	2
9	GC6AU-000BS	CLAMP WITH ANTI-JUMPER	1
10	GC6AT-000BS	CLAMP WITH ANTI-JUMPER AND STOPPER	1
11	RO6AU-090SS	ROLLER ASSEMBLY WITH STOPPER PIN	1
12	RO6AU-090SS	ROLLER ASSEMBLY	1
13	GU9AD-000PS	GUIDE	1
14	TB6C-018SS	18" PULL/KNOB or BACK TO BACK KNOB	1
**	SC4295	1/8" BUMPER	3
**	SC4296	1/4" BUMPER	3
15	SC4106	PLASTIC WALL PLUG	20
16**	--	ALCOHOL PAD	2
17	SCR09SV	#8 X 1 1/2 STRIKE JAMB SCREW	20
18**	SCV924	1/16 SETTING BLOCK	10
19	SCV925	1/8 SETTING BLOCK	10

NOTE: Not every part in parts pak will be used

** Part not shown.

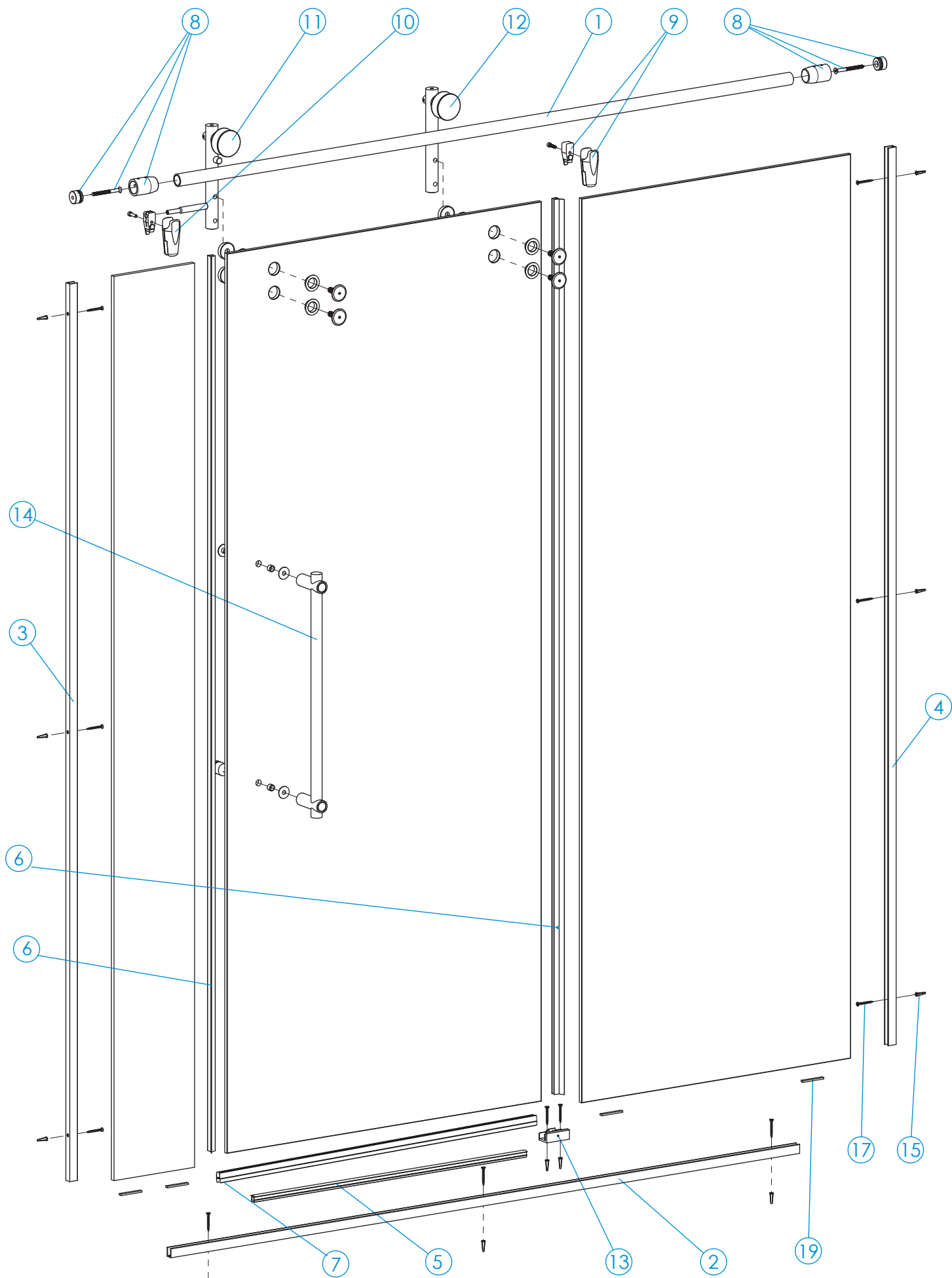

Tools:

To install your New Shower Enclosure, you may need the following:

- | | | |
|---------------------------|--------------------------|------------------------|
| ? Pencil | ? Drill | ? Hack Saw |
| ? Low Tack Tape | ? 1/8" & 3/16" Drill Bit | ? Caulk Gun |
| ? Tape Measure | ? Center Punch | ? Clear Silicone Caulk |
| ? 4' & 6' Levels | ? Files | ? Suction Cups |
| ? #2 Phillips Screwdriver | | |

Safety Notes:

- ? This unit is best installed by two people.
- ? Handle the glass panels carefully and protect the edges. Safety tempered glass is very resistant to breakage, but the sharp corners of the panels can damage tile and flooring surfaces.
- ? The glass can break if unequal pressure is applied during installation.
- ? Please wear safety glasses whenever drilling or cutting. When drilling holes in ceramic tile or marble, use a center punch and hammer to carefully break the glazed surface to prevent skidding when drilling.

NOTE: Tempered glass cannot be cut.

Installation Notes:

- ? Proper blocking is required for every Heavy Glass unit prior to installation. At minimum 2x4 blocking is required at the location of any structural member of the unit including, but not limited to: hinges, clamps, and header brackets. All fasteners at these locations are required to be installed into the blocking.
- ? A minimum of 1 1/4" thread engagement is required of all fasteners into the blocking at these locations. Depending on the application the customer maybe required to supply the proper fasteners to ensure adequate engagement.
- ? U-Channel maybe installed using wall plugs where no backing is found.
- ? Use caution to not pierce plumbing or electric lines while installing door hardware.
- ? Cover the drain with tape prior to installation to prevent loss of small parts.
- ? Unpack your unit carefully and inspect for freight damage. Lay out and identify all parts using the instruction sheet as a reference. Before discarding the carton, check to see that no small hardware parts have fallen to the bottom of the box. If any parts are damaged or missing, refer to the description noted in the instructions when contacting your dealer for replacements.

Maintenance:

Two primary materials are used to manufacture your new shower enclosure: tempered glass and anodized aluminum. To assure a long lasting finish on the enclosure, wipe it down with a towel after each use.

For occasional, more concentrated cleaning efforts, we find that Lysol® Non -Abrasive Bathroom Cleaner works extremely well. Be sure that any over spray falling on the aluminum frame is rinsed thoroughly and dried. Many over -the-counter cleaners, if applied to the aluminum and left on, will harm the metal finish and cause permanent damage even though their directions indicate safe use on shower doors. Never use a scouring agent to clean the aluminum.

For units with AquaglideXP please use Maintain spray from the maintenance on the glass. Please contact customer service for details and to purchase the maintenance kit.

1 If a continuous unit centerline does not exist from the original measuring process, it will be necessary to create one. Lightly mark a continuous unit centerline on the threshold. Next, mark a continuous unit centerline on each wall, starting where the threshold centerline meets the wall. Use a level to ensure the wall centerline is plumb and straight. The wall centerlines should be a minimum of the unit height from the threshold.

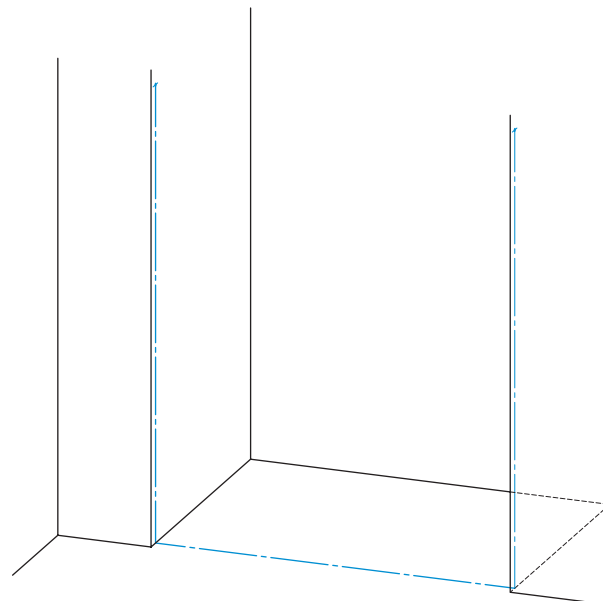

Note: It is extremely important the unit centerline is continuous and straight to ensure proper installation.

2 Use a level to check the threshold for out of level conditions if the original measured conditions are not available. If no conditions exist, measure up each wall centerline a distance of $\text{Unit Height} - 1/2"$ from the threshold, and clearly mark each location.

Note: $\text{Header Mount Hole} = \text{Unit Height} - 1/2"$, or $\text{Panel Glass Height} + 1 11/16"$

Next, drill a $3/16"$ diameter hole, approximately 3" deep, at each wall location. If out of level conditions exist; measure up the "high" side wall centerline a distance of $\text{Unit Height} - 1/2"$ from the threshold and clearly mark this location. For the wall centerline distance on the "low" side of the threshold, use a level to determine the threshold out of level distance and add that value to the equation $\text{Unit Height} - 1/2"$. Measure this summed distance up the "low" side wall centerline from the threshold and clearly mark this location. Next drill a $3/16"$ diameter hole approximately 3" deep, at each marked wall location. (See illustration example.)

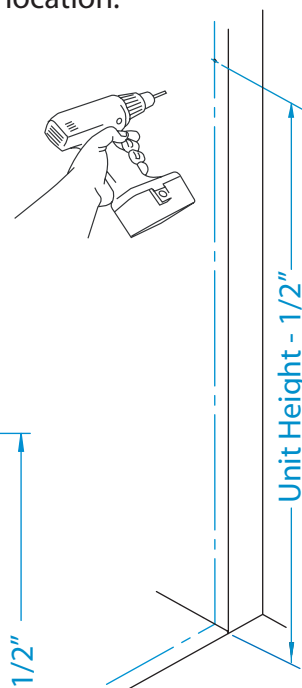

****IMPORTANT****

Keep both holes in-line to ensure the header mounts level.

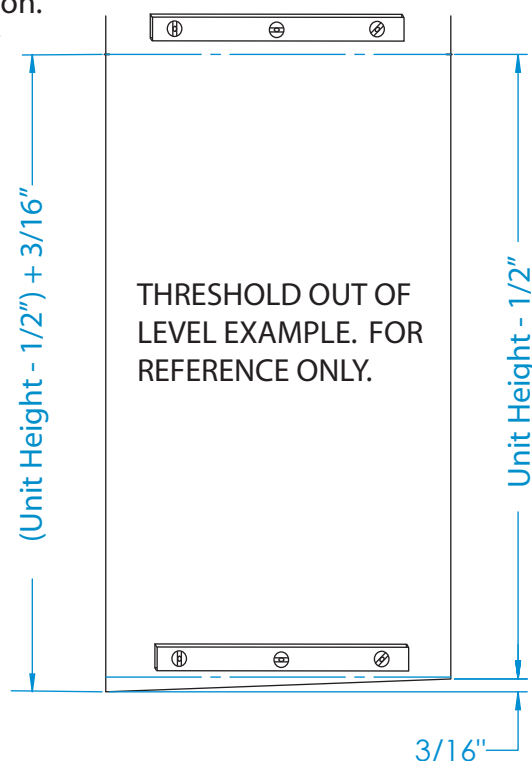

3 Verify that the U-channel [2] is cut to the appropriate size. This piece of U-channel will be equal to the opening width.

Next, drill three 3/16" diameter holes in the center of U-channel [2] (centerline groove provided for convenience), two holes approximately 2-1/2" from each end and one in the middle. Place the U-channel in its correct position with the u-channel centerline over the threshold centerline as marked in step one. With a pencil, carefully mark each hole position on the threshold centerline. Remove the u-channel and drill a 3/16" diameter hole, approximately 1" deep, directly on the threshold centerline at the marked locations.

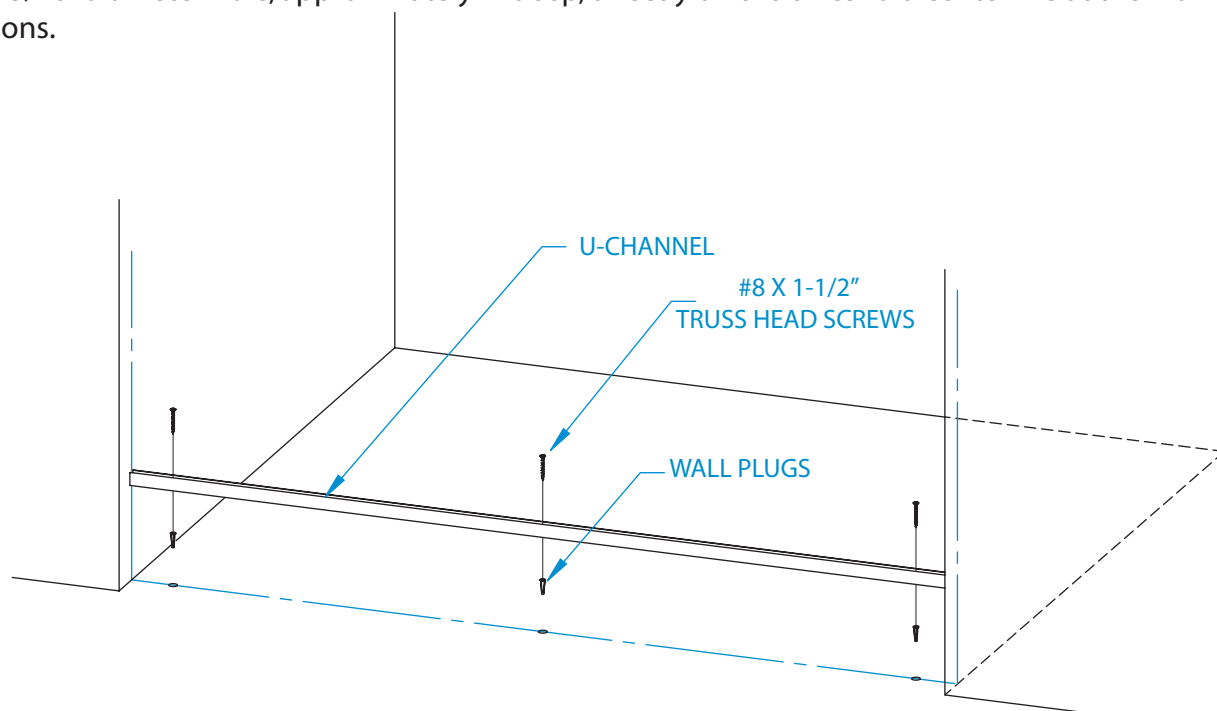

4 Insert a small amount of silicone into each drilled hole and insert a wall plug [15] into each hole. This must be done just before the U-channel installation. Carefully cut the heads off the wall plugs with a razor blade so there is nothing raised above the surface of the threshold. Place U-channel in correct position and secure it with #8 x 1-1/2" truss head screws [17].

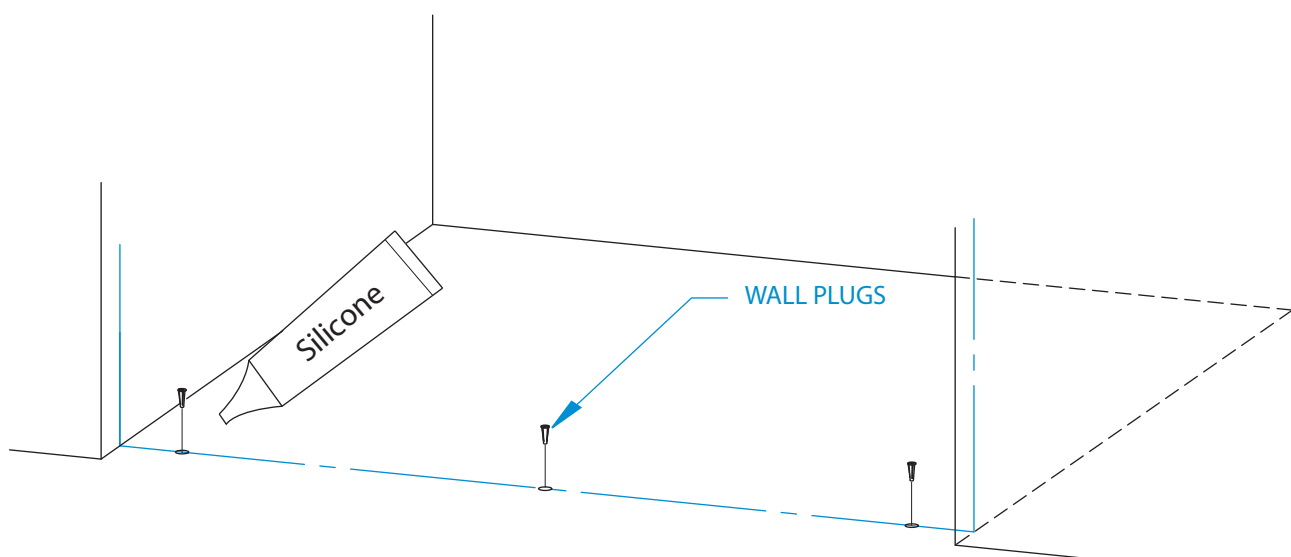

Note: Do not overtighten screws

5 Verify that the U-channels [3 & 4] are cut properly using the below formulas:

$$U\text{-channel Height} = \text{Unit Height} - 2\frac{3}{4}"$$

or

$$U\text{-channel Height} = \text{Panel Glass Height} - \frac{9}{16}"$$

Note: If out of level conditions exist be sure to use the longer U-channel on the appropriate side (see illustration).

Next, drill three $\frac{3}{16}"$ diameter holes in the center of each U-channel (centerline groove provided for convenience); one hole $2\frac{1}{2}"$ from each end and one hole in the middle. Place the U-channels over the wall centerline marked in step one. With a pencil, carefully mark each hole position on the wall centerline. Drill a $\frac{3}{16}"$ diameter hole, approximately 1" deep, directly on the wall centerline at the marked locations.

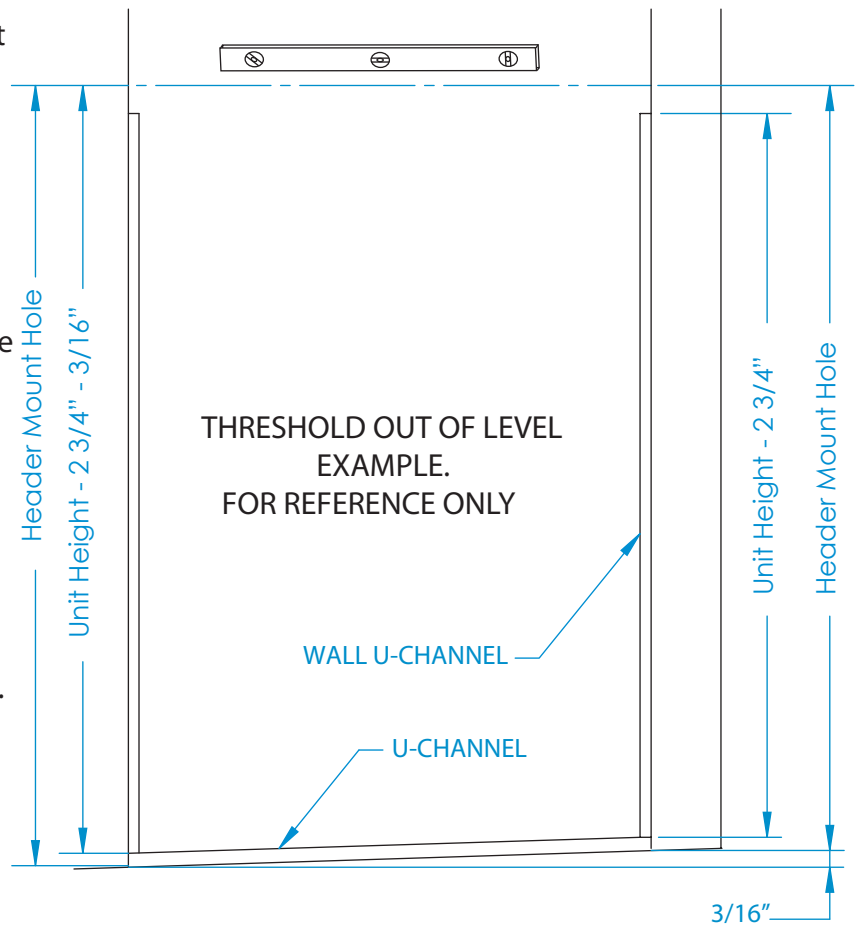

6 Insert a wall plug [15] into each drilled hole. Carefully cut the heads off of the wall plugs with a razor blade so there is nothing raised above the surface of the wall. Place the u-channels [3 & 4] in position and secure it with #8 x 1-1/2" truss head screws [17].

Note: Do not overtighten the screws.

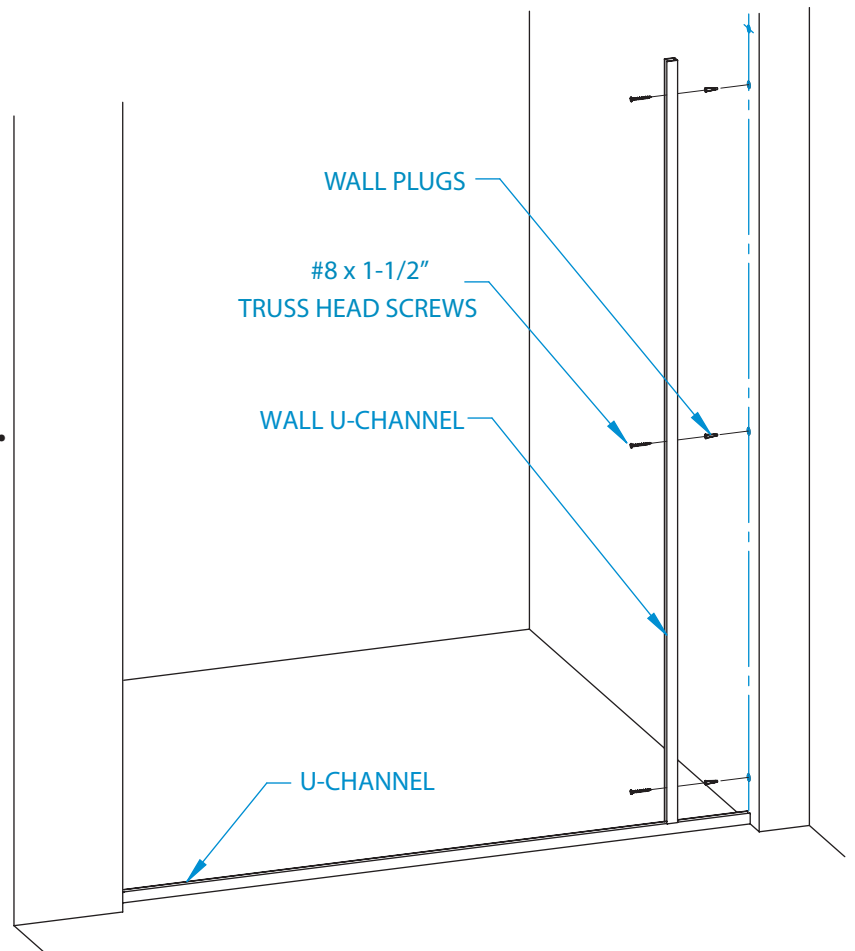

7 Disassemble two Wall Mount Header Brackets [8] by loosening the set screws.

Screw the inner part of the Header Bracket [8] into the wall with the supplied socket countersunk head screw.

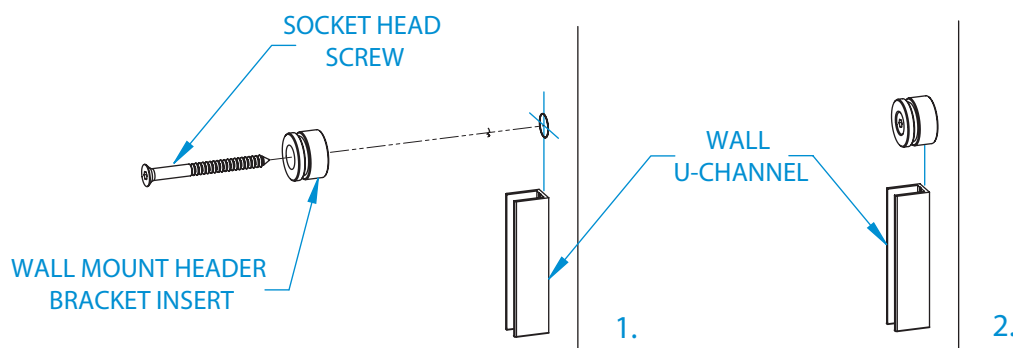
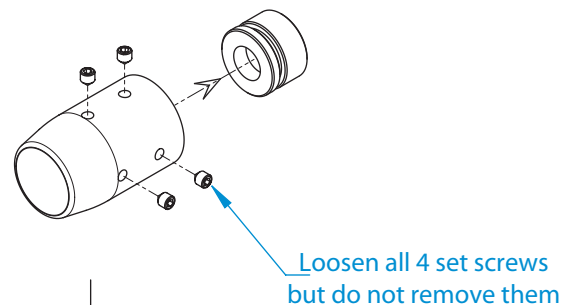

8 Check the size of the Header [1]. It should be equal to the opening size minus 1 1/2" (+/- 1/8" tolerance). Slide the Wall Mount Header Brackets [8] onto both ends of the Header [1], align the Header with the inner part of the Header Brackets [8] mounted to the walls and slide out the Wall Mount Header Brackets [8] (see pictures). Rotate the Wall Mount Header Brackets until the set screws are facing up and inside the shower. Tighten the 4 set screws on each Wall Mount Header Bracket.

Note: The set screws closest to the wall must be tightened first.

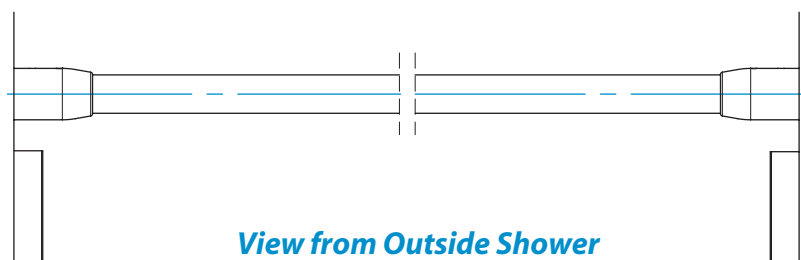
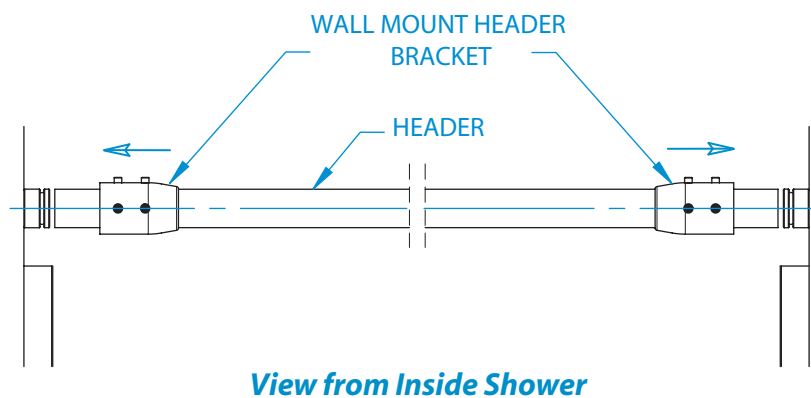
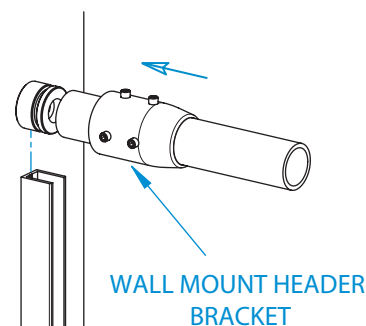

9 Place 1/8" setting blocks [19] into the U-channel as shown or approximately every 18". **DO NOT** place setting blocks over screw heads, but set them close to ensure that the screw heads are below the setting blocks.

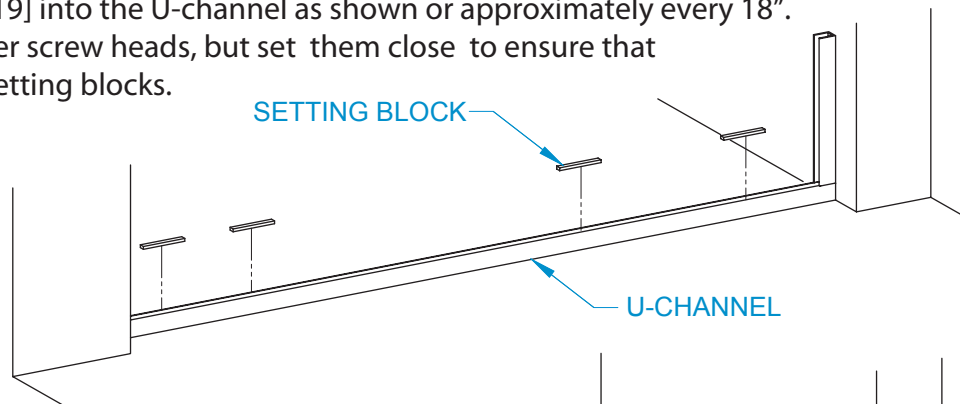

Using suction cups, set the Stationary Glass Panels into the U-channels on the appropriate side. Use different sizes of setting blocks to make exposed edges of the glass level and plumb.** Exposed edges **MUST** be level and plumb before moving to next step.

**Different size setting blocks may be required depending on level conditions. Various sizes of setting blocks are provided and can be used in different combinations (stacked) to obtain the desired result.

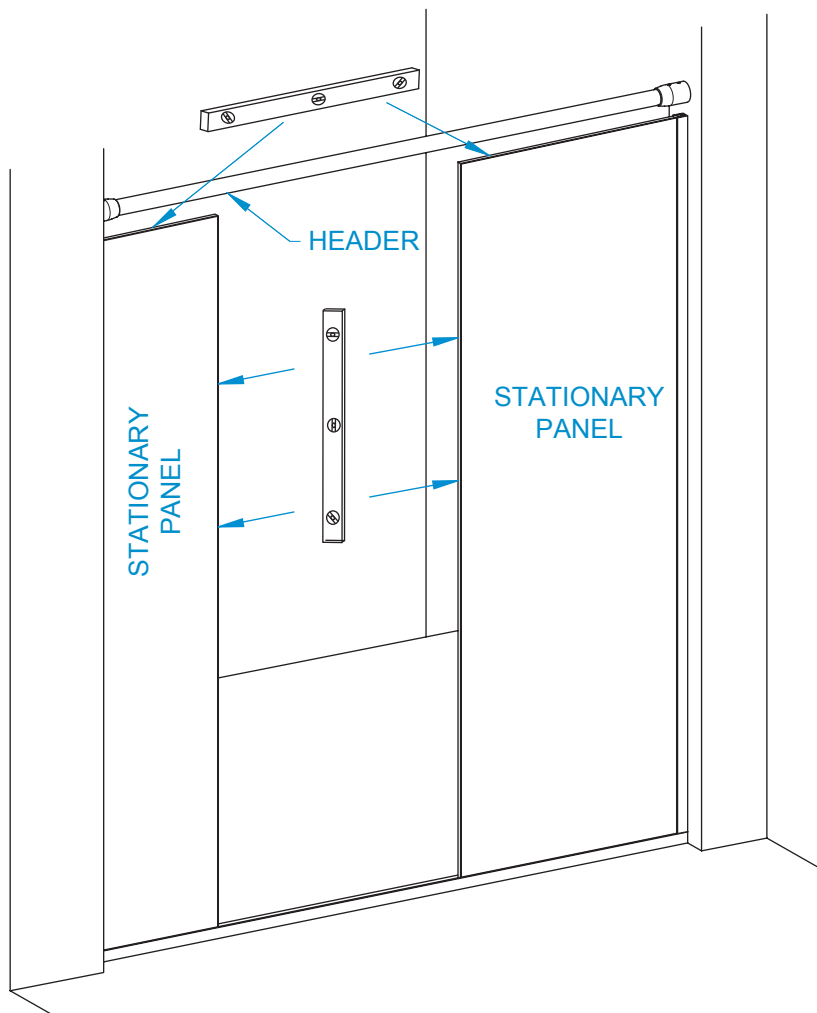

10 Remove the Anti-jumper from the Clamp [9] and loosen the Clamp screw but do not remove it. Remove the Anti-jumper and the Stopper from the Clamp [10] and loosen the Clamp screw but do not remove it.

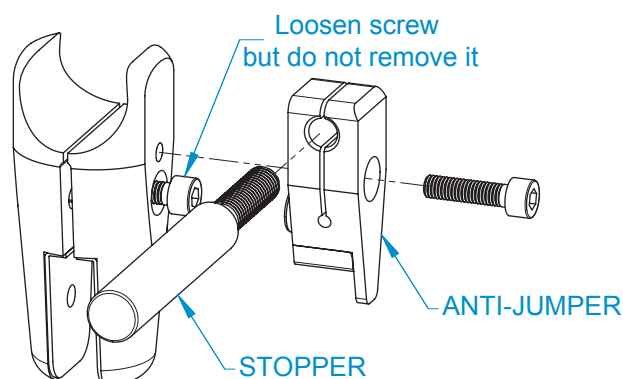
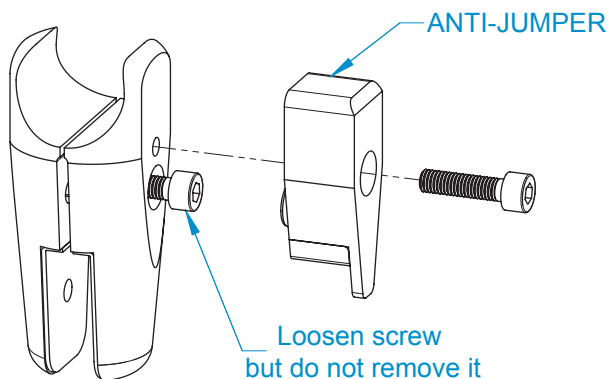

Slide the Clamps [9 & 10] over the glass panels and the Header [1] with the screw on the inside of the shower. Set a distance between the exposed glass edges and the Clamps [9 & 10] equal to 1/4" then tighten the screws.

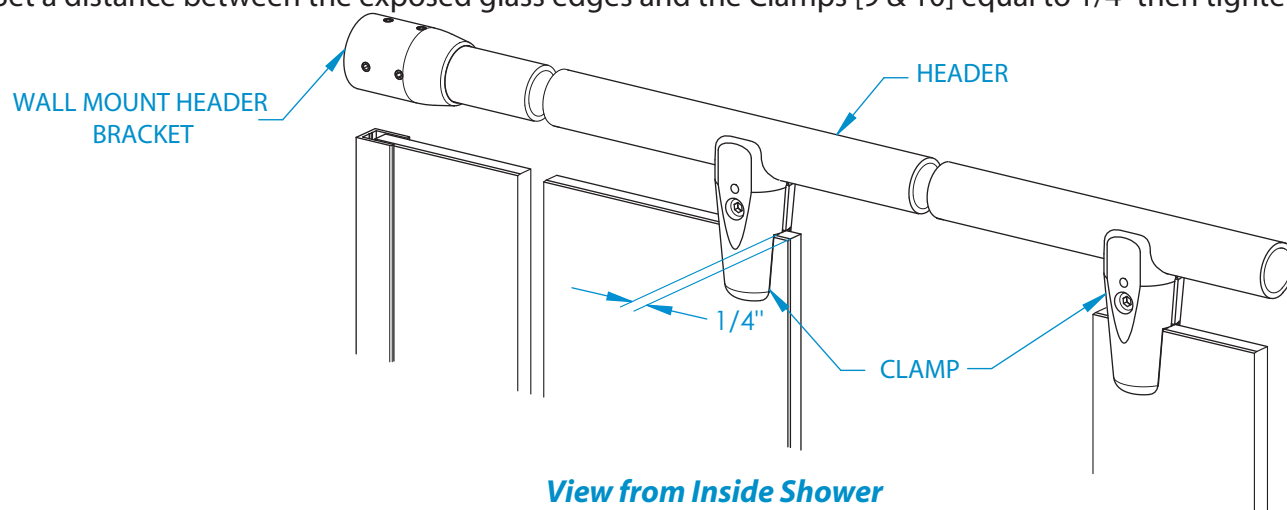

- 11** Take the Roller with Stopper Pin [11] and set the roller cam shaft by loosening a set screw with the 4mm Allen wrench and rotate the cam shaft to set the adjustment hole to horizontal then retighten the set screw. Do the same steps with the Roller [12]. Remove mount bolts and washers before mounting the Roller Assemblies [11/12] to the Door Panel.

Note: The Rollers [9/10] have +/-1/8" height adjustment.

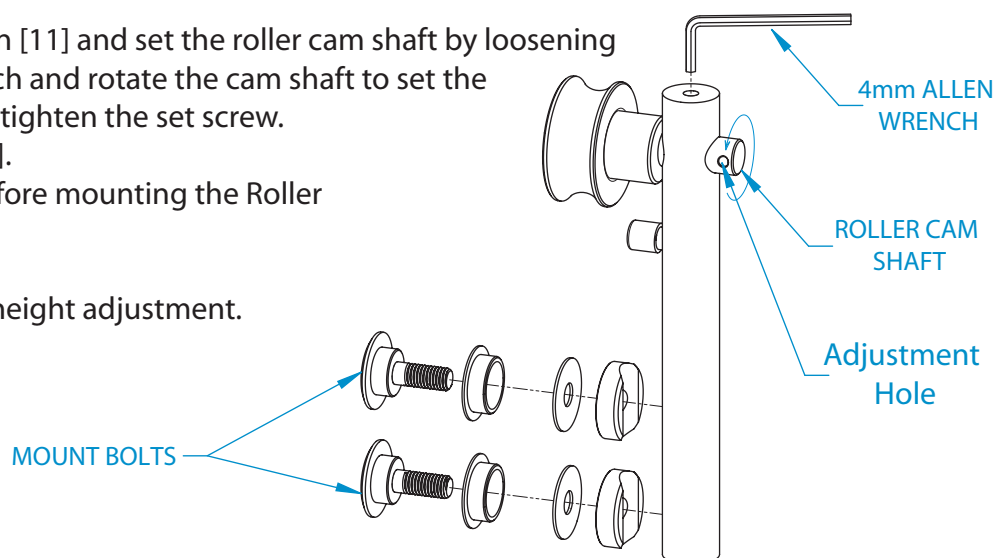

- 12** Mount the Roller Assembly With Stopper Pin [11] to the smaller stationary panel side of the Door Panel with the bolts facing to the outside of the shower. Mount the Roller Assembly [12] to the other side of the Door Panel with the bolts facing to the outside of the shower.

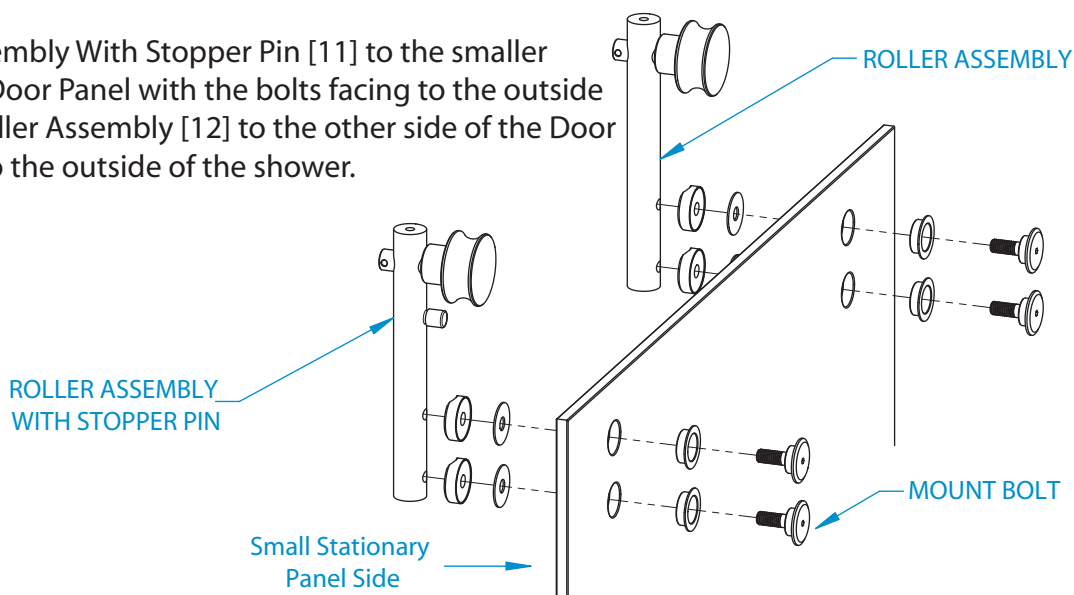

13 Cut the Drip Vinyl [7] to the appropriate size. Place the Drip Vinyl [7] onto the bottom of the door panel. Line it up on the small panel side of the door.

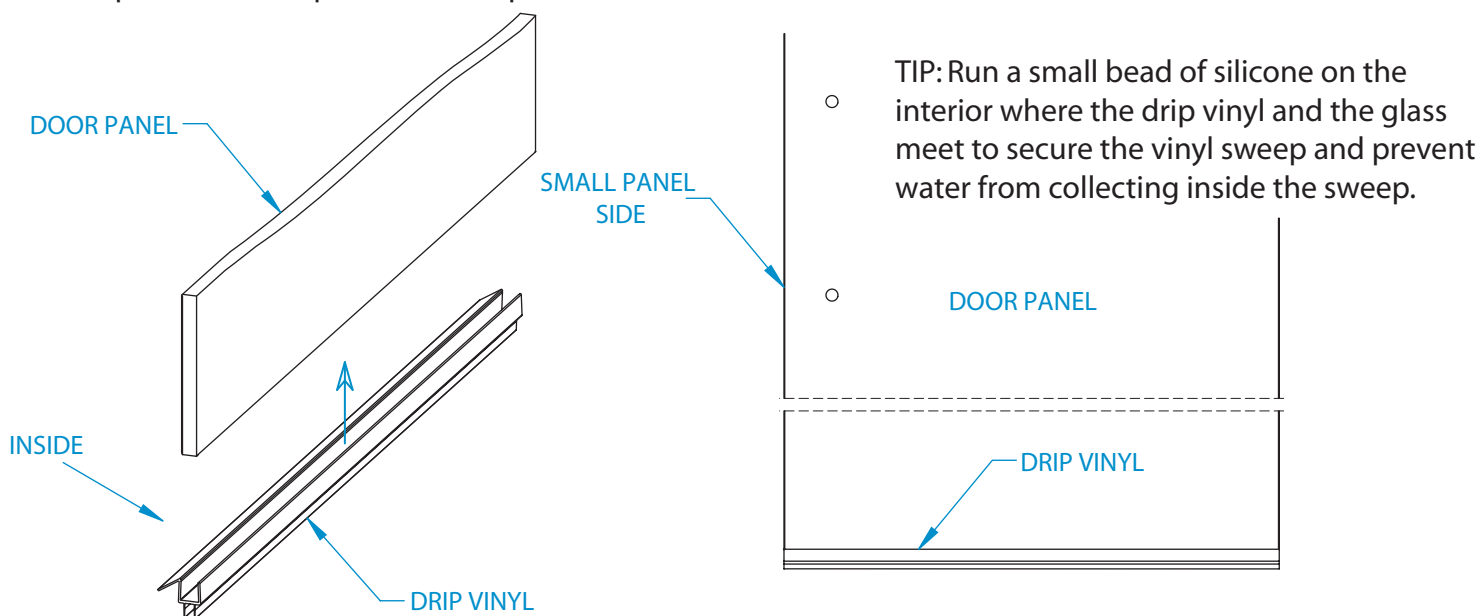

14 Carefully hang the Door Panel with Rollers [11/12] on the Header [1]. Then, if necessary, adjust the Door Panel so the top of the glass is flush with the Stationary Panel by loosening the set screw located on the top of the Roller Assembly with 4mm Allen wrench and rotating the cam shaft.

Note: The Rollers [11 & 12] have $\pm 1/8$ " height adjustment.

Be sure to tighten the set screws before releasing the door.

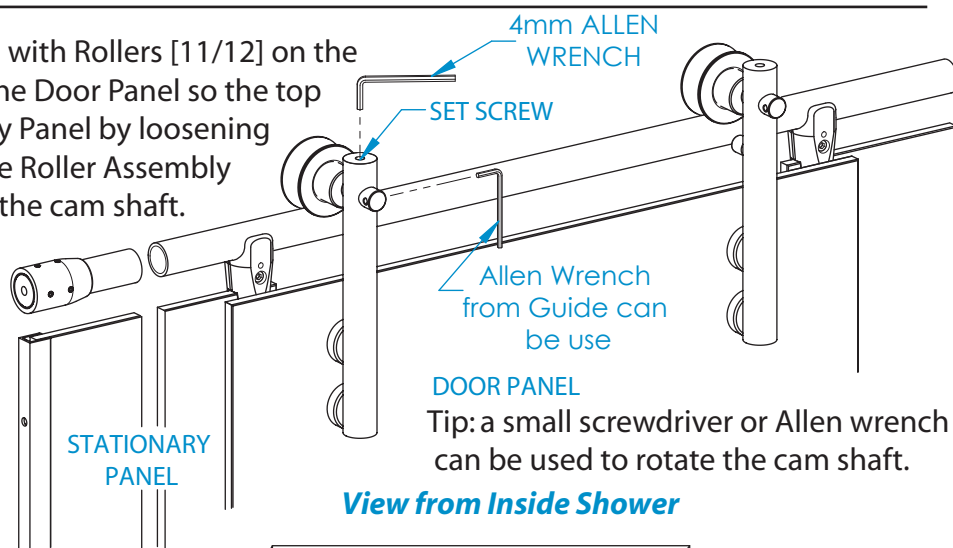

View from Inside Shower

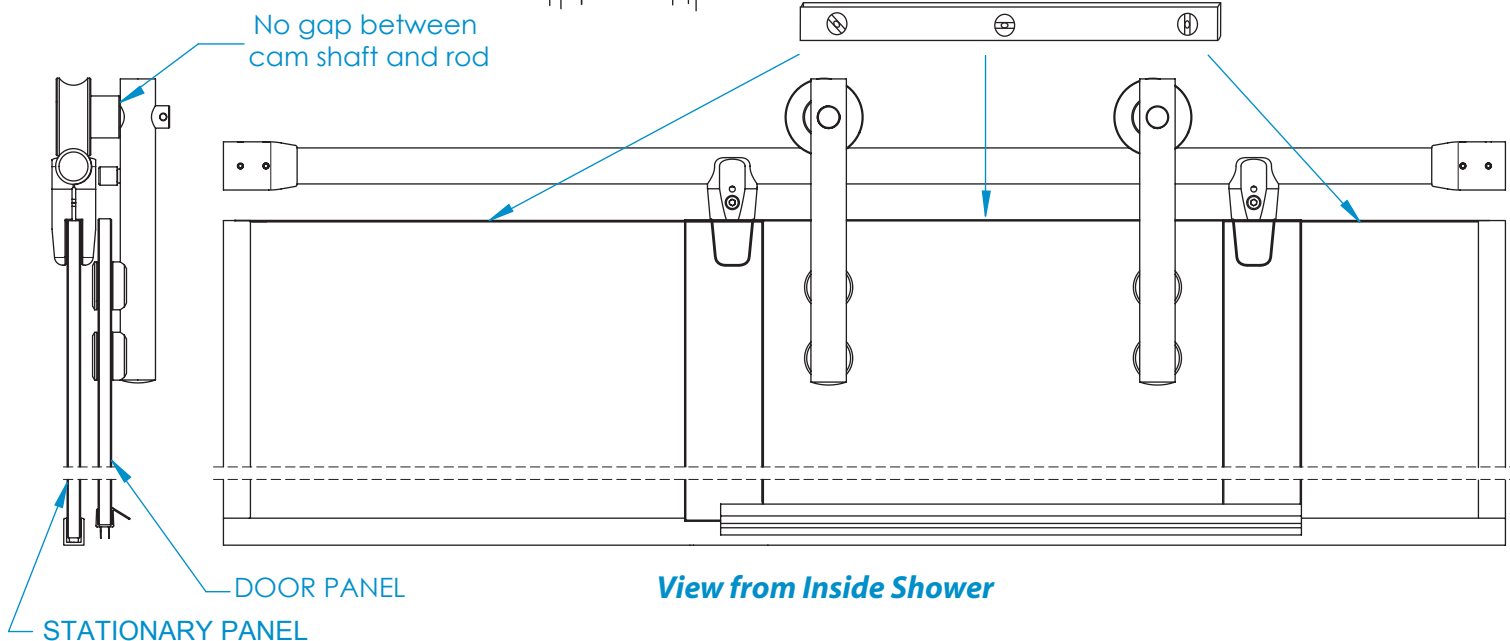

View from Inside Shower

15 Slide the Door Panel to set equal overlap on both Stationary Panels. Remove black plastic insert from the Guide and discard. Place the Guide [13] on the threshold on the side which the Door Panel will be opening with the 1/8" overlap and against the inside face of the U-channel (See Illustration). Place a mark on the threshold. Slide the door out and mark the location of the two mounting holes of the Guide onto the threshold. Next, drill two 3/16" diameter holes at the marked locations. Insert a small amount of silicone into each drilled hole and insert a wall plug into each hole. Carefully cut the heads off of the wall plugs with a razor blade so there is nothing raised above the surface of the threshold. Place Guide [13] in correct position and secure it with #8 x 1-1/2" truss head screws [17].

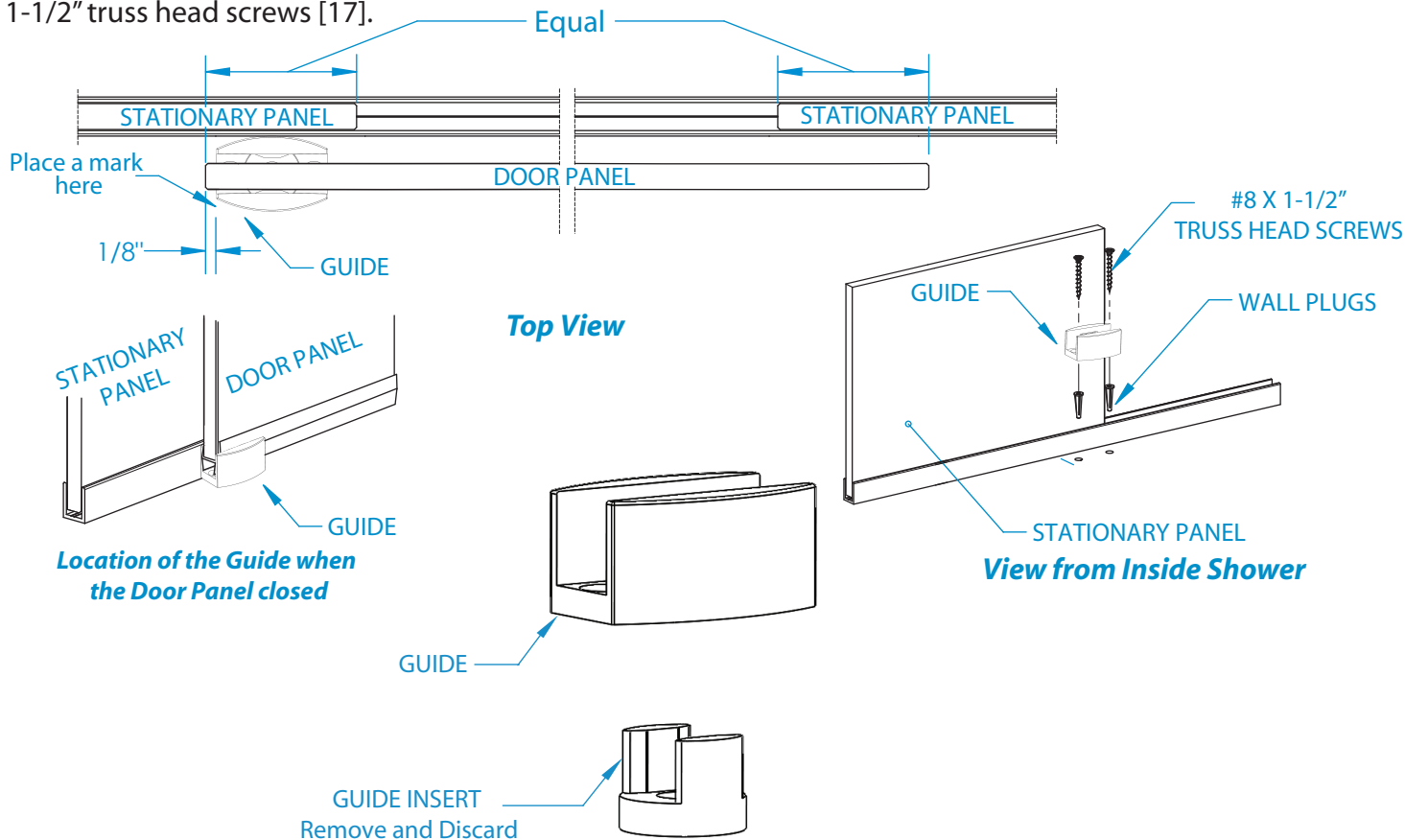

16 Reinstall the Anti-jumper on the Clamp [9] which was removed from the Clamp (see step 10). Reinstall the Anti-jumper and the Stopper on the Clamp [10] which was removed from the Clamp, but do not completely tighten the head cap screw. Adjust the door position by rotating the Stopper, then tighten the screw.

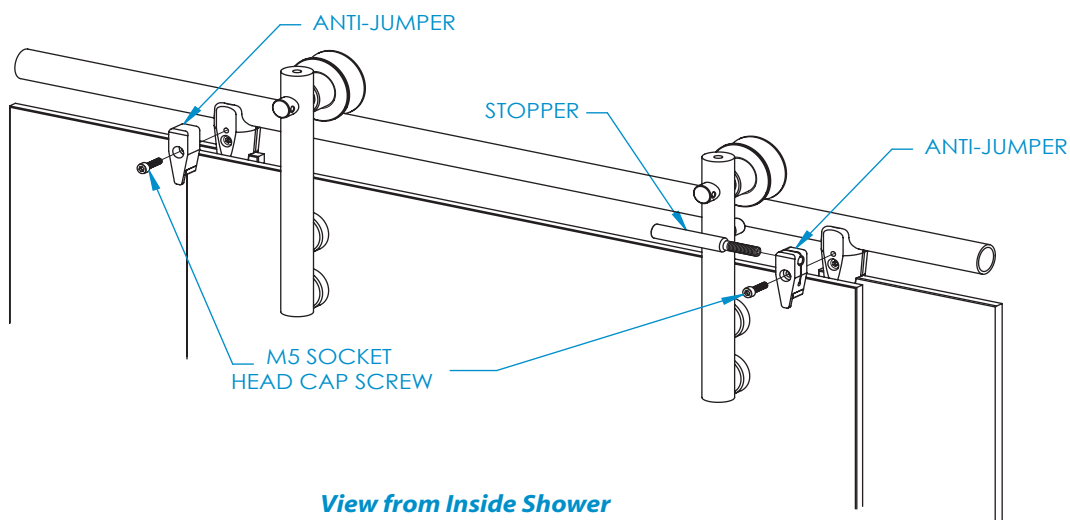

17 Place 18" Pull/Knob [14] or Back to Back Knob [14] on the Door Panel (see pictures).

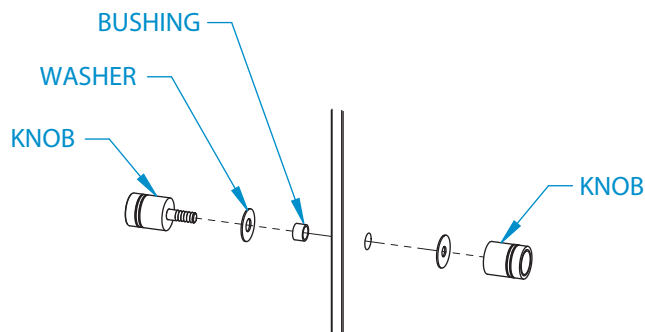

BACK TO BACK KNOB

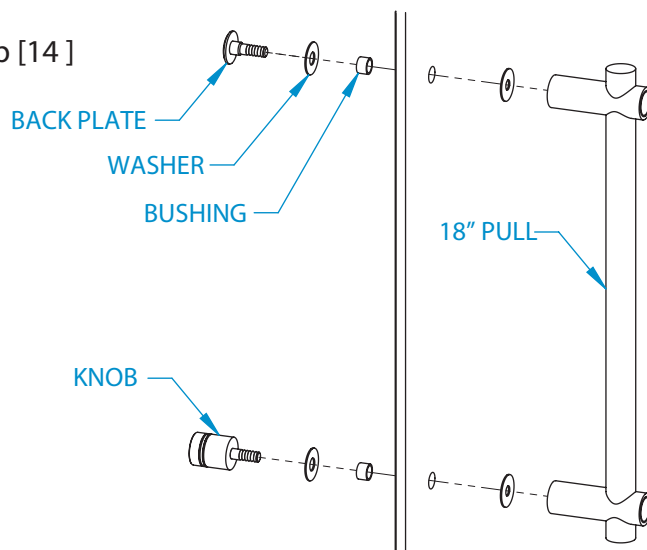

18" PULL/KNOB

18 Measure the distance between the Stationary Panels. Cut the Filler [5] to the measured distance. Run a small bead of silicone along both sides of the Filler [5]. Then, insert the Filler into the U-channel [2] (see illustrations).

Run a small bead of silicone
along these edges.

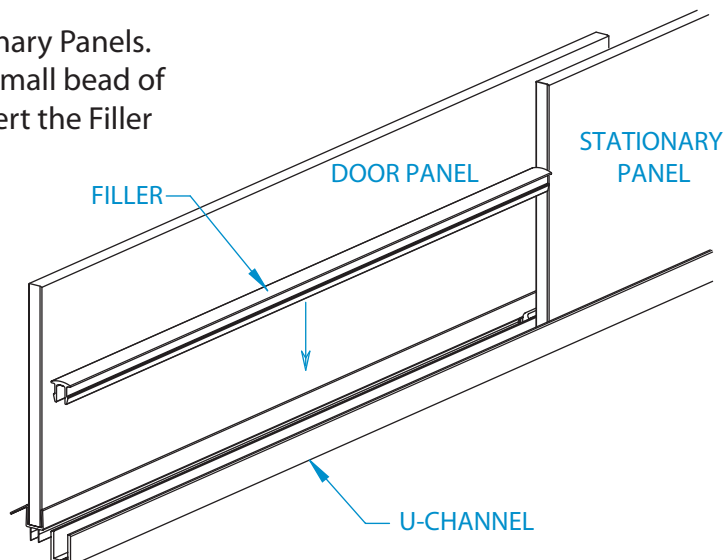
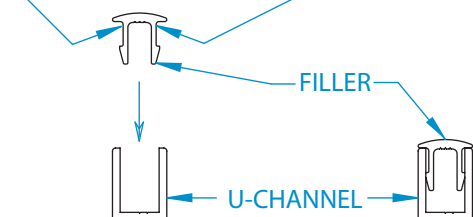

19 Be sure to test full range of door and make sure no interference happens at any point. With the door in its closed position (against the wall) slowly open it fully (until the stopper pin hits the antijump) making sure the handle doesn't hit the fixed panel, and the back end of the glass does not hit the wall.

20 You have the option to use the Vinyl Seal [6] for one or both side of the door. Cut the Vinyl Seal to size equal to the Door Panel height minus 1/2" and place the Vinyl Seal onto the Door Panel with vinyl lip facing to the Stationary Panel.

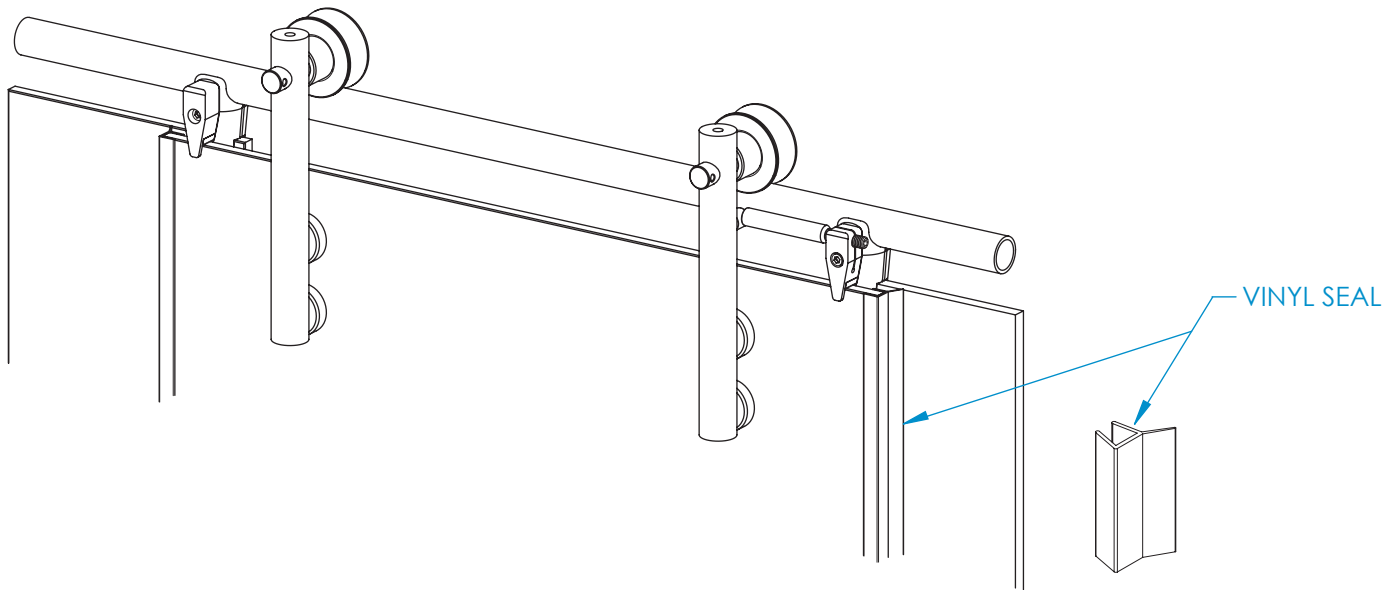

21 On the interior face of the Side Panel, place a strip of low tack tape on the glass about 1/8" to 3/16" away from edge of the u-channel both vertically and horizontally. Run a small bead of silicone along this edge. Finally, on the interior, run a bead of silicone between the u-channel and the threshold and also between the u-channel and the wall. After complete, remove the tape before silicone sets.

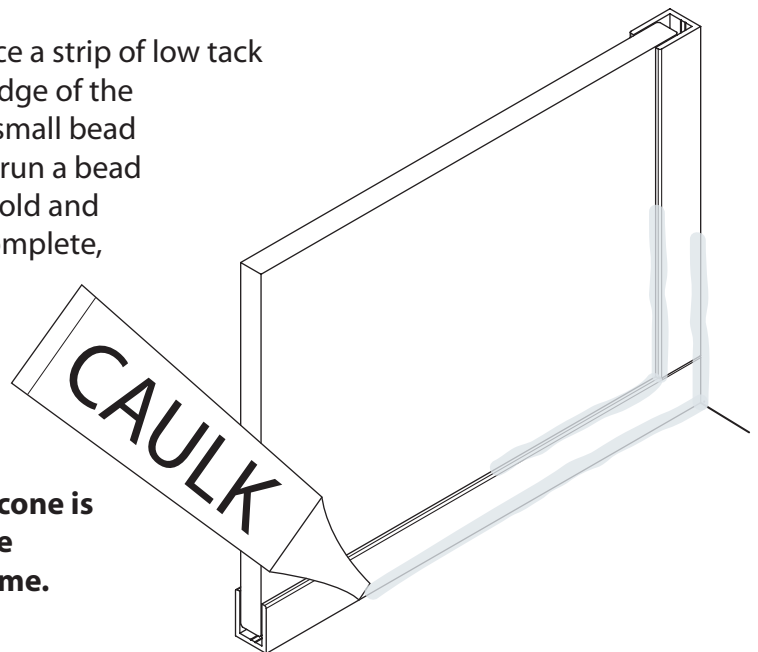

NOTE: DO NOT USE the shower until the silicone is completely cured. Check the tube of silicone for the manufacturer recommended cure time. (typically 24 - 48 hours)