

DRAW, PAINT DESIGN, PLANT

JEFF CHARLESWORTH

**CHARLESWORTH FLEISCHACKER
LANDSCAPE ARCHITECTS**

DRAW, PAINT DESIGN, PLANT

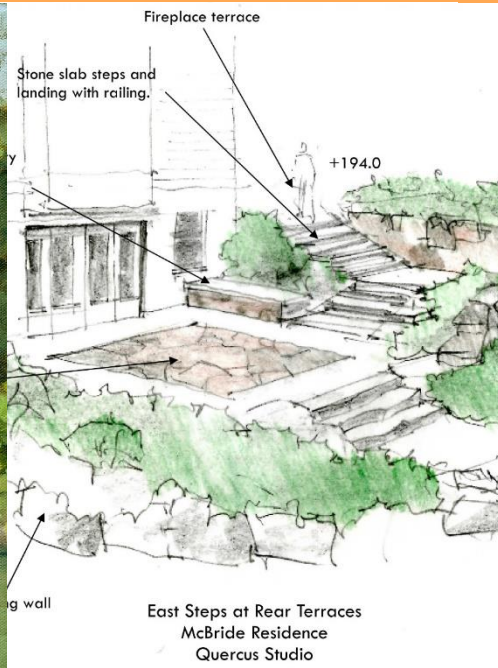
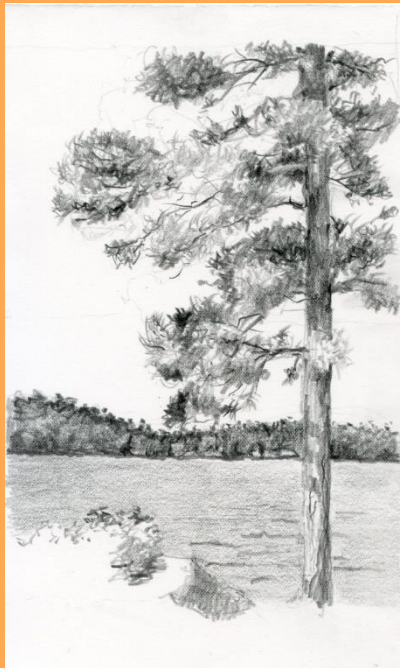

East Steps at Rear Terraces
McBride Residence
Quercus Studio

“Our ability to perceive quality in nature begins, as in art, with the pretty. It expands through successive stages of the beautiful to values as yet uncaptured by language.”

Aldo Leopold

A Sand County Almanac and Sketches Here and There

**DRAW, PAINT
OBSERVE, THINK**

DRAWING TO OBSERVE

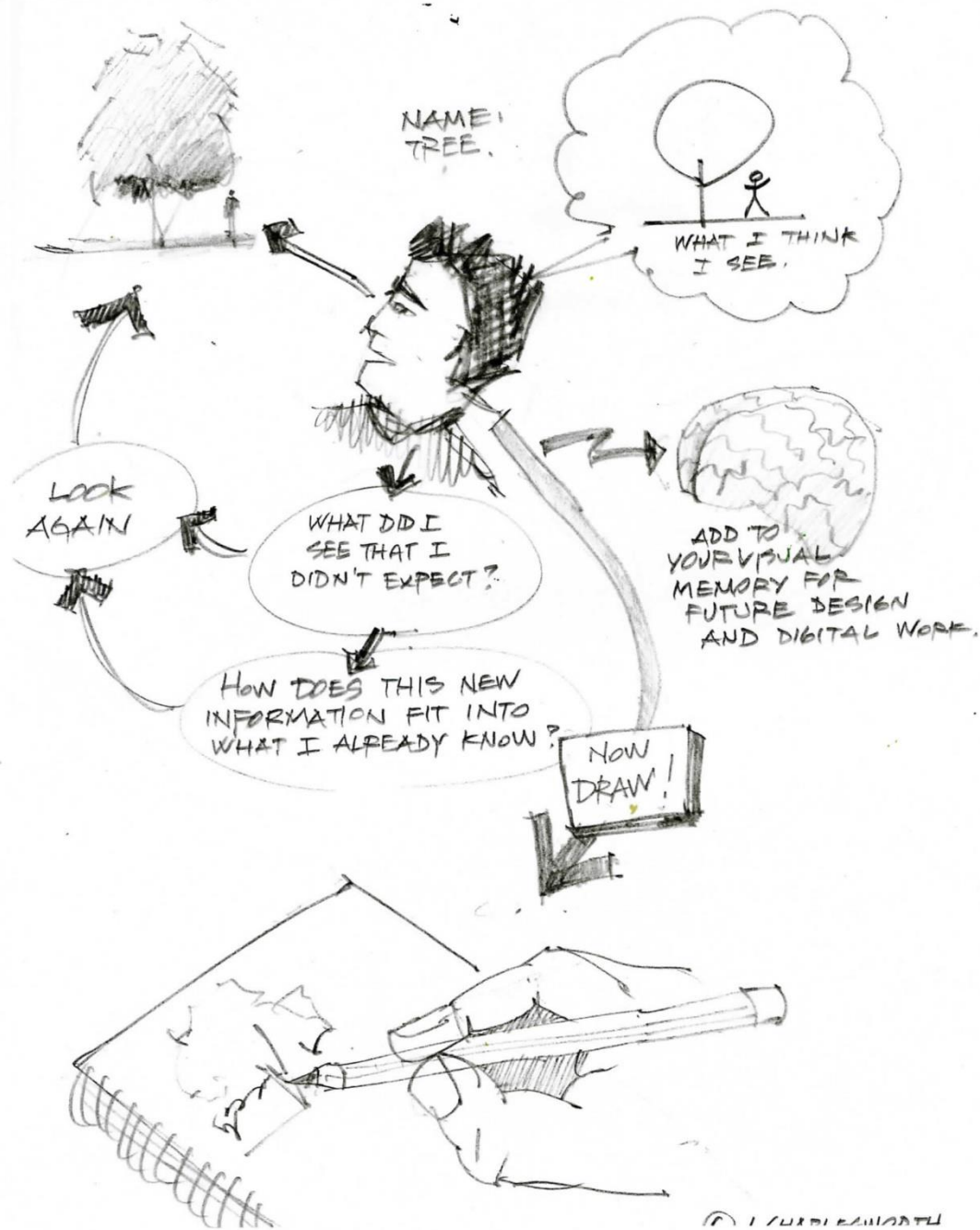



← top edge -
just up stroke w/
pencil to keep
fuzzy edge

• build up layers
of value.

2B + 3B.

gesture of leaves



ASH TREE

locust +
mulberry on
shore.

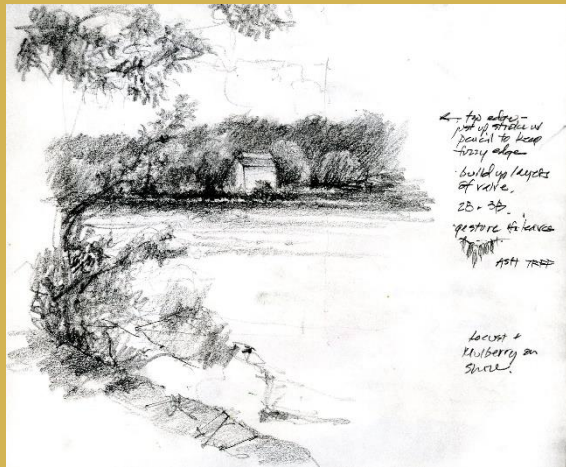

to the above -
put up structure w/
pedestrian to keep
fence edge
build up height
of walk
25-30'
gesture to house
ASTH TRAP

Locust +
Mulberry on
Spice

NEW
HOPE
pedestrian
walkway on
south side
Lamberville
SPICER
North

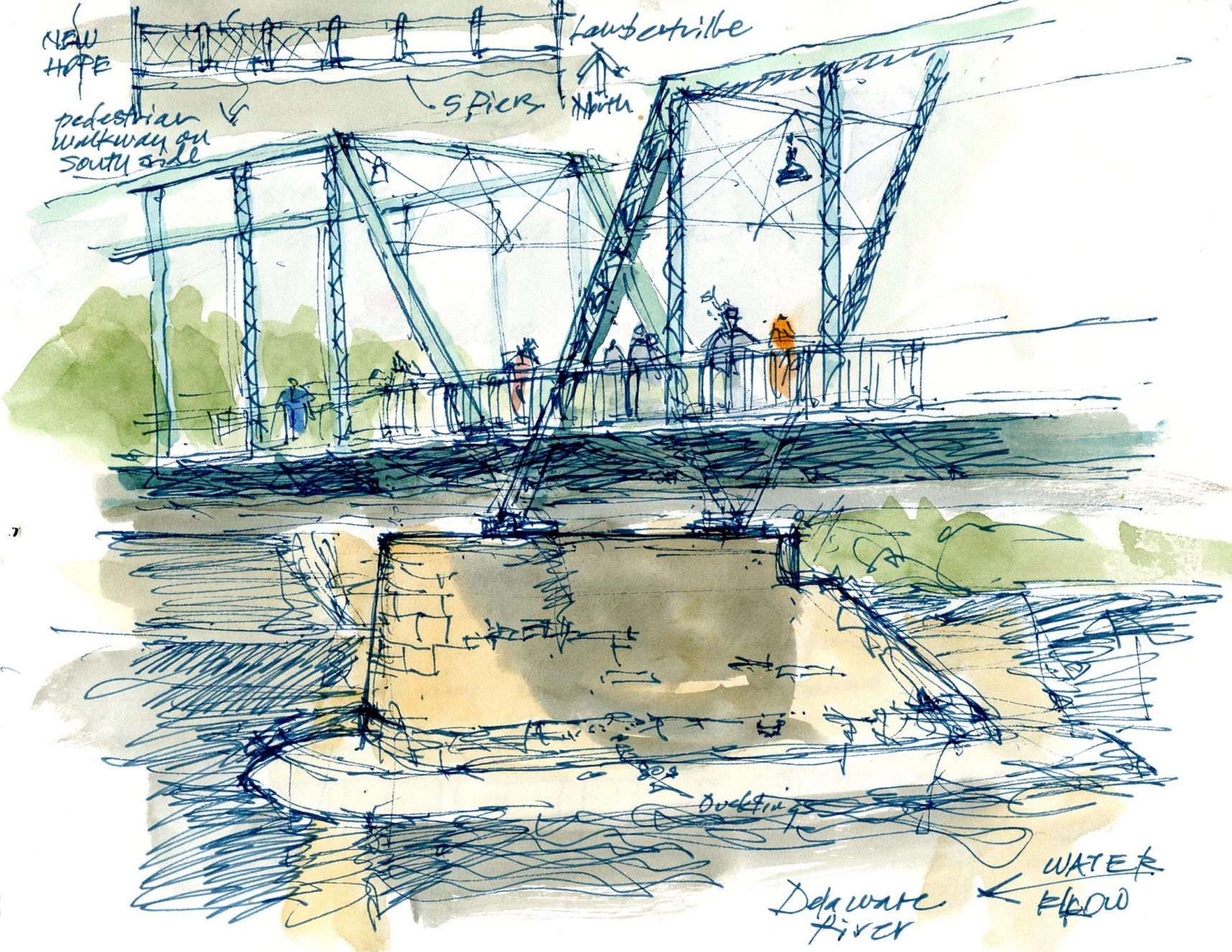

Dedwater
river
WATER
FLOW

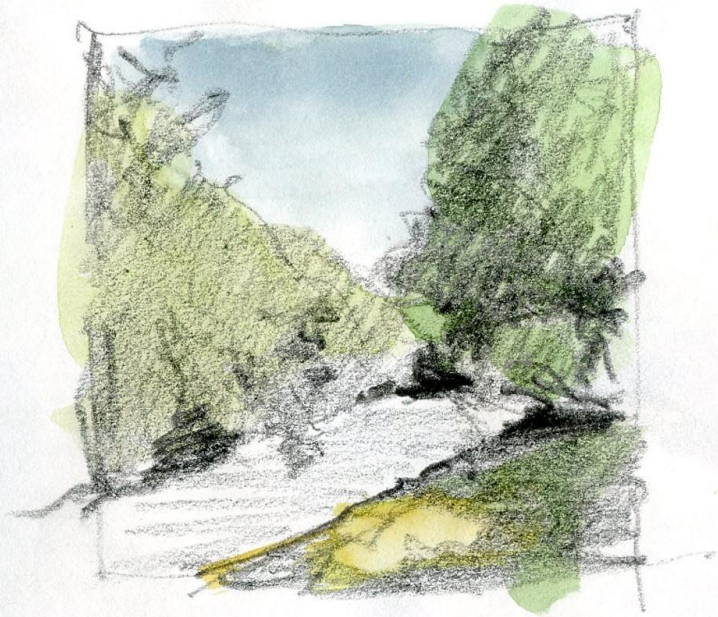
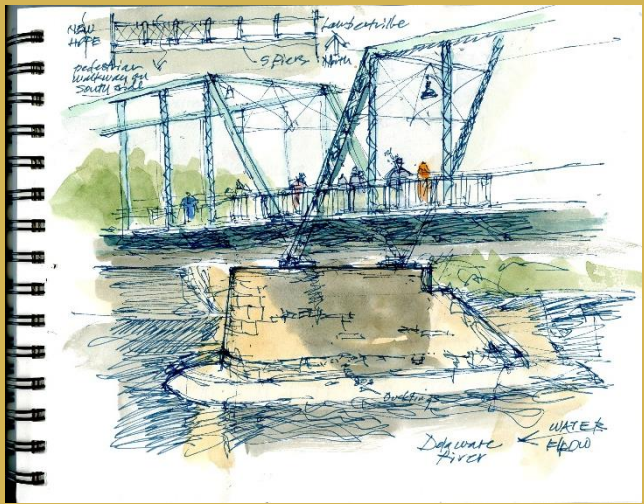

Small blades
on hill side
faint, snow
on roof

less
contrast,

subtle
of building
+ snow
on roof.

strong
contrast
value

blue
purples

purplish grey

blue blue
green

snow

white
warm

blue blue

less
calligraphy

LOOK

gradual
Gold
Frame
3 1/2"

WARM

strong
individual
brush
strokes

blue under
earthy pink
top sky

1/22/2012

yellow sawn
shatched dried leaves
against earthy
red purple
blue green
sky holes
MT.



Warm earthy
yellows
ochre, russet, greys -
detailed brush work
(sense of stems), dried
grasses

George Sotter
The Windy Bush
Valley, 1936
est. 50 x 36"
(48)

contracts w/ broad brush
of snow blue grey as
each drift turns/rolls
away.
snow painted on top
after veg.

f
8.7K

Twitter icon

Pinterest icon

3

Message icon

9

Email icon

Museum 'Bans' Cameras And Asks Guests To Sketch Art Instead

"In today's world of mobile phones and media a visit to a museum is often a passive and superficial experience."



Elyse Wanshel
Trends Writer, The Huffington Post



Posted: 11/23/2015 01:25 PM EST



RIJKSMUSEUM

F



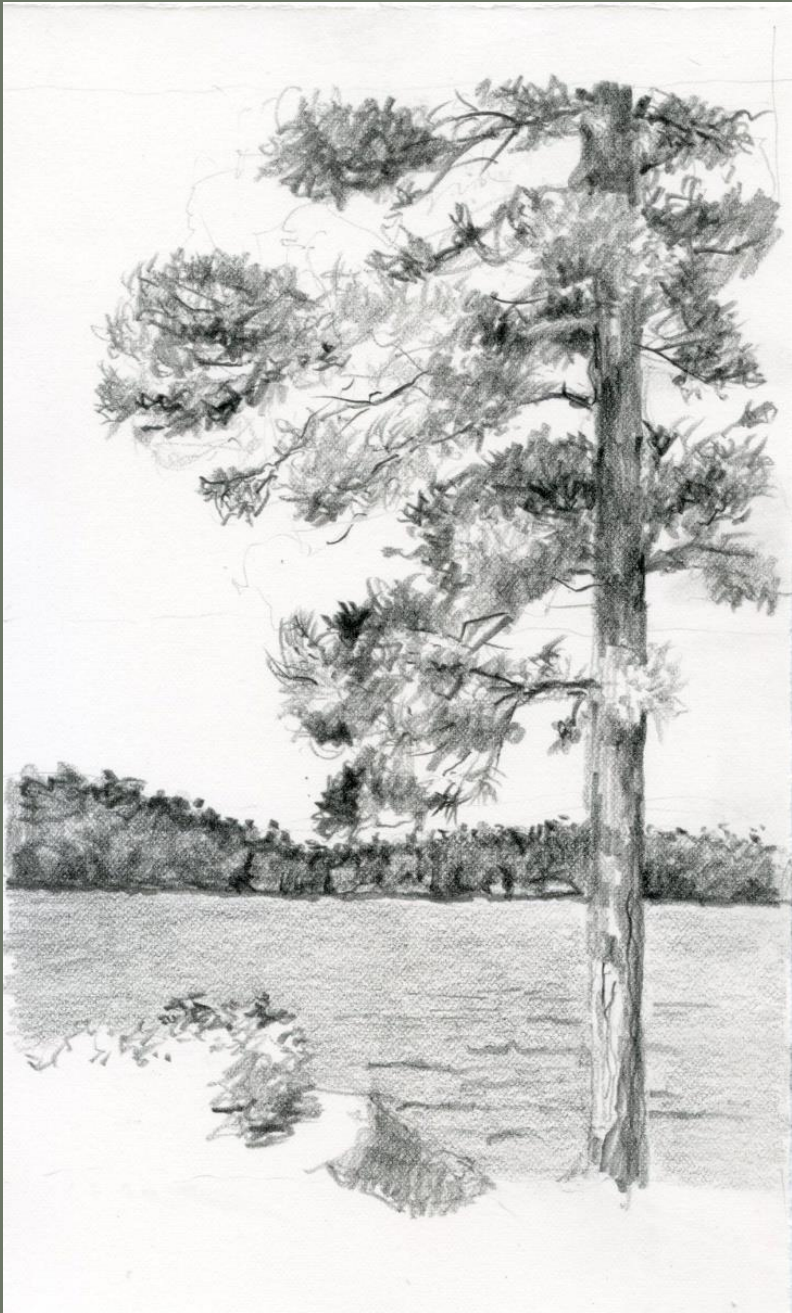

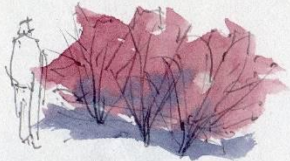

Euroymia alata



Forsythia x intermedia



Fagus sylvatica



SHAGBARK HICKORY

Tree
paper

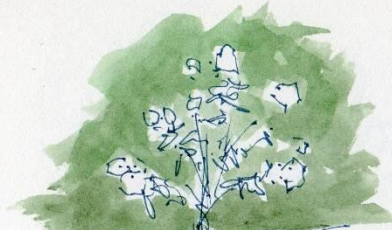

Hydrangea Limelight



Prunus
Cornus Prunus



White oak



Norway Spruce (3)



Trees at edge of field.



7 August 2011

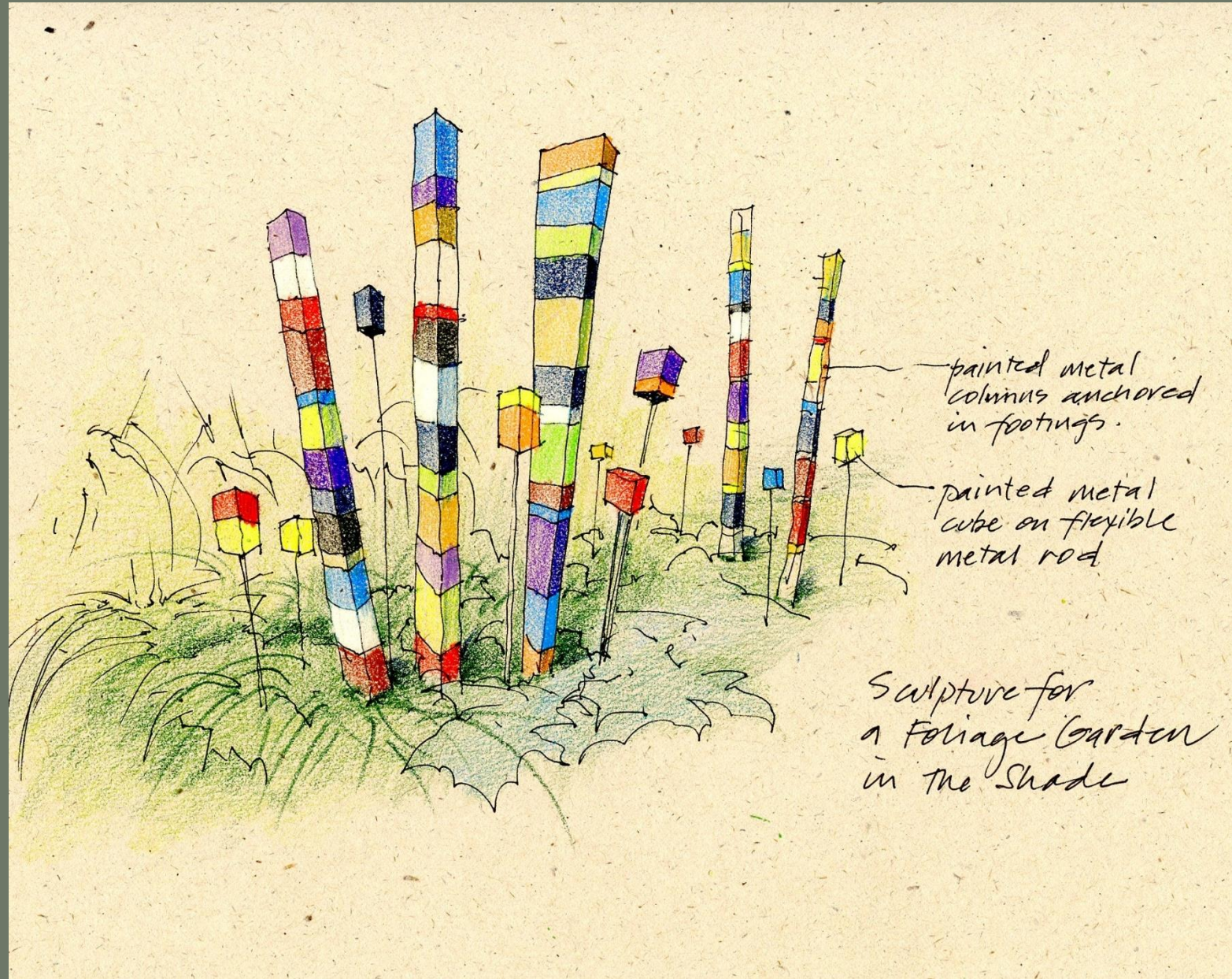

painted metal
columns anchored
in footings.

painted metal
cube on flexible
metal rod

Sculpture for
a Foliage Garden
in the Shade

class - direct source
vs
internet

3.9.14

? www.charlesworthart.com
jeffpaints.com

Abstract fall
garden paintings



white
↓

EARTH COLORS

TITLE	Yellow Ochre	Raw Sienna	Burnt Sienna	Raw Umber	Burnt Umber

RAW UMBER + VARIATIONS

RAW UMBER	+ cad yellow	+ purple	+ cad red	+ green	ultra blue	+ orange

+ white
↓

oil
Vene
inch



9-12
12x16
1-3

winter stream: 1
spring study: 2.



Sandwich
Weeds
Chickory,
grass

4.25.14

$7 \div 9 = .777$
 $7 \div 12 = .583$
 $11 \div 14 = .786$

x 5.2.14

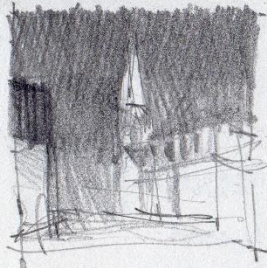

x

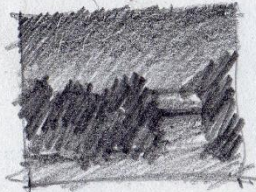
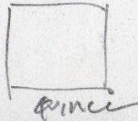

Dusk + rain clouds

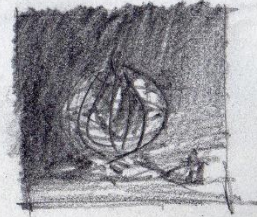

**DRAW, PAINT
TELL A STORY**

GARDENING WITH WATER

HOW JAMES VAN SWEDEN AND WOLFGANG OEHME BUILD AND PLANT FOUNTAINS, SWIMMING POOLS, LILY POOLS, PONDS, & WATER EDGES

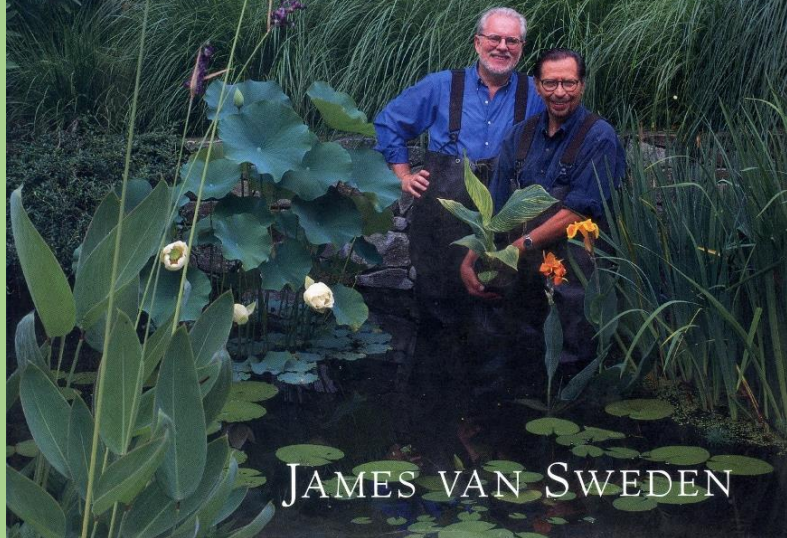

JAMES VAN SWEDEN

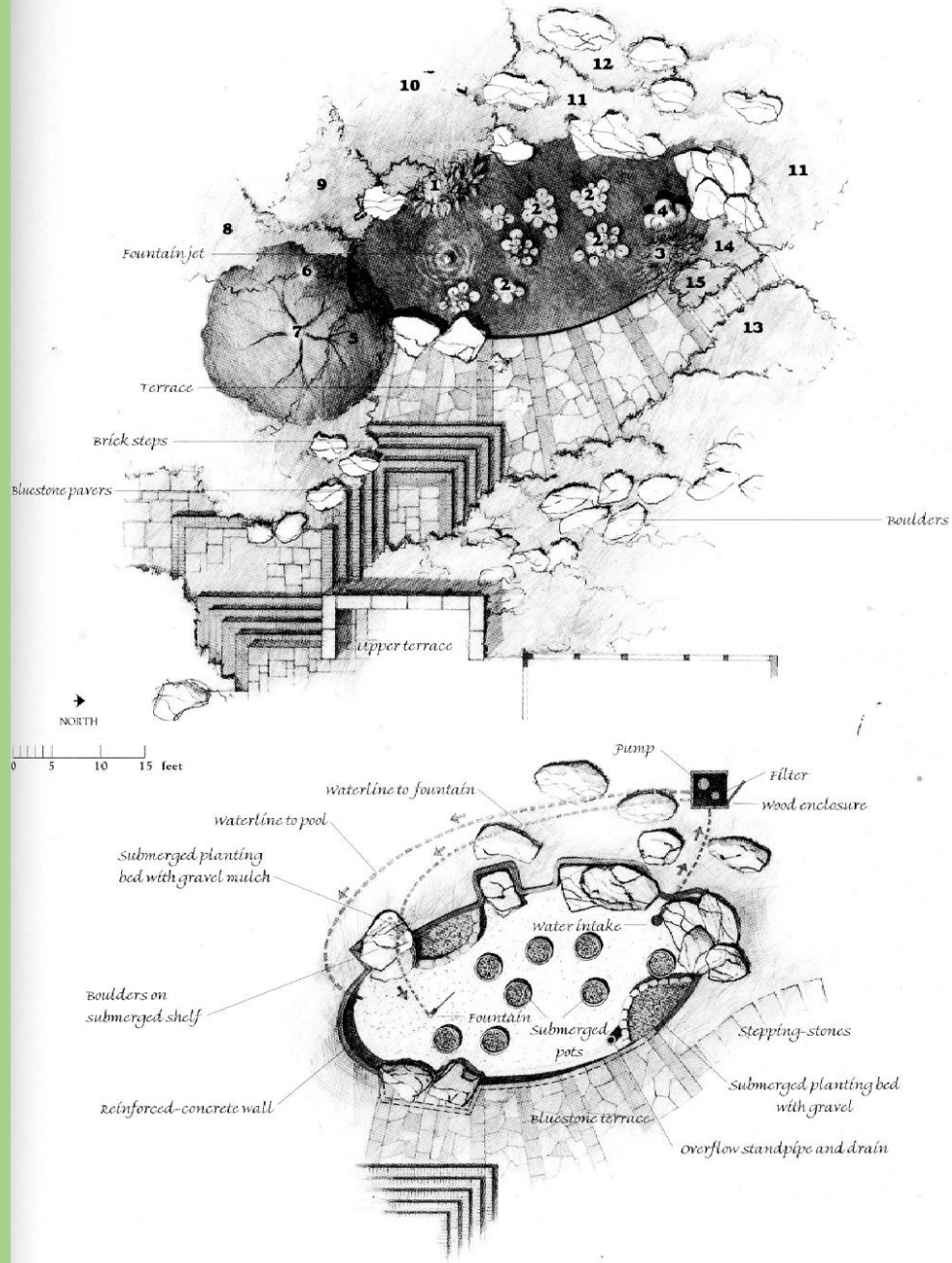

GARDENS IN AUGUST

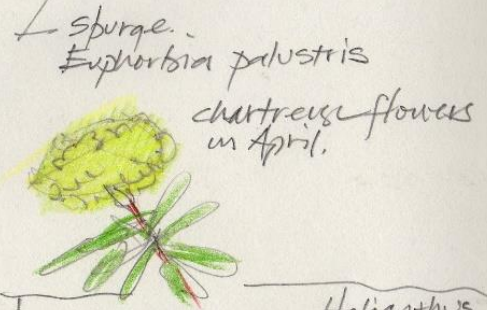
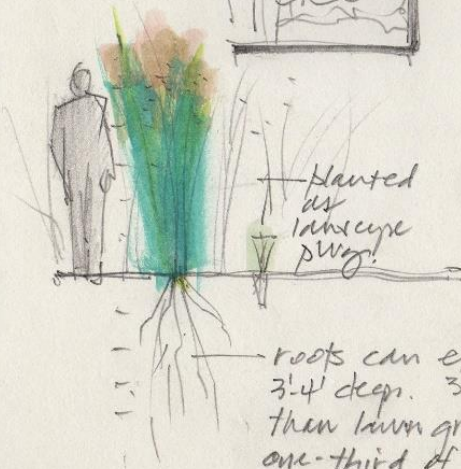
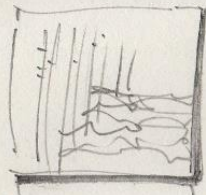
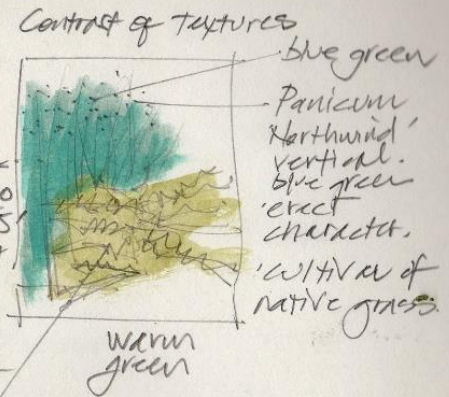
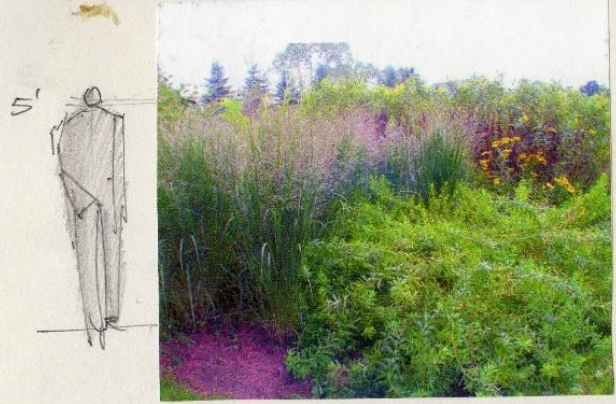
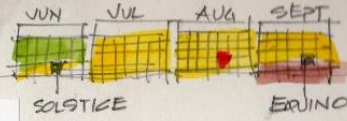

BOWMAN'S HILL WILDFLOWER PRESERVE.

August 20-22
Meadow in bloom
2014.
cannot identify.

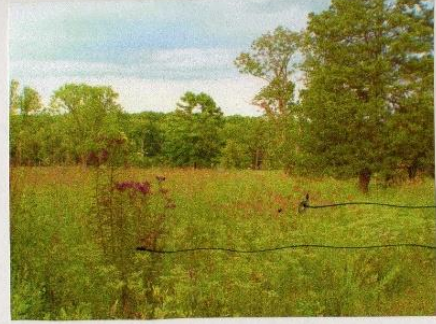

Eupatorium purpureum
New York Ironweed, Individual
(go back in September for changes)

Veils of grasses - flowers tend to stand higher than grasses.



? Coreopsis + Helianthus

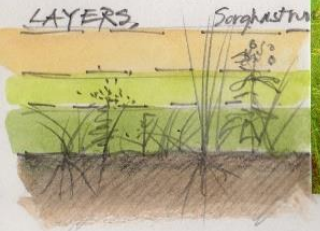

SOLIDAGO species? I saw at least two different species in bloom.



Painting -
brush work heavy, color: too saturated? try again with more of an earth palette.
how would Russell Chatham approach? too much detail?



Eupatorium hyssopifolium
whitish green flowers

S. Sioux Blue?

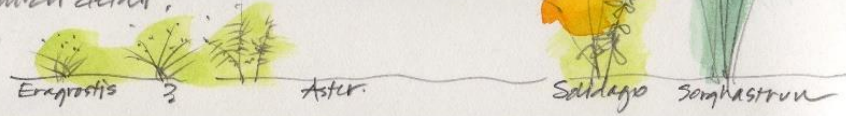

SKETCHBOOK IN THE GARDEN



JULY 24 2015



Beautyberry
Callicarpa

seeded here
2-3 years ago from
mother plants 40 feet
away.

Euphorbia palustris
Spikes 3'4, 4'4
reseeded from
original plants
15' away
in gravel driveway

Solidago
reseeded.

Silphium perfoliatum
8.5' TALL

Anemone variety?

Silphium,
9 stems,
8-8.5'

Hemiphysalis Karley Rose
Earthy salmon seed wands flutter
with the breeze. Crowded by reseeded
Euphorbia (in gravel driveway). ~~TR~~
looks great now

Tenny behind yellow bottom flowers
in clusters. Very floppy. Not a
good cut flower for indoors -
unpleasant smell - (keeps deer away.)

Seeded
Red bud

Panicum Shearsoak
Foliage + seed heads 4'4 HT.
dense leaves/foliage,
tight and vertical
red tinge to seed stems

Deschampsia grass
Cold season
golden brown dready.
tuft of foliage 12" HT.
seed stems 36"-42"
Lots of weeds.
Clover, Stilt grass.



Echinacea purpurea
coneflower. started with
reseeded itself vigorously
over last 5 years.
into gravel driveway
18-24". The last two
long cold winters w/
insulating snow seems
to irrigate reseeding.
New seedlings 6" tall

Panicum Heavy Metal
4.5' height - seed branches
delicate texture next
to large *Silphium* leaves

Echinacea
Another clump
low plants
in front. Mostly
tufts in gravel
driveway.

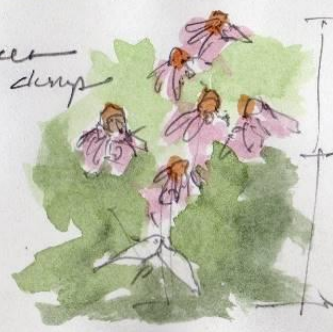

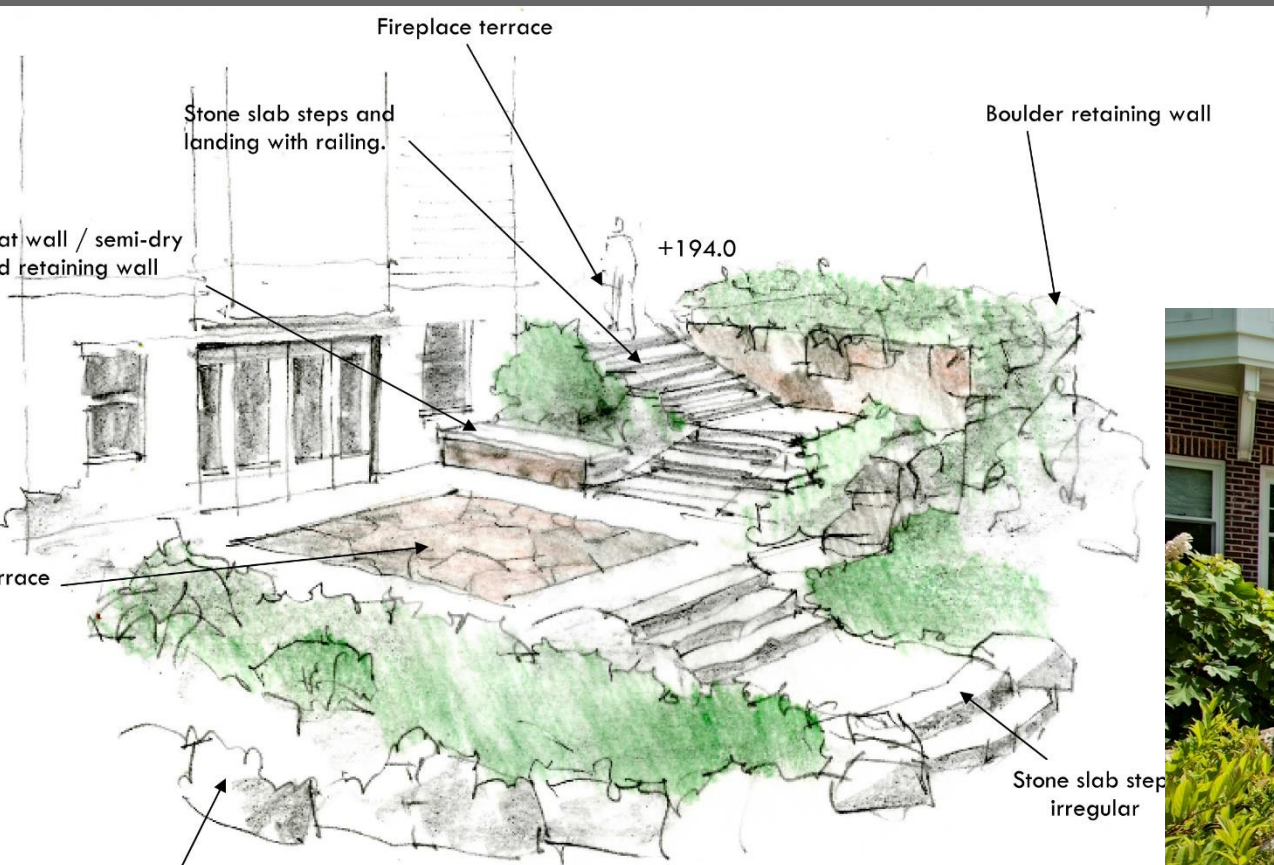

East Steps at Rear Terraces
 McBride Residence
 Quercus Studio

Note: All grades and elevations are approximate.





Shea Residence · Proposed Pond Plantings

Overco's Studio Landscape Architects

Decentralized Wastewater Treatment System for Ridge 29

Septic Tank: A two-compartment septic tank for each house separates and settles waste solids. Duplex pumps inside the tank convey the remaining liquid effluent for treatment through a low-pressure sewer pipe to the CTW influent control structure.

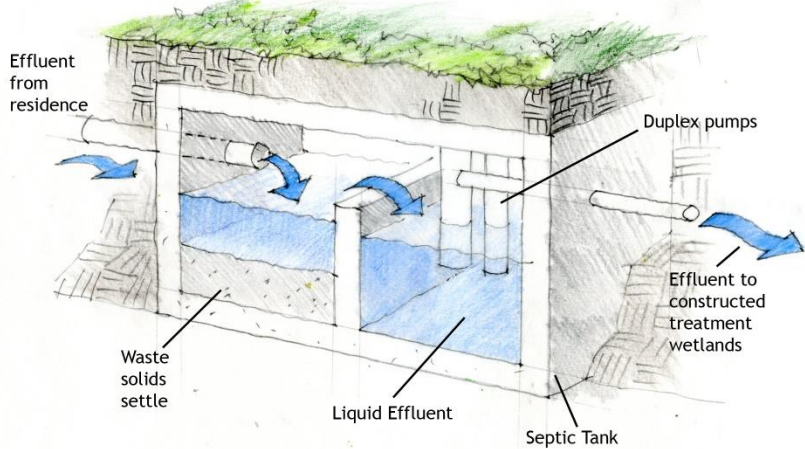

Influent Control Structure:

ICS passes the liquid effluents passively collected from households for treatment into the Enhanced SSFCTW.

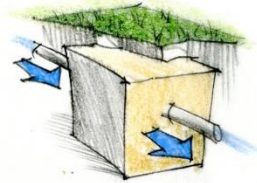

Enhanced Subsurface Flow Constructed Treatment Wetlands:

The Roux Associates Patented Enhanced SSF Constructed Treatment Wetlands host beneficial bacteria and wetland-type plants that remove harmful bacteria, microbes and any remaining organic waste material. Fine bubble diffuser provide constant aeration within the CTW to support the biological processes.

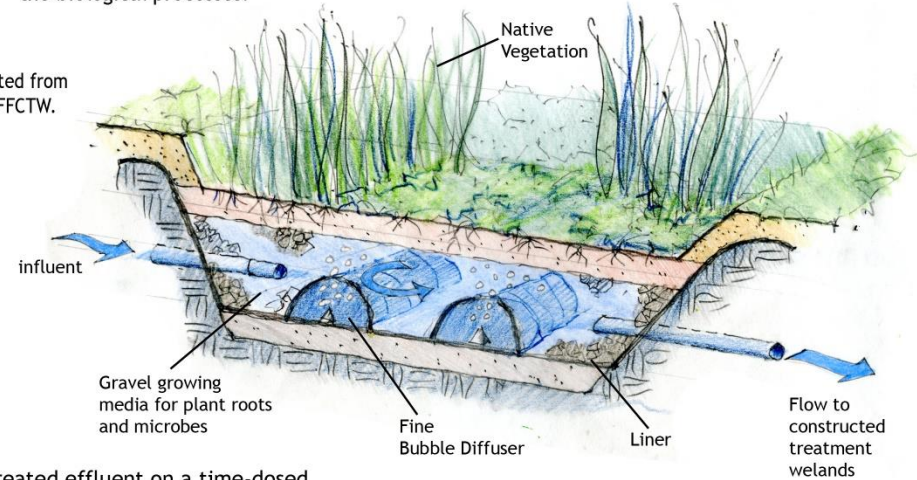

Drip Dispersal Dosing Tank: Drip Dispersal Dosing Tank sends treated effluent on a time-dosed basis into the subsurface Drip Dispersal Field. Only two out of three fields receive effluent on a rotating basis.

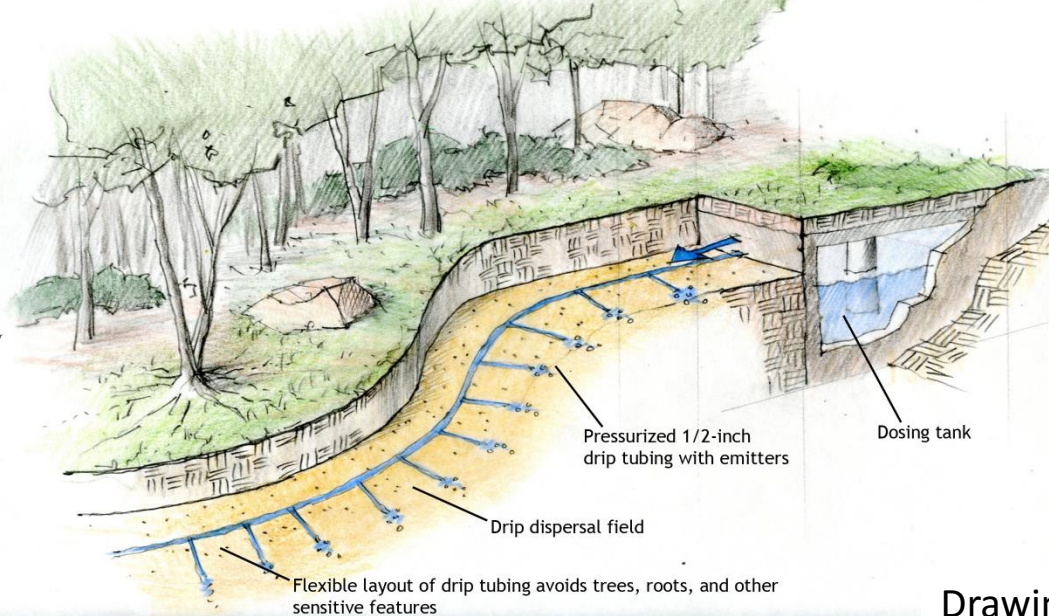

Effluent Control Structure:

ECS passes the treated effluent to the Drip Dispersal Dosing Tank.

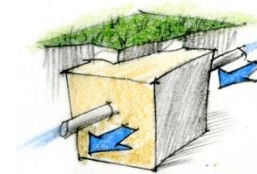

Stormwater Treatment for Ridge 29

Biofiltration Swales and Treatment Process:

Storm water from roadway collects in planted swales and is conveyed to bioretention basins. In bioretention basin, plantings of trees, shrubs and ground covers treat runoff for water quality and enable infiltration. Overflow from bioretention basins continues to linear woodland stormwater basins for further infiltration. Excess water overflows basins for shallow sheet flow into woodlands.

Planted Bioretention Swale

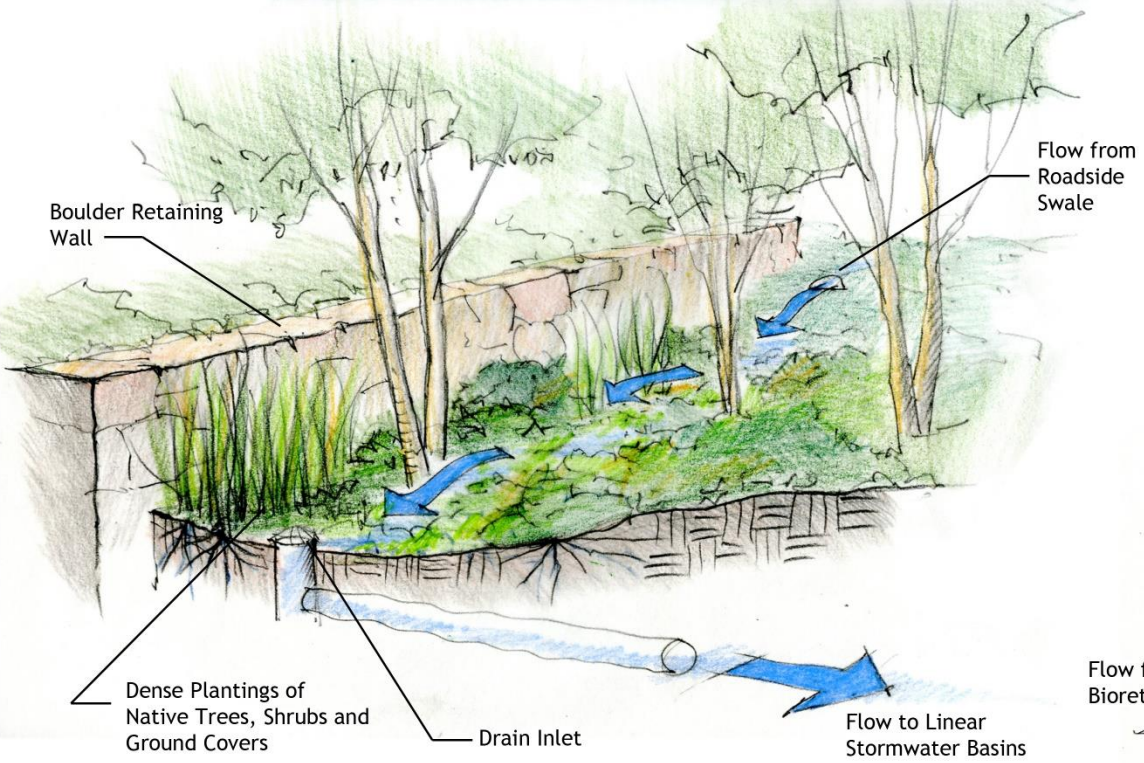

Roadside Swale and Stormwater Collection

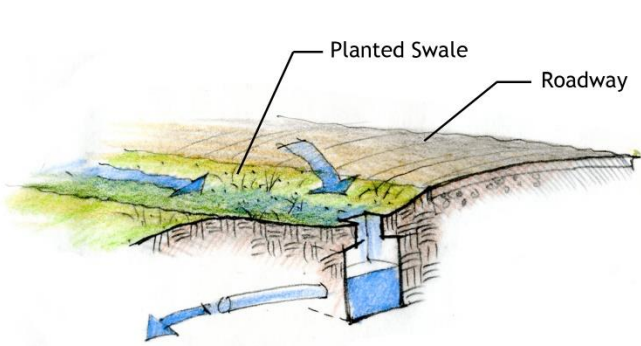

Linear Stormwater Basin

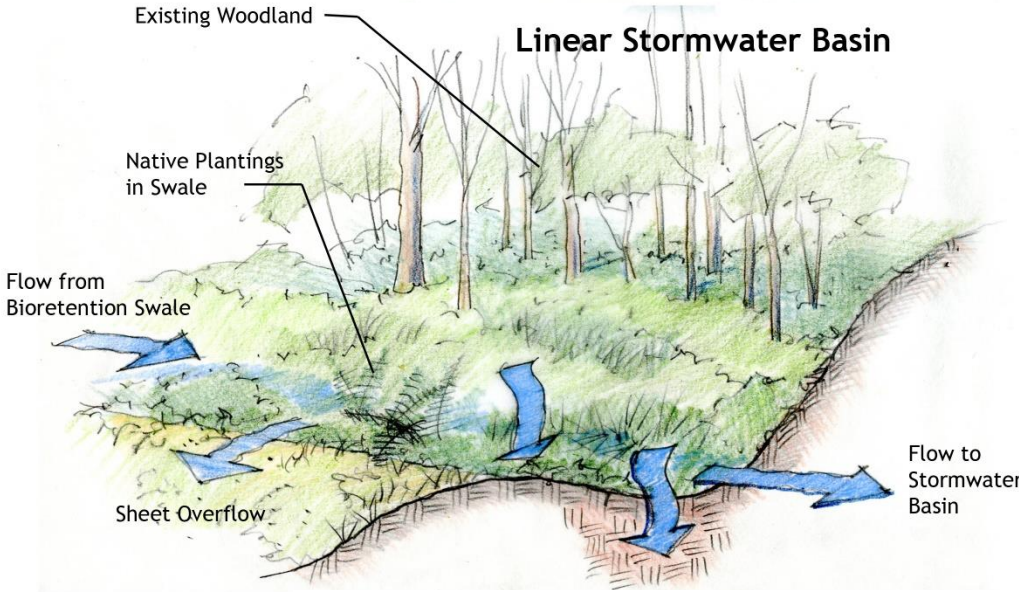

Exposed bedrock on Huckleberry Hill.

Ramapo River

+ 300 feet

+ 230 feet

Bedrock

LAKE SIDE PROPERTY

Over 10,000 years ago, as global warming increased, glaciers in North American melted and receded north. Deposits of sand and gravel and boulders pushed along by glaciers often accumulated and blocked the flow of melt water.

Geologists have found evidence of many glacial lakes in the Ramapo River valley. A naturally formed dam was located about three-quarters of a mile south of this site. This lake filled with glacial melt waters to an elevation of 290-300 feet above sea level—putting water at about the level of the first floor of this home.

Sediments from this lake shape the local land forms and may contribute to water drainage patterns in the area. The spillway for this lake (since eroded by the Ramapo River) was about a mile north of Crystal Lake.

+ Sea Level

Glacial Deposits + Melt Water = Lakeside Property

Robbins Towers Residence

Mahwah, New Jersey

Quercus Studio LLC

Landscape Architects

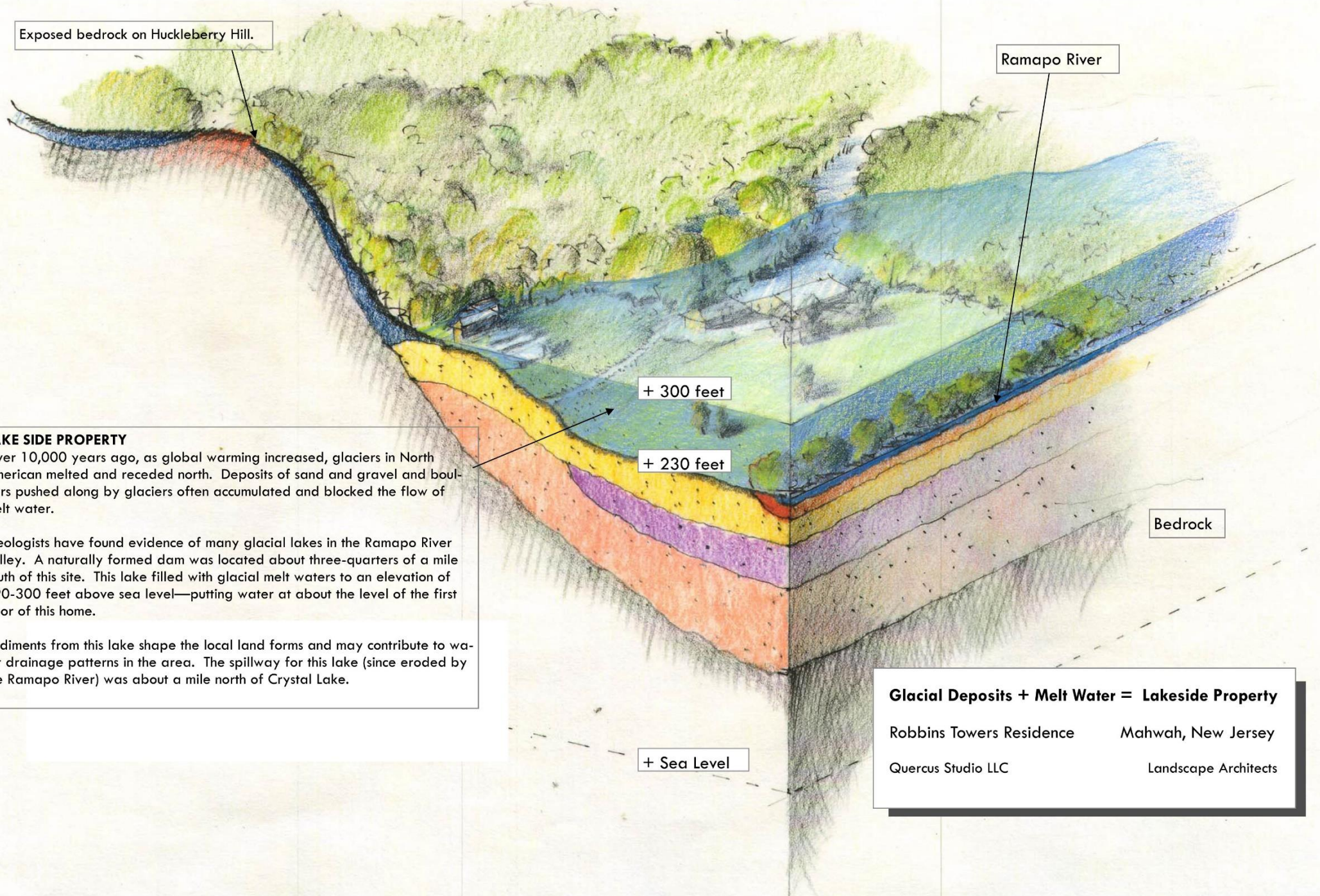

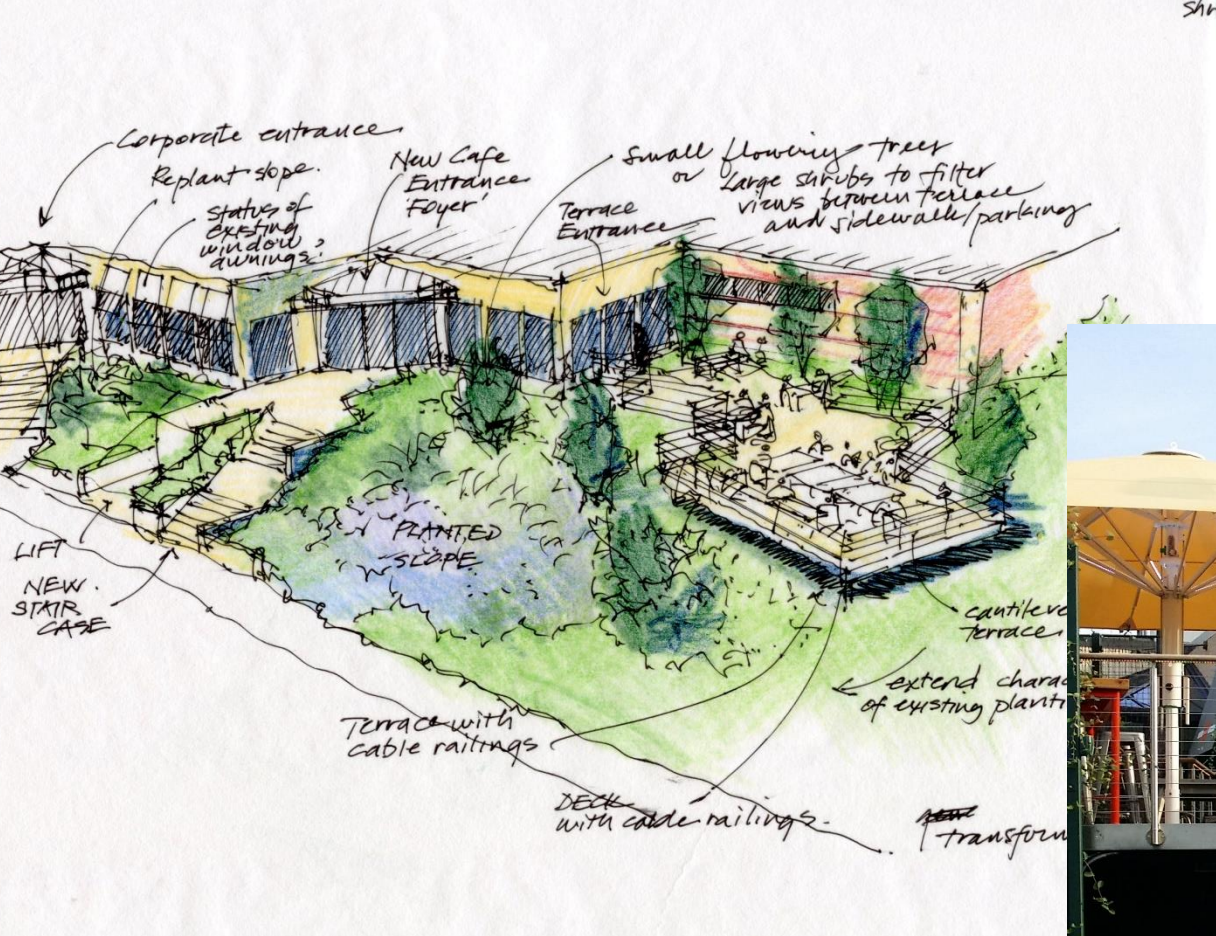

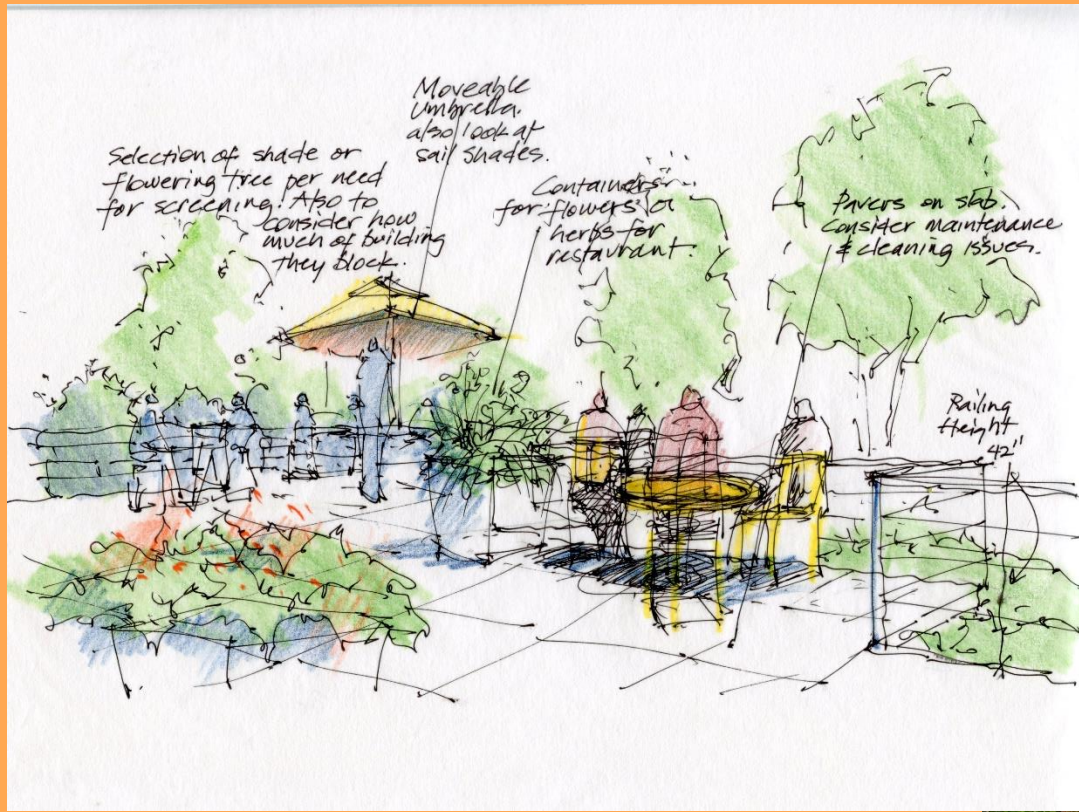

**PAINTING,
LOOKING**



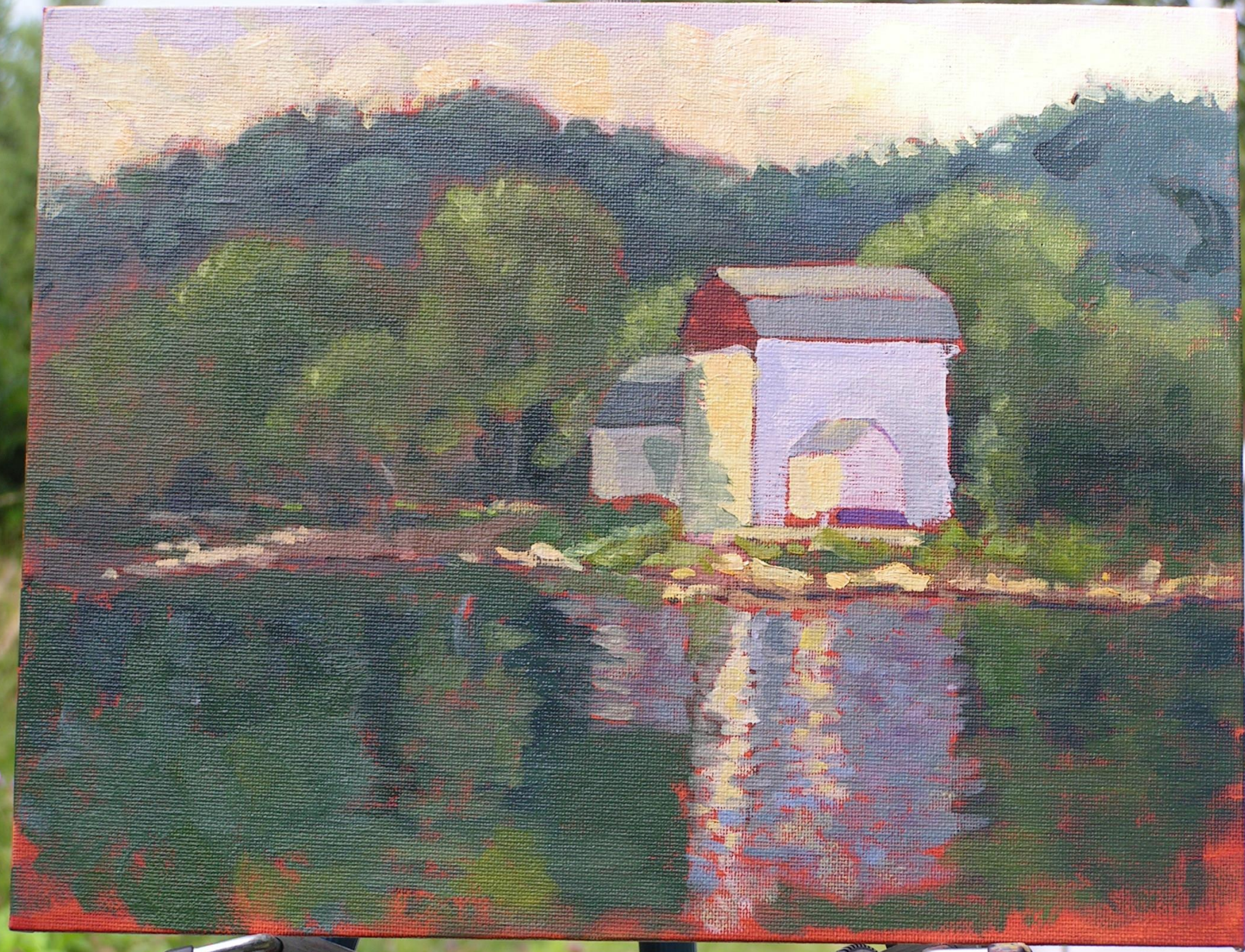

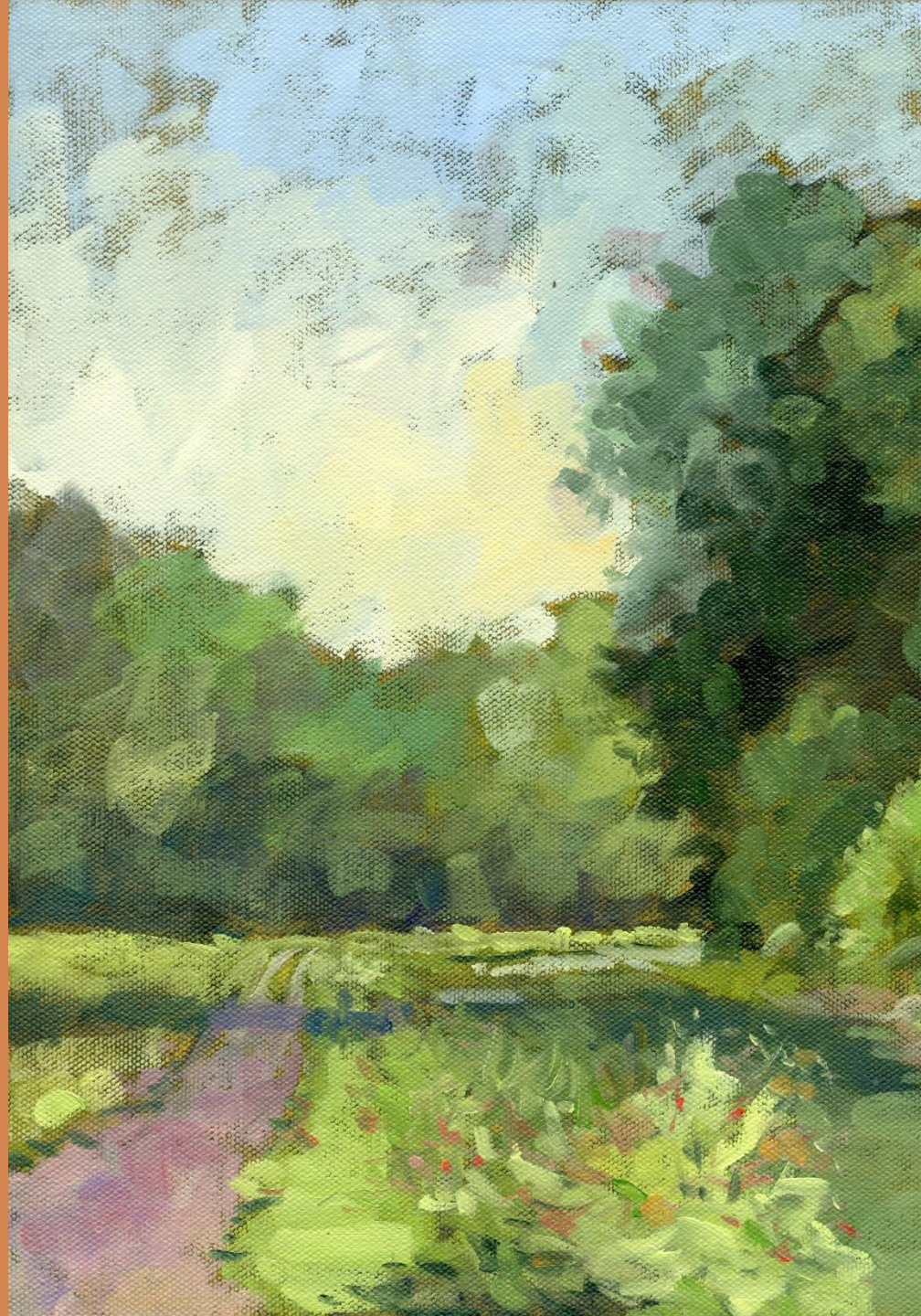





Fields at Honey Hollow Farm









INSPIRATION



TO THE BOTTLES
E. W. RICHIE





Tom Thompson
Group of Seven

**PAINING ,
PLANTING**











An oil painting of a still life scene. In the center, a light-colored box is open, revealing a pair of red and white patterned shoes. To the right, a pair of white socks with blue stripes lies on the surface. In the foreground, a pair of yellow and white patterned shoes is visible. The background is a warm, textured wash of brown and red tones. The overall style is expressive and painterly.

jeffreycharlesworth@gmail.com
www.JeffCharlesworth.com

jeff@cfland.com
www.cfland.com