

Level

3

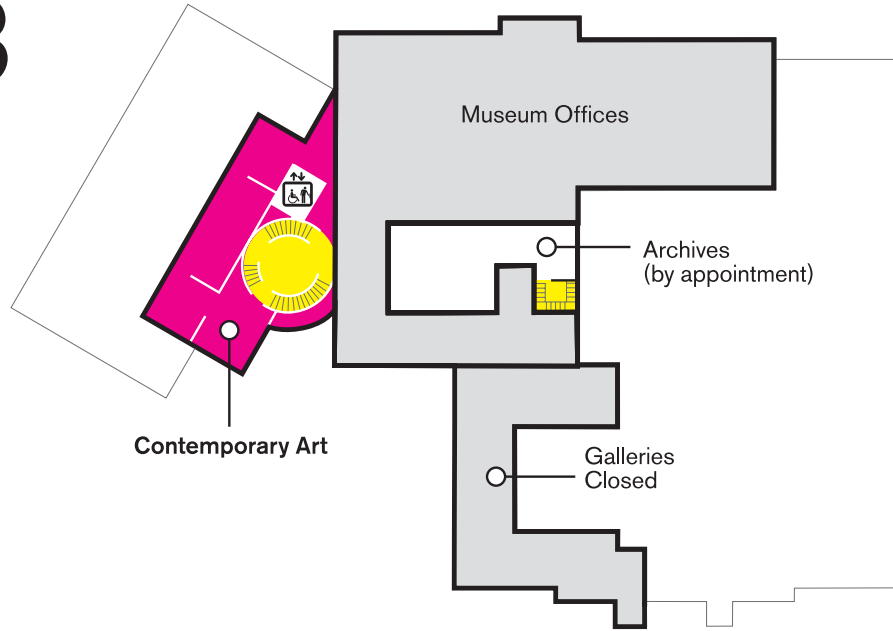

- Information
- Accessible Elevator
- Restroom
- Family Restroom
- Accessible Restroom
- Water Fountain
- Checkroom
- Parking Pay Station
- Stairs
- BMA Shop
- Gertrude's

Level

2

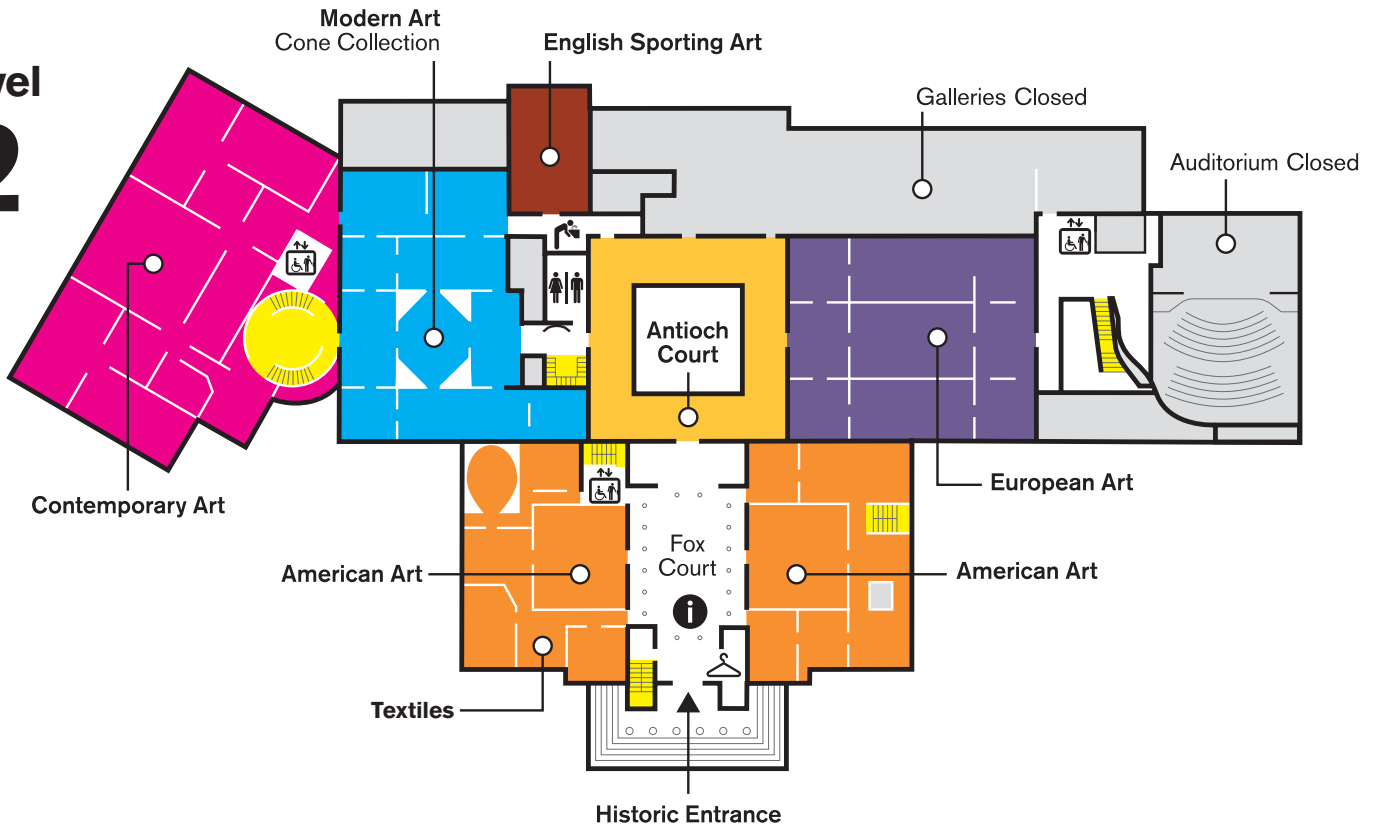

Level

1

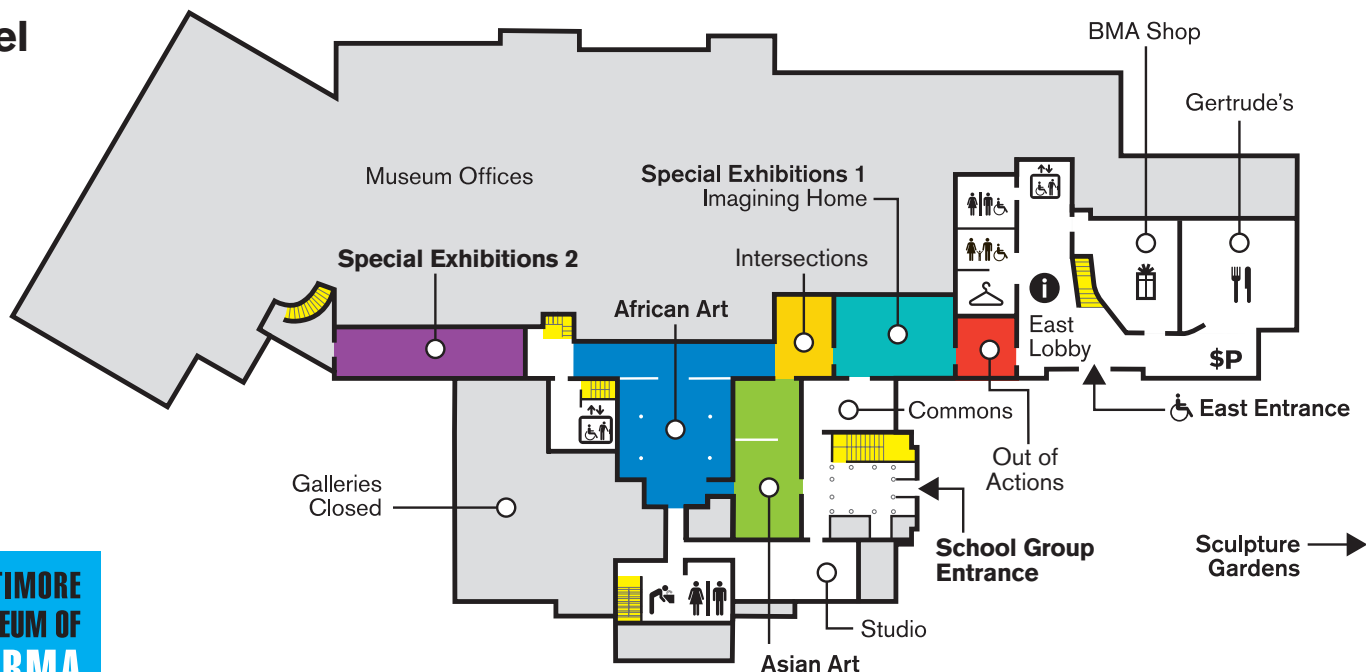

**BALTIMORE  
MUSEUM OF  
ART BMA**

# Museum Map & Information

## FREE general admission to the Museum

### Museum + Sculpture Gardens

Wednesday–Sunday  
10 a.m.–5 p.m.

Monday–Tuesday Closed

[artbma.org](http://artbma.org)

443-573-1700

### BMA Shop

Sunday & Tuesday 10 a.m.–5 p.m.

Wednesday–Saturday  
10 a.m.–8 p.m.

Monday Closed

[shopartbma.org](http://shopartbma.org)

### Gertrude's Restaurant

Tuesday–Friday 11:30 a.m.–9 p.m.

Saturday 10 a.m.–9 p.m.

Sunday 10 a.m.–8 p.m.

Monday Closed

[gertrudesbaltimore.com](http://gertrudesbaltimore.com)

410-889-3399

### #artbma

The BMA is photogenic and looks great in selfies. Share your best shots with us:

  @artbma

 @baltimoremuseumofart

The BMA is closed New Year's Day, July 4, Thanksgiving, and Christmas.

## Enjoy your visit

Henri Matisse's dog Raoudi shares tips on how to have a great experience at the BMA.

### We hope your visit to the BMA is as enjoyable as possible.

Ask our Visitor Services team any questions you might have about your visit, including parking, access services, public transportation, and local attractions.



**Enjoy art with eyes and ears, not hands or paws.**



**Leave food and drinks outside.**

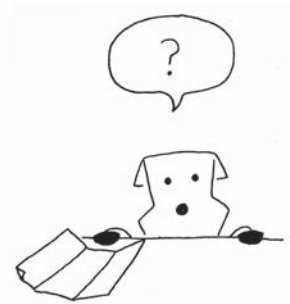

**Ask questions often.**



**Take photos, but turn off the flash first.**

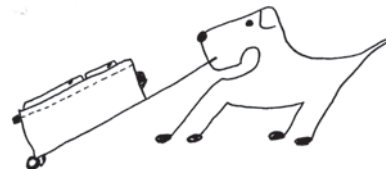

**Check large bags and umbrellas.**



**Sketch and take notes with pencil only.**

## Members Matter

[artbma.org/join](http://artbma.org/join)

Members receive a 10% discount at the BMA Shop and Gertrude's restaurant, invitations to exclusive events, and more.

**Join at the Information Desk, BMA Shop, or online.**

From helping to preserve the BMA's world-class collection to supporting special exhibitions, Members provide vital support that makes it possible for everyone to experience the power of art.

Thank you, BMA Members. Your support makes this a wonderful museum to visit.

## Planning an event?

[artbma.org/go/rentals](http://artbma.org/go/rentals)

The BMA is a unique venue for events such as weddings, bar/bat mitzvahs, corporate receptions, meetings, and performances. Email [rentals@artbma.org](mailto:rentals@artbma.org) for more information.

## Accessibility

A limited number of wheelchairs and strollers are available free of charge.

Large print and braille maps are available at the Information Desk.

Service animals are welcome. Please check in upon arrival.

## Group Tours

[artbma.org/go/tours](http://artbma.org/go/tours)

The BMA offers guided and self-guided tours for parties of 10 or more. Book guided tours six weeks in advance. Self-guided tours require two weeks' notice.

We also offer drop-in tours. Visit the Information Desk to see what's on this week.

## Smile!

While at the BMA, visitors may be photographed by Museum staff. These images may be used by the BMA in print, online, and signage.

## Visitor Policies

Help us maintain a safe environment for visitors and works of art. Thank you!

**Thank you for not smoking in the Museum or Sculpture Gardens.**

Please do not touch the art except where noted.

Photography for personal use is allowed—without flash, lights, or tripod. Art on loan to the Museum may not be photographed. Videotaping is not permitted in the galleries.

Sketching is welcome in the galleries with pencil only. Copyists wishing to work with other media should call 443-573-1730.

Lockers are provided free at the Checkroom for bags and items larger than 11" x 15" in any direction, including backpacks, packages, laptops, umbrellas, and diaper bags. Please check backpack baby carriers. Strollers are welcome.

Pets, bicycles, scooters, skateboards, glass containers, and alcoholic beverages are not permitted in the Sculpture Gardens.