

For outside corner
remove 2-1/2" section
of waterboard and form

For inside corner
lap panels

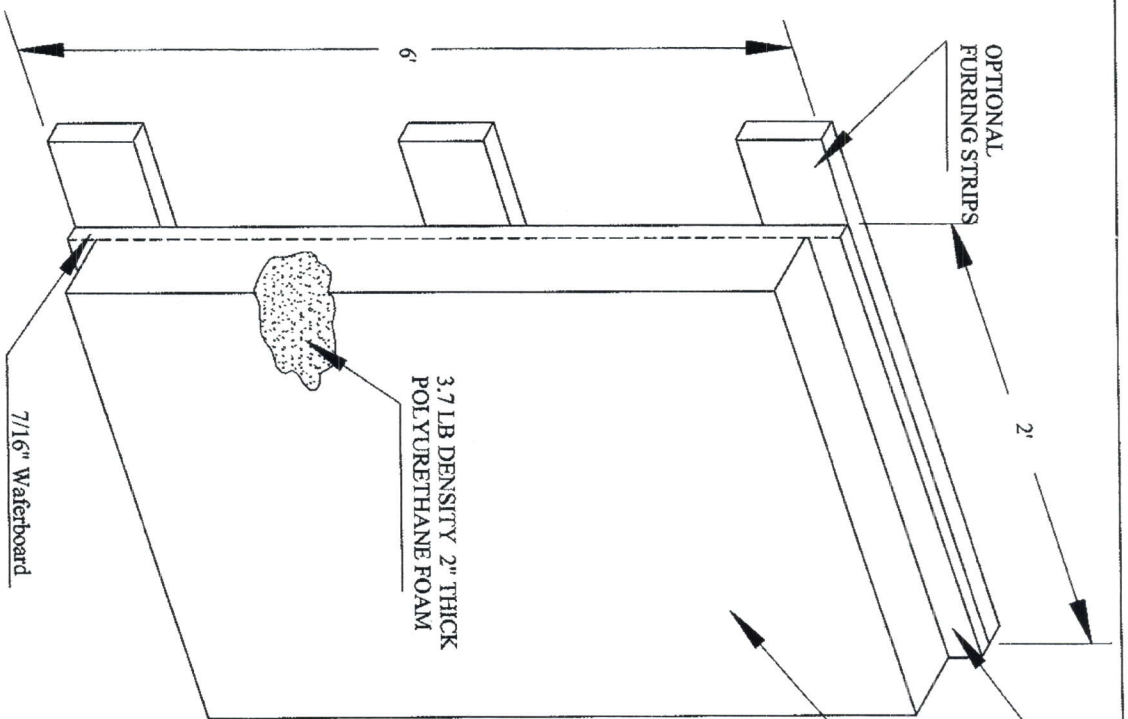

OPTIONAL
FURRING STRIPS

2'

1" nailer lip

14-ounce minimum laminated
vinyl attached to backing with
staples every 2"

3.7 LB DENSITY 2" THICK
POLYURETHANE FOAM

7/16" Waterboard

TYPICAL CUT OUT

cut here

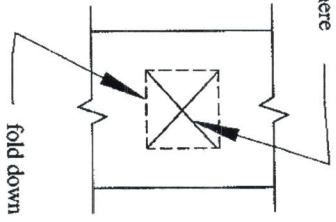

fold down
glue in corner inserts
and staple flaps under
panel, cover inside
edges with additional
vinyl as required

ARCHITECTURAL SPECIFICATION:

WALL PADDING TO BE MODEL- WP-26LU AS MANUFACTURED BY AK ATHLETIC EQUIPMENT, INC. IN COLUMBUS, OH. SIZE TO BE 2' WIDE BY 2 1/2" DEEP BY 6" HIGH WITH 1" LIP ON TOP AND BOTTOM OF EACH PANEL. PADS TO BE CONSTRUCTED USING 2" THICK 3.7LB.DENSITY POLYURETHANE FOAM CEMENTED TO 7/16" OSB. COVER MATERIAL TO BE (COLOR) 14 OUNCE POLYESTER LAMINATED VINYL STAPLED TO BACKING EVERY TWO INCHES. VINYL TO BE FLAME RETARDANT MATERIAL WHICH MEETS THE REQUIREMENTS OF CALIFORNIA FIRE MARSHALL. VINYL PASSES FLAME TEST ASTM E-84-87 AND IS RATED CLASS A FLAMESPREAD. IT MEETS THE REQUIREMENTS OF NFPA 701. CLASS "A" RATING. TEST RESULTS ARE:
* SMOKE DEVELOPMENT INDEX RATING OF 450 OR LESS
* FLAME SPREAD INDEX OF 25 OR LESS
* VINYL IS PUNCTURE AND TEAR RESISTANT WITH MILDEW, ROT AND FUNGUSIDE COMBATING PROPERTIES. COLOR AVAILABLE ARE: FLAIR RED, RICH RED, ROYAL BLUE, CHAMPION BLUE, NAVY BLUE, SKY BLUE, FOREST GREEN, KELLY GREEN, BLACK, CAMEL, WHITE, YELLOW, LIGHT GOLD, GREY, ORANGE, PURPLE, DARK MAROON, LIGHT MAROON AND BEIGE

DEALER:
CUSTOMER:
PROJECT:
Date:

Approved by: _____ **Drawn by:** A. Katz

MODEL: WP-26LU
AK ATHLETIC EQUIPMENT, INC.
COLUMBUS, OHIO 43213
Drawing number: 110