

# *Axe Throwing , The most fun gift*

---

## **Assembly Instructions**

---

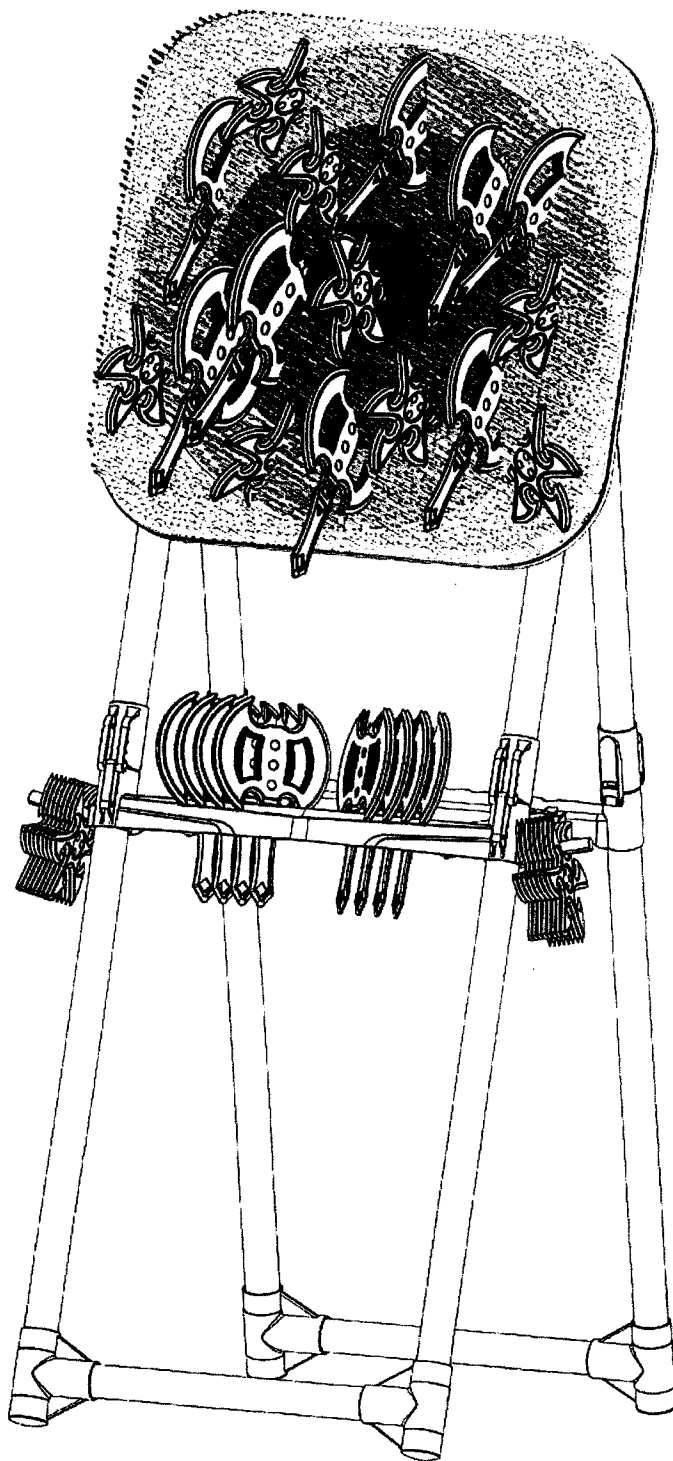

# Axe Throwing

## Parts List

01

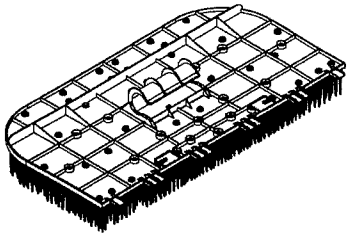

Target-Upper  
①x 1

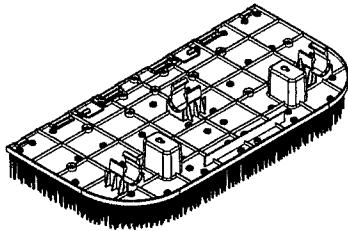

Target-Lower  
②x 1



Pole  
③x 4



Pole  
④x 2

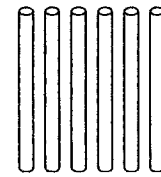

Pole  
⑤x 6



Pole  
⑥x 4

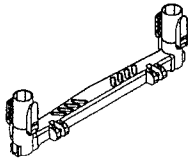

Connector-Axe Storage  
⑦x 1

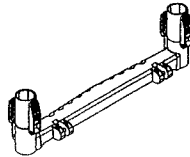

Connector  
⑧x 1

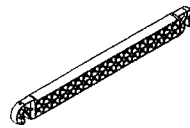

Drawbar  
⑨x 2



Star Hook  
⑩x 2

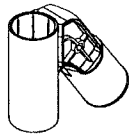

Connector with Hinge  
⑪x 2

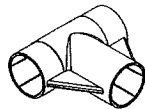

Connector-3way  
⑫x 6

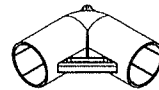

Connector-2way  
⑬x 2



Feet piers  
⑭x 4

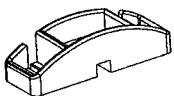

Feet Lock  
⑮x 2



Hatchet-Orange  
⑯x 4

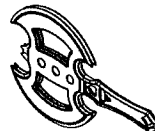

Hatchet-Cyan  
⑰x 4



Throwing dart-Orange  
⑱x 4



Throwing dart-Cyan  
⑲x 4

# Axe Throwing

## Assembly Instructions

02

Step 1

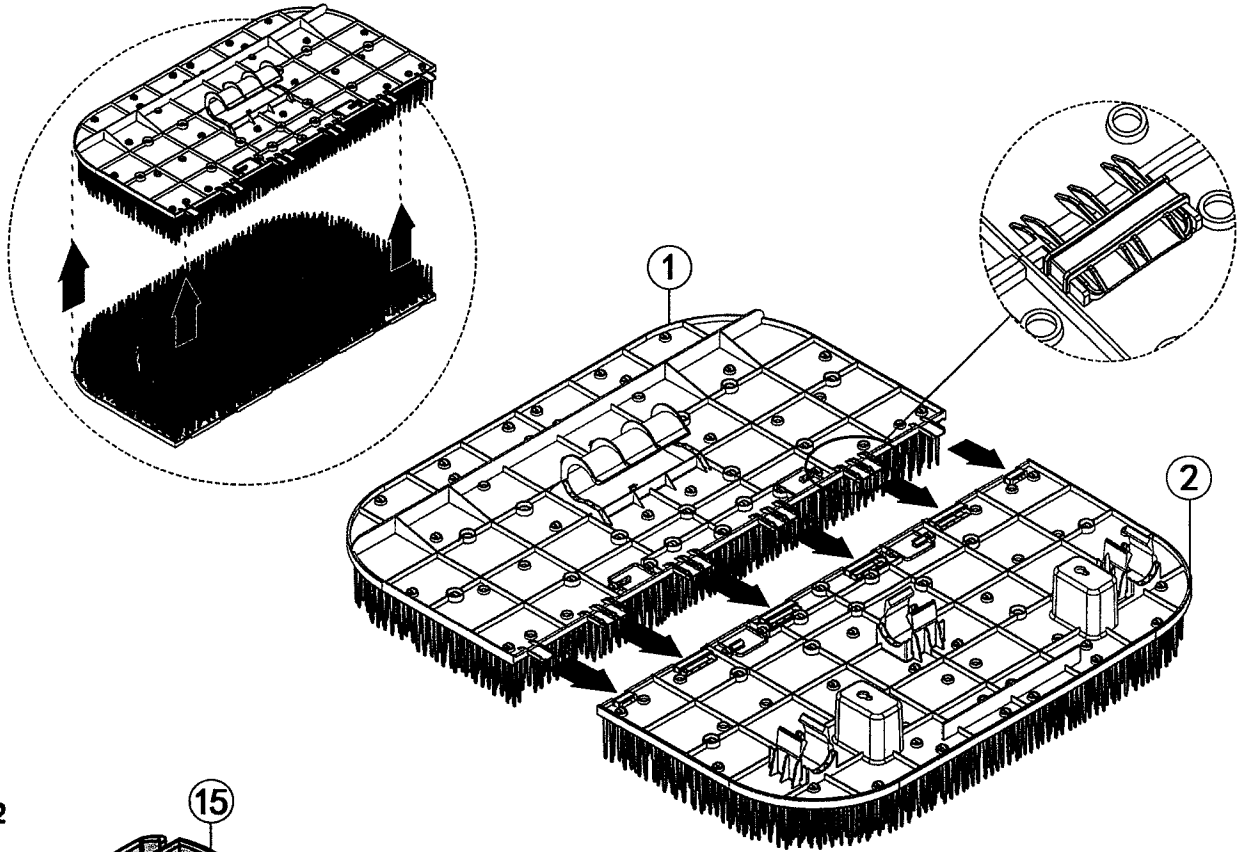

Step 2

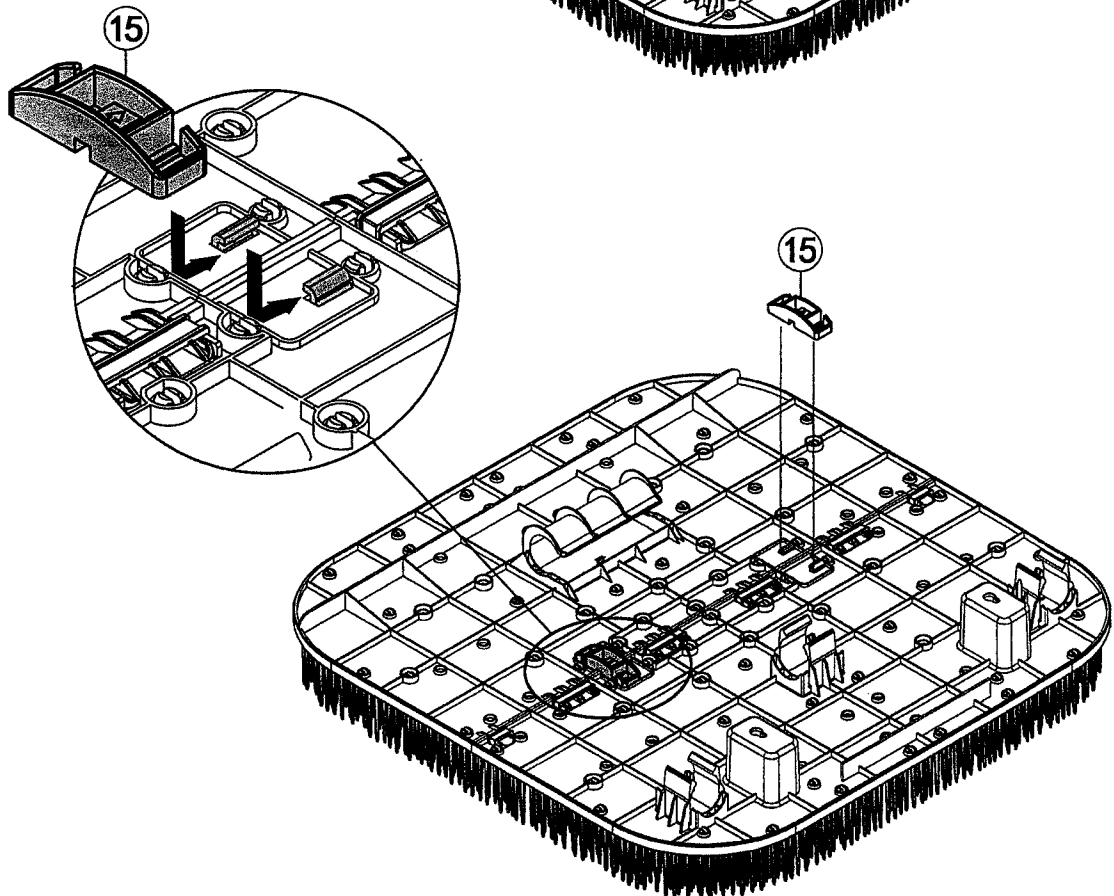

# Axe Throwing

## Assembly Instructions

03

### Step 3

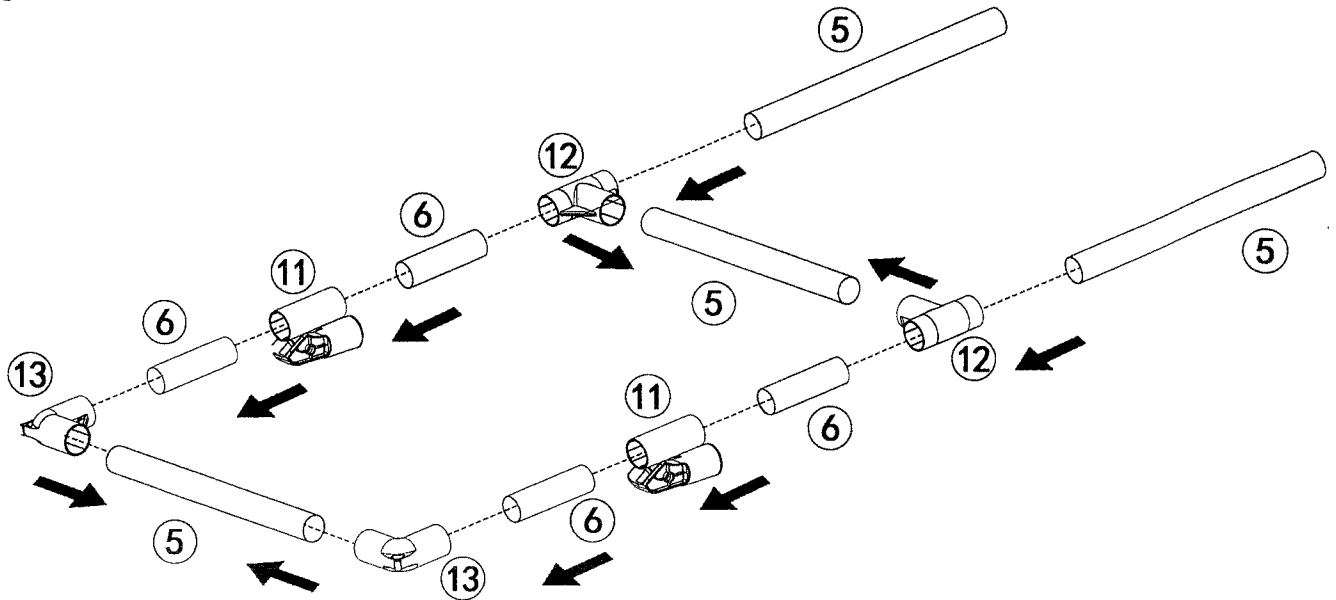

### Step 4

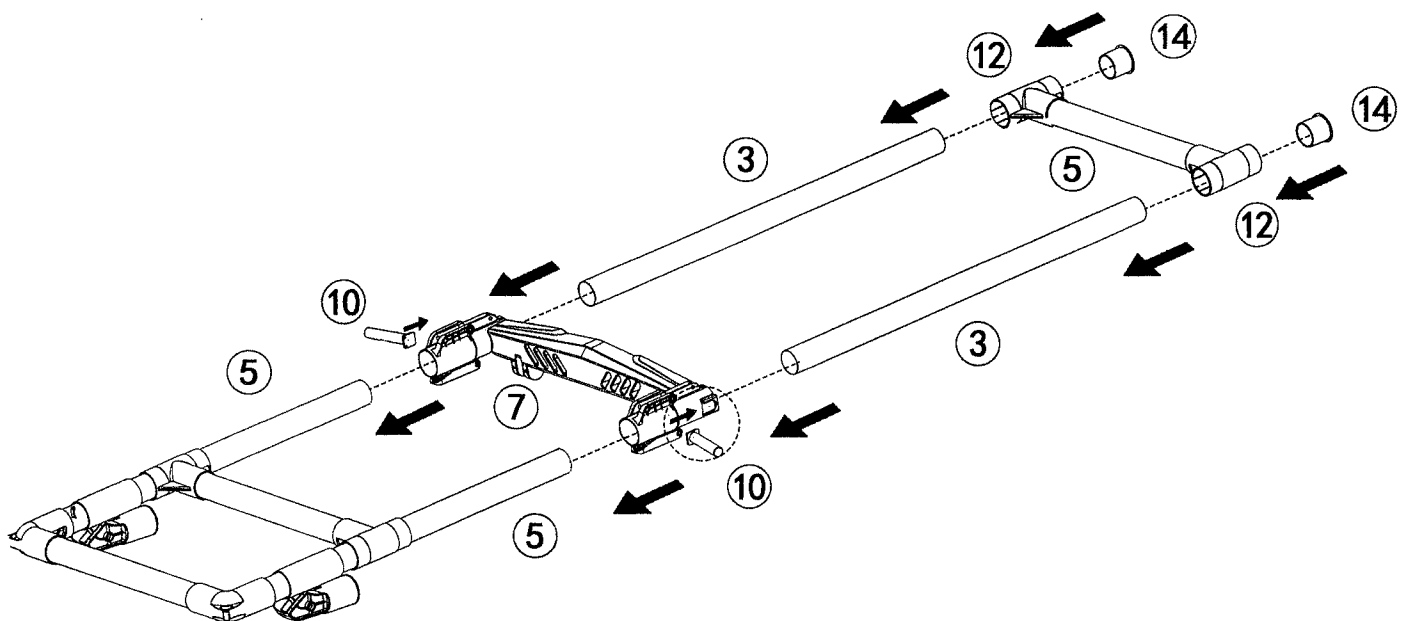

# Axe Throwing

## Assembly Instructions

04

Step 5

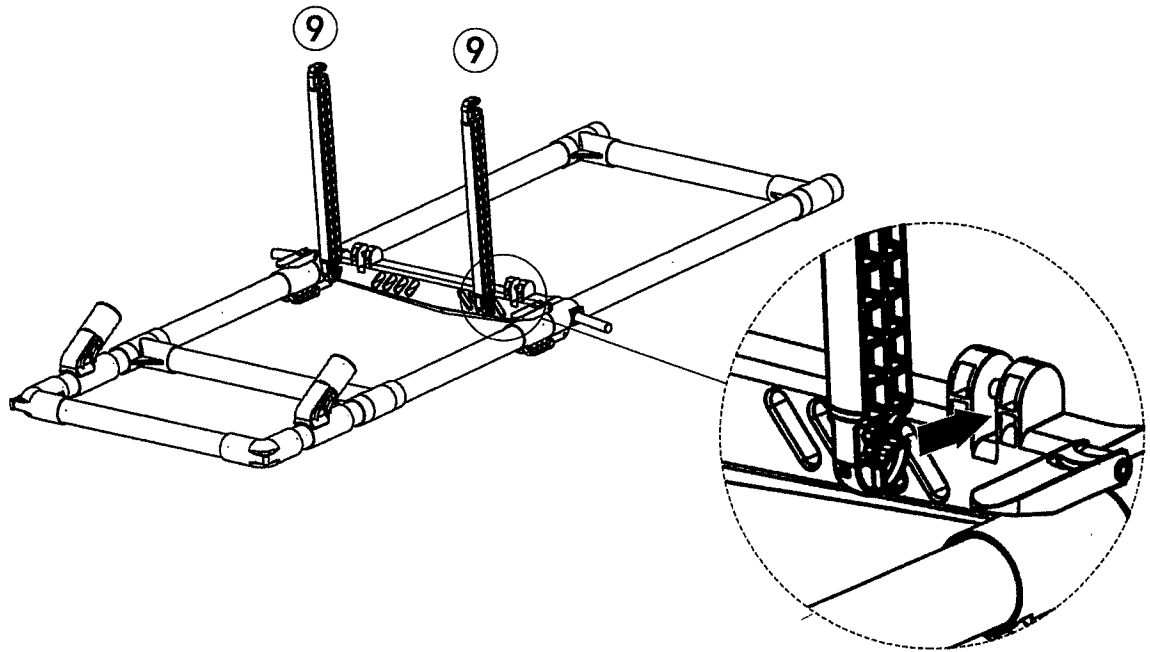

Step 6

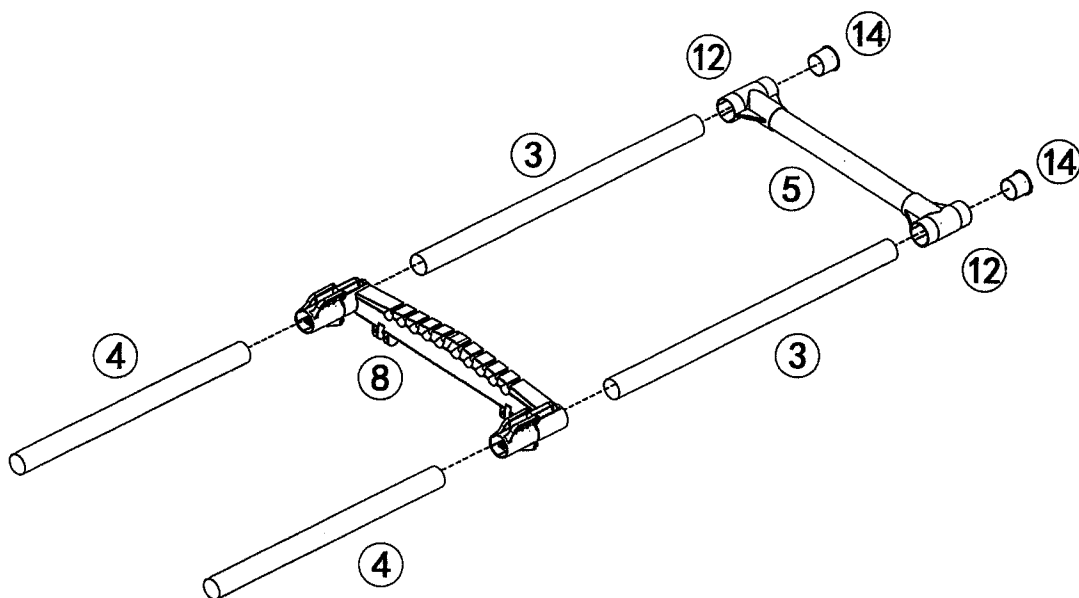

# Axe Throwing

## Assembly Instructions

05

### Step 7

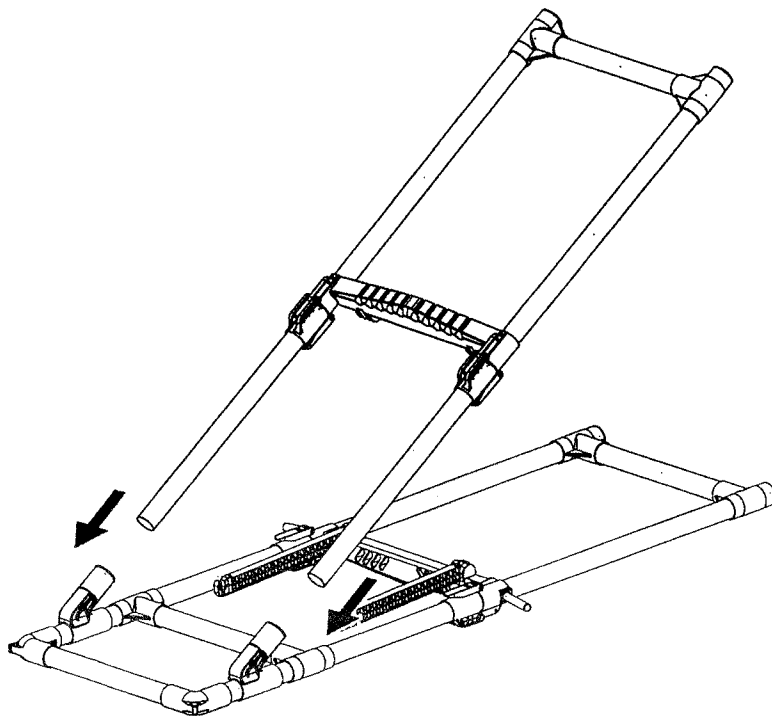

### Step 8

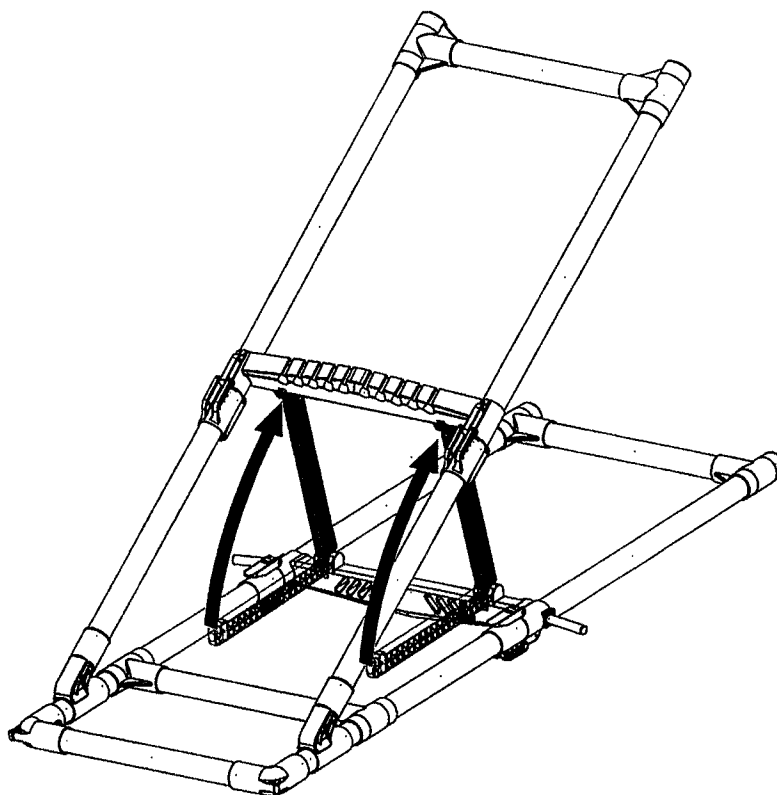

# Axe Throwing

## Assembly Instructions

06

Step 9

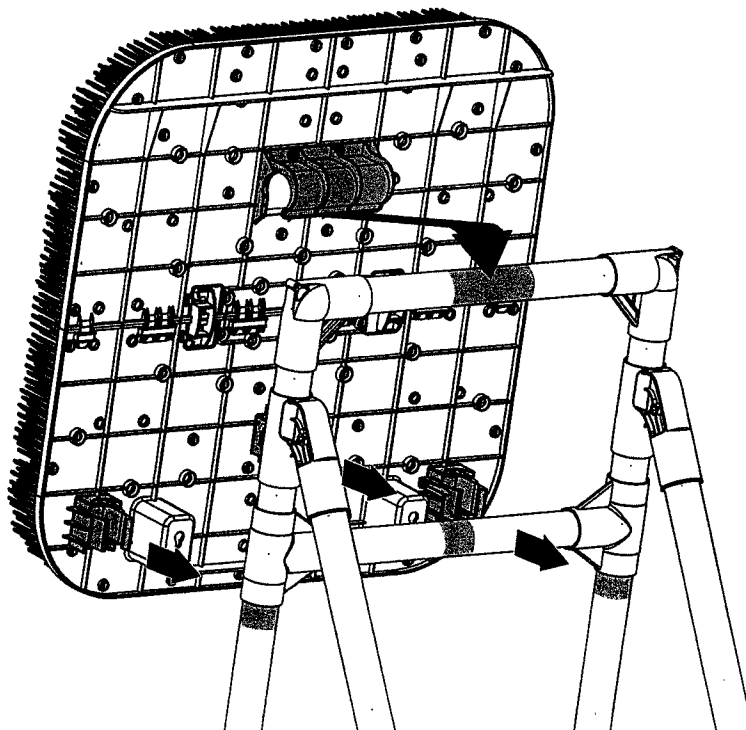

Step 10

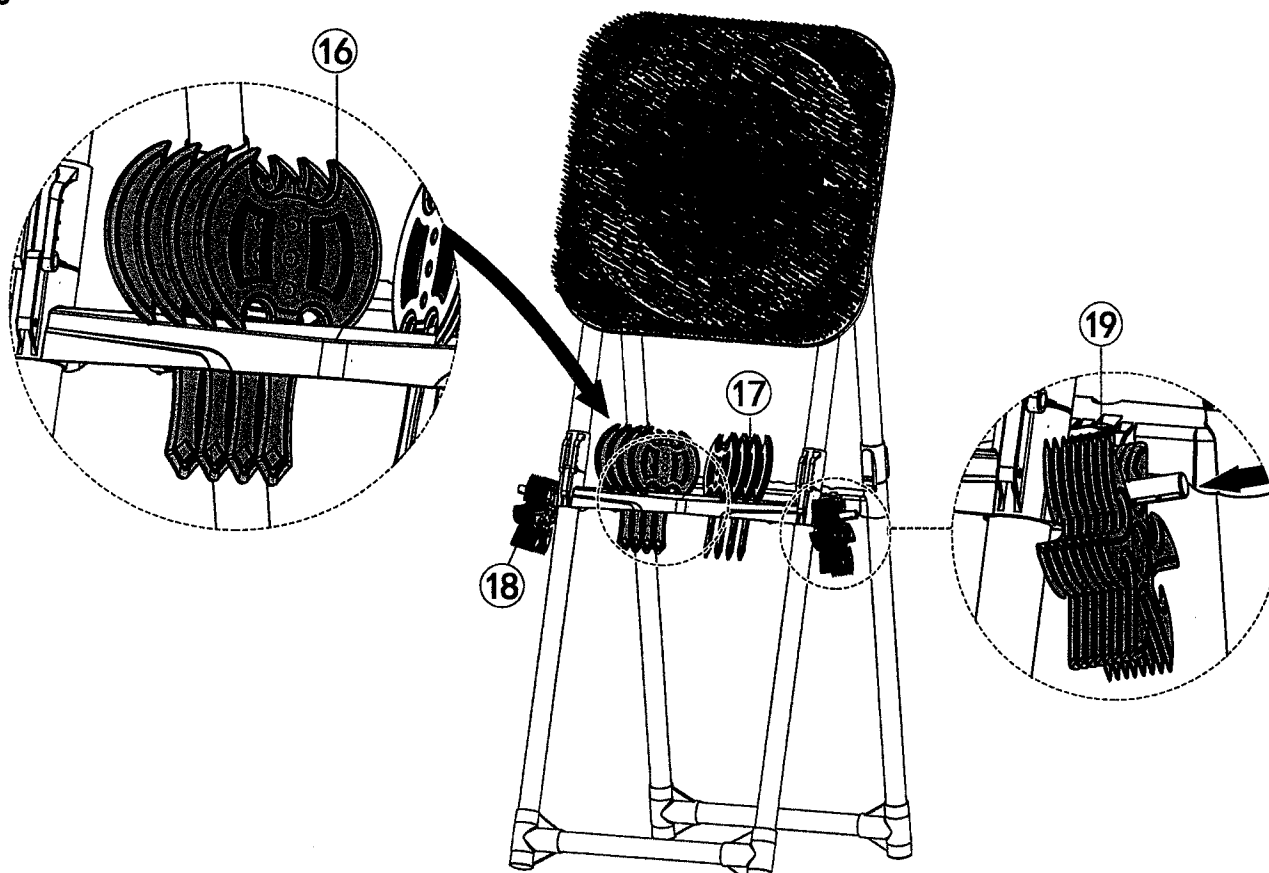

# Axe Throwing

## Assembly Instructions

07

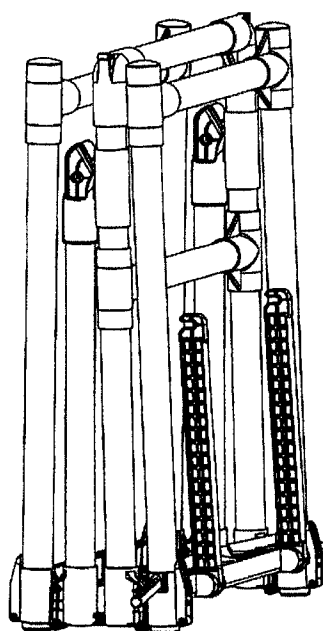
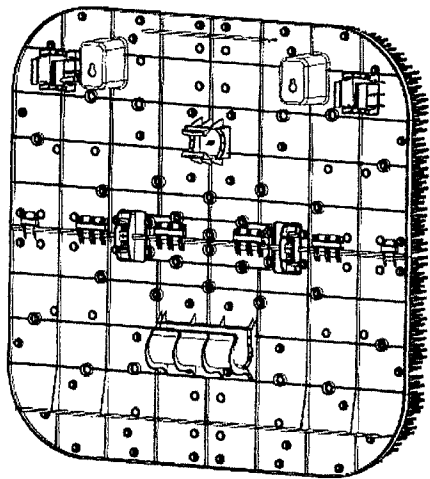
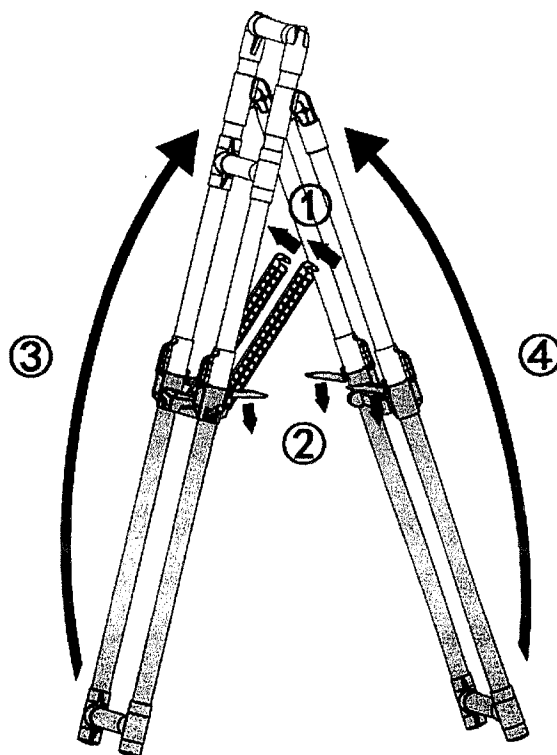
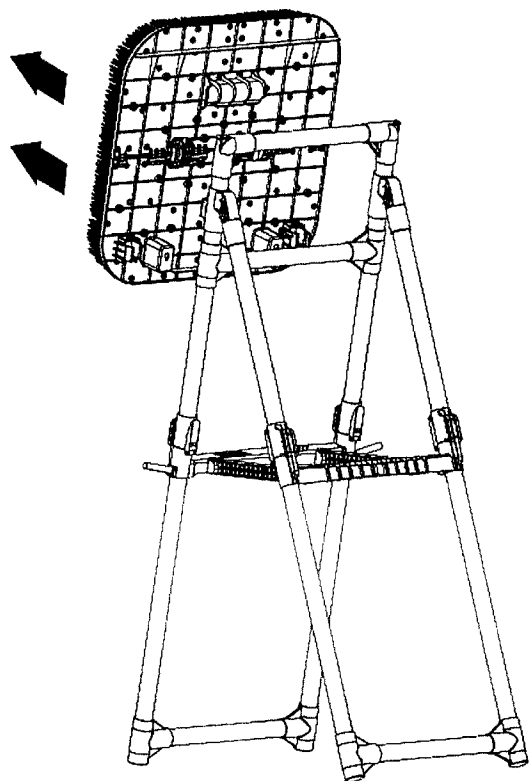

Free-standing when folded.

# Axe Throwing

## Wall-Mounted Assembly Instructions

08

Wall-mounted for direct throwing of axes and darts.

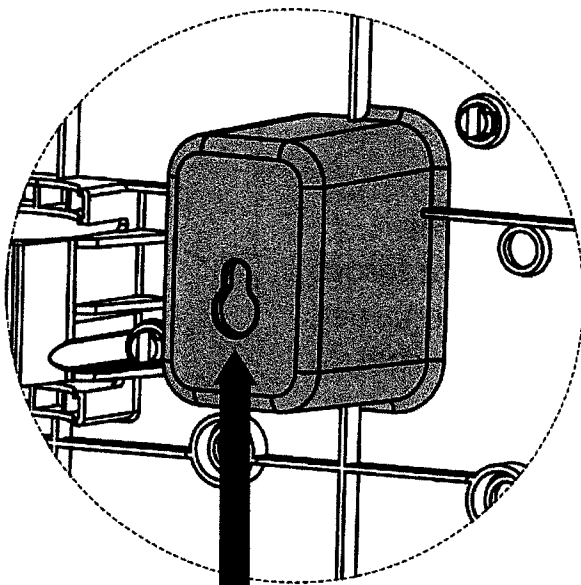
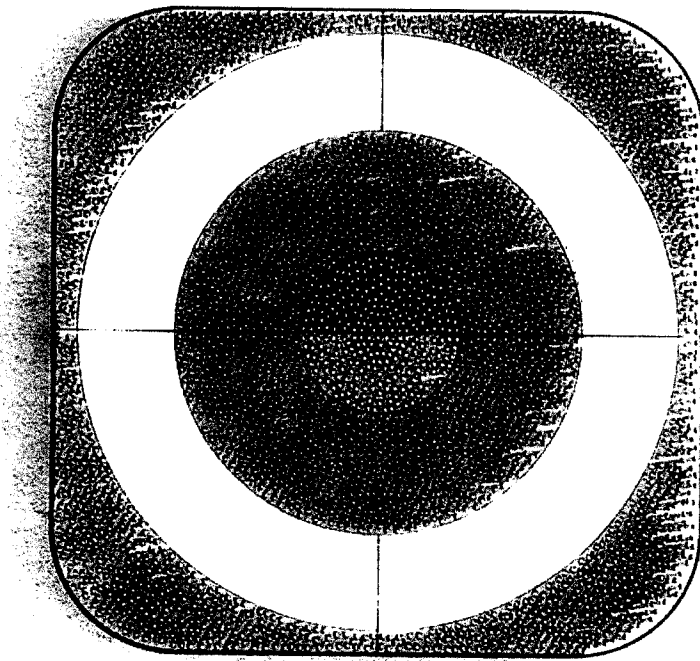

Hanging hole

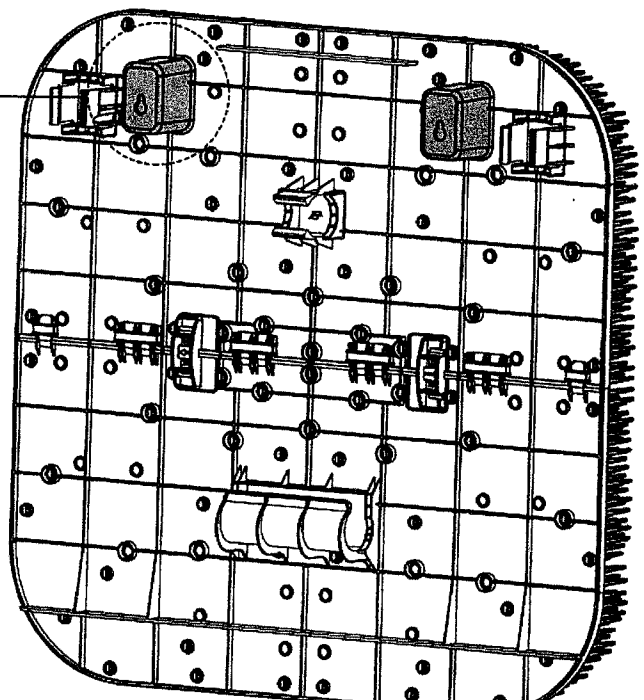

**WARNING: Never throw darts toward individuals or animals**

## Axe Throwing

### Setup

- Establish a throwing line about 10-15 ft. from the target.
- Determine a throwing order, usually going from youngest to oldest.
- Try a few warm up throws. **Safety axes stick best when thrown lightly at the target.**

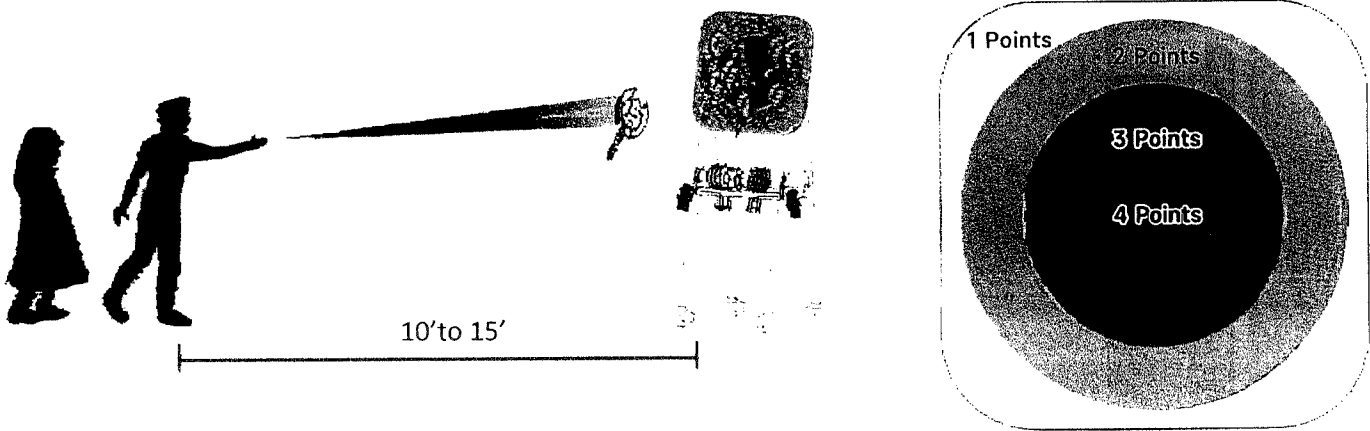

### Go Play!

- **Scoring:**
  - 1 Point: Throw lands in the Outer Section of the target
  - 2 Points: Throw lands in the Outer Ring section of the target
  - 3 Points: Throw lands in the Inner Ring Section of the target.
  - 4 Points: Throw lands in the Bullseye section of the target.
  - 0 Points: Throw that misses the target completely, or doesn't stick in the target.
  - The first team to reach 21 points wins the game.
  - If an axe lands on the border of two point zones, award the points to whichever zone the majority of the blade lands. If it's evenly in two zones, award the higher point value
- **Game play:**
  - Players take turns throwing the 4 axes and tallying their own scores.
  - In the sudden death round, the player with the highest round score wins! If after one round, there's still a tie, additional sudden death rounds are played until there is a clear victor!