

Apple Pencil

Apple Pencil uses Bluetooth® technology to connect to iPad Pro.

Pair and charge Apple Pencil

Pair and charge Apple Pencil with iPad Pro:

- 1 Lay iPad Pro on a flat surface.
- 2 Pull the top off the end of Apple Pencil to expose the Lightning connector.
- 3 Plug the end of Apple Pencil into the Lightning connector on iPad Pro.

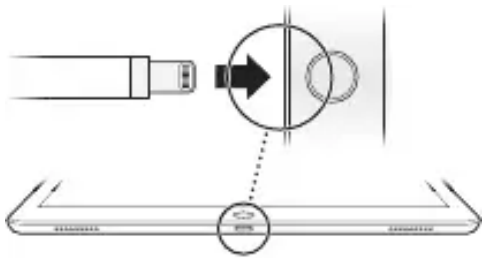

If Apple Pencil isn't paired with iPad Pro yet, this brings up onscreen instructions so you can complete the pairing process.

This also charges Apple Pencil.

To pair Apple Pencil with a different iPad Pro, repeat the process above.

Check the battery status of Apple Pencil:

You can check the battery status of Apple Pencil on the iPad Pro it's paired with.

- Swipe down from the top edge of the screen to open Notification Center, then tap Widgets.

Turn off Bluetooth:

- Swipe up from the bottom edge of any screen to open Control Center, then tap 

Note: This turns off Bluetooth on Apple Pencil as well as on your iPad Pro.

Unpair Apple Pencil and iPad Pro:

- On the paired iPad Pro, go to Settings > Bluetooth, tap  next to Apple Pencil, then tap Forget This Device.

Note: You can pair iPad Pro with only one Apple Pencil at a time, and pair Apple Pencil with only one iPad Pro at a time.

Charge Apple Pencil with the Apple Pencil Adapter:

- 1 Connect Apple Pencil to the recessed end of the Apple Pencil Adapter, then connect the Lightning to USB cable to the flat end of the Apple Pencil Adapter.

