



**IMMEASURABLY MORE**  
MINISTRY • OPPORTUNITY • REACHING • EQUIPPING

# IMMEASURABLY MORE

*Now to Him who is able to do IMMEASURABLY MORE than all we ask or imagine, according to His power that is at work within us, to Him be glory in the church and in Christ Jesus throughout all generations, forever and ever! Amen*  
Ephesians 3:20-21 NIV

# Meeting Overview

- Kurt Rosenhagen, Campaign Director
- Generosity Teaching, Pastor John Kieschnick
- Campaign Overview, Pastor Dan & Beth Koerber
  - The Vision
  - The “Why”
  - The Plan
- Questions
- Next Steps



**IMMEASURABLY MORE**  
MINISTRY • OPPORTUNITY • REACHING • EQUIPPING

# IMMEASURABLY MORE

*Now to Him who is able to do IMMEASURABLY MORE than all we ask or imagine, according to His power that is at work within us, to Him be glory in the church and in Christ Jesus throughout all generations, forever and ever! Amen*  
Ephesians 3:20-21 NIV

# IMMEASURABLY MORE will....

- Position Gloria Dei to serve the needs of Kids and Student Ministries with IMMEASURABLY MORE opportunities
- Improve and expand our facilities and increase our capacity to reach IMMEASURABLY MORE people with the message of Jesus Christ within and beyond our community
- Provide IMMESAURABLY MORE funding for our local and global partnerships
- Reduce our building debt IMMEASURABLY MORE to under \$500,000 (it was over \$10.3 million in 2013)



# IMMEASURABLY MORE

M – Ministry Expansion

O – Opportunity for Growth

R – Reaching our Community

E – Equipping Disciples



# The Plan

A \$5.5 million, 3 ½ year capital campaign

- 10% External Missions
- 10% Debt Reduction
- 80% Campus Improvements and Upgrades; Kids, Students and Family Ministry Expansion; Increased Gathering Spaces

# Why allocate 10% of the campaign to external missions?

- This models Biblical stewardship of first fruits giving (Giving 10% as a tithe outside of Gloria Dei)
- Provides us the opportunity for community outreach
- Positions Gloria Dei for Ready Response Preparedness
- Continues our support for Gloria Dei - Honduras and our CarePoint in Uganda

# Why allocate 10% of the campaign to debt reduction?

- This places Gloria Dei in an even stronger financial position to live out our mission
- Demonstrates fiscal responsibility
- For example:
  - In 2013, total indebtedness was \$10.3 million
  - 2024, total indebtedness is \$1 million
- A highly successful campaign will reduce our indebtedness to \$500K. Praise the Lord!!!!

# How will the remaining 80% of the funds be utilized?

- Campus Infrastructure needs
- Expansion of facilities
- Kids, Students, and Family ministry

# “Excel in the Grace of Giving”

2 Corinthians 8-9

Pastor John Kieschnick



# IMMEASURABLY MORE Capital Campaign

A funding initiative to raise \$5.5 Million over the next 3 ½ years



# Why a Capital Campaign?

- A strategic decision to focus on our Kids, Students, and Families
- Multiple infrastructure issues that must be addressed immediately and in the very near future
- An intentional process to raise the level of generosity and stewardship education at Gloria Dei
- A desire to create a larger space for congregational gatherings and community use
- A shift from “1-fund asks” to a strategic mechanism that funds specific capital projects without negatively affecting our day-to-day operations or ministry programs

# The problem to solve....

- A strategic focus to develop a “pipeline” of growth
  - Kindergarten-4<sup>th</sup> grades
  - 5<sup>th</sup>-6<sup>th</sup> grades
  - 7<sup>th</sup>-8<sup>th</sup> grades
  - High school
- With additional staffing in Kids ministry, we see outgrowing our current facilities....
- **How can we expand our current Kids area?**

# The “How”

A 3-part approach

# Part 1 – Main Building

80% of the first \$1 Million to be used in the main building.

# Part 1 – Main Building

## ■ Main Building Projects:

- Existing chapel bathrooms will be remodeled for ADA compliance
- 3 family bathrooms will be added throughout the building
- Worship center bathrooms upgraded
- Remove the leaking sky light in worship center commons.
- Improve the hospitality of the Dei Break seating area to include a “coffee bar” type seating area
- Replace and expand the damaged overhang by the entrance of the Life Center



# Part 2 – Construction of new building

## Part 2 – Construction of New Building

- Construct a new building attached to Student Center for staff
- This two-story building will also include on the back side of the staff offices a “shell” for a future multi-purpose space
- This new building will also have a dedicated space for the expansion of the “Nova Vita” counseling center
- Relocate church staff to new building



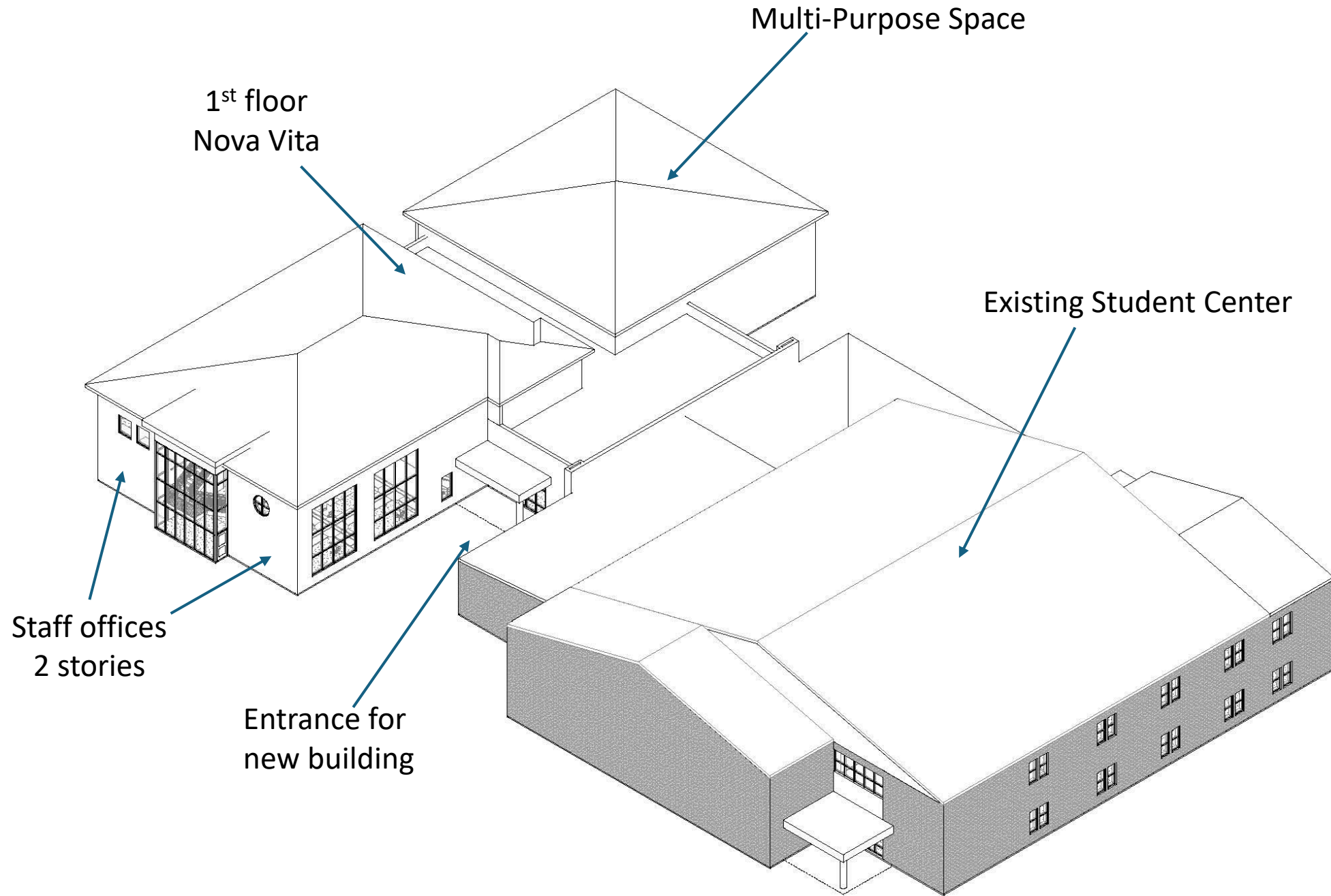

# Part 3 – Relocating Kids Ministry

# Part 3 – Relocating Kids Ministry

- Re-purpose 1st floor administrative offices for K-4 ministry
- Remodel 2nd floor administrative offices into a recording studio and classroom spaces
- Relocate Kids ministry (K-4) to new space



Kid  
Ministry  
• K-5TH GRADE

# Part 4 – Expansion of Life Center

# Part 4 – Expansion of Life Center

- Following the successful relocation of Kids Ministry Area
  - Expand current Life Center by removing long wall separating Kids area and Life Center
  - This will increase seating capacity from 400 to 600
  - Add two additional classrooms alongside the northernmost wall

# Long Range Vision

- Future Capital Campaign – 2028 will include:
  - The completion of the interior of the multi-purpose area (connected to admin. building)
  - Gathering space and outside kitchen
  - Parking Lot and access from Vinland
  - Construct an indoor playground and gathering area in Life Center courtyard

# Home Group Gatherings

- Sunday, September 29
  - 12:30pm – Stephanie Knea gathering (Chat room)
  - 3:00pm – Gary and Merry Bell home
  - 7:00pm – Larry and Molly Myers home
- Monday, September 30
  - 7:00 pm - Chuck and Pam Fimble Home
- Tuesday, October 1
  - 5:30pm - Pastor Nelson and Perla Rodriguez home
- Wednesday, October 2
  - 7:00pm - Harv and Carolyn Hartman Home
- Thursday, October 3
  - 7:00 pm – Rick and Becky Rosenhagen home
- Sunday, October 20 - Next Gen Gathering (Ages 25-35)
  - 6:00pm - Tee Box in Kemah, TX

# Gift Level Guide

There is a difference between  
 “fund raising” vs. “faith raising”  
 -Pastor K

# of Gifts	IMMEASURABLY MORE Gifts
1	\$1,000,000
1	\$750,000
# of Gifts	Impact Gifts
1	\$500,000
1	\$250,000
2	\$100,000
3	\$75,000
# of Gifts	Pacesetter Gifts
4	\$50,000
6	\$45,000
10	\$40,000
12	\$30,000
# of Gifts	Sacrificial Gifts
20	\$25,000
45	\$20,000
70	\$15,000
90	\$5,000
Many	As God Enables



# Sample gift chart

<b>Weekly Commitment</b>	<b>Total Commitment (182 weeks)</b>
\$10	\$1,820
\$15	\$2,730
\$25	\$4,550
\$50	\$9,100
\$75	\$13,650
\$100	\$18,200
\$250	\$45,500
\$350	\$63,700
\$500	\$91,000

# Various ways to think of your giving

- Some Ways to Give
  - Cash, Stocks or Bonds
  - Cash values of Life Insurance Policies
  - Income Tax refunds
  - Irrevocable or Revocable Trust
  - Matching company funds
  - Average pay increase, etc.

Equal Sacrifice, NOT Equal Giving

Giving is for 3.5 years, over and above your regular giving



# How Can I Participate?

- **PRAY** for God to pour out His grace on this campaign and its effects
- **PRAY** for guidance in the sacrificial giving God has prepared for you
- **USE** the Gift Profile as a guide in considering your commitment
- **RETURN** a Commitment Card
- **GIVE** sacrificially and joyfully, knowing that you are investing in the future of Gloria Dei
- **COMPLETE** your commitment by the end of 2027

# FAQ Sheet

# Resources

- Immeasurably More Website - <https://gdlc.org/more/>
- Bible study content
  - Blessed and Blessing
  - What Lutherans Believe.... About Stewardship
  - St. Paul and the Jerusalem Offering
  - Discovery Bible Study
- Small Group resources
- Campaign information
- Pastor K's teaching

# Fully Alive – Weekly Bible Study Resource



## FULLY ALIVE

# You were designed for more.

*Fully Alive is a digital community  
for developing your character  
and growing your influence.*

*Scan QR Code  
with your phone!*



JOIN FULLY ALIVE @  
[GDL.C.ORG/FULLYALIVE](https://gdlc.org/fullyalive)



# Important Dates

- Campus Prayer Walk September 24
- Vision Sunday September 29
- Prayer Workshop October 4-5
- Initial Commitments Announced October 20
- Commitment Celebration October 27
  - Return Commitment Card
  - One Service at 10am
  - Octoberfest following
- Give Thanks Sunday November 24



**IMMEASURABLY MORE**  
MINISTRY • OPPORTUNITY • REACHING • EQUIPPING

# IMMEASURABLY MORE

*Now to Him who is able to do IMMEASURABLY MORE than all we ask or imagine, according to His power that is at work within us, to Him be glory in the church and in Christ Jesus throughout all generations, forever and ever! Amen*  
Ephesians 3:20-21 NIV