

Pfaff 543 Subclass

PFAFF[®] 543

Unterklassen-Ausstattung

Subclass parts

Composition des sous-classes

Composición de las subclases

Subclass organizations')

Dotación de las subclases')

Unterklasse Subclass Sous-classe Subclasse	Ausführung Model Version Tipo de máquina	Nadelstange Needle bar Barre à aiguille Barra de aguja	Nadelhalter Needle holder Pince-aiguille Puntaaguja	Stoffschieber ^[1] Feed dog Griffe Transportador	Stichplatte ^[1] Needle plate Plaque à aiguille Placa de aguja	Nähfuß ^[1] Presser foot Pied presseur Pie prensateelas	Fingerschutz Finger guard Protecte-digits Salvadados	Niederhalter Work retainer Pied de maintien Pie de retención
-6/01	CN 8	91009678-91		91-491668-04	91-491669-04	91-040330-03	91-046864-25	
-6/01 -900/11;/51	CN 8	91-009678-91		91-059013-05	91-058704-05	91-040330-03	91-046864-25	
-6/01 -900/16;/56	CN 8	91-009678-91		91-059013-05	91-058958-05	91-040330-03	91-046864-25	
-6/01	CN 10	91-710484-92		91-047850-04	91-058495-04	91-051323-93	91-046864-25	
-6/01 -900/11;/51	CN 10	91-710484-92		91-059012-05	91-058703-05	91-040330-03	91-046864-25	
-6/01 -900/16;/56	CN 10	91-710484-92		91-059012-05	91-058959-05	91-040330-03	91-046864-25	
-55/02	CN; DN	91-009678-91		91-040417-04	91-058678-04	91-051144-93 ^[3]		
-712/01 -6/01	B	91-011870-05	91-002025-92		91-058012-91	91-057182-05	91-055247-21	
-712/02 -6/01	B	91-011870-05	91-002025-92		91-058012-91	91-057182-05	91-055247-21	
-944/01	CN; DN	91-009678-91		91-040417-04	91-058678-04	91-051255-93	91-009492-91	
-944/01 -900/11;/51	CN	91-009678-91		91-047999-05	91-058686-05	91-051255-93	91-009492-91	
-944/01 -900/16;/56	CN	91-009678-91		91-047999-05	91-058842-04	91-051255-93	91-009492-91	
-944/01	CN 8; DN 8	91-009678-91		91-040417-04	91-058678-04	91-054648-93		91-049666-03
-944/01 -900/11;/51	CN 8	91-009678-91		91-047999-05	91-058686-05	91-051255-93	91-009492-91	
-944/01 -900/16;/56	CN 8; C/DN 8	91-009678-91		91-047999-05	91-058842-04	91-051255-93	91-009492-91	

¹⁾ Die Liste enthält nur die reinen Unterklassenteile und nicht die Teile, die für den Umbau in eine andere Ausführungsart erforderlich sind, wie z. B. von Ausführung „CN 8“ in „CN 10“ usw. Geben Sie daher bei der Bestellung von Umbauteilen die vollständige Bezeichnung der vorhandenen und der gewünschten Maschine an.

¹⁾ This list contains only pure subclass parts and not parts which are necessary for converting a machine to another model, as, for example, from model „CN 8“ to „CN 10“ etc. For this reason please always state the full number of the existing version and the new version required when ordering conversion parts.

¹⁾ Cette liste ne mentionne que les pièces de la sous-classe et non celles nécessaires pour transformer la machine en une autre version, par ex. de la version „CN 8“ en „CN 10“, etc. En cas de commande de pièces de transformation, veuillez donc préciser la désignation complète du modèle existant et celle du nouveau modèle désiré.

¹⁾ Esta lista sólo contiene las piezas propias de la subclase y no las necesarias para la transformación en otro tipo de máquina, del tipo „CN 8“ al „CN 10“ por ejemplo. Por tanto, siempre que se haga un pedido de piezas para transformar una máquina, deberá indicarse la denominación completa del tipo de máquina que se tiene y del tipo deseado.

[1] = Ausführung angeben
= Indicate model
= Préciser la version
= Indicar el tipo de máquina

[1] = Nähmuster einsenden
= Submit sewing sample
= Joindre échantillons de couture
= Enviar muestra de costura

Unterklassen-Übersicht / Table of subclasses / Table des sous-classes / Tabla de subclasses

91-009 678-91

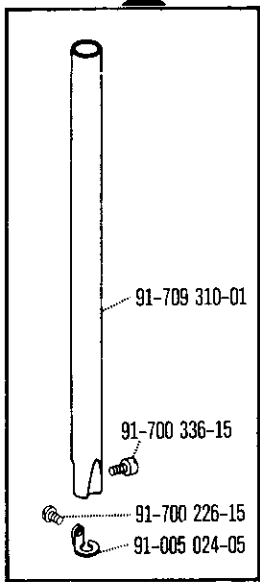

91-011 870-05



91-710 484-92

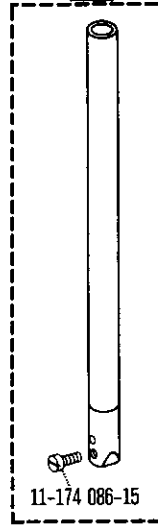

91-002 025-92

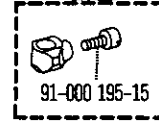

91-049 666-03



91-040 417-04 ◻



91-047 850-04 ◻

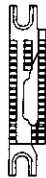

91-047 999-05



91-059 012-05



91-059 013-05



91-491 668-04 ◻



91-058 012-91



91-058 495-04 ◻



91-058 678-04 ◻

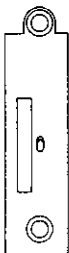

91-058 686-05

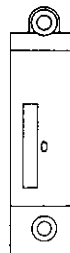



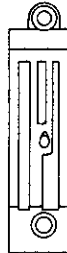





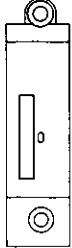



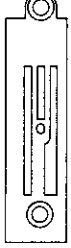

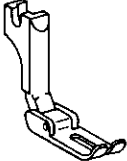

91-058 703-05

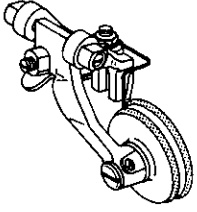

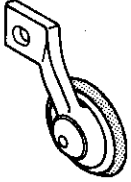
91-058 704-05

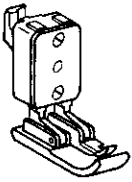

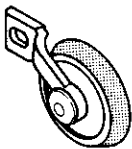
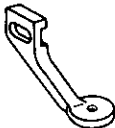
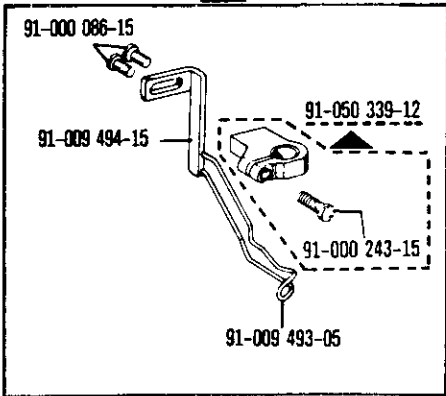
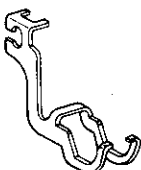
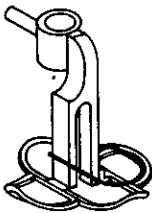
<p>91-058 842-04 </p> 	<p>91-058 958-05</p> 	<p>91-058 959-05</p> 	<p>91-491 669-04 </p> 
<p>91-040 330-03 </p> 	<p>91-051 144-93   </p> 	<p>91-051 255-93 </p> 	<p>91-051 323-93 </p> 
<p>91-054 648-93 </p> 	<p>91-057 182-05</p> 	<p>91-009 492-91</p> 	
<p>91-046 864-25</p> 	<p>91-055 247-21</p> 		

PFAFF INDUSTRIEMASCHINEN GMBH KAISERSLAUTERN