

# Amtico Signature

## Class 1 Building Product Information Sheet

SIG-BPI-20240202-02-NZ

Product description and its intended use:	<p>Amtico Signature is a premium collection of LVT design-led flooring which allows you to choose from an inspirational range of designs and laying patterns to create a unique solution for your space. Suitable for Commercial and Residential use.</p> <ul style="list-style-type: none"><li>• Thickness: 2.5mm</li><li>• Wear Layer: 1mm</li><li>• Weight: 3.15kg/m<sup>2</sup></li><li>• Warranty: Residential - Lifetime. Commercial - 25 Years</li><li>• Fire Critical Radiant Flux, (ISO 9239-1: 2010): &gt;4.5 kW/m<sup>2</sup></li></ul>
Product identifier:	Amtico Signature (AR0Axxxx, AR0Sxxxx, AR0Wxxxx, AR0Dxxxx, AR0Bxxxx, AR0Cxxxx, AR0Mxxxx, DESxxx, AR0Dxxxx, DCxxx, AR0Dxxxx, EPxxx)
Place of manufacture:	Overseas
Legal and trading name and address of the manufacturer(s):	<b>Amtico International Pty Ltd</b> Unit 1, 40 Mill Street Yarrabilba 4207, Australia
Website:	<a href="http://www.amtico.com">www.amtico.com</a>
Email address:	<a href="mailto:Peter.Branch@amtico.com">Peter.Branch@amtico.com</a>
Phone number:	+ 61 (0) 7 5620 5789
NZBN:	N/A
Legal and trading name and address of the importer:	<b>Belgotex</b> 25 Leslie Hills Drive, Riccarton Christchurch, New Zealand
Website:	<a href="http://www.belgotex.co.nz">www.belgotex.co.nz</a>
Email address:	<a href="mailto:info@belgotex.co.nz">info@belgotex.co.nz</a>
Phone number:	+ 64 3 349 2140
NZBN:	N/A
Relevant Building Code clauses:	<ul style="list-style-type: none"><li>• B2 Durability: Performance clauses B2.3.1(c) (i) and (ii)</li><li>• C3.4 (b) Fire Affecting Areas Beyond the Fire Source, Provisions</li><li>• D1.3.3 (D) Access Routes, adequate slip-resistance.</li><li>• E3.3.3 Internal Moisture. Cleaning of floor surfaces.</li><li>• F2.3.1 Emission of hazards compounds</li></ul>
Statement on how the building product is expected to contribute to compliance:	<ul style="list-style-type: none"><li>• B2 Durability: Performance clauses B2.3.1(c) (i) and (ii). Amtico Signature is warrantied against wear-out for life in a Residential installation and 20 years in Commercial environments. Full warranty details are available at <a href="http://www.amtico.com/commercial/technical/">www.amtico.com/commercial/technical/</a></li><li>• C3.4 (b). Amtico Signature has a Critical Radiant Flux &gt;4.5 kW/m<sup>2</sup> (ISO 9239-1: 2010).</li><li>• D1.3.3 (D) Amtico Signature has been tested to AS/NZ 4586:2013 Appendix A: P 3-5 (Dependant on Emboss), Appendix C: R10</li><li>• E3.3.3 Amtico Signature is easily cleaned and maintained. See cleaning and maintenance guide.</li><li>• F2.3.1 Amtico signature is a low VOC emitting product and has been tested to the requirements of Eurofins Indoor Air Comfort Gold and Floor Score.</li></ul>
Limitations on the use of the building product:	<ul style="list-style-type: none"><li>• Amtico Signature is only suitable for internal installation, bonded to a suitability prepared, dry subfloor surface.</li><li>• Amtico Signature can be installed over an under floor heating system where the temperature at the adhesive interface does not exceed 27°C.</li><li>• Installations where direct sunlight is anticipated, or where underfloor heating is installed should be bonded with a suitable temperature resistant adhesive.</li></ul>

# Amtico Signature

## Class 1 Building Product Information Sheet

SIG-BPI-20240202-02-NZ

Design requirements that would support the appropriate use of the building product:	<ul style="list-style-type: none"><li>• Amtico Signature is a durable floor covering with a minimum 20 year wear out warranty</li><li>• Amtico Signature has low flammability properties which far exceed the required critical radiant flux requirements detailed in Table C3.4(b).</li><li>• Amtico Signature has a low slip resistance rating, AS/NZ 4586:2013 Appendix A: P 3-5 (Dependant on Emboss), Appendix C:R10.</li><li>• Amtico Signature is a low VOC product</li></ul>
Installation requirements	See below
Maintenance requirements	See below
Is the building product/building product line subject to warning or ban under section 26 of the Building Act 2004?:	No
If yes, description of the warning or ban under section 26:	N/A
Date	05.09.23

# Amtico Signature

## Installation Guidelines

### Introduction & areas of use

Installation of Amtico tiles is straightforward, and follows the same guidelines that apply to all quality resilient tile floors.

Amtico Signature, Spacia and Form are suitable for use in most heavy commercial and residential areas.

Amtico First is designed for light commercial use.

Amtico Signature 36+ & Spacia 36+ are designed for commercial areas where sustainable enhanced slip resistance is required.

In all cases Amtico International products are not suitable for external installation or in unheated locations.

All 915x915mm (36x36") product should be installed in a tessellated format.

Note: For all acoustic backed products please consult the separate Acoustic installation guide.

### Receiving materials, conditioning & storage

Before laying flooring, all materials must be checked to ensure that the batches are identical and free from defects. Complaints with regard to clearly identifiable defects cannot be accepted once the flooring has been laid.

Boxes of tiles should be removed from pallets and separated from one another as part of the acclimatisation process. Ensure that the heating/air conditioning is fitted and operating. Alternatively, temporary heating or cooling may be used to maintain a constant temperature within the specified range.

Tiles, adhesive and subfloor must be allowed to stabilise to a constant temperature between 18°C-27°C for a period of at least 24 hours before, during and after installation. If tiles and adhesive have been stored outside of this temperature range, then it is recommended that acclimatisation is increased to 48 hours. Tiles must be stored flat and kept away from direct sunlight, heaters or air vents for proper conditioning.

Preparation and Installation should not begin until all other trades have been completed.

### Tile Directionality

All Amtico planks and tiles have arrows on the back, indicating the direction of the product grain. Care should be taken to ensure these directional arrows are followed, unless a laying pattern requires product to be rotated to achieve the desired look.

With stripping, please note not all strips will have directional arrows on the back of the product. Visual checks should be made to ensure stripping is installed in the same direction, to guarantee a uniform finish. Particular care needs to be taken with metallic stripping as product directionality can more be obvious.

### Subfloor Preparation

The suitability of subfloors and site conditions must be assessed prior to beginning an installation to ensure that they are in accordance with Amtico International and subfloor manufacturers' guidelines and national standards.

Good preparation is essential as the finished appearance of the floor will only be as good as the quality of the base and preparation over which it is installed. The base should be hard, smooth, clean, dry and free from defects. The surface should be even in order to achieve good fitting and adhesion. Any irregularities in the subfloor will show through the finished floor.

The guidance notes provided by Amtico International are intended to give general information on the methods that can be used to prepare various subfloor types.

The quality and preparation of subfloors, testing for moisture content and relative humidity, and installation procedures must be in accordance with Amtico International technical guidelines and country specific standards (BS 8203 and BS 8204 for UK).

### Moisture in Subfloors

Moisture testing of all subfloors is essential before installation can begin. This is true of new and old buildings. Moisture testing must be carried out and recorded. All moisture tests must be undertaken in accordance with local regulations (e.g. BS 8203 for UK) and using an appropriate method to suit the subfloor type.

The subfloor may be considered dry when the relative humidity is 75% or below.

If readings are above this level, a surface damp proof membrane can be applied. Consult manufacturers for instructions. Alternatively subfloors can be given sufficient time to dry.

### Solid subfloors

#### Concrete / Sand and Cement

Tiles must only be installed on suitably dry concrete or sand and cement subfloors. Drying time will depend on several conditions, including thickness of slab, location, type of construction, temperature and humidity. New concrete bases contain a high percentage of residual moisture.

Subfloors must be thoroughly mechanically cleaned of all paint, curing agents, grease, wax and any other foreign matter. The use of solvents to remove surface contaminants is not permitted.

The floor must be hard, smooth, level and free from cracks. Use a suitable repair compound to fill grooves, cracks, holes and depressions.

Please refer to section titled Levelling / Smoothing Compounds for Solid Subfloors.

#### Power Floated Concrete

Power floated concrete has a relatively non-absorbent, low porosity surface which will increase the drying time. It is not a suitable surface for direct application of adhesive. Surface laitance may also be produced by the power floating procedure. For these reasons, it is recommended that an appropriate method of mechanical preparation such as shot blasting or scarifying is used to prepare the surface.

Please refer to section titled Levelling / Smoothing Compounds for Solid Subfloors.

#### Anhydrite (Calcium Sulphate)

Anhydrite screeds can be difficult to identify and can be mistaken for the more traditional cement based products.

Provided ambient conditions are acceptable, anhydrite screeds dry at a similar rate to their cement-based counterparts. In the case of the floor screed not being sufficiently dry please consult the manufacturer on how to proceed, in most cases the screed should be allowed to dry out to an acceptable level.

When the floor is sufficiently dry preparation can begin. Please refer to section titled Levelling / Smoothing Compounds for Solid Subfloors.

#### Asphalt

Mastic asphalt is normally applied between 15 and 20 mm thickness and sets to a dense hard mass which is impermeable to moisture and therefore forms an efficient damp-proof membrane. Mastic asphalt is often applied over an existing concrete base which lacks a conventional DPM. If the asphalt is cracked or damaged it will need to be repaired and damp proofing may be required.

The asphalt will need to be cleaned before preparation can begin. Please refer to section titled Levelling / Smoothing Compounds for Solid Subfloors.

### Levelling / Smoothing Compounds for Solid Subfloors

Most solid subfloors will require an application of a compatible compound to provide a hard, smooth and level surface to which adhesive and tiles can be applied.

The selection of a suitable compound is critical in determining the long term durability and appearance of the flooring system. Generally these compounds should be applied at a minimum of 3 mm thickness. The manufacturer of this compound can supply details of the product within their range that should be used to suit the end use application together with details of which primer should be used.

### Expansion Joints

Expansion joints are incorporated into concrete floor slabs in order to permit movement without causing cracks to form. These joints should not be filled with smoothing compound or overlaid with Amtico floor coverings. In all cases they should be mirrored through to the surface.

# Amtico Signature

## Installation Guidelines

### Timber floors

#### Existing Floorboards

Loose floor boards should be firmly nailed down and any damaged boards replaced. If necessary, the boards should be planed and/ or levelled with a suitable levelling compound prior to covering with plywood. See section on Plywood Overlays.

Wood subfloors that exhibit excessive deflection, or are “springy” or “give” when walked on are not suitable for installing Amtico tiles unless suitable remedial work is carried out.

#### Chipboard, Hardboard, Particleboard

Tiles should not be adhered directly to such subfloors whether they are free floating or fixed, and floors should always be overlaid with plywood prior to installation of tiles. See section on Plywood Overlays.

#### Wood Block Floors

Existing wood block floors laid onto a concrete base are unsatisfactory as an underlayment for resilient floors, even when plywood has been fitted. Such floors must be lifted and the subfloor suitably prepared.

#### Plywood Overlays

Plywood should be a minimum nominal thickness of 5.5 mm with a Plywood classification EN636-2 or 3, and a glue bond classification EN314-2 Class 3 Exterior. The thickness selected should be determined by the quality of the surface being covered.

Panels should be acclimatised to the site conditions as recommended by the supplier. Plywood should be protected against damage or water prior to application.

The plywood should be laid in sheet sizes not exceeding 2440 x 1220 mm, and fixed using screws or ring shank nails. Fixings should be 2.5 times the depth of the plywood selected, but should not protrude below the timber base. Fixing should start at the centre of each sheet – screwing or nailing at 150 mm intervals at intermediate centres and at 100 mm centres along the perimeters with the fixing line 12 mm from the edge. All fixings should be finished flush with the surface.

Joint lines should be staggered, and every effort made to prevent coincidence of joints in the sheets and the timber base.

We would recommend the use of a suitable compound to ensure the joints of the plywood and all fixings are not visible when the installation is complete. The manufacturer of this compound can supply details of the product within their range that should be used to suit the end use application together with details of which primer should be used.

### Other subfloor types

#### Existing Resilient Floors

It is recommended that Amtico products are not directly applied over existing resilient floors (with the exception of Amtico Access and Amtico Click). Generally, the old flooring should be removed and the base prepared to suit the type of subfloor uncovered. Please refer to relevant section.

Some older resilient tiles and adhesives can contain asbestos. In case of doubt, contact the relevant local authority for advice on their removal and disposal.

#### Terrazzo, Stone, Quarry tiles

Some existing flooring materials such as quarry tiles, ceramic or terrazzo may be suitable for the installation of Amtico tiles if properly prepared. These bases may be sufficiently porous to allow moisture to pass through to the back of the tile, and must be checked for moisture and damp-proofed if necessary. Worn and damaged areas must be repaired, including any tiles that are insecure, which must be removed.

The surface must be thoroughly cleaned of all sealants and varnishes, as well as foreign matter such as oil, grease, wax, etc. It is recommended that a suitable mechanical method is used to prepare the surface, as this will also provide a satisfactory surface ready for preparation. Please refer to section titled Levelling / Smoothing Compounds for Solid Subfloors.

### Metal

#### (i) Direct Application

The metal surface should be cleaned/degreased and then prepared by grinding or scarifying to ensure that it is clean and free from any contamination, such as rust or metal oxide. It should then be mechanically abraded to give a surface key. Amtico tiles can then be installed onto the prepared surface using Amtico International Universal 2-Part Adhesive.

Note that under no circumstances should a water-based adhesive be used for bonding directly to metal.

#### (ii) Indirect Application

The metal surface should be cleaned/degreased and then prepared by grinding or scarifying to ensure that it is clean and free from any contamination, such as rust or metal oxide. It should then be mechanically abraded to give a surface key.

A suitable primer should be applied to the metal surface prior to putting down a suitable compound, which must be applied as recommended by the manufacturer.

Once the levelling compound has dried, any adhesive from our range can potentially be used subject to the restrictions described in the Adhesive Section.

#### Raised Access Floors

Amtico tiles cannot be fitted directly to raised floor panels. Where this is required, the panels should be level and stable, and then overlaid with plywood, using appropriate fixings to suit the panels surface – see section on Plywood Overlays.

Note that Amtico Access has been specifically developed for fitting directly onto raised access floor panels.

#### Underfloor Heating

There are various types of underfloor heating systems available – including hot water pipes embedded in the subfloor and electrical systems that can be laid onto the surface of the subfloor. In all cases, the temperature limitations are the same – the heating system must operate so that the temperature at the subfloor surface (i.e. the adhesive interface) should not exceed 27°C.

The heating system must be commissioned before the floor tiles are installed, to ensure that the subfloor is stable, the heating system is working as required with no leaks or cable breaks.

Underfloor heating should be switched off for 48 hours before, and should not be switched back on until 48 hours have elapsed after installation. It is recommended that the heating is slowly re-applied avoiding full operating temperature for 7 days.

With underfloor heating systems, it is the responsibility of the manufacturer and/or installer to recommend appropriate procedures and materials for producing a surface suitable for installing floor tiles. For electrical systems, this will require that the heating elements are fully embedded in a well-bonded and appropriate levelling compound, and that the temperature is adequately controlled to maintain the temperature at the subfloor surface at a maximum of 27°C.

Care should be taken in the placing of large insulating items such as rugs, beanbags and towels onto floors containing underfloor heating. This can result in localised “hot-spots” which may lead to discolouration of the tiles. No responsibility can be accepted under these circumstances.

# Amtico Signature

## Installation Guidelines

### Adhesive Selection & Application

#### Recommended Adhesives

Only Amtico adhesives should be used – others may not give adequate performance and could fail.

#### Amtico SF Adhesive

SF Adhesive is a very low emissions (EC1 Plus), water-based acrylic adhesive with a working time of 1 hour that is recommended for use in all areas except those subject to heat and moisture.

#### Amtico PS Adhesive

PS Adhesive is a water-based acrylic adhesive that has an extended working time of 3 hours and is recommended for all areas except those subject to temperature change or moisture.

#### Amtico HT Adhesive

HT Adhesive is a very low emissions (EC1 Plus), single-part, wetset water-based acrylic adhesive that has very good temperature resistance; it has a working time of 30 minutes.

It is recommended for areas subject to some heat variations, such as conservatories and areas receiving direct sunlight. It is also suitable for use where underfloor heating has been installed.

#### Amtico HT Extra Adhesive

Amtico HT Extra is a single part, wet set, water based adhesive with very low emissions (EC1 Plus): it has a working time of 20 minutes.

Recommended for all areas, including those with heat variation and underfloor heating.

#### Amtico Universal 2-Part Adhesive

Universal 2-Part Adhesive is a wet-set adhesive that can be used for bonding Amtico tiles in wet areas such as bathrooms. It may also be used for high temperature areas. Universal 2-Part has a working time up to 60 minutes, is entirely solvent free and classified as EC1R Plus very low emissions

#### Application:

Follow the instructions on the packaging. Spread adhesive evenly using an A2 trowel. Do not use worn trowels.

Only spread sufficient adhesive that can be covered within the recommended working time.

Tiles should be rolled with a 45kg (100lbs) roller after installation to flatten the adhesive ridges, and then again approximately 20 minutes after this to ensure full contact.

Always clean away excess adhesive before it is allowed to dry – use a soft cloth moistened with Amtico Adhesive Remover. Dried adhesive can be removed by carefully scraping it off the tile, or by using a 3M red pad moistened with Amtico Adhesive Remover.

# Amtico Signature

## Maintenance Guidelines

### Daily Sweeping and Dust Mopping

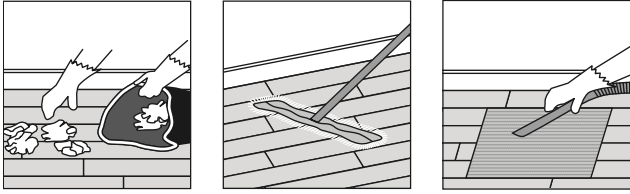

- Pick up litter and thoroughly sweep floor area using a dry dust mop
- Pick up debris with a dustpan and brush
- Vacuum entrance mats and crevices at all entrances

### Manual Mopping

Manual mopping is used for soil removal in small or congested areas (including within large floors) and some mark removal. Spray cleaning may be required for heavier surface marking.

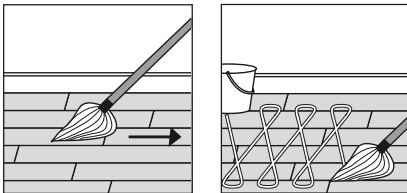

- Put out caution signs to warn people that cleaning is in progress
- Prepare a solution of Amtico Maintainer diluted in accordance with the instructions on the label
- Using a two-bucket mopping system, apply solution using a damp mop to remove soiling
- Mop using overlapping strokes
- Rinse the mop frequently and change the solution as necessary
- Allow entire floor area to dry thoroughly
- Remove caution signs
- Ensure all equipment is cleaned thoroughly after use and stored safely

#### Tips

- In conditions of heavy soiling, perform a pre-wash by preparing a solution of Amtico Maintainer diluted in accordance with instructions on the container and pre-wash heavily soiled areas
- Where dirt has become ingrained over time we would recommend that the floor is deep cleaned
- To help remove stubborn scuff marks use a non abrasive 3M red pad or equivalent
- Any surface marking that is not removed by routine manual mopping may be removed by occasional spray cleaning
- Spills of water, grease, food, chemicals and other foreign matter or use of inappropriate cleaning products may cause the floor to become slippery. Wipe up spills immediately with an absorbent cloth, then wash thoroughly with a properly diluted solution of Amtico Maintainer or Spillage Remover until the spill area is completely clean. Rinse and allow to dry thoroughly
- At least once a year the floor should be scrubbed thoroughly to remove in-grained dirt and floor dressing if applied

### Spray Cleaning

Spray cleaning can be used for light soil removal in small/medium size areas and removal of most scuff marks from all floor sizes.

In conditions of heavy soiling, perform a pre-wash by preparing a solution of Amtico Maintainer diluted in accordance with the manufacturer's instructions and pre-wash heavily soiled areas.

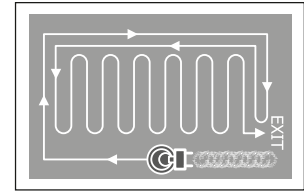
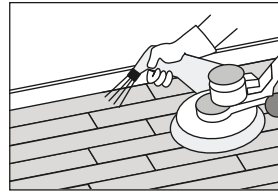

- Put out caution signs to warn people that cleaning is in progress
- Pour a diluted solution of Amtico Maintainer solution in to a suitable spray container
- Apply a fine mist of liquid on to an area of approximately 2 square metres at a time. Use a rotary buffing machine (approx. 450 rpm) fitted with a red 3M nylon scrubbing pad (or equivalent). Do not buff with any pad more abrasive than a red 3M (or equivalent) pad
- Work in parallel overlapping passes until the floor is clean and dry
- Allow entire floor area to dry thoroughly
- Remove caution signs
- Ensure all equipment is cleaned thoroughly after use and stored safely

#### Tips

- Where dirt has become ingrained over time we would recommend the floor is deep cleaned
- Spills of water, grease, food, chemicals and other foreign matter or use of inappropriate cleaning products may cause the floor to become slippery. Wipe up spills immediately with an absorbent cloth, then wash thoroughly with a properly diluted Amtico Maintainer or Spillage Remover until the spill area is completely clean. Rinse and allow to dry thoroughly
- At least once a year the floor should be scrubbed thoroughly to remove in-grained dirt and floor dressing if applied

### Scrubber Drying – Large Areas

Scrubber drying can be used for soil removal in large installations and some mark removal.

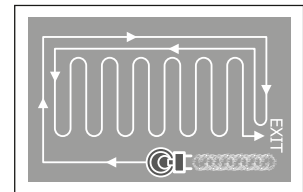

- Put out caution signs to warn people that cleaning is in progress
- Prepare a solution of Amtico Maintainer and pour in to the dispensing tank. The scrubber dryer should be fitted with a red or blue 3M nylon scrubbing pad (or equivalent) or brush
- Scrub entire floor area
- Ensure vacuum pick up is operating efficiently
- Once entire floor area is dry remove caution signs
- Ensure all equipment is cleaned thoroughly after use and stored safely

#### Tips

- Spills of water, grease, food, chemicals and other foreign matter may cause the floor to become slippery. Wipe up spills immediately with an absorbent cloth, then wash thoroughly with a properly diluted solution of Amtico Maintainer until the spill area is completely clean. Rinse and allow to dry thoroughly
- Any surface marking that is not removed by scrubber drying, may be removed by occasional spray cleaning
- Soiling in congested areas should be removed using manual mopping
- At least once a year the floor should be scrubbed thoroughly to remove in-grained dirt and floor dressing if applied

# Amtico Signature

## Maintenance Guidelines

### Guide to Stripping and Deep Cleaning

- Before commencing work, put out caution signs to warn people that cleaning is in progress
- Sweep floor to remove debris and vacuum entrance mats
- Prepare a solution of Amtico Stripper using warm water as per instructions on the label
- Carefully follow all safety instructions, particularly noting that the floor can become slippery during the stripping process

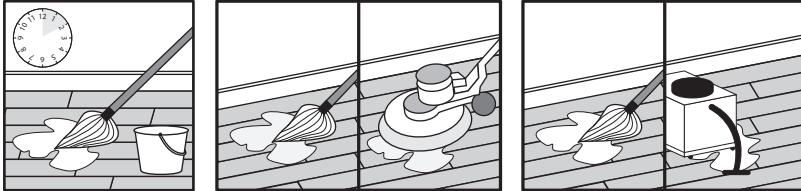

- Apply plenty of solution over a manageable area using a mop and bucket. Allow 10-15 minutes contact time
- Agitate the solution using either a low speed rotary machine with a green 3M (or equivalent pad) or with a mop. Edges will need to be agitated manually. Do not allow the slurry to dry
- Remove slurry with wet vacuum machine or mop and bucket. Rinse floor twice with clean water, allow to dry
- Remove caution signs
- Ensure all equipment is cleaned thoroughly after use and stored safely

### Guide to Application of Dressing

If a protective finish is required or if you are seeking to restore the appearance of an older Amtico tile floor, an application of Amtico Dressing is an option.

Dressings can be applied following stripping of Amtico tile floors. Ensure floor is clean and completely dry prior to applying dressing. Do not use the same equipment for stripping as that used for application of Amtico Dressing.

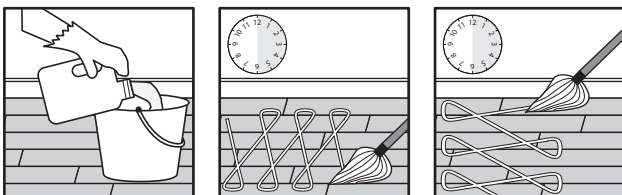

- Pour a quantity of Amtico Dressing into bucket
- Load a clean flat applicator mop with dressing
- Starting at the furthest point from the exit apply a thin even coat around the perimeter and fill in with overlapping passes and allow to dry (for approx 30 minutes in good ventilation)
- Apply a second coat at right angles to the first. Allow to dry
- Do not buff for 24 hours
- All equipment should be cleaned thoroughly after use and stored safely