



HOW TO INSTALL

# *Procreate Brushes*

---

GOOD



STUFF

RSCO DEPT. OF INSTRUCTIONS

# Getting Started

There are several ways to install Procreate brushes. The method you choose will depend on if you're working on a Mac, PC, or just on your iPad. Use the index below to proceed to the pages with the right tutorial for you!

Mac User Tutorial .....	2-3
PC User Tutorial .....	4-5
iPad Only Tutorial .....	6-7

## Want more Procreate brushes?

Just click the button below to see our collection of Procreate brushes.

CLICK HERE

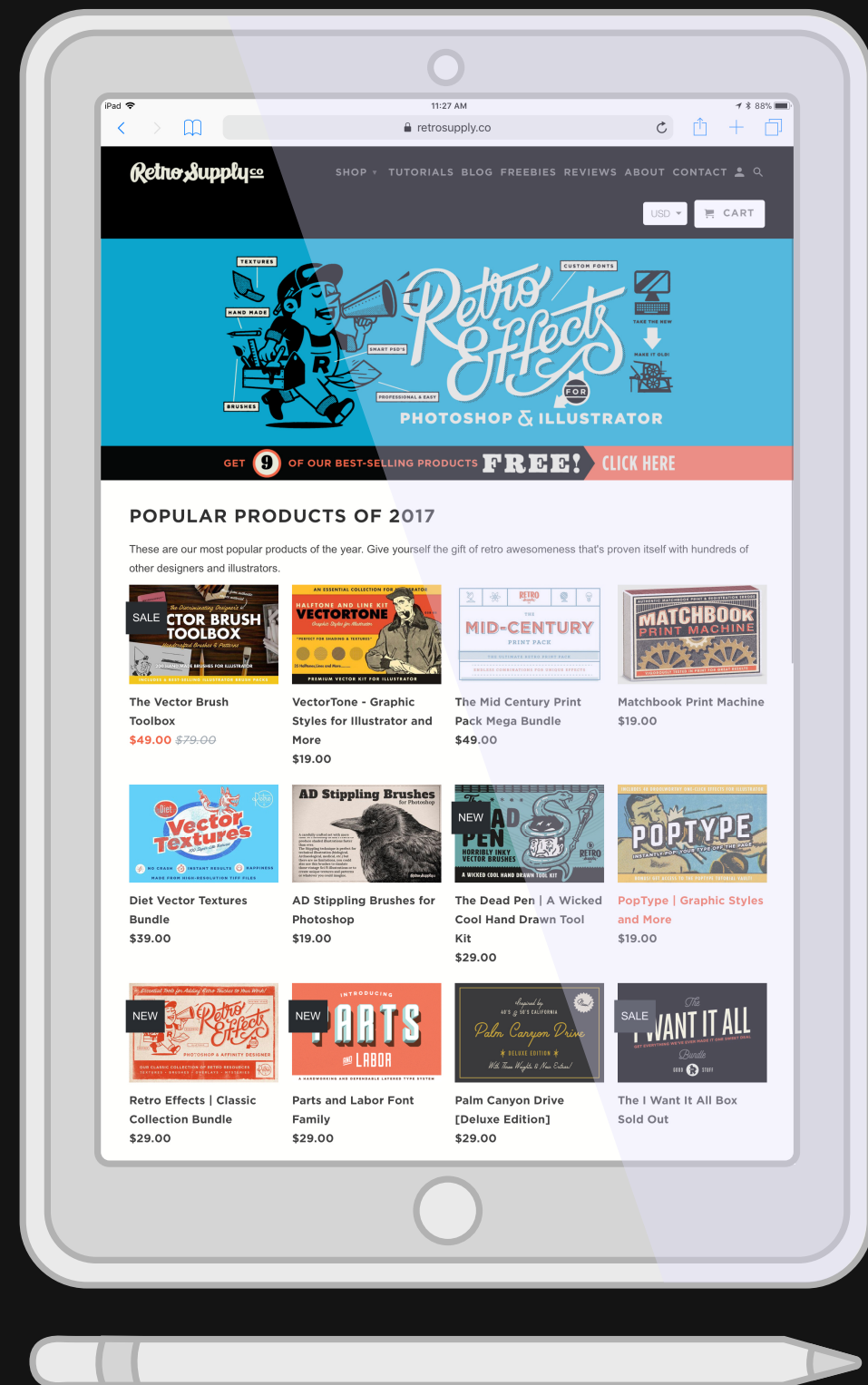



# MAC USER TUTORIAL

## Step One ACTIVATE AIRDROP

Open the Control Center on your iPad by swiping up from the bottom of your screen. Click the AirDrop icon.



Choose Everyone from the menu to make your iPad discoverable.

## Step Two IMPORT BRUSHES FROM MAC

Find the brush files on your Mac and select them all. Drag and drop the files into your AirDrop folder.

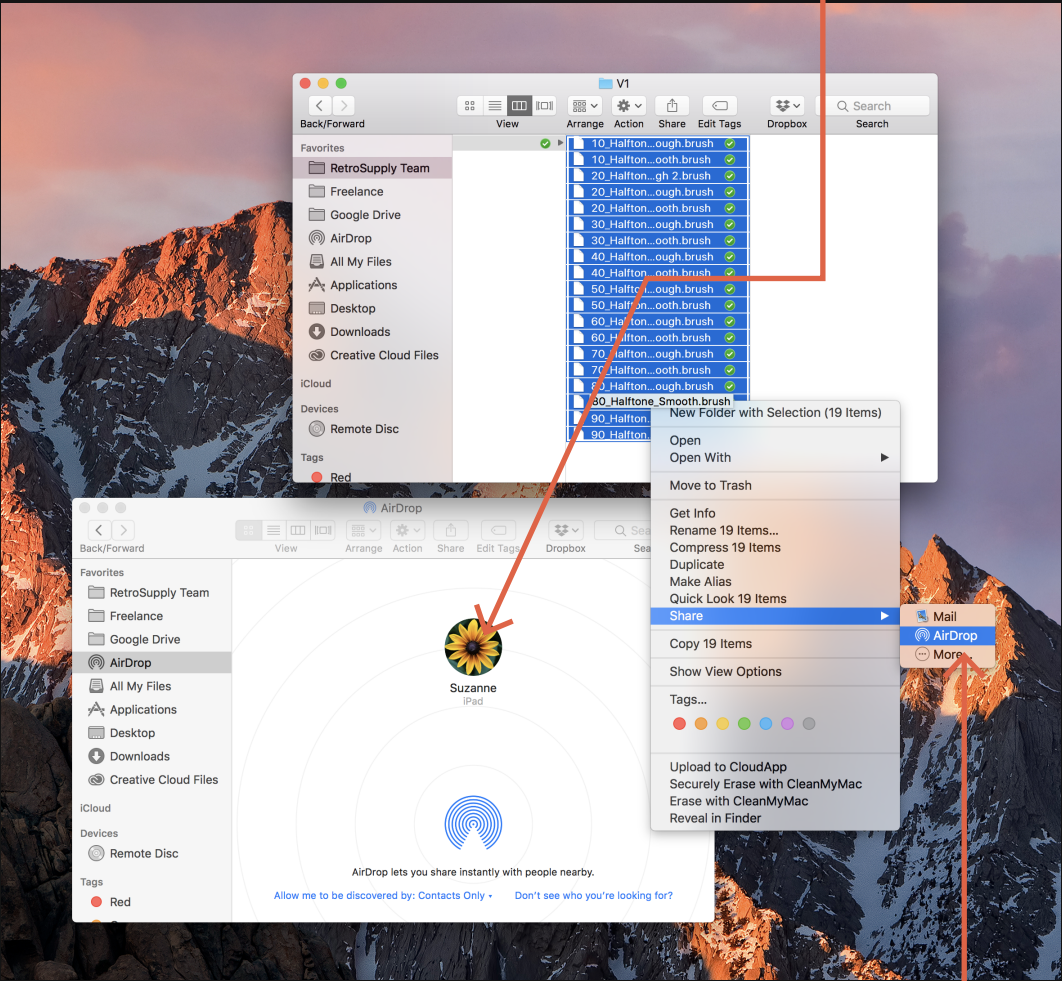

You can also right click on the files and choose Share > AirDrop.

# MAC USER TUTORIAL

## *Step Three* FIND THE BRUSHES IN PROCREATE

Procreate will automatically open and the brushes will be installed instantly. Click the brush.

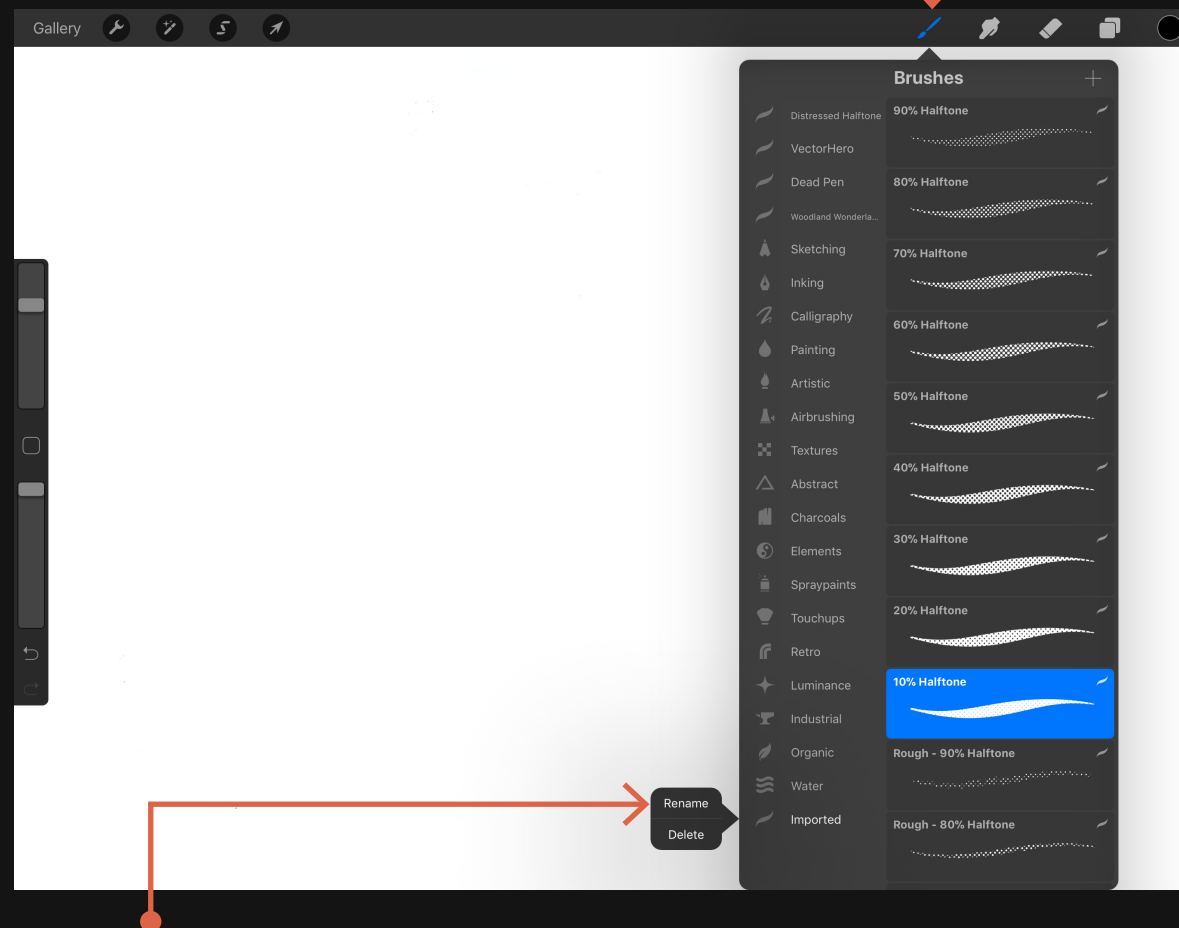

Your new brushes will be in a folder titled “Imported”. To change the name, just click the folder and choose Rename. Be sure to rename the folder before you import more brushes.

# PC USER TUTORIAL

## *Step One* UPLOAD BRUSHES TO THE CLOUD

Once you have downloaded the files onto your computer, move them into a cloud service, such as iCloud Drive, Dropbox, or Google Drive.



Download the app for that cloud service onto your iPad.

## *Step Two* CREATE NEW BRUSH SET

You will need to create a new brush set to import the brushes into. Click New Set and name the folder accordingly.

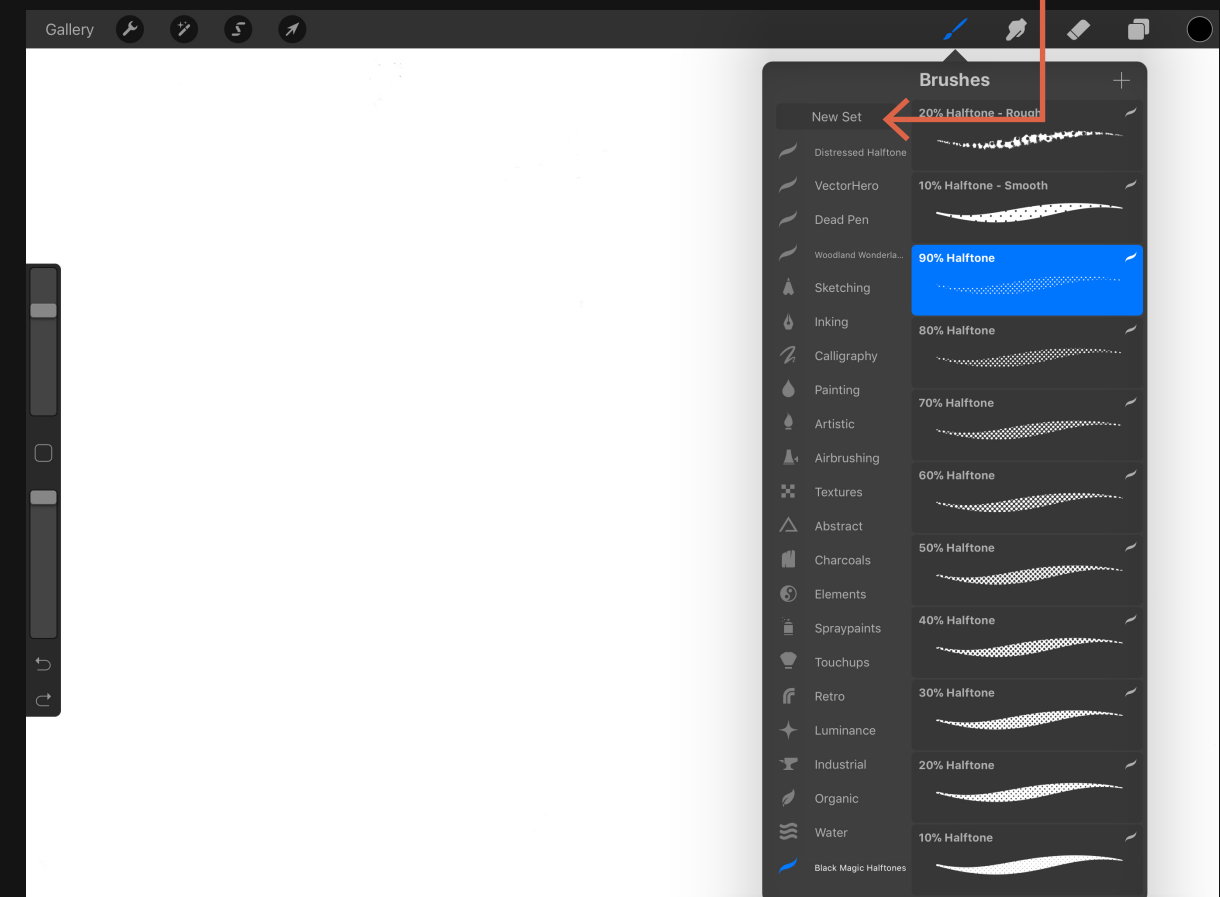



# PC USER TUTORIAL

## Step Three IMPORT BRUSHES FROM THE CLOUD

Open Procreate. Click the brush icon and then the plus icon in the top right hand corner of the menu.

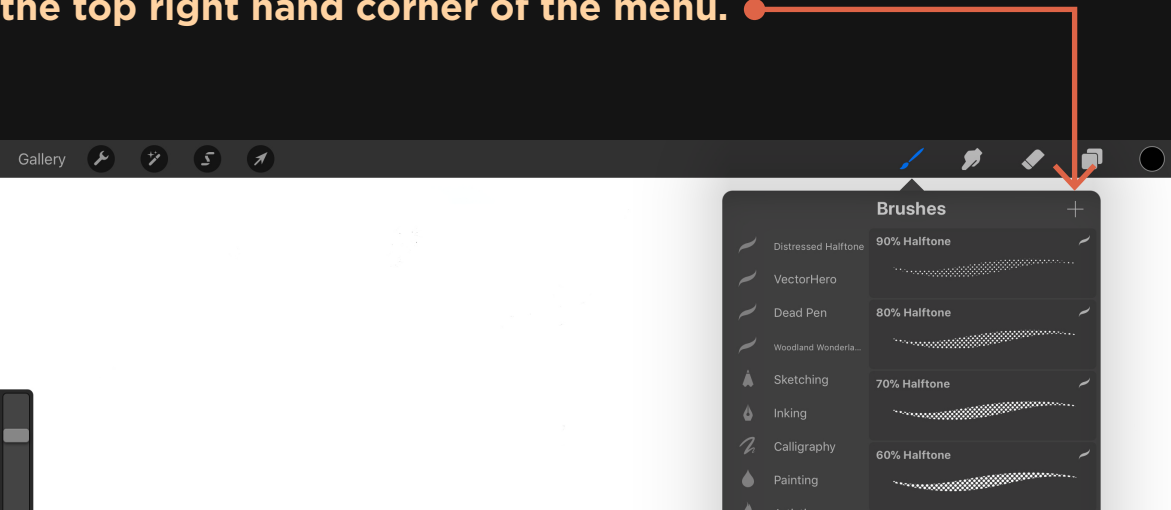

Click Import.

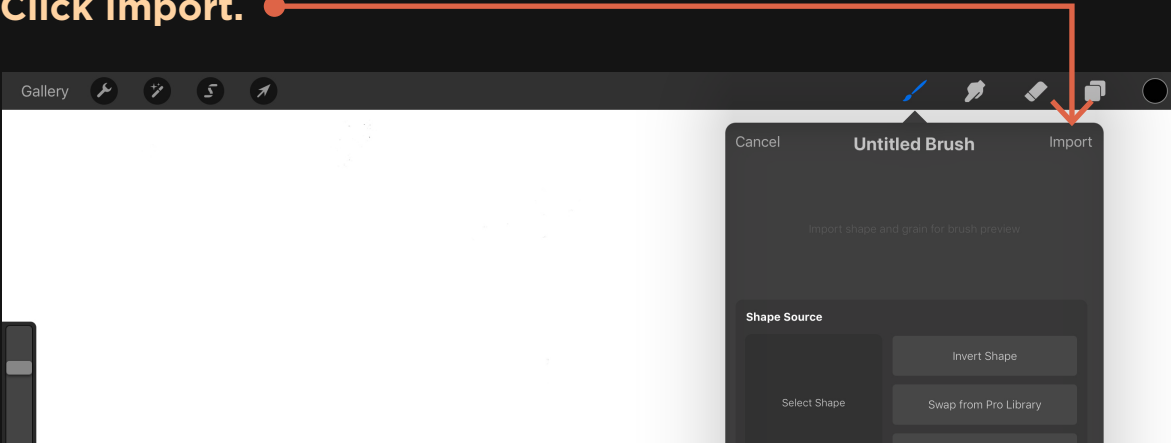

## Step Four FIND YOUR BRUSHES

Find your desired cloud app in your Locations.

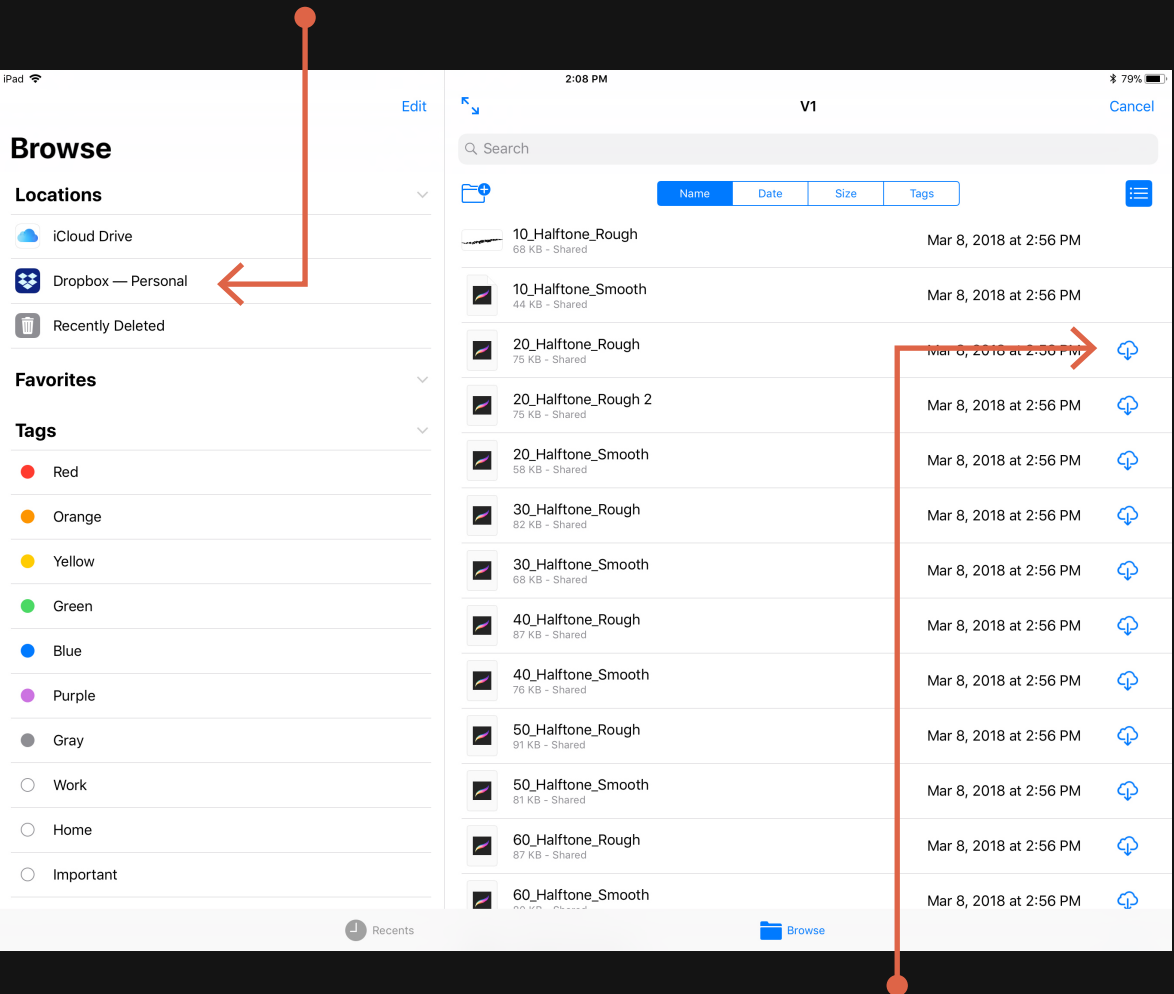

Click the brush you want to import. In Dropbox, you will need to click the download cloud icon. The brush will automatically import into your new brush set.

# iPAD ONLY TUTORIAL

## Step One DOWNLOAD AN UNZIP TOOL

Find an unzip tool, or file extractor in the App Store. We will be using iZip Pro, though there are other options such as Unzip Tool or WinZip.



## Step Two DOWNLOAD BRUSH FILES

If you are purchasing through RetroSupply.co, click the download button on the purchase page or from your email receipt.

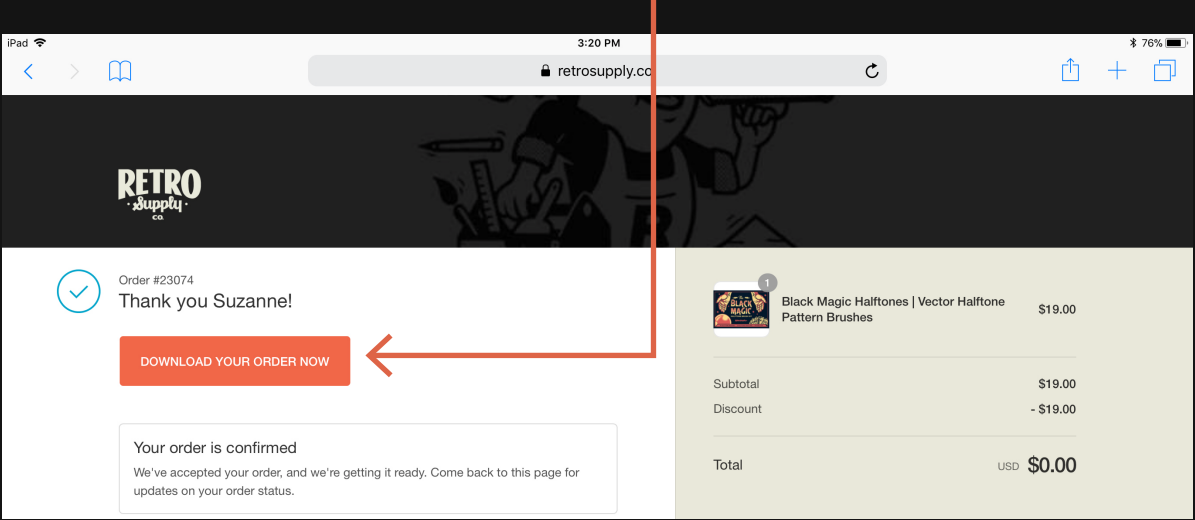

You will be redirected to a SendOwl link. Click Download.

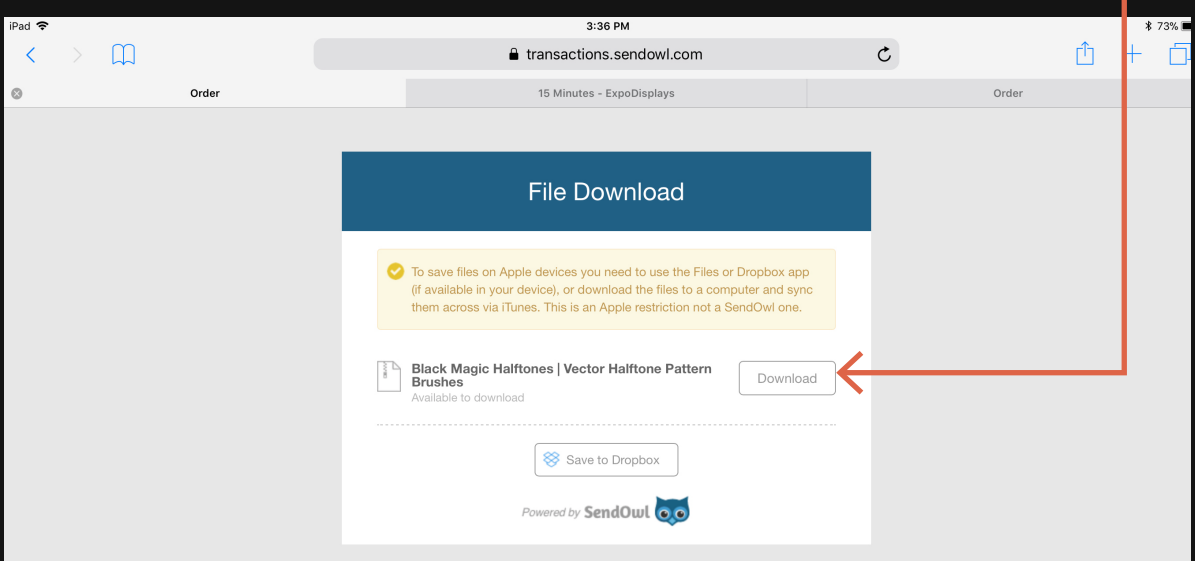

# iPAD ONLY TUTORIAL

If you are purchasing through Creative Market, click the download button on the product page after you have completed your purchase.

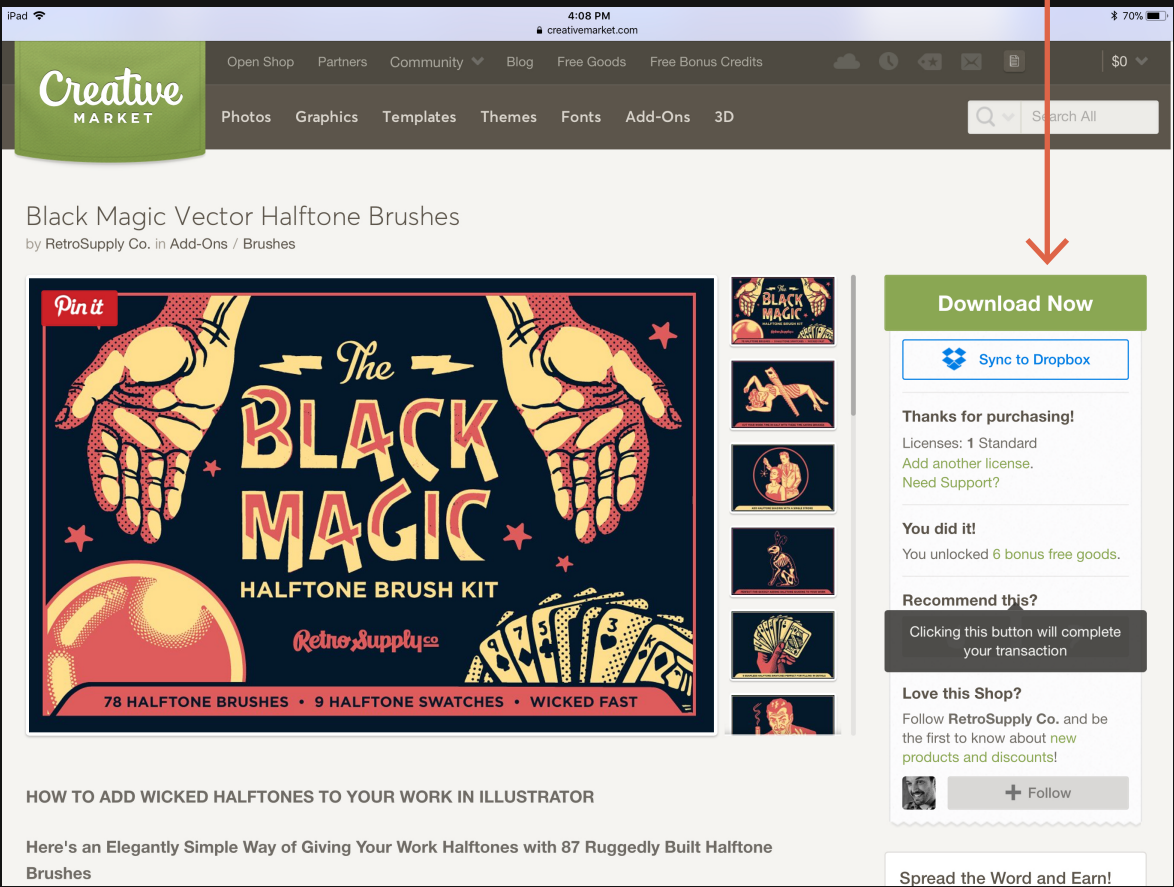

For all other sites, click the native download button.

## Step Three UNZIP THE FILES

Choose Open in “iZip”, or whichever app you downloaded in step one.

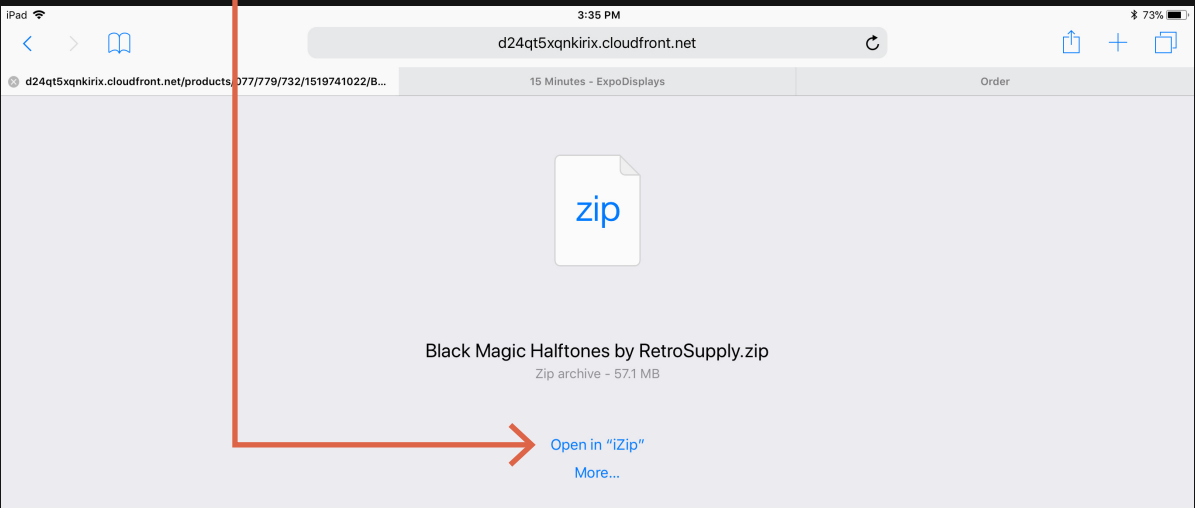

Allow the app to unzip the files.

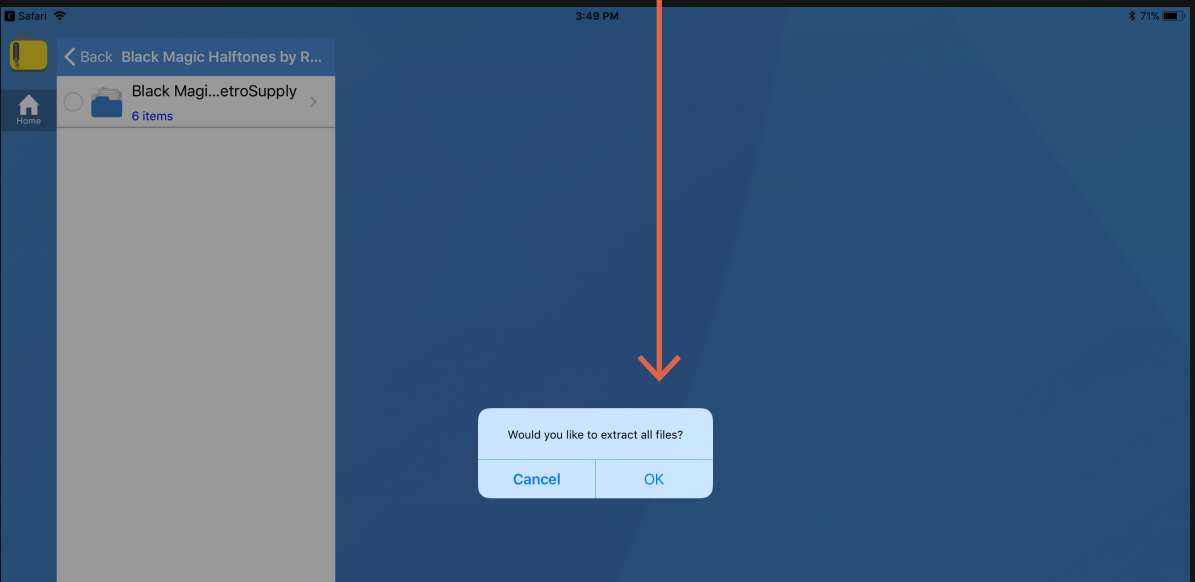

# iPAD ONLY TUTORIAL

## Step Four IMPORT BRUSHES

Open Procreate. Click the brush icon and then the plus icon in the top right hand corner of the menu.

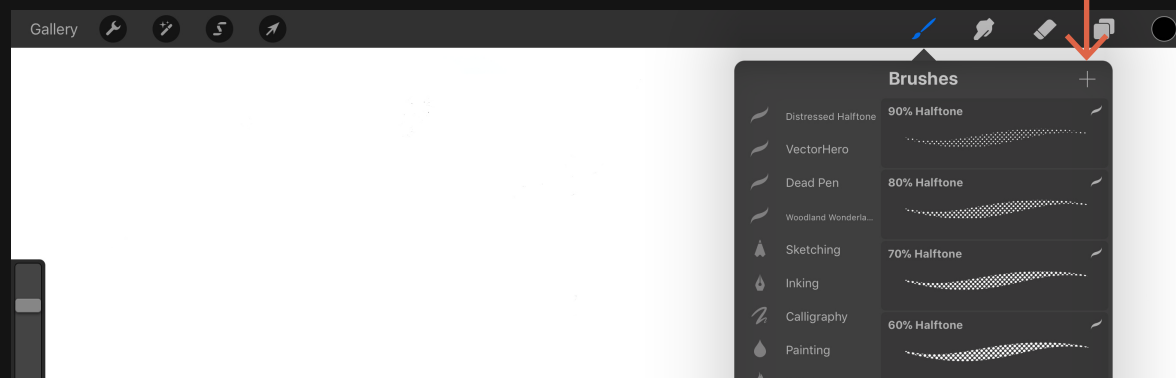

Click Import.

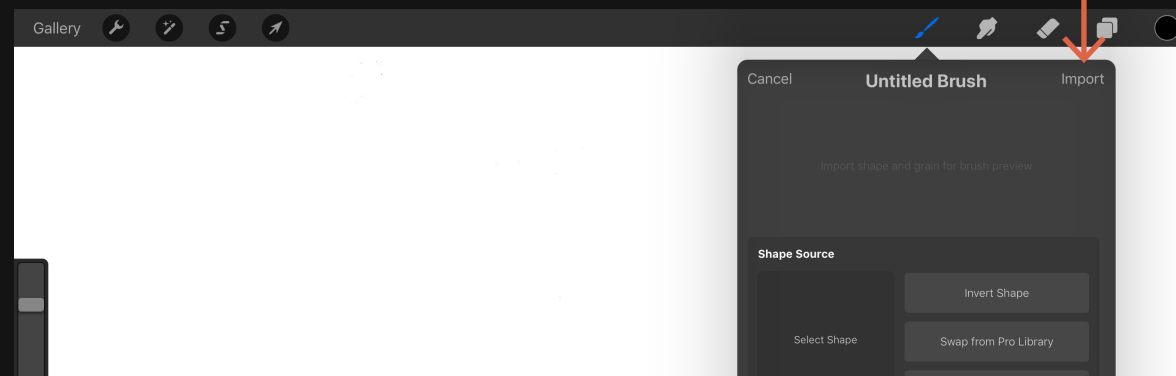

## Step Five FIND YOUR BRUSHES

Click On My iPad.

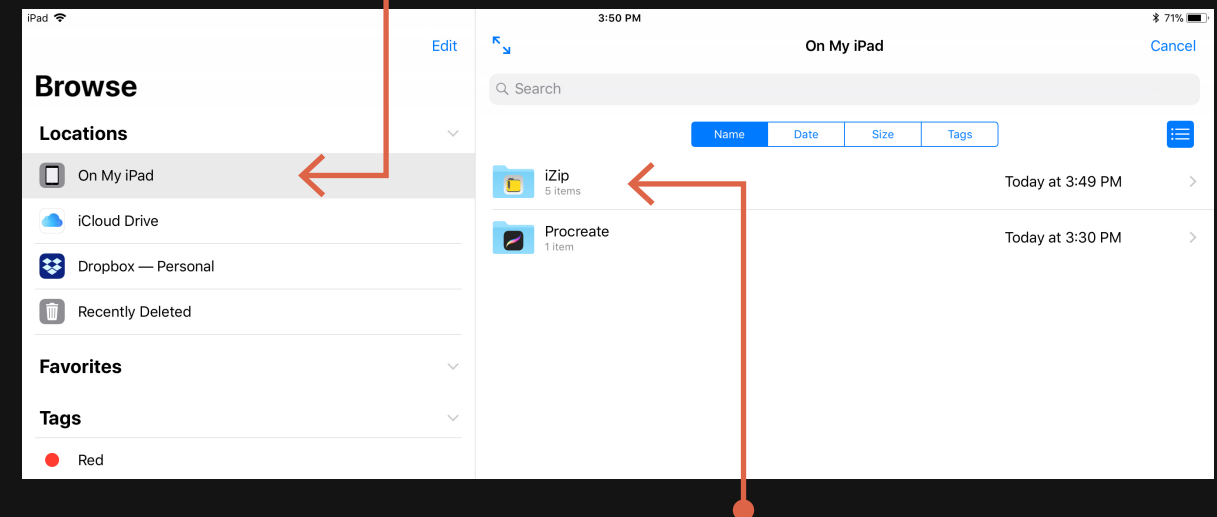

Then click iZip, or whichever app you downloaded in step one. Find the brush files within this folder. Click on the brush to import it into Procreate.

