

FOIA MARKER

This is not a textual record. This is used as an administrative marker by the William J. Clinton Presidential Library Staff.

Collection/Record Group: Clinton Presidential Records

Subgroup/Office of Origin: National AIDS Policy Office

Series/Staff Member:

Subseries:

OA/ID Number: 19397

FolderID:

Folder Title:

Admin - Travel - SLT - New York Site Visits

Stack:

S

Row:

66

Section:

6

Shelf:

11

Position:

3

The Special Treatment and Research (STAR) Clinic
University Hospital of Brooklyn
445 Lenox Road, 7th Floor (NS 72)

has moved to a great new location!

In celebration of our new space, we are inviting you and your colleagues to tour our facility, enjoy refreshments and chat with us about our services. So, please...

SAVE THE DATE

and join us at our
OPEN HOUSE

Friday, September 18, 1998
1:30 p.m. to 4:00 p.m.

Watch for invitations the week of August 31, 1998

Feel free to contact Ellen Honey at
718.270.2690
for further information

University Hospital of Brooklyn is a Designated AIDS Center by
New York State Department of Health AIDS Institute

CLINTON LIBRARY PHOTOCOPY

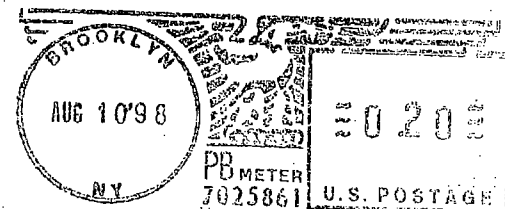

Sandy Thurman
Executive Office of the President
750 17th Street, NW, Suite 1060
Washington, DC 20503

LGBT

COMPREHENSIVE PRIMARY CARE
HIV/PRIMARY CARE
ADOLESCENT MEDICINE/HOTI PROGRAM
LESBIAN HEALTH SERVICES
TRANSGENDER HEALTH & EDUCATION
STD SCREENING & TREATMENT
DENTAL CARE
ON-SITE X-RAY
ON-SITE MAMMOGRAPHY
HIV COUNSELING & TESTING
COUNSELING & SUPPORT GROUPS
PEER COUNSELING
CASE MANAGEMENT
ENTITLEMENTS ADVOCACY
HEALTH & WELLNESS EDUCATION
ON-LINE HEALTH EDUCATION RESOURCES
COMMUNITY FORUMS
DAY-EVENING & WEEKEND HOURS

TLC4

FORMERLY COMMUNITY HEALTH PROJECT

CALLEN LORDE

MICHAEL CALLEN • AUDRE LORDE
COMMUNITY HEALTH CENTER

356 WEST 18TH STREET, NEW YORK, NY 10011

TELEPHONE (212) 271-7200

MICHAEL CALLEN · AUDRE LORDE COMMUNITY HEALTH CENTER

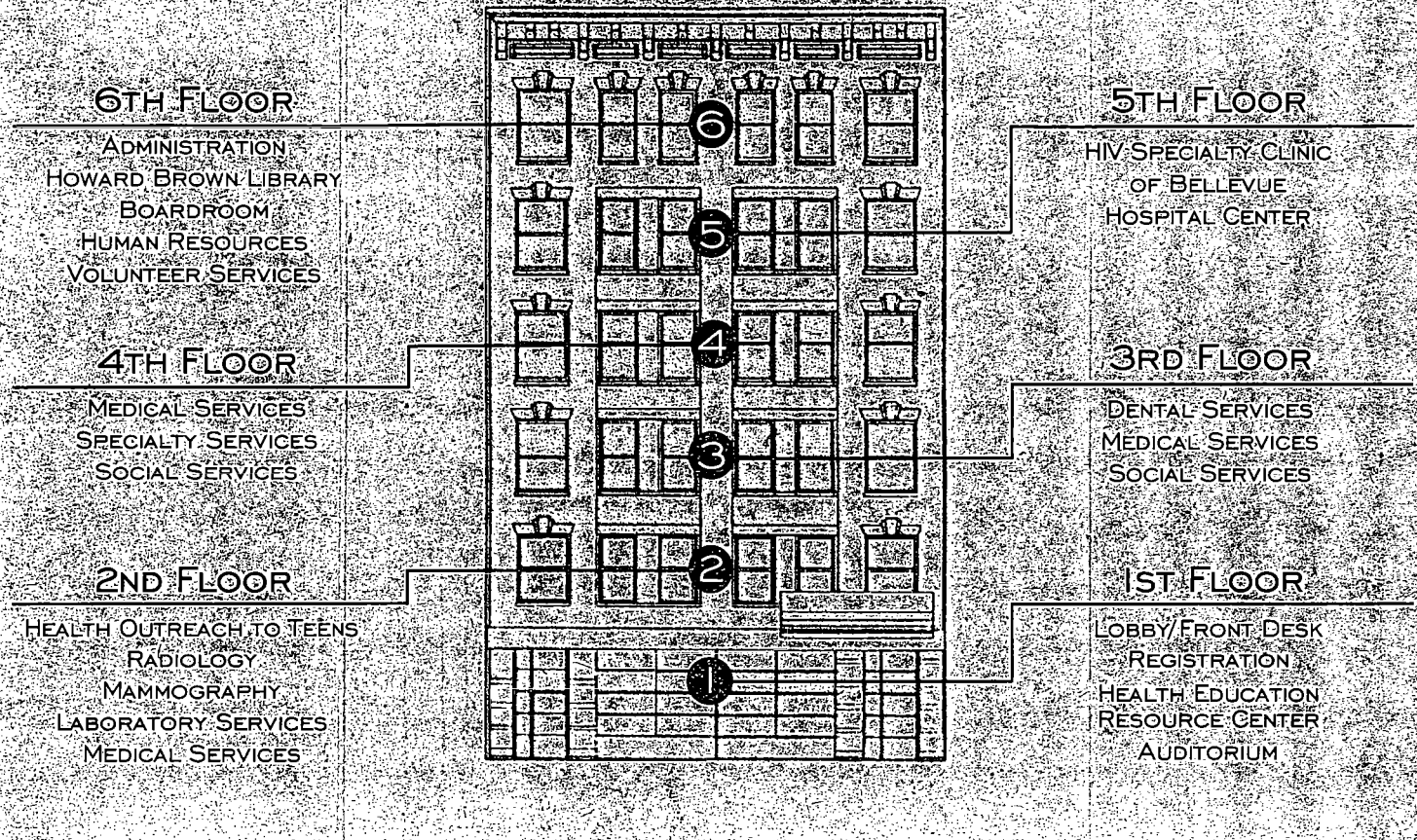

CLINTON LIBRARY PHOTOCOPY

TLC4LGBT*

**Tender Loving Care for
lesbians, gay men, bisexuals and people of transgender experience,
including:*

<i>Comprehensive Primary Care</i>	<i>Adolescent/HOTT Program</i>
<i>HIV Primary Care</i>	<i>Lesbian Health Services</i>
<i>STD Screening & Treatment</i>	<i>Transgender Health Care</i>
<i>Dental Care^x</i>	<i>On-Site X-Ray^x</i>
<i>HIV Counseling & Testing</i>	<i>On-Site Mammography^x</i>
<i>Counseling & Support Groups</i>	<i>Health & Wellness Education</i>
<i>Peer Counseling</i>	<i>On-Line Health Ed Resources</i>
<i>Case Management</i>	<i>Community Forums</i>
<i>Entitlements Advocacy</i>	<i>Handicapped Accessible</i>

Medicaid and ADAP+ accepted. Out-of-Network coverage for most health insurance plans available. Affordable Sliding Fee Scale also available.

Now Open!

Please call (212) 271-7200 for an appointment or more information
Morning, Afternoon, Evening & Weekend Hours Available

x = coming soon!

CalLEN ▼ LORDE

MICHAEL CALLEN ▼ AUDRE LORDE COMMUNITY HEALTH CENTER

356 WEST 18TH STREET (BETWEEN 8TH & 9TH AVENUES), NEW YORK, NY 10011

☎ 212/271-7200

FACT SHEET



Michael Callen-Audre Lorde Community Health Center

(*formerly Community Health Project*) is New York City's *only* medical facility dedicated to meeting the myriad health care needs of the lesbian, gay, bisexual and transgender (lgbt) community and people living with HIV/AIDS -- *regardless of any patient's ability to pay*. Established in 1983, when the St. Mark's Community Clinic merged with the Gay Men's Health Project to create Community Health Project (CHP), Callen-Lorde Community Health Center is one of the lgbt community's most precious and important resources providing essential primary health care to thousands of individuals. Callen-Lorde's high quality, affordable, sensitive and non-judgmental care is provided through the following vital and innovative on-site services and programs:

*formerly
Community Health Project*

*356 West 18th Street
New York, New York 10011*

*212 271 7200 patient care
212 271 7250 administration
212 271 8111 fax*

■ **PRIMARY MEDICAL CARE:**

- ▶ **PRIMARY CARE:** A comprehensive health service model which provides on-going health maintenance and preventive care, as well as screening and treatment for sexually transmitted diseases (STD), hepatitis B prevention and immunization, walk-in services for acute and episodic medical care, dermatological care and other medical and specialty services. Primary care is provided by paid providers and episodic (walk-in) care is provided by a combination of paid and volunteer medical staff.
- ▶ **LESBIAN HEALTH SERVICES:** Comprehensive primary health care, gynecological care, breast health (including on-site mammography) and comprehensive HIV care, as well as targeted health education and counseling for women who partner with women exclusively or not.; provided by both paid and volunteer staff.
- ▶ **HIV/AIDS SERVICES:** HIV counseling and testing; early medical intervention for newly diagnosed individuals; *immediate* HIV primary medical care appointments and timely follow-up care visits that include diagnostic testing, medical treatments, access to clinical trials, benefits and entitlements advocacy, mental health care, HIV/AIDS education, and risk-reduction education.
- ▶ **HIV/AIDS PRIMARY CARE (BELLEVUE SATELLITE) CLINIC:** One of the nation's first community-based HIV primary care clinics, operating in conjunction with Bellevue Hospital Center and offering comprehensive HIV/AIDS-related medical care and social services.
- ▶ **HEALTH OUTREACH TO TEENS (HOTT) PROGRAM:** Free, confidential, comprehensive primary medical care (including a full continuum of HIV care), social services, counseling and health education to lesbian, gay, bisexual, transgender and questioning adolescents and young adults (ages 13-21), delivered both on-site at Callen-Lorde and on the 34-foot mobile medical HOTT van.
- ▶ **TRANSGENDER HEALTH & EDUCATION (THE) CLINIC:** Comprehensive primary medical care (including HIV-related care), counseling, and targeted health education and harm reduction information for people of transgender experience.

■ **SOCIAL SERVICES**

- ▶ **COUNSELING:** Provides crisis intervention and on-going one-on-one and group counseling, as well as supportive services and targeted support groups to HIV+ individuals, adolescents, etc.

- ▶ CASE MANAGEMENT: Offers assistance and advocacy for access to benefits and entitlements (i.e., DAS, Medicaid, ADAP, housing, etc.) for those living with HIV, as well as general case management services for others with chronic needs.
- ▶ PEER COUNSELING: Provides a safe and sensitive setting where patients as well as individuals who walk- or phone-in can speak to a trained volunteer peer counselor/educator about a variety of health and psychosocial issues, as well as obtain other lgbt and HIV-related health education and community referrals.

■ **HEALTH EDUCATION**

- ▶ TRAINING: Offers on-site and community-based lgbt health and HIV/AIDS educational workshops, presentation and targeted health ed materials.
- ▶ COMMUNITY OUTREACH: Outreach and training services to members of our community and other community-based organizations and training programs for health professionals (e.g. medical schools, nursing schools) on subjects such as "Unlearning Homophobia."
- ▶ RESOURCES: State-of-the-art health resource center offering a library and access to the health internet for patients and the lgbt community-at-large.

■ **COMING SOON!!!**

- ▶ *On-site Dental Care, Radiology (x-rays) and Mammography.*

Our greatest challenge and effort to date -- the construction of and relocation to our new, six-story, state-of-the-art, spacious, handicapped-accessible, and dignified primary care health center for the lgbt community, located on West 18th Street in Chelsea -- was realized in March of 1998.

In the rich tradition of Community Health Project, **Michael Callen-Audre Lorde Community Health Center** offers services to all, *regardless of ability to pay*, ensuring that our lgbt community will **thrive...not merely survive**.

Callen-Lorde currently accepts Medicaid, ADAP+ and out-of-network health insurance plans. An affordable sliding fee scale exists for all self-pay (uninsured) individuals. Cash, checks and most major credit cards are acceptable methods of payment.

Callen-Lorde's annual operating budget of \$3.4 million sustains a paid staff of 50 and more than 120 dedicated and caring volunteers. One-third of Callen-Lorde's revenue is derived from city and state contracts; one-third from corporations and foundations; and one-third from other fundraising sources. More than 20,000 patient visits were logged in 1997 at our old (13th St.) location; a 50% increase in visits is anticipated for 1998.

CHP's new **Michael Callen-Audre Lorde Community Health Center** was designed by the architectural firm of Thanhuaser & Esterson. Long-term financing for this facility was obtained from the Dormitory Authority of the State of New York and the Primary Care Development Corporation. Additional generous financial support was received from a variety of foundations and corporations who support Callen-Lorde's mission, and from the generosity of many donors from the lgbt community.

calord.fct 3/98