

**United States Department of the Interior
National Park Service**

For NPS use only

**National Register of Historic Places
Inventory—Nomination Form**

received MAR 26 1986

date entered 6-25-86

See instructions in *How to Complete National Register Forms*
Type all entries—complete applicable sections

1. Name

historic Barn at Oxford Horse Ranch

and/or common Barn at Burman Ranch

2. Location

street & number 868 US Highway 287 ___ not for publication
city, town Laramie Red Buttes: Red Buttes Biological Sciences
___ vicinity of Research Laboratory
state Wyoming code 056 county Albany code 001

3. Classification

| | | | |
|---|---|---|---|
| Category | Ownership | Status | Present Use |
| ___ district | ___ public | <input checked="" type="checkbox"/> occupied | <input checked="" type="checkbox"/> agriculture |
| <input checked="" type="checkbox"/> building(s) | <input checked="" type="checkbox"/> private | ___ unoccupied | ___ commercial |
| ___ structure | ___ both | ___ work in progress | ___ educational |
| ___ site | Public Acquisition | Accessible | ___ entertainment |
| ___ object | <input type="checkbox"/> n/an process | <input checked="" type="checkbox"/> yes: restricted | ___ government |
| | <input type="checkbox"/> n/a being considered | ___ yes: unrestricted | ___ industrial |
| | | ___ no | ___ military |
| | | | ___ museum |
| | | | ___ park |
| | | | ___ private residence |
| | | | ___ religious |
| | | | ___ scientific |
| | | | ___ transportation |
| | | | ___ other: |

4. Owner of Property

name Mr. Keith Burman

street & number 950 US Highway 287

city, town Laramie ___ vicinity of Red Buttes state Wyoming

5. Location of Legal Description

courthouse, registry of deeds, etc. Albany County Courthouse

street & number 501 Grand Avenue

city, town Laramie state Wyoming

6. Representation in Existing Surveys

title Albany County Historic Survey has this property been determined eligible? ___ yes no

date 1981 ___ federal ___ state county ___ local

depository for survey records State Historic Preservation Office

city, town Laramie state Wyoming

7. Description

| | | | |
|--|---------------------------------------|---|--|
| Condition | | Check one | Check one |
| <input type="checkbox"/> excellent | <input type="checkbox"/> deteriorated | <input checked="" type="checkbox"/> unaltered | <input checked="" type="checkbox"/> original site |
| <input type="checkbox"/> good | <input type="checkbox"/> ruins | <input type="checkbox"/> altered | <input type="checkbox"/> moved date <u> N/A </u> |
| <input checked="" type="checkbox"/> fair | <input type="checkbox"/> unexposed | | |

Describe the present and original (if known) physical appearance

The Oxford House Barn is a massive log barn measuring 158 feet eight inches long and fifty feet wide. Apart from its size, the structure has a particularly distinctive earthen ramp on the back, used for providing wagon access to the loft, and a strict bilateral symmetry of plan and facade.

Resting on a sandstone foundation, the barn is constructed of horizontal squared logs mortised into vertical posts at exact 17 foot intervals. This technique divides the long facade visually into nine equal sections. Massive 1 3/4 ground level sliding doors with original hardware are located in the gable ends and also in the middle (5th) and end sections (1st and 9th) of the long facades. Modern garage doors function in one end and one side opening. Additionally, fixed 4 light windows with plain surrounds are centered in the even numbered sections (2,4,6 and 8) on these facades. There are 2 larger square, sliding, plank loft doors in the 3rd and 6th sections which balance all apertures in the facade. This balance is further emphasized by 2, double hung, 4/4, gabled roof dormers, located directly above the sliding loft doors and gabled ventilator cupolas which straddle the roof peak immediately above the dormers. The gable roof of cedar shingles needs repair. It is supported by 2 rows of vertical posts in the loft.

The interior is intact on one wall of the ground floor which retains the original 3/4 wall, iron-grilled, box stalls with original hardware and all doors intact on most. The other row was removed to make room for modern equipment. The loft contains a series of lateral beams and angled supports, for use in hay storage. There is also a bunkhouse tackroom partitioned off at one end of the loft.

Boundaries for this site are defined by the historic cultural landscape and follow corral lines and driveways. Within this complex of functionally dependent interrelated structures are two out buildings used in the horse ranching operation, which retain integrity and contribute to the sense of time and place. They are shed roofed with a combination of stacked log, frame and board and batten construction. They have fixed 6 light windows and angled plank doors with plain surrounds and original hardware.

All buildings and corrals retain a high degree of integrity of setting, design, location, workmanship, materials, feeling and association and are excellent examples of the influence of English cattle barons on high plains ranching.

8. Significance

| Period | Areas of Significance—Check and justify below | | | |
|---|--|--|---|--|
| <input type="checkbox"/> prehistoric | <input type="checkbox"/> archeology-prehistoric | <input type="checkbox"/> community planning | <input type="checkbox"/> landscape architecture | <input type="checkbox"/> religion |
| <input type="checkbox"/> 1400–1499 | <input type="checkbox"/> archeology-historic | <input type="checkbox"/> conservation | <input type="checkbox"/> law | <input type="checkbox"/> science |
| <input type="checkbox"/> 1500–1599 | <input type="checkbox"/> agriculture | <input type="checkbox"/> economics | <input type="checkbox"/> literature | <input type="checkbox"/> sculpture |
| <input type="checkbox"/> 1600–1699 | <input checked="" type="checkbox"/> architecture | <input type="checkbox"/> education | <input type="checkbox"/> military | <input type="checkbox"/> social/ |
| <input type="checkbox"/> 1700–1799 | <input type="checkbox"/> art | <input type="checkbox"/> engineering | <input type="checkbox"/> music | <input type="checkbox"/> humanitarian |
| <input checked="" type="checkbox"/> 1800–1899 | <input type="checkbox"/> commerce | <input checked="" type="checkbox"/> exploration/settlement | <input type="checkbox"/> philosophy | <input type="checkbox"/> theater |
| <input type="checkbox"/> 1900– | <input type="checkbox"/> communications | <input type="checkbox"/> industry | <input type="checkbox"/> politics government | <input type="checkbox"/> transportation |
| | | <input type="checkbox"/> invention | | <input type="checkbox"/> other (specify) |

Specific dates 1887 **Builder/Architect** Unknown

Statement of Significance (in one paragraph)

The Oxford horse barn, constructed in 1887, is both one of the oldest and one of the largest extant barns in Albany County, Wyoming. It is also probably the County's best preserved example of vernacular architecture as influenced by late 19th-century English cattle and horse ranchers. It provides important evidence for an interesting phenomenon in the history of the American West: the transplantation of the English upper class thoroughbred horse culture (with such attendant forms as riding to hounds) to the Rocky Mountain west and more specifically, Wyoming. The rigid, tripartite, bilateral symmetry of the barn justifies considering it an agricultural manifestation of the "Georgian vernacular" tradition so pervasive in the domestic architecture of England and the eastern U.S. Beyond this broad cultural significance, the Oxford horse barn also figures prominently in local history. Most notably it is associated with the name of Axel Palmer, who worked at and later became part owner of the then Whitehouse Ranch on which the barn is located. Palmer trained horses and used the barn loft as a kind of obstacle course for breaking teams.

(SEE ADDENDUM)

9. Major Bibliographical References

See Addendum

10. Geographical Data

Acreeage of nominated property less than 1 acre

Quadrangle name Red Buttes

Quadrangle scale 1:24000

UTM References

A

| | | | | | | | | | | | | | | |
|------|---|---|---------|---|---|---|---|----------|---|---|---|---|---|---|
| 1 | 3 | 4 | 5 | 0 | 3 | 2 | 0 | 4 | 5 | 5 | 9 | 6 | 4 | 0 |
| Zone | | | Easting | | | | | Northing | | | | | | |

B

| | | | | | | | | | | | | | | |
|------|---|---|---------|---|---|---|---|----------|---|---|---|---|---|---|
| 1 | 3 | 4 | 5 | 0 | 3 | 4 | 0 | 4 | 5 | 5 | 9 | 6 | 4 | 0 |
| Zone | | | Easting | | | | | Northing | | | | | | |

C

| | | | | | | | | | | | | | | |
|------|---|---|---------|---|---|---|---|----------|---|---|---|---|---|---|
| 1 | 3 | 4 | 5 | 0 | 3 | 5 | 0 | 4 | 5 | 5 | 9 | 6 | 5 | 0 |
| Zone | | | Easting | | | | | Northing | | | | | | |

D

| | | | | | | | | | | | | | | |
|------|---|---|---------|---|---|---|---|----------|---|---|---|---|---|---|
| 1 | 3 | 4 | 5 | 0 | 3 | 6 | 0 | 4 | 5 | 5 | 9 | 5 | 4 | 0 |
| Zone | | | Easting | | | | | Northing | | | | | | |

E

| | | | | | | | | | | | | | | |
|------|---|---|---------|---|---|---|---|----------|---|---|---|---|---|---|
| 1 | 3 | 4 | 5 | 0 | 3 | 2 | 0 | 4 | 5 | 5 | 9 | 5 | 4 | 0 |
| Zone | | | Easting | | | | | Northing | | | | | | |

F

| | | | | | | | | | | | | | | |
|------|--|--|---------|--|--|--|--|----------|--|--|--|--|--|--|
| | | | | | | | | | | | | | | |
| Zone | | | Easting | | | | | Northing | | | | | | |

G

| | | | | | | | | | | | | | | |
|------|--|--|---------|--|--|--|--|----------|--|--|--|--|--|--|
| | | | | | | | | | | | | | | |
| Zone | | | Easting | | | | | Northing | | | | | | |

H

| | | | | | | | | | | | | | | |
|------|--|--|---------|--|--|--|--|----------|--|--|--|--|--|--|
| | | | | | | | | | | | | | | |
| Zone | | | Easting | | | | | Northing | | | | | | |

Verbal boundary description and justification

See Addendum

List all states and counties for properties overlapping state or county boundaries

state n/a code n/a county n/a code n/a

state n/a code n/a county n/a code n/a

11. Form Prepared By

name/title Albany County Historic Preservation Board, Dr. John Dorst nominator

organization Albany County Historic Preservation Board date March 15, 1985

street & number c/o Albany County Clerk telephone 742-2149

city or town Laramie state Wyoming

12. State Historic Preservation Officer Certification

The evaluated significance of this property within the state is:

national state local

As the designated State Historic Preservation Officer for the National Historic Preservation Act of 1966 (Public Law 89-665), I hereby nominate this property for inclusion in the National Register and certify that it has been evaluated according to the criteria and procedures set forth by the National Park Service.

State Historic Preservation Officer signature

Robert W. Bush

title Director and State Historic Preservation Officer

date 3-18-86

For NPS use only

I hereby certify that this property is included in the National Register

J. Melvyn Byers
Keeper of the National Register

Entered in the
National Register

date 6-25-86

Attest:

date

Chief of Registration

**United States Department of the Interior
National Park Service**

**National Register of Historic Places
Inventory—Nomination Form**

For NPS use only
received
date entered

25 1980

Continuation sheet Barn at Oxford Horse Ranch Item number 8 Page 1

The Laramie Plains are often referred to as the cradle of the livestock industry for it was here that pioneers first noticed that oxen abandoned after a hard summer laboring, turned up fat and healthy in the spring. The ranch near Red Butte known as the Oxford horse ranch was one of the earliest in the area established in the 1870s by Pete Johnson and then sold to Whitehouse and Stokes in the 1880s. Scottish born and Canadian educated Whitehouse and Stokes brought the ranch to international recognition as breeders of full blooded pedigree horses, running up to 3,000 head of stock during peak years. Additionally they became locally noted for their practice of lavish entertaining and for Scottish and English style sporting events including horse racing at their personal 1/2 mile track and hunting with a pack of 54 trained hounds. Another popular event hosted by the Oxford was a pocket billiards tournament with the table pockets filled with \$20.00 gold pieces; players played for the jackpot.

The Oxford became the main attraction for English, Scottish and other European cattle barons who had established themselves at many neighboring ranches, and who transplanted their way of life nearly intact to the northwestern plains region. A colorful group whose money, culture, education and political activities greatly influenced the unusual history of the area.

The horse barn, outbuildings, and corrals were constructed in 1876 and the barn loft held grain bins in addition to 200 tons of hay. Axel Palmer, a Swedish gentleman who had begun working on the ranch as a hired hand, eventually bought into the Whitehouse operation after Stokes returned to Glasgow. Palmer became a full partner with Whitehouse. Whitehouse was a veterinarian and is thought to have been the first visiting lecturer at the University of Wyoming School of Agriculture, and also served on the Veterinary faculty of the Colorado A and M College at Fort Collins from 1912 to 1922 before he returned to Glasgow, Scotland.

United States Department of the Interior
National Park Service

National Register of Historic Places
Inventory—Nomination Form

For NPS use only
received MAR 26 1986
date entered

Continuation sheet Barn at Oxford Horse Ranch Item number 9 (Bibliography) Page 1

Burns, Robert, Andrew Gillespie, and Williny Richardson. Wyoming's Pioneer Ranches. Laramie: Top of the World Press, 1955.

Burns, Robert, Tour of Old Time Ranches of the Laramie Plains. Laramie: Albany County Historical Society, October 12, 1950.

Larson, T.A., History of Wyoming. Lincoln: University of Nebraska Press, 1985.

Laramie Boomerang; Special Edition Spring 1889. page 11, columns 1 and 2.

National Register Nominations. Cheyenne: State Historic Preservation Office files, 1985.

**United States Department of the Interior
National Park Service**

**National Register of Historic Places
Inventory—Nomination Form**

| |
|----------------------|
| For NPS use only |
| received JUN 18 1986 |
| date entered |

Continuation sheet Barn at Oxford Horse Ranch Item number 10 (Boundary Des.) Page 1

The boundary for the Oxford Horse Ranch is defined by manmade features and one short arbitrary line used for connecting the site.

The boundary on the east is defined by a corral fence which extends the full length of the complex. The point of beginning (A) is located at the meeting place of the corral fence and another fence defining the northern boundary, this point is located approximately 15 feet from the northwest corner of the foal barn. The boundary follows the fence east approximately 150 feet to point (B) where it meets the existing roadway. The eastern boundary then proceeds south approximately 350 feet along the west side of the roadway, the full length of the complex to an arbitrary point (C) which coincides with another fence extending the full length of the north side of the complex. The boundary then follows an arbitrary line approximately 25 feet to the point where it meets the corner of the fence (D). It then follows the fence west approximately 125 feet to point (E) at the next fence corner. It then follows this fence north approximately 350 feet to the point of beginning. This boundary concisely defines the barn complex and includes four contributing structures: The main barn, foaling sheds and the corral system. These are the only historic structures which remain on the site and have retained integrity. Because the complex is still operating as a working ranch and the owners are very seriously pursuing restoration and preservation of the complex, the boundaries will remain intact for the life of the site.

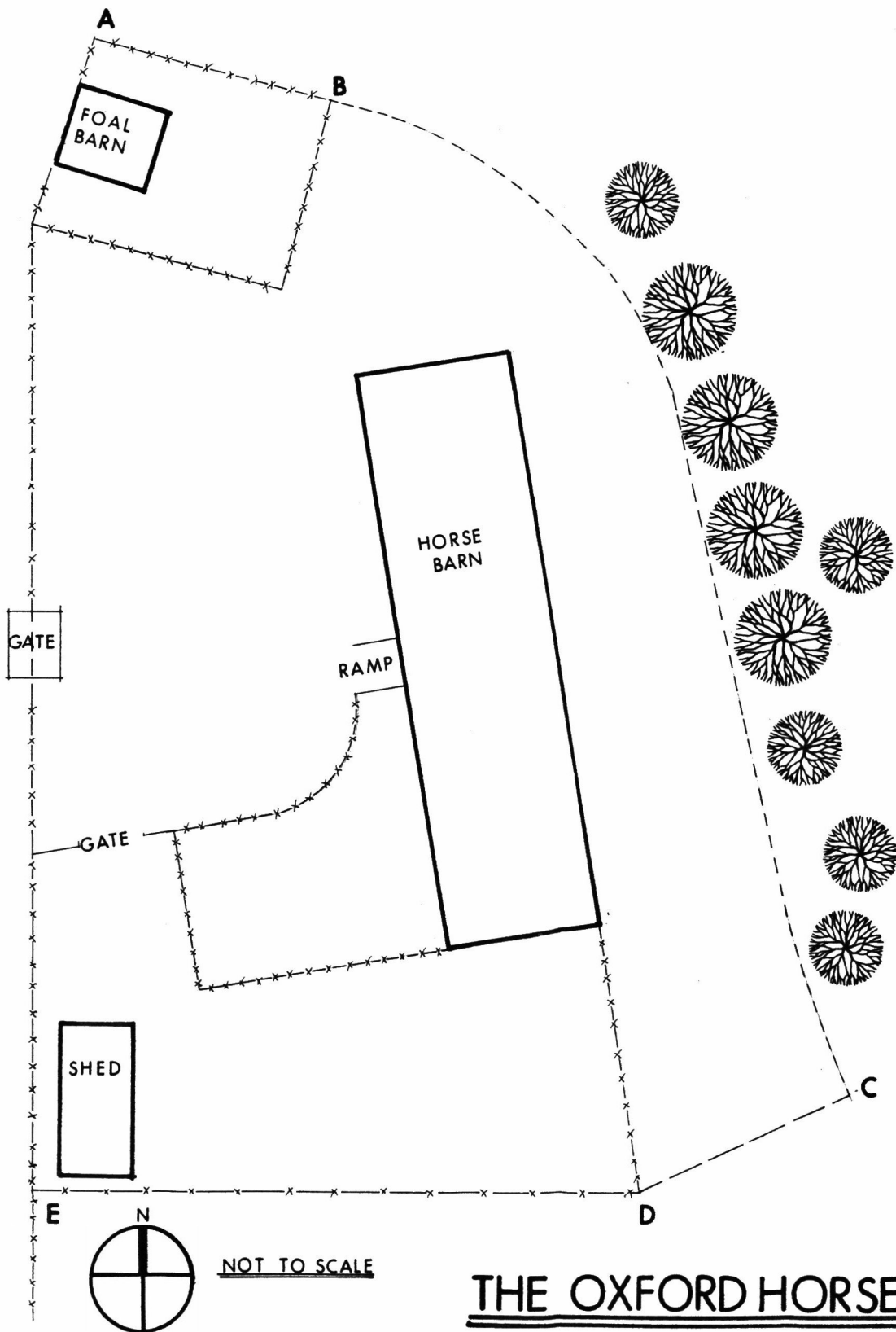

THE OXFORD HORSE RANCH BARN

NATIONAL REGISTER OF HISTORIC PLACES
EVALUATION/RETURN SHEET

Barn at Oxford Horse Ranch
Albany County
WYOMING

Working No. MAR 26 1986

Fed. Reg. Date: _____

Date Due: 4/24/86 - 5/10/86

Action: ACCEPT

RETURN 4/25/86

REJECT

Federal Agency: _____

- resubmission
- nomination by person or local government
- owner objection
- appeal

Substantive Review: sample request appeal NR decision

Reviewer's comments:

Recom./Criteria _____

Reviewer _____

Discipline _____

Date _____

_____ see continuation sheet

Nomination returned for: technical corrections cited below
 substantive reasons discussed below

1. Name

2. Location

3. Classification

| | | | |
|----------|--------------------|------------|-------------|
| Category | Ownership | Status | Present Use |
| | Public Acquisition | Accessible | |

4. Owner of Property

5. Location of Legal Description

6. Representation in Existing Surveys

Has this property been determined eligible? yes no

7. Description

Condition

- excellent
- good
- fair
- deteriorated
- ruins
- unexposed

Check one

- unaltered
- altered

Check one

- original site
- moved date _____

Describe the present and original (if known) physical appearance

- summary paragraph
- completeness
- clarity
- alterations/integrity
- dates
- boundary selection

8. Significance

Period Areas of Significance—Check and justify below

Specific dates Builder/Architect
Statement of Significance (in one paragraph)

- summary paragraph
- completeness
- clarity
- applicable criteria
- justification of areas checked
- relating significance to the resource
- context
- relationship of integrity to significance
- justification of exception
- other

9. Major Bibliographical References

X 10. Geographical Data

X Acreage of nominated property Please give acreage to the nearest acre.
 Quadrangle name _____
 UTM References _____

X Verbal boundary description and justification Please provide scale for sketch map or a fixed starting point (eg starting at the SE corner of the fence, which is located 10 feet SE of the corner of the barn, then proceed ---"). Fences are vulnerable to removal. They do not make good reference points.

11. Form Prepared By

X 12. State Historic Preservation Officer Certification

The evaluated significance of this property within the state is: Please provide "Level of Significance".

___ national ___ state ___ local

State Historic Preservation Officer signature

title date

13. Other

- Maps
- Photographs
- Other

Questions concerning this nomination may be directed to _____

Signed [Signature] Date 4/25/86 Phone: _____

NATIONAL REGISTER OF HISTORIC PLACES
EVALUATION/RETURN SHEET

Barn at Oxford Horse Ranch
Albany County
WYOMING

Working No. 3-26-86

Fed. Reg. Date: 2/3/87

Date Due: 8/2/86

Action: ACCEPT 6-25-86

RETURN

REJECT

Federal Agency:

- resubmission
- nomination by person or local government
- owner objection
- appeal

Substantive Review: sample request appeal NR decision

Reviewer's comments:

Recom./Criteria

Reviewer

Discipline

Date

see continuation sheet

Nomination returned for: technical corrections cited below
 substantive reasons discussed below

1. Name

2. Location

3. Classification

| Category | Ownership Public Acquisition | Status Accessible | Present Use |
|----------|---------------------------------|----------------------|-------------|
|----------|---------------------------------|----------------------|-------------|

4. Owner of Property

5. Location of Legal Description

6. Representation in Existing Surveys

Has this property been determined eligible? yes no

7. Description

- | | | |
|------------------------------------|---------------------------------------|---|
| Condition | Check one | Check one |
| <input type="checkbox"/> excellent | <input type="checkbox"/> deteriorated | <input type="checkbox"/> original site |
| <input type="checkbox"/> good | <input type="checkbox"/> ruins | <input type="checkbox"/> moved date _____ |
| <input type="checkbox"/> fair | <input type="checkbox"/> unexposed | |
| | <input type="checkbox"/> unaltered | |
| | <input type="checkbox"/> altered | |

Describe the present and original (if known) physical appearance

- summary paragraph
- completeness
- clarity
- alterations/integrity
- dates
- boundary selection



OXFORD HORSE BARN
ALBANY COUNTY
OXFORD HORSE RANCH, APPROX. 8 MI.
SOUTH OF LARAMIE ON HWY. 287
VIEW IS OF SIDE AND NEAR FACADE
LOOKING N.W.
PHOTOGRAPHER: RICHARD COLLIER

MAR 26 1986



OXFORD HORSE BARN
ALBANY COUNTY
OXFORD HORSE RANCH, APPROX. 8 MI. SOUTH OF
LARAMIE, WYO. ON HWY. 287
VIEW IS S.S.E. LOOKING AT END AND NEAR
FACADE OF BARN
PHOTOGRAPHER: RICHARD COLLIER
5/3/85

MAR 26 1986



OXFORD HORSE BARN
ALBANY COUNTY
OXFORD HORSE RANCH APPROX. 8 MI.
SOUTH OF LARAMIE ON HWY. 287
VIEW IS EAST OF RAMP LEADING TO SECOND
FLOOR OF BARN
PHOTOGRAPHER: RICHARD COLLIER
5/3/85

MAR 26 1985



FOLD BARN
ALBANY COUNTY
OXFORD HORSE RANCH, APPROX. 8 MILES
SOUTH OF LARAMIE, WYOMING ON HIGHWAY
287
VIEW IS N.W. LOOKING AT FOLD BARN
SHOT FROM CORRAL AREA
PHOTOGRAPHER: RICHARD COLLIER
5/3/85

MAR 26 1986



INTERIOR OF OXFORD HORSE BARN, (STALLS)
ALBANY COUNTY
OXFORD HORSE RANCH, APPROX. 8 MI. SOUTH
OF LARAMIE, WYO. ON HWY. 287
VIEW IS N.W. LOOKING AT FIRST FLOOR STALLS
PHOTOGRAPHER: RICHARD COLLIER
5/3/85

MAR 26 1980



SLED AND CORRAL
ALBANY COUNTY
OXFORD HORSE RANCH, APPROX. 8
MILES SOUTH OF LARAMIE, ON HIGH-
WAY 287
PHOTOGRAPHER: RICHARD COLLIER

VIEW IS WEST OF THE FRONT OF THE
SHED
5/3/85

MAR 26 1986



OXFORD HORSE BARN, 2ND FLOOR INTERIOR
AL

ALBANY COUNTY
OXFORD HORSE RANCH, APPROX. 8 MI. SOUTH
OF LARAMIE, WYO. ON HWY. 287
VIEW IS SOUTH OF SECOND FLOOR INTERIOR
OF BARN

PHOTOGRAPHER: RICHARD COLLIER
5/3/85

MAR 26 1986



OXFORD HORSE BARN
ALBANY COUNTY
OXFORD HORSE RNAHC, APPROX. 8 MI.
SOUTH OF LARAMIE, WYO. ON HWY. 287
PHOTOGRAPHER: RICHARD COLLIER
VIEW IS S.W. LOOKING AT SIDE OF
FRONT FACADE OF BLDG.
5/3/85

MAR 26 1986

THE OXFORD HORSE RANCH BARN

- A E 4 50 320
- B E 4 50 340
- C E 4 50 350
- D E 4 50 360
- E E 4 50 320

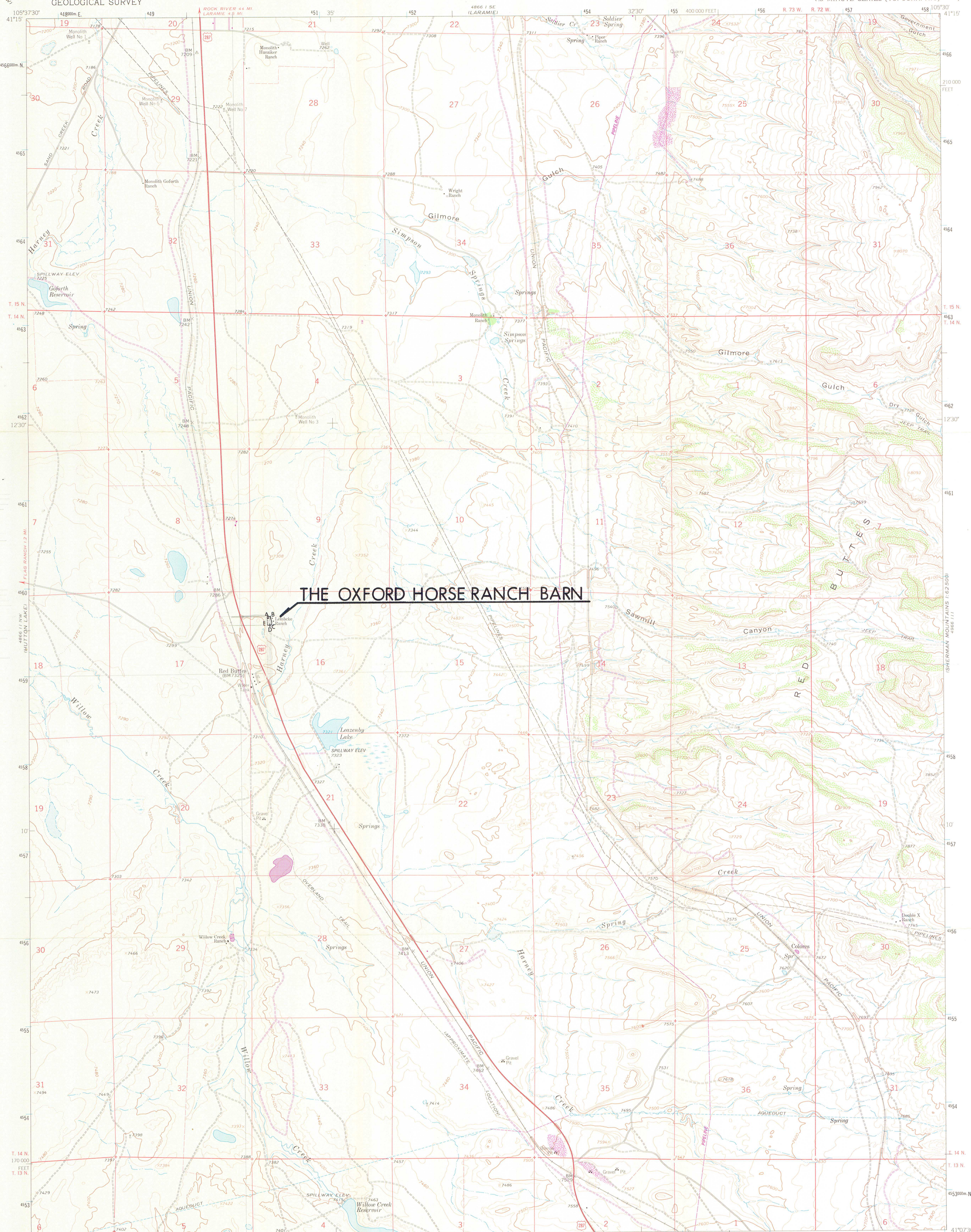

THE OXFORD HORSE RANCH BARN

Mapped, edited, and published by the Geological Survey as part of the Department of the Interior program for the development of the Missouri River Basin.

Control by USGS and NOS/NOAA

Topography by photogrammetric methods from aerial photographs taken 1961. Field checked 1963

Polyconic projection 1927 North American datum 10,000 foot grid based on Wyoming coordinate system, east zone 1000 meter Universal Transverse Mercator grid ticks, zone 13, shown in blue

Fine red dashed lines indicate selected fence lines

Revisions shown in purple compiled from aerial photographs taken 1976. Map edited 1978. This information not field checked

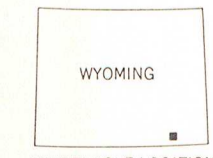
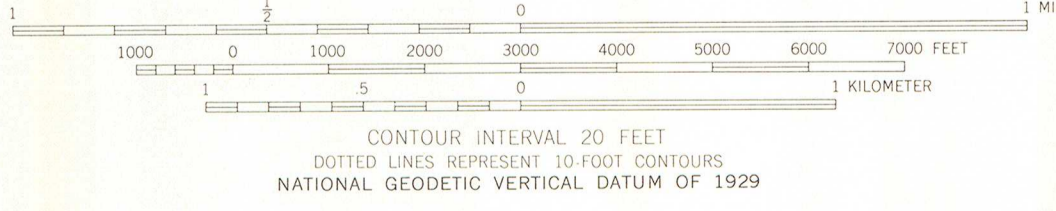
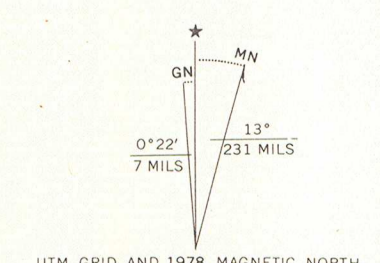

ROAD CLASSIFICATION

Heavy duty ——— Light duty ———

Unimproved dirt - - - - - U.S. Route

THIS MAP COMPLIES WITH NATIONAL MAP ACCURACY STANDARDS
FOR SALE BY U. S. GEOLOGICAL SURVEY, DENVER, COLORADO 80225, OR RESTON, VIRGINIA 22092
A FOLDER DESCRIBING TOPOGRAPHIC MAPS AND SYMBOLS IS AVAILABLE ON REQUEST

RED BUTTES, WYO.
N4107 5 - W10530 7.5
1963
PHOTOREVISED 1978
AMS 4866 11 NE - SERIES V874

MARK 2 b 19000

SHERMAN MOUNTAINS 1:62,500



Ed Herschler
Governor

Wyoming State Archives, Museums & Historical Department

Barrett Building

State Historic Preservation Office

Cheyenne, WY 82002

Robert D. Bush, Ph. D.

Director
307-777-7519

March 14, 1986

Mr. Jerry Rogers
Keeper of the National Register
USDI, NPS
P.O. Box 37127
Washington, D.C. 20013-7127

Dear Mr. Rogers:

Enclosed are National Register nominations for the Dixon Town Hall in Carbon County, the Wyoming University or Old Main building, the Oxford Horse barns and the Dale Creek Crossing Sites, all in Albany County. All of the technical requirements for nomination and listing of these sites have been completed.

We are requesting substantive review for the Dale Creek Crossing Site. This nomination was prepared by a graduate student at the University of Wyoming, who has requested substantive comments. Additionally because this is a fairly unusual type of site we are eager to receive comments on items 7, 8, and 10. We have a number of individuals interested in nominating similar types of sites. We feel substantive comments will help our staff in preparing and training others to complete similar nominations. We have included some color slides of this site for your staff to review but would like to have them back after the review period.

Thank you for your cooperation in this matter. Please do not hesitate to call if you have questions or if I or my staff can be of assistance.

Sincerely,

Dr. Robert D. Bush
Director and State Historic Preservation Officer

RDB:SBW:tjw

Re-submission 3 Copies



Ed Herschler
Governor

Wyoming State Archives, Museums & Historical Department

Barrett Building

State Historic Preservation Office

Cheyenne, WY 82002

Robert D. Bush, Ph. D.

Director
307-777-7519

June 11, 1986

Mr. Jerry Rogers
Keeper of the National Register
United States Department of the Interior
National Park Service
P.O. Box 37127
Washington, D. C. 20013-7127

Dear Mr. Rogers:

We are returning four nominations, which were sent back for technical and substantive corrections, the Dixon Town Hall in Carbon County, and the Vee Bar Ranch, Oxford Horse Barns and Old Main in Albany County. The requested changes, additions and corrections have been made and we hope that these nominations can now be listed without further delays. Additionally, we are requesting a copy of the U. S. Department of Interior document which would have informed us of the listing of the Worland House, in Washakie County, Wyoming. Though we received verbal confirmation that this property was listed early in 1986 we have not received any official documentation and so, have not been able to notify the owner and appropriate officials. Your attention to this matter will be greatly appreciated.

My staff is working to correct the situations which resulted in these returns, so that such problems will not arise in the future. Please do not hesitate to call if your staff has suggestions on how we can improve our nominations.

Sincerely,

Robert D. Bush
Director and State Historic Preservation Officer

RDB:SBW:tjw
Enclosures

| | | | | | | | | |
|----------------------------------|---|------------------------------|-----------------------------|---------------------------|-------------------------|--------------------------|--------------------------|------------------------------|
| Frank Bowron Chairman, Casper | Luella Dumbrell Vice-Chairman, Newcastle | Bill Bruce Hines Gillette | Thomas J. Mangun Laramie | Gladys G. Hill Douglas | Mary Sawaya Kemmerer | Dave Paulley Cheyenne | Mary Guthrie Cheyenne | Marion Barngrover Worland |
|----------------------------------|---|------------------------------|-----------------------------|---------------------------|-------------------------|--------------------------|--------------------------|------------------------------|

JUN 18 1986