

**United States Department of the Interior
Heritage Conservation and Recreation Service**

**National Register of Historic Places
Inventory—Nomination Form**

See instructions in *How to Complete National Register Forms*
Type all entries—complete applicable sections

For HCRS use only

received

DEC 16 1983

date entered

1. Name

historic

John, David, and Jacob Rees House

and/or common

LeFevre Farm

2. Location

street & number

1.6 miles west on West Virginia Secondary Route 24/1 (Sam Mason Road),
off of U.S. Route #11; south 0.5 mile down lane. not for publication

city, town

Bunker Hill vic.

vicinity of

congressional district

state

West Virginia

code

54

county

Berkeley

code

003

3. Classification

Category

 district building(s) structure site object

Ownership

 public private both

Public Acquisition

 in process being considered

Status

 occupied unoccupied work in progress

Accessible

 yes: restricted yes: unrestricted no

Present Use

 agriculture commercial educational entertainment government industrial military museum park private residence religious scientific transportation other:

4. Owner of Property

name

Mr. and Mrs. Lucien D. LeFevre

street & number

Route #1, Box 690

city, town

Bunker Hill

vicinity of

state

West Virginia

5. Location of Legal Description

courthouse, registry of deeds, etc.

Berkeley County Courthouse

street & number

100 West King Street

city, town

Martinsburg

state

West Virginia

6. Representation in Existing Surveys

title

G-17 Berkeley County Historic
Landmarks Commission Surveyhas this property been determined eligible? yes no

date

1973 - 1983

 federal state county local

depository for survey records

Berkeley County Courthouse

city, town

Martinsburg

state

West Virginia

7. Description

Condition		Check one	Check one
<input checked="" type="checkbox"/> excellent	<input type="checkbox"/> deteriorated	<input type="checkbox"/> unaltered	<input checked="" type="checkbox"/> original site
<input type="checkbox"/> good	<input type="checkbox"/> ruins	<input checked="" type="checkbox"/> altered	<input type="checkbox"/> moved date _____
<input type="checkbox"/> fair	<input type="checkbox"/> unexposed		

Describe the present and original (if known) physical appearance

The Rees house is located on a 232 acre farm at the end of a half mile driveway and is situated in a large yard with many old trees and a small stream. The house is "L" shaped and is forty-five feet (45') wide by seventy feet (70') long. It consists of three separate sections built at three separate times using log, stone, and brick, all on a stone foundation.

The two story, three bay log section, twenty-one feet (21') wide by sixteen feet (16') deep, was built first, ca. 1760, as a settler's small dwelling house. Room partitions are the vertical, hand-planed, beaded board walls. A stone fireplace is on the west wall as is the large exterior two story stone chimney. The steep winder stair is enclosed and has a board and batten door. On the second story, the loft is accessible by ladder. This section is representative of permanent settler housing. When the stone section was constructed, ca. 1795, the log house was attached to be used as the kitchen and was covered with beaded weatherboard. These two sections comprise the ell.

The two story, three bay coursed rubble stone house is Federal and measures twenty-seven feet (27') wide by twenty-four feet (24') deep. The four flight open-well stairway has a beaded stringer course and ornamental scrolls as step-end decoration and leads to a small plastered room under the eaves on the third floor. Window and exterior door jambs are panelled and facings are symmetrically molded with rondel corner blocks. The two fireplaces are quite handsome with very decorative Federal mantels having pilasters and end blocks of symmetrical moldings. Exterior moldings are the quirked ovalo of the period and exterior doors are heavy board and batten on strap hinges with small four-light windows near the top.

The Greek-Revival front section of this "L" shaped house was constructed ca, 1855 of brick in five row common bond on a stone foundation. Forty-five feet (45') wide and twenty-two feet (22') deep, it is a full two-and-a-half stories and five bays with inside end chimneys on a gently sloping gable roof. All fenestration is trabeated with white, wooden lintels. Windows are 6/6 double hung sash except for the third floor which has six light casement sash. Brick dentil cornices extend across the front and rear of the building.

The entrance door has a diamond-light transom and shouldered trim. The stairway in the central hall is magnificent and is a four-flight, oval open-well stair with simple brackets as step-end decoration. All four mantels are nearly identical with a heavily molded rectangular frieze over like pilasters. Parlor windows are set over panels. Other windows have the same beaded back-band trim, including the casement windows on the third floor. All doors are period four-panel doors with original hardware.

A small stone springhouse, seventeen feet (17') by thirteen feet (13'), in the rear yard and the log barn are included.

8. Significance

Period	Areas of Significance—Check and justify below			
<input type="checkbox"/> prehistoric	<input type="checkbox"/> archeology-prehistoric	<input type="checkbox"/> community planning	<input type="checkbox"/> landscape architecture	<input type="checkbox"/> religion
<input type="checkbox"/> 1400–1499	<input type="checkbox"/> archeology-historic	<input type="checkbox"/> conservation	<input type="checkbox"/> law	<input type="checkbox"/> science
<input type="checkbox"/> 1500–1599	<input type="checkbox"/> agriculture	<input type="checkbox"/> economics	<input type="checkbox"/> literature	<input type="checkbox"/> sculpture
<input type="checkbox"/> 1600–1699	<input checked="" type="checkbox"/> architecture	<input type="checkbox"/> education	<input type="checkbox"/> military	<input type="checkbox"/> social/
<input checked="" type="checkbox"/> 1700–1799	<input type="checkbox"/> art	<input type="checkbox"/> engineering	<input type="checkbox"/> music	<input type="checkbox"/> humanitarian
<input checked="" type="checkbox"/> 1800–1899	<input type="checkbox"/> commerce	<input checked="" type="checkbox"/> exploration/settlement	<input type="checkbox"/> philosophy	<input type="checkbox"/> theater
<input type="checkbox"/> 1900–	<input type="checkbox"/> communications	<input type="checkbox"/> industry	<input type="checkbox"/> politics/government	<input type="checkbox"/> transportation
		<input type="checkbox"/> invention		<input type="checkbox"/> other (specify)

Specific dates 1761, 1791, ca. 1855 **Builder/Architect** John Rees, David Rees, Jacob Rees

Statement of Significance (in one paragraph)

The Rees house is significant for its historical associations with the Rees family, an early settler family in Berkeley County, West Virginia (then Frederick County, Virginia). It is also significant for being a wonderful collection of American architectural history representing three distinct periods and three types of construction, and it was entirely built by three generations of the same family.

On September 7, 1761, John Rees and his wife and children transferred their membership in the Quaker Meeting House at Sadsbury (Lancaster County), Pennsylvania to Hopewell in Frederick County, Virginia. The log house was constructed at approximately this time as a permanent dwelling for this settler's family. The house had five rooms and a large stone cooking fireplace with oven. It is constructed entirely of hand-hewn logs and beams and hand-planed interior board walls. Interestingly, John Rees was disowned at Hopewell Meeting House because he "Neglected attending the meetings" on October 1, 1781.

The house and farm of 300 acres in 1791 went to son David who constructed the Federal stone house and sided the log house. The contrast in workmanship is very apparent as sawn lumber was used for the joists and although board wall partitions were again used, the boards are not as wide. The mantels and stairway in particular are very fine period work.

David's grandson, Jacob, built the brick house, ca. 1855, which is an exceptionally fine late Greek Revival dwelling. The exterior with its handsome brick façade of trabeated fenestration has definite classical overtones. No expense was spared in finishing the house with its sweeping staircase and well trimmed large rooms. Unfortunately, and probably because of the expense of building the brick house, the property was sold for debt in 1857. Finally, in 1873, it was sold to the LeFevres, a family who again have owned it through successive generations.

The Rees house is significant for being a representation in Berkeley County of vernacular architectural development and of the changing fortunes of one of the early settler families and their successive generations.

9. Major Bibliographical References

Hopewell Friends History, 1734-1934, Frederick County, Virginia by a Joint Committee of Hopewell Friends, Genealogical Publishing Co., Inc., Baltimore, Md. 1975.
The Berkeley Journal, Issue Eight 1979, published by the Berkeley County County Historical Society.

10. Geographical Data

Acreeage of nominated property 3 acres
 Quadrangle name Inwood, WV

Quadrangle scale 1 : 24,000

UMT References

A

1	7
---	---

7	5	0	2	0	0
---	---	---	---	---	---

4	3	5	5	3	3	0
---	---	---	---	---	---	---

 Zone Easting Northing

B

--	--

--	--	--	--

--	--	--	--	--	--

 Zone Easting Northing

C

--	--

--	--	--	--

--	--	--	--	--	--

D

--	--

--	--	--	--

--	--	--	--	--	--

E

--	--

--	--	--	--

--	--	--	--	--	--

F

--	--

--	--	--	--

--	--	--	--	--	--

G

--	--

--	--	--	--

--	--	--	--	--	--

H

--	--

--	--	--	--

--	--	--	--	--	--

Verbal boundary description and justification Nominated property includes roughly 100' on each side of the house and buildings and runs down to Sylvan Run (see map).

List all states and counties for properties overlapping state or county boundaries

state N/A code county code

state code county code

11. Form Prepared By

name/title Frances D. Ruth - Chairperson
 organization Berkeley County Historic Landmarks Commission date September 30, 1983
 street & number Route #2, Box 320 telephone (304) 754 - 7097
 city or town Martinsburg, state West Virginia

12. State Historic Preservation Officer Certification

The evaluated significance of this property within the state is:

national state local

As the designated State Historic Preservation Officer for the National Historic Preservation Act of 1966 (Public Law 89-665), I hereby nominate this property for inclusion in the National Register and certify that it has been evaluated according to the criteria and procedures set forth by the Heritage Conservation and Recreation Service.

State Historic Preservation Officer signature 

title Commissioner, WV Department of Culture and History date November 18, 1983

For HCRS use only

I hereby certify that this property is included in the National Register

Entered in the
National Register

date 1/12/84

Keeper of the National Register

Attest:

date

Chief of Registration

JOHN, DAVID, and JACOB REES HOUSE

G-17

Inwood Quadrangle

Berkeley County, West Virginia

Area 3 acres

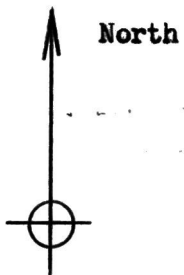
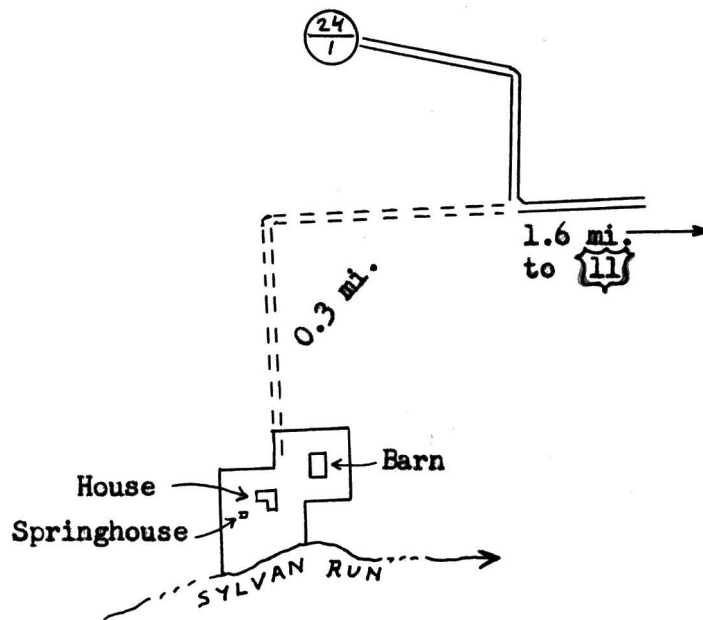

SCALE 1 : 7,920

Copied September 1983 from
photo AGS-90-39, Apr 23, 1938
by Galtjo L. Geertsema

NATIONAL REGISTER OF HISTORIC PLACES
EVALUATION/RETURN SHEET

Rees, John, David, and Jacob, House
Berkeley County
WEST VIRGINIA

Working No. DEC 16 1983
Fed. Reg. Date: 2-5-85
Date Due: 1/24/84 - 1/30/84
Action: ACCEPT 1/2/84
 RETURN
 REJECT
Federal Agency: _____

Entered in the
National Register

- resubmission
- nomination by person or local government
- owner objection
- appeal

Substantive Review: sample request appeal NR decision

Reviewer's comments:

Recom./Criteria _____
Reviewer _____
Discipline _____
Date _____
_____ see continuation sheet

Nomination returned for: _____ technical corrections cited below
_____ substantive reasons discussed below

1. Name

2. Location

3. Classification

Category: Ownership Public Acquisition Status Accessible Present Use

4. Owner of Property

5. Location of Legal Description

6. Representation in Existing Surveys

Has this property been determined eligible? yes no

7. Description

Condition: excellent good fair
 deteriorated ruins unexposed
Check one: unaltered altered
Check one: original site moved date _____

Describe the present and original (if known) physical appearance

- summary paragraph
- completeness
- clarity
- alterations/integrity
- dates
- boundary selection

8. Significance

Period Areas of Significance—Check and justify below

Specific dates Builder/Architect
Statement of Significance (*in one paragraph*)

- summary paragraph
- completeness
- clarity
- applicable criteria
- justification of areas checked
- relating significance to the resource
- context
- relationship of integrity to significance
- justification of exception
- other

9. Major Bibliographical References

10. Geographical Data

Acreage of nominated property _____

Quadrangle name _____

UTM References _____

Verbal boundary description and justification

11. Form Prepared By

12. State Historic Preservation Officer Certification

The evaluated significance of this property within the state is:

 ___ national ___ state ___ local

State Historic Preservation Officer signature

title date

13. Other

- Maps
- Photographs
- Other

Questions concerning this nomination may be directed to _____

Signed _____ Date _____ Phone: _____



- 1 JOHN, DAVID, and JACOB REES HOUSE
- 2 Bunker Hill, West Virginia
- 3 Don C. Wood
- 4 June 1983
- 5 Berkeley County Court House, Martinsburg
- 6 East and north façades;
camera facing southwest
- 7 G - 17 #1 of 7

78



- 1 JOHN, DAVID, and JACOB REES HOUSE
- 2 Bunker Hill, West Virginia
- 3 Frances D. Ruth
- 4 June 1983
- 5 Berkeley County Court House, Martinsburg
- 6 Step-end decoration, stone house;
camera facing east
- 7 G - 17 #2 of 7

78



- 1 JOHN, DAVID, and JACOB REES HOUSE
- 2 Bunker Hill, West Virginia
- 3 Frances D. Ruth
- 4 June 1983
- 5 Berkeley County Court House, Martinsburg
- 6 Window detail, stone house;
camera facing south.
- 7 G - 17 #3 of 7

70 E



78 E

- 1 JOHN, DAVID, and JACOB REES HOUSE
- 2 Bunker Hill, West Virginia
- 3 Frances D. Ruth
- 4 June 1983
- 5 Berkeley County Court House, Martinsburg
- 6 Mantelpiece, stone house;
camera facing west
- 7 G - 17 #4 of 7



70 E

- 1 JOHN, DAVID, and JACOB REES HOUSE
- 2 Bunker Hill, West Virginia
- 3 Frances D. Ruth
- 4 June 1983
- 5 Berkeley County Court House, Martinsburg
- 6 Step-end decoration, brick house;
camera facing west
- 7 G - 17 #5 of 7



- 1 JOHN, DAVID, and JACOB REES HOUSE
- 2 Bunker Hill, West Virginia
- 3 Frances D. Ruth
- 4 June 1983
- 5 Berkeley County Court House, Martinsburg
- 6 Oval stair-well, brick house;
camera facing west
- 7 G - 17 #6 of 7

7 8 E



- 1 JOHN, DAVID, and JACOB REES HOUSE
- 2 Bunker Hill, West Virginia
- 3 Frances D. Ruth
- 4 June 1983
- 5 Berkeley County Court House, Martinsburg
- 6 Mantelpiece and window, brick house;
camera facing west
- 7 G - 17 #7 of 7

82

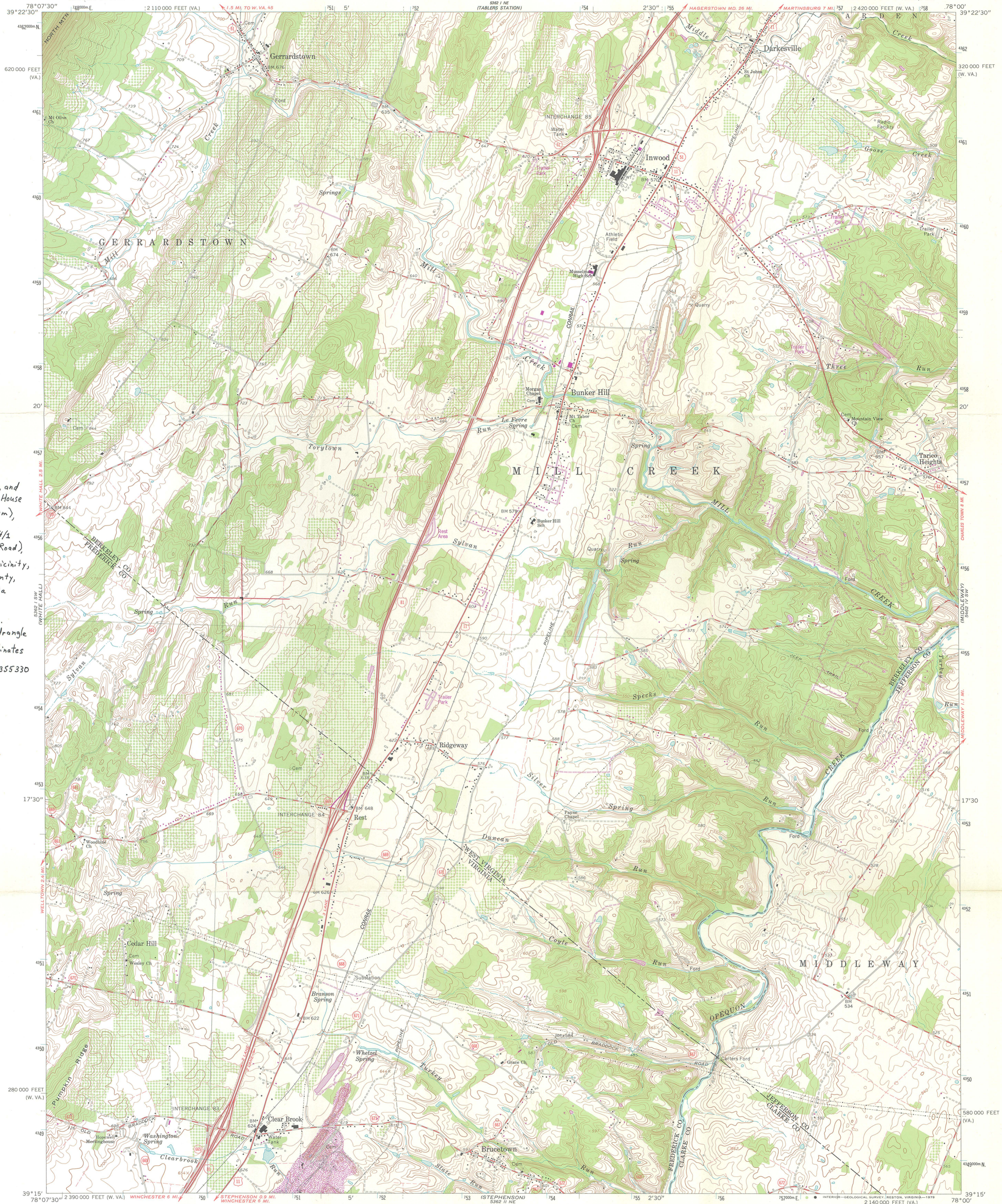
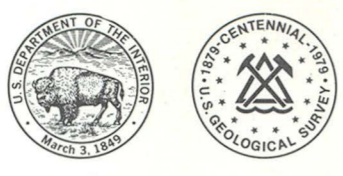

John, David, and
Jacob Rees House
(LeFevre Farm),
W.Va. Route 24 1/2
(Sam Mason Road),
Bunker Hill vicinity,
Berkeley County,
West Virginia

Inwood, W.Va.
U.S.G.S. Quadrangle
U.T.M. Coordinates
17/750200/4355330

Mapped, edited, and published by the Geological Survey
in cooperation with Commonwealth of Virginia Division of
Mineral Resources
Control by USGS and USC&GS
Topography by photogrammetric methods from aerial
photographs taken 1963. Field checked 1966
Polyconic projection. 1927 North American datum
10,000-foot grids based on West Virginia coordinate system,
north zone, and Virginia coordinate system, north zone
1000-meter Universal Transverse Mercator grid ticks,
zone 17, shown in blue
Fine red dashed lines indicate selected fence and field lines where
generally visible on aerial photographs. This information is unchecked
Revisions shown in purple compiled in cooperation with Commonwealth
of Virginia agencies from aerial photographs taken 1977 and other
source data. This information not field checked. Map edited 1979

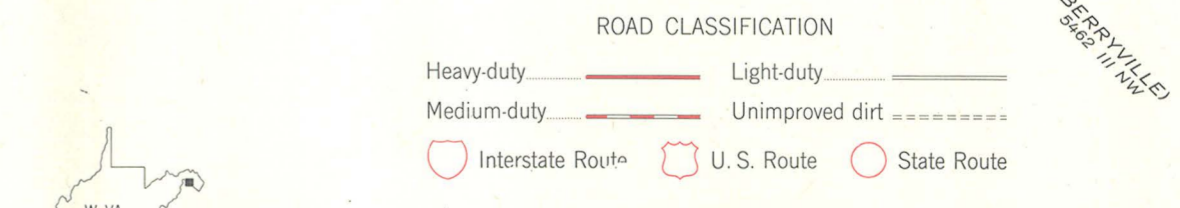
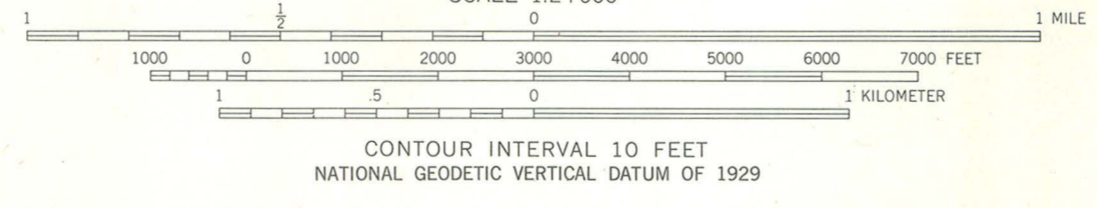
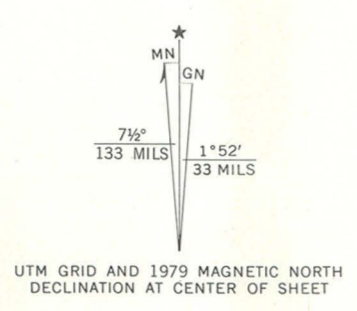

THIS MAP COMPLIES WITH NATIONAL MAP ACCURACY STANDARDS
FOR SALE BY U.S. GEOLOGICAL SURVEY, RESTON, VIRGINIA 22092
AND VIRGINIA DIVISION OF MINERAL RESOURCES, CHARLOTTEVILLE, VIRGINIA 22903
A FOLDER DESCRIBING TOPOGRAPHIC MAPS AND SYMBOLS IS AVAILABLE ON REQUEST

INWOOD, W. VA. - VA.
SE/4 GERRARDSTOWN 15' QUADRANGLE
N3915-W7800/7.5
1966
PHOTOREVISED 1979
AMS 5362 I SE-SERIES V854

THE S. SPENCER MOORE CO.
118 CAPITOL STREET
CHARLESTON, W. VA. 25301
PH. 304-342-6185