

EXP. 12/31/84

United States Department of the Interior
National Park Service

National Register of Historic Places
Inventory—Nomination Form

See instructions in *How to Complete National Register Forms*
Type all entries—complete applicable sections

For NPS use only

received MAR 30 1982

date entered APR 29 1982

1. Name

historic Lewis, Governor James T., House

and/or common Lewis-Stare House (preferred)

2. Location

street & number 711 W. James Street not for publication

city, town Columbus vicinity of ~~Congressional district~~

state Wisconsin code 55 county ~~Columbia~~ Columbus code 021

3. Classification

Category	Ownership	Status	Present Use
<input type="checkbox"/> district	<input type="checkbox"/> public	<input checked="" type="checkbox"/> occupied	<input type="checkbox"/> agriculture
<input checked="" type="checkbox"/> building(s)	<input checked="" type="checkbox"/> private	<input type="checkbox"/> unoccupied	<input type="checkbox"/> commercial
<input type="checkbox"/> structure	<input type="checkbox"/> both	<input type="checkbox"/> work in progress	<input type="checkbox"/> educational
<input type="checkbox"/> site	Public Acquisition	Accessible	<input type="checkbox"/> entertainment
<input type="checkbox"/> object	<input type="checkbox"/> in process	<input type="checkbox"/> yes: restricted	<input type="checkbox"/> government
	<input type="checkbox"/> being considered	<input checked="" type="checkbox"/> yes: unrestricted	<input type="checkbox"/> industrial
	Not applicable	<input type="checkbox"/> no	<input type="checkbox"/> military
			<input type="checkbox"/> museum
			<input type="checkbox"/> park
			<input checked="" type="checkbox"/> private residence
			<input type="checkbox"/> religious
			<input type="checkbox"/> scientific
			<input type="checkbox"/> transportation
			<input type="checkbox"/> other:

4. Owner of Property

name Susan E. Stare

street & number 711 W. James Street

city, town Columbus vicinity of state Wisconsin 53925

5. Location of Legal Description

courthouse, registry of deeds, etc. Columbia County Courthouse

street & number P. O. Box 177

city, town Portage state Wisconsin 53901

6. Representation in Existing Surveys

title Wisconsin Inventory of Historic Places has this property been determined eligible? ☐ yes ☒ no

date 1975 ☐ federal ☒ state ☐ county ☐ local

depository for survey records State Historical Society of Wisconsin

city, town Madison state Wisconsin 53706

7. Description

Condition

☐ excellent
☒ good
☐ fair

☐ deteriorated
☐ ruins
☐ unexposed

Check one

☐ unaltered
☒ altered

Check one

☒ original site
☐ moved date _____

Describe the present and original (if known) physical appearance

Dramatically sited on the crest of a hill on the northwest edge of Columbus, the Lewis-Stare House is an imposing cream brick Italianate structure distinguished by widely extended and bracketed eaves and surmounted by an elaborate cupola. Characterized by unusually tall proportions and overscaled detail, the house is a dominant visual landmark in a neighborhood of more modest buildings.

Built in two phases over a period of three years (1854-56),¹ the house is composed on a cross plan with two sensitively designed twentieth century additions (an enclosed porch and an attached garage) built on the rear. Although the oldest unit of the house (the western wing, completed in 1854) is a two story-plus-attic structure with bracketed eave, the second unit (the eastern wing, completed in 1856) rises 28" higher (two stories, attic) and is crowned with a cupola, dominating the house in size, scale, and character. The low-pitched hip roof has unusually broad eaves with a pronounced cornice, supported by large scrolled brackets (paired at the corners). The same treatment is repeated on the cupola in smaller scale, where extended eaves are supported by similar brackets. Round headed windows rise the full height of the cupola on all sides and retain some of the original sash windows and muntins. On the first two stories, the tall windows are symmetrically disposed across the facade, crowned with molded and projecting cornice-like window hoods. A bracketed balcony (its original balustrade now replaced by a cast-iron rail) extends over the first story window of the center bay on the east facade. A porch with Tuscan columns wraps around the corner of the front (the original railing now removed) and a side porch on the south facade of the original unit was enclosed and converted to a sun porch in the 1920s. At the same time, a two story garage and sleeping porch was built to the rear of the house, designed in a handsome Prairie vernacular style with hip roof, banded windows, and extended eaves. Finally, an original window on the building's north facade (west wing) has been altered into a bay window.

The interior of the Lewis-Stare House remains in a good state of preservation. Although ceilings on three first floor rooms have been lowered (in the parlor, library, and living room) elsewhere the original ceiling heights and hardwood floors have been maintained. Throughout the house, including the first floor rooms, the original wooden window and door trim is unaltered and in good condition. The interior of the cupola, as well, is in original condition.

Situated on a spacious lawn, much of the visual appeal of the property derives from its dramatic location overlooking the northwest side of Columbus. Today, its tall cupola is the highest landmark in the area and perfect for surveying the surrounding neighborhood. A stone barn/storage building in the far northwest corner on the property is included in the nomination. Constructed of locally quarried stone, the gable roof structure once served as a grist mill and, although its original equipment has been removed, the heavy hand-hewn structural timbers remain in good condition and the stone walls, roughly two feet in thickness, are largely unaltered. Built in 1856, it is included in the nomination because of its historic relationship to the property as a utilitarian outbuilding.

8. Significance

Period	Areas of Significance—Check and justify below			
<input type="checkbox"/> prehistoric	<input type="checkbox"/> archeology-prehistoric	<input type="checkbox"/> community planning	<input type="checkbox"/> landscape architecture	<input type="checkbox"/> religion
<input type="checkbox"/> 1400–1499	<input type="checkbox"/> archeology-historic	<input type="checkbox"/> conservation	<input type="checkbox"/> law	<input type="checkbox"/> science
<input type="checkbox"/> 1500–1599	<input type="checkbox"/> agriculture	<input type="checkbox"/> economics	<input type="checkbox"/> literature	<input type="checkbox"/> sculpture
<input type="checkbox"/> 1600–1699	<input checked="" type="checkbox"/> architecture	<input type="checkbox"/> education	<input type="checkbox"/> military	<input type="checkbox"/> social/
<input type="checkbox"/> 1700–1799	<input type="checkbox"/> art	<input type="checkbox"/> engineering	<input type="checkbox"/> music	<input type="checkbox"/> humanitarian
<input checked="" type="checkbox"/> 1800–1899	<input type="checkbox"/> commerce	<input type="checkbox"/> exploration/settlement	<input type="checkbox"/> philosophy	<input type="checkbox"/> theater
<input checked="" type="checkbox"/> 1900–	<input type="checkbox"/> communications	<input type="checkbox"/> industry	<input type="checkbox"/> politics/government	<input type="checkbox"/> transportation
		<input type="checkbox"/> invention		<input checked="" type="checkbox"/> other (specify)
				associated with sig-
Specific dates	1854, 1856 ¹ – 1966	Builder/Architect	not known	nificant persons

Statement of Significance (in one paragraph)

Historically significant for its association with Wisconsin Civil War Governor James T. Lewis and prominent Columbus businessman Fred A. Stare, the Lewis-Stare House is a distinguished vernacular adaptation of Italianate architecture, reflecting both the skill of local craftsmen and the stature of its occupants. Built in 1854–56 by Governor Lewis,¹ the house is sited on a hill overlooking the city, a commanding visual landmark which recalls over a century of state and local history.

Architecture

Situated on a gently sloping hill at the northwest edge of the city, the Lewis-Stare House is a restrained but imposing example of vernacular Italianate architecture. First completed in 1854, the west wing of the house was constructed with handmade brick fired upon the premises; the more elaborate cupola-adorned east wing was completed in 1856, built with cream brick hauled to the site by ox team.⁶ Although two sensitively designed additions have been appended to the rear of the structure, the characteristic Italianate hallmarks—dramatically bracketed and extended eaves, tall proportions, molded window hoods, and an elaborate cupola—are still well-preserved, reflecting both the dignity and the vigor of the style. Although not elaborate, its scale and attractive siting help make the Lewis-Stare House an outstanding Italianate structure in Columbus. The nearby stone barn, constructed of locally quarried stone and supported by hand-hewn structural timbers, remains in good condition but does not contribute to the architectural significance of the property. Built in 1856 by Lewis' brother William, the structure has been a functional part of the property since that date. ¹⁰

Associated with Significant Person

The Lewis-Stare House, built by Governor James T. Lewis in 1854–56,¹ is historically significant as the last remaining structure associated with Wisconsin's final Civil War governor. An early and important Columbus settler, James T. Lewis rose steadily through the ranks of local and state government, serving successively as district attorney, county judge, constitutional convention delegate, general assembly member, state senator, lieutenant governor, secretary of state, and, beginning in January 1864, Wisconsin's ninth governor.^{2,3}

Lewis was elected governor on the Union Republican ticket in 1863, amassing the largest majority of votes received by any gubernatorial candidate prior to 1896.⁴ As the state's chief executive during the closing years of the Civil War, Governor Lewis was preoccupied with overseeing Wisconsin's role in the conflict. Concerned with the lack of facilities and care provided to wounded soldiers by the federal government, Lewis was successful in securing the transfer of sick and disabled Wisconsin soldiers to hospitals within their home state. In addition, Lewis was able to adjust Wisconsin's draft quota to a lower and, to Lewis' mind, fairer level. Despite these successes, Lewis declined renomination in 1865, as well as repeated offers of state and national political office, and chose instead to devote his time and attention to local Columbus affairs.⁵

9. Major Bibliographical References

See Continuation Sheet

10. Geographical Data

ACREAGE NOT VERIFIED

UTM NOT VERIFIED

Acres of nominated property 2.0

Quadrangle name Columbus, WI

Quadrangle scale 1:62500

UMT References

A 16 336150 4800600
Zone Easting Northing

B
Zone Easting Northing

C

D

E

F

G

H

Verbal boundary description and justification The nominated property is a rectangle, contained within Lot 1, Block 10 of Lewis' First Addition to Columbus, WI, described as follows: Beginning at a point 80 feet southwest of the northwest corner of the intersection of west James and Charles streets on the Charles Street property line of 711 W. James St., and continuing along said line (parallel to Charles St.) for 265 feet, then (continued)

List all states and counties for properties overlapping state or county boundaries

state	code	county	code
-------	------	--------	------

state	code	county	code
-------	------	--------	------

11. Form Prepared By

name/title Julie Davis/volunteer and Leonard T. Garfield/Historian

organization State Historical Society of Wisconsin date 12-8-81

street & number 816 State Street telephone 608/262-2970

city or town Madison state Wisconsin 53706

12. State Historic Preservation Officer Certification

The evaluated significance of this property within the state is:

 national state X local

As the designated State Historic Preservation Officer for the National Historic Preservation Act of 1966 (Public Law 89-665), I hereby nominate this property for inclusion in the National Register and certify that it has been evaluated according to the criteria and procedures set forth by the National Park Service.

State Historic Preservation Officer signature

Richard Henry

title Director, State Historical Society of Wisconsin

date

2/11/82

For NPS use only

I hereby certify that this property is included in the National Register

Entered in the
National Register

date

4/29/82

Delores Byers
Keeper of the National Register

Attest:

date

Chief of Registration

**United States Department of the Interior
Heritage Conservation and Recreation Service**

**National Register of Historic Places
Inventory—Nomination Form**

For HCRS use only

received

date entered

Lewis-Stare House, Columbus, Columbia County, Wis.

Continuation sheet

Item number 8

Page 1

Lewis first arrived in Columbus from his native New York State in 1845 and was for a time Columbia County's first and only lawyer. In 1854, while he served as lieutenant governor in the administration of William Barstow, Lewis built his first home (now known as the Lewis-Stare House). The original portion of the 18-room Italianate structure was built with cream-colored brick fired upon the premises; the Lewis family moved in while the front portion with the cupola was still under construction.⁶

In 1856, Lewis sold the property to his brother William, and subsequently moved his own family to a Greek Revival house across the street where he resided until his death in 1904. But, the second Lewis house was demolished in 1920,⁷ and the Lewis-Stare House retains significance as the last remaining structure associated with Governor Lewis's life and career.

Since 1917, the house has been home to the Fred A. Stare family. Fred Stare was a successful businessman and a noted pioneer in the canning industry, widely recognized for his contributions to that historically important Wisconsin industry.

Stare joined the newly formed Columbus Canning Company in 1901, eventually becoming general manager in 1924 and president of the firm the next year. Under his administration, the company was reorganized and expanded into the Columbus Foods Corporation, a major enterprise in the city.⁸ During World War II, Stare served the canning industry as a member of the first Industry Advisory Committee for the War Production Board, frequently serving as a consultant in Washington. In 1945, Stare assumed the presidency of the National Cannery Association for two years, during which time Columbus Foods Company merged with Stokely Van Camp, Inc.⁹ Meanwhile, in 1944, Stare was appointed president of the Farmers and Merchants Union Bank in Columbus and served in this capacity until 1963 when he was named chairman of the Board of directors. The author of numerous books and publications, including The Story of Wisconsin's Canning Industry, Stare died in 1966. Today, the house remains in the Stare family.

¹ Property Abstract, in possession of Susan E. Stare, 711 W. James St., Columbus, WI 53925.

² The State Historical Society of Wisconsin, Dictionary of Wisconsin Biography (Milwaukee: The North American Press, 1960), p. 230.

³ F. A. Stare, "Story of Columbus," Columbus Journal-Republican, June 11, 1953.

⁴ Richard N. Current, The History of Wisconsin, Vol. 2. (Madison: State Historical Society of Wisconsin, 1976), pp. 406-08.

⁵ Soldiers' and Citizens' Album of Biographical Record (Chicago: Grand Army Publishing Co., 1890), p. 691.

⁶ F. A. Stare, "Story of Columbus," Columbus Journal-Republican, June 11, 1953.

(continued)

**United States Department of the Interior
Heritage Conservation and Recreation Service****National Register of Historic Places
Inventory—Nomination Form**

Lewis-Stare House, Columbus, Columbia County, Wis.

Continuation sheet

Item number 8

Page 2

For HCRS use only
received
date entered

7 F. A. Stare, "Story of Columbus," Columbus Journal-Republican, January 5, 1956.

8 F. A. Stare, The Story of Wisconsin's Great Canning Industry. (Baltimore: The Canning Trade, 1949), pp. 372-76.

9 Ibid.

10 F.A.Stare, "Story of Columbus", Columbus Journal-Republican, March 5, 1953.

11 The dates of specific significance represent the years of construction (1854, 56) and the year of F.A. Stare's death (1966).

**United States Department of the Interior
Heritage Conservation and Recreation Service****National Register of Historic Places
Inventory—Nomination Form**

Lewis-Stare House, Columbus, Columbia County, Wis.

Continuation sheet

Item number 9, 10

Page 1

For HCRS use only
received
date entered

Bibliographic Reference

Current, Richard N., The History of Wisconsin, Vol II. Madison: The State Historical Society of Wisconsin, 1976.

Soldiers' and Citizens' Album of Biographical Record. Chicago: Grand Army Publishing Company, 1890.

Stare, Fred A. "Story of Columbus," Columbus Journal-Republican, 1951-1963 (appeared serially).

Stare, Fred A. The Story of Wisconsin's Great Canning Industry. Baltimore: The Canning Trade, 1949.

Verbal boundary description (continued):

turn right 90° and proceed northwesterly 144 feet, then turn right 90° and proceed northeasterly 265 feet, then turn right 90° and proceed southeasterly 144 feet to point of beginning.

NATIONAL REGISTER OF HISTORIC PLACES

United States Department of the Interior
National Park Service

EVALUATION / RETURN SHEET

Property: Lewis, Gov. James T. House
State, County: WI, Columbia
Federal Agency: _____

Working No. 3/30/82-948

Fed. Reg. Date: 2.7.83

Date Due: 4/29/82 - 5/14/82

Action: ☒ ACCEPT 4/29/82

Entered in the ☐ RETURN _____

National Register ☐ REJECT _____

photos ☒

maps ☒

- ☐ resubmission
- ☐ nomination by person or local government
- ☐ owner objection
- ☐ appeal

Substantive Review: ☐ sample ☐ request ☐ appeal ☐ NR decision

Reviewer's comments:

Recom./Criteria _____

Reviewer _____

Discipline _____

Date _____

☐ see continuation sheet

Nomination returned for: ☐ technical corrections cited below
☐ substantive reasons discussed below

1. Name

2. Location

3. Classification

Category	Ownership	Status	Present Use
	Public Acquisition	Accessible	

4. Owner of Property

5. Location of Legal Description

6. Representation in Existing Surveys

has this property been determined eligible? ☐ yes ☐ no

7. Description

Condition	Check one	Check one
<input type="checkbox"/> excellent	<input type="checkbox"/> deteriorated	<input type="checkbox"/> unaltered
<input type="checkbox"/> good	<input type="checkbox"/> ruins	<input type="checkbox"/> altered
<input type="checkbox"/> fair	<input type="checkbox"/> unexposed	<input type="checkbox"/> original site
		<input type="checkbox"/> moved date _____

Describe the present and original (if known) physical appearance

- ☐ summary paragraph
- ☐ completeness
- ☐ clarity
- ☐ alterations/integrity
- ☐ dates
- ☐ boundary selection

8. Significance

Period _____ Areas of Significance—Check and justify below

Specific dates _____ Builder/Architect _____

Statement of Significance (in one paragraph)

- _____ summary paragraph
- _____ completeness
- _____ clarity
- _____ applicable criteria
- _____ justification of areas checked
- _____ relating significance to the resource
- _____ context
- _____ relationship of integrity to significance
- _____ justification of exception
- _____ other

9. Major Bibliographical References

10. Geographical Data

Acreage of nominated property _____

Quadrangle name _____

UNIT References

Verbal boundary description and justification

11. Form Prepared By

12. State Historic Preservation Officer Certification

The evaluated significance of this property within the state is:

_____ national _____ state _____ local

State Historic Preservation Officer signature

Title _____ date _____

13. Other

- _____ Maps
- _____ Photographs
- _____ Other

Questions concerning this nomination may be directed to _____

Signed _____ Date _____ Phone: 202 272 - 3504

Comments for any item may be continued on an attached sheet



Lewis-Stare House, 711 West James St.,
Columbus, Columbia Co., WI. Photo by
Leonard T. Garfield, Nov., 1981. Neg. at
State Historic al Society of WI. View from
east. Photo # 1 of 3..



Lewis-Stare House, 711 West James St.,
Columbus, Columbia Co., WI. Photo by
Leonard T. Garfield, Nov., 1981. Neg.
at State Historical Society of Wisconsin.
View from northeast. Photo#2 of 3.



Lewis-Stare House, 711 West James St.,
Columbus, Columbia County, Wis. Photo
by Julie Davis, February, 1982. Negative
at the State Historical Society of Wisconsin.
Stone barn/storage building from southeast.
Photo # 3 of 3.



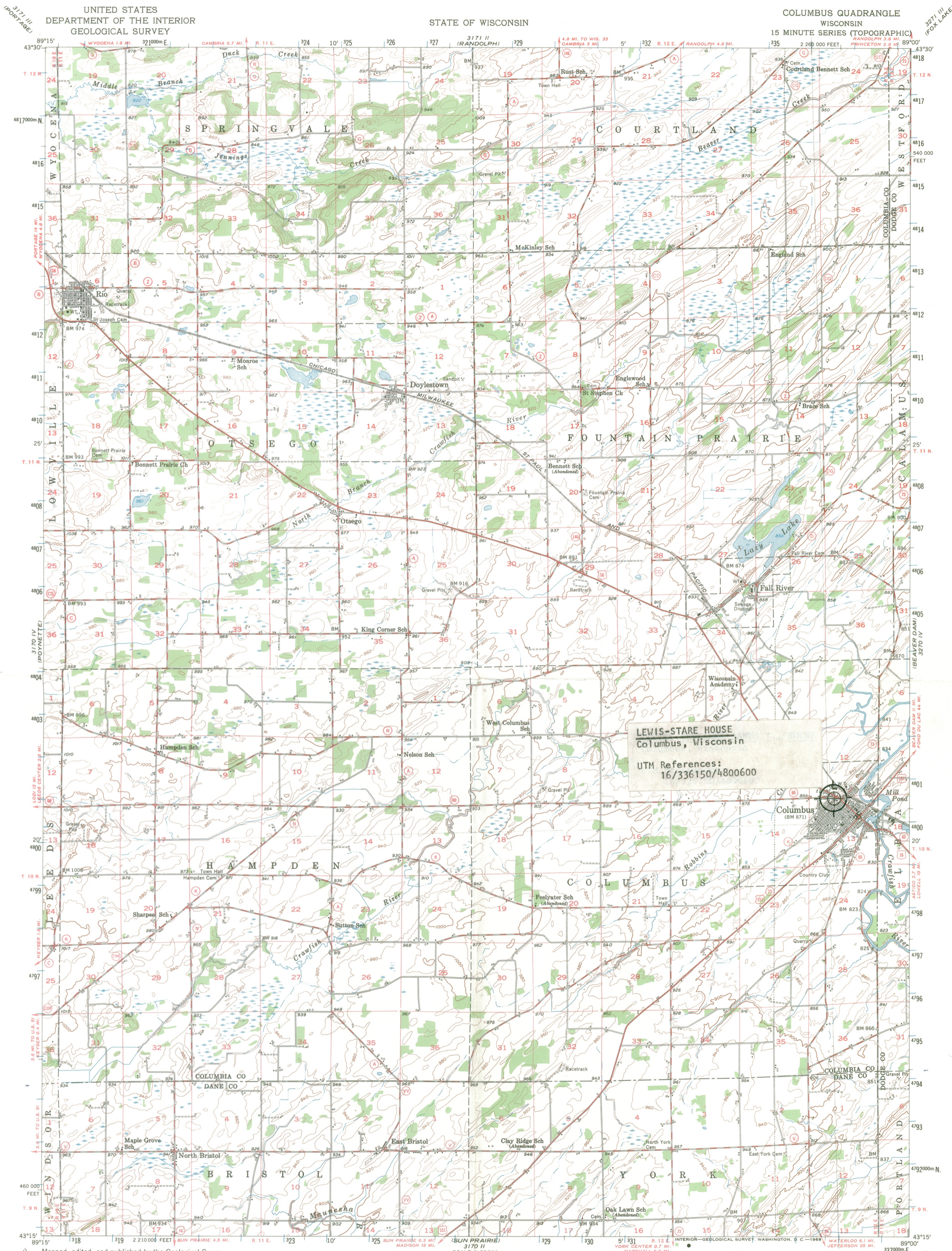

Mapped, edited, and published by the Geological Survey in cooperation with State of Wisconsin agencies. Control by USGS and USC&GS. Topography from aerial photographs by Kelsh plotter. Aerial photographs taken 1953. Field check 1955. Polyconic projection. 1927 North American datum. 10,000-foot grid based on Wisconsin coordinate system, south zone. 1000-meter Universal Transverse Mercator grid ticks, zone 16, shown in blue.

UTM GRID AND 1955 MAGNETIC NORTH DECLINATION AT CENTER OF SHEET

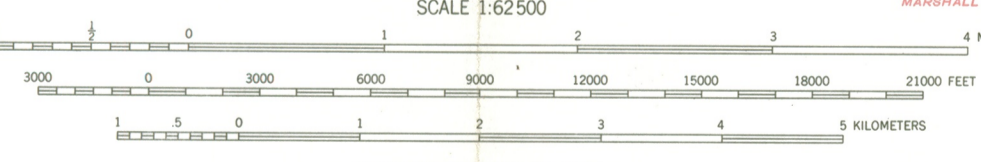

CONTOUR INTERVAL 20 FEET DATUM IS MEAN SEA LEVEL

THIS MAP COMPLIES WITH NATIONAL MAP ACCURACY STANDARDS FOR SALE BY U.S. GEOLOGICAL SURVEY, WASHINGTON, D. C. 20242 AND WISCONSIN GEOLOGICAL AND NATURAL HISTORY SURVEY, MADISON, WISCONSIN 53706 A FOLDER DESCRIBING TOPOGRAPHIC MAPS AND SYMBOLS IS AVAILABLE ON REQUEST



ROAD CLASSIFICATION
Heavy-duty ——— Light-duty ———
Medium-duty ——— Unimproved dirt ———
U.S. Route ——— State Route ———

COLUMBUS, WIS.
N4315-W8900/15

1955

AMS 3170 I-SERIES V761

LEWIS-STARE HOUSE

711 West James St., Columbus
Columbia Co., Wis.

Sketch map of site plan

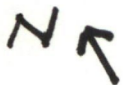
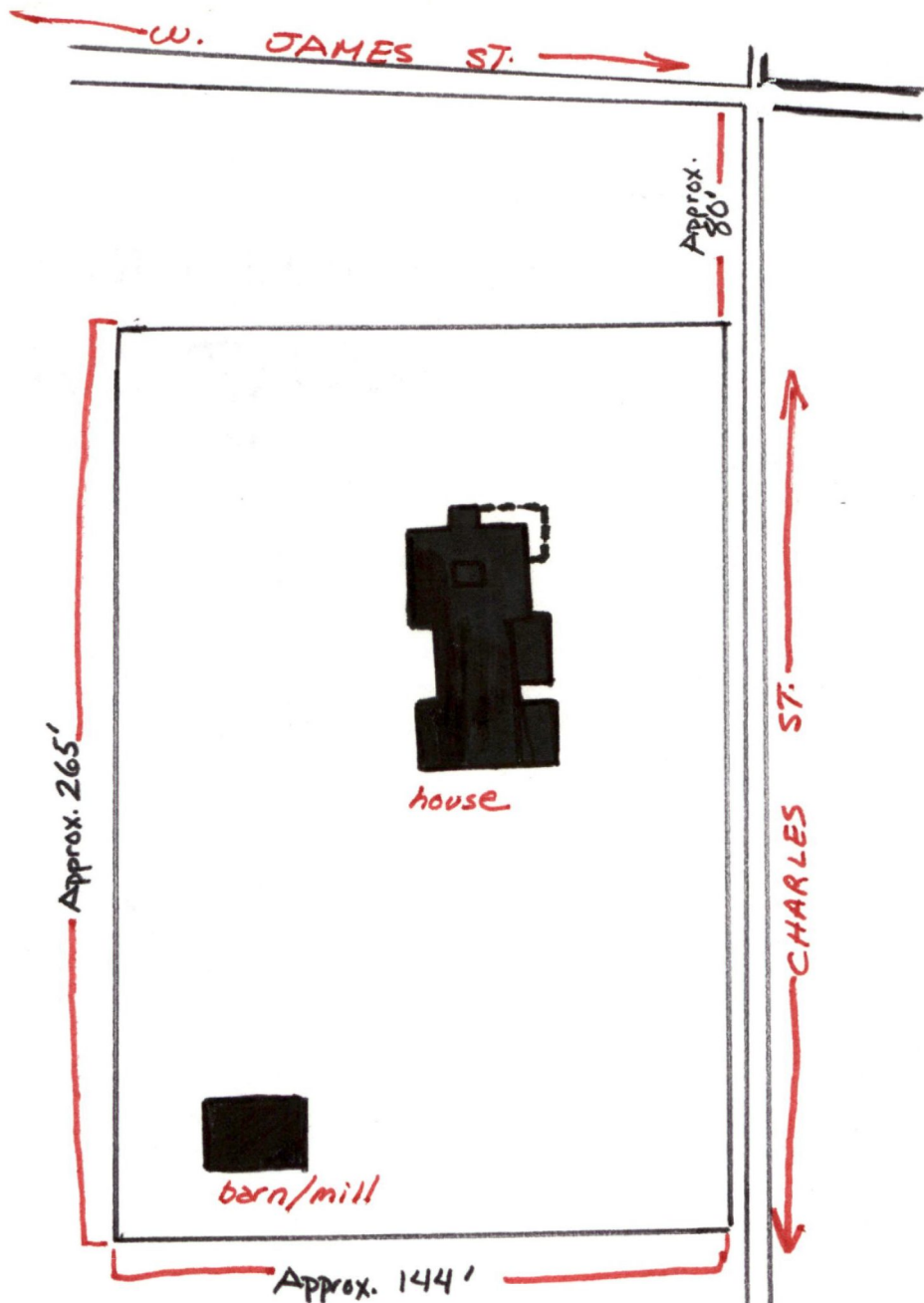

LEWIS-STARE HOUSE: SITE PLAN
NOT TO SCALE



HISTORIC PRESERVATION DIVISION

TO: Carol Shull, Acting Keeper
National Register of Historic Places

FROM: Diane Filipowicz
1 Leonard Garfield
Barbara Wyatt

SUBJECT: National Register Nominations

The following materials are submitted on this 18 day of March, 1982,
for the nomination of the Lewis-Stare House, Columbus, WI
to the National Register of Historic Places:

- 1 original National Register inventory-nomination form
- supplementary survey forms
- district survey form(s)
- 1 original USGS map(s)
- 3 photographs
- 1 sketch map(s)
- piece(s) of correspondence
- other: _____

____ PLEASE INSURE THAT THIS NOMINATION IS REVIEWED

BW:ch

Enclosures

THE STATE HISTORICAL SOCIETY OF WISCONSIN

816 STATE STREET • MADISON, WISCONSIN 53706 RICHARD A. ERNEY, DIRECTOR