



1198

**United States Department of Interior
National Park Service**

**National Register of Historic Places
Registration Form**

This form is for use in nominating or requesting determinations for individual properties and districts. See instructions in *How to Complete the National Register of Historic Places Registration Form* (National Register Bulletin 16A). Complete each item by marking "x" in the appropriate box or by entering the information requested. If an item does not apply to the property being documented, enter "N/A" for "not applicable." For functions, architectural classification, materials, and areas of significance, enter only categories and subcategories from the instructions. Place additional entries and narrative items on continuation sheets (NPS Form 10-900A). Use a typewriter, word processor, or computer, to complete all items.

1. Name of Property

historic name Yawkey, William H., Boathouse
other names/site number N/A

2. Location

street & number	7090 Woodson Street	N/A	not for publication
city or town	Town of Hazelhurst	N/A	vicinity
state	Wisconsin	code	WI
county	Oneida	code	085
zip code	54531	zip code	54531

3. State/Federal Agency Certification

As the designated authority under the National Historic Preservation Act, as amended, I hereby certify that this nomination request for determination of eligibility meets the documentation standards for registering properties in the National Register of Historic Places and meets the procedural and professional requirements set forth in 36 CFR Part 60. In my opinion, the property meets _ does not meet the National Register criteria. I recommend that this property be considered significant _ nationally _ statewide locally. (See continuation sheet for additional comments.)

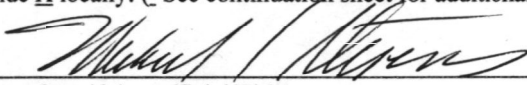
 _____
Signature of certifying official/Title Date 11/16/09

State Historic Preservation Officer – Wisconsin

State or Federal agency and bureau

In my opinion, the property _ meets _ does not meet the National Register criteria.
(See continuation sheet for additional comments.)

Signature of commenting official/Title Date

State or Federal agency and bureau

Yawkey, William H., Boathouse

Oneida

Wisconsin

Name of Property

County and State

4. National Park Service Certification

I hereby certify that the property is:
 entered in the National Register.
 ___ See continuation sheet.
 determined eligible for the National Register.
 ___ See continuation sheet.
 determined not eligible for the National Register.
 ___ See continuation sheet.
 removed from the National Register.
 ___ other, (explain:)

Edson H. Beall

12-30-09

ban

Signature of the Keeper

Date of Action

5. Classification

Ownership of Property (check as many boxes as apply)	Category of Property (Check only one box)	Number of Resources within Property (Do not include previously listed resources in the count)	
		contributing	noncontributing
<input checked="" type="checkbox"/> private	<input checked="" type="checkbox"/> building(s)		
public-local	district	1	buildings
public-State	structure	0	sites
public-Federal	site	0	structures
	object	0	objects
		1	0 Total

Name of related multiple property listing:
(Enter "N/A" if property not part of a multiple property listing.)

N/A

Number of contributing resources is previously listed in the National Register

0

6. Function or Use

Historic Functions

(Enter categories from instructions)

DOMESTIC/camp

Current Functions

(Enter categories from instructions)

DOMESTIC/camp

7. Description

Architectural Classification

(Enter categories from instructions)

LATE NINETEENTH AND EARLY TWENTIETH CENTURY AMERICAN MOVEMENTS/Craftsman

Materials

(Enter categories from instructions)

Foundation WOOD
walls WEATHERBOARD
roof ASPHALT
other N/A

Narrative Description

(Describe the historic and current condition of the property on one or more continuation sheets.)

**United States Department of the Interior
National Park Service**

**National Register of Historic Places
Continuation Sheet**

Section 7 Page 1

Yawkey, William H., Boathouse
Town of Hazelhurst, Oneida County, Wisconsin

Description

The William H. Yawkey Boathouse is situated on the west bank of Lake Katherine in the town of Hazelhurst in Oneida County. The 1917 wet boathouse is located on the property at 7090 Woodson Street and is still owned by descendants of the William H. Yawkey Family. Although there are other buildings on the property, the boathouse is the only resource being nominated to the National Register of Historic Places.

The Yawkey Boathouse has a simple square footprint measuring 36 feet by 36 feet and it rests on wood pilings. The two-story, frame building is clad in horizontal clapboard siding that has been painted a rich brown color. The low-pitched hip roof is covered with asphalt shingles and the wide overhanging eaves feature exposed rafters. Window openings are original and feature wood casings and screens. Glass panes were never set into the window frames, but rather have remained screen openings with interior wood shutters throughout the life of the building. The exterior of the boathouse is modest; however, elements of the Craftsman style are displayed in the low-pitched hip roof, overhanging eaves, exposed rafters, decorative braces on the rear elevation, and bands of window openings.

The facade (southeast) extends into Lake Katherine and features three slips with the original wood overhead doors. The doors open inward like awnings and display a simple decoration that resembles a Y with triangle centered above. The bays vary in size, with the smallest in the middle. The overhead doors remain open all season, and net screening covers each bay in the summer to keep the birds out. The second story of the facade features three bands of window openings. When facing the boathouse from the water, the band of screened openings on the right has been replaced with four casement windows. The band of window openings in the center and on the left remain screens with interior wood shutters. Interior wood shutters with hinges at the bottom of the openings were used to close the screens to protect the living space from the elements.

The lower level side elevations (northeast and southwest) each feature three sets of fixed windows, arranged in bands of three in the middle flanked on each side by a pair. The upper level side elevations have three sets of openings, with a ribbon of five screened openings in the middle flanked by a band of three screened openings on each side. The set of three openings on the northeast elevation has been replaced with casement windows.

From the shoreline, two wood-board walkways provide access to the upper and lower levels of the rear (northwest) elevation of the boathouse. The pedestrian entrance to the lower level is centrally located on the rear elevation. A simple wood door and surround, original to the boathouse, provides access to the interior and

United States Department of the Interior
National Park Service

National Register of Historic Places
Continuation Sheet

Section 7 Page 2

Yawkey, William H., Boathouse
Town of Hazelhurst, Oneida County, Wisconsin

boat slips. The entrance to the upper level is also centrally located on the rear elevation and is accessed by a wood stairway with a simple balustrade. The stairs are parallel to the exterior of the boathouse and lead up to a small landing supported by decorative braces. The landing is sheltered by a low-pitched, hip roof portico supported by square posts. Aside from the addition of a screen door, the entrance door on the upper level is the same as the entrance on the lower level. A band of three screened openings flank the single screened openings located on either side of the door.

Interior

The interior of the boathouse's first level is functional and the structural building elements, such as unfinished beams and rafters, are exposed. The floor is composed of unfinished wood boards that provide platforms between each of the three interior boat slips. Boats are pulled from the water using a pulley system that still operates. The center slip features a vertical wood boat ramp with hinges. A small storage closet is located in the northwest corner. The upper level cannot be accessed from the interior of the lower level.

The upper level is one large room. Similar to the lower level, the structural elements, such as cross-beams, rafters, and clapboard, are exposed, unfinished wood. One alteration to the interior space is the remnants of a bedroom partition located in the northeast corner. This partition was added in the 1950s and removed in the 1980s. Vertical wood paneling and two bands of casement windows in the original screened openings are located along the northeast and southeast elevations. Wood shutters cover the screen openings on the upper level. The shutters are hinged at the bottom and secured at the top with a handmade wood lock. The shutters open inward similar to a hopper window, and drop down to provide light and air. Electricity was added to the boathouse shortly after World War II.

Condition and alterations

The Yawkey Boathouse is in excellent condition. Through the years the boathouse has been well maintained and descendents of William H. Yawkey, including the current owners of the boathouse, are sensitive to the historic character of the building. Aside from the addition of a few casement windows on the upper level, the boathouse retains its original form, materials and design. Overall, the William H. Yawkey Boathouse retains good integrity and reflects its original design and construction.

8. Statement of Significance

Applicable National Register Criteria
(Mark "x" in one or more boxes for the criteria qualifying the property for the National Register listing.)

- A Property is associated with events that have made a significant contribution to the broad patterns of our history.
- B Property is associated with the lives of persons significant in our past.
- C Property embodies the distinctive characteristics of a type, period, or method of construction or represents the work of a master, or possesses high artistic values, or represents a significant and distinguishable entity whose components lack individual distinction.
- D Property has yielded, or is likely to yield, information important in prehistory or history.

Areas of Significance
(Enter categories from instructions)

ARCHITECTURE

Period of Significance

1917

Significant Dates

1917

Criteria Considerations
(Mark "x" in all the boxes that apply.)

Property is:

- A owned by a religious institution or used for religious purposes.
- B removed from its original location.
- C a birthplace or grave.
- D a cemetery.
- E a reconstructed building, object, or structure.
- F a commemorative property.
- G less than 50 years of age or achieved significance within the past 50 years.

Significant Person
(Complete if Criterion B is marked)

N/A

Cultural Affiliation

N/A

Architect/Builder

Unknown

Narrative Statement of Significance
(Explain the significance of the property on one or more continuation sheets.)

Yawkey, William H., Boathouse
Name of Property

Oneida
County and State

Wisconsin

9. Major Bibliographic References

(Cite the books, articles, and other sources used in preparing this form on one or more continuation sheets.)

Previous Documentation on File (National Park Service):

- preliminary determination of individual listing (36 CFR 67) has been requested
- previously listed in the National Register
- previously determined eligible by the National Register
- designated a National Historic landmark
- recorded by Historic American Buildings Survey #
- recorded by Historic American Engineering Record #

Primary location of additional data:

- State Historic Preservation Office
- Other State Agency
- Federal Agency
- Local government
- University
- Other

Name of repository:

10. Geographical Data

Acree of Property Less than one acre

UTM References (Place additional UTM references on a continuation sheet.)

1 16 2/8/8/7/3/6 5/0/7/6/3/5/0
Zone Easting Northing

2 _____
Zone Easting Northing

3 _____
Zone Easting Northing

4 _____
Zone Easting Northing

See Continuation Sheet

Verbal Boundary Description (Describe the boundaries of the property on a continuation sheet)

Boundary Justification (Explain why the boundaries were selected on a continuation sheet)

11. Form Prepared By

name/title	Christina Slattery, Shannon Dolan, and Mollie Douglas		
organization	Mead & Hunt, Inc.	date	December 2008
street & number	6501 Watts Road	telephone	(608) 273-6380
city or town	Madison	state	WI
		zip code	53719-2700

Yawkey, William H., Boathouse

Oneida

Wisconsin

Name of Property

County and State

Additional Documentation

Submit the following items with the completed form:

Continuation Sheets

Maps

A U.S. Geological Survey map (7.5- or 15-minute series) indicating the property's location.
A sketch map for historic districts and properties having large acreage or numerous resources.

Photographs

Representative black and white photographs of the property.

Additional Items (Check with the SHPO or FPO for any additional items)

Property Owner

Complete this item at the request of SHPO or FPO.)

name/title	Wilmington Trust Company	date	December 2008
organization	Wilmington Trust Company	telephone	715-845-9201
street&number	PO Box 65	zip code	54402
city or town	Wausau	state	WI

Paperwork Reduction Act Statement: This information is being collected for applications to the National Register of Historic Places to nominate properties for listing or determine eligibility for listing, to list properties, and to amend existing listings. Response to this request is required to obtain a benefit in accordance with the National Historic Preservation Act, as amended (16 U.S.C. 470 et seq.).

Estimated Burden Statement: Public reporting burden for this form is estimated to average 18.1 hours per response including time for reviewing instructions, gathering and maintaining data, and completing and reviewing the form. Direct comments regarding this burden estimate or any aspect of this form to the Chief, Administrative Services Division, National Park Service, P.O. Box 37127, Washington, DC 20013-7127; and the Office of Management and Budget, Paperwork Reductions Projects, (1024-0018), Washington, DC 20503.

**United States Department of the Interior
National Park Service**

**National Register of Historic Places
Continuation Sheet**

Section 8 Page 1

Yawkey, William H., Boathouse
Town of Hazelhurst, Oneida County, Wisconsin

Statement of Significance

The William H. Yawkey Boathouse is eligible for the National Register at the local level under *Criterion C: Architecture* as a distinctive example of an early twentieth-century wet boathouse in Oneida County and northern Wisconsin. The W.H. Yawkey Boathouse retains a high degree of historic integrity with its original materials, picturesque setting, skillful workmanship, and clean, Craftsman style design. The Yawkey Boathouse presents an uncommon profile on the shores of Lake Katherine and stands out when compared to other boathouses in the area, which are typically smaller, one-story vernacular examples. The period of significance for the William H. Yawkey Boathouse is 1917, corresponding to the building's construction date.

Historic Overview

The William H. Yawkey Boathouse is located on the northwest bank of Lake Katherine in Wisconsin's Northwoods in the town of Hazelhurst, five miles south of the town of Minocqua in northern Oneida County. The town of Hazelhurst was named by Mrs. C.C. Yawkey for the hazel bushes that grew throughout the area.¹

The logging industry played the largest role in the early development of the Hazelhurst area. The greatest concentration of pre-1880 logging activity in Wisconsin was in the central regions of the state; however, the construction of the Chicago, Milwaukee & St. Paul Railway from Merrill northward to Lake Superior beginning in the fall of 1880 greatly improved access to the northern regions. By 1887 the line had reached Minocqua, and C.C. Yawkey and George Lee chose a site on the northwest shore of Lake Katherine as headquarters for the newly formed Yawkey & Lee Lumber Company.² William C. Yawkey served as president, with C.C. Yawkey and friend George Lee as partners, and William H. Yawkey served as secretary. A sawmill, planing mill, and factory were constructed by 1888, and the new town of Hazelhurst, owned in entirety by Yawkey & Lee Company, began to grow with the lumber company. Within a few short years the village included Yawkey & Lee Company workers' dwellings, a boarding house, a general store, a post office, a barber shop, a blacksmith shop, a church, and a school. In 1891 the population of the village was a mere 300 people; however, by 1900 Hazelhurst had over 1052 full-time residents.³

¹ Lelah Bruso, ed., *Oneida County, Centennial History Edition 1887-1987* (n.p., 1987), 88.

² Tom Collier and Hannah and Dan Hansell, *Hazelhurst; Oneida County Centennial History Edition 1887-1987* (n.p., 1987), 87.

³ Hazelhurst Centennial Committee, *Hazelhurst, the First 100 Years* (n.p., 1987), 16.

United States Department of the Interior
National Park Service

National Register of Historic Places
Continuation Sheet

Section 8 Page 2

Yawkey, William H., Boathouse
Town of Hazelhurst, Oneida County, Wisconsin

The Yawkeys and George Lee originally intended to construct a canal between Lake Katherine and Lake Tomahawk to provide an access channel through which to float logs. A difference in elevation between the two lakes made a canal impossible. Instead, a railroad spur was constructed to connect Hazelhurst with the Chicago, Milwaukee and St. Paul Railroad and the Chicago and NorthWestern Railroad.⁴ The access to the deep woods by rail allowed the Yawkey & Lee Lumber Company to continue logging year round, as they were not dependent on the snow and ice to haul their logs on sleighs. This advantage made the company extremely competitive, and at the turn of the twentieth century the Yawkey & Lee Lumber Company was considered to be one of the largest exporters of lumber and lumber products in the United States.⁵ With the seemingly inexhaustible supply of virgin white pines and the unending stream of eager loggers disembarking at the depot, the Yawkey & Lee Lumber Company and Hazelhurst were paired in a promising partnership.

In Oneida County, the railroad brought more than an advantage to the lumbering industry. The improved accessibility to the area soon highlighted the region as a sportsman's paradise. Parties from all over the Midwest came to the Northwoods of Wisconsin in search of muskellunge and other trophy fish. The few locals that inhabited the area year-round often served as private guides, opening their homes and offering their property as camp sites for the fishing groups. In the last decade of the nineteenth century, sport fishing came to rival logging as the premier catalyst for development in the area.⁶

News of the beautiful lakes in the area spread quickly, and soon men were bringing their families along to experience a northern Wisconsin summer. The ever-increasing area traffic led to the development of large summer resorts, and families began to stay for months at a time. In 1882, prior to the establishment of the family lumbering enterprise, C.C. Yawkey had been the first person to purchase land adjacent to Lake Katherine. By 1889 he had built a summer home on the island located within Lake Katherine, and one year later he constructed a large, year-round house on the mainland. As their lumber business grew and evolved, the Yawkey family began to divide its time between Hazelhurst and Wausau. The Yawkeys became one of the first families to begin the summer-vacation-home trend in Hazelhurst.⁷

⁴ Collier, 88.

⁵ Collier, 87.

⁶ Daniel D. Scrobell, *Early Times: The Early History of the Minocqua Area as Seen Through the Pages of the Minocqua Times Newspaper* (Minocqua, Wis.: Heritage House Publishers, 1988), 5.

⁷ Scrobell, 40.

United States Department of the Interior
National Park Service

National Register of Historic Places
Continuation Sheet

Section 8 Page 3

Yawkey, William H., Boathouse
Town of Hazelhurst, Oneida County, Wisconsin

Citizens within the community found that the tourism industry could be a lucrative alternative to lumber. By the 1910s the lumber supply had diminished and was no longer the primary industry for Hazelhurst, and by 1912 the Yawkey & Lee Lumber Company had ceased operations. Capitalizing on Oneida County's growing reputation as a resort area seemed to be a viable solution, and in 1913 Axel Anderson and John G. Schwartz were the first entrepreneurs to recognize the financial gains that could be made from selling recreational property along the shores of Lake Katherine in Hazelhurst.⁸ The railroads also had a vested interest in this economic plan, as passenger trains carrying tourists north could easily replace the cars that had hauled logs and the tracks could remain in use. The railroad companies began to promote the Northwoods in earnest.

The partnership between Anderson and Schwartz was brief, ending in 1914. Schwartz continued to sell real estate and eventually formed a new partnership with Eugene E. Terrell, establishing the Lake Katherine Improvement Company. Throughout the 1910s and 1920s, Schwartz proceeded to build a majority of the resorts and summer homes on Lake Katherine and in Hazelhurst.⁹ The Sylvan Shores Resort, Birchwood Resort, and the Garth Lake Resort, later known as the Log Cabin Resort, were a few of the resorts that attracted tourists to Hazelhurst during the early twentieth century. People from across the United States traveled to the Northwoods and built summer homes along the banks of Lake Katherine and other lakes in the region. Private, single family houses were soon being constructed en masse, first as seasonal residences and eventually as year-round homes.¹⁰

The introduction of the automobile and the improvement and construction of roadways led to a decline in passenger rail travel. Eventually passenger trains were unable to compete with the automobile, which quickly became the preferred method of transportation. Regardless of the manner in which vacationers arrived, the popularity and development of the Northwoods as a summer home and resort area has continued from the late nineteenth century to the present day.

⁸ Scrobell, 250.

⁹ Scrobell, 250.

¹⁰ Hazelhurst Centennial Committee, 46.

United States Department of the Interior
National Park Service

National Register of Historic Places
Continuation Sheet

Section 8 Page 4

Yawkey, William H., Boathouse
Town of Hazelhurst, Oneida County, Wisconsin

*History of the Property*¹¹

The William H. Yawkey Boathouse is located on Lake Katherine adjacent to parts of Government Lots 5 and 6, in the southeast to northwest quarters of Section 3, Township 38 North, Range 6 East, in Oneida County, Wisconsin. The boathouse was originally owned by William H. Yawkey, uncle to C.C. Yawkey and secretary of the Yawkey Lumber Company. Family records indicate that the large, two-story, wet boathouse was added to the property in 1917.¹² Newspaper research and tax rolls did not reveal further information concerning the dates of construction or the identity of the architect or builder. However, an article in the local paper mentions the delivery of a new Buick to the Yawkey summer home in Hazelhurst in 1918, demonstrating that the family was definitely spending significant time on Lake Katherine.¹³ The property, including the boathouse, has remained under the ownership of descendants of William H. Yawkey.

William Hoover Yawkey was born on August 22, 1875, in Michigan and died unexpectedly of influenza on March 5, 1918, while on an automobile trip through Georgia.¹⁴ He was involved in the lumber business for the majority of his life, amassing a great fortune from his holdings in Michigan and Wisconsin. In addition to his partnership in the Yawkey Lumber Company and family lumbering assets, he also invested heavily and profited within the oil and steel trades. A great lover of baseball, Yawkey purchased the Detroit Tigers franchise in 1904 and was the sole owner until 1907, when he joined with Frank Navin to form the partnership of Yawkey, Navin & Co.¹⁵ The diverse economic pursuits of W.H. Yawkey and his success in those efforts allowed him and his family the freedom to spend many summers relaxing in the wilderness of Northern Wisconsin.¹⁶

¹¹ The history of the property was compiled using Town of Hazelhurst, Oneida County Tax Rolls 1905-1930, and local newspaper research.

¹² Company papers state that the boathouse was constructed in 1917.

¹³ "Buick News," *The Minocqua Times*, February 1918, 10.

¹⁴ William Richard Cutter, *American Biography: A New Cyclopedia* (New York: American Historical Society, 1918), 105, and "Adopted Boy of 18 Heir to \$3,408,650" *The New York Times*, February 3, 1920, national edition.

¹⁵ Hugh C. Weir, "The Richest Man in Baseball," *Baseball Magazine*, August 1914, 49-54.

¹⁶ Weir, 52.

**United States Department of the Interior
National Park Service**

**National Register of Historic Places
Continuation Sheet**

Section 8 Page 5

Yawkey, William H., Boathouse
Town of Hazelhurst, Oneida County, Wisconsin

*Boathouse Design and Architecture*¹⁷

Boathouses are a resource uniquely tied to the resorts and summer homes of Oneida County. Just as garages were built to house automobiles, boathouses were constructed to protect boats from the elements. Most late nineteenth- and early twentieth-century wet boathouses, cottages, and resorts located in northern Wisconsin were not architect designed. These buildings were often completed by local builders and carpenters, and were sometimes based on pattern books and building design guides. The builders often remain unknown.

Wet boathouses in northern Wisconsin are typically one-or two-story frame buildings with hip or front gable roofs. The buildings are located over the water and typically rest on a foundation of wood pilings. Boathouses generally have square or rectangular floor plans with docks that wrap around several sides of the building. The lake side of the boathouse is the main facade and public face of the boathouse. This facade typically includes one to three bays on the lower elevation that house the boats. The interior of the first level is often fairly rustic with exposed wall framing. The second level typically includes bands of windows providing views of the lake. The second level is often a living space that may include bedrooms, bathroom, and kitchen, or it can be an open space used for recreational activities. As a result, this space may have finished walls or may be left unfinished, displaying exposed roof rafters and wall framing.

Even though these buildings are largely vernacular, elements of the Craftsman, Rustic, and Queen Anne styles were incorporated into boathouse design in northern Wisconsin. Typically the overall form, massing, and wall materials contribute to the display of the architectural style. The application of architectural details is frequently limited to smaller details, such as exposed rafters, window style, and flower boxes.

The Rustic Style, as applied to a boathouse, utilizes log or partial log construction to imitate the rustic character of log buildings constructed during the early settlement of the area. The Queen Anne Style, as applied to boathouse construction, is demonstrated primarily through a prominent turret/lookout tower, wall texture variation, and several decorative details. Characteristics of the Craftsman Style that have been adapted to boathouse construction include broad gable or hip roofs, decorative brackets or exposed rafters, multi-pane windows, and dormers on the roof. The W.H. Yawkey Boathouse features the following traits of the Craftsman

¹⁷ This discussion of boathouse design and architecture has been compiled using Mead & Hunt's *Land of Silver Lakes and Streams, Survey of Resorts and Boathouses in Oneida County, Wisconsin* Report (prepared for the Wisconsin Historical Society, 1998), field observations of boathouses in Oneida and Vilas counties by the author, and John De Visser, *At the Water's Edge: Muskoka's Boathouses* (Toronto: Stoddart Publishing Co. Limited, 1993).

United States Department of the Interior
National Park Service

National Register of Historic Places
Continuation Sheet

Section 8 Page 6

Yawkey, William H., Boathouse
Town of Hazelhurst, Oneida County, Wisconsin

style: low-pitched hip roof, overhanging eaves, exposed rafters, decorative braces on the rear elevation, and bands of windows.

The construction of larger, two-story, architecturally distinctive boathouses appears to have been most popular in north-central Wisconsin in the first half of the twentieth century, based on the recreational settlement of the area, known ages of a number of boathouses, building form, and use of materials. Two-story boathouses with upstairs living spaces have been found to possess a higher level of architectural interest. Examples of these buildings that retain good integrity have been listed in the National Register. Due to their larger scale, the application of architectural details, although limited, is more common on these boathouses and contributes to their architectural significance.

The William H. Yawkey Boathouse compares favorably to other wet boathouses identified along Lake Katherine and throughout Oneida and Vilas counties. This two-story boathouse with three bays retains its overall form, fenestration pattern, and wall material, and displays elements of the Craftsman Style in the low-pitched hip roof, exposed rafters, decorative braces, and bands of windows. The Yawkey Boathouse also displays similar architectural distinction as other boathouses in Oneida and Vilas counties that have been listed in the National Register, including the Hans M. Hage Boathouse on Lake Katherine, the Phillip Orth Boathouse on Lake Minocqua, and the Reay Boathouse on the Three Lakes chain of lakes. The Yawkey Boathouse and these listed boathouses share the following characteristics: they are large-scale, two-story buildings with two or three bays; they contain upper-story living areas; and they retain the original building materials as well as their use and function. In addition, their architectural details, though modest, are indicative of the Craftsman architectural style.

When compared with other boathouses on Lake Katherine, the William H. Yawkey Boathouse is significantly larger in scale, with a second, livable story and three bays as opposed to the more common one-story and one- or two-bay configuration. The low-pitched hip roof, overhanging eaves, and bands of windows are also components of a more stylized design. The majority of other area boathouses are one-story vernacular buildings with gable roofs and few windows, if any.

**United States Department of the Interior
National Park Service**

**National Register of Historic Places
Continuation Sheet**

Section 8 Page 7

Yawkey, William H., Boathouse
Town of Hazelhurst, Oneida County, Wisconsin

Conclusion

The William H. Yawkey Boathouse is eligible for the National Register under *Criterion C: Architecture* as a distinctive example of an early twentieth-century wet boathouse. The building demonstrates characteristics of the Craftsman style as applied to the boathouse property type. The boathouse retains its original location, design, setting, materials, and workmanship, allowing it to retain integrity and convey its 1917 construction. The boathouse's large-scale, upper-story living area and Craftsman details demonstrate the building's architectural significance compared to other boathouses in the area, which tend to be smaller and more vernacular in design.

Preservation Potential

Boathouses have been a fixture on northern Wisconsin's lakes since the beginning of the area's summer tourist industry. These structures, located on the water, are more visible to the boater than the lake cottages or resorts on the shores. The boathouses have often served as landmarks for the generations that have enjoyed recreating on the lakes. Since 1979, the Wisconsin Department of Natural Resources has banned the construction of new wet boathouses and placed a limitation on repairs of existing boathouses to 50 percent of the assessed value of the building under State Statute 30.121 *Regulation of boathouses and houseboats*. As a result, the amount of maintenance that can be completed on a wet boathouse over its lifetime is limited. However, under Section (2) (3g), the repair limit does not apply to boathouses with "historic or cultural value, as determined by the state historical society or a local or county historical society established under Section 44.03." Nomination of these buildings to the National Register not only recognizes their historic and cultural value, it also offers a degree of protection by allowing for their continued maintenance.

**United States Department of the Interior
National Park Service**

**National Register of Historic Places
Continuation Sheet**

Section 9 Page 1

Yawkey, William H., Boathouse
Town of Hazelhurst, Oneida County, Wisconsin

Bibliography

“Adopted Boy of 18 Heir to \$3,408,650.” *The New York Times*, February 3, 1920, national edition.

Bruso, Lelah, ed. *Oneida County, Centennial History Edition 1887-1987*. N.p., 1987.

Collier, Tom, and Hannah and Dan Hansell. *Hazelhurst; Oneida County Centennial History Edition 1887-1987*. N.p., 1987.

Cutter, William Richard. *American Biography: A New Cyclopedia*. New York: American Historical Society, 1918.

De Visser, John. *At the Water's Edge: Muskoka's Boathouses*. Toronto: Stoddart Publishing Co. Limited, 1993.

Hazelhurst Centennial Committee. *Hazelhurst, the First 100 Years*. N.p., 1987.

How to Build 20 Cabins. New York: Arco Publishing Co., 1955.

Laabs, Joyce. *A Collection of Northwoods Nostalgia*. Sun Prairie, Wis.: Royle Publishing Company, 1978.

Mead & Hunt, Inc. Interviews with the property owners, 2008.

Mead & Hunt. *Land of Silver Lakes and Streams: Survey of Resorts and Boathouses in Oneida County, Wisconsin*. Prepared for the Wisconsin Historical Society, 1998.

Oneida County Tax Rolls, 1905-1930. Available at Wisconsin Historical Society Archives, Madison, Wisconsin.

Ross, Robert Budd, and George Byron Catlin and Clarence Monroe Burton. *Landmarks of Detroit*. Detroit, Mich.: Evening News Association, 1898.

United States Department of the Interior
National Park Service

National Register of Historic Places
Continuation Sheet

Section 9 Page 2

Yawkey, William H., Boathouse
Town of Hazelhurst, Oneida County, Wisconsin

Scrobell, Daniel D. *Early Times: The Early History of the Minocqua Area as Seen Through the Pages of the Minocqua Times Newspaper*. Minocqua, Wis.: Heritage House Publishing, 1988.

Weir, Hugh C. "The Richest Man in Baseball," *Baseball Magazine*, August 1914, 49-54.

Wyatt, Barbara, ed. *Cultural Resource Management in Wisconsin*. Madison, Wis.: The State Historical Society of Wisconsin, 1986.

United States Department of the Interior
National Park Service

National Register of Historic Places
Continuation Sheet

Section 10 Page 1

Yawkey, William H., Boathouse
Town of Hazelhurst, Oneida County, Wisconsin

Verbal boundary description

The boundary of the William H. Yawkey Boathouse is shown as a dashed line on the accompanying map entitled "W.H. Yawkey Boathouse." The boundary extends 20 feet beyond the edge of the boathouse on the northeast, southeast, southwest, and northwest sides.

Boundary justification

The boundary of the W.H. Yawkey Boathouse was delineated to encompass the historic property of the wet boathouse and provides an appropriate setting.

**United States Department of the Interior
National Park Service**

**National Register of Historic Places
Continuation Sheet**

Section Photos Page 1

Yawkey, William H., Boathouse
Town of Hazelhurst, Oneida County, Wisconsin

William H. Yawkey Boathouse

7090 Woodson Street

Town of Hazelhurst

Oneida County, Wisconsin, 54531

Photographer: Christina Slattery, Mead & Hunt, Inc., September 2008

Ink and Paper: Fuji Crystal Archive paper and printing

Photograph 1 of 9

Boathouse (setting) – front and side (northeast and southeast) elevations

View facing southwest

Photograph 2 of 9

Boathouse – front and side (northeast and southeast) elevations

View facing west

Photograph 3 of 9

Boathouse – side (northwest) elevation

View facing southeast

Photograph 4 of 9

Boathouse – rear (southwest) elevation with docks and staircase

View facing east

Photograph 5 of 9

Boathouse – rear (southwest) elevation; close-up of staircase and entryways

View facing northeast

Photograph 6 of 9

Boathouse – first level interior with three boat slips and raised overhead doors

View facing east

**United States Department of the Interior
National Park Service**

**National Register of Historic Places
Continuation Sheet**

Section Photos Page 2

Yawkey, William H., Boathouse
Town of Hazelhurst, Oneida County, Wisconsin

Photograph 7 of 9

Boathouse – first level interior

View facing southeast

Photograph 8 of 9

Boathouse – second story interior

View facing west

Photograph 9 of 9

Boathouse – second story interior and window detail

View facing east

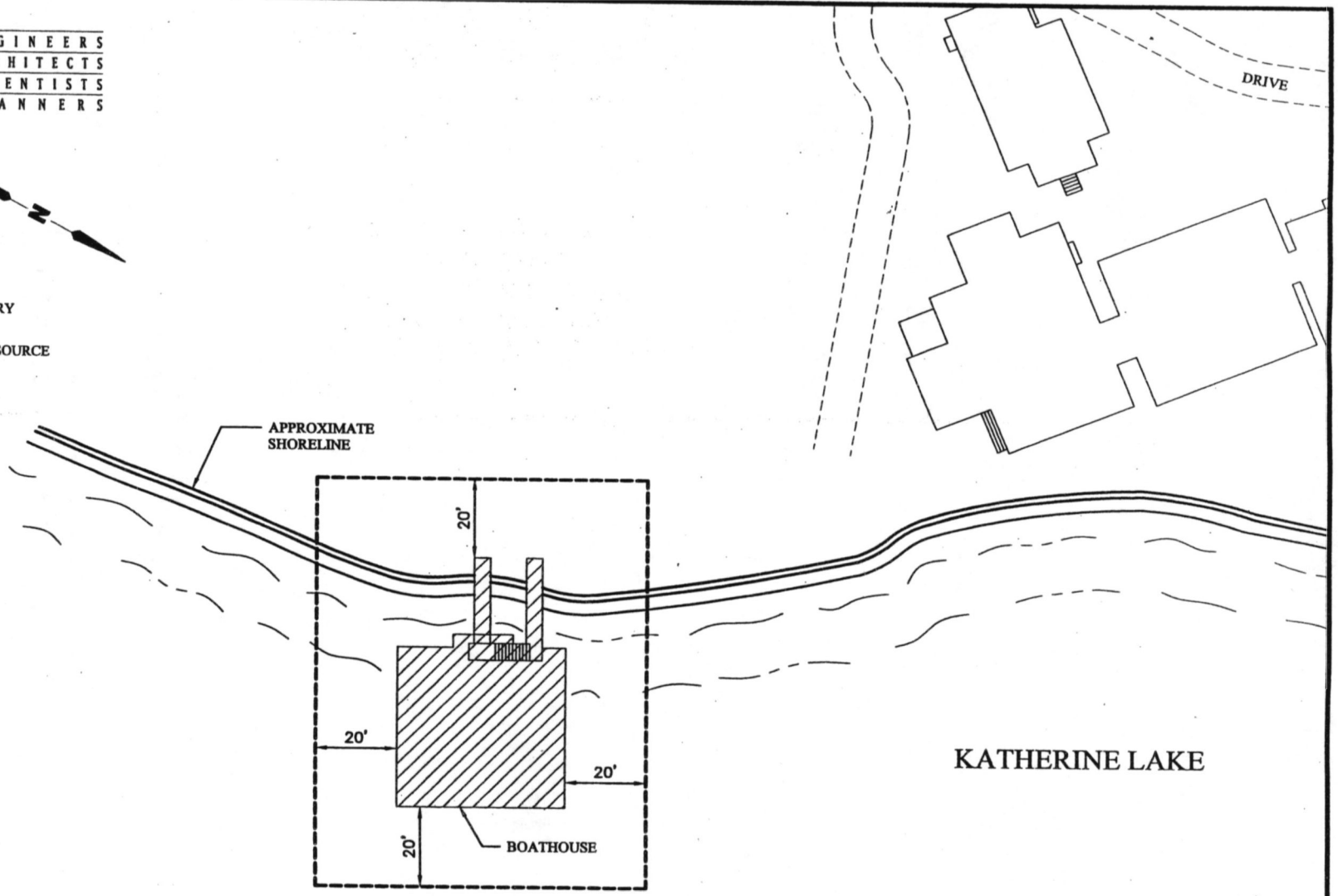
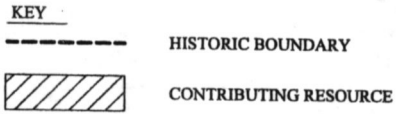
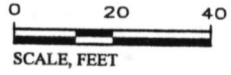

**FIGURE 1: YAWKEY, WILLIAM H.,
BOATHOUSE**
7090 WOODSON STREET
TOWN OF HAZELHURST
ONEIDA COUNTY, WISCONSIN

UNITED STATES DEPARTMENT OF THE INTERIOR
NATIONAL PARK SERVICE

NATIONAL REGISTER OF HISTORIC PLACES
EVALUATION/RETURN SHEET

REQUESTED ACTION: NOMINATION

PROPERTY Yawkey, William H., Boathouse
NAME:

MULTIPLE
NAME:

STATE & COUNTY: WISCONSIN, Oneida

DATE RECEIVED: 11/20/09 DATE OF PENDING LIST: 12/09/09
DATE OF 16TH DAY: 12/24/09 DATE OF 45TH DAY: 1/03/10
DATE OF WEEKLY LIST:

REFERENCE NUMBER: 09001198

REASONS FOR REVIEW:

APPEAL: N DATA PROBLEM: N LANDSCAPE: N LESS THAN 50 YEARS: N
OTHER: N PDIL: N PERIOD: N PROGRAM UNAPPROVED: N
REQUEST: N SAMPLE: N SLR DRAFT: N NATIONAL: N

COMMENT WAIVER: N

ACCEPT RETURN REJECT 12-30-09 DATE

ABSTRACT/SUMMARY COMMENTS:

**Entered in
The National Register
of
Historic Places**

RECOM./CRITERIA _____

REVIEWER _____ DISCIPLINE _____

TELEPHONE _____ DATE _____

DOCUMENTATION see attached comments Y/N see attached SLR Y/N

If a nomination is returned to the nominating authority, the nomination is no longer under consideration by the NPS.



Yawkey, Wm. H., Boathouse
Town of Hazeldurst, Oneida County, WI

10F9

0182242, IMG_0078_002

CAMERA CO. SQUARE. 10/07/09



Yawkey, Wm. H., Boathouse
Town of Hazelhurst, Oneida County, WI

20f9

0182242, IMG_0079_003

CAMERA CO. SQUARE. 10/07/09



Yawkey, Wm. H., Boathouse
Town of Hazelhurst, Oneida County, WI

3 of 9

0182242. IMG_0052_001

CAMERA CO. SQUARE. 10/07/09



Yawkey, Wm. H., Boathouse
Town of Hazelhurst, Oneida County, WI

4 of 9

6182221, Wisconsin, Oneida, Yawkey

Fujifilm, F0000, 10/27/09



Yawkey, Wm. H., Boathouse
Town of Hazelhurst, Oneida County, WI

5 of 9

0182242: IMG_0145_004

CAMERA CO. SQUARE. 10/07/09



Yawkey, Wm. H., Boathouse

6 of 9

Town of Hazelturst, Oneida County, WI

0182242, IMG_0180_006

CAMERA CO. SQUARE, 10/07/09



Yawkey, Wm. H., Boathouse
Town of Hazelhurst, Oneida County, WI

7 of 9

0182242, IMG_0176_005

CAMERA CO. SQUARE, 10/07/09



Yawkey, Wm. H., Boathouse
Town of Hazelhurst, Oneida County, WI

8 of 9

0182242, IMG_0217_007

CAMERA CO. SQUARE, 10/07/09



Yawkey, Wm. H., Boathouse
Town of Hazelhurst, Oneida County, WI

9 of 9

0182242, IMG_0220_008

CAMERA CO, SQUARE, 10/07/09



William H. Yawkey Boathouse
Tn. of Hazelhurst, Oneida Co., WI.
UTM REFERENCES
Z E 10 2/8/87/3/6 E N 5/07/6/3/5/0 N

(BARRONS LAKE)
3075 N 15 E

Mapped, edited, and published by the Geological Survey in cooperation with the Wisconsin Division of Highways and Wisconsin Geological and Natural History Survey. Control by USGS and NGS/NOAA. Topography by photogrammetric methods from aerial photographs taken 1964. Revised from aerial photographs taken 1978. Field checked 1979. Map edited 1982. Hydrography compiled from information furnished by Wisconsin Department of Natural Resources. Projection and 10,000-foot grid ticks: Wisconsin coordinate system, north zone (Lambert conformal conic). 1000-meter Universal Transverse Mercator grid, zone 16 1927 North American Datum. To place on the predicted North American Datum 1983 move the projection lines 6 meters north and 10 meters east as shown by dashed corner ticks. There may be private inholdings within the boundaries of the National or State reservations shown on this map. Fine red dashed lines indicate selected fence and field lines where generally visible on aerial photographs. This information is unchecked.

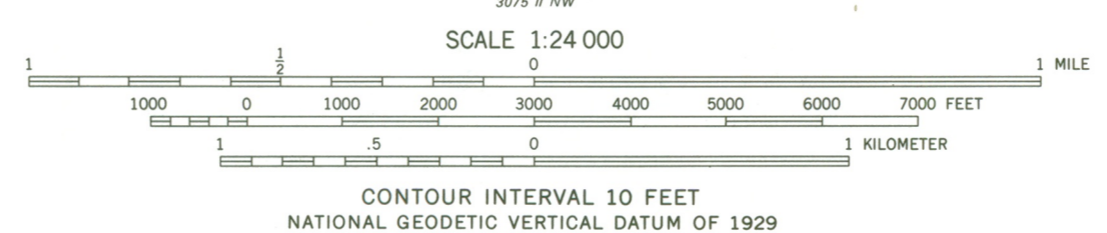

SCALE 1:24 000
CONTOUR INTERVAL 10 FEET
NATIONAL GEODETIC VERTICAL DATUM OF 1929

THIS MAP COMPLIES WITH NATIONAL MAP ACCURACY STANDARDS FOR SALE BY U.S. GEOLOGICAL SURVEY, DENVER, COLORADO 80225, OR RESTON, VIRGINIA 22092 AND WISCONSIN GEOLOGICAL AND NATURAL HISTORY SURVEY, MADISON, WISCONSIN 53706. A FOLDER DESCRIBING TOPOGRAPHIC MAPS AND SYMBOLS IS AVAILABLE ON REQUEST.



ROAD CLASSIFICATION

Primary highway, hard surface	Light-duty road, hard or improved surface
Secondary highway, hard surface	Unimproved road
Interstate Route	U. S. Route
	State Route

HAZELHURST, WIS.
SW4 MINOQUA 15' QUADRANGLE
N4545-W8937.5/7.5
1982
DMA 3075 1 SW-SERIES V861



WISCONSIN
HISTORICAL
SOCIETY

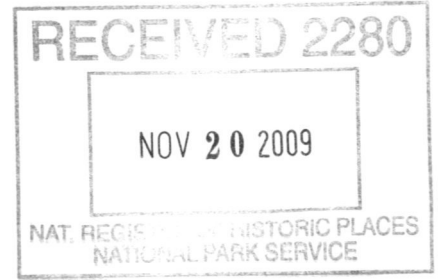

**TO: Keeper
National Register of Historic Places**

FROM: Daina Penkiunas

SUBJECT: National Register Nomination

The following materials are submitted on this 16th day of November 2009,
for nomination of the William H. Yawkey Boathouse to the National Register of
Historic Places:

1 Original National Register of Historic Places nomination form

 Multiple Property Nomination form

9 Photograph(s)

1 CD with electronic images

1 Original USGS map(s)

1 Sketch map(s)/figure(s)/exhibit(s)

 Piece(s) of correspondence

 Other _____

COMMENTS:

 Please insure that this nomination is reviewed

 This property has been certified under 36 CFR 67
 The enclosed owner objection(s) do _____ do not _____
constitute a majority of property owners.

 Other: _____
