

**TENNESSEE MULTIPLE PROPERTY FORM**

RECEIVED

MAR 03 1988

NATIONAL  
REGISTER

Title: Historic Resources of Williamson County

Historic Name: Franklin Historic District Extension

Common Name: Franklin Historic District Extension

Classification: District

Owner: Multiple Ownership

Location: Along Third Avenue South in Franklin, Tennessee.

Contributing:

Buildings	12
Structures	1
Sites	0

Non-Contributing:

Buildings	4
Structures	0
Sites	0

*Third Ave South  
S. Main St and the 20*

Total: 13

Total: 4

Description:

The Franklin Historic District extension is a one block area of Third Avenue, South in Franklin, Tennessee. The district contains 12 residences, all of which are contributing to the district. Within this one block are also one contributing structure, four non-contributing buildings and a vacant lot. This block displays large shade trees, concrete sidewalks and fairly uniform setbacks and placement of the residences.

The majority of structures on this block were constructed prior to 1900 and reflect 19th century architectural styles. The oldest house on the block is the Miller-Beaseley House constructed in 1866. The Simms-Brown House is also a notable Italianate design built ca. 1880. The other residences on the street are primarily one and two-story frame residences constructed between 1880 and 1900. These homes were built in vernacular side passage, T-plan, central passage and pyramidal roof forms of the period. They share similar detailing such as eave vergeboard, milled porch posts and arched windows.

Since 1900, few alterations have occurred in this block. While some additions have taken place to several of the residences most retain their original design and character. They represent a small but notable grouping of late 19th and early 20th century architecture which was omitted from the original Franklin Historic District boundary (NR-1972). (Frame buildings have weatherboard siding.)

Individual Property Descriptions:

1. 350 3rd Ave South: One-story frame residence built ca.1900; has a side passage entrance and porch, four-over-four sash windows; weatherboard siding. (C)

2. 348 3rd Ave South: One-story, frame, T-plan residence built ca.1890; on main and east facades is a porch with original milled posts; one-over-one sash windows and eave returns. (C)

3. 334 3rd Ave South: One-story frame, pyramidal roof residence built ca.1905; entrance has large sidelights and transom; one-over-one sash windows and eave vergeboard; at the roofline is a hipped dormer with diamond light windows. (C) At the rear are three non-contributing outbuildings.
4. 324 3rd Ave South: One-story frame, ca.1880 residence extensively altered with addition but still retains enough integrity to be contributive to the district; original details include porch with milled posts and square baluster railing; six-over-six sash windows. (C) At the rear is a contributing ca. 1880 frame shed.
5. 320 3rd Ave South: One-story frame ca.1890, side-passage residence; entrance has sidelights and transom; windows are four-over-four sash; porch has original simple square posts.(C).
6. 318 3rd Ave South: One-story, frame, side-passage residence built ca.1890; entrance has sidelights and transom; windows are one-over-one sash; porch has original square posts. (C).
7. 312 3rd Ave South: One-story frame, T-plan residence built ca.1890; entrance has original transom; windows are both one-over-one and four-over-four sash; eave vergeboard; porch has original square posts; added tile siding. (C).
8. 302 3rd Ave South: Simms-Brown House built ca. 1880; one and a half story brick, Italianate residence; entrance has original glass and frame door and single light transom; porch has original posts and milled balusters; one-story bay window on the main facade; windows are arched one-over-one sash; eave brackets and gable dormers at the roofline.(C).
9. 305 3rd Ave South: Miller-Beaseley House built 1866; one-story brick Greek Revival influenced residence; on main facade is original porch with Doric motif columns and eave dentils; entrance has sidelights and transom; windows are eight-over-eight sash with frame lintels and sills. (C).
10. 315 3rd Ave South: Two-story Italianate, T-plan residence built ca.1880; porch has original milled posts and vergeboard; entrance has original glass and frame door and single light transom; windows are six-over-one sash; eave vergeboard and brackets. (C) At the rear is a non-contributing garage.
11. 321 3rd Ave South: One-story frame, T-plan residence built ca.1890; porch has original milled posts and vergeboard trim; windows are one-over-one sash; entrance has original glass and frame door and single light transom. (C).
12. 339 3rd Ave South: Two-story frame residence built ca.1890; porch has added square posts and railing; windows are nine-over-nine sash on the first story and nine light casement on the second story; pedimented window hoods. (C).

Period of Significance: ca. 1866 - ca. 1905.

Area of Significance: Architecture

Criterion: C

Architect/Builder: Unknown

Statement of Significance:

The Franklin Historic District Extension is a one block area of Third Avenue, South which was inadvertently left out of the original Franklin Historic District boundary. The block contains twelve residences, all of which are contributing to the district. Within this block are two brick residences and eleven frame residences constructed prior to ca. 1905. These residences reflect the historical and architectural characteristics which were cited in the original nomination's statement of significance.

The Franklin Historic District nomination was prepared in 1972 and careful delineation of the edges of the boundary did not occur. The boundary which was drawn followed the sixteen block area of the original town limits of Franklin. This boundary was drawn to include everything within the limits of South and North Margin Streets, First Avenue South and Fifth Avenue South. In retrospect this boundary excluded a grouping of residences on Third Avenue, South on the southeast edge of the district.

The extension includes twelve contributing frame and brick residences constructed between ca. 1866 and ca. 1905. The block is a logical continuation of the district down Third Avenue, South and the block terminates the streetscape of historic architecture. There are no non-contributing residences on the block and it retains its original character.

Acreage: 5.2 acres

UTM References: Franklin Quad/ A. 16/511970/3975100 B. 16/512090/3975160  
C. 16/512150/3975040 D. 16/512060/3974920

Verbal Boundary Description and Justification: The boundary for the Franklin Historic District extension is illustrated on the accompanying sketch map. The boundary includes the following block and parcel numbers; 78-F-F-1 through 78-F-F-8 and 78F-G-1 through 78F-G-4.01. The boundary is defined on the northwest by the present southern boundary of the Franklin Historic District, on the northeast by modern industrial buildings, on the southeast by the L&N Railroad tracks and on the southwest by the rear lot lines of the properties.

Supplemental Bibliographical References: Historic Williamson County, Bowman.

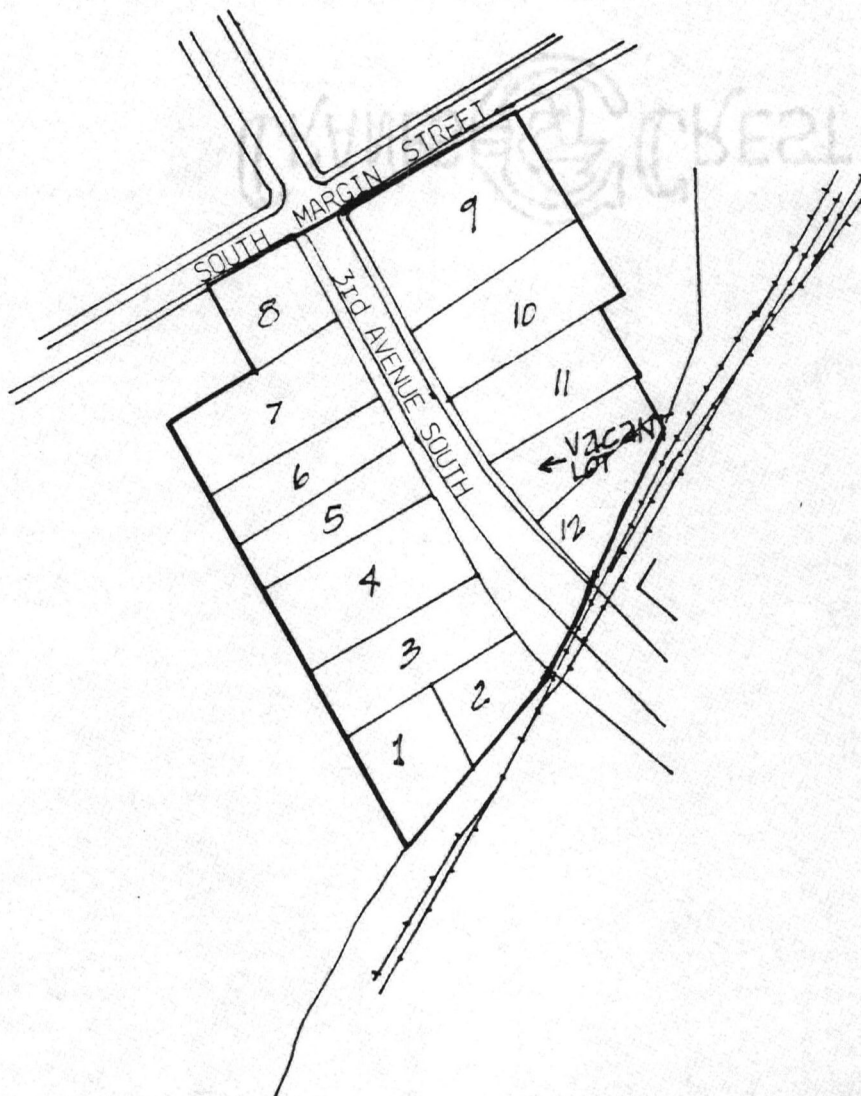

All principal buildings are contributing  
 Franklin Historic District Extension  
 Franklin, Tennessee  
 Scale: 1"=200'

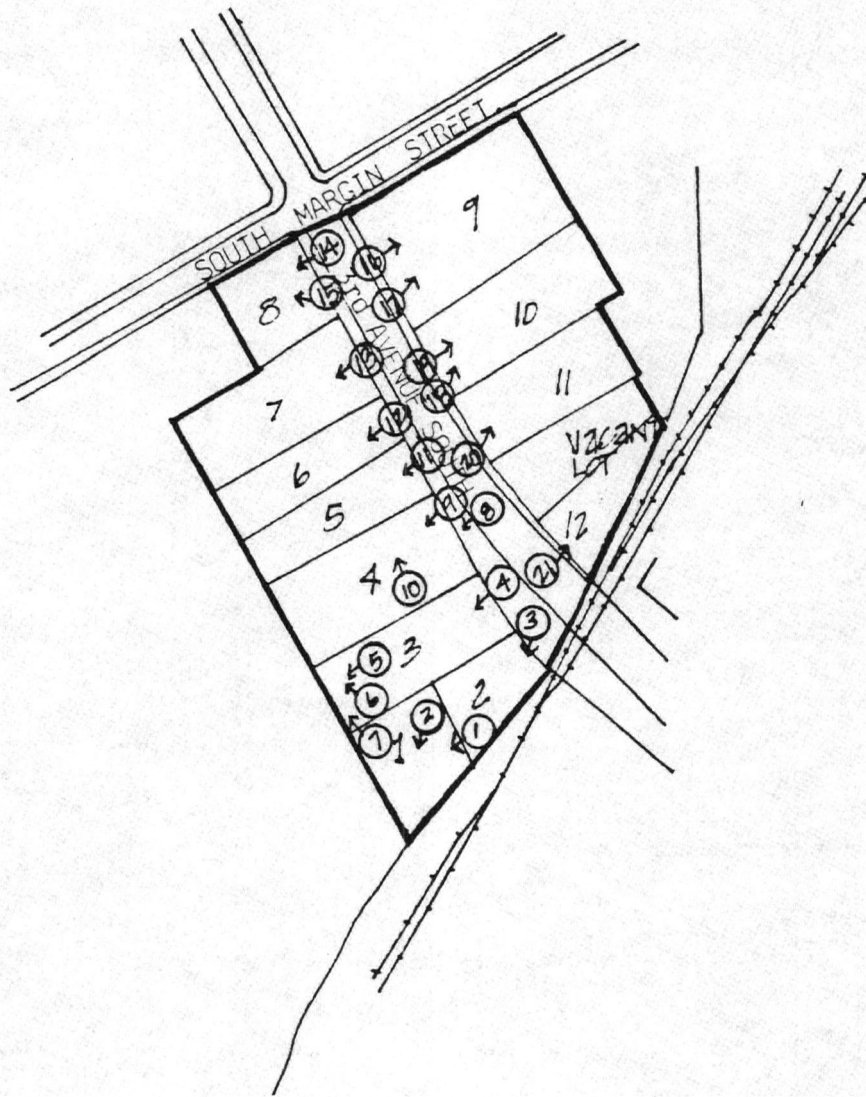

Franklin Historic District Extension  
 Franklin, Tennessee  
 Scale: 1"=200'

Photo Key

MAR 3 1988

United States Department of the Interior  
National Park Service

National Register of Historic Places  
Continuation Sheet

Section number \_\_\_\_\_ Page \_\_\_\_\_

Multiple Resource Area  
Thematic Group

Name Williamson County MRA  
State TENNESSEE

Nomination/Type of Review

Date/Signature

- |  |   |        |                             |
|--|---|--------|-----------------------------|
| Cover  | <del>Substantive Review</del>   | Keeper | <u>Amy Schlager 4/12/88</u> |
| 1. Davis, James B. House                     | <del>Substantive Review</del><br><b>DOE/OWNER OBJECTION</b>               | Keeper | <u>Amy Schlager 4/13/88</u> |
|  |   | Attest | _____                       |
| 2. Moore, Thomas, House                      | <del>Substantive Review</del><br><b>DOE/OWNER OBJECTION</b>               | Keeper | <u>Amy Schlager 4/13/88</u> |
|  |   | Attest | _____                       |
| 3. Sayers, James J., House                   | <del>Substantive Review</del><br><b>DOE/OWNER OBJECTION</b>               | Keeper | <u>Amy Schlager 4/13/88</u> |
|  |   | Attest | _____                       |
| 4. Franklin Historic District                | <del>Substantive Review</del> <i>B. Town</i><br><b>Substantive Review</b> | Keeper | <u>Amy Schlager 4/13/88</u> |
|  |   | Attest | _____                       |
| <i>WLD SET</i> 5. Allison, William, House    | <del>Substantive Review</del>   | Keeper | <u>Amy Schlager 4/13/88</u> |
|  |   | Attest | _____                       |
| <i>SAR</i> 6. Crockett, Samuel, House        | <del>Substantive Review</del>   | Keeper | <u>Amy Schlager 4/14/88</u> |
|  |   | Attest | _____                       |
| <i>WLD SET</i> 7. Davis, Stokely, House      | <del>Substantive Review</del>   | Keeper | <u>Amy Schlager 4/13/88</u> |
|  |   | Attest | _____                       |
| <i>WLD SET</i> 8. Douglass--Reams House      | <del>Substantive Review</del>   | Keeper | <u>Amy Schlager 4/13/88</u> |
|  |   | Attest | _____                       |
| <i>SAR</i> 9. Hadley, Denny P., House        | <del>Substantive Review</del>   | Keeper | <u>Amy Schlager 4/14/88</u> |
|  |   | Attest | _____                       |
| <i>WLD SET</i> 10. Hardeman, Franklin, House | <del>Substantive Review</del>   | Keeper | <u>Amy Schlager 4/13/88</u> |
|  |   | Attest | _____                       |

84000378

NATIONAL REGISTER OF HISTORIC PLACES  
EVALUATION/RETURN SHEET

Franklin Historic District (Boundary Increase)  
(Williamson County MRA)  
Williamson County  
TENNESSEE

*Substantive Review*

Working No. MAR - 3 1988  
Fed. Reg. Date: 2/7/89  
Date Due: 3/31/88 - 4/17/88  
Action:  ACCEPT 4-13-88  
 RETURN  
 REJECT

- resubmission
- nomination by person or local government
- owner objection
- appeal

Federal Agency: \_\_\_\_\_

Substantive Review:  sample  request  appeal  NR decision

Reviewer's comments:

*Properties quite similar to earlier adjacent HD - USGS map for this amendment includes added area; refer to*

Recom./Criteria Accept  
Reviewer Aschlag  
Discipline \_\_\_\_\_  
Date 4-13-88  
\_\_\_\_\_ see continuation sheet

Nomination returned for: \_\_\_\_\_ technical corrections cited below original map for HD - takes HD to RR tracks, it appears  
\_\_\_\_\_ substantive reasons discussed below

1. Name \_\_\_\_\_

2. Location \_\_\_\_\_

3. Classification \_\_\_\_\_

Category	Ownership	Status	Present Use
	Public Acquisition	Accessible	

4. Owner of Property \_\_\_\_\_

5. Location of Legal Description \_\_\_\_\_

6. Representation in Existing Surveys

Has this property been determined eligible?  yes  no

7. Description

Condition	Check one	Check one
<input type="checkbox"/> excellent	<input type="checkbox"/> deteriorated	<input type="checkbox"/> original site
<input type="checkbox"/> good	<input type="checkbox"/> ruins	<input type="checkbox"/> moved date _____
<input type="checkbox"/> fair	<input type="checkbox"/> unexposed	
	<input type="checkbox"/> unaltered	
	<input type="checkbox"/> altered	

Describe the present and original (if known) physical appearance

- summary paragraph
- completeness
- clarity
- alterations/integrity
- dates
- boundary selection

**8. Significance**

Period \_\_\_\_\_ Areas of Significance—Check and justify below

Specific dates \_\_\_\_\_ Builder/Architect \_\_\_\_\_

Statement of Significance (in one paragraph)

- summary paragraph
- completeness
- clarity
- applicable criteria
- justification of areas checked
- relating significance to the resource
- context
- relationship of integrity to significance
- justification of exception
- other

**9. Major Bibliographical References**

**10. Geographical Data**

Acreage of nominated property \_\_\_\_\_

Quadrangle name \_\_\_\_\_

UTM References \_\_\_\_\_

Verbal boundary description and justification

**11. Form Prepared By**

**12. State Historic Preservation Officer Certification**

The evaluated significance of this property within the state is:

\_\_\_\_ national      \_\_\_\_ state      \_\_\_\_ local

State Historic Preservation Officer signature

title

date

**13. Other**

- Maps
- Photographs
- Other

Questions concerning this nomination may be directed to \_\_\_\_\_

Signed \_\_\_\_\_ Date \_\_\_\_\_ Phone: \_\_\_\_\_

















SOLD  
Century 21





















O' MORE SCHOOL  
OF DESIGN  
←

CARTER HOUSE ↑

← CANTON

NO  
PARKING





Nutrena  
Feeds



Please refer to the map in the  
Multiple Property Cover Sheet  
for this property

Multiple Property Cover Sheet Reference Number: 64000824