

**United States Department of the Interior  
National Park Service**

**NATIONAL REGISTER OF HISTORIC PLACES  
REGISTRATION FORM**



1107

This form is for use in nominating or requesting determinations for individual properties and districts. See instructions in How to Complete the National Register of Historic Places Registration Form (National Register Bulletin 16A). Complete each item by marking "X" in the appropriate box or by entering the information requested. If any item does not apply to the property being documented, enter "N/A" for "not applicable." For functions, architectural classification, materials, and areas of significance, enter only categories and subcategories from the instructions. Place additional entries and narrative items on continuation sheets (NPS Form 10-900a). Use a typewriter, word processor, or computer, to complete all items.

=====

1. Name of Property

=====

historic name Salem Church

other names/site number Salem United Church of Christ

=====

2. Location

=====

street & number 208 Ohio Street not for publication N/A  
city or town Tulare vicinity X  
state South Dakota code SD county Spink code 115 zip code 57476

=====

3. State/Federal Agency Certification

=====

As the designated authority under the National Historic Preservation Act of 1986, as amended, I hereby certify that this \_\_\_ nomination \_\_\_ request for determination of eligibility meets the documentation standards for registering properties in the National Register of Historic Places and meets the procedural and professional requirements set forth in 36 CFR Part 60. In my opinion, the property \_\_\_ meets \_\_\_ does not meet the National Register Criteria. I recommend that this property be considered significant \_\_\_ nationally \_\_\_ statewide \_\_\_ locally. (\_\_\_ See continuation sheet for additional comments.)

Jay D. Voigt 07-29-97  
Signature of certifying official Date

\_\_\_\_\_  
State or Federal agency and bureau

In my opinion, the property \_\_\_ meets \_\_\_ does not meet the National Register criteria. (\_\_\_ See continuation sheet for additional comments.)

\_\_\_\_\_  
Signature of commenting or other official Date

name of property Salem Church

county and state Spink, South Dakota

4. National Park Service Certification

I, hereby certify that this property is:

entered in the National Register Linda McClelland 9/3/97  
 See continuation sheet.  
 determined eligible for the National Register  
 See continuation sheet.  
 determined not eligible for the National Register  
 removed from the National Register  
 other (explain):

Signature of Keeper Date of Action

5. Classification

Ownership of Property (Check as many boxes as apply)

- private
- public-local
- public-State
- public-Federal

Category of Property (Check only one box)

- building(s)
- district
- site
- structure
- object

Number of Resources within Property

Contributing	Noncontributing
<u>1</u>	<input type="checkbox"/> buildings
<input type="checkbox"/>	<input type="checkbox"/> sites
<input type="checkbox"/>	<input type="checkbox"/> structures
<input type="checkbox"/>	<input type="checkbox"/> objects
<u>1</u>	<input type="checkbox"/> Total

Number of contributing resources previously listed in the National Register 0

Name of related multiple property listing (Enter "N/A" if property is not part of a multiple property listing.) N/A

6. Function or Use

Historic Functions (Enter categories from instructions)

Cat: Religion Sub: Religious Facility

Multiple horizontal lines for entering historic functions.

Current Functions (Enter categories from instructions)

Cat: Religion Sub: Religious Facility

Multiple horizontal lines for entering current functions.

7. Description

Architectural Classification (Enter categories from instructions)

Late 19th & 20th Century Revivals: Late Gothic Revival

Materials (Enter categories from instructions)

foundation Concrete

roof Asphalt

walls Wood - Weatherboard

other

Narrative Description (Describe the historic and current condition of the property on one or more continuation sheets.)

8. Statement of Significance

Applicable National Register Criteria (Mark "x" in one or more boxes for the criteria qualifying the property for National Register listing)

- A Property is associated with events that have made a significant contribution to the broad patterns of our history.
- B Property is associated with the lives of persons significant in our past.
- C Property embodies the distinctive characteristics of a type, period, or method of construction or represents the work of a master, or possesses high artistic values, or represents a significant and distinguishable entity whose components lack individual distinction.
- D Property has yielded, or is likely to yield information important in prehistory or history.

Criteria Considerations (Mark "X" in all the boxes that apply.)

- A owned by a religious institution or used for religious purposes.
- B removed from its original location.
- C a birthplace or a grave.
- D a cemetery.
- E a reconstructed building, object, or structure.
- F a commemorative property.
- G less than 50 years of age or achieved significance within the past 50 years.

Areas of Significance (Enter categories from instructions)

Architecture  
 \_\_\_\_\_  
 \_\_\_\_\_  
 \_\_\_\_\_  
 \_\_\_\_\_  
 \_\_\_\_\_  
 \_\_\_\_\_  
 \_\_\_\_\_

Period of Significance 1911  
 \_\_\_\_\_  
 \_\_\_\_\_

name of property Salem Church

county and state Spink, South Dakota

Significant Dates 1911

\_\_\_\_\_  
\_\_\_\_\_

Significant Person (Complete if Criterion B is marked above)

N/A

Cultural Affiliation N/A

\_\_\_\_\_  
\_\_\_\_\_

Architect/Builder Unknown

\_\_\_\_\_

Narrative Statement of Significance (Explain the significance of the property on one or more continuation sheets.)

=====

9. Major Bibliographical References

=====

(Cite the books, articles, and other sources used in preparing this form on one or more continuation sheets.)

Previous documentation on file (NPS)

preliminary determination of individual listing (36 CFR 67) has been requested.

previously listed in the National Register

previously determined eligible by the National Register

designated a National Historic Landmark

recorded by Historic American Buildings Survey # \_\_\_\_\_

recorded by Historic American Engineering Record # \_\_\_\_\_

Primary Location of Additional Data

State Historic Preservation Office

Other State agency

Federal agency

Local government

University

Other

Name of repository: Salem United Church of Christ, Tulare, South Dakota

10. Geographical Data

Acreage of Property less than one acre

UTM References (Place additional UTM references on a continuation sheet)

	Zone	Easting	Northing	Zone	Easting	Northing
1	14	538985	4953645	3		
2				4		

See continuation sheet.

Verbal Boundary Description (Describe the boundaries of the property on a continuation sheet.)

Boundary Justification (Explain why the boundaries were selected on a continuation sheet.)

11. Form Prepared By

name/title William Otto and Michelle C. Saxman-Rogers SHPO Staff  
 organization Member of Salem Church date 12/3/96  
 street & number 208 Main telephone 605/596-4335  
 city or town Tulare state SD zip code 57476

Additional Documentation

Submit the following items with the completed form:

Continuation Sheets

Maps

A USGS map (7.5 or 15 minute series) indicating the property's location.

A sketch map for historic districts and properties having large acreage or numerous resources.

Photographs

Representative black and white photographs of the property.

Additional items (Check with the SHPO or FPO for any additional items)

**United States Department of the Interior**  
National Park Service

**NATIONAL REGISTER OF HISTORIC PLACES**  
**CONTINUATION SHEET**

Section 7 Page 1

Narrative Description

Summary Paragraph

The Salem Church is a good example of a first generation church in rural South Dakota, constructed in the vernacular Gothic Revival tradition. Located in the small town of Tulare, South Dakota, at 208 Ohio Street, the one-story wood frame building was completed in 1911 and retains a high degree of architectural integrity. The only alterations have been the covering of the pressed metal on the south wall of the sanctuary, and the installation of electricity and a furnace. The church building is rectangular in shape with a center steeple. It measures forty-four by twenty-eight feet and rests on a poured concrete foundation. The church roof was originally covered with wood shingles, which were replaced with asphalt shingles. It has been in continues use as a religious institution.

Description

The north (facade) elevation features a tall centered bell tower with a steeple (a mansard roof) and a front-gable. The main entrance is centered on the bell tower. The entrance consists of double doors, and an arch fanlight. A bull's eye stained glass window is above the fanlight. A new wood entrance ramp was added to the front door in 1987, to provide better wheelchair access to the building. Located to the right and left of the bell tower are Gothic head stained glass windows.

The east elevation features four Gothic head stained glass windows and a side entrance to the church. The west elevation also features four Gothic head stained glass windows. The south facade is a blank gable wall. Some of the window frames were badly deteriorated and were replaced with similiar frames in 1995. The original glass was inserted in the new frames.

The building has a simple rectangular floor plan, the building is organized with a north-facing main entrance leading to the sanctuary. The apse at the south end still features the original baptismal font and altar. All of the interior woodwork remains, as well as a balcony at the back of the worship area.

The balcony is supported by two posts, one on either side of the aisle. The front of the balcony is covered with wainscoting. Most of the walls and ceiling are covered with pressed metal.

Currently used as a church, the building itself has undergone some alterations and upgrades to facilitate continued use. Electricity and heat were added to the interior, but no plumbing has ever been introduced. The parsonage next door served the bathroom needs after the outhouses were removed at an unknown date.

**United States Department of the Interior**  
National Park Service

**NATIONAL REGISTER OF HISTORIC PLACES**  
**CONTINUATION SHEET**

Section 7.8 Page 2

Upon entering the building, the foyer provides a greeting area and staircase to the balcony on the east side. Directly in front of the entrance, there is the entrance to the sanctuary. The foyer wall material is pressed metal.

The sanctuary walls and ceiling are covered with pressed metal. The pressed metal is in the quatrefoil design with a bead-and-reel-molding. The south wall metal was covered with wood paneling in 1965. This minor alteration was done because the metal was deteriorated but, the metal is still present under the paneling. The altar is centered on the south wall, it is a raised stage area with a two step rise. The pulpit is covered with dark stained wainscoting. The pulpit is accessed from a staircase on the left side of the pulpit. A chimney is located to the right of the pulpit. The pews are in a center-aisle plan with rows of pews flush against the walls. The floors and pews were refinished in 1990. This room also features the eight Gothic head stain glass windows and the second entrance to the building.

Except for electricity and a propane furnace which were installed years ago, the building is very close to original. It has no basement, and no plumbing was ever installed. After the outhouses were removed, the parsonage next door served the bathroom needs of the congregation. A large cottonwood tree provides shade for the front of the church. A parsonage is located next door, but it was built much later and is not included in the nomination.

**Statement of Significance**

The Salem Church is eligible for listing on the National Register of Historic Places under criterion C as embodying the distinctive characteristics of a type, period, or method of construction. More specifically, the Salem Church typifies the "first generation" of church construction in eastern South Dakota and has local architectural significance. It typifies the religious buildings common to most permanent rural settlements in South Dakota.

The Salem church is a center-steeple church, one of the most common types built. The facade of this type of church relies on several center-oriented devices: the steps and porch, entry doors, window in the tower, belfry, and spire are all visually layered over each other.<sup>1</sup> The placement of the openings are symmetrical, and the rest of the building is modestly ornamented. Like other churches of this type, the Salem Church has the center-aisle plan with rows of pews flush against the walls.

---

<sup>1</sup> Jennings, Jan & Herbert Gottfried, American Vernacular Interior Architecture 1870-1940, Iowa State University Press, 1993.

**United States Department of the Interior**  
National Park Service

**NATIONAL REGISTER OF HISTORIC PLACES**  
**CONTINUATION SHEET**

Section   8   Page   3  

Historic Context

Scholars of church architecture in the Great Plains have divided the evolution of church architecture in the region into several phases. These phases tend to happen in generational cycles and so they have been termed generations. Typically, a parish or congregation would be established in a given area as soon as there was sufficient population. The first order of business for a newly organized church was to construct a building. In most instances, the financial resources of a church dictated that the structure cost as little as possible. As a result, most of the first generation churches were simple frame buildings constructed by local carpenters or builders. In eastern South Dakota, first generation churches date from the late 19th century with most buildings constructed during the First Dakota Boom, 1878-1893.

Church architecture has been long associated with the use of stained glass, and at the turn of the century, richly colored glass - including coated, opalescent, and drapery glass - became widely available. At the same time, builders developed techniques to increase the size of windows. The shapes of windows also became more varied, ranging from single, pointed Gothic windows; multiple, Gothic-tracery windows; and round-top, Romanesque windows. Most churches constructed around the turn of the century did not have basements. But basements were routinely included in later church plans and were frequently dug under the older churches.<sup>2</sup>

South Dakota and the northern Great Plains in general, suffered heavily during the 1890s. A multi-year drought beginning in 1886, devastated the rural community. This situation was worsened by the national depression that followed the Silver Panic of 1893. As a result, few church buildings were constructed until the return of relative prosperity at the turn-of -the-century. The period from 1900-1917, known as the Second Dakota Boom, found many eastern South Dakota churches facing an expanding membership and aging, inadequate church buildings. Many congregations decided to construct new church buildings to replace their original first generation structures. These "second generation" structures were usually architect designed masonry buildings rendered in one of the popular ecclesiastic styles of the time. Despite the relative prosperity of the first two decades of this century, few eastern South Dakota churches could afford extravagant buildings. As a result, second generation churches tended to exhibit less expensive materials and construction techniques than those employed in more prosperous areas of the country.

The Salem Congregation in Tulare, South Dakota, is the oldest congregation in the Evangelical Synod of North America in South Dakota. It was organized in 1882 by a group of German Immigrants who settled in the Tulare, Crandon area of Spink County. According to the early

---

<sup>2</sup> Erpestad, David and David Wood, Building South Dakota: A Historical Survey of the State's Architecture to 1945, South Dakota State Historical Society, Pierre, SD, 1997.

**United States Department of the Interior**  
National Park Service

**NATIONAL REGISTER OF HISTORIC PLACES**  
**CONTINUATION SHEET**

Section   8   Page   4  

secretary's book, a minister by the name of David Labahn came to Crandon and preached the first sermon in the Crandon Depot on January 7, 1883. On Sunday, January 14, 1883 an organizational meeting was held and the Salem Congregation was formed. According to information from the Secretary of State, Salem Congregation was incorporated in 1892.

The congregation adopted the constitution of the Evangelical Lutheran Iowa Synod. Salem Congregation became a member of the Evangelical Synod of North America and formulated a new Constitution in 1904. Until the present church was built in 1911, services were held in homes, schools, and other buildings. A simple center-steeple church was constructed by local carpenters and builders.

The Salem Church is classified a first generation church because it a simple frame building constructed by local carpenters. The congregation was unable financial to build a church until 1911. This building has all of the characteristic of a first generation church. The building possess a simple plan and design, no basement, and pointed Gothic windows like other first generation churches

The church shared a minister with its sister church, St. Johns, at Turtle Creek, which was organized in 1892. During the period of 1902-1922, the Salem pastor also served the German Evangelical St. Emmanuals Congregation which had a church sixteen miles east and one mile north of Tulare.

The Salem Congregation was known as the Salem Evangelical Lutheran Congregation until 1934, when it changed to Salem Evangelical and Reform Church. On August 22, 1937, the last German Services was held at Salem. In 1957, it became the Salem United Church of Christ.

In July, 1965, the congregations of Salem United Church of Christ, St. Johns United Church of Christ, and Tulare Methodist Church joined in the endeavor of sharing a minister and formed the Tri-church Parish. Services have been held continually in Salem church since 1911.

The church retains a high degree of architectural integrity and has only a few alterations. Few examples of this building type remain in South Dakota with a high degree of architectural integrity. Many churches have suffered alterations such as modern siding, new windows, and removal of the steeple. The major charater defining feature of the building is the bell tower with a mansard roof. The Salem Church remains an excellent example of a vernacular Gothic Revivial center-steeple church building and therefore eligible for listing on the National Register of Historic Places under criterion C.

name of property Salem Church

county and state Spink, South Dakota

Property Owner

(Complete this item at the request of the SHPO or FPO.)

name Evangelical Lutheran Salem Congregation of Tulare

street & number 208 Ohio St telephone 605/596-4156

city or town Tulare state SD zip code 57476

**Paperwork Reduction Act Statement:** This information is being collected for applications to the National Register of Historic Places to nominate properties for listing or determine eligibility for listing, to list properties, and to amend existing listings. Response to this request is required to obtain a benefit in accordance with the National Historic Preservation Act, as amended (16 U.S.C. 470 et seq.).

**Estimated Burden Statement:** Public reporting burden for this form is estimated to average 18.1 hours per response including the time for reviewing instructions, gathering and maintaining data, and completing and reviewing the form. Direct comments regarding this burden estimate or any aspect of this form to the Chief, Administrative Services Division, National Park Service, P.O. Box 37127, Washington, DC 20013-7127; and the Office of Management and Budget, Paperwork Reductions Project (1024-0018), Washington, DC 20503.

**United States Department of the Interior**  
National Park Service

**NATIONAL REGISTER OF HISTORIC PLACES**  
**CONTINUATION SHEET**

Section 9,10 Page 5

**Bibliography**

Erpestad, David and David Wood. Building South Dakota: A Historical Survey of the State's Architecture to 1945, South Dakota State Historical Society: Pierre, SD, 1997.

Jennings, Jan & Herbert Gottfried. American Vernacular Interior Architecture 1870-1940, Iowa State University Press, 1993.

McAlester, Virginia & Lee. A Field Guide To American Houses, New York: Alfred A. Knopf, 1992.

**Verbal Boundary Description**

Lot 10, 11, & 12 of Block 11 of the original plat of Tulare.

**Boundary Justification**

The boundary includes the church and the property surrounding the building that have historically been associated with the property.

SOUTH

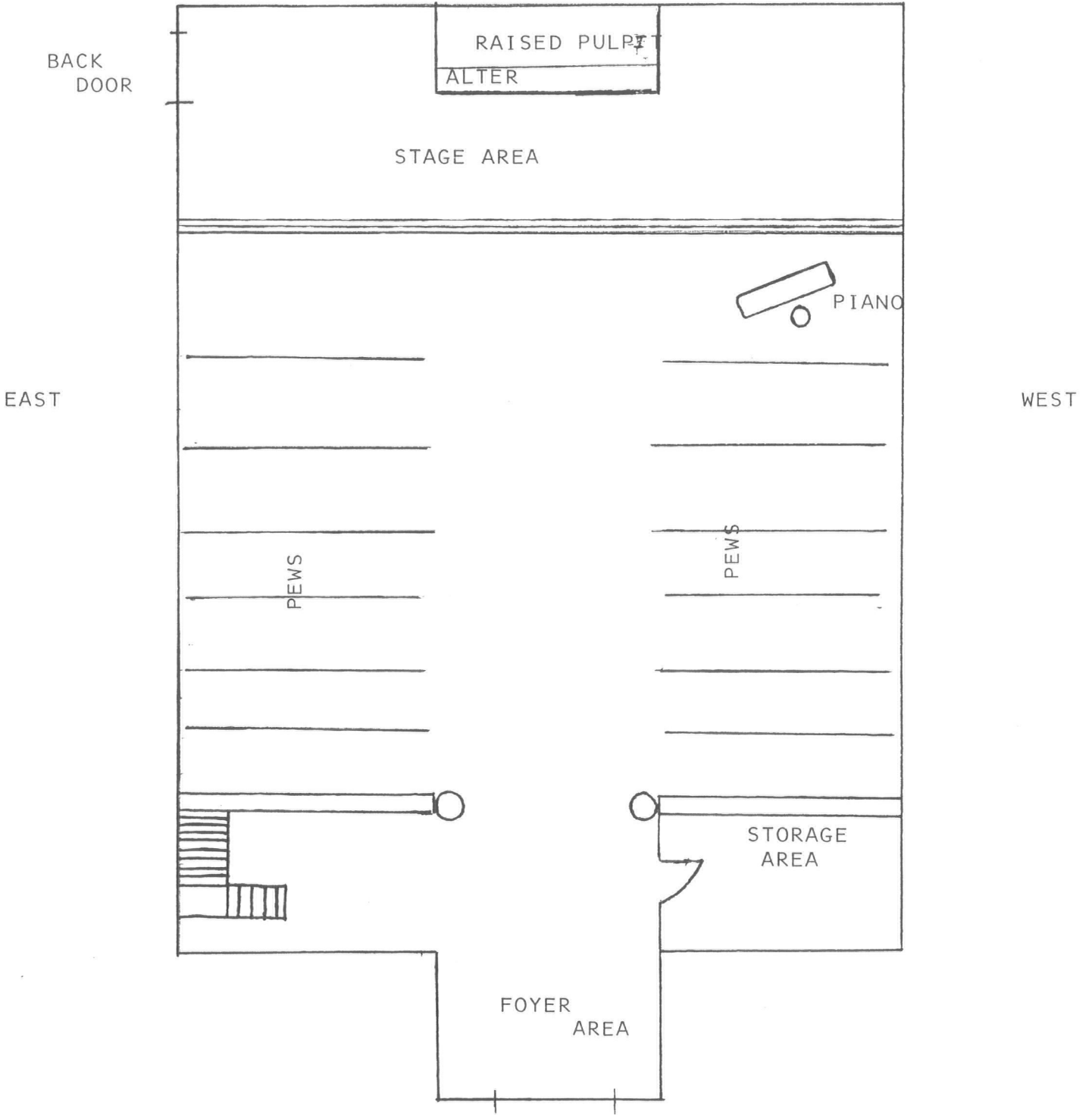

FLOOR PLAN TO THE SALEM CHURCH, TULARE, SPINK CO., SD

NORTH

United States Department of the Interior  
National Park Service

National Register of Historic Places  
Continuation Sheet

Section number \_\_\_\_\_ Page \_\_\_\_\_

SUPPLEMENTARY LISTING RECORD

NRIS Reference Number: 97001107

Property Name: Salem Church

County: Spink State: South Dakota

none  
Multiple Name

-----  
This property is listed in the National Register of Historic Places in accordance with the attached nomination documentation subject to the following exceptions, exclusions, or amendments, notwithstanding the National Park Service certification included in the nomination documentation.

*Fonda M. Cullard*  
Signature of the Keeper

September 3, 1997  
Date of Action

=====  
Amended Items in Nomination:

Section 3. Certification. "Locally" is, hereby, entered as the level of significance. The status of "nomination" and "meets criteria" is also, hereby, verified.

-----  
Steve Rogers of the South Dakota State Preservation Office provided the additional information and was notified of this amendment.

-----  
**DISTRIBUTION:**

- National Register property file
- Nominating Authority (without nomination attachment)

UNITED STATES DEPARTMENT OF THE INTERIOR  
NATIONAL PARK SERVICE

NATIONAL REGISTER OF HISTORIC PLACES  
EVALUATION/RETURN SHEET

REQUESTED ACTION: NOMINATION

PROPERTY NAME: Salem Church

MULTIPLE NAME:

STATE & COUNTY: SOUTH DAKOTA, Spink

DATE RECEIVED: 8/08/97                      DATE OF PENDING LIST: 8/18/97  
DATE OF 16TH DAY: 9/03/97                      DATE OF 45TH DAY: 9/22/97  
DATE OF WEEKLY LIST:

REFERENCE NUMBER: 97001107

NOMINATOR: STATE

REASONS FOR REVIEW:

APPEAL: N    DATA PROBLEM: N    LANDSCAPE: N    LESS THAN 50 YEARS: N  
OTHER: N    PDIL: N    PERIOD: N    PROGRAM UNAPPROVED: N  
REQUEST: N    SAMPLE: N    SLR DRAFT: Y    NATIONAL: N

COMMENT WAIVER: N

     ACCEPT           RETURN           REJECT                           DATE

ABSTRACT/SUMMARY COMMENTS:

*SLR to verify nomination status and indicate level of significance a "nomination", "meets criteria", and "local level"*

*(Steve Rogers notified)  
- responded 9/13/97*

RECOM./CRITERIA C Accept

REVIEWER LINDA McClelland      DISCIPLINE HISTORIAN

TELEPHONE 202-343-9544      DATE 9/3/97

DOCUMENTATION see attached comments Y/N see attached SLR (Y)N



Backoz Church and west side

Salem Church

#1

208 DHIO

Tulare, Spink Co, SD

w<sup>m</sup> OHO

Kodak  
PREMIUM  
Processing  
FEB. 1997



East side and north front of church

parsonage next door

# 2

Salem Church

208 Ohio

Tulare, Spink Co, SD

Wm O'H

**Kodak**  
**PREMIUM**  
**Processing**  
FEB. 1997



Salem Church  
208 Ohio

#13

Tulare, Spring CO. 91

Wm Otto

Kodak  
PREMIUM  
PROCESSING  
FEB. 1997

Salem Church

#13



west side of church  
Salem church  
208 Ohio  
Tulare, Spink Co., SD  
Wm Otto

# 4

**Kodak**  
**PREMIUM**  
**Processing**  
FEB. 1997



The Lord is my strength  
and my deliverance  
in the day of battle  
my strength and my deliverance  
in the day of battle

Balcony in back of Church #15

Salem Church

208 Ohio

Tulare, Spink Co., SD

Wm Otto

**Kodak**  
**PREMIUM**  
**Processing**  
FEB. 1997



Inside view of pews

#6

Salem Church

208 Ohio

Tulare, Spink Co., SD

Wm Otto

**Kodak**  
**PREMIUM**  
**Processing**  
FEB. 1997



front of church  
raised pulpit, altar, etc

#7

Salem Church

208 Ohio

Tulare, Spink Co., SD

W<sup>m</sup> Otto

Kodak  
PREMIUM  
Processing  
FEB. 1997



pressed tin on walls

Salem Church

208 Ohio

Tulare, Spink Co., S.D.

W<sup>m</sup> Otto

**Kodak**  
**PREMIUM**  
Processing  
FEB. 1997

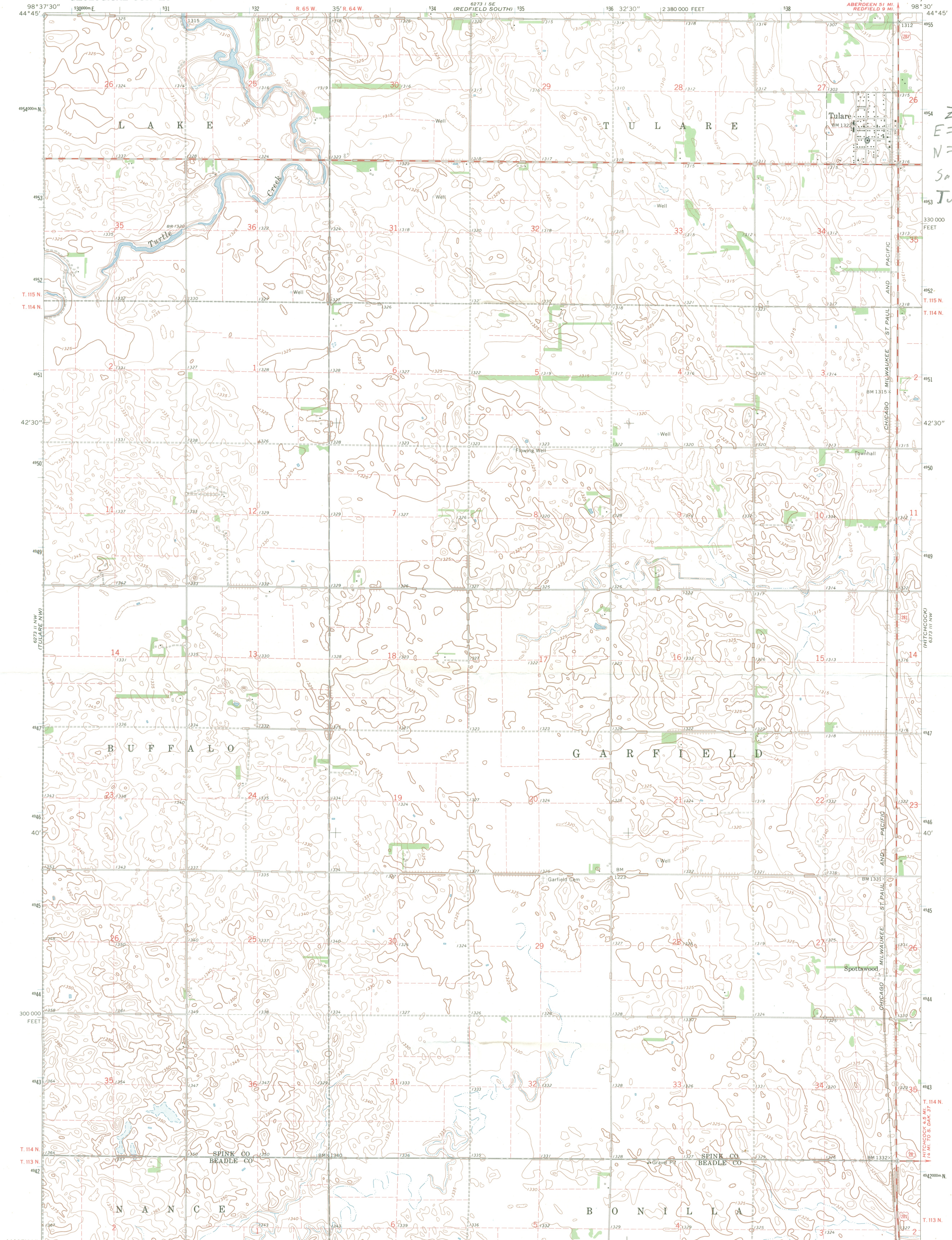

Z = 14  
E = 538985  
N = 4953645  
Salem Church  
Tulare, Spink Co

Mapped, edited, and published by the Geological Survey as part of the Department of the Interior program for the development of the Missouri River Basin Control by USGS, USC&GS, and U.S. Bureau of Reclamation  
Planimetry by photogrammetric methods from aerial photographs taken 1965. Topography by planetable surveys 1967, and in part by U.S. Bureau of Reclamation  
Polyconic projection. 1927 North American datum  
10,000-foot grid based on South Dakota coordinate system, north zone  
1000-meter Universal Transverse Mercator grid ticks, zone 14, shown in blue  
Fine red dashed lines indicate selected fence and field lines where generally visible on aerial photographs. This information is unchecked

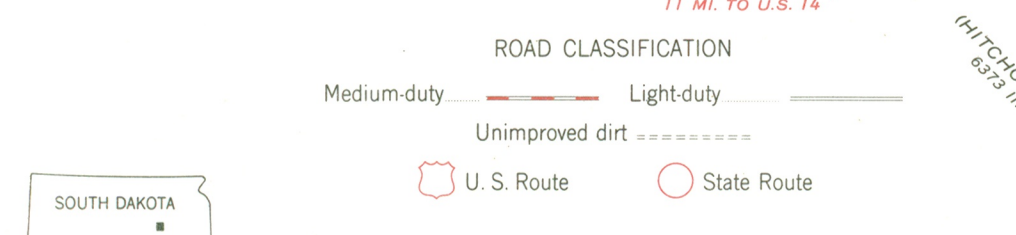
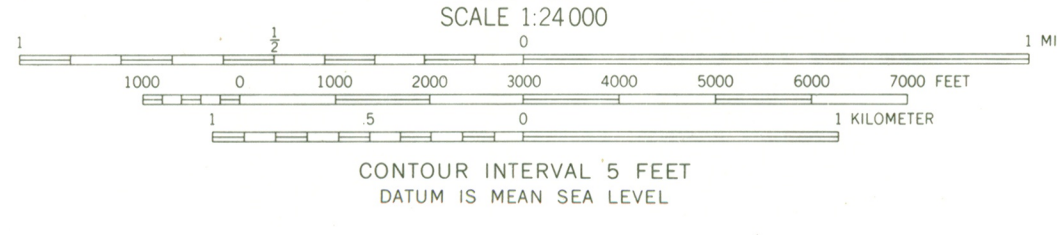

THIS MAP COMPLIES WITH NATIONAL MAP ACCURACY STANDARDS  
FOR SALE BY U.S. GEOLOGICAL SURVEY, DENVER, COLORADO 80225, OR WASHINGTON, D.C. 20242  
A FOLDER DESCRIBING TOPOGRAPHIC MAPS AND SYMBOLS IS AVAILABLE ON REQUEST

TULARE, S. DAK.  
N4437.5-W9830.7.5  
1967

AMS 6273 II NE—SERIES V873

July 29, 1997

CAROL SHULL, KEEPER OF THE NR  
U. S. DEPARTMENT OF THE INTERIOR  
NATIONAL PARK SERVICE  
PO BOX 37127  
WASHINGTON DC 20013-7127

Dear Ms. Shull:

Enclosed are two nominations to the National Register of Historic Places, which were approved by the South Dakota Review Board on July 18, 1997. These properties are:

Gerhart, Augustus and Augusta, House, Highmore, Hyde County, South Dakota

Salem Church, Tulare, Spink County, South Dakota

Please review these documents at your earliest convenience. Thank you.

Sincerely,



Jay D. Vogt  
State Historic Preservation Officer