

United States Department of the Interior
National Park Service

National Register of Historic Places
Registration Form

205

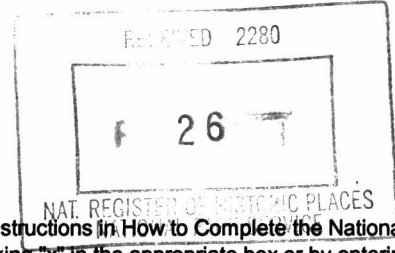

This form is for use in nominating or requesting determinations for individual properties and districts. See instructions in How to Complete the National Register of Historic Places Registration Form (National Register Bulletin 16A). Complete each item by marking "X" in the appropriate box or by entering the information requested. If any item does not apply to the property being documented, enter "N/A" for "not applicable." For functions, architectural classification, materials, and areas of significance, enter only categories and subcategories from the instructions. Place additional entries and narrative items on continuation sheets (NPS Form 10-900a). Use a typewriter, word processor, or computer to complete all items.

1. Name of Property

historic name Alexander House
other names/site number Alexander Music House

2. Location

street & number 319 East Main Street not for publication
city or town Spartanburg vicinity _____
state South Carolina code SC county Spartanburg code 083 zip code 29306

3. State/Federal Agency Certification

As the designated authority under the National Historic Preservation Act of 1986, as amended, I hereby certify that this nomination request for determination of eligibility meets the documentation standards for registering properties in the National Register of Historic Places and meets the procedural and professional requirements set forth in 36 CFR Part 60. In my opinion, the property meets does not meet the National Register Criteria. I recommend that this property be considered significant nationally statewide locally. (See continuation sheet for additional comments.)

Mary W. Edmonds 2/17/03
Signature of certifying official Date

Mary W. Edmonds, Deputy State Historic Preservation Officer, S.C. Dept. of Archives and History, Columbia, S.C.
State or Federal agency and bureau

In my opinion, the property meets does not meet the National Register criteria. (See continuation sheet for additional comments.)

Signature of commenting or other official Date

State or Federal agency and bureau

4. National Park Service Certification

I, hereby certify that this property is:
 entered in the National Register Sandra McCullough 9/11/03
 See continuation sheet.
 determined eligible for the National Register
 See continuation sheet.
 determined not eligible for the National Register
 removed from the National Register
 other (explain): _____

Alexander House
Name of Property

Spartanburg County, South Carolina
County and State

5. Classification

Ownership of Property
(Check as many boxes as apply)

Category of Property
(Check only one box)

Number of Resources within Property
(Do not include previously listed resources)

- private
- public-local
- public-State
- public-Federal

- building(s)
- district
- site
- structure
- object

Contributing	Noncontributing
1	1
_____	_____
_____	_____
1	1

buildings
sites
structures
objects
Total

Name of related multiple property listing
(Enter "N/A" if property is not part of a multiple property listing.)
N/A

Number of contributing resources previously listed
in the National Register
0

6. Function or Use

Historic Functions
(Enter categories from instructions)

Category: DOMESTIC

Subcategory: Single Dwelling

Current Functions
(Enter categories from instructions)

Category: VACANT

Subcategory: Not in Use

7. Description

Architectural Classification
(Enter categories from instructions)

Neoclassical Revival

Materials
(Enter categories from instructions)

foundation Brick
walls Weatherboard

roof Composition
other _____

Narrative Description

(Describe the historic and current condition of the property on one or more continuation sheets.)

United States Department of the Interior
National Park Service

National Register of Historic Places
Continuation Sheet

Section number 7 Page 5

Alexander House
Name of Property
Spartanburg County, South Carolina
County and State

The Alexander House is a two-story frame and weatherboard-clad building in the Neoclassical Revival style at 319 East Main Street, two blocks east of downtown Spartanburg, South Carolina. It was designed by Epton and Keating, architects of Spartanburg, and built in 1904 for John A. Walker.¹ The Neoclassical style became a dominant style for domestic architecture throughout the United States during the first half of the twentieth century. This house is an uncommon subtype of the style; here a wraparound one-story porch is added under the more common two-story centrally located porch. Epton and Keating may have taken their design inspiration from Design No.199 and Floor Plan No. 188 in George Barber's pattern book of 1903.²

In 1907 the house became the residence of Alonzo Marshall Alexander and Cecelia McCants Alexander. Gas lighting was originally installed in this residence and was converted to electrical lighting prior to 1929; a family photo album from that year documents this change. One original gas fixture of bronze and glass was later reinstalled in the dining room. Minor architectural alterations were made after Alonzo Bernard Alexander inherited the house upon the death of his father in 1933. The most significant change was the remodeling of the kitchen and the removal of the butler's pantry and storage area and conversion of this area to a breakfast room ca. 1935. In 1969 the residence was converted by Alonzo "Lonnie" Bernard Alexander, Jr., grandson of Alonzo M. Alexander, to a musical instruments store. At this time other architectural changes were made. The north façade's first story wide double-hung, one-over-one windows were removed from the parlor and the library and replaced with two large thirty-five-paned storefront windows. The mantels in the parlor, library and dining room were removed to allow for more wall space to display instruments and sheet music. The music store was located here until 1994. Since that date the structure has served several retail and office uses with little change. Just prior to its closing Sheryl Alexander, a great-granddaughter of Alonzo Marshall Alexander, restored the deteriorating front porch.³ The large Tuscan columns were replaced at that time with ones slightly smaller in circumference. The smaller columns on the first floor porch were also replaced at that time because the originals were deteriorated. Cornice modillions and the original second level porch balustrade were removed and non-deteriorated material was stored in the back garage and basement. The current owners plan to restore the balustrade to their original configuration using the original material.

The Alexander House is a 44' wide x 40' deep block, and is three bays in overall width. It is set upon a granite ashlar and brick foundation. It features a composition shingle-clad hipped roof that shelters the house as well as an engaged two-tiered porch supported by four monumental Tuscan columns. A nearly flat segment at the peak of the hipped roof is metal-clad and once featured a balustraded

¹ W.S. Kline, *Spartanburg of Today* (Spartanburg, S.C.: Band and White, 1904), p. 9.

² George F. Barber & Company, *Modern Dwellings: A Book of Practical Designs and Plans for Those Who Wish To Build or Beautify Their Homes* (Knoxville: S.B. Newman & Co., 1901), p. 199.

³ *Spartanburg Herald Journal* (Spartanburg, S.C.), 12 May 1992.

United States Department of the Interior
National Park Service

National Register of Historic Places
Continuation Sheet

Section number 7 Page 6

Alexander House
Name of Property
Spartanburg County, South Carolina
County and State

widow's walk; it currently contains a skylight. A central pediment with a cameo window projects from the main porch roof and is supported by the two additional monumental free-standing columns set in alignment or in tandem with the two central columns of the porch roof. Two large pedimented dormers with beveled casement windows adorn the house's front slope, while two similar dormers with paired double-hung windows punctuate each of the side roof slopes. Two large corbel-capped chimneys also rise symmetrically from the roof slopes.

A one-story Tuscan order wraparound porch is set slightly within the large columns, with the denticulated cornice of the one-story porch encompassing the four main columns. Between each of the small columns is a turned balustrade. The porch ceilings, both first and second level, are of beaded board, while the porch flooring is of narrow tongue-and-groove planks. The extension of this porch at the right [west] terminates in a porte cochere. A ramp for the disabled was added in 1998 by the previous owner, a chiropractor, and is made of original pickets from the second floor porch rail. The upper floor's porch, with its uncovered extensions to either side, once contained a turned balustrade with square newels and ball finials. The house's central pavilion features projecting entry bays, with the first floor entrance consisting of a double-leaf glazed door with decorative stained glass transom and wide sidelights. The upper floor's entry bay consists of double-leaf doors that have upper beveled glass panels, stained glass transom and flanking cameo windows. Windows throughout are oversized one-over-one light, double-hung sash, fitted with wide louvered shutters. The most notable exceptions are the large multi-light Colonial Revival display windows flanking the main entrance that were installed when the house became Alexander Music House.

On the west elevation and just to the rear of the porte cochere is a two-story curved or bowed bay. On the rear [south] elevation is a one-bay deep, two-story ell that features a hip roof and a single hipped roof dormer with a paired double-hung, one-over-one light window. A single-leaf secondary entrance with beveled upper glass panel and sidelights is located along the east elevation where the two-story ell is inset. Steps from the side yard lead to this entrance. To the rear of this is a one-story-over-basement hipped roof ell that features large metal casement windows that are obviously a historic alteration. A shed-roofed extension is along the west elevation and may be a porch enclosure.

The first floor plan consists of a central hall, which accesses the parlor and an ornate stairway to the right and the library and dining room to the left. The central hall is an ample 11'-1" x 31'-7" space, with 11' high ceilings, high paneled wainscoting and deep denticulated cornice. The main stair niche, perhaps the most elaborately articulated feature of this space, has curved end risers and treads which flow into the central hall and provide for an original telephone nook. The stairway niche is framed handsomely with Tuscan order pilasters. Doorway trim is simple and consists of flat trim

United States Department of the Interior
National Park Service

National Register of Historic Places
Continuation Sheet

Section number 7 Page 7

Alexander House
Name of Property
Spartanburg County, South Carolina
County and State

with rounded edges and topped with a simple moulded architrave. The floors are heart pine throughout the residence. The recesses on each side of the parlor fireplace have been in-filled with bookshelves. The mantel and tile fireplace surround in the first floor bedroom is extant. The 1929 family album reveals that many of the rooms had dropped picture moulding, above which were painted scenes creating a frieze effect. These were removed in one of the more recent renovations.

A back service hall is accessed through a door in the front hall's south wall. The service hall accesses a bedroom, a bathroom, the back porch, a service stair and a breakfast room. The breakfast room was created from the original butler's pantry and storage area located between the dining room and the kitchen. A 1929 photograph of the dining room shows two doors in the south wall of the dining room accessing the kitchen, as well as paneled wainscoting around the room. Currently, only one of these doors is extant. The wainscoting was removed during the 1969 renovations. The south door in the back hall opens onto an enclosed back porch. The porch accesses a servant's restroom, a stairway to grade and the basement, a closet and the door to the kitchen, which is housed in the one-story rear ell. The main stairway leads to another spacious second floor hallway, which accesses three bedrooms. A door in the south wall of the hallway provides access to a service stair to the attic, a back bedroom, with bath, service stair to the first floor and a second floor bathroom, which was originally a linen room. On the second floor all original mantels are intact and three of the four feature overmantels with beveled glass mirrors. All interior doors contain five horizontal panels and retain all of their original hardware. All of the major rooms in the house are cornice moulded including all the second floor bedrooms.

There is little of the original urban landscape plan intact. The front yard area was reduced by road widening on Main Street in the 1950s and paving by former merchants. The current owner plans to remove the asphalt paving and create a landscaped area in front of the house. The back garden was destroyed in the 1960s with the paving of the garden area and the building of a concrete block garage on the southwest corner of the lot. The Sanborn map of 1908 shows a carriage house located near the southeast corner of the lot and the eave of this building appears in the album of 1929. The current owners have developed plans to reuse the residence as Spartanburg's first bed and breakfast. A concrete block garage, which the current owners plan to demolish, is the only noncontributing building on the property. A pergola, located at the rear of the one-story ell, is perhaps a later addition. The owners also plan to restore the garden space as well as the carriage house as an innkeeper's apartment.

Alexander House
Name of Property

Spartanburg County, South Carolina
County and State

8. Statement of Significance

Applicable National Register Criteria

(Mark "x" in one or more boxes for the criteria qualifying the property for National Register listing)

- A Property is associated with events that have made a significant contribution to the broad patterns of our history.
X B Property is associated with the lives of persons significant in our past.
X C Property embodies the distinctive characteristics of a type, period, or method of construction or represents the work of a master, or possesses high artistic values, or represents a significant and distinguishable entity whose components lack individual distinction.
D Property has yielded, or is likely to yield information important in prehistory or history.

Criteria Considerations

(Mark "X" in all the boxes that apply.)

- a owned by a religious institution or used for religious purposes.
b removed from its original location.
c a birthplace or a grave.
d a cemetery.
e a reconstructed building, object, or structure.
f a commemorative property.
g less than 50 years of age or achieved significance within the past 50 years.

Areas of Significance

(Enter categories from instructions)

ARCHITECTURE
COMMERCE

Period of Significance

1904-1933

Significant Dates

1904
1933

Significant Person

(Complete if Criterion B is marked above)

Alexander, Alonzo Marshall

Cultural Affiliation

Architect/Builder

Epton, Leland P., and Keating, Thomas

Narrative Statement of Significance

Explain the significance of the property on one or more continuation sheets.)

9. Major Bibliographical References

(Cite the books, articles, and other sources used in preparing this form on one or more continuation sheets.)

Previous documentation on file (NPS):

- preliminary determination of individual listing (36 CFR 67) has been requested.
previously listed in the National Register
previously determined eligible by the National Register
designated a National Historic Landmark
recorded by Historic American Buildings Survey #
recorded by Historic American Engineering Record #

Primary location of additional data:

- State Historic Preservation Office
Other State agency
Federal agency
Local government
University
x Other
Name of repository:
Susan Sease (Owner), 319 E. Main St.,
Spartanburg, S.C.

United States Department of the Interior
National Park Service

National Register of Historic Places
Continuation Sheet

Section number 8 Page 8

Alexander House
Name of Property
Spartanburg County, South Carolina
County and State

The Alexander House is eligible for listing in the National Register of Historic Places under Criterion C as an outstanding example of Neoclassical Revival residential architecture. Notable exterior features include a full-height entry porch with lower full-width porch and oversized one-over-one double-hung window sashes. Notable interior features include an original ornate wooden stairway, leaded glass windows, dentiled cornices and original mantels. The Alexander House is also eligible for listing under Criterion B for its association with Alonzo Marshall Alexander, a prominent early twentieth-century merchant with extensive business interests in Spartanburg and throughout the South Carolina upcountry.

The house, with an original address of 205 East Main Street (the address was changed to 319 East Main Street by 1933), was built in 1904. It was designed for John A. Walker, a merchant who owned a shoe store on Spartanburg's Morgan Square, by Leland P. Epton and Thomas Keating, architects and real estate developers who were partners in Spartanburg 1903-05.⁴ In 1905 Walker sold the house to W.C. Carrington, a Spartanburg salesman, who sold it to Alonzo Marshall Alexander for \$10,000 in 1907.⁵ The house remained in the Alexander family until 1997.

Alonzo Marshall Alexander (1867-1933), son of Isaac Newton and Margaret Amelia Alexander, was born in Abbeville County. He married Cecelia McCants (1863-1931) in 1891 and moved to Greenville, becoming a merchant as a partner (with his older brother Thomas Oscar Alexander, and a cousin, Marshall L. Alexander) in Alexander Brothers and Company, a store specializing in pianos, organs, and sewing machines. When Thomas O. Alexander died in 1897 Alonzo moved his family to Spartanburg and soon opened a new Alexander Brothers and Company store, incorporated in 1901. He also expanded his business interests, founding the Piedmont Mutual Insurance Company in 1903 and becoming a real estate entrepreneur as well, eventually owning extensive commercial and residential properties in Spartanburg, Greenville, Greenwood, and Richland Counties by the time of his death in 1933.⁶

⁴ *Hill's Spartanburg City Directory, 1896* (Richmond, Va.: Hill Directory Company); Kline, p. 9; John E. Wells and Robert E. Dalton, *The South Carolina Architects 1885-1935: A Biographical Dictionary* (Richmond: New South Architectural Press, 1992), pp. 50-51, 90-91.

⁵ *Hill's Spartanburg City Directory, 1899*; Spartanburg County Deed Book 4D, p. 789, Spartanburg County Register of Mesne Conveyance, Spartanburg County Courthouse, Spartanburg, S.C. (hereafter referenced as Deed Book, with book number and page citation, Spartanburg County RMC); Spartanburg County Deed Book 4L, p. 760, Spartanburg County RMC.

⁶ Francis Pearre Fretwell, *Alexander and McCants Genealogy* (Spartanburg, S.C.: Published by the Author, 1980); *Greenville City Directory, 1896-97*; *Spartanburg City Directory, 1903-04, 1905-06*, Obituary of Alonzo Marshall Alexander, *Spartanburg Herald Journal* (Spartanburg, S.C.), 5 January 1933.

United States Department of the Interior
National Park Service

**National Register of Historic Places
Continuation Sheet**

Section number 8 Page 9

Alexander House
Name of Property
Spartanburg County, South Carolina
County and State

Marshall's son Alonzo Bernard Alexander (1896-1961) inherited both the house at 319 East Main Street and the Alexander Brothers and Company store, which changed its name to the Alexander Music Company and opened at a new location at 200 East Main Street in 1941.⁷ His only child Alonzo Bernard "Lonnie" Alexander, Jr. (1922-1990) inherited the house and business in 1961, living in the house until 1965, when he rented it to Margaret M. Taylor as an antique shop. In 1969 Lonnie moved the Alexander Music House into the house at 319 East Main Street, where it remained until it closed in 1994.⁸ After his death his daughter Sherry took over the business, rehabilitating the house in 1992 and receiving the Peggy Gignilliat Preservation Award of the Spartanburg County Historical Association.⁹ The Alexander Music House closed in 1994, and housed a chiropractic clinic from 1997 to 2002, when the present owners, Wayne and Susan Sease, acquired it. They plan to open Spartanburg's first bed and breakfast in the house in the near future.

⁷ Obituary of Alonzo Bernard Alexander, *Spartanburg Herald Journal*, 11 September 1961;

Peggy Burton Rich, *Alexander Families of Upper South Carolina* (Clemson, S.C.: Published by the Author, 1988).

⁸ Obituary of Alonzo Bernard Alexander, Jr., *Spartanburg Herald Journal*, 26 January 1990; *Spartanburg City Directory*, 1961-1994.

⁹ *Spartanburg Herald Journal*, 13 May 1992.

United States Department of the Interior
National Park Service

**National Register of Historic Places
Continuation Sheet**

Section number 9 Page 10

Alexander House
Name of Property
Spartanburg County, South Carolina
County and State

SELECT BIBLIOGRAPHICAL REFERENCES

Spartanburg County Register of Mesne Conveyance, Spartanburg County Courthouse,
Spartanburg, S.C. Spartanburg County Deed Books 4D, 4G, 4L, 8L, CC, II, MM, X, Z, ZZZ.

Fretwell, Francis Pearre. *Alexander and McCants Geneology*. Spartanburg, S.C.: Published
by the Author, 1980.

Hill's Greenville City Directory (Richmond, Va.: Hill Directory Company), 1896-97, 1901-02.

Hill's Spartanburg City Directory (Richmond, Va.: Hill Directory Company), 1896-97, 1899, 1903-04,
1905-06, 1961-95.

Kline, W.S. *Spartanburg of Today*. Spartanburg, S.C.: Band and White, 1904.

Rich, Peggy Burton. *Alexander Families of Upper South Carolina*. Clemson, S.C.: Published
by the Author, 1988.

Spartanburg Herald Journal (Spartanburg, S.C.), 4 January 1933, 11 September 1961,
26 January 1990, 13 May 1992.

Wells, John E., and Robert E. Dalton. *The South Carolina Architects 1885-1935: A Biographical
Dictionary*. Richmond, Va.: New South Architectural Press, 1992.

Alexander House
Name of Property

Spartanburg County, South Carolina
County and State

10. Geographical Data

Acreeage of Property Less than one acre

UTM References

(Place additional UTM references on a continuation sheet)

Zone Easting Northing	Zone Easting Northing
1 <u>17 415577 3867783</u>	3 _____
2 _____	4 _____

___ See continuation sheet.

Verbal Boundary Description (Describe the boundaries of the property on a continuation sheet.)

Boundary Justification (Explain why the boundaries were selected on a continuation sheet.)

11. Form Prepared By

name/title Susan and Jennie Sease [with assistance from SHPO Staff]
 organization _____ date 8 July 2002
 street & number 319 East Main Street telephone (864) 415-3814
 city or town Spartanburg state SC zip code 29306

Additional Documentation

Submit the following items with the completed form:

Continuation Sheets

Maps

- A USGS map (7.5 or 15 minute series) indicating the property's location.
- A sketch map for historic districts and properties having large acreage or numerous resources.

Photographs

Representative **black and white** photographs of the property.

Additional items

(Check with the SHPO or FPO for any additional items)

Property Owner

(Complete this item at the request of the SHPO or FPO.)

name Susan Phillips Sease
 street & number 319 East Main Street telephone (864) 415-3814
 city or town Spartanburg state SC zip code 29306

Paperwork Reduction Act Statement: This information is being collected for applications to the National Register of Historic Places to nominate properties for listing or determine eligibility for listing, to list properties, and to amend existing listings. Response to this request is required to obtain a benefit in accordance with the National Historic Preservation Act, as amended (16 U.S.C. 470 et seq.). **Estimated Burden Statement:** Public reporting burden for this form is estimated to average 18.1 hours per response including the time for reviewing instructions, gathering and maintaining data, and completing and reviewing the form. Direct comments regarding this burden estimate or any aspect of this form to the Chief, Administrative Services Division, National Park Service, P.O. Box 37127, Washington, DC 20013-7127; and the Office of Management and Budget, Paperwork Reductions Project (1024-0018), Washington, DC 20503.

**United States Department of the Interior
National Park Service**

**National Register of Historic Places
Continuation Sheet**

Section number 10 Page 11

Alexander House
Name of Property
Spartanburg County, South Carolina
County and State

VERBAL BOUNDARY DESCRIPTION:

The boundary of the nomination is shown as the black line marked "Alexander Music" on the accompanying Spartanburg County Tax Map 7-12-11, Parcel 111, drawn at a scale of 1" = 100'.

BOUNDARY JUSTIFICATION:

The nominated property includes the historic urban lot as it has existed since 1902.

**United States Department of the Interior
National Park Service**

**National Register of Historic Places
Continuation Sheet**

Section number Photographs Page 12 Alexander House
Name of Property
Spartanburg County, South Carolina
County and State

The following information is the same for each of the photographs:

Name of Property: Alexander House
Location of Property: 319 East Main Street
Spartanburg
Spartanburg County, South Carolina

Name of Photographer: Martin Meek
Date of Photographs: 30 January 2002
Location of Original Negatives: S.C. Department of Archives & History, Columbia, S.C.

1. Streetscape
2. North and East Elevations
3. North Elevation
4. North Elevation
5. North Elevation, Porch Detail
6. First Floor Porch, Main Entrance
7. West Elevation
8. Eastern Porch Elevation
9. East Elevation, Side Entrance
10. East Elevation
11. South Elevation
12. South Elevation
13. First Floor Entry Doors
14. Front Hall
15. Stairway
16. Parlor
17. Dining Room, Original Gaslight Fixture
18. First Floor, Back Stairway
19. Second Floor, Stairway Landing
20. Second Floor Hall
21. Second Floor Hall
22. Second Floor, Northwest Bedroom
23. Second Floor, Northeast Bedroom
24. Second Floor, Southeast Bedroom, Mantel Detail

**United States Department of the Interior
National Park Service**

**National Register of Historic Places
Continuation Sheet**

Section number _____ Page _____

SUPPLEMENTARY LISTING RECORD

NRIS Reference Number: 03000205

Property Name: Alexander House

County: Spartanburg State: South Carolina

none
Multiple Name

This property is listed in the National Register of Historic Places in accordance with the attached nomination documentation subject to the following exceptions, exclusions, or amendments, notwithstanding the National Park Service certification included in the nomination documentation.

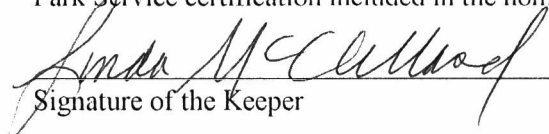
Signature of the Keeper

April 11, 2003
Date of Action

Amended Items in Nomination:

Section 8: Significance

“Criterion B,” the corresponding Area of Significance for “Commerce,” and the entry for Significant Person are hereby dropped because the nomination documentation does not support eligibility for association with Alonzo Marshall Alexander. His ownership from 1907 to 1933 and role in preserving the home’s original grandeur and architectural design however are recognized in the Period of Significance, which extends from the date of construction in 1904 to Alexander’s death in 1933. “1933” is, however, hereby dropped from Significant Dates to be consistent with the property’s documented significance in architecture.

The South Carolina Historic Preservation Office was notified of this amendment.

DISTRIBUTION:

- National Register property file
- Nominating Authority (without nomination attachment)

UNITED STATES DEPARTMENT OF THE INTERIOR
NATIONAL PARK SERVICE

NATIONAL REGISTER OF HISTORIC PLACES
EVALUATION/RETURN SHEET

REQUESTED ACTION: NOMINATION

PROPERTY NAME: Alexander House

MULTIPLE NAME:

STATE & COUNTY: SOUTH CAROLINA, Spartanburg

DATE RECEIVED: 2/26/03 DATE OF PENDING LIST: 3/14/03
DATE OF 16TH DAY: 3/30/03 DATE OF 45TH DAY: 4/12/03
DATE OF WEEKLY LIST:

REFERENCE NUMBER: 03000205

REASONS FOR REVIEW:

APPEAL: N DATA PROBLEM: N LANDSCAPE: N LESS THAN 50 YEARS: N
OTHER: N PDIL: N PERIOD: N PROGRAM UNAPPROVED: N
REQUEST: N SAMPLE: N SLR DRAFT: Y NATIONAL: N

COMMENT WAIVER: N

ACCEPT RETURN REJECT DATE

ABSTRACT/SUMMARY COMMENTS:

Outstanding example of Neo-classical (1904) residential architecture in Spartanburg. Although the nomination claims eligibility under Criterion B also for association with prominent merchant who lived here 1904-1933, the documentation fails to detail his accomplishments or contributions to local commercial development. Many items need to be added.

RECOM./CRITERIA Accept C

REVIEWER K McClelland

DISCIPLINE History

TELEPHONE 202-354-7258

DATE 4/11/03

DOCUMENTATION see attached comments Y/N see attached SLR (Y/N)

See ser. P.O.S. is OK to enter through 1933. Since Alexander was responsible for main turning house in its original grand style.





Bekue
Chiropractic

CONTACT POSSIBLE

SPRING HILLS
583-1001
1001 10th St





APR 19 1981
10 11 12 13 14 15 16 17 18 19 20 21 22 23 24 25 26 27 28 29 30 31







































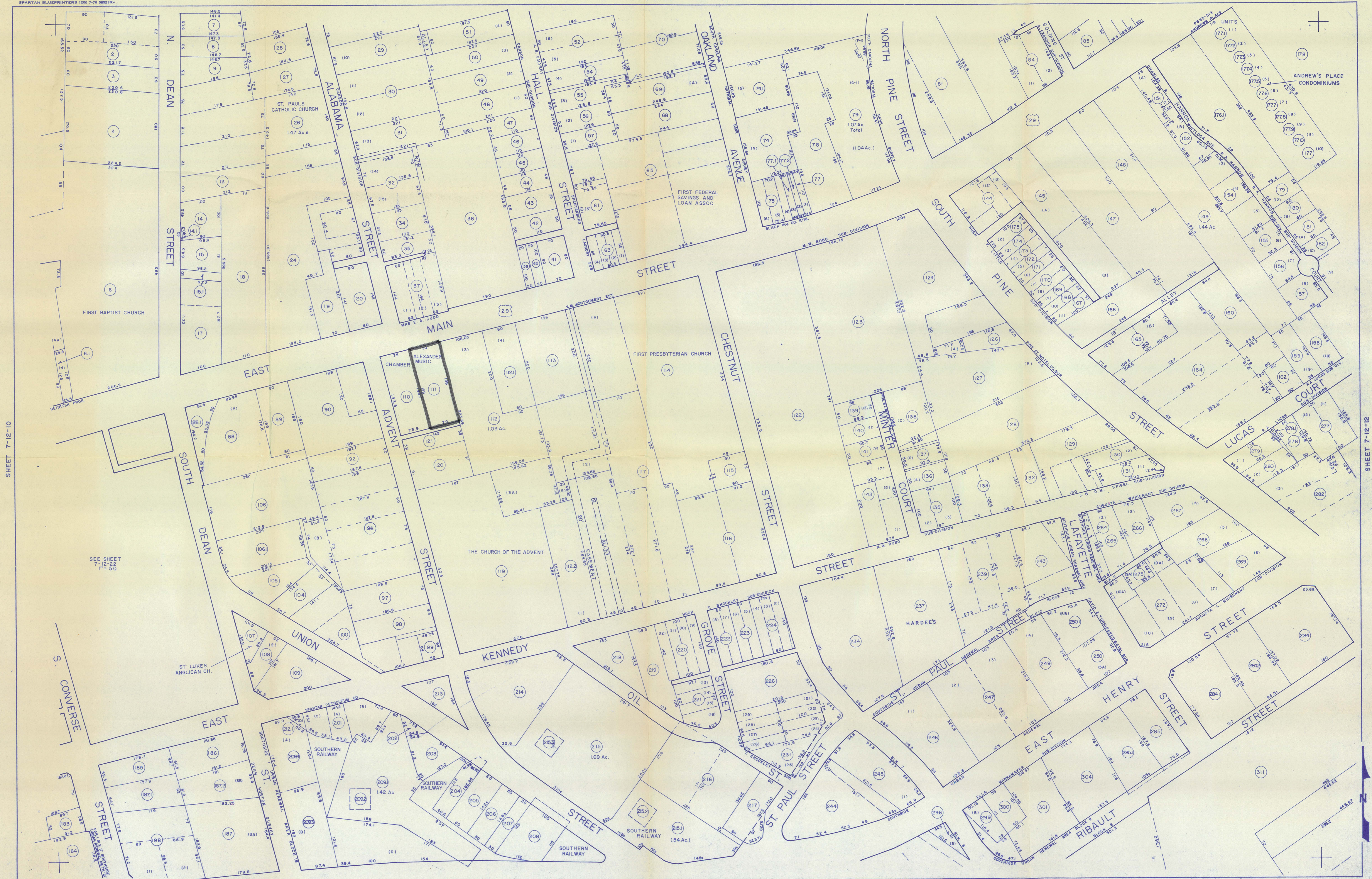

SHEET 7-12-10

SHEET 7-12-12

SEE SHEET 7-12-22

SCALE 1 INCH = 100 FEET

BASE MAP COMPILED BY PHOTOGRAMMETRIC METHODS-DATE OF PHOTOGRAPHY MARCH 1965
 PROPERTY DATA FROM DEED RESEARCH, FIELD RECONNAISSANCE, AND RECORDED PLATS
 SHEET LAYOUT BASED ON THE SOUTH CAROLINA LAMBERT GRID SYSTEM

LEGEND			
	County line		Map parcel number
	Corporation line		Original lot number
	District line (school)		Map scaled dimension
	District line (water, fire, or sewer)		Denotes some owner
	Original lot line		



ALEXANDER HOUSE
17/415577/3967793

PRODUCED BY THE UNITED STATES GEOLOGICAL SURVEY CONTROL BY USGS, NOS/NOAA, AND SOUTH CAROLINA GEODETIC SURVEY COMPILED FROM AERIAL PHOTOGRAPHS TAKEN 1976 FIELD CHECKED 1977. MAP EDITED 1983 PROJECTION LAMBERT CONFORMAL CONIC GRID: 100-METER UNIVERSAL TRANSVERSE MERCATOR ZONE 17 10,000-FOOT STATE GRID TICKS SOUTH CAROLINA, NORTH ZONE UTM GRID DECLINATION 03°22' WEST 1983 MAGNETIC NORTH DECLINATION 4° WEST VERTICAL DATUM NATIONAL GEODETIC VERTICAL DATUM OF 1929 HORIZONTAL DATUM 1927 NORTH AMERICAN DATUM To place on the predicted North American Datum of 1983, move the projection lines as shown by dashed corner ticks (10 meters west and 15 meters south). There may be private inholdings within the boundaries of any Federal and State Reservations shown on this map. Gray tint indicates area in which selected buildings are shown.

PROVISIONAL MAP
Produced from original manuscript drawings. Information shown as of date of field check.

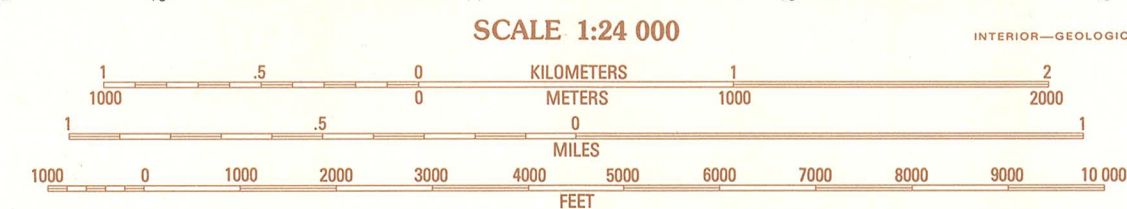

SCALE 1:24 000
CONTOUR INTERVAL 3 METERS
CONTROL ELEVATIONS SHOWN TO THE NEAREST 0.1 METER
OTHER ELEVATIONS SHOWN TO THE NEAREST METER.
To convert meters to feet multiply by 3.2808
To convert feet to meters multiply by .3048

THIS MAP COMPLIES WITH NATIONAL MAP ACCURACY STANDARDS
FOR SALE BY U.S. GEOLOGICAL SURVEY, RESTON, VIRGINIA 22092

QUADRANGLE LOCATION

1	2	3	1 Inman
			2 Valley Falls
			3 Coupens
4	5	6	4 Wellford
			5 Parcelot
			6 Reidville
6	7	8	7 Moore
			8 Glenn Springs

ADJOINING 7.5' QUADRANGLE NAMES

CONTOURS AND ELEVATIONS IN METERS
ROAD LEGEND

Improved Road
Unimproved Road
Trail
Interstate Route U.S. Route State Route

SPARTANBURG, S. C.
PROVISIONAL EDITION 1983

34081-H8-TM-024





Tuesday, 18 February 2003

Ms. Carol D. Shull
Keeper, National Register of Historic Places
United States Department of the Interior
National Park Service
National Register, History and Education
National Register of Historic Places
800 North Capitol Street, N.W., Suite 400
Washington, D.C. 20002

Dear Carol:

Enclosed are the National Register nominations for the Alexander House, in Greenville County, and the Union Downtown Historic District (Boundary Increase) in Union County, South Carolina. These nominations were approved by the South Carolina State Board of Review last year and we are now submitting them for formal listing in the Register.

If I may be of further assistance, please do not hesitate to contact me at the address below, call me at (803) 896-6182, fax me at (803) 896-6167, or e-mail me at POWER@scdah.state.sc.us. I hope to hear from you soon.

Sincerely,

A handwritten signature in cursive script, appearing to read "J. Tracy Power", is positioned above the typed name.

J. Tracy Power
Historian
State Historic Preservation Office