

**PENNSYLVANIA HISTORIC RESOURCE SURVEY FORM**  
 OFFICE OF HISTORIC PRESERVATION Box 1026  
 PA HISTORICAL & MUSEUM COMMISSION Harrisburg, PA 17120

7. Local survey organization  
 West Whiteland Historical Commission

8. property owners name and address  
 Lynda Petrov  
 1311 Grove Road  
 West Chester, PA 19380

9. tax parcel number / other number  
 41-8-162

10. U.T.M. zone 118 easting 41416101010  
 Map# 55 northing 44271170

11. status (other surveys, lists etc.)  
 CCHSS

usgs sheet: Unionville 1.466A

12. classification  
 site ( ) structure ( ) object ( )  
 building (X)  
 in N.R. district yes ( ) no ( )

13. date(s) (how determined)

14. period  
 1700-1799

15. style, design or folk type  
 Additive Vernacular

19. original use  
 Residence-farm

20. present use  
 Residence-non-farm

16. architect or engineer

17. contractor or builder

18. primary building mat. construction  
 Stone/Frame

21. condition  
 Average

22. integrity  
 Average

23. site plan with north arrow

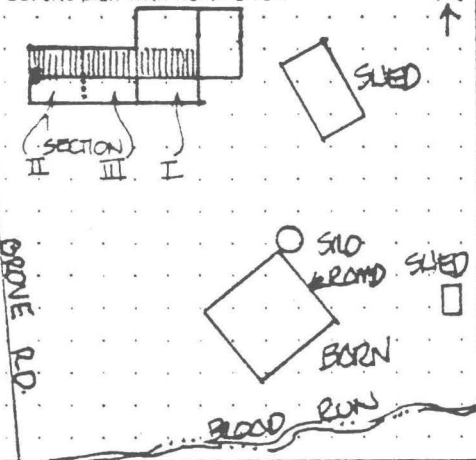

24. photo notation

PG: John Ronayne  
 PV: NW Elevation  
 PD: 11/1981

25. file/location  
 CCHS, #09-73, #18A

26. brief description (note unusual features, integrity, environment, streets and associated buildings)

The Hoffman House is located along Grove Road and faces south within the small valley drained by Broad Run. George Hoffman's 1772 purchase of 275 acres in the southwestern portion of the Township came to be known as the Barren Ridges and Hoffman's Barrens, indicating it was relatively poor, hilly land. Consisting of, at present, five sections four of which are stone, the Hoffman House and associated agricultural buildings nevertheless bespeak a prosperous past. The Hoffman House is a fine example of an additive, vernacular dwelling and is of particular interest for the manner in which it grew. From the 1798 and 1799 tax lists it is apparent that George Hoffman, first settler, had built a two-story, stone (16'x20') house with attached one-story log (16'x18') kitchen. He also had a log barn ("in bad repair") and a wheelwright-workshop. Despite the allegation that the homestead was "razed," an examination of the existing structure indicated it was, rather, incorporated into the body of the house (see Section I). It was originally 2 low stories with just 1 window (6/6,3/3) on each level. Section I's dimensions (Cont'd)

(continue on back if necessary)

27. history, significance and/or background

Exploration/Settlement: The Hoffman House was the homestead of first settler George Hoffman and home to his descendants until 1902. George Hoffman had emigrated from Germany, served as a teamster under General Braddock during the French and Indian War (1755), and finally settled in West Whiteland in 1772 where he purchased 275 acres of ground from Evans Jones and built a house. Hoffman was highly regarded in his day and, upon his death in 1829, it was noted that he was one of the chief founders of the Methodist Church in Chester County. In addition, he was important to the

(continue on back if necessary)

28. sources of information

CCHS: West Whiteland Clipping File - Lands: AR 1-5-1830,  
 VR 1-13-1830  
 A. P. Reid Title Search #138

29. prepared by:  
 Brandywine Cons.  
 M. L. Wolf

30. date . . . revision(s)

1. County  
 Chester  
 5. present name  
 George Hoffman House

2. municipality  
 West Whiteland  
 6. other name (historic name if any)  
 (George Hoffman House)

3. street address or specific location  
 1311 Grove Road.

4. survey code  
 029-09-41-170



#26 Cont'd...

approximate 16'x20', its interior features are 18th century, and its roof obviously has been raised. To the north of Section I is an old kitchen with cooking fireplace and evidence of a bake oven; this probably replaced the earlier log kitchen. The kitchen has no foundation but steps contain old stone steps (concealed beneath the floor) which lead to the cellar of Section I. The westernmost part of the Hoffman House likely was built next (Section II) circa 1805. It is stone with prominent quoins, 16'x22', a two-bay Penn Plan, and underlain by a cellar featuring niches, an arched fireplace support, and log joists. The chimney is entirely stone. A narrow passage leads from the cellar of Section II to the ground level kitchen of Section I. There is no direct access from the cellar of Section II to that of I or to any of III, the 18'x22' stone center portion of the house. This area, built in the mid-19th century, provides the house with a center hall and a wide stairway of two flights. Sections I, II, and III have a common roofline and show pegged rafters marked with roman numerals; between Sections I and III, however, there exist the remains of a pointed-stone wall, indicating that the roof of Section I originally was lower. To the east of Section I is a frame addition (c.1900) containing present-day cooking facilities. Associated buildings include a banked, double-decker stone barn, corn crib, and many old foundations.

#27 Cont'd...

development of the Grove crossroad village. His son, Benjamin, purchased the homestead, left it to his brother's son, George, and it then descended through George's line. In 1883, it was regarded as "one of the most beautiful farms in West Whiteland." It was a dairy farm which shipped to the Philadelphia market.

Architecture: Architecturally, as stated above, the Hoffman House is a representative example of an additive vernacular dwelling and is particularly noteworthy for its external integrity and unity. The unusual progression of additions is of extreme interest and apparently unique to the Township. Hoffman was a German and this particular building could be the southernmost evidence of German occupation in Chester County.

West Whiteland Township, Chester County, Pennsylvania  
Multiple Resource Nomination

Survey Code 029-09-41-170      Page 3  
George Hoffman House          Map #55

Summary Statement of Significance:

The Hoffman House is eligible for listing under criterion C as an example of an eighteenth and nineteenth century vernacular dwelling that was expanded from its original one room plan to a long narrow house by 1900.

Additional Photographs:



PG: J. RONAYNE  
PV: SOUTH VIEW  
PD: 11/1981  
LOCATION: WWHC #09-73-16

West Whiteland Township,  
Chester County, PA  
Multiple Resource Nomination  
Survey Code 029-09-41-170  
George Hoffman House Map #55

This Deed,

Between LYNDA PETROV and JUAN CARLOS SOLER, Co-Partners doing business as  
King Street Traders

(hereinafter called the "Grantor"),

of the one part, and LYNDA PETROV, Individually,

(hereinafter called the "Grantee"), of the other part.

Witnesseth, That in consideration of Eighteen Thousand (\$18,000.00)

in hand paid, the receipt whereof is hereby acknowledged, the said Grantor do hereby grant and convey unto the said Grantee, her heirs, successors, and assigns.

ALL THAT CERTAIN lot or piece of ground, with the buildings and improvements thereon erected, hereditaments and appurtenances, Situate in the Township of West Whiteland, County of Chester and State of Pennsylvania, bounded and described according to a Map and Plan made for Henry M. Waltz, by Edgar Laub, Registered Surveyor, Coatesville, Pa., dated 12-1-1967 as follows, to wit:-

BEGINNING at an iron pin in the title line in the bed of the West Chester and Grove Road marking a corner of this and in line of land now or late of the Philadelphia Electric Company (as shown on said Plan); thence extending from said beginning point, along the title line in the bed of the West Chester and Grove Road, the 2 following courses and distances: (1) North 32 degrees, 5 minutes, 4 seconds West, 52.47 feet to an iron pin; and (2) North 21 degrees, 5 minutes 44 seconds West, 303.5 feet to a tack marking a corner of land now or late of Highland Glen, Section No. 5; thence extending along the same the 2 following courses and distances: (1) North 84 degrees, 55 minutes, 45 seconds East, 180.3 feet to an iron pin; and (2) South 63 degrees, 12 minutes, 15 seconds East, 195.66 feet to an iron pin in line of land now or late of the Philadelphia Electric Company; thence extending along the same South 40 degrees, 22 minutes, 57 seconds West, 335.15 feet to the first mentioned iron pin and place of beginning.

CONTAINING 1.466 acres of land, be the same more or less.

BEING the same premises which Henry M. Waltz and Laura Waltz, his wife, by Deed dated the 6th day of October A.D. 1976 and duly recorded at West Chester, in the Office for the Recording of Deeds, in and for the County of Chester, in Deed Book L-49 page 224, granted and conveyed unto Lynda Petrov and Juan Carlos Soler, in fee.

MUNICIPAL TRANSFER TAX  
PAID IN AMOUNT OF \$ 180.00

ELVA M. MCGUEN

COLL 9

NATIONAL REGISTER OF HISTORIC PLACES  
EVALUATION/RETURN SHEET

Hoffman, George, House (West Whiteland  
Township MRA)  
Chester County  
PENNSYLVANIA

Substantive Review

Working No. SEP 29 1983

Fed. Reg. Date: \_\_\_\_\_

Date Due: 10/28/83 - 11/13/83

Action: ACCEPT

RETURN 11/10/83

REJECT \_\_\_\_\_

Federal Agency: \_\_\_\_\_

- resubmission
- nomination by person or local government
- owner objection
- appeal

Substantive Review:  sample  request  appeal  NR decision

Reviewer's comments:

*PLEASE DESCRIBE AND EVALUATE ALL  
OF THE FEATURES WITHIN THE  
NOMINATED AREA*

Recom./Criteria Return

Reviewer Mark Brown

Discipline Arch.

Date 11/10/83

\_\_\_\_\_ see continuation sheet

Nomination returned for:  technical corrections cited below  
 substantive reasons discussed below

1. Name

2. Location

3. Classification

|          |                    |            |             |
|----------|--------------------|------------|-------------|
| Category | Ownership          | Status     | Present Use |
|          | Public Acquisition | Accessible |             |

4. Owner of Property

5. Location of Legal Description

6. Representation in Existing Surveys

Has this property been determined eligible?  yes  no

7. Description

|                                    |                                       |   |
|------------------------------------|---------------------------------------|---|
| Condition                          | Check one                             | Check one                                 |
| <input type="checkbox"/> excellent | <input type="checkbox"/> deteriorated | <input type="checkbox"/> unaltered        |
| <input type="checkbox"/> good      | <input type="checkbox"/> ruins        | <input type="checkbox"/> altered          |
| <input type="checkbox"/> fair      | <input type="checkbox"/> unexposed    | <input type="checkbox"/> original site    |
|                                    |                                       | <input type="checkbox"/> moved date _____ |

Describe the present and original (if known) physical appearance

- summary paragraph
- completeness
- clarity
- alterations/integrity
- dates
- boundary selection

---

**8. Significance**

Period \_\_\_\_\_ Areas of Significance—Check and justify below

Specific dates \_\_\_\_\_ Builder/Architect \_\_\_\_\_

Statement of Significance (*in one paragraph*)

- summary paragraph
- completeness
- clarity
- applicable criteria
- justification of areas checked
- relating significance to the resource
- context
- relationship of integrity to significance
- justification of exception
- other

---

**9. Major Bibliographical References**

---

**10. Geographical Data**

Acreage of nominated property \_\_\_\_\_

Quadrangle name \_\_\_\_\_

UTM References \_\_\_\_\_

---

Verbal boundary description and justification \_\_\_\_\_

---

**11. Form Prepared By**

---

**12. State Historic Preservation Officer Certification**

The evaluated significance of this property within the state is:

\_\_\_\_ national      \_\_\_\_ state      \_\_\_\_ local

State Historic Preservation Officer signature \_\_\_\_\_

title \_\_\_\_\_ date \_\_\_\_\_

---

**13. Other**

- Maps
- Photographs
- Other

Questions concerning this nomination may be directed to \_\_\_\_\_

Signed  Date 11/10/83 Phone: \_\_\_\_\_

United States Department of the Interior  
National Park Service

**National Register of Historic Places  
Inventory—Nomination Form**

West Whiteland Township, Chester County, PA MRA  
Continuation sheet Item number

For NPS use only  
received  
date entered

Page

Survey Code 029-09-41-170  
George Hoffman House

Page 4  
Map#55

The nominated acreage consists of all land currently associated with the resource. Also present on the site are a twentieth century 1 story, stuccoed stone stable/workshop with a shed roof, a recently built 1 ½ story, banked, frame workshop constructed on an old stone foundation and a large stone and frame barn rebuilt in 1920. The foundations of several silos remain to the north of the barn. None of the above features contribute to the significance of the main house.

United States Department of the Interior  
National Park Service

National Register of Historic Places  
Inventory—Nomination Form

For NPS use only

received

date entered

SEP 29 1983

Continuation sheet

Item number

Page 2 of 6

Multiple Resource Area  
Thematic Group

Name West Whiteland Township Multiple Resource Area  
State Chester County, PENNSYLVANIA

Nomination/Type of Review

Date/Signature

- 11. Everhart, William, House **Substantive Review** Keeper Bruce Lee Dwyer 8/2/83  
Attest \_\_\_\_\_
- 12. Exton Hotel **Substantive Review** Keeper Bruce Lee Dwyer 11/10/83  
Attest \_\_\_\_\_
- 13. Fox Chase Inn **Substantive Review** Keeper Bruce Lee Dwyer 9/6/84  
Attest \_\_\_\_\_
- 14. Greenwood School **Substantive Review** Keeper Bruce Lee Dwyer 11/10/83  
Attest \_\_\_\_\_
- 15. Grove Historic District **Substantive Review** Keeper Bruce Lee Dwyer 8/2/84  
Attest \_\_\_\_\_
- 16. Halfway House **Substantive Review** **Determined Eligible** Keeper Bruce Lee Dwyer 11/10/83  
**DOE/OWNER OBJECTION**  
Attest \_\_\_\_\_
- 17. Hoffman, George, House **Substantive Review** Keeper Bruce Lee Dwyer 8/2/84  
Attest \_\_\_\_\_
- 18. Jacobs, Benjamin, House **Substantive Review** Keeper Bruce Lee Dwyer 8/2/84  
Attest \_\_\_\_\_
- 19. Kennedy, Francis W., House **Substantive Review** Keeper Bruce Lee Dwyer 8/2/84  
Attest \_\_\_\_\_
- 20. Kinbawn **Substantive Review** Keeper Bruce Lee Dwyer 9/6/84  
Attest \_\_\_\_\_

NATIONAL REGISTER OF HISTORIC PLACES  
EVALUATION/RETURN SHEET

Hoffman, George, House (West Whiteland  
Township MRA)  
Chester County  
PENNSYLVANIA

Substantive Review 9/29/83  
Working No. 2.5.85  
Fed. Reg. Date: 8/2/84  
Date Due: 8-2-84  
Action:  ACCEPT 8-2-84  
 RETURN  
 REJECT  
Federal Agency: \_\_\_\_\_

- resubmission
- nomination by person or local government
- owner objection
- appeal

Substantive Review:  sample  request  appeal  NR decision

Reviewer's comments:

Recom./Criteria Accept ✓  
Reviewer [Signature]  
Discipline A.H.  
Date 8.2.84  
\_\_\_\_\_ see continuation sheet

Nomination returned for: \_\_\_\_\_ technical corrections cited below  
\_\_\_\_\_ substantive reasons discussed below

1. Name

2. Location

3. Classification

|          |                    |            |             |
|----------|--------------------|------------|-------------|
| Category | Ownership          | Status     | Present Use |
|          | Public Acquisition | Accessible |             |

4. Owner of Property

5. Location of Legal Description

6. Representation in Existing Surveys

Has this property been determined eligible?  yes  no

7. Description

|                                    |                                       |   |
|------------------------------------|---------------------------------------|---|
| Condition                          | Check one                             | Check one                                 |
| <input type="checkbox"/> excellent | <input type="checkbox"/> deteriorated | <input type="checkbox"/> original site    |
| <input type="checkbox"/> good      | <input type="checkbox"/> ruins        | <input type="checkbox"/> moved date _____ |
| <input type="checkbox"/> fair      | <input type="checkbox"/> unexposed    |   |
|                                    | <input type="checkbox"/> unaltered    |   |
|                                    | <input type="checkbox"/> altered      |   |

Describe the present and original (if known) physical appearance

- summary paragraph
- completeness
- clarity
- alterations/integrity
- dates
- boundary selection

---

**8. Significance**

Period      Areas of Significance—Check and justify below

Specific dates                      Builder/Architect  
Statement of Significance (*in one paragraph*)

- summary paragraph
- completeness
- clarity
- applicable criteria
- justification of areas checked
- relating significance to the resource
- context
- relationship of integrity to significance
- justification of exception
- other

---

**9. Major Bibliographical References**

---

**10. Geographical Data**

Acreage of nominated property \_\_\_\_\_  
Quadrangle name \_\_\_\_\_  
UTM References \_\_\_\_\_

---

Verbal boundary description and justification

---

**11. Form Prepared By**

---

**12. State Historic Preservation Officer Certification**

The evaluated significance of this property within the state is:

\_\_\_\_ national      \_\_\_\_ state      \_\_\_\_ local

State Historic Preservation Officer signature

title                      date

---

**13. Other**

- Maps
- Photographs
- Other

Questions concerning this nomination may be directed to \_\_\_\_\_

Signed \_\_\_\_\_ Date \_\_\_\_\_ Phone: \_\_\_\_\_

SEP 20 1983

PENNSYLVANIA HISTORIC RESOURCE SURVEY FORM  
OFFICE OF HISTORIC PRESERVATION Box 1026  
PA HISTORICAL & MUSEUM COMMISSION Harrisburg, PA 17120

7. Local survey organization  
West Whiteland Historical Commission

8. property owners name and address  
Lynda Petrov  
1311 Grove Road  
West Chester, PA 19380

9. tax parcel number / other number  
41-8-162  
10. U.T.M. zone 118 easting 41416101010  
Map# 55 northing 442711710  
usgs sheet: Unionville 1466A

12. classification  
site ( ) structure ( ) object ( )  
building (X)  
in N.R. district yes ( ) no ( )

13. date(s) (how determined)  
14. period  
1700-1799

15. style, design or folk type  
Additive Vernacular

19. original use  
Residence-farm  
20. present use  
Residence-non-farm

16. architect or engineer

17. contractor or builder

18. primary building mat./construction  
Stone/Frame

21. condition  
Average  
22. integrity  
Average

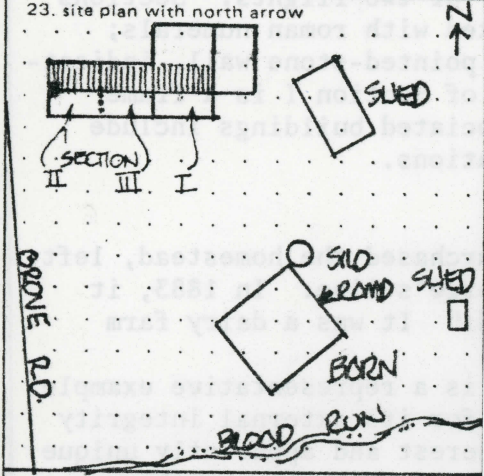

24. photo notation  
PG: John Ronayne  
PV: NW Elevation  
PD: 11/1981

25. file/location  
CCHS, #09-73, #18A

26. brief description (note unusual features, integrity, environment, threats and associated settings)  
The Hoffman House is located along Grove Road and faces south within the small valley drained by Broad Run. George Hoffman's 1772 purchase of 275 acres in the southwestern portion of the Township came to be known as the Barren Ridges and Hoffman's Barrens, indicating it was relatively poor, hilly land. Consisting of, at present, five sections four of which are stone, the Hoffman House and associated agricultural buildings nevertheless bespeak a prosperous past. The Hoffman House is a fine example of an additive, vernacular dwelling and is of particular interest for the manner in which it grew. From the 1798 and 1799 tax lists it is apparent that George Hoffman, first settler, had built a two-story, stone (16'x20') house with attached one-story log (16'x18') kitchen. He also had a log barn ("in bad repair") and a wheelwright-workshop. Despite the allegation that the homestead was "razed," an examination of the existing structure indicated it was, rather, incorporated into the body of the house (see Section I). It was originally 2 low stories with just 1 window (6/6,3/3) on each level. Section I's dimensions (Cont'd)

(continue on back if necessary)

27. history, significance and/or background  
Exploration/Settlement: The Hoffman House was the homestead of first settler George Hoffman and home to his descendants until 1902. George Hoffman had emigrated from Germany, served as a teamster under General Braddock during the French and Indian War (1755), and finally settled in West Whiteland in 1772 where he purchased 275 acres of ground from Evans Jones and built a house. Hoffman was highly regarded in his day and, upon his death in 1829, it was noted that he was one of the chief founders of the Methodist Church in Chester County. In addition, he was important to the

(continue on back if necessary)

28. sources of information  
CCHS: West Whiteland Clipping File - Lands: AR 1-5-1830,  
VR 1-13-1830  
A. P. Reid Title Search #138

29. prepared by:  
Brandywine Cons.  
M. L. Wolf  
30. date 12/1981 revision(s)

(continue on back if necessary)

1. County Chester  
2. municipality West Whiteland  
3. street address or specific location 1311 Grove Road  
4. survey code 029-09-41-170  
5. present name George Hoffman House  
6. other name (historic name if any) George Hoffman House

#26 Cont'd...

approximate 16'x20', its interior features are 18th century, and its roof obviously has been raised. To the north of Section I is an old kitchen with cooking fireplace and evidence of a bake oven; this probably replaced the earlier log kitchen. The kitchen has no foundation but does contain old stone steps (concealed beneath the floor) which lead to the cellar of Section I. The westernmost part of the Hoffman House likely was built next (Section II) circa 1805. It is stone with prominent quoins, 16'x22', a two-bay Penn Plan, and underlain by a cellar featuring niches, an arched fireplace support, and log joists. The chimney is entirely stone. A narrow passage leads from the cellar of Section II to the ground level kitchen of Section I. There is no direct access from the cellar of Section II to that of I or to any of III, the 18'x22' stone center portion of the house. This area, built in the mid-19th century, provides the house with a center hall and a wide stairway of two flights. Sections I, II, and III have a common roofline and show pegged rafters marked with roman numerals; between Sections I and III, however, there exist the remains of a pointed-stone wall, indicating that the roof of Section I originally was lower. To the east of Section I is a frame addition (c.1900) containing present-day cooking facilities. Associated buildings include a banked, double-decker stone barn, corn crib, and many old foundations.

#27 Cont'd...

development of the Grove crossroad village. His son, Benjamin, purchased the homestead, left it to his brother's son, George, and it then descended through George's line. In 1883, it was regarded as "one of the most beautiful farms in West Whiteland." It was a dairy farm which shipped to the Philadelphia market.

Architecture: Architecturally, as stated above, the Hoffman House is a representative example of an additive vernacular dwelling and is particularly noteworthy for its external integrity and unity. The unusual progression of additions is of extreme interest and apparently unique to the Township. Hoffman was a German and this particular building could be the southernmost evidence of German occupation in Chester County.

EVALUATION

EVALUATOR(S)

SEP 29 1983

West Whiteland Township, Chester County, Pennsylvania  
Multiple Resource Nomination

Survey Code 029-09-41-170      Page 3  
George Hoffman House      Map #55

Summary Statement of Significance:

The Hoffman House is eligible for listing under criterion C as an example of an eighteenth and nineteenth century vernacular dwelling that was expanded from its original one room plan to a long narrow house by 1900.

Additional Photographs:



PG: J. RONAYNE

PV: SOUTH VIEW

PD: 11/1981

LOCATION: WWHC #09-73-16

West Whiteland Township,  
Chester County, PA  
Multiple Resource Nomination  
Survey Code 029-09-41-170  
George Hoffman House Map #55

This Deed,

Between, LYNDA PETROV and JUAN CARLOS SOLER, Co-Partners doing business as  
King Street Traders

(hereinafter called the "Grantor")

of the one part, and LYNDA PETROV, Individually,

(hereinafter called the "Grantee"), of the other part

Witnesseth, That in consideration of Eighteen Thousand (\$18,000.00)

in hand paid, the receipt whereof is hereby acknowledged, the said Grantor do hereby grant and convey unto the said Grantee, her heirs, successors, and assigns, Dollars

ALL THAT CERTAIN lot or piece of ground, with the buildings and improvements thereon erected, hereditaments and appurtenances, Situate in the Township of West Whiteland, County of Chester and State of Pennsylvania, bounded and described according to a Map and Plan made for Henry N. Waltz, by Edgar Laub, Registered Surveyor, Coatesville, Pa., dated 12-1-1967 as follows, to wit:-

BEGINNING at an iron pin in the title line in the bed of the West Chester and Grove Road marking a corner of this and in line of land now or late of the Philadelphia Electric Company (as shown on said Plan); thence extending from said beginning point, along the title line in the bed of the West Chester and Grove Road, the 2 following courses and distances: (1) North 32 degrees, 5 minutes, 4 seconds West, 52.47 feet to an iron pin; and (2) North 21 degrees, 5 minutes 44 seconds West, 303.5 feet to a tack marking a corner of land now or late of Highland Glen, Section No. 5; thence extending along the same the 2 following courses and distances: (1) North 84 degrees, 56 minutes, 45 seconds East, 180.3 feet to an iron pin; and (2) South 63 degrees, 12 minutes, 15 seconds East, 195.66 feet to an iron pin in line of land now or late of the Philadelphia Electric Company; thence extending along the same South 40 degrees, 22 minutes, 57 seconds West, 335.15 feet to the first mentioned iron pin and place of beginning.

CONTAINING 1.466 acres of land, be the same more or less.

BEING the same premises which Henry N. Waltz and Laura Waltz, his wife, by Deed dated the 6th day of October A.D. 1976 and duly recorded at West Chester, in the Office for the Recording of Deeds, in and for the County of Chester, in Deed Book L-49 page 224, granted and conveyed unto Lynda Petrov and Juan Carlos Soler, in fee.

MUNICIPAL TRANSFER TAX  
PAID IN AMOUNT OF \$ 180.00

ELVA M. McQUEEN

COLL 8

Please refer to the map in the  
Multiple Property Cover Sheet  
for this property

Multiple Property Cover Sheet Reference Number: 64000736