

**United States Department of the Interior  
Heritage Conservation and Recreation Service**

**National Register of Historic Places  
Inventory—Nomination Form**

See instructions in *How to Complete National Register Forms*  
Type all entries—complete applicable sections

For HCRS use only

received MAR 24 1980

date entered JUN 27 1980

## 1. Name

historic Hibshman Farm

and/or common Schantz Farm

## 2. Location

street &amp; number Springville Road \_\_\_\_\_ not for publication

city, town Ephrata Township \_\_\_\_\_ vicinity of \_\_\_\_\_ congressional district 16

state Pennsylvania code 42 county Lancaster code 071

## 3. Classification

Category	Ownership	Status	Present Use	
<input checked="" type="checkbox"/> district	<input type="checkbox"/> public	<input checked="" type="checkbox"/> occupied	<input checked="" type="checkbox"/> agriculture	<input type="checkbox"/> museum
<input checked="" type="checkbox"/> building(s)	<input checked="" type="checkbox"/> private	<input type="checkbox"/> unoccupied	<input type="checkbox"/> commercial	<input type="checkbox"/> park
<input type="checkbox"/> structure	<input type="checkbox"/> both	<input type="checkbox"/> work in progress	<input type="checkbox"/> educational	<input checked="" type="checkbox"/> private residence
<input type="checkbox"/> site	<b>Public Acquisition</b>	<b>Accessible</b>	<input type="checkbox"/> entertainment	<input type="checkbox"/> religious
<input type="checkbox"/> object	<input type="checkbox"/> in process	<input type="checkbox"/> yes: restricted	<input type="checkbox"/> government	<input type="checkbox"/> scientific
	<input type="checkbox"/> being considered	<input type="checkbox"/> yes: unrestricted	<input type="checkbox"/> industrial	<input type="checkbox"/> transportation
		<input checked="" type="checkbox"/> no	<input type="checkbox"/> military	<input type="checkbox"/> other:

## 4. Owner of Property

name Dr. &amp; Mrs. Paul S. Schantz

street &amp; number R.D. #1, Ephrata Twp., Springville Road

city, town Ephrata \_\_\_\_\_ vicinity of \_\_\_\_\_ state Pennsylvania 17522

## 5. Location of Legal Description

courthouse, registry of deeds, etc. Lancaster County Courthouse

street &amp; number 42 Duke Street

city, town Lancaster \_\_\_\_\_ state Pennsylvania

## 6. Representation in Existing Surveys

title Pennsylvania Inventory of Historic Places \_\_\_\_\_ has this property been determined eligible?  yes  no

date March 26, 1979 \_\_\_\_\_  federal  state  county  local

depository for survey records Pennsylvania Historical and Museum Commission

city, town Harrisburg \_\_\_\_\_ state Pennsylvania

# 7. Description

**Condition**

excellent  
 good  
 fair

deteriorated  
 ruins  
 unexposed

**Check one**

unaltered  
 altered

**Check one**

original site  
 moved date \_\_\_\_\_

**Describe the present and original (if known) physical appearance**

The Hibschan Farm is a fine agricultural complex with representative farm structures from the late 18th Century to the early 20th Century. Included in the complex are the the original farm house with three sections, the wash house, stone barn, silo, tobacco shed, tobacco barn, garage, milk house, chicken house, brooder house, and a second farmhouse.

The Farmhouse: #1

The original farmhouse is made up of three sections. The first section was built c. 1750-60 and is a one and one-half story stone, gable roofed structure located to the rear of the main house today.

This back wing, containing a large walkin fireplace, could well date from sometime in the second half of the eighteenth century. Also possibly of a pre-1801 vintage is the very fine arched collar under about half of the front of the mansion section of the house. Although such arched collars were occasionally built in the first quarter of the nineteenth century, they were more prevalent in the eighteenth century. Hence, it seems at least plausible that these elements are remnants of a house of some stature built by the Hefflys, the parents of Mrs. Wendell Hibschan, in the 1760's. The second section, or main section was built in 1801 by Wendell and Hannah Hibschan. This can be noted on the datestone. The 1801 section is a large two and one-half story, stone, gable roofed house with a central hall.

Tradition states that the small, lower stone wing to the left of one looking at the facade was built for a spinster sister about 1803. This custom of building a separate room or wing for unmarried relatives was relatively widespread in the eighteenth and early nineteenth centuries.

It is likely that the decisions about the design, plan, and ornamentation of this most imposing house reflect a combination of the ideas of the Hibschmans and the various craftsmen were from the immediate vicinity. Although no documents are known to survive which could identify the joiners who executed the magnificent original interior woodwork, it seems probable that it might have been done by members of the Zartman family, who lived in the general area between Ephrata and Brickerville. The close relationship between the original interior woodwork of the Hibschan house and that of Zion Lutheran Church at Brickerville (known to have been done by the Zartmans) tends to support this supposition.

Although the Hibschmans were of Germanic lineage, it is notable that most of the features of the design, floor plan, and architectural ornament of their house represent English oriented taste. This is a striking illustration of the gradual adoption of English ways by the Germanic settlers in Pennsylvania. Specific features which relate to English, Georgian architecture include:

1. The symmetrical, five bay (five opening) facade with central doorway.
2. The center hall floor plan, with its generally symmetrical arrangement of rooms flanking the hall. In the eighteenth century, this floor plan with a central hall was called a "double house."

FOR HCRS USE ONLY  
RECEIVED MAR 24 1980  
DATE ENTERED JUN 27 1980

## NATIONAL REGISTER OF HISTORIC PLACES INVENTORY -- NOMINATION FORM

Hibshman Farm, Lancaster County

CONTINUATION SHEET

ITEM NUMBER 7 PAGE 2

3. All the superb original woodwork, which constitutes some of the most intact and sophisticated Georgian interior woodwork surviving in the county. Among the most notable elements of this woodwork are the three corner cupboards, the superb chimneybreast with pilasters, crossetted corner moldings, and dentils on the overmantel in the present dining room, the keystone arch supported on fluted pilasters in the hall, and the staircase. In the period of the house's construction, a handrail shaped like that in the Hibsman house would have been said to have "rampings and easings." Most likely, the design features in this woodwork were adapted from books published in England in the eighteenth century. A very likely source for some of the details here in Abraham Swan's The British Architect, first published in London in the mid 1740's.

Some other notable features about the interior of the Hibsman house include the following:

1. The rare survival, and very accurate restoration, of original paint colors;
2. The painting of the fireplace surround in the best bed chamber;
3. The great grained doors, which simulate mahogany with inlaid borders.
4. Stylistically, the interior of this house is closely related to very good Philadelphia interiors of the period 1760-1775. The date of this house (1801) suggests a marked degree of conservatism in the taste of the Hibsman and their local contemporaries.

Indeed, in terms of style, most of the woodwork of this house remains in the Georgian tradition, although the house itself was built in the Federal period. Only the following features suggest a transition to the new, Federal style:

- a. The relative slenderness of the stairway balusters.
- b. The diminutive scale of the dentils of the overmantel in the dining room.
- c. The style of graining of the doors, which imitates inlay. In other words, this corresponds to the method of ornamenting Federal period furniture (Hepplewhite and Sheraton) with inlays in contrasting woods.

FOR HCRS USE ONLY

RECEIVED MAR 24 1980

DATE ENTERED JUN 27 1980

**NATIONAL REGISTER OF HISTORIC PLACES  
INVENTORY -- NOMINATION FORM**

Hibshman Farm, Lancaster County

CONTINUATION SHEET

ITEM NUMBER 7 PAGE 3

Stone Barn: #2

Located to the east of the house is a large stone barn with cross-gable roof and frame forebay. To the rear is a modern silo.

This is one of the most intact and beautiful of all stone end barns surviving in Lancaster County. The use of native limestone and the local reddish sandstone on the gable end facing the house shows a rare sensitivity to the use of contrasting materials. In its general form and design, this barn represents the adaptation of Swiss and Germanic traditions to meet the needs of conditions in the New World. Also notable is the German datestone for Wendell and Hannah Hibschan in 1790.

Wash House: #3

Located to the rear of the c. 1750-60 section of the house is located a one and one-half story frame wash house.

Brooder House: #4

East of the stone barn is located a two and one-half story, gable-roof, frame brooder house built in 1950.

Tabacco Barn: #5

Located to the rear of the brooder house is a frame, gable roof, tabacco barn built in 1950.

Tabacco Shed: #6

This frame, gable-roof structure was built in 1900 and is located to the rear of the stone barn.

Chicken House: #7

Built in 1948, this large two and one half story frame chicken house is located to the rear of the main house.

Farmers House #8

The second farmhouse was built in 1955 as an additional farm residence.

# 8. Significance

Period	Areas of Significance—Check and justify below			
<input type="checkbox"/> prehistoric	<input type="checkbox"/> archeology-prehistoric	<input type="checkbox"/> community planning	<input type="checkbox"/> landscape architecture	<input type="checkbox"/> religion
<input type="checkbox"/> 1400-1499	<input type="checkbox"/> archeology-historic	<input type="checkbox"/> conservation	<input type="checkbox"/> law	<input type="checkbox"/> science
<input type="checkbox"/> 1500-1599	<input checked="" type="checkbox"/> agriculture	<input type="checkbox"/> economics	<input type="checkbox"/> literature	<input type="checkbox"/> sculpture
<input type="checkbox"/> 1600-1699	<input type="checkbox"/> architecture	<input type="checkbox"/> education	<input type="checkbox"/> military	<input type="checkbox"/> social/
<input type="checkbox"/> 1700-1799	<input type="checkbox"/> art	<input type="checkbox"/> engineering	<input type="checkbox"/> music	<input type="checkbox"/> humanitarian
<input checked="" type="checkbox"/> 1800-1899	<input type="checkbox"/> commerce	<input type="checkbox"/> exploration/settlement	<input type="checkbox"/> philosophy	<input type="checkbox"/> theater
<input checked="" type="checkbox"/> 1900-	<input type="checkbox"/> communications	<input type="checkbox"/> industry	<input type="checkbox"/> politics/government	<input type="checkbox"/> transportation
		<input type="checkbox"/> invention		<input type="checkbox"/> other (specify)

**Specific dates** \_\_\_\_\_ **Builder/Architect** \_\_\_\_\_

**Statement of Significance (in one paragraph)**

The Hibschanman farm is an excellent example of the family farm complex once common in Pennsylvania. The earliest sections of this farm date to the late 1700's and early 1800's. Wendell and Hannah Hibschanman built their home in 1801 and as successive generations inhabited the structure they added to it and the farm complex. The Hibschanman farm has been a general farm since the late 18th Century. Its 78 acres, part of the original tract, is still under cultivation and operated as a family farm. As the farm complex grew and the crops diversified the farm complex had to adapt. A larger dairly facility was added in 1943, and a new brooder house (to meet state requirements) was added in 1950. These additions were made to keep up with the needs and farming technology of the times so that the farm could continue to function as a truly working farm.

The farm continues the diversified crops, corn, wheat, barley, alfalfa and at times tobacco are still grown regularly. Crop rotation has long been a common practice in this area.

The old orchard property had pretty well died out except for a few trees but was replanted in 1945.

The significance of this complex lies in its continued existence as a working family farm. It acceptance and adaptation to new farming techniques has kept pace with progress but still retains the family farm concept.

# 9. Major Bibliographical References

Heineche. History of Ephrata, Vol IV. Historical Society of Cocalico Valley, Meginness, John F. Biographical Annals of Lancaster County, PA J. H. Beers & Co., 1903, P 735. (continued - see attached)

# 10. Geographical Data

**UTM NOT VERIFIED**

Acreege of nominated property 78

Quadrangle name Ephrata, Pa.

**ACREAGE NOT VERIFIED**

Quadrangle scale 1:24,000

### UMT References

A	<u>1</u> <u>8</u>	<u>4</u> <u>0</u> <u>0</u> <u>3</u> <u>4</u> <u>0</u>	<u>4</u> <u>4</u> <u>5</u> <u>1</u> <u>3</u> <u>2</u> <u>0</u>
	Zone	Easting	Northing

B	<u>1</u> <u>8</u>	<u>4</u> <u>0</u> <u>0</u> <u>6</u> <u>0</u> <u>0</u>	<u>4</u> <u>4</u> <u>5</u> <u>0</u> <u>7</u> <u>3</u> <u>0</u>
	Zone	Easting	Northing

C	<u>1</u> <u>8</u>	<u>4</u> <u>0</u> <u>0</u> <u>2</u> <u>4</u> <u>0</u>	<u>4</u> <u>4</u> <u>5</u> <u>0</u> <u>4</u> <u>6</u> <u>0</u>
---	-------------------	---	--

D	<u>1</u> <u>8</u>	<u>3</u> <u>9</u> <u>8</u> <u>9</u> <u>0</u> <u>0</u>	<u>4</u> <u>4</u> <u>5</u> <u>1</u> <u>1</u> <u>8</u> <u>0</u>
---	-------------------	---	--

E	<u> </u> <u> </u>	<u> </u> <u> </u> <u> </u> <u> </u> <u> </u> <u> </u>	<u> </u> <u> </u> <u> </u> <u> </u> <u> </u> <u> </u>
---	-------------------	---	---

F	<u> </u> <u> </u>	<u> </u> <u> </u> <u> </u> <u> </u> <u> </u> <u> </u>	<u> </u> <u> </u> <u> </u> <u> </u> <u> </u> <u> </u>
---	-------------------	---	---

G	<u> </u> <u> </u>	<u> </u> <u> </u> <u> </u> <u> </u> <u> </u> <u> </u>	<u> </u> <u> </u> <u> </u> <u> </u> <u> </u> <u> </u>
---	-------------------	---	---

H	<u> </u> <u> </u>	<u> </u> <u> </u> <u> </u> <u> </u> <u> </u> <u> </u>	<u> </u> <u> </u> <u> </u> <u> </u> <u> </u> <u> </u>
---	-------------------	---	---

### Verbal boundary description and justification

See Continuation Sheet

### List all states and counties for properties overlapping state or county boundaries

state	code	county	code
-------	------	--------	------

state	code	county	code
-------	------	--------	------

# 11. Form Prepared By

name/title Mary G. Schantz

organization R. D. #1, P. O. Box 515 date           

street & number Springville Road telephone           

city or town Ephrata state Pennsylvania 17522

# 12. State Historic Preservation Officer Certification

The evaluated significance of this property within the state is:

national     state     local

As the designated State Historic Preservation Officer for the National Historic Preservation Act of 1966 (Public Law 89-665), I hereby nominate this property for inclusion in the National Register and certify that it has been evaluated according to the criteria and procedures set forth by the Heritage Conservation and Recreation Service.

State Historic Preservation Officer signature Ed Weintraub

ED WEINTRAUB, Director

title Office of Historic Preservation date 3/10/80

For HCRS use only

I hereby certify that this property is included in the National Register

for Bruce M. Dwyer date 6-27-80  
Keeper of the National Register

Attest: William H. Brannon date 6-23-80  
Chief of Registration

FHR-8-300A  
(11/78)

UNITED STATES DEPARTMENT OF THE INTERIOR  
HERITAGE CONSERVATION AND RECREATION SERVICE

FOR HCRS USE ONLY

RECEIVED MAR 24 1980

DATE ENTERED

MAR 27 1980

**NATIONAL REGISTER OF HISTORIC PLACES  
INVENTORY -- NOMINATION FORM**

Hibshman Farm, Lancaster County

**CONTINUATION SHEET**

ITEM NUMBER 9 PAGE 2

Bridgens, H.F. Bridgens' Atlas of Lancaster County, Pa.  
Lancaster; D.S. Bare Publisher, 1864, p. 17.

Ellis, Franklin and Samuel Evans. History of Lancaster County, Pa.  
Philadelphia: Everts & Peck, 1883 p.834

FOR HCRS USE ONLY

RECEIVED MAR 24 1980

DATE ENTERED JUN 27

**NATIONAL REGISTER OF HISTORIC PLACES  
INVENTORY -- NOMINATION FORM**

Hibshman Farm

CONTINUATION SHEET

ITEM NUMBER 10 PAGE

Verbal boundary description and justification:

Purpart A

All That Certain lot or piece of land in the Township of Ephrata, County of Lancaster and State of Pennsylvania, together with the stone house, a stone and frame barn, frame tobacco shed, and other buildings thereon erected, more fully bounded and described as follows, to wit:

BEGINNING at a point, or sand stone, in the middle of the public road leading from Ephrata to Schoeneck, and a corner of land of Horace B. Rutt; thence by land of Horace B. Rutt, crossing an iron pin planted on the East side of the road, being sixteen and one-half (16 1/2) feet from the corner in the road, North eighty (80) degrees and forty-five (45) minutes East, fourteen hundred and nine and five-tenths (1,409.5) feet to a stake; thence by land of Mahlon Redcay, South fifteen (15) degrees and forty (40) minutes East, five hundred and thirty-five (535) feet to a sand stone on the North side of a public road leading from Lincoln to Stevens; thence by land of the same, South twenty-six (26) degrees and forty-three (43) minutes East, fifteen hundred fifty-three and two-tenths (1,553.2) feet to the middle of the public road leading from Ephrata to Stevens; thence along in said road by lands of Clayton Zimmerman and A. L. Gerhart, respectively, South fifty-eight (58) degrees and ten (10) minutes West, fourteen hundred eighty (1,480) feet to a point in the road; thence by land of A. L. Gerhart, South sixty-six (66) degrees and forty (40) minutes West, ninety-nine (99) feet to a point in the intersection of the roads; thence along the middle of the first mentioned public road by lands of Moses Kurtz, Henry Martin, Springville Mennonite Church and Horace B. Rutt, respectively, North nineteen (19) degrees and twenty-six (26) minutes West, twenty-six hundred fifty-three and five tenths (2,653.5) feet to the place of Beginning.

CONTAINING seventy-eight (78) acres and four (4) perches as per survey made April 16, 1943, by D. G. Ranck, Registered Surveyor, of Bareville, Pennsylvania.

Hibshman Farm  
Lancaster County  
Floor plan of main house

JUN 27 1980

MAR 24 1980

TERRACE (WITH CANOPY)

1750-60



FIRST FLOOR PLAN OF HOUSE  
ON SCHANTZ FARM

SCALE: 1/8" = 1'

Hibshman Farm  
Lancaster County  
Map of farm complex

JUN 27 1980

MAR 24 1980

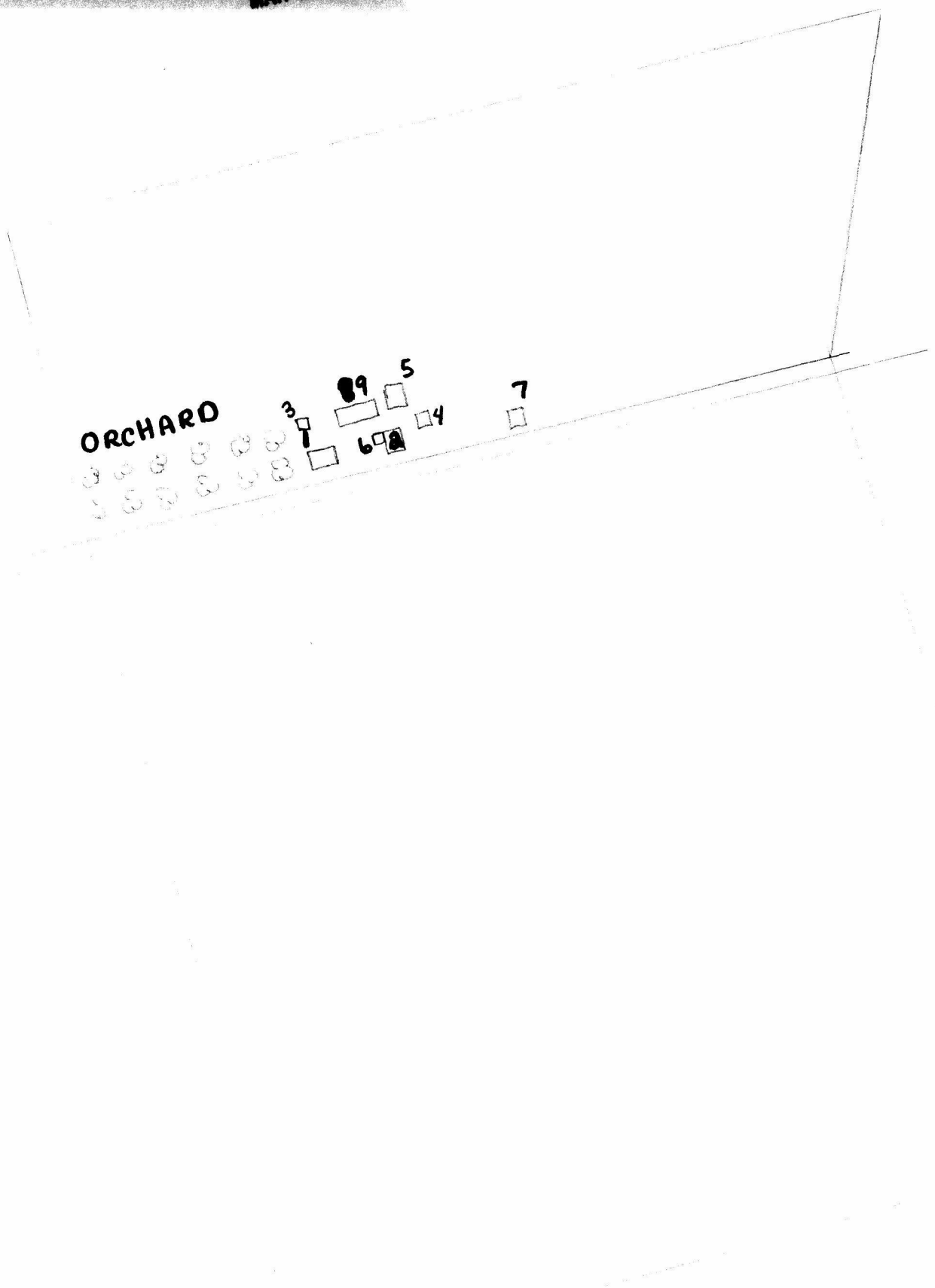

Property Hibshman Farm

80003513

State Pa - Lancaster

Working Number 3-24-80 960

**TECHNICAL**

**CONTROL**

Photos 4  
Maps     

**HISTORIAN**

*Intact farm complex  
significant for agriculture and architecture.  
House (in stone) was constructed in stages  
and reflects Georgian styling and detailing.  
The barn is a magnificent stone ended structure  
70 plus acres seems justified since still  
under agricultural cultivation.*

**ARCHITECTURAL HISTORIAN**

*accept  
Braham  
6-23-80*

**ARCHEOLOGIST**

**OTHER**

**HAER**

Inventory \_\_\_\_\_  
Review \_\_\_\_\_

**REVIEW UNIT CHIEF**

*accept  
Braham  
6-23-80*

**BRANCH CHIEF**

**KEEPER**

National Register Write-up \_\_\_\_\_  
Federal Register Entry 2.3.81

Send-back \_\_\_\_\_  
Re-submit \_\_\_\_\_

Entered JUN 23



*Aerial Photo*

Hibshman Farm  
Lancaster County

MAR 24 1980

PD: 1979

PC: Schantz

PV: aerial view of farm complex

JUN 27 1980

1/3



Hibshman Farm  
Lancaster County  
PD: 1979  
PC: Schantz  
PV: Barn #2/4

MAR 24 1980



JUN 27 1980

This barn was built  
by Wendell Hibshman &  
Hannah his wife in the  
year of Christ 1790

This inscription is (in German) is still readily  
legible on the stone just below the  
sunburst on the west side of barn  
Barn



Dining Room - Main House

Hibshman Farm  
Lancaster County

MAR 24 1980

PD: 1979

PC: Schantz

JUN 27 1980

PV: fireplace in diningroom

3/4



Ephrata Rebielski Photo  
50 East Main Street  
Ephrata, Pa. 17522

Hibshman Farm  
Lancaster County

PD: 1979

PC: Schantz

PV: front elevation of original  
farmhouse

MAR 24 1980

JUN 27 1980

4/4

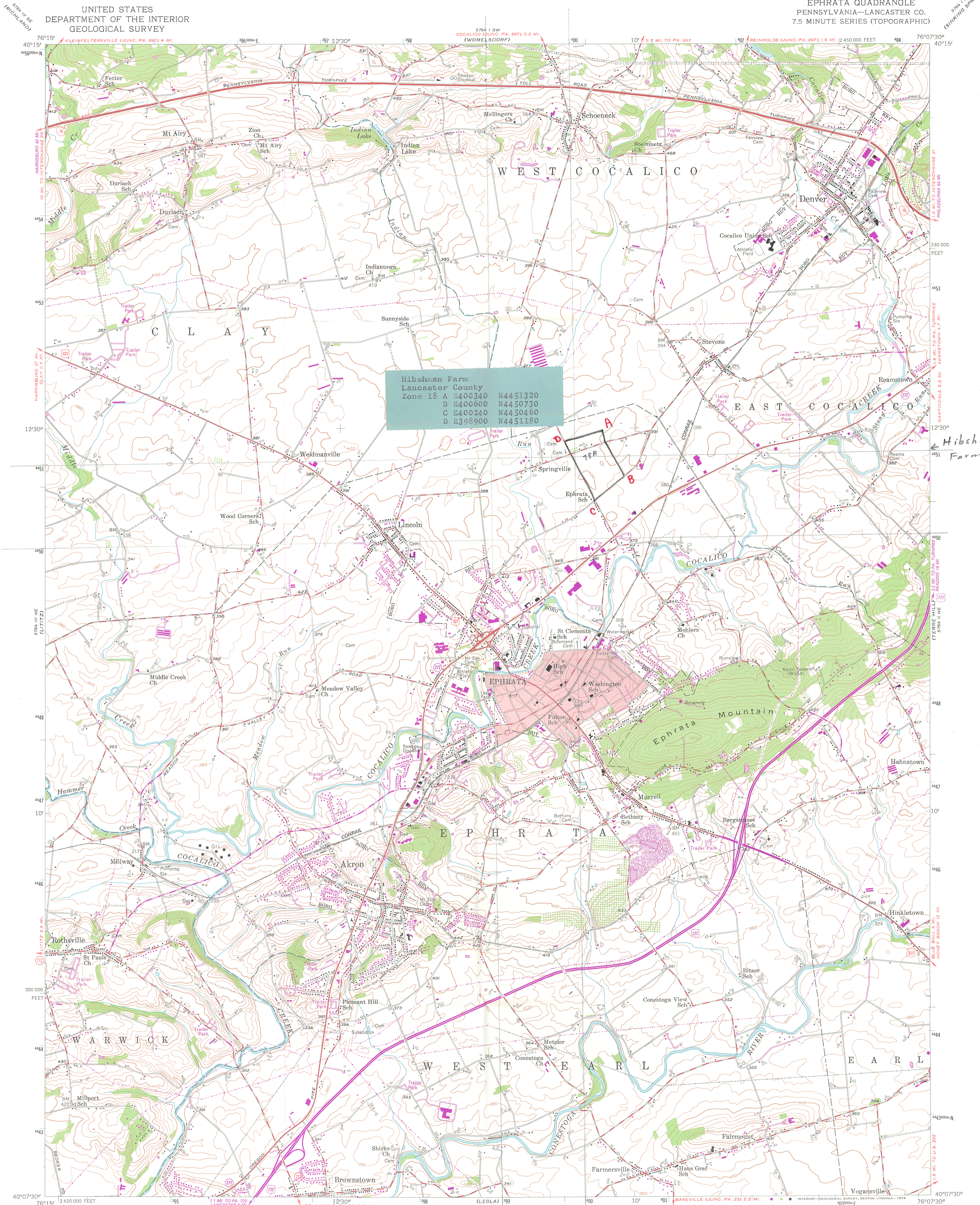

Mapped, edited, and published by the Geological Survey  
Control by USGS, USCGS, and USSCS  
Topography from aerial photographs by photogrammetric methods  
Aerial photographs taken 1951. Field check 1956  
Polyconic projection. 1927 North American datum  
10,000-foot grid based on Pennsylvania coordinate system,  
south zone  
Red-tint indicates area in which only  
landmark buildings are shown  
Unchecked elevations are shown in brown  
1000-meter Universal Transverse Mercator grid ticks,  
zone 18, shown in blue  
Revisions shown in purple compiled in cooperation with State of  
Pennsylvania agencies from aerial photographs taken 1969 and 1974.  
This information not field checked

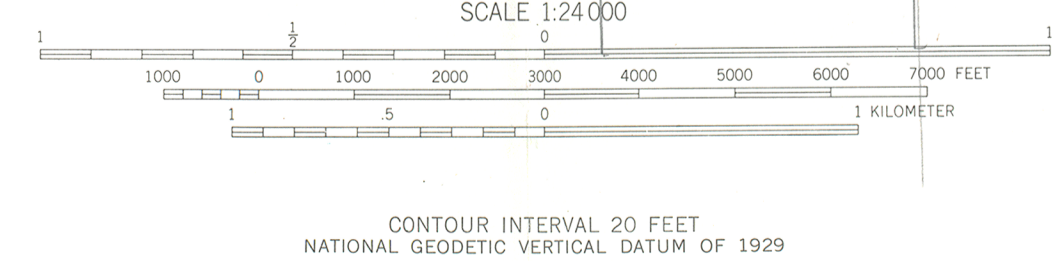
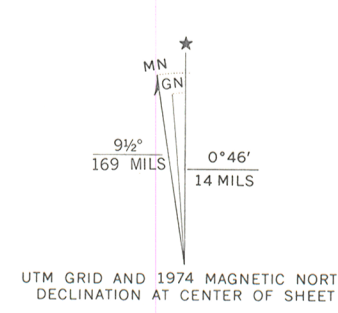

CONTOUR INTERVAL 20 FEET  
NATIONAL GEODETIC VERTICAL DATUM OF 1929

THIS MAP COMPLIES WITH NATIONAL MAP ACCURACY STANDARDS  
FOR SALE BY U.S. GEOLOGICAL SURVEY, RESTON, VIRGINIA 22092  
A FOLDER DESCRIBING TOPOGRAPHIC MAPS AND SYMBOLS IS AVAILABLE ON REQUEST



ROAD CLASSIFICATION  
Heavy-duty ——— Light-duty ———  
Medium-duty ——— Unimproved dirt ———  
U.S. Route ——— State Route ———  
Interstate Route ———  
EPHRATA, PA.  
N4007.5—W7607.5/7.5  
1956  
PHOTOREVISED 1969 AND 1974  
AMS 5764 II NW—SERIES V831

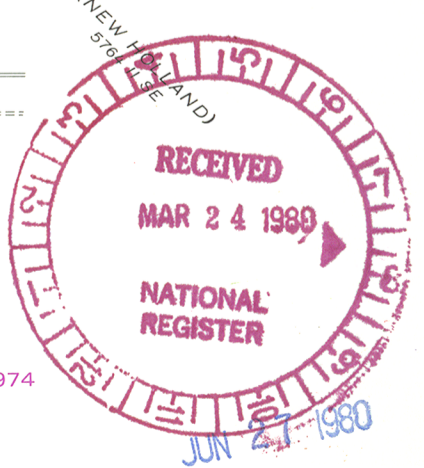

ENTRIES IN THE NATIONAL REGISTER

STATE      PENNSYLVANIA

Date Entered

JUN 27 1980

<u>Name</u>	<u>Location</u>
Tabor Reformed Church (United Church of Christ)	Lebanon Lebanon County
Dohner, Michael Farmhouse	Lancaster vicinity Lancaster County
Hibshman Farm	Ephrata Lancaster County
Kreider Shoe Manufacturing Company	Elizabethtown Lancaster County
Ashley and Bailey Silk Mill	Marietta Lancaster County

Also Notified

Honorable H. John Heinz, III  
Honorable Richard S. Schweiker  
Honorable Robert S. Walker

State Historic Preservation Officer  
Mr. Ed Weintraub  
Pennsylvania Historical and Museum  
Commission  
P.O. Box 1026  
Harrisburg, Pennsylvania 17120

NR

Byers/mjd      7/8/80

For further information, please call the National Register at (202)343-6401.