

UNITED STATES DEPARTMENT OF THE INTERIOR
NATIONAL PARK SERVICE

FOR NPS USE ONLY	
RECEIVED	FEB 25 1986
DATE ENTERED	APR 11 1986

**NATIONAL REGISTER OF HISTORIC PLACES
INVENTORY -- NOMINATION FORM**

DEPRESSION-ERA BUILDINGS

CONTINUATION SHEET

ITEM NUMBER

PAGE 1 of 3

NAME: Cascade Locks Work Center

LOCATION: Mt. Hood National Forest, Columbia Gorge Ranger District;
Congressional District 2; Cascade Locks, Oregon (41); Hood River
County (027)

ADDRESS: USDA Forest Service
Mt. Hood National Forest
2955 NW Division
Gresham, OR 97030

CLASSIFICATION/CATEGORY: Buildings

DESCRIPTION:

Condition

 x Excellent

D&E x Unaltered
C x Altered

 x Original Site

Columbia Gorge Work Center: Warehouse: 1936-38 Rectangular, 1 1/2 story, wood frame, poured concrete foundation, wood shingled medium hipped gable roof, eaves project, rafters exposed, three shed-roof dormers on north slope of roof. Six bays in length. Exterior walls on main facade and rear elevation, and dormer cheeks are wall shakes, ground level on east and west gable ends are broken-coursed rubble masonry, gable ends are vertical boards, battens every other board. Mullion windows, with two, three, and four divisions, single sash, of six, nine, and twelve lights on ground level; mullion windows with nine divisions of eight lights in vertical arrangements on each gable end. Single leaf two-panel doors with window panels are located to the right of the easterly most bay on the main facade, and offset to the left on the east gable end: five horizontal slide-opening vertical board vehicle doors, each with three 12-light windows, enclose the remaining five bays on the north (main) facade. Three well-shaped tree-logo cutouts in horizontal arrangement, are centered on each gable end. No apparent structural additions or alterations; no obvious material modifications.

Prevention Assistant's Residence: Rectangular, 1 1/2 story, wood frame, poured concrete foundation, split shake medium gable roof, eaves project, rafters exposed, verges project, fascia alone, supported by plain brackets, stretcher bond brick interior chimney, center of ridgeline, center gable porch on north (main) facade. Exterior walls are flush siding with end boards. Windows are

UNITED STATES DEPARTMENT OF THE INTERIOR
NATIONAL PARK SERVICE

FOR NPS USE ONLY

RECEIVED

DATE ENTERED

**NATIONAL REGISTER OF HISTORIC PLACES
INVENTORY -- NOMINATION FORM**

DEPRESSION-ERA BUILDINGS

CONTINUATION SHEET

ITEM NUMBER

PAGE 2 of 3

twenty-four light single sash on the main facade, and six light sash on gable ends and rear. Main entry is a single-leaf door, accessed by two straight steps and an open plank platform, at the center of the main facade. A hip roofed structural addition, clad with similar flush siding, abuts the west gable end. The large multi-light window to the right of the main door has been replaced with a single pane sash of smaller dimension. No decoration.

Gas House: Rectangular, 1 story, wood frame, poured concrete foundation, wood shingled medium gable roof. Exterior walls are covered with wood shingles. Windows are single sash with three lights in vertical placement. Main entry is slightly off-set to left on south (main) facade. Single leaf two-panel door with 12-light window is recessed in anterior wall: enclosure also protects gas pump. A horizontal slide opening vertical board door, centered in wall, is off-set to the right on the main facade: opening is elevated to facilitate loading. No apparent structural addition or alteration; no obvious material modification. No decoration.

SIGNIFICANCE:

The Cascade Locks Work Center typifies the construction projects undertaken by the Civilian Conservation Corps and signifies the aid to the local community provided by the emergency work-relief program through employment of youth and experienced craftsmen, purchase of building materials and camp supplies, and personal expenditures of enrollees. The property represents the Forest Service's presence in the locality, as the headquarters for field operation, and denotes, via the physical facilities required to carry out the agency's expanding responsibilities, the critical transition in the Service's development from custodial superintendence to extensive resource management. The Cascade Locks Work Center exemplifies the rustic architectural idiom developed by the Forest Service, Pacific Northwest Region, to impart Forest Service identity and to represent its purposes and ideals, and signifies the agency's particular interpretation of a singular expression of early twentieth century American architectural thought. Possessing superior qualities of design and execution, the Cascade Locks Warehouse is an outstanding example of an architectural location invested with special aesthetic and associative values by the agency that created it.

UNITED STATES DEPARTMENT OF THE INTERIOR
NATIONAL PARK SERVICE

**NATIONAL REGISTER OF HISTORIC PLACES
INVENTORY -- NOMINATION FORM**

FOR NPS USE ONLY

RECEIVED

DATE ENTERED

DEPRESSION-ERA BUILDINGS

CONTINUATION SHEET

ITEM NUMBER

PAGE 3 of 3

GEOGRAPHICAL DATA:

Acreage: 1.91+

UTM Reference:

<u>Point</u>	<u>Zone</u>	<u>Easting</u>	<u>Northing</u>
A	10	590058	5059147

VERBAL BOUNDARY DESCRIPTION:

The boundaries are delineated as follows: Beginning at the southwest corner of Section 5, Township 2 north, Range 8 east of the Willamette Meridian; thence north 63° east 4350 feet (calculated) to the northwest corner of the property, thence north 90° east 112 feet (calculated), thence north 47° 30' east 362 feet following the south side of the Old Columbia River Highway, thence south 49° east 160 feet, thence south 47° 30' west 408 feet, thence south 90° west 182 feet, thence north 0° east 148 feet to close on the northwest corner of the property. All bearings and distances are calculated and are subject to adjustment in actual field location. Area of the property is 1.91 acres, more or less.

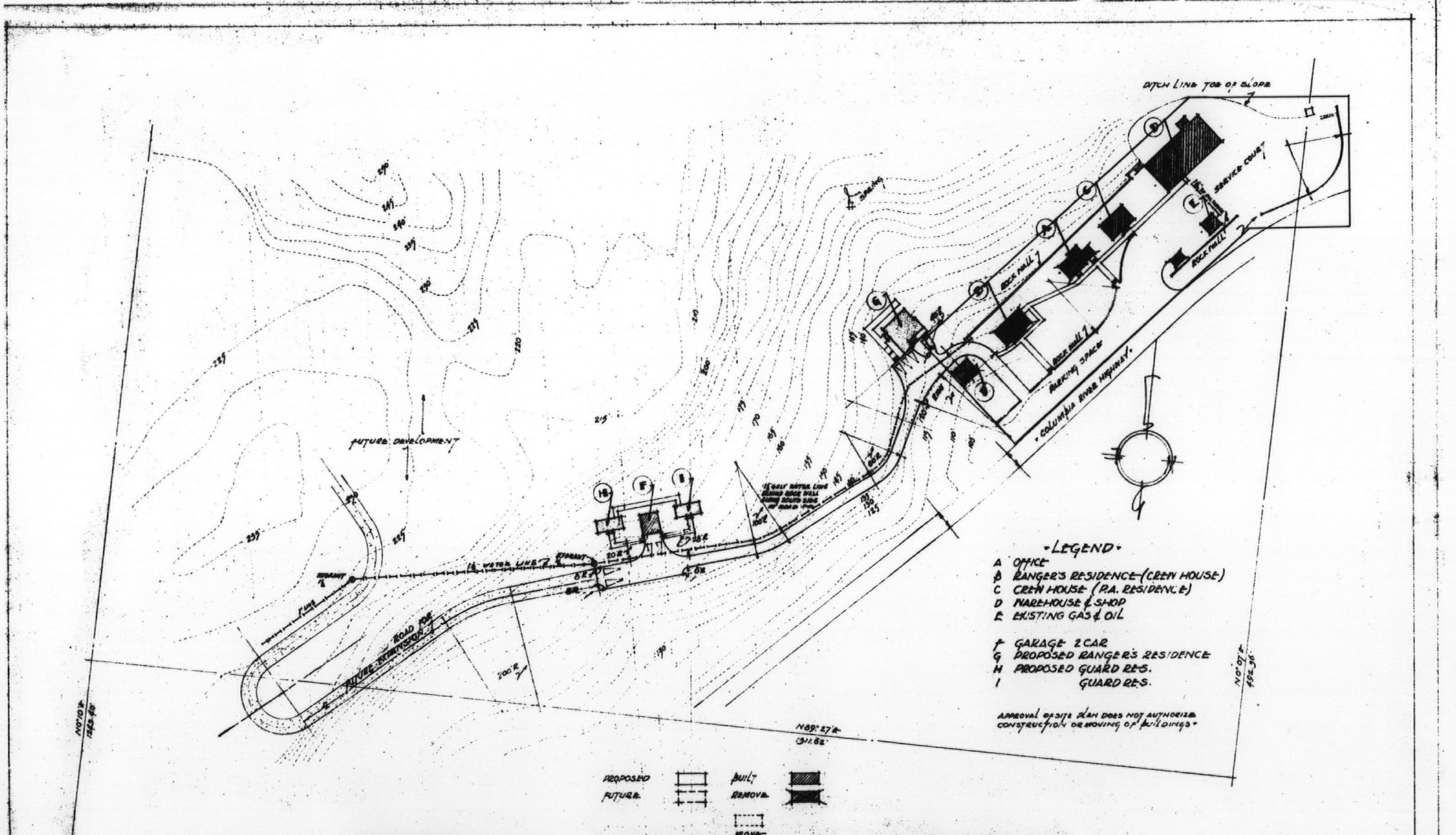

- LEGEND-**
- A OFFICE
 - B RANGER'S RESIDENCE (CREEN HOUSE)
 - C CREW HOUSE (P.A. RESIDENCE)
 - D WAREHOUSE (SHOP)
 - E EXISTING GAS & OIL
 - F GARAGE 2 CAR
 - G PROPOSED RANGER'S RESIDENCE
 - H PROPOSED GUARD RES.
 - I GUARD RES.



DRAWN A. HOSSE
 DRAWN A. HOSSE
 APPROVED [Signature] DATE 11/12/39
 APPROVED [Signature] DATE 7/16/39

U.S. DEPARTMENT OF AGRICULTURE
 FOREST SERVICE
 MT. HOOD NATIONAL FOREST
 NORTH PACIFIC REGION (REV) JAN 20 1939

SITE PLAN
 COLUMBIA GORGE N.G.
 SEC. 3, TEN. R.G.B.
 SCALE 1"=50'-00"

United States Department of the Interior
National Park Service

National Register of Historic Places
Inventory—Nomination Form

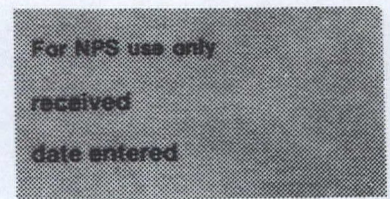

Continuation sheet

Item number

Page 3 of 3

Multiple Resource Area
Thematic Group

Name Depression--Era Buildings TR
State OREGON and WASHINGTON

Nomination/Type of Review

Date/Signature

- | | |
|---|--|
| <p>50 ✓ 21. Parkdale Ranger Station (OR)
<i>Substantive Review</i></p> | <p>✓ Keeper <u>[Signature]</u> 4/11/86
Attest <u>William B. Bushong</u> 4/8/86</p> |
| <p>50 ✓ 22. Cascade Locks Works Center (OR)
<i>Substantive Review</i></p> | <p>✓ Keeper <u>[Signature]</u> 4/11/86
Attest <u>William B. Bushong</u> 4/8/86</p> |
| <p>✓ 23. Lick Creek Guard Station (OR)
<i>Substantive Review</i></p> | <p>for Keeper <u>William B. Bushong</u> 4/8/86
Attest _____</p> |
| <p>50 ✓ 24. Unity Ranger Station (OR)
<i>Substantive Review</i></p> | <p>✓ Keeper <u>[Signature]</u> 4/11/86
Attest <u>William B. Bushong</u> 4/8/86</p> |
| <p>✓ 25. Diamond Lake Guard Station (OR)
<i>Substantive Review</i></p> | <p>Keeper <u>Return</u>
Attest _____</p> |
| <p>✓ 26. Cedar Guard Station No. 1019 (OR)
<i>Substantive Review</i></p> | <p>for Keeper <u>William B. Bushong</u> 4/8/86
Attest _____</p> |
| <p>✓ 27. Gold Beach Ranger Station (OR)
<i>Substantive Review</i></p> | <p>for Keeper <u>William B. Bushong</u> 4/8/86
Attest _____</p> |
| <p>50 ✓ 28. Glide Ranger Station (OR)
<i>Substantive Review</i></p> | <p>for Keeper <u>William B. Bushong</u> 4/8/86
Attest _____</p> |
| <p>29.</p> | <p>Keeper _____
Attest _____</p> |
| <p>30.</p> | <p>Keeper _____
Attest _____</p> |

less than 50 yrs.
86000829

NATIONAL REGISTER OF HISTORIC PLACES
EVALUATION/RETURN SHEET

Substantive Review

Cascade Locks Work Center (Depression-Era
Buildings TR)
Hood River County
OREGON

Working No. FEB 25 1986
Fed. Reg. Date: 2/3/87
Date Due: 3/27/86 → 4/11/86
Action: ACCEPT 4-11-86
 RETURN
 REJECT
Federal Agency: Forest Service

- resubmission
- nomination by person or local government
- owner objection
- appeal

Substantive Review: sample request appeal NR decision

Reviewer's comments:

*See comments
prepared for Keeper*

Recom./Criteria Accept A, C
Reviewer Bushong
Discipline Historical
Date 4/8/86
see continuation sheet

Nomination returned for: technical corrections cited below
 substantive reasons discussed below

1. Name

2. Location

3. Classification

Category	Ownership	Status	Present Use
	Public Acquisition	Accessible	

4. Owner of Property

5. Location of Legal Description

6. Representation in Existing Surveys

Has this property been determined eligible? yes no

7. Description

Condition	Check one	Check one
<input type="checkbox"/> excellent	<input type="checkbox"/> deteriorated	<input type="checkbox"/> original site
<input type="checkbox"/> good	<input type="checkbox"/> ruins	<input type="checkbox"/> moved date _____
<input type="checkbox"/> fair	<input type="checkbox"/> unexposed	
	<input type="checkbox"/> unaltered	
	<input type="checkbox"/> altered	

Describe the present and original (if known) physical appearance

- summary paragraph
- completeness
- clarity
- alterations/integrity
- dates
- boundary selection

8. Significance

Period Areas of Significance—Check and justify below

Specific dates Builder/Architect

Statement of Significance (*in one paragraph*)

- summary paragraph
- completeness
- clarity
- applicable criteria
- justification of areas checked
- relating significance to the resource
- context
- relationship of integrity to significance
- justification of exception
- other

9. Major Bibliographical References

10. Geographical Data

Acreage of nominated property _____

Quadrangle name _____

UTM References _____

Verbal boundary description and justification _____

11. Form Prepared By

12. State Historic Preservation Officer Certification

The evaluated significance of this property within the state is:

____ national ____ state ____ local

State Historic Preservation Officer signature

title

date

13. Other

- Maps
- Photographs
- Other

Questions concerning this nomination may be directed to _____

Signed _____ Date _____ Phone: _____



- 1) Name of Property: Cascade Locks (WC)--Warehouse
- 2) City and State: Cascade Locks, Oregon
- 3) Photographer: Susan Marvin
- 4) Date: 10/05/83
- 5) Negative Location: USDA Forest Service, Regional Office, Recreation Unit, CRM Files
- 6) Description: Looking southwest at left and main north-facing elevations
- 7) Photograph Number: 06-04-MHCGD-1



- 1) Name of Property: Cascade Locks (WC)--Warehouse
- 2) City and State: Cascade Locks, Oregon
- 3) Photographer: Susan Marvin
- 4) Date: 10/05/83
- 5) Negative Location: USDA Forest Service, Regional Office, Recreation Unit, CRM Files
- 6) Description: Looking east at main north-facing and right elevations
- 7) Photograph Number: 06-04-MHCGD-2



- 1) Name of Property: Cascade Locks (WC)--Protective Assistant's Residence
- 2) City and State: Cascade Locks, Oregon
- 3) Photographer: Susan Marvin
- 4) Date: 10/05/83
- 5) Negative Location: USDA Forest Service, Regional Office, Recreation Unit, CRM Files
- 6) Description: Looking east at main and right elevations.
- 7) Photograph Number: 06-04-MHCGC



Handwritten text on a sign or board leaning against the building, possibly indicating a name or address.

Small text above the doorway, possibly a name or address.



- 1) Name of Property: Cascade Locks (WC)--Gas and Oil House
- 2) City and State: Cascade Locks, Oregon
- 3) Photographer: Susan Marvin
- 4) Date: 10/05/83
- 5) Negative Location: USDA Forest Service, Regional Office, Recreation Unit, CRM Files
- 6) Description: Looking northwest at main elevation.
- 7) Photograph Number: 06-04-MHCGE



Mapped, edited, and published by the Geological Survey
Control by USGS and NOS/NOAA
Topography by photogrammetric methods from aerial
photographs taken 1973. Field checked 1974. Map edited 1979
Selected hydrographic data compiled from NOS/NOAA Chart 18531 (1977)
This information is not intended for navigational purposes
Projection: Oregon coordinate system, north zone
(Lambert conformal conic)
10,000-foot grid ticks based on Oregon coordinate system,
north zone and Washington coordinate system, south zone
1000-meter Universal Transverse Mercator grid, zone 10
1927 North American Datum
To place on the predicted North American Datum 1983
move the projection lines 22 meters north and
92 meters east as shown by dashed corner ticks
There may be private inholdings within the boundaries of
the National or State reservations shown on this map

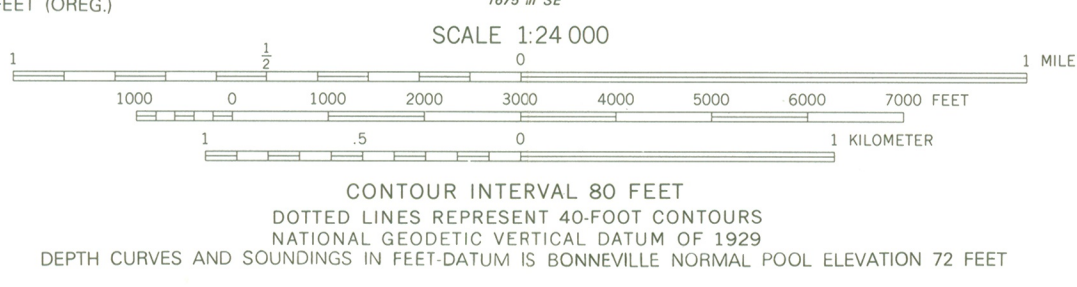
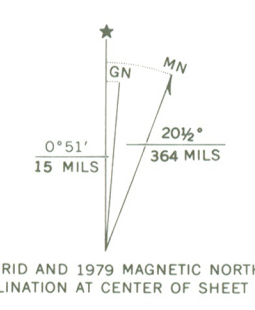

ROAD CLASSIFICATION

Primary highway, hard surface	Light-duty road, hard or improved surface
Secondary highway, hard surface	Unimproved road

○ Interstate Route □ U. S. Route ○ State Route

CARSON, WASH.-OREG.
NE/4 BONNEVILLE DAM 15' QUADRANGLE
N4537.5-W12145/7.5

1979
DMA 1675 III NE-SERIES V892

CASCADE LOCKS WORK CENTER
MT. HOOD NATIONAL FOREST
HOOD RIVER COUNTY, OREGON

<u>POINT</u>	<u>ZONE</u>	<u>EASTSIDE</u>	<u>NORTHING</u>
A	10	590058	5059147