

NPS Form 10-900
(Rev. 8-86)

OMB No. 1024-0018

United States Department of the Interior
National Park Service

RECEIVED
JAN 28 1993
NATIONAL REGISTER

NATIONAL REGISTER OF HISTORIC PLACES
REGISTRATION FORM

1. Name of Property

historic name: Gleason, Edmund Farm, (boundary increase)

other name/site number: NPS Tract# 123-03, List of Classified Structures
HS-403 - 407

2. Location

street & number: 7243 Canal Road

not for publication: N/A

city/town: Valley View

vicinity: x_

state: OH county: Cuyahoga

code: 035

zip code: 44125

3. Classification

Ownership of Property: public-Federal

Category of Property: district

Number of Resources within Property:

Contributing	Noncontributing	
<u> 5 </u>	<u> 1 </u>	buildings
<u> 2 </u>	<u> 1 </u>	sites
<u> 1 </u>	<u> 1 </u>	structures
<u> 8 </u>	<u> 2 </u>	objects
	<u> 2 </u>	Total

Number of contributing resources previously listed in the National Register: 2

Name of related multiple property listing: Agricultural Resources of Cuyahoga Valley

4. State/Federal Agency Certification

As the designated authority under the National Historic Preservation Act of 1986, as amended, I hereby certify that this X nomination request for determination of eligibility meets the documentation standards for registering properties in the National Register of Historic Places and meets the procedural and professional requirements set forth in 36 CFR Part 60. In my opinion, the property X meets does not meet the National Register Criteria. See continuation sheet.

Barbara Lane Signature of certifying official 12-21-92 Date

Ohio Historic Preservation Office State or Federal agency and bureau

In my opinion, the property X meets does not meet the National Register criteria. See continuation sheet.

Edith Beavers Signature of commenting or other official 1/22/93 Date

Cheff Hudson, National Park Service State or Federal agency and bureau

5. National Park Service Certification

I, hereby certify that this property is:

- entered in the National Register See continuation sheet.
- determined eligible for the National Register See continuation sheet.
- determined not eligible for the National Register
- removed from the National Register
- other (explain):

Beth L. Savage 3/12/93

BLS Signature of Keeper Date of Action

=====
6. Function or Use
=====

Historic: Domestic_____ Sub: single dwelling_____
Agricultural Subsistence_____ processing_____
Current : Vacant/Not in Use_____ Sub: _____

=====
7. Description
=====

Architectural Classification:

Greek Revival_____
Other_____

Other Description: Wisconsin Dairy Barn_____

Materials: foundation Stone_____ roof Asphalt_____
walls Stone_____ other Wood_____
Wood_____

Describe present and historic physical appearance. X See continuation sheet.

=====
8. Statement of Significance
=====

Certifying official has considered the significance of this property in relation to other properties: Locally .

Applicable National Register Criteria: A and C

Criteria Considerations (Exceptions) : N/A_____

Areas of Significance: Agriculture_____
Architecture_____

Period(s) of Significance: 1851-1930 _____

Significant Dates : 1851 1855 1905

Significant Person(s): N/A_____

JAN 28 1993

Cultural Affiliation: N/A_____

Architect/Builder: Unknown_____

State significance of property, and justify criteria, criteria considerations, and areas and periods of significance noted above.
 See continuation sheet.

=====

9. Major Bibliographical References

=====

See continuation sheet.

Previous documentation on file (NPS):

- preliminary determination of individual listing (36 CFR 67) has been requested.
- previously listed in the National Register
- previously determined eligible by the National Register
- designated a National Historic Landmark
- recorded by Historic American Buildings Survey # _____
- recorded by Historic American Engineering Record # _____

Primary Location of Additional Data:

- State historic preservation office
- Other state agency
- Federal agency
- Local government
- University
- Other -- Specify Repository: NPS\ Cuyahoga Valley NRA_____

=====
10. Geographical Data
=====

Acreage of Property: 13

UTM References: Zone Easting Northing Zone Easting Northing

A	17	448925	4579460	B	17	449420	4579130
C	17	448420	4579860	D	<u> </u>	<u> </u>	<u> </u>

 See continuation sheet.

Verbal Boundary Description: See continuation sheet.
Beginning at Point A on the sketch map proceed approximately 190' northeast to point B; thence 225' southeast to Point C; thence 190' north east to Point D; thence 225' southeast to Point E; thence 150' south across Tinker's Creek Road to Point F. Proceed east approximately 560' to Point G; thence south 375' to Point H. Follow the northern bank of Tinker's Creek to Point I, where the creek intersects with the eastern berm of Canal Road. From Point I proceed north to the starting point, Point A.

Boundary Justification: See continuation sheet.
The boundary for the nominated property encompass those resources historically related to the property that retain integrity.

=====
11. Form Prepared By
=====

Name/Title: Jeff Winstel, Historian/ Dean Dickerson, Historian

Organization: NPS/ Cuyahoga Valley NRA Date: 7/89, 5/92

Street & Number: 15610 Vaughn Road Telephone: 216/526-5256

City or Town: Brecksville State: OH_ ZIP: 44141

NPS Form 10-900-a
(8-86)

OMB Approval No. 1024-0018

United States Department of the Interior
National Park Service

NATIONAL REGISTER OF HISTORIC PLACES
CONTINUATION SHEET

Section number 7 Edmond Gleason Farm

Page 1

Edmond Gleason Farm
Valley View, Ohio
Cuyahoga County

The Edmond Gleason farm is situated along the valley wall overlooking the intersection of Canal Road, Tinkers Creek Road, Riverview Road, and the level floodplain of the Cuyahoga River. Tinkers Creek Road separates the house and buildings from the field that once produced corn and oats which fed Gleason's livestock and mills along the river. The farm consists of six buildings: the house, built for Edmund Gleason ca. 1854; a large Wisconsin Dairy Barn built in 1905 and a noncontributing garage built behind the house; and three outbuildings. The rail fence is considered a noncontributing structure because of its uncertain date and origin.

There are two outbuildings and one site located east of the barn. the two outbuildings are the granary and a shed, and the site is a barn foundation. Behind the barn is a corncrib and a poultry house. The field, located south of the buildings across Tinker's Creek Road, is historically associated with the property and considered a contributing site.

The house (NR 1979), situated on a knoll about one hundred yards northwest of the barn and outbuildings, is a two-story building of Greek Revival style interpreted in dressed sandstone. The shingled gable roof and wood spindle porch were added ca. 1880. Its side and rear windows feature stone sills and lintels while the front windows are of larger size, with acanthus leaf decorations. The facade, with its recessed entrance and tooled stonework, is particularly fine. A sandstone foundation supports the building. With the exception of the addition of dormer windows and a new end chimney, the house is little altered.

Located approximately one hundred yards southeast of the house at the bottom of the hill is the Gleason barn (NR 1979). Built in 1905, this large 2 1/2-story barn has an gambrel roof covered with corrugated sheet metal. Its exterior walls are vertical wood siding. The south side, facing Tinkers Creek Road, has a sheet metal, pent roof overhang running the full one-hundred and eight-foot length of the barn. The foundation of this structure is concrete. Numerous doors and windows line the facade wall under the pent roof. Four large hay doors are located above the pent roof and are flanked by two symmetrically spaced windows. The other side of the barn is banked into a hillside and contains two large tracked doors.

JAN 28 1993

NPS Form 10-900-a
(8-86)

OMB Approval No. 1024-0018

United States Department of the Interior
National Park Service

NATIONAL REGISTER OF HISTORIC PLACES
CONTINUATION SHEET

Section number 7 Edmond Gleason Farm

Page 2

=====

Edmond Gleason Farm
Valley View, Ohio
Cuyahoga County

Four outbuildings are located near the eastern end of the barn. The granary is a rectangular, gable-roofed structure with slat walls, a vertical plank door, a small gabled ventilator monitor astride the roof ridge, and rectangular openings under the eaves. The corncrib is located just to the rear of the northeastern corner of the barn. This structure has slanted slated walls, block piers, and two flat monitors on its shed roof. Both the granary and corncrib are elevated, preventing rodents access to the grain. The shed, is a small wooden structure with a gable roof, drop siding, endboards and plain window and door trim. The door is of vertical plank construction and there are two four light windows, one on each gable end.

Located approximately fifty yards east of the barn, and almost entirely hidden by brush and trees, is an old stone foundation approximately 60 by 40 ft. wide. Very little information about this structure is available. However, it appears to be the remnants of an old barn. Possibly this is the location of the first barn built on the Gleason farm. The foundation, and what is left of the basement walls, consists of stone and stone rubble. There is a large opening on the east end of the foundation which appears to be the principal entrance. Inside the foundation are several concrete stubs which, at one time, supported the main floor.

The second land parcel--Tract 4, Lot 8--is located across Tinkers Creek Road, to the southeast of the buildings. This parcel consists of 3.06 acres, making the combined acreage of the two parcels 13.5 acres. The only existing fence is a recently installed wood rail fence encompassing the northwest tip of the field. Although the fence is a noncontributing object, it does not distract from the visual appearance of the property. There are no additional fences on this smaller tract, but old property lines are distinguishable along tree lines to the south. Although now overtaken by sub-growth, it was here, on this bottom ground, where the Gleasons grew corn.

Although the attached photographs of the farm were taken more than 2 years ago, recent site inspection by park staff confirms that they depict the current condition of the resources.

JAN 28 1993

NPS Form 10-900-a
(8-86)

OMB Approval No. 1024-0018

United States Department of the Interior
National Park Service

NATIONAL REGISTER OF HISTORIC PLACES
CONTINUATION SHEET

Section number 8 Edmond Gleason Farm Page 3
=====

Edmond Gleason Farm
Valley View, Ohio
Cuyahoga County

The Edmond Gleason farm is being nominated as a boundary increase to the Edmund Gleason House nomination, listed 1979. The amendment to this document is being nominated under Criterion A for association with the agricultural development of Cuyahoga Valley, and Criterion C for representing locally important building practices. The original nomination was done under Criterion C, also for architecture. This document discusses the architecture of the house and only mentions the barn. The boundary increase nomination will address the architectural significance of the barn along with the other agricultural outbuildings.

The contributing resources are consistent with the description, significance statement, and registration requirements for Associated Property Type: Farmstead listed in the Agricultural Resources of Cuyahoga Valley MPD.

Historical Background

The Gleason farm dates from 1847 when Mary C. and Edward C. Hubbard of Middletown, Connecticut, sold one hundred acres in Independence Township, Cuyahoga County, Ohio, to Edmond Gleason for \$1500. Regardless, Edmond Gleason is not listed as the owner of ninety-eight acres in tract 4, lot 8, until 1850.

The exact date of Edmond Gleason's arrival in Independence Township is not known. However, he is listed as a resident Independence landowner on the east side of the Cuyahoga River in 1843. Edmond Gleason married Charlotte Comstock of Bedford, Ohio, on April 4, 1848. The 1850 census shows that Edmond Gleason, then thirty-four years old, was a native of New York state and that he was employed as a farmer. Charlotte and Edmond had two children, Frank, the oldest, and Clara. Edmond Gleason died ca. 1860. Thereafter, his property is listed in the tax duplicate under the name of "Edmond Gleason Heirs."

The 1880 U.S. Census Products of Agriculture lists Frank Gleason as the owner of record. The farm consisted of 110 acres of tilled land and 50 acres of meadow and pasture, and 50 acres of woodland.

NPS Form 10-900a
(8-86)

OMB Approval No. 1024-0018

United States Department of the Interior
National Park Service

NATIONAL REGISTER OF HISTORIC PLACES
CONTINUATION SHEET

Section number 8 Edmond Gleason Farm

Page 4

Edmond Gleason Farm
Valley View, Ohio
Cuyahoga County

Edmond's daughter, Clara, married Dominick M. Carey in 1881. Carey was a prominent contractor who founded the firm of Paige, Carey & Co. He participated in the building of West Virginia's Norfolk & Western Railroad, the Valley Railroad between Cleveland and Canton, and the Union Bridge over the Ohio River in Wheeling, West Virginia. On January 14, 1892, Dominick Carey drowned when he was swept by flood waters from a temporary tramway being used in the construction of the Main Street stone bridge in Wheeling. After the death of her husband, Clara and her three sons, moved from their home in northern Ohio back onto the family farm.

Clara lived on the farm until her death 1938. In 1935, the property of Edmond Gleason passed to his grandson, Edwin Carey, who lived there until his death in 1987, at age 98. Edwin Carey served as the first elected mayor of Valley View from 1926 to 1929.

Criterion A: Agriculture

The Gleason Farm is associated with the Railroads, Industrialization and Scientific Farming Era, 1851-1913, and the period of Agricultural Decline and Economic Diversification, 1913-1930. The nominated property has historically functioned as a farm from its acquisition in 1851 by Edmond Gleason throughout the context period, ending in 1930.

As a native of New York state, Edmond is typical of the migratory patterns and cultural influences that impacted the development of agriculture in the context area. The remaining foundation of the old barn roughly matches the dimensions typical of the New England or Three Bay Barn type. Although the U.S. Census Records Products of Agriculture for Cuyahoga County are only available for 1880, the types of crops and livestock found on the farm would have been influenced by the proximity to the canal. The canal provided profits that encouraged valley farmers to raise cattle and grow wheat-- two commodities that required more effort than swine and corn.

The 1880 U.S. Census Products of Agriculture indicates that the Gleason Farm relied on hired help. During 1879, the Gleason's paid \$388 in wages for 24 weeks of hired labor. Other farms in the township listed in the census records do not indicate this level of outside help. Dairying seems to have been the principal emphasis of the farm. Livestock consisted of 7 "milch

NPS Form 10-900a
(8-86)

OMB Approval No. 1024-0018

United States Department of the Interior
National Park Service

NATIONAL REGISTER OF HISTORIC PLACES
CONTINUATION SHEET

Section number 8 Edmond Gleason Farm Page 5

Edmond Gleason Farm
Valley View, Ohio
Cuyahoga County

cows", 10 "other" cattle, and 7 calves. The farm produced 400 pounds of butter that year. The principal crop was oats with a production of 530 bushels, followed by Indian corn, with a production of 200 bushels.

Criterion C: Architecture

The buildings, structures and sites that comprise the Gleason Farm, form a functionally related unit that is associated with historic agricultural practices. The buildings either represent specific farming practices, or construction practices associated with historic agricultural outbuildings.

The Wisconsin Dairy Barn contains architectural features associated with this building type. The rectangular massing, double pitch roof line, light lumber trussing, and rows of hay doors are characteristic features of this barn type developed at the Agricultural Experiment Station at the University of Wisconsin, Madison. The narrow width and rows of small windows are design features that maximize light for the lower livestock area. The gambrel roof profile provided more storage space needed for hay to feed the livestock.

The barn's interior contains rough cut timber beams and pegged mortise and tenon joints. The loft, or second level, retains a functional hay rail and hook; a feature that emphasizes transition from mowing loose hay to contemporary hay bailing techniques. The lower level contains evidence of a dairy operation. On the west end, milking stanchions and a closed-loop watering system remain. On the east end there is evidence of more livestock; mangers are damaged where horses have been "cribbing," or chewing, while they stood in their stalls.

The granary evidences architectural features that convey its function. The slat walls, single door, ventilator monitor, and raised block foundation provided ventilation needed to prevent spontaneous combustion associated with grain storage. Elevating the structure on blocks helped keep rodents away from the crops.

Similar building features are found on the corncrib-- the concern for ventilation and rodent abatement also being necessary. Unlike the granary, however, the corncrib also has slanted walls, making it more difficult for rodents to get in.

NPS Form 10-900a
(8-86)

OMB Approval No. 1024-0018

United States Department of the Interior
National Park Service

NATIONAL REGISTER OF HISTORIC PLACES
CONTINUATION SHEET

Section number 8 Edmond Gleason Farm Page 6
=====

Edmond Gleason Farm
Valley View, Ohio
Cuyahoga County

The shed structure typifies the materials and construction of agricultural outbuildings from the late 19th and early 20th century. Both the drop siding and plain wood surround trim are constructed of milled lumber, which the railroads made readily available to farmers.

The agricultural fields, located in the valley floor, took advantage of the rich soils of the floodplain. This site, along with the old barn ruin site, are integral parts of the farm's historic landscape.

Historic Integrity

The Gleason farm has a high degree of integrity. The farm is in an agricultural setting, surrounded by fields or wooded lands. The watered portion of the Ohio & Erie Canal, (NHL, 1979) still flows directly west of the farmstead, contributing to the integrity of feeling and association. The buildings and structures are in their original location and do not evidence any significant alterations. The noncontributing garage and the one noncontributing structure, the post and rail fence, do not detract from the historic rural character of the farmstead.

JAN 28 1993

NPS Form 10-900a
(8-86)

OMB Approval No. 1024-0018

United States Department of the Interior
National Park Service

NATIONAL REGISTER OF HISTORIC PLACES
CONTINUATION SHEET

Section number 9 Edmond Gleason Farm Page 7
=====

Edmond Gleason Farm
Valley View, Ohio
Cuyahoga County

Major Bibliographical References

Deeds. Cuyahoga County Records. vol. 4561, p. 46.

Graham, Priscilla. typewritten history of the Gleason house. 92 College Street, Hudson, Ohio, 1981.

History of Cuyahoga County, Ohio. Cleveland: D.W. Ensign and Co., 1879, p. 462.

Jones, Lynn. typewritten history of the Gleason family. historical research file. Cuyahoga Valley National Recreation Area, 1987.

Tax records for Independence. Cuyahoga County, Ohio.

Western Reserve Historical Society, comp. "Cuyahoga County Marriage Records." 11 vols., (typescript, 1935), p. 462.

Wheeling Daily Intelligencer, Wheeling West Virginia. 15 January 1892.

JAN 28 1992

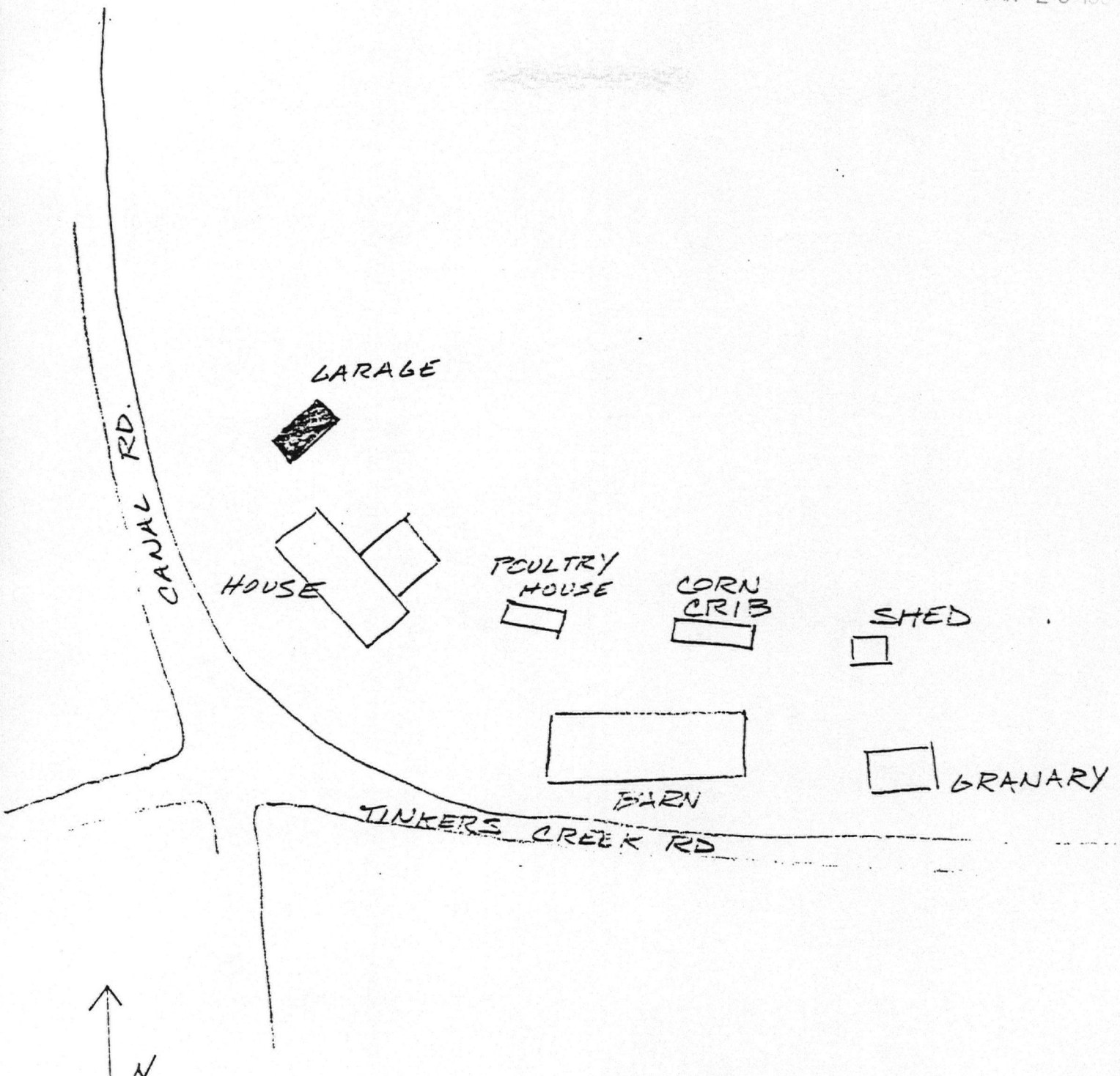

NO SCALE

FARMSTEAD SKETCH MAP

■ NONCONTRIBUTING

□ CONTRIBUTING

EDMUND GLEASON FARM
 VALLEY VIEW, OHIO
 CUYAHOGA COUNTY
 C.V.N. R.A.

JEFF WINSTEL
 5/92

JAN 28 1993

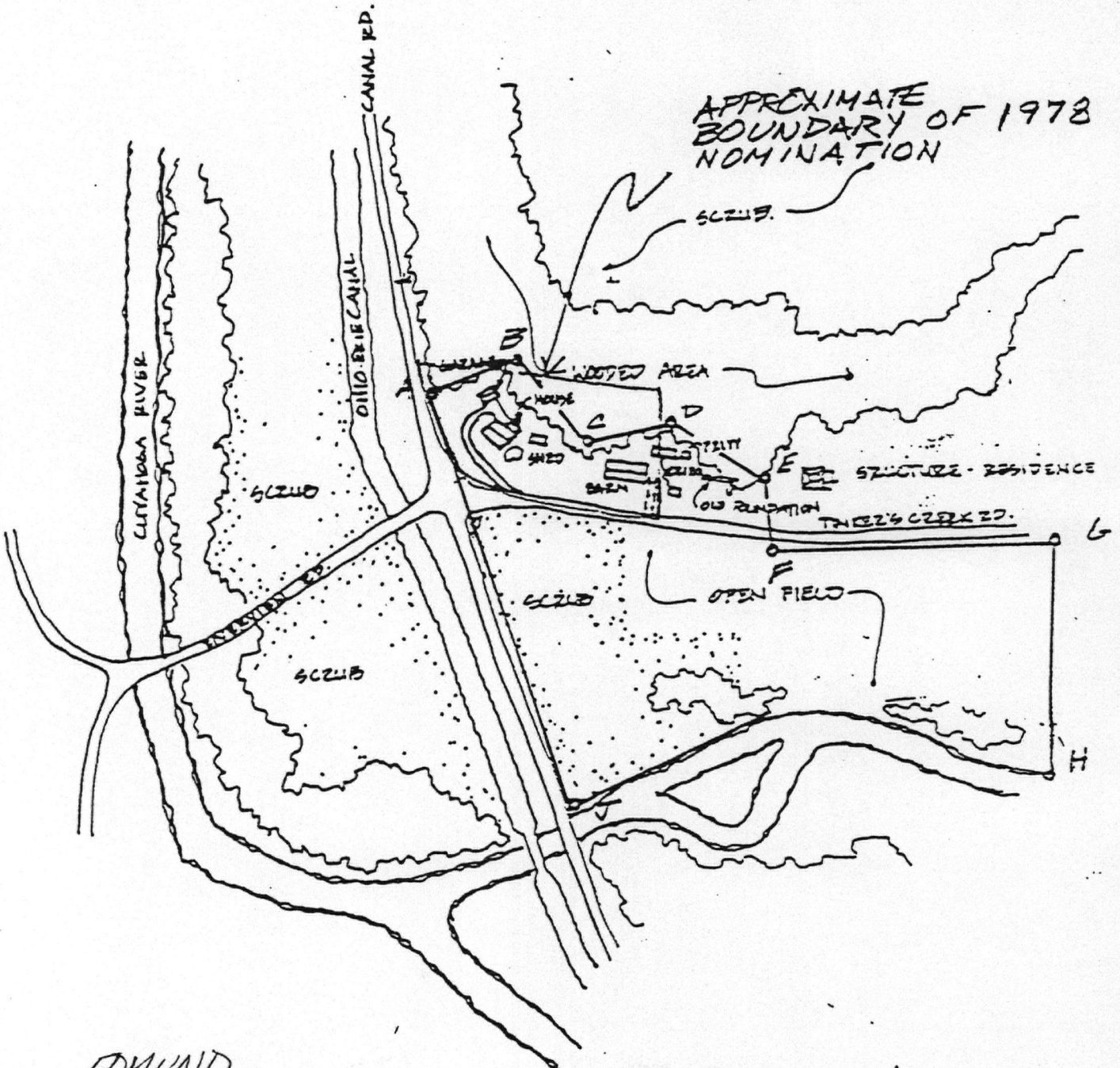

EDMUND
GLEASON

FARM SKETCH PLAN

CATAWOGA VALLEY NATIONAL RECREATION AREA

C. GILBERT 7.7.89

J. WINSTEL 5.92

Scale: 1:300ft.

1/28/93

United States Department of the Interior
National Park Service

National Register of Historic Places
Continuation Sheet

Section number _____ Page _____

Agricultural Resources of the Cuyahoga Valley MPS OHIO

	Listed
COVER	3/12/93
1. Gleason, Edmund, Farm (Boundary Increase)	2/12/93
2. Vaughn, Richard, Farm	3/12/93
3. Brown--Bander Farm (Boundary Increase)	3/12/93
4. Cranz, Edward, Farm	3/12/93
5. Cranz, William and Eugene, Farm	3/12/93
6. Duffy, Michael, Farm	3/12/93
7. Hunt--Wilke Farm	3/12/93

NATIONAL REGISTER OF HISTORIC PLACES
EVALUATION/RETURN SHEET

REQUESTED ACTION: BOUNDARY INCREASE

PROPERTY NAME: Gleason, Edmund, Farm (Boundary Increase)

MULTIPLE NAME: Agricultural Resources of the Cuyahoga Valley MPS

STATE & COUNTY: OHIO, Cuyahoga

DATE RECEIVED: 1/28/93
DATE OF 16TH DAY: 2/25/93
DATE OF WEEKLY LIST:

DATE OF PENDING LIST:
DATE OF 45TH DAY: 3/14/93

REFERENCE NUMBER: 93000075

NOMINATOR: FEDERAL NPS

REASONS FOR REVIEW:

APPEAL: N DATA PROBLEM: N LANDSCAPE: N LESS THAN 50 YEARS: N
OTHER: N PDIL: N PERIOD: N PROGRAM UNAPPROVED: N
REQUEST: N SAMPLE: Y SLR DRAFT: Y NATIONAL: N

COMMENT WAIVER: N

ACCEPT RETURN REJECT 3/12/93 DATE

ABSTRACT/SUMMARY COMMENTS:

*the Edmund Gleason Farm is significant under
Criteria A and C in the areas of agriculture
and architecture. The resources illustrate
typical mudding methods for the era and
the history of agricultural practices in the
Cuyahoga Valley.*

RECOM./CRITERIA Accept A&C
REVIEWER PS Chairman
DISCIPLINE Historic
DATE March 12, 1993

DOCUMENTATION see attached comments Y/N see attached SLR Y N

CLASSIFICATION

count resource type

STATE/FEDERAL AGENCY CERTIFICATION

FUNCTION

historic current

DESCRIPTION

architectural classification
 materials
 descriptive text

SIGNIFICANCE

Period Areas of Significance--Check and justify below

Specific dates Builder/Architect
Statement of Significance (in one paragraph)

summary paragraph
 completeness
 clarity
 applicable criteria
 justification of areas checked
 relating significance to the resource
 context
 relationship of integrity to significance
 justification of exception
 other

BIBLIOGRAPHY

GEOGRAPHICAL DATA

acreage verbal boundary description
 UTM's boundary justification

ACCOMPANYING DOCUMENTATION/PRESENTATION

sketch maps USGS maps photographs presentation

OTHER COMMENTS

Questions concerning this nomination may be directed to

_____ Phone _____

Signed _____

Date _____



- 1) Gleason, Edward: Privy
- 2) Valley View, OH IO
- 3) Dean R. Dickerson
- 4) May 29, 1989
- 5) U.S. Department of Interior, National Park Service, Midwest Region,
1709 JACKSON, OMAHA, NE
- 6) Camera direction: North



1) Edmund Glosser: Field

2) Valley View, OHIO

3) Dean R. Dickerson

4) May 29, 1989

5) U.S. Department of Interior, National Park Service, Midwest Region,
1709 JACKSON, OMAHA, NE

6) Camera direction: South east



- 1) Edmond GLOSSON, SOUTH of TINKERS CREEK ROAD
- 2) Valley View, OHIO
- 3) DEAN R. DICKERSON
- 4) MAY 29, 1989
- 5) U.S. DEPARTMENT OF INTERIOR, NATIONAL PARK SERVICE, Midwest Region, 1709 JACKSON, OMAHA, NE
- 6) CAMERA DIRECTION: EAST



- 1) Edmond GLEASON, CORN CRIB
- 2) VALLEY VIEW, OHIO
- 3) DEAN R. DICKERSON
- 4) MAY 29, 1989
- 5) U. S. DEPARTMENT OF INTERIOR, NATIONAL PARK SERVICE,
MIDWEST REGION, 1209 JACKSON, OMAHA, NE
- 6) CAMERA DIRECTION: NORTH WEST



- 1) Edmund Gleason, CORN CRIB
- 2) Valley View, OHIO
- 3) Dean R. Dickerson
- 4) May 29, 1989
- 5) U.S. Department of Interior, National Park Service, Midwest Region,
1709 JACKSON, OMAHA NE
- 6) Camera direction: Northeast



1) Edmund Gleason, Born

2) Valley View, OHIO

3) Dean R. Dickerson

4) May 29, 1989

5) U.S. Department of Interior, National Park Service, Midwest Region,
1709 JACKSON, OMAHA, NE

6) Camera direction: Southeast



- 1) Edmond Gleason, old barn foundation
- 2) Valley View, OHIO
- 3) Dean Dickerson
- 4) May 29, 1989
- 5) U.S. Department of Interior, National Park Service, Midwest Region,
1709 Jackson, OMAHA, NE
- 6) Camera direction: North east

JAN 28 1909

UNITED STATES
DEPARTMENT OF THE INTERIOR
GEOLOGICAL SURVEY

CLEVELAND SOUTH
4581 NW

81°37'30"
41°22'30"

480000m E. 3.7 MI. TO U.S. 21 :49

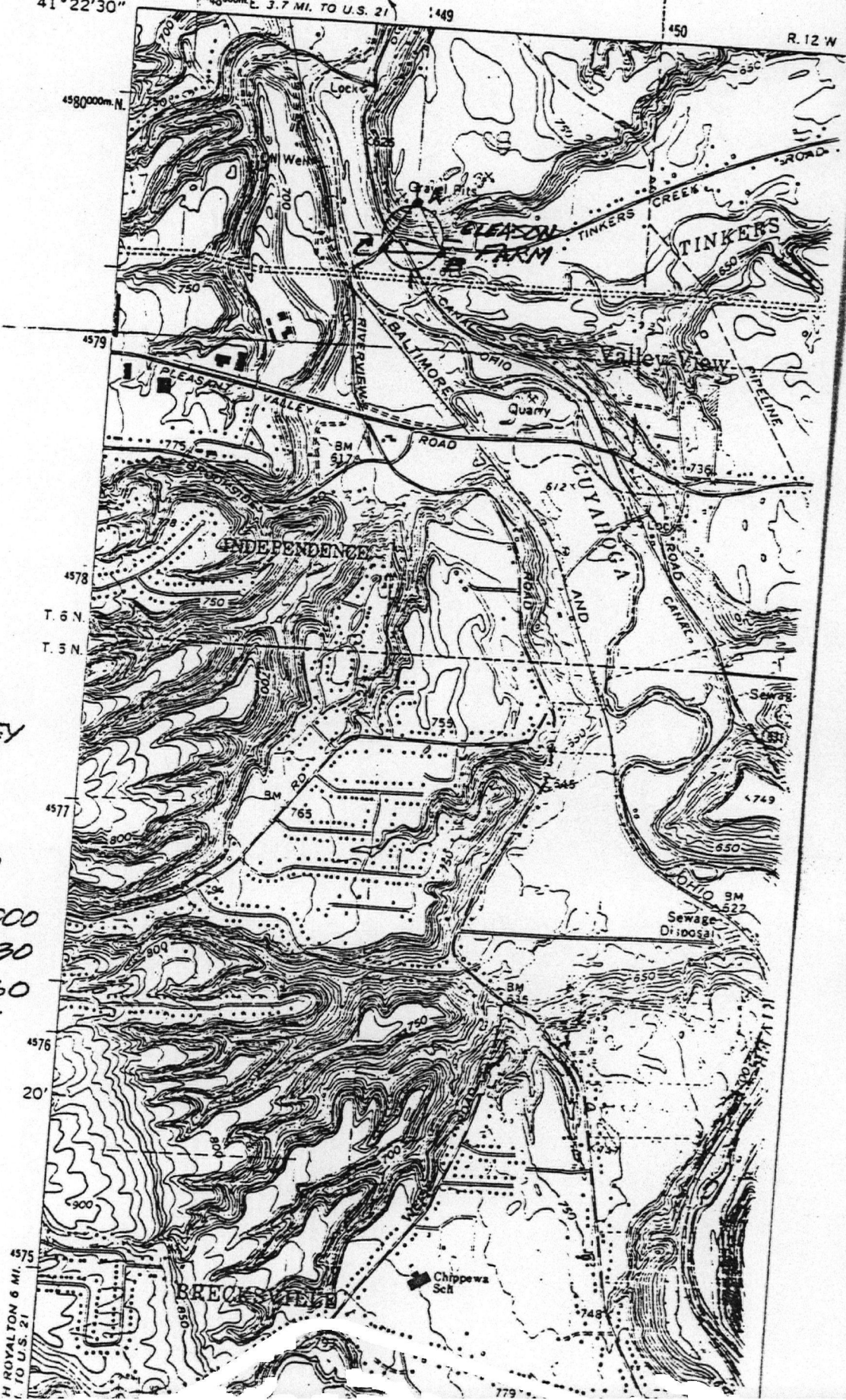

AGRICULTURAL
RESOURCES OF
CUYAHOGA VALLEY
MPD:

EDMOND GLEASON
FARM
VALLEY VIEW, OHIO
CUYAHOGA COUNTY

A: 17-449620-4579000

B: 17-449420-4579130

C: 17-448420-4579860

H ROYALTON 6 MI.
TO U.S. 21

UNITED STATES DEPARTMENT OF THE INTERIOR
NATIONAL PARK SERVICE

NATIONAL REGISTER OF HISTORIC PLACES
EVALUATION/RETURN SHEET

REQUESTED ACTION: ADDITIONAL DOCUMENTATION

PROPERTY NAME: Gleason, Edmund, House
INCLUDED WITH

MULTIPLE NAME: *GLEASON, EDWARD, FARM (BOUNDARY INCREASE)*
CUYAHOGA VALLEY NPS

ORIGINAL NOMINATION
FILED SEPARATELY UNDER
GLEASON, EDMUND, HOUSE

STATE & COUNTY: OHIO, Cuyahoga

DATE RECEIVED: 1/28/93

DATE OF PENDING LIST:

DATE OF 16TH DAY:

DATE OF 45TH DAY: 3/14/93

DATE OF WEEKLY LIST:

REFERENCE NUMBER: 78000377

NOMINATOR: ~~STATE~~ *NPS*

REASONS FOR REVIEW:

APPEAL: N DATA PROBLEM: N LANDSCAPE: N LESS THAN 50 YEARS: N
OTHER: Y PDIL: N PERIOD: N PROGRAM UNAPPROVED: N
REQUEST: N SAMPLE: Y SLR DRAFT: N NATIONAL: N

COMMENT WAIVER: N

ACCEPT RETURN REJECT 3/12/93 DATE

ABSTRACT/SUMMARY COMMENTS:

RECOM./CRITERIA *Accept A-C*
REVIEWER *P. S. Chismar*
DISCIPLINE *Historic*
DATE *3/12/93*

DOCUMENTATION see attached comments Y/N see attached SLR *Y/N*

Please Refer to the Following
Nomination for Additional
Documentation

<u>Resource Name</u>	<u>County, State</u>	<u>Reference Number</u>
Gleason, Edmund, House	Cuyahoga, Ohio	78000377